

Bellamio

Medje
Bett



Hey,

wir freuen uns, dass Du Dich für unser Produkt entschieden hast. Beachte die kommenden Hinweise, um den Aufbau problemlos zu gestalten.

Viel Spaß mit Deinem Produkt!

50%

weniger Fehler beim Aufbau durch
sorgfältiges Lesen der Anleitung



50-60

min

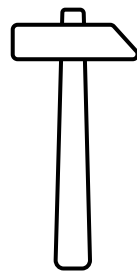

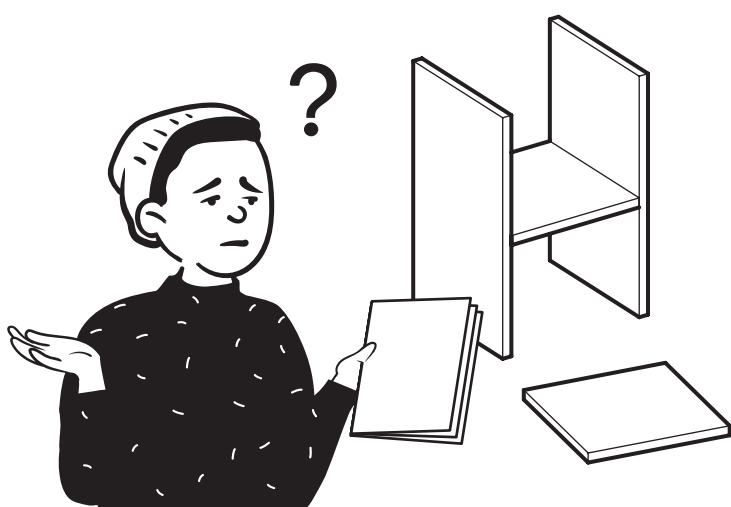
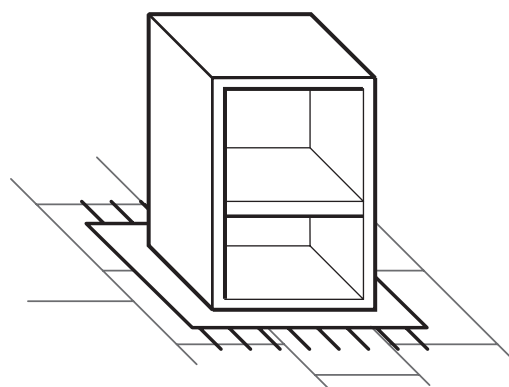
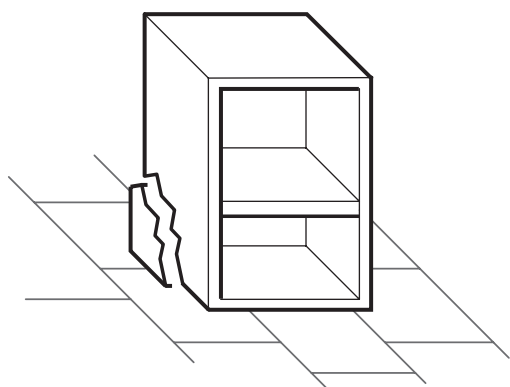

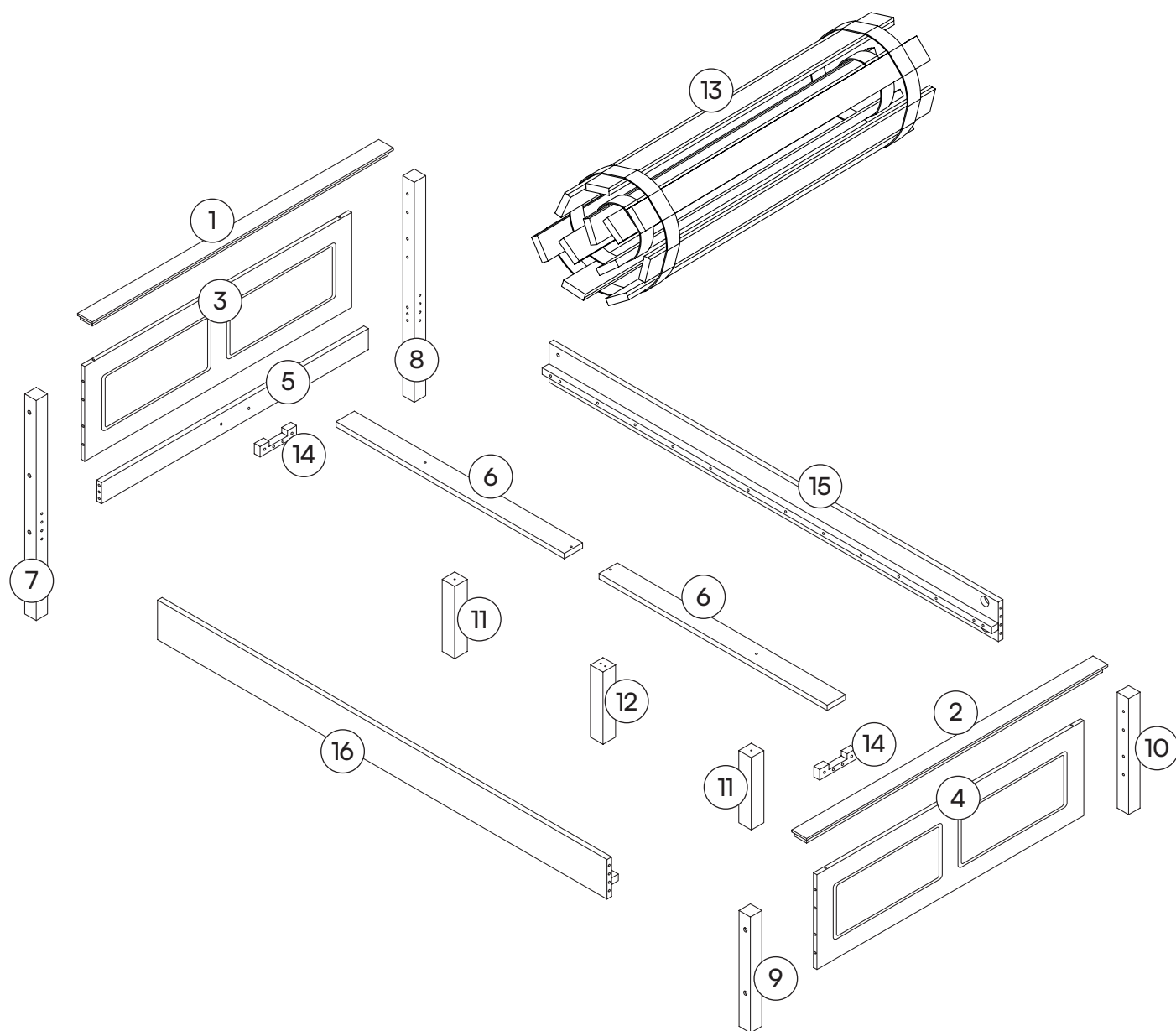

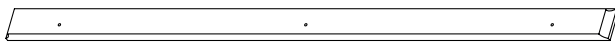

1 Abschlussleiste, Kopfteil
1x

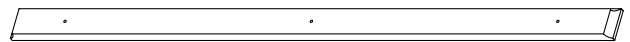

2 Abschlussleiste, Fußteil
1x

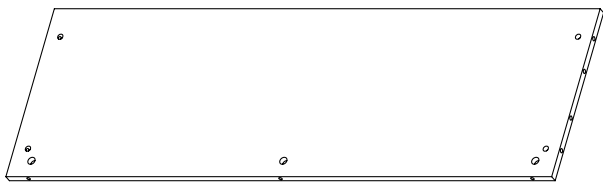

3 Kopfteil
1x

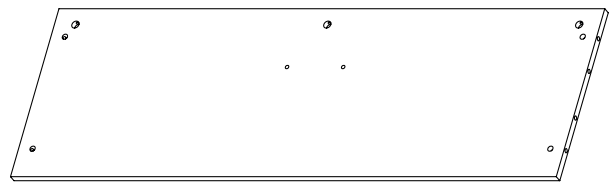

4 Fußteil
1x

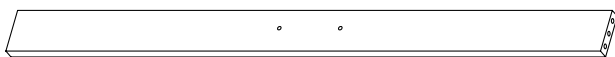

5 Kopfleiste
1x



6 Mittelbalken
2x

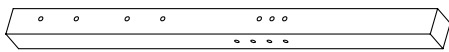

7 Stütze
1x

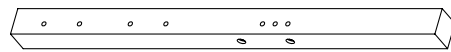

8 Stütze
1x

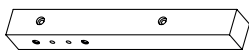

9 Stütze
1x

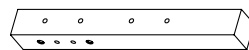

10 Stütze
1x



11 Mittelfuß
2x



12 Mittelfuß
1x

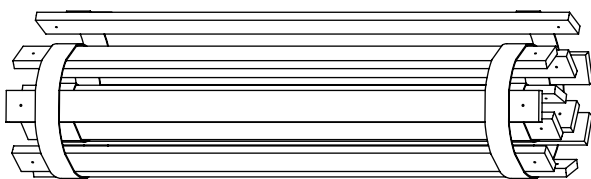

13 Lattenrost
1x

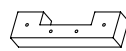

14 Mittelbalkenauflage
2x

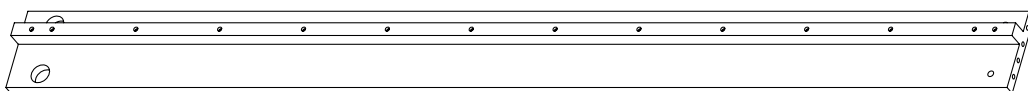

15 Seitenteil
1x

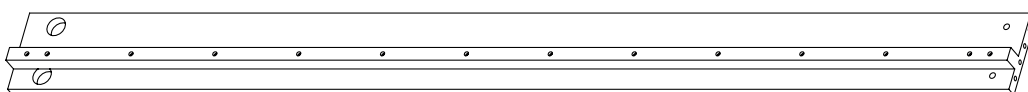

16 Seitenteil
1x

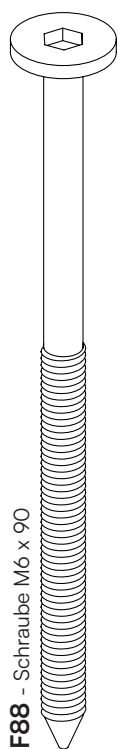

F88 - Schraube M6 x 90

14x

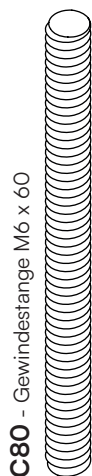

C80 - Gewindestange M6 x 60

4x



W66 - Schraube 7 x 50

4x

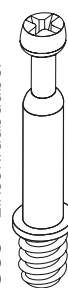

C35 - Einschraubdübel

6x

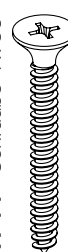

W44 - Schraube 4 x 30

36x

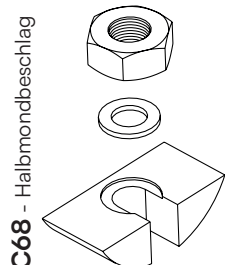

C68 - Halbmondbeschlag

4x

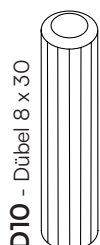

D10 - Dübel 8 x 30

20x

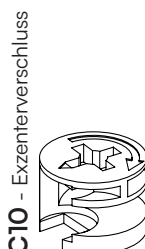

C10 - Exzenterverschluss

6x



C21 - Fassmutter

14x

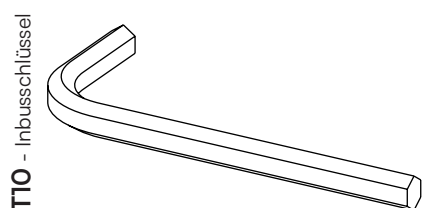

T10 - Inbusschlüssel

1x

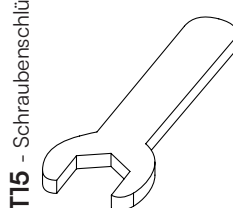

T15 - Schraubenschlüssel

1x

Ein letzter Check:

Bitte überprüfe, ob Du alle Teile hast.

Viel Spaß beim Aufbau!

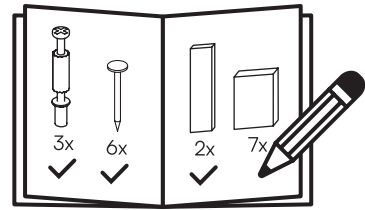

1

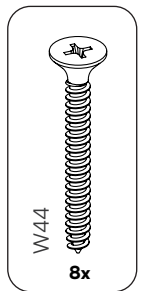
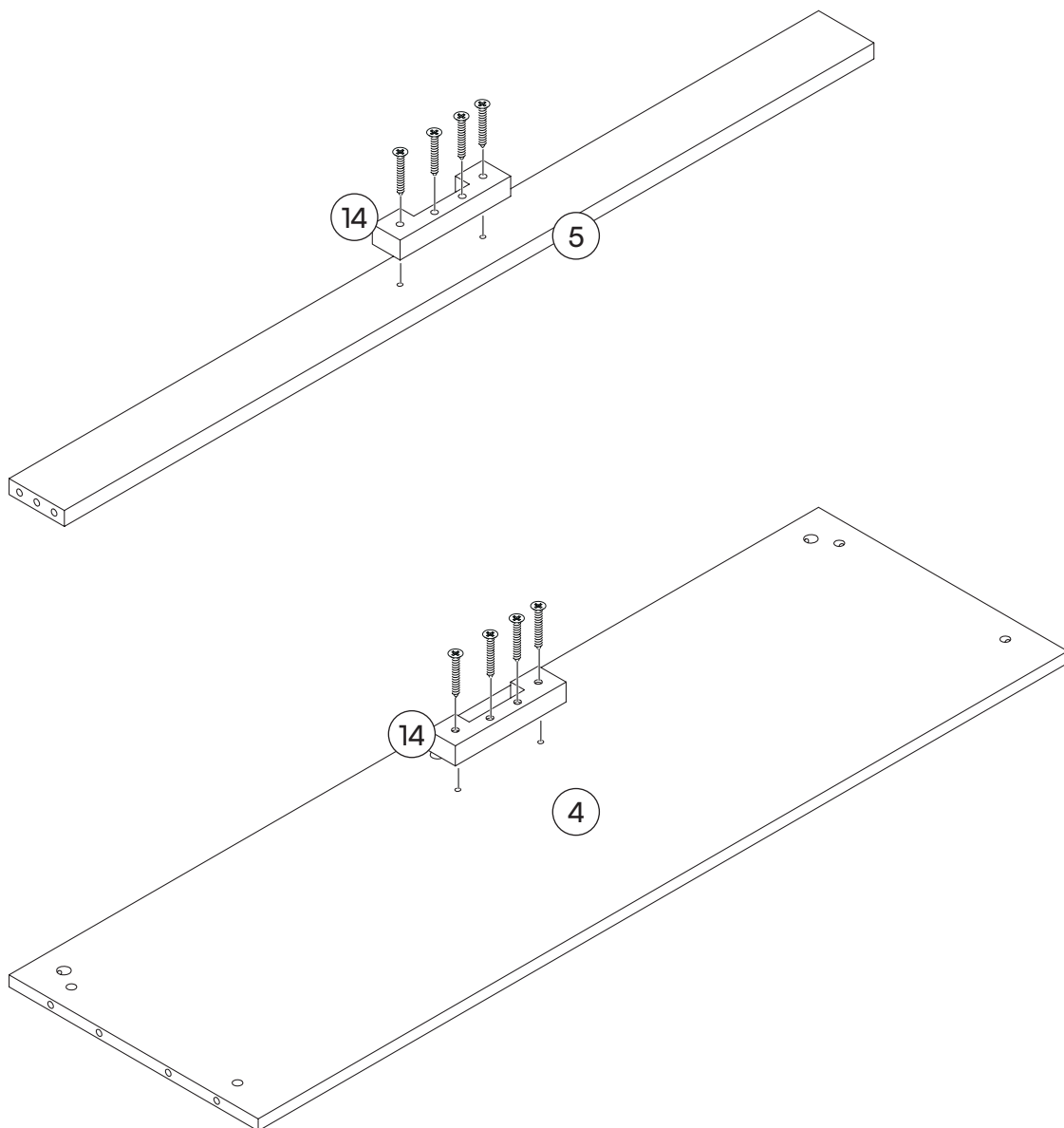

2

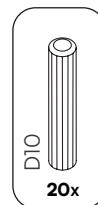
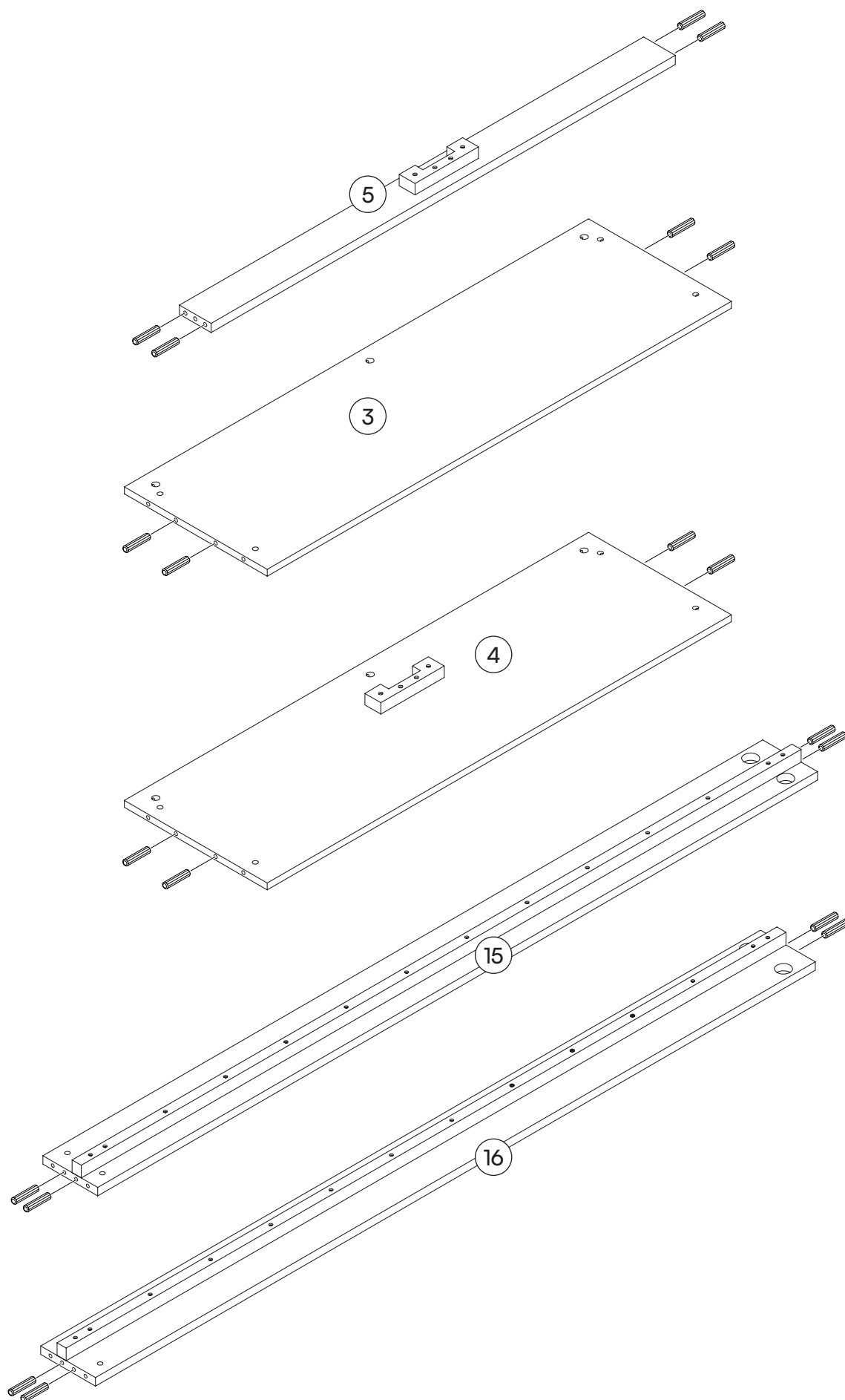

3

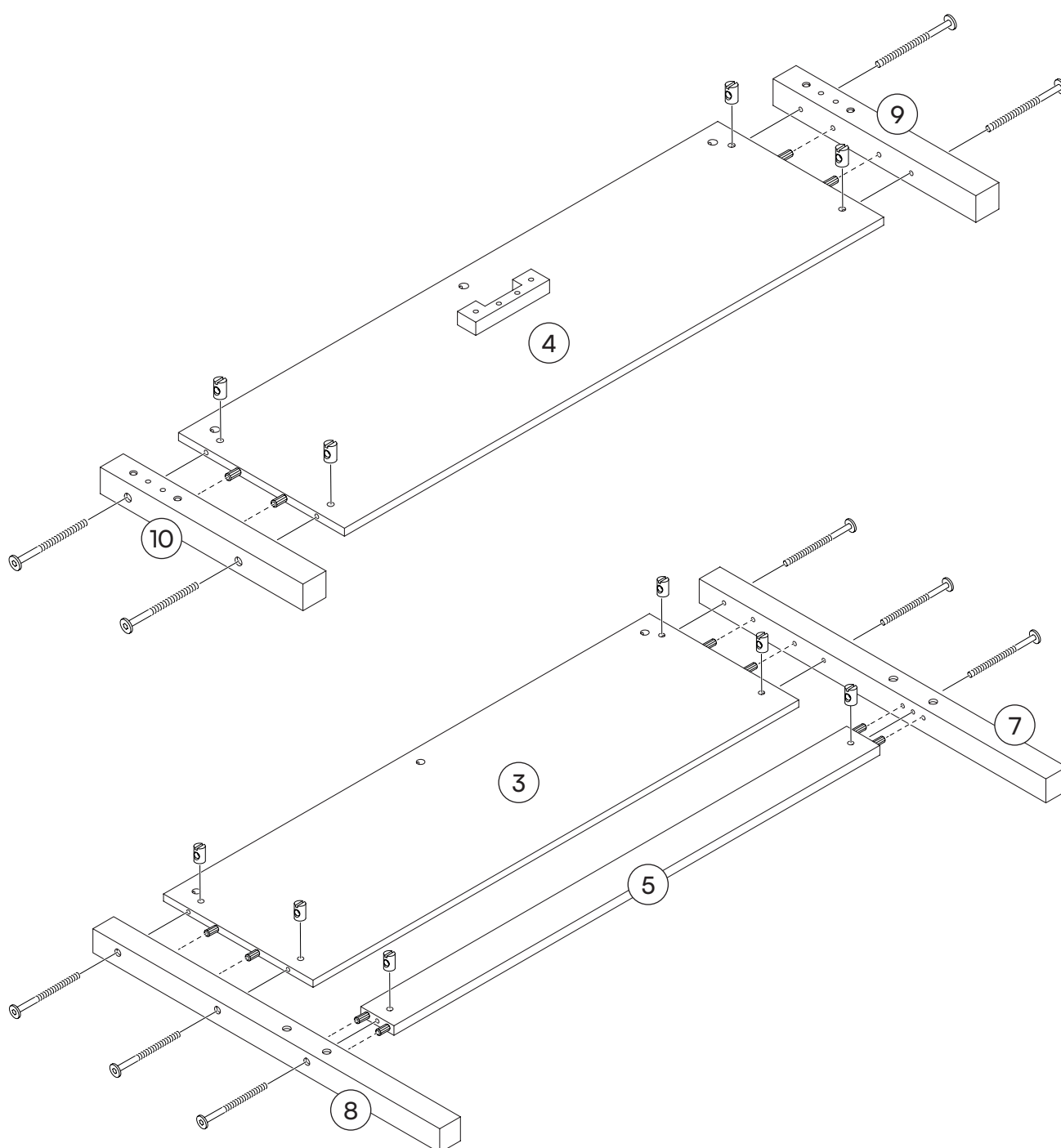
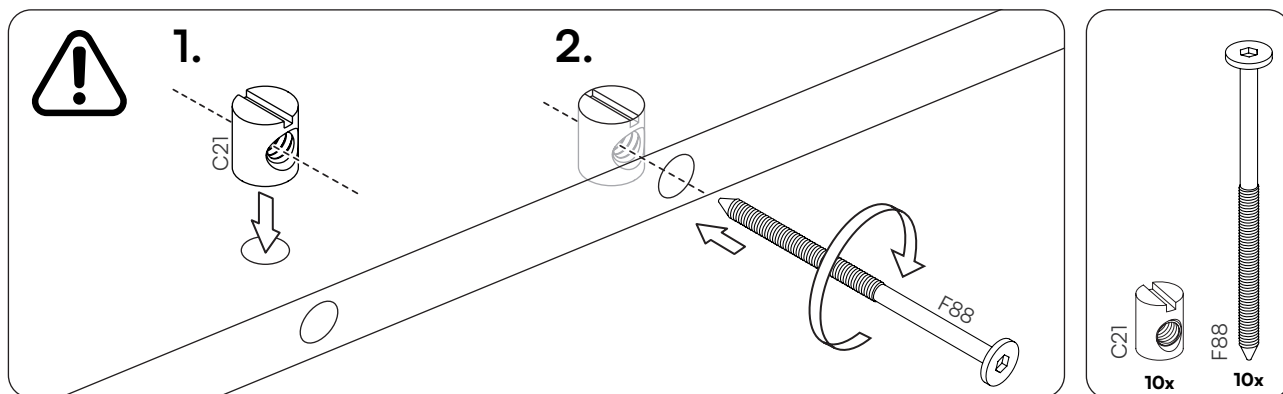

4

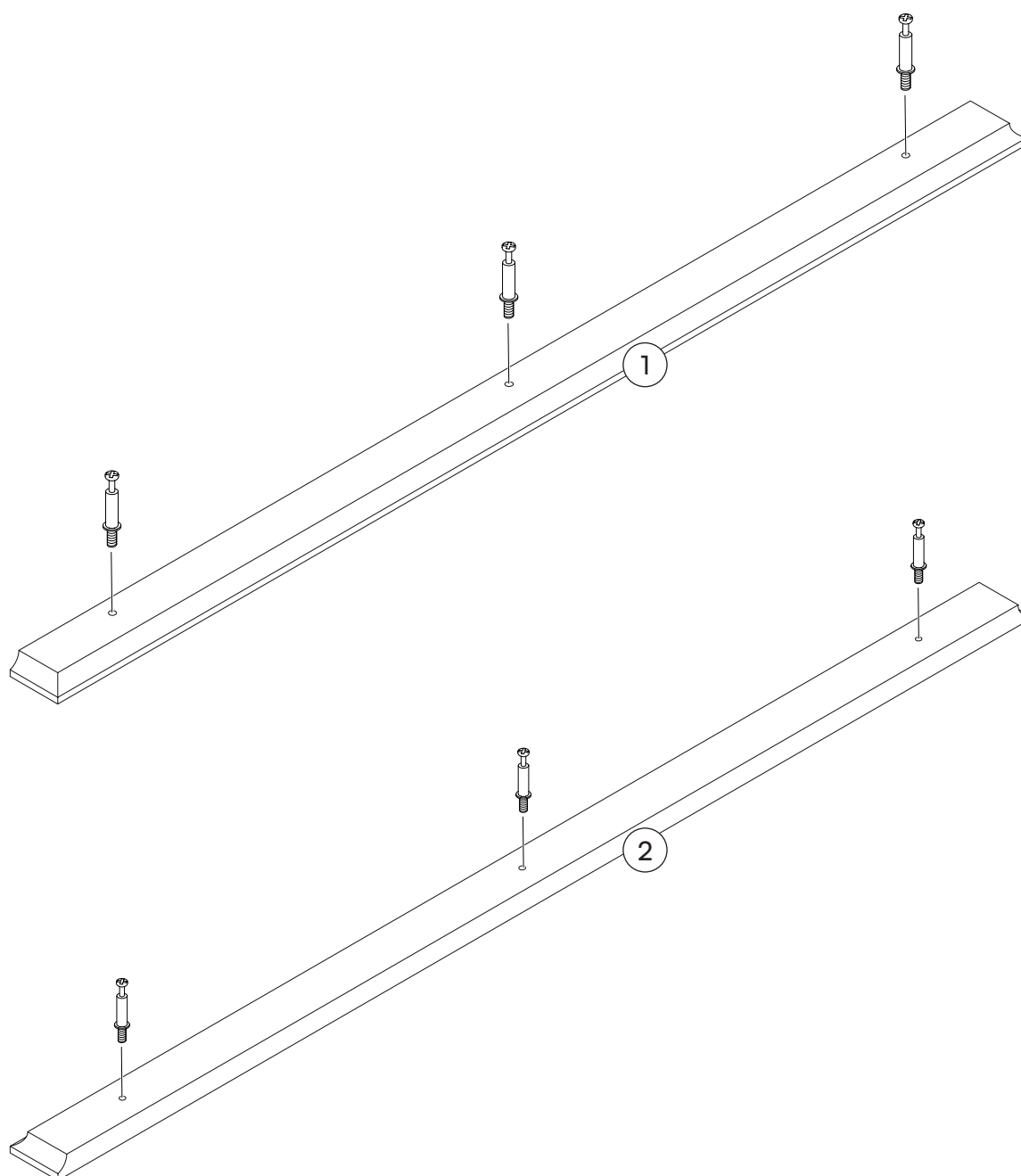
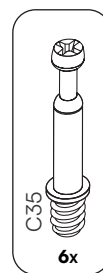

5

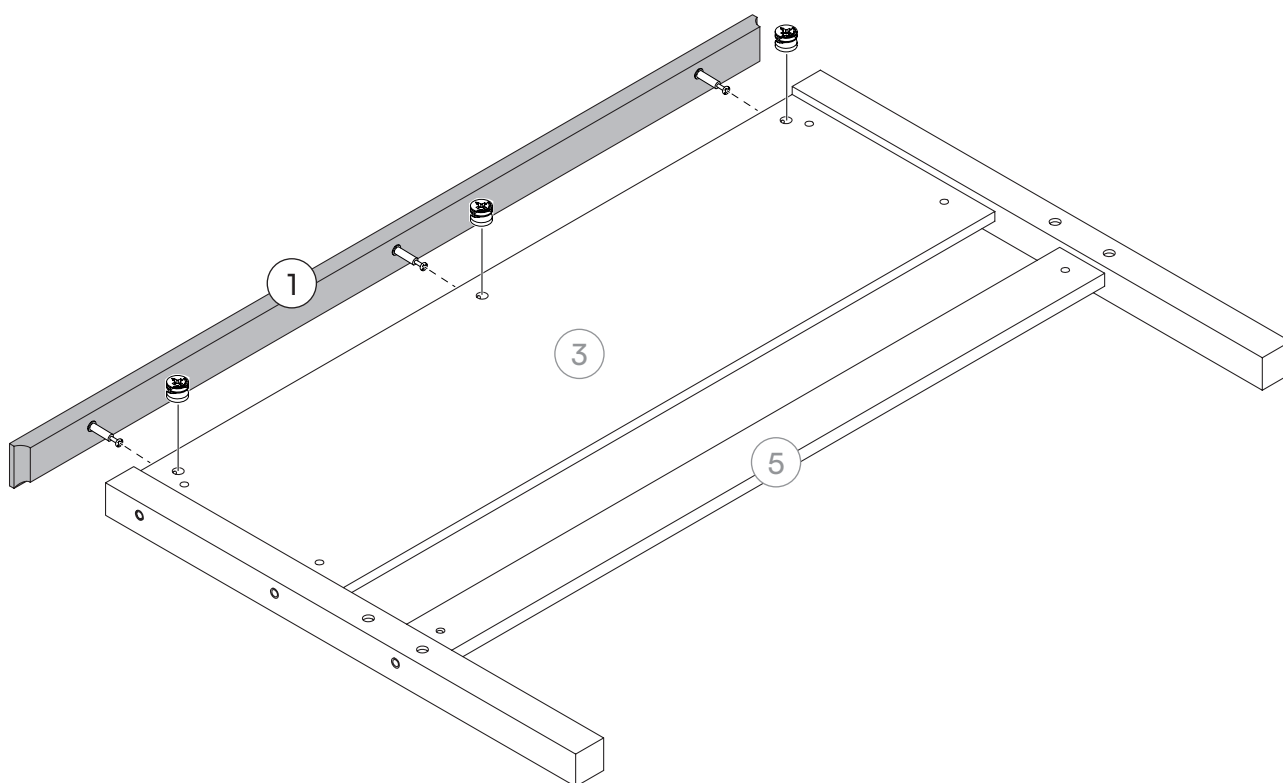
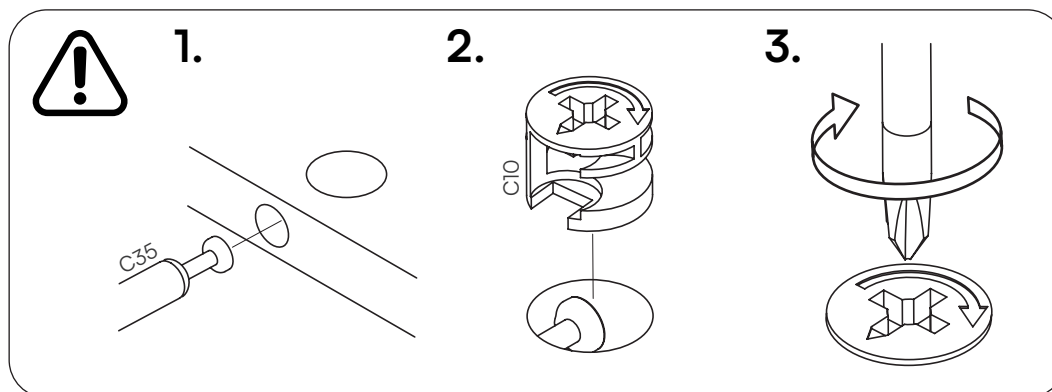

6

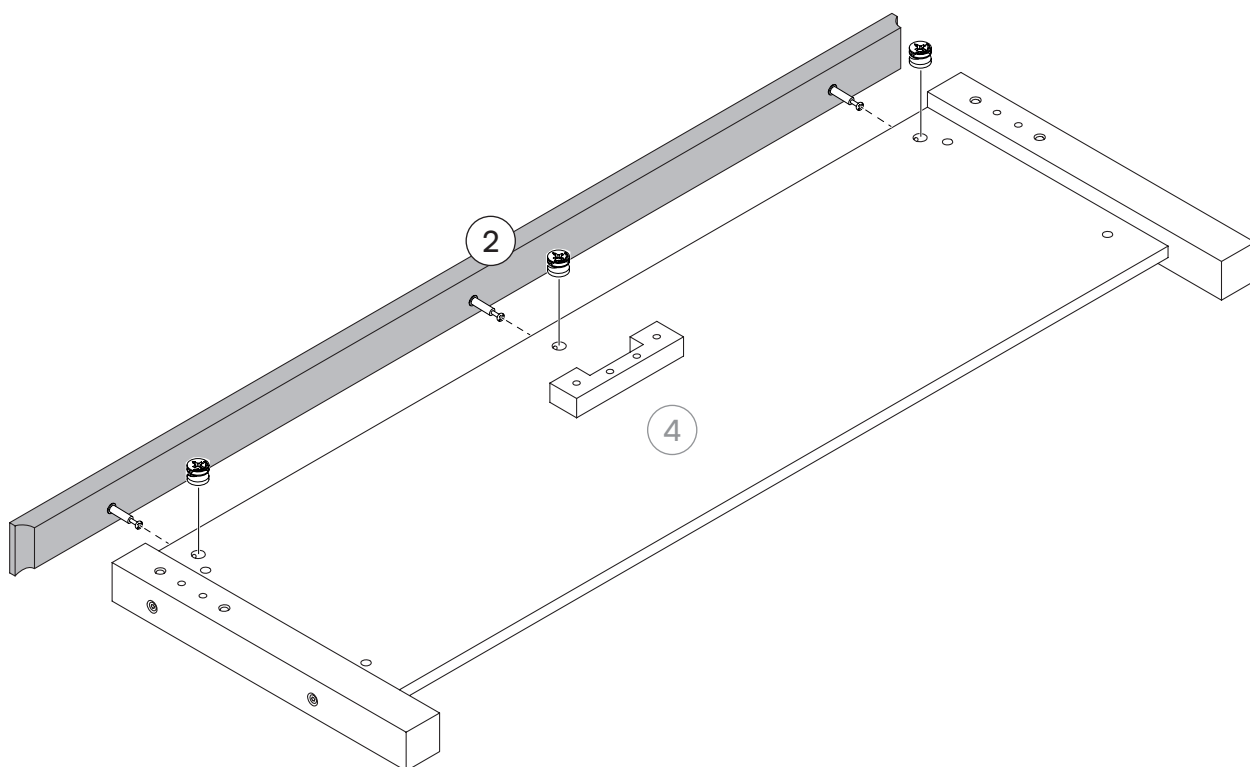
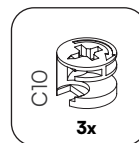

7

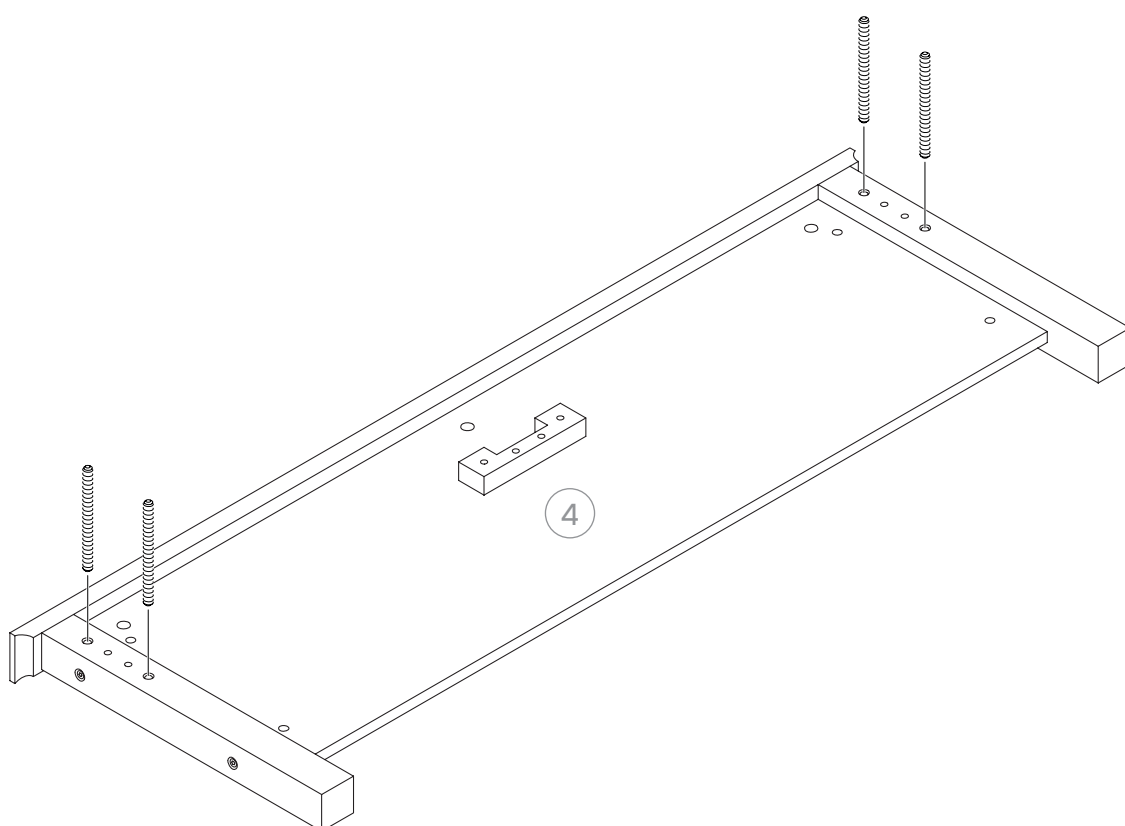
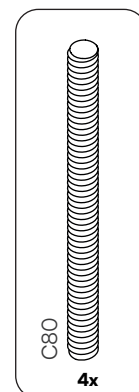

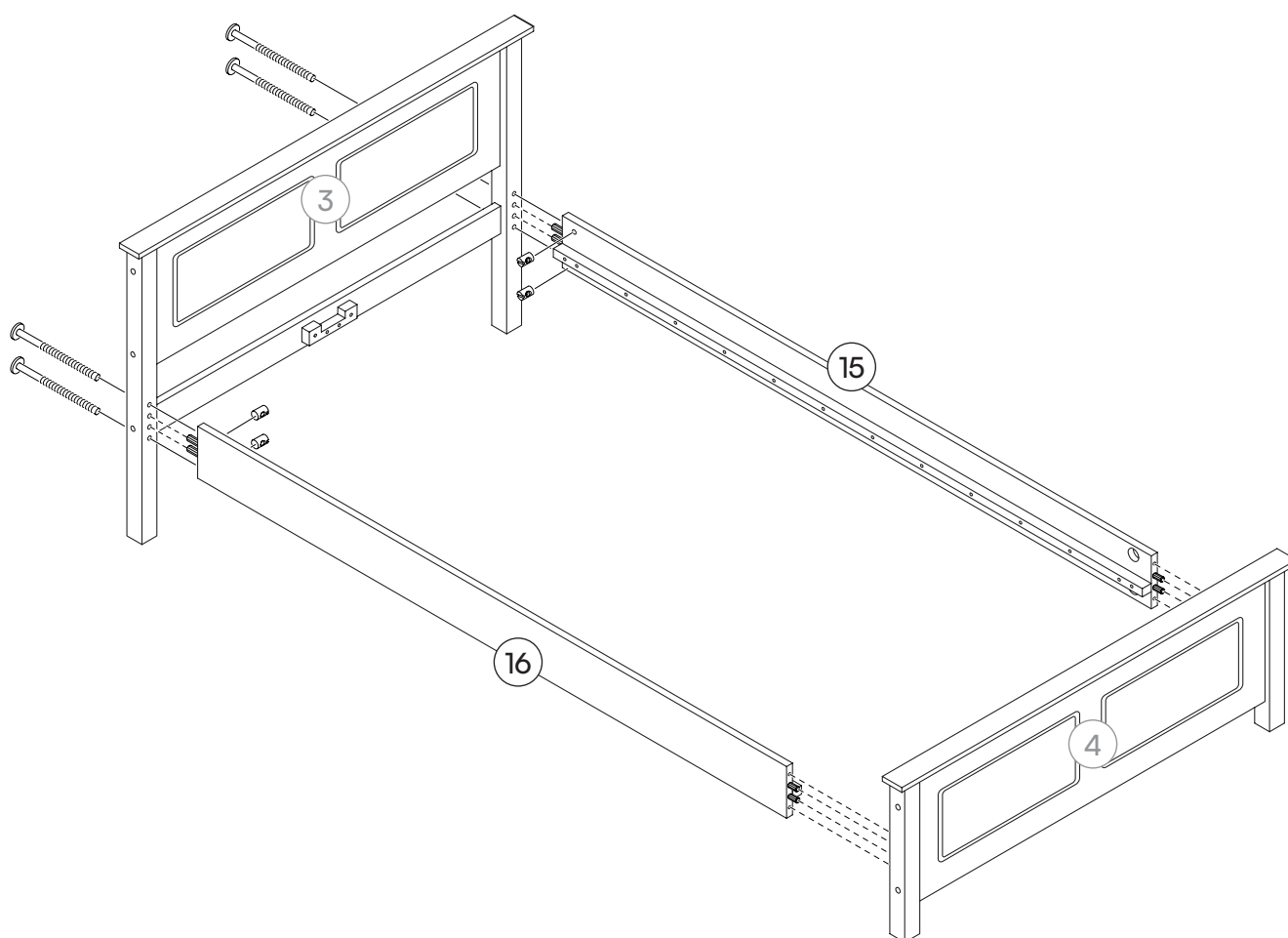
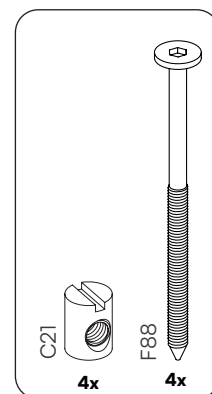

9

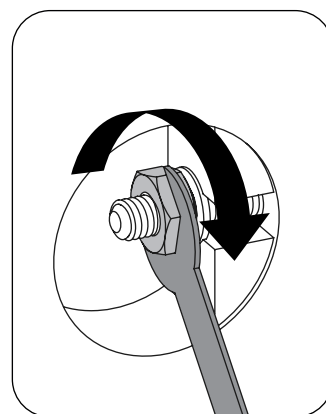
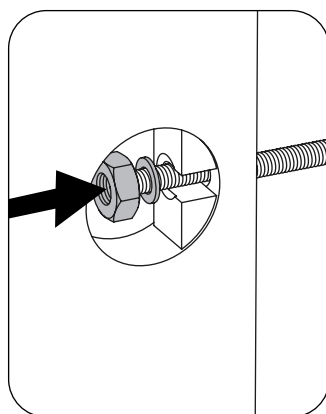
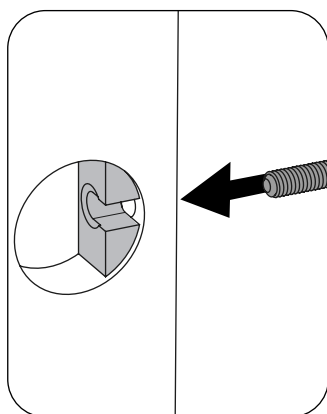
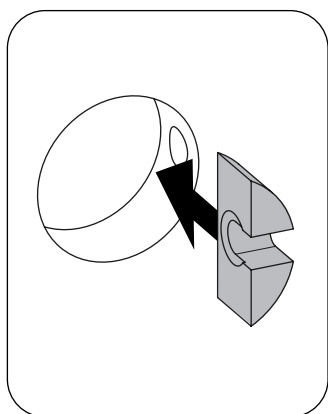
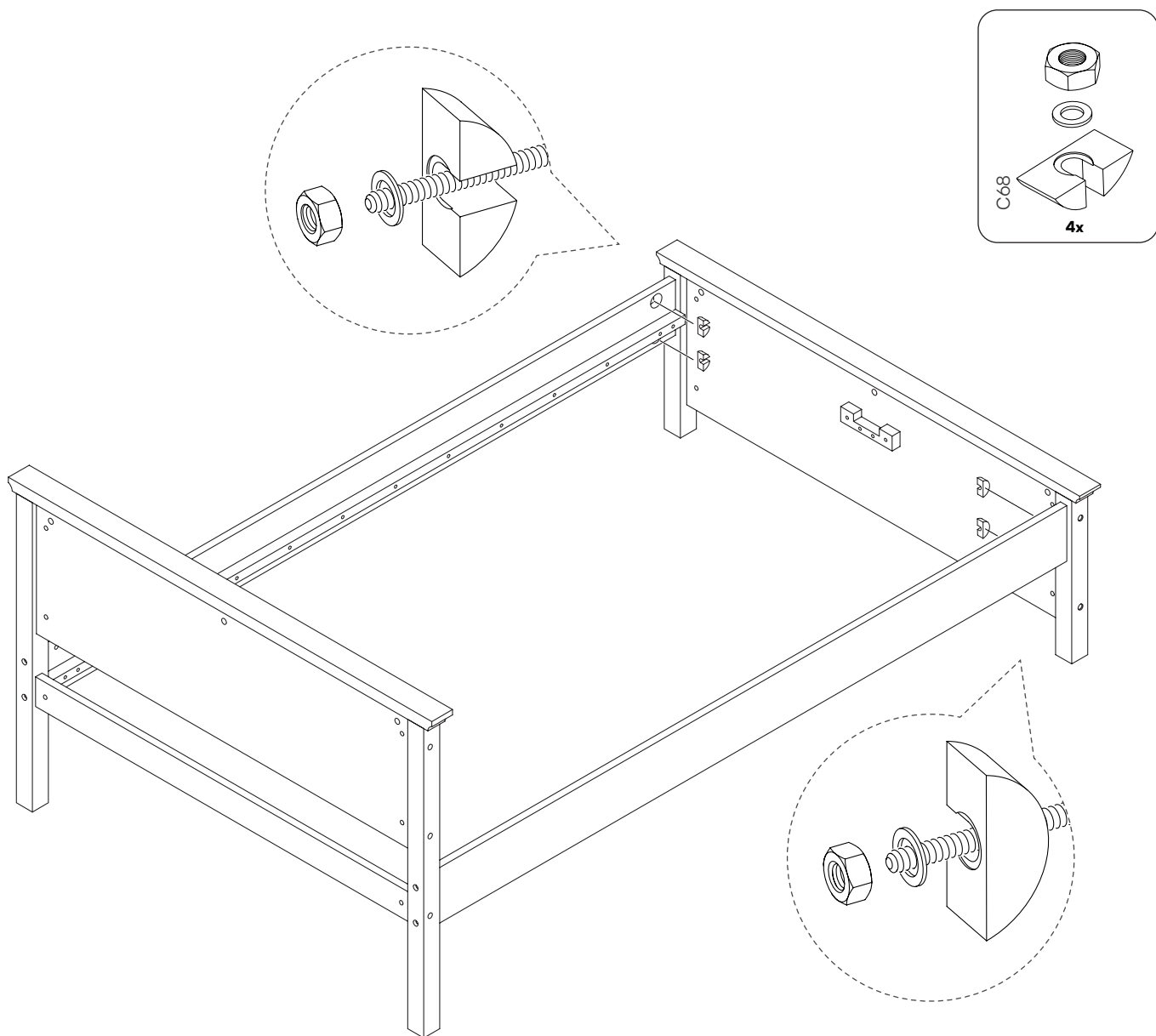

10

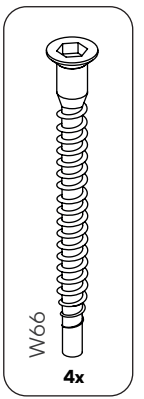
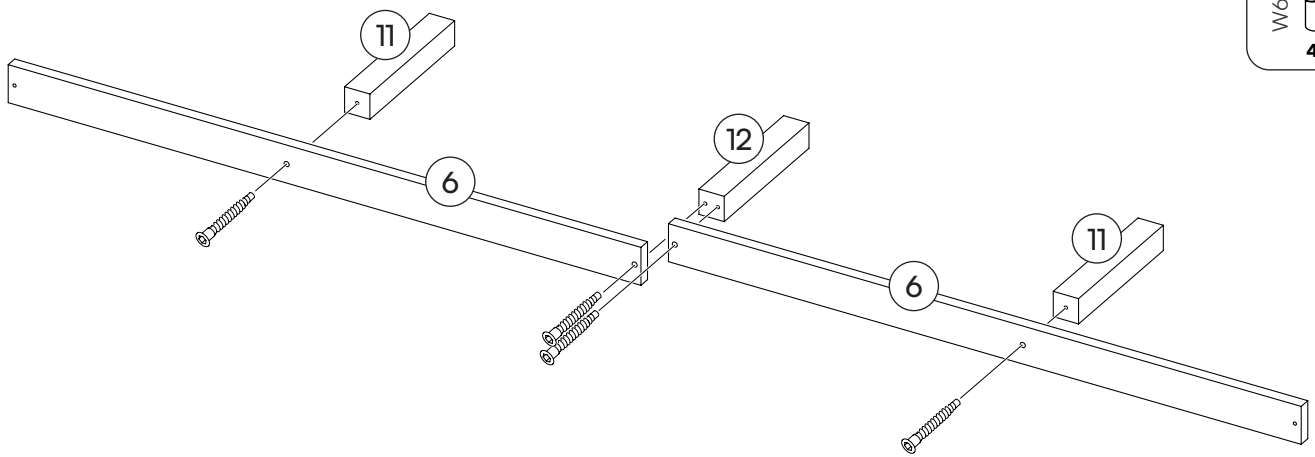

11

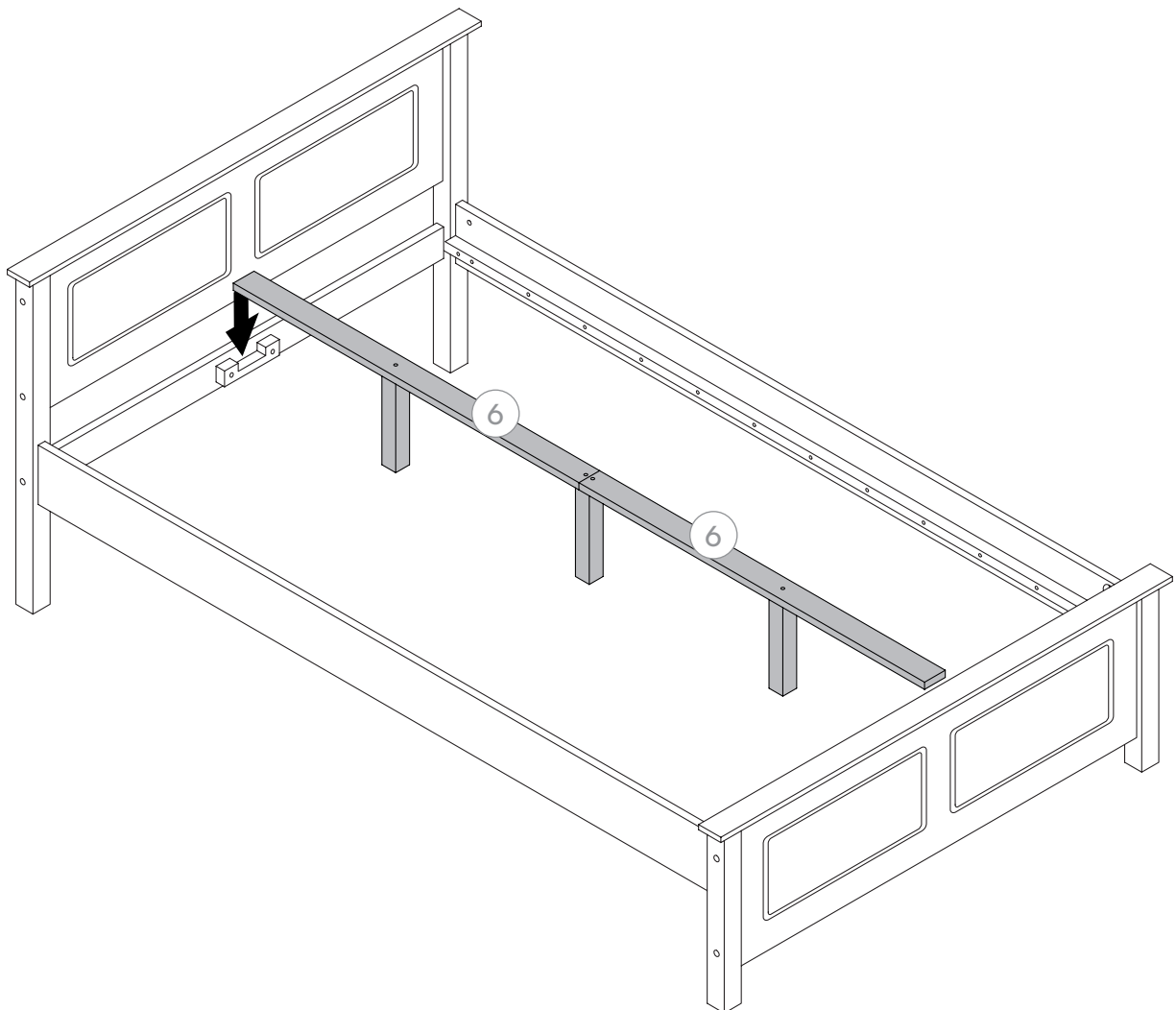

12

