

# skølm.

**Fenrir**  
Bett

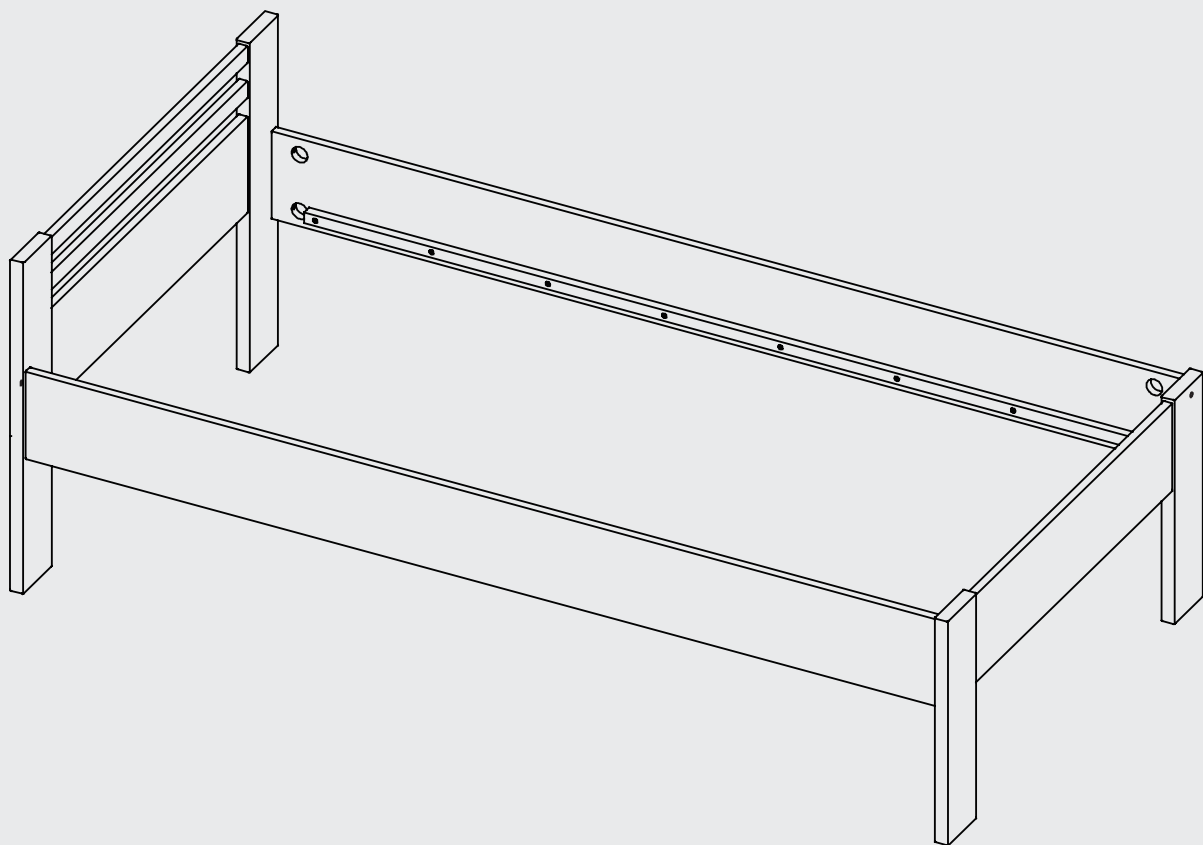



# Hey,

wir freuen uns, dass Du Dich für unser Produkt entschieden hast. Beachte die kommenden Hinweise, um den Aufbau problemlos zu gestalten.

**Viel Spaß mit Deinem Produkt!**

# 50%

weniger Fehler beim Aufbau durch  
sorgfältiges Lesen der Anleitung



## 20-30

min

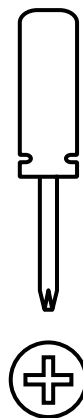

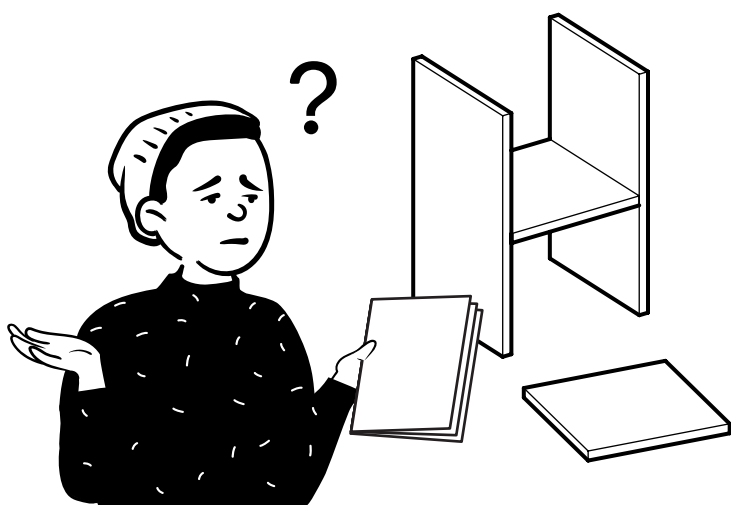
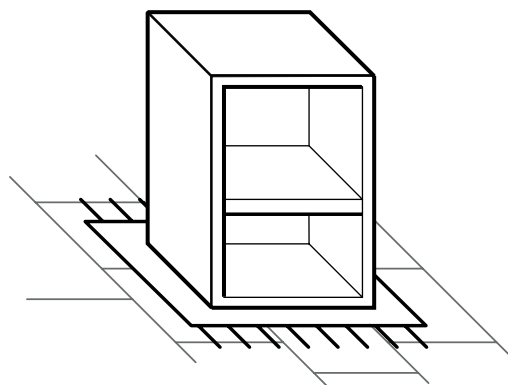
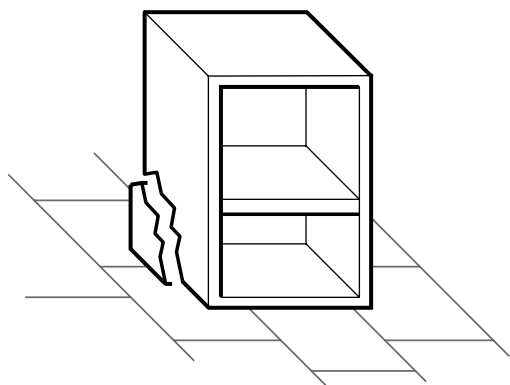

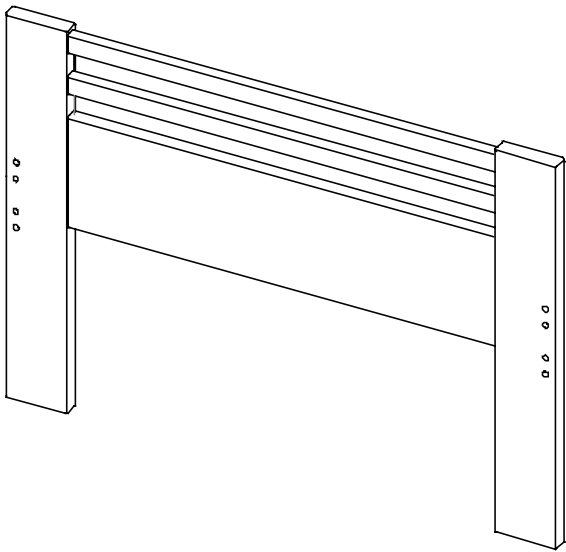

1 Kopfteil  
1x

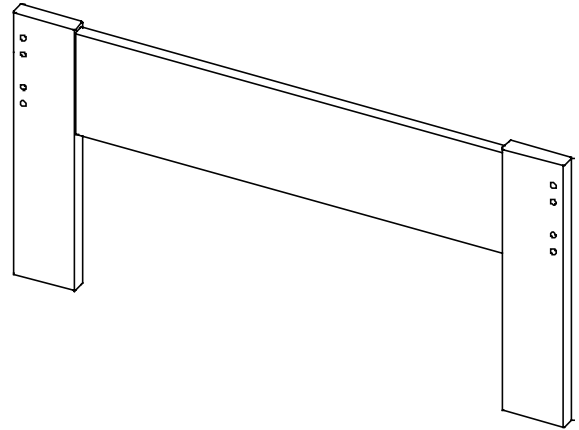

2 Fußteil  
1x

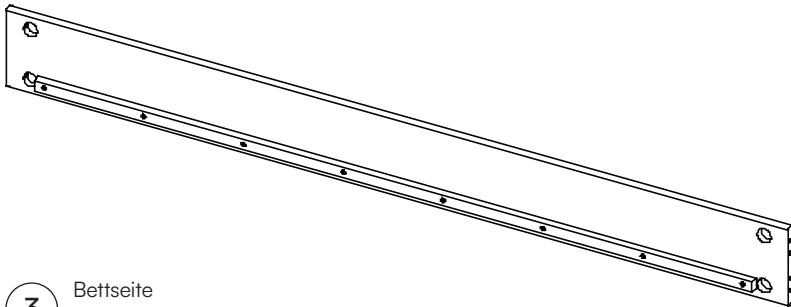

3 Bettseite  
2x

**L87** - Klettverschluss

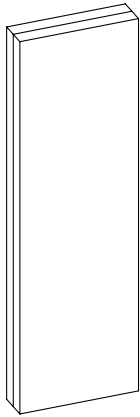

8x

**C23** - Gewindestange M8x80

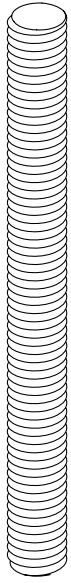

8x

**C22** - Mutter M8

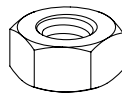

8x

**C24** - Halbmondbeschlag

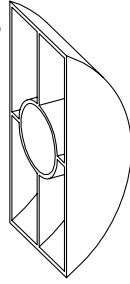

8x

**D12** - Dübel 10x30

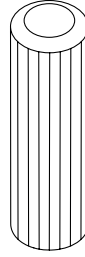

8x

**T12** - Maulschlüssel

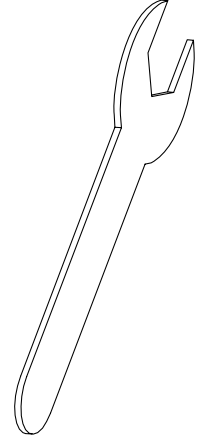

1x

# Ein letzter Check:

Bitte überprüfe, ob Du alle Teile hast.

**Viel Spaß beim Aufbau!**

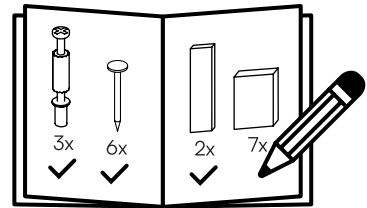

# 1

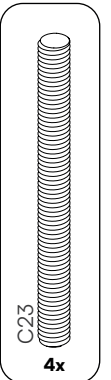
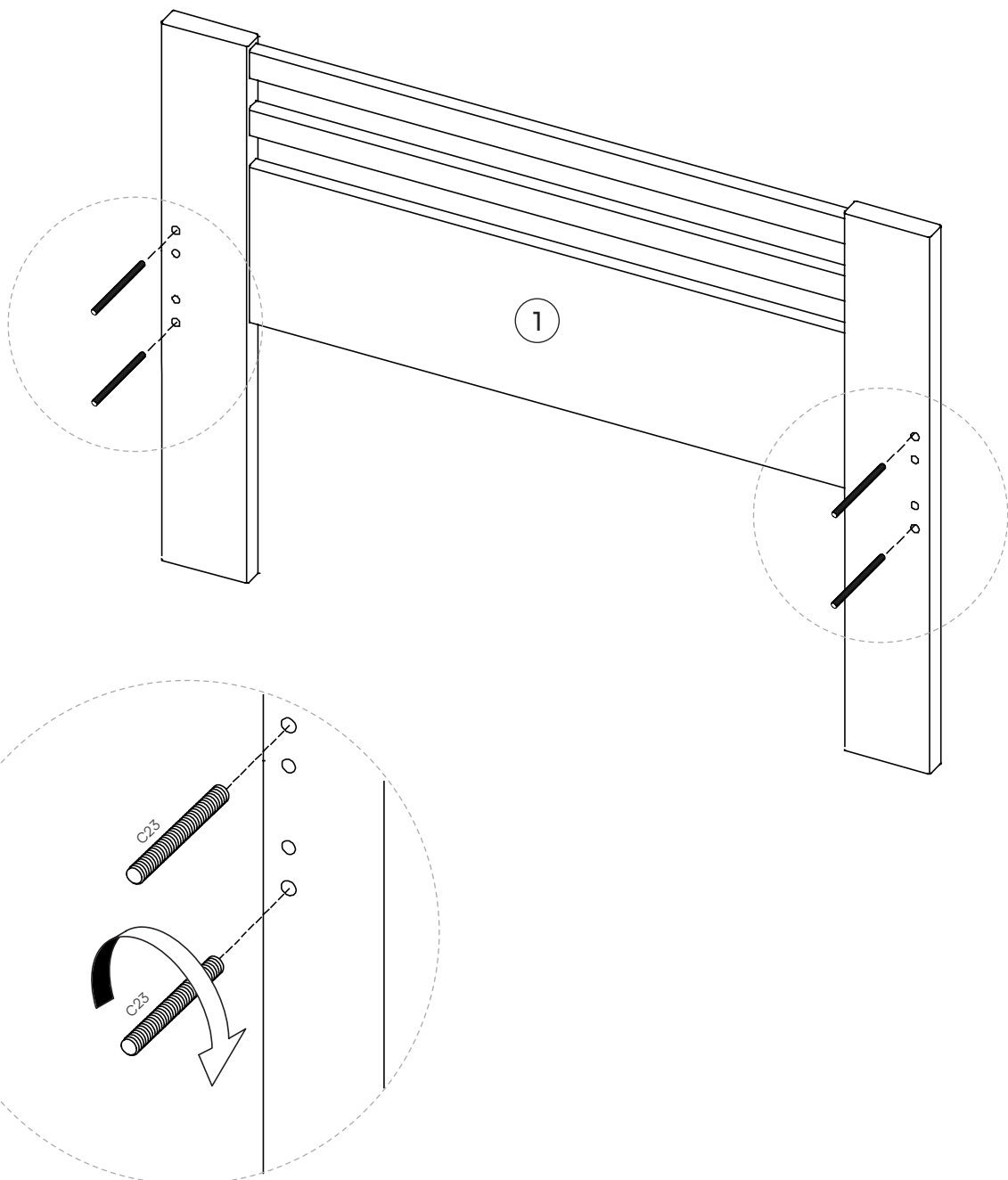

2

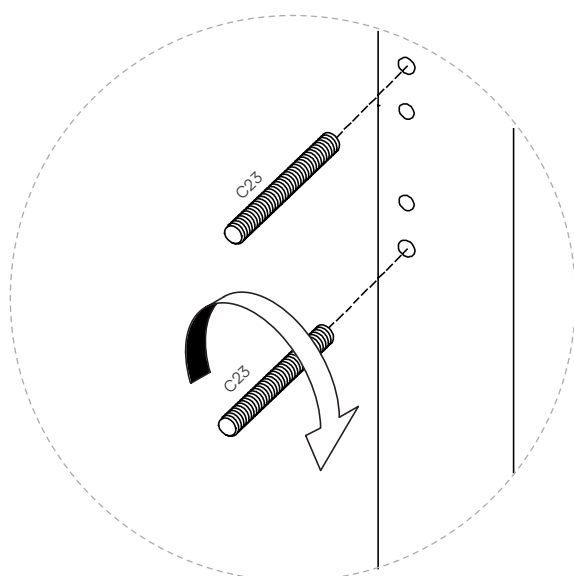
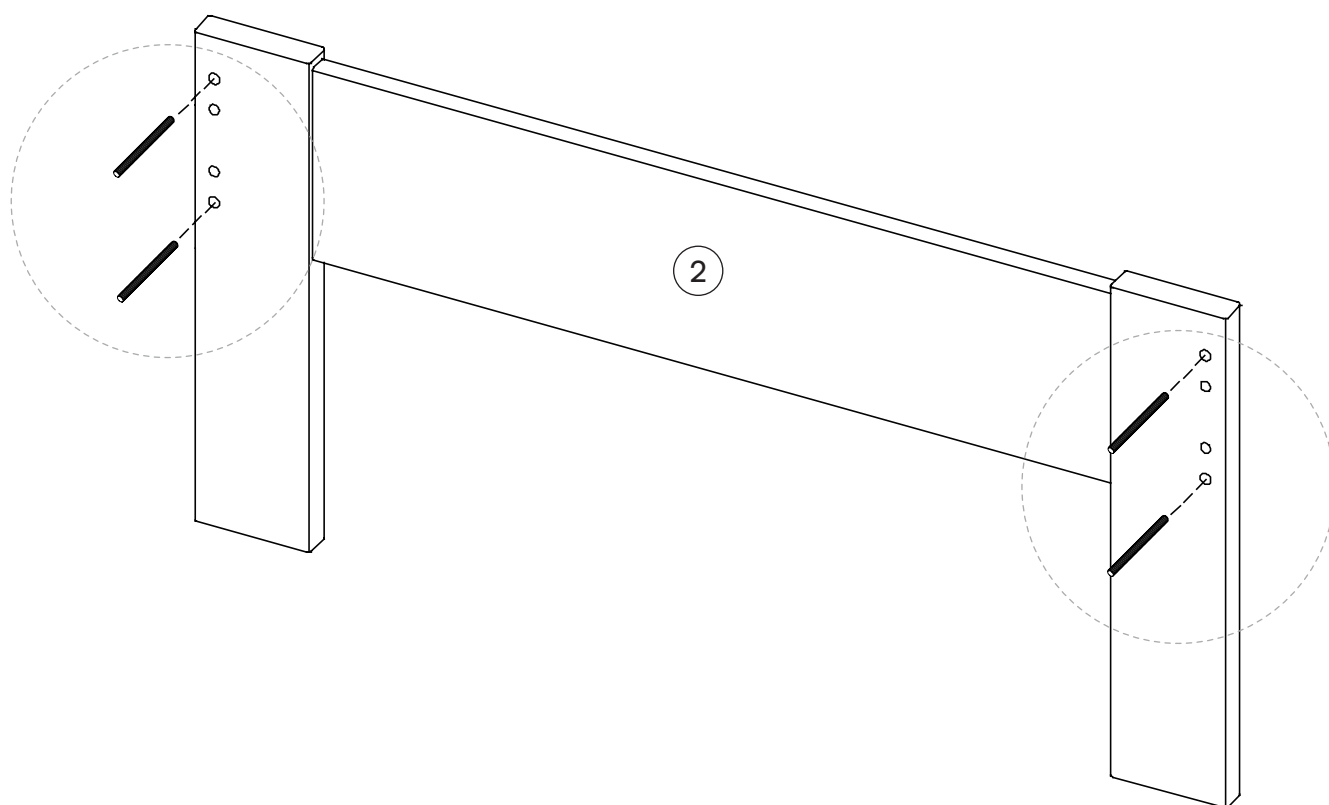
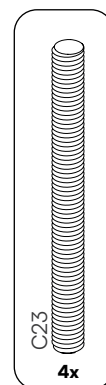

# 3

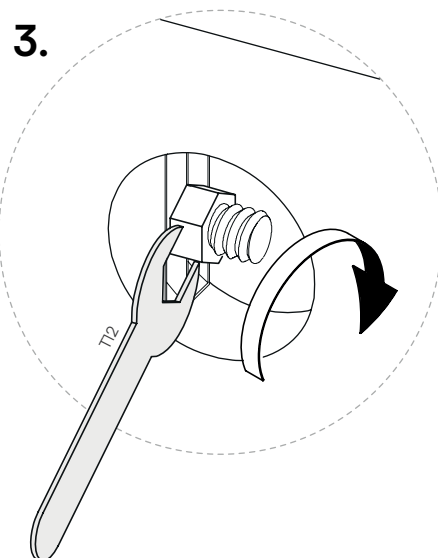
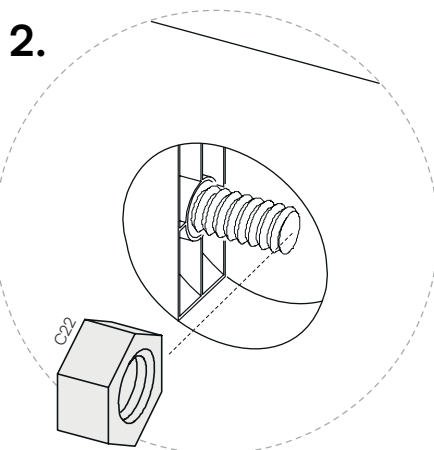
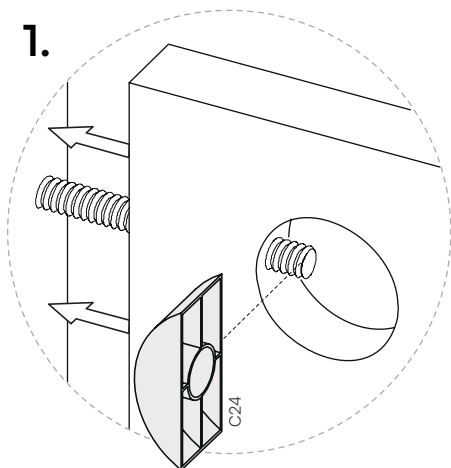
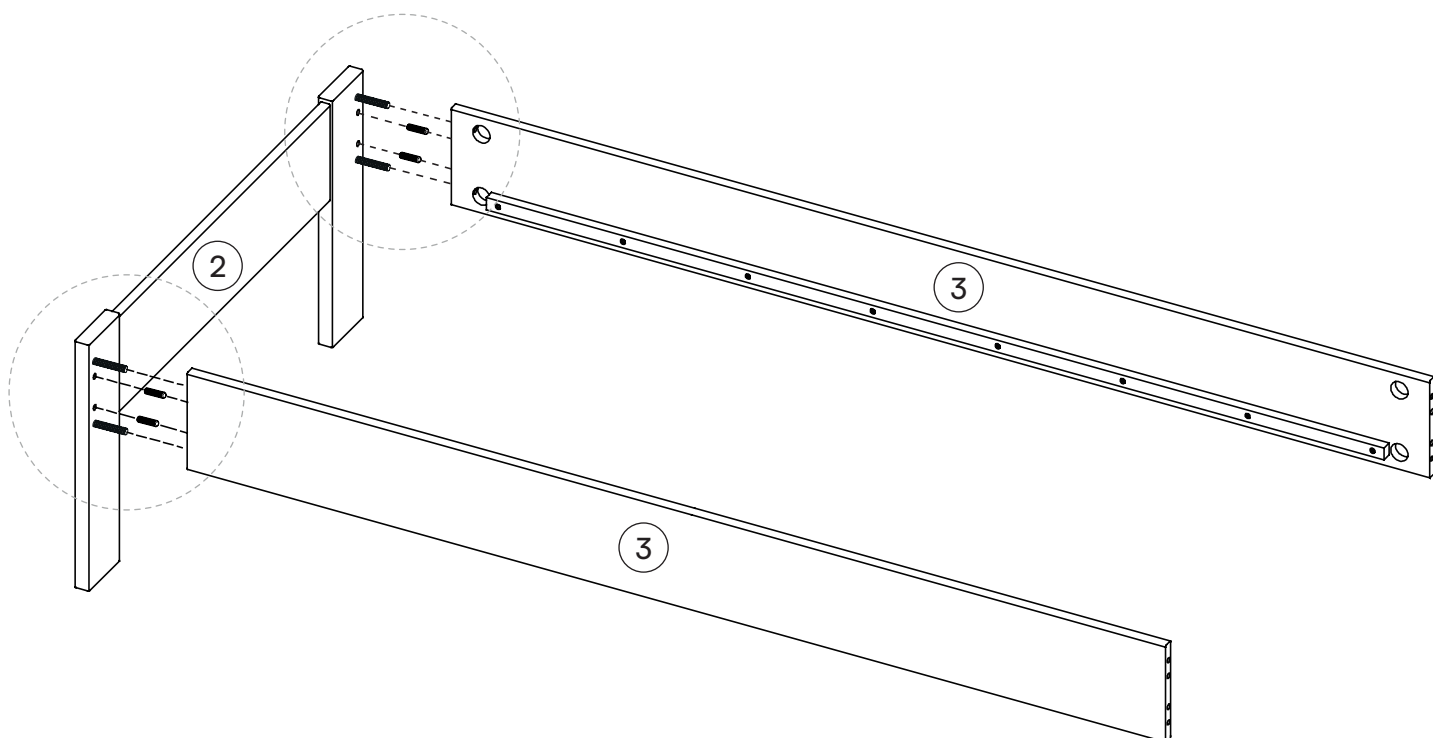
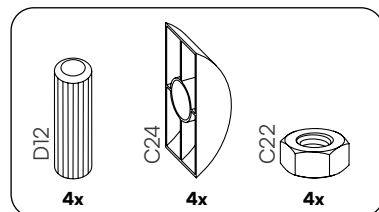
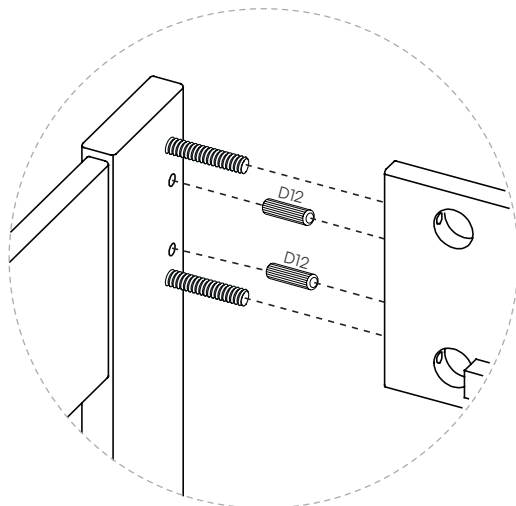



# 4

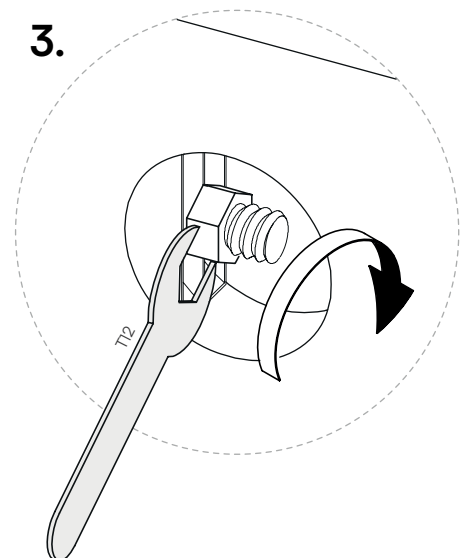
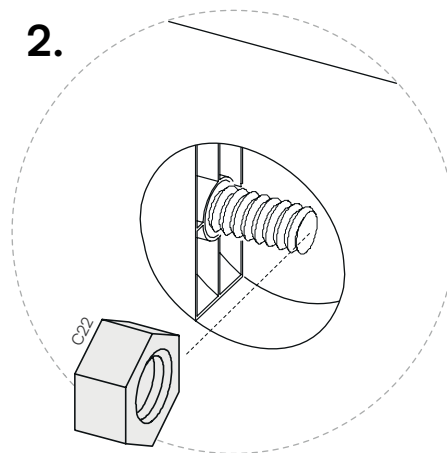
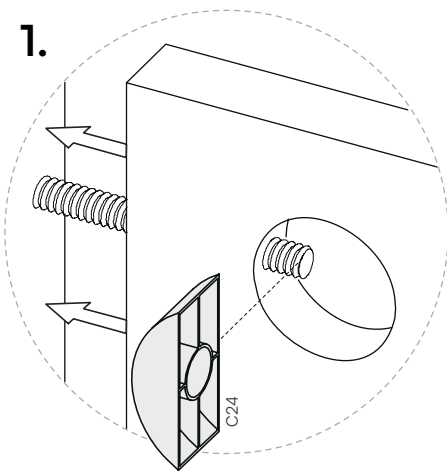
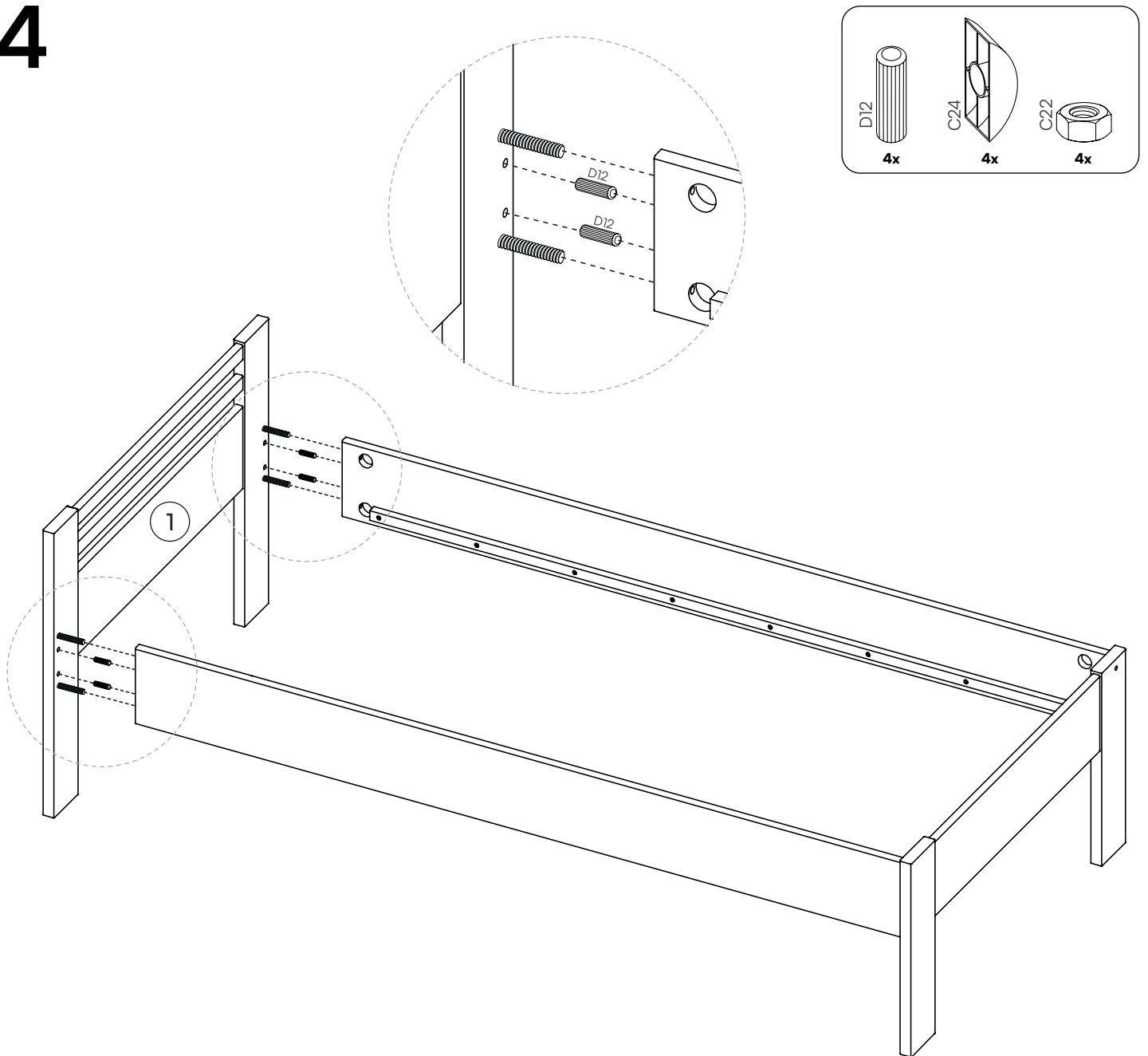

# 5

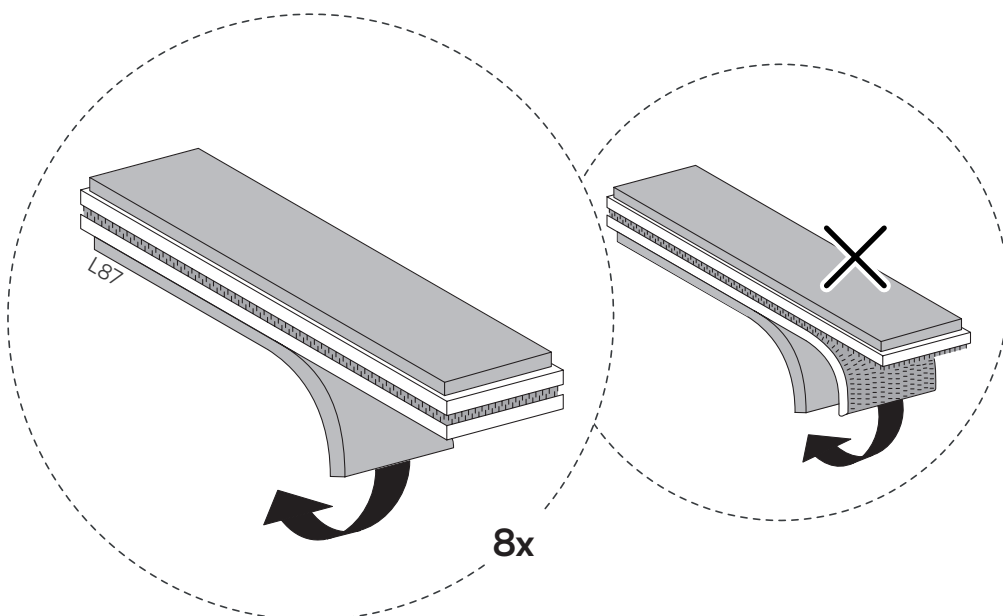
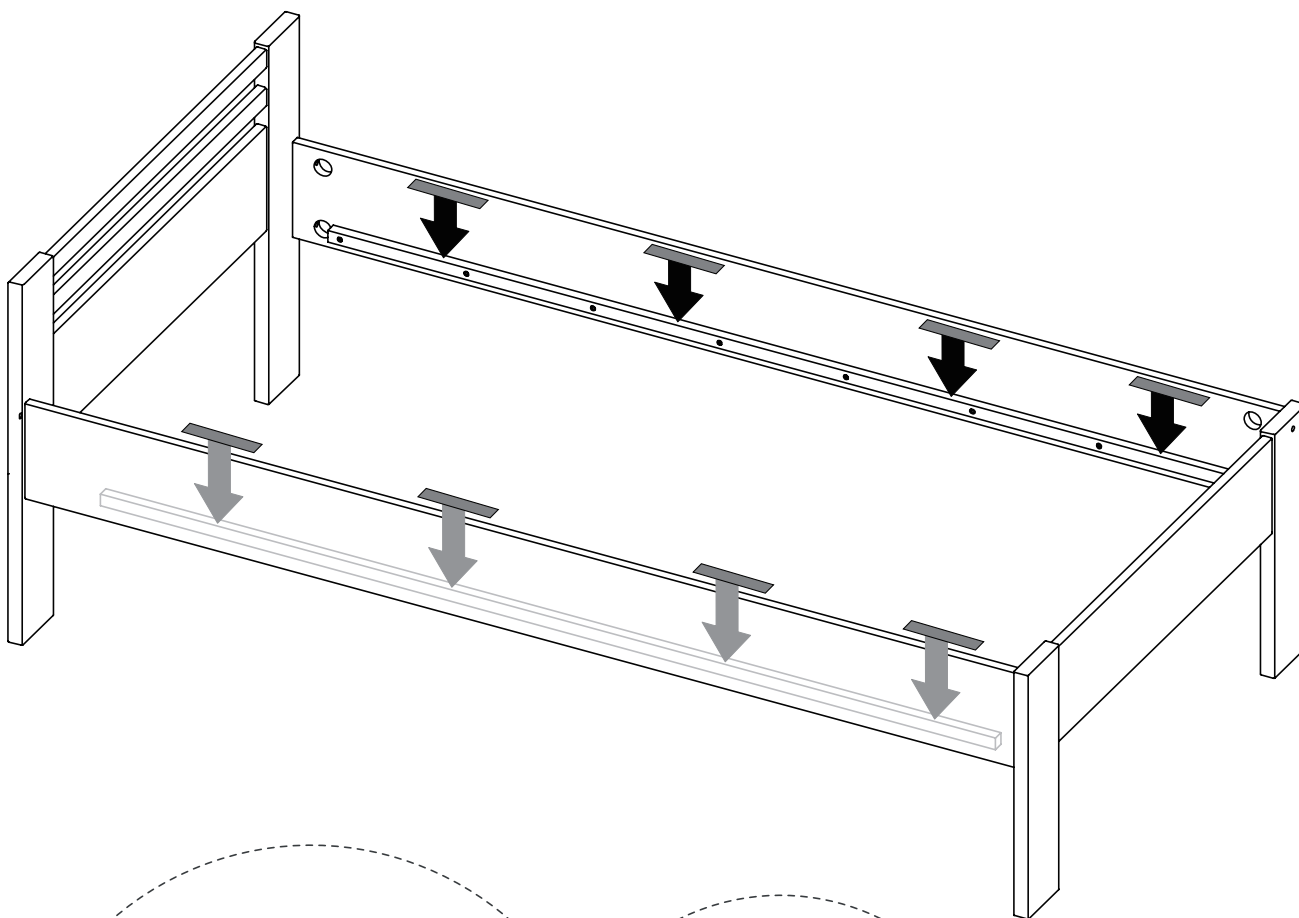
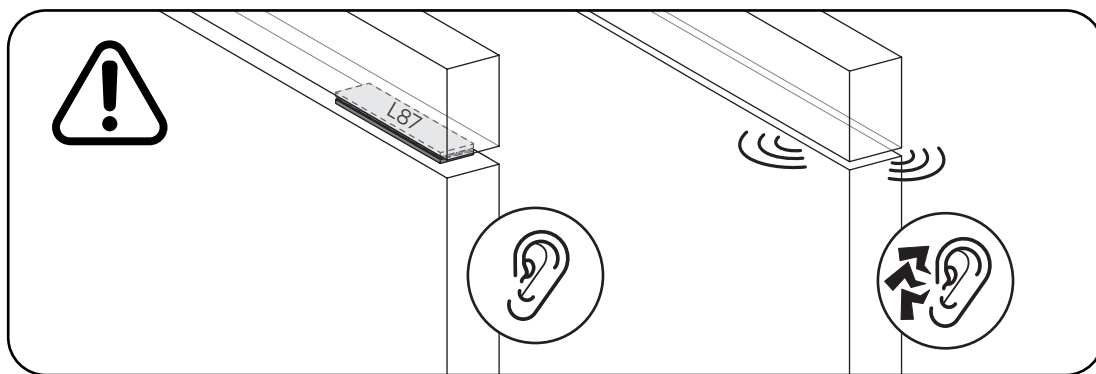

6

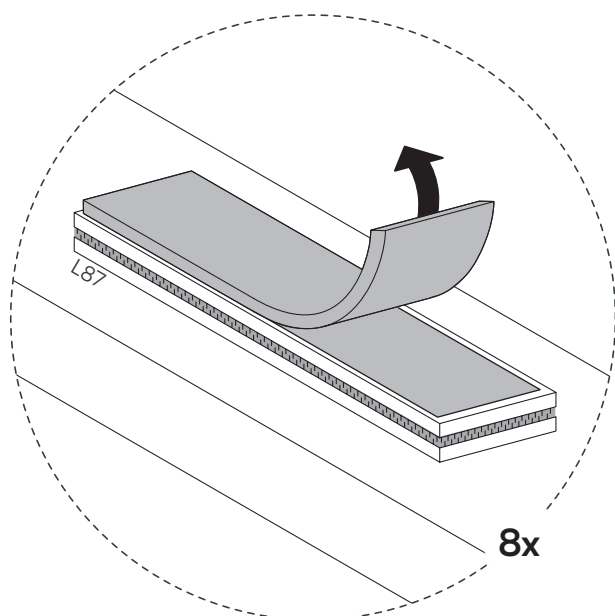
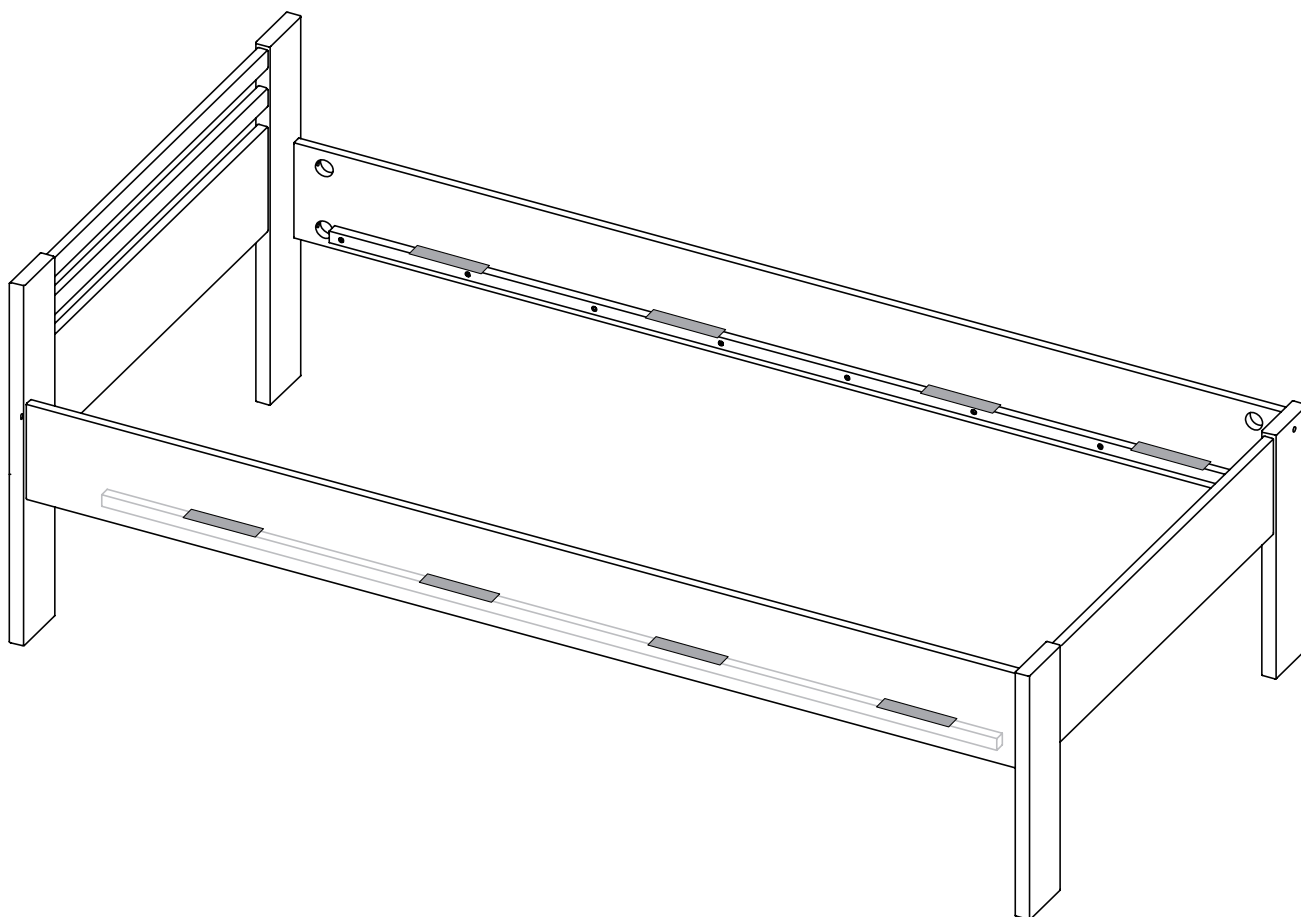

7



Das Lattenrost ist nicht im Lieferumfang enthalten.

