

Wickelaufsatz 'Oti'

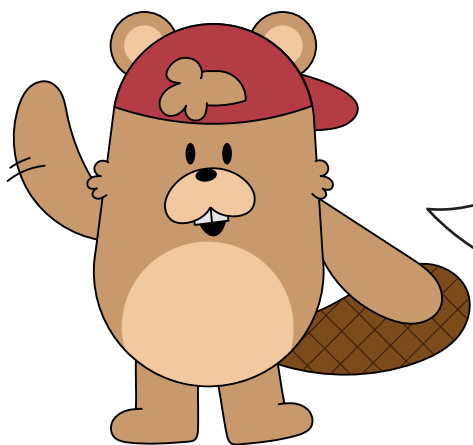

Hey,

ich freue mich, dass Du Dich für mein Produkt entschieden hast. Beachte die kommenden Hinweise, um den Aufbau problemlos zu gestalten.

Viel Spaß mit Deinem Produkt!

50%

weniger Fehler beim Aufbau durch
sorgfältiges Lesen der Anleitung

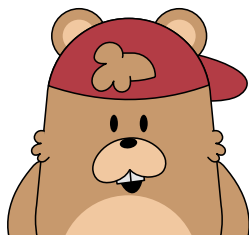
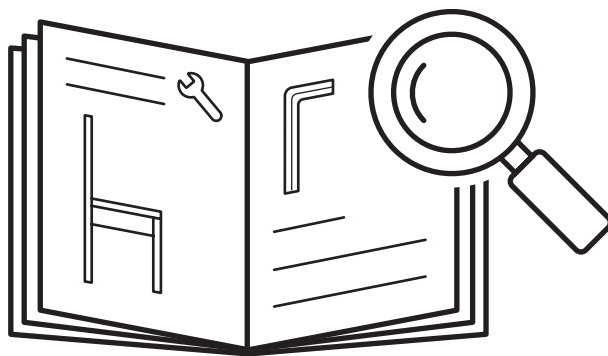

30 - 45

min



optional

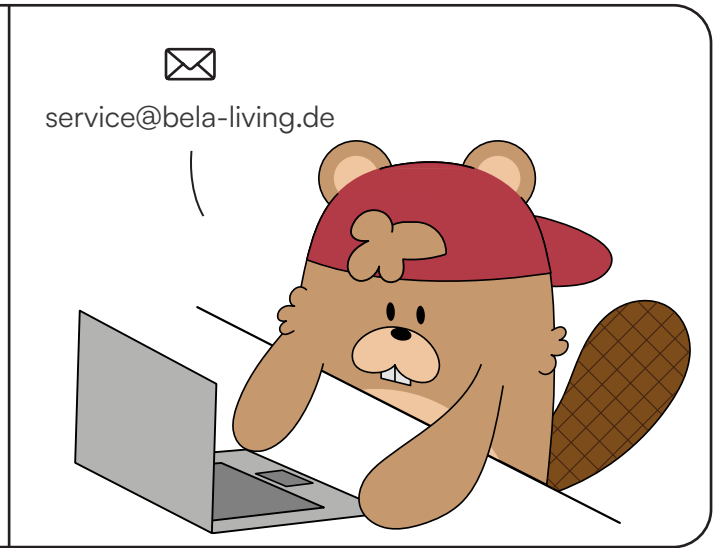
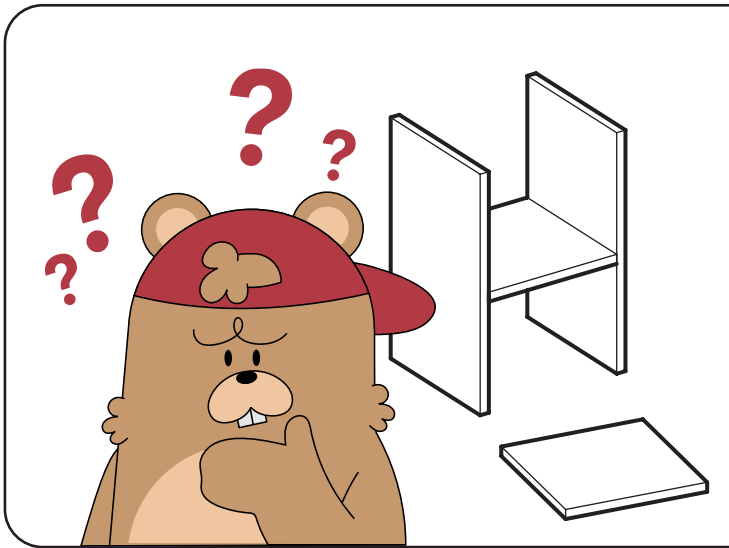
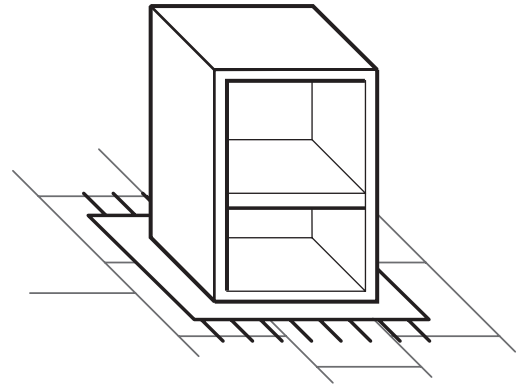
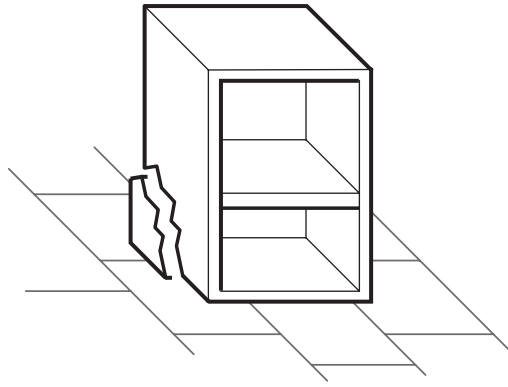

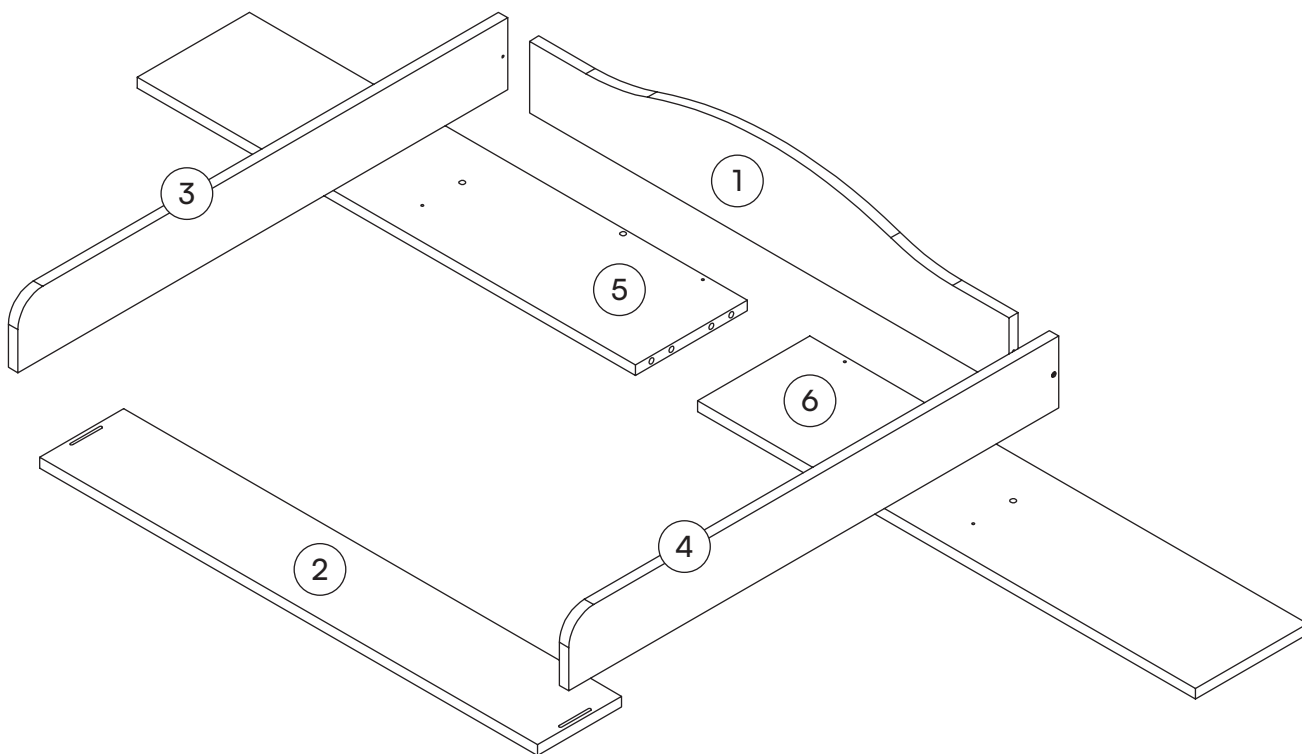

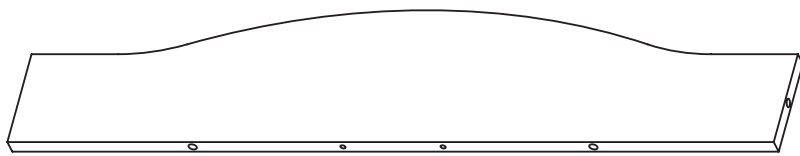

1 Rückwand
1x

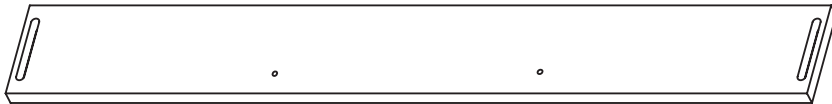

2 Passleiste, vorne
1x

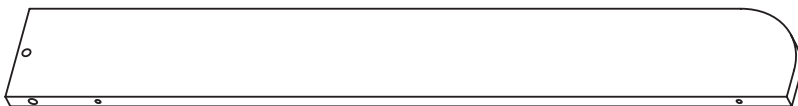

3 Seitenwand, links
1x

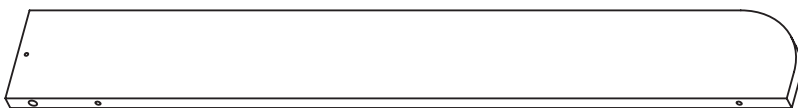

4 Seitenwand, rechts
1x

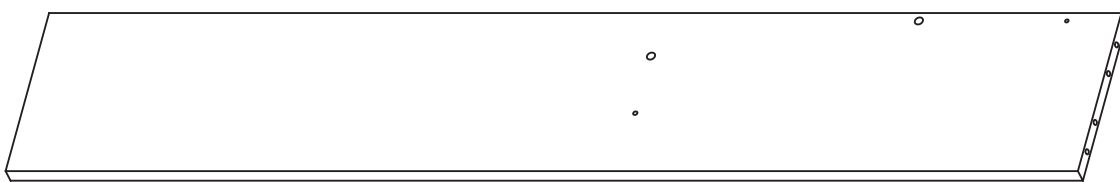

5 Passleiste, hinten, links
1x

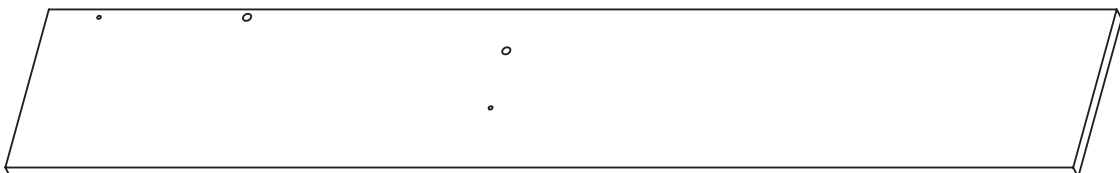

6 Passleiste, hinten, rechts
1x

A - Schraube 3,5 x 14



8x

B - Schraube 3,5 x 35



8x

C - Unterlegscheibe



2x

D - Winkel

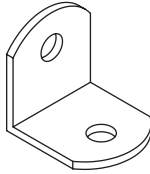

2x

E - Winkel

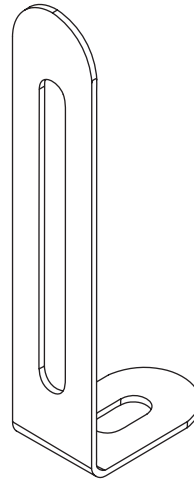

2x

F - Verbindungsplatte

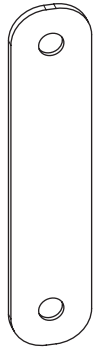

2x

G - Dübel

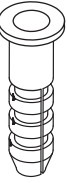

2x

H - Schraube 4 x 50



2x

I - Einschraubdübel



2x

J - Exzenterverschluss



2x

K - Dübel

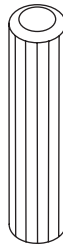

6x

L - Sticker



2x

M - Beilagscheibe Ø6



2x

N - Schraube 3,5 x 20

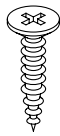

2x

Ein letzter Check:

Bitte überprüfe, ob Du alle Teile hast.

Viel Spaß beim Aufbau!

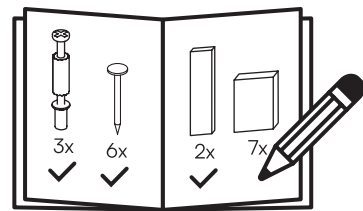

1

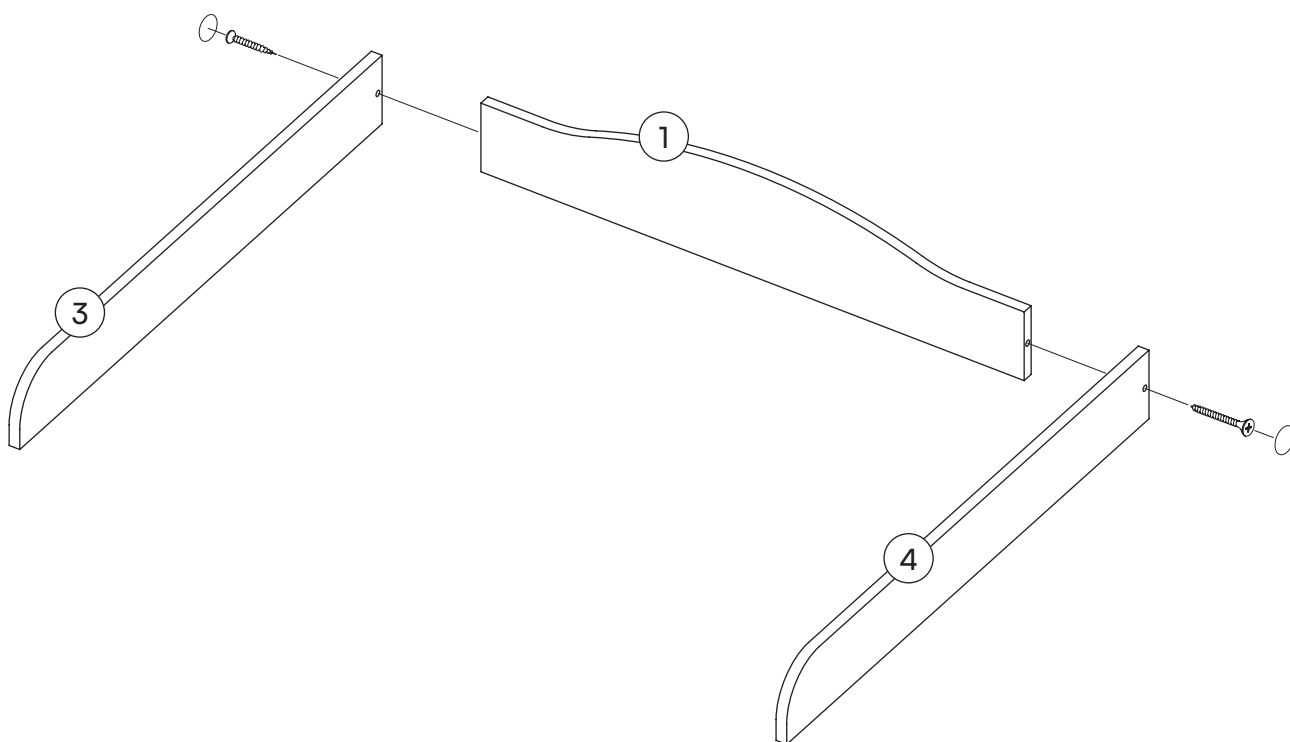
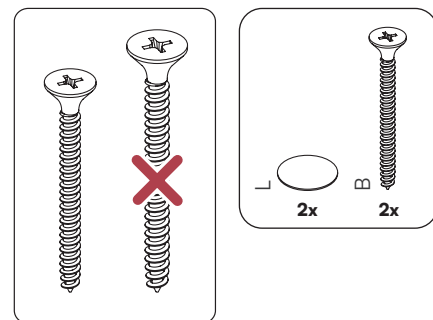

2

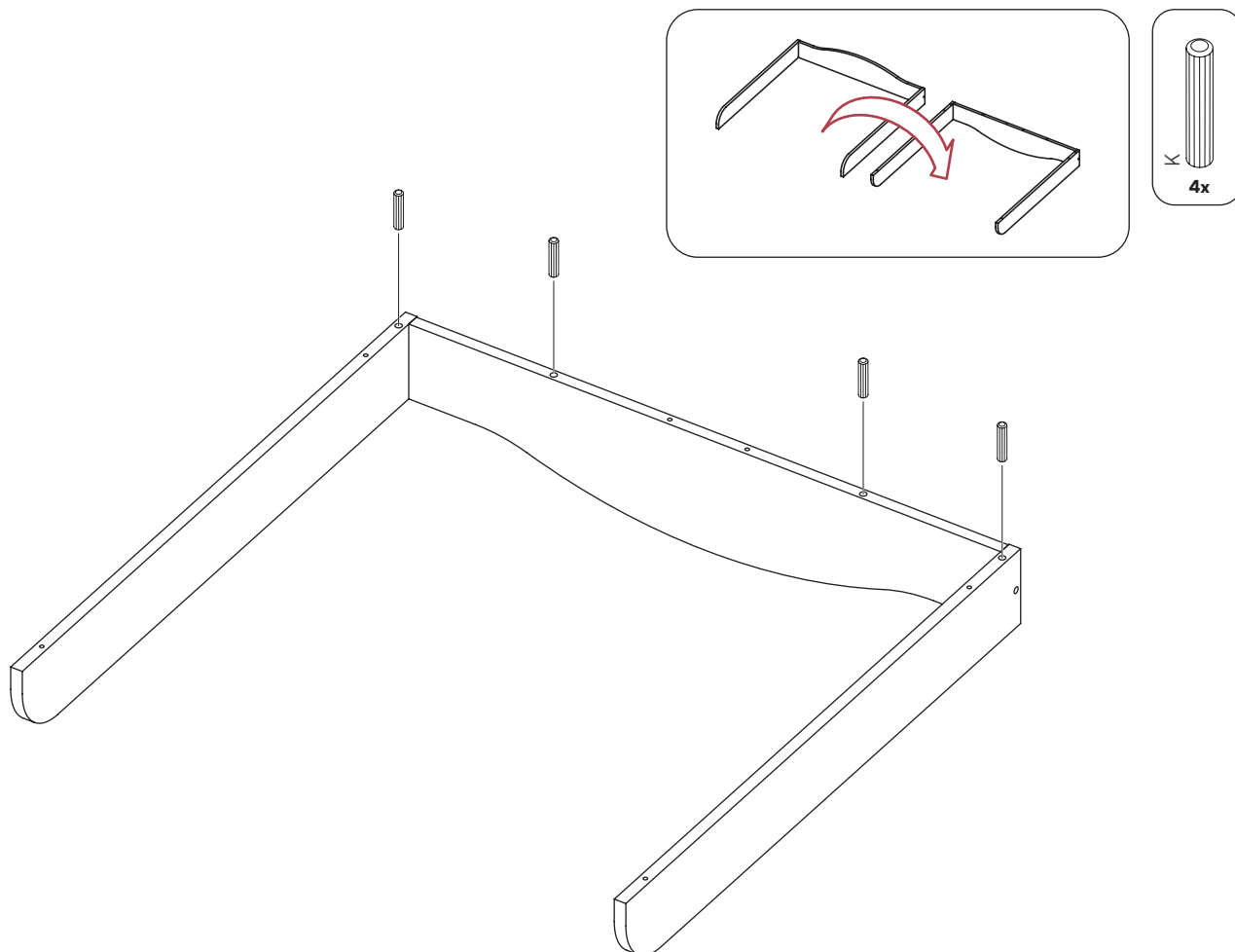

3

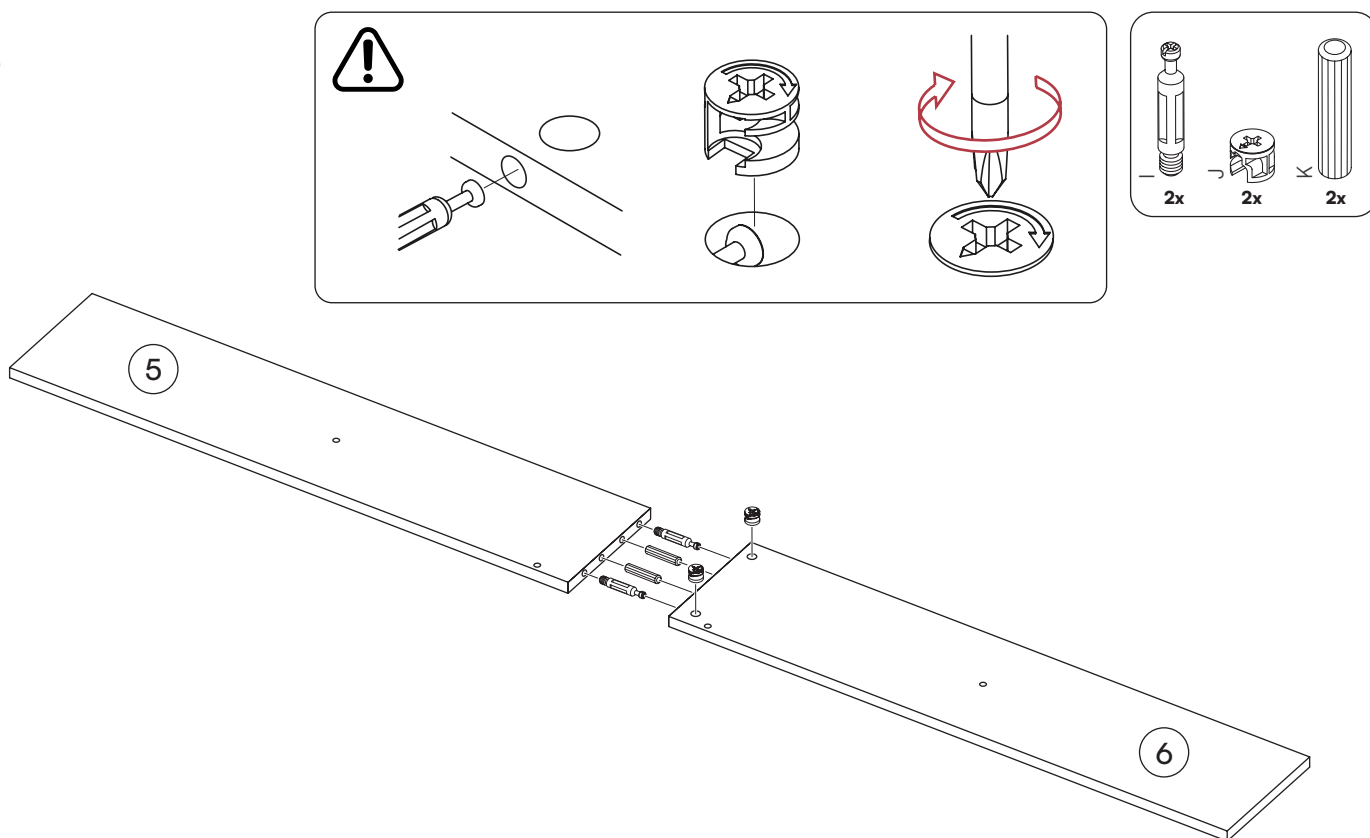

4

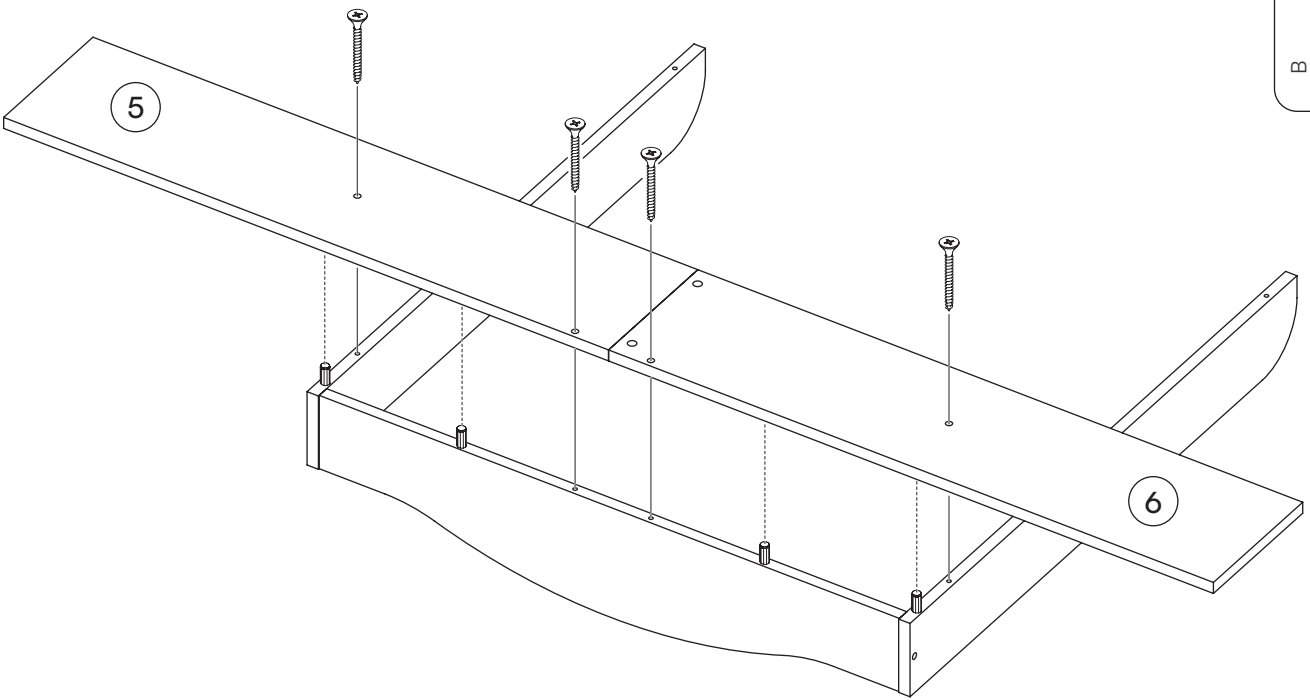

5

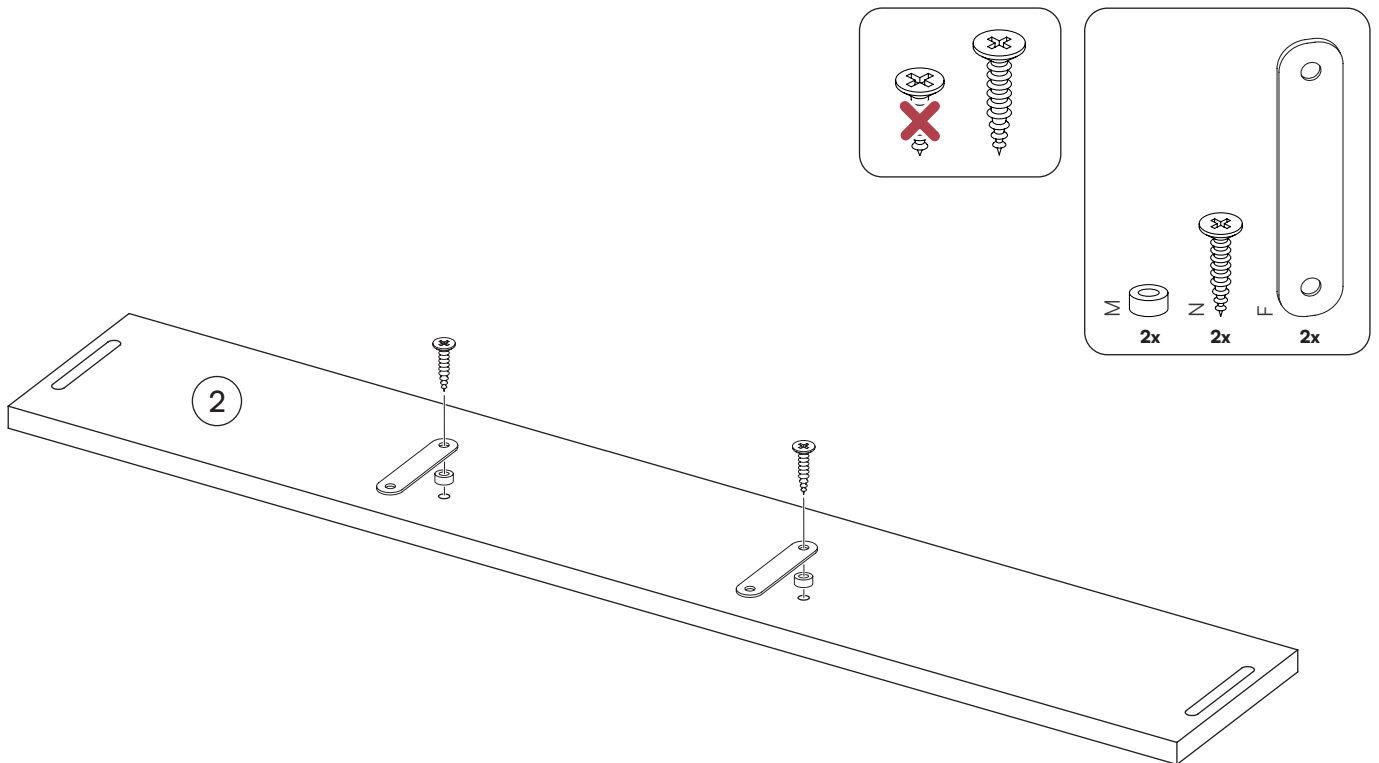

6

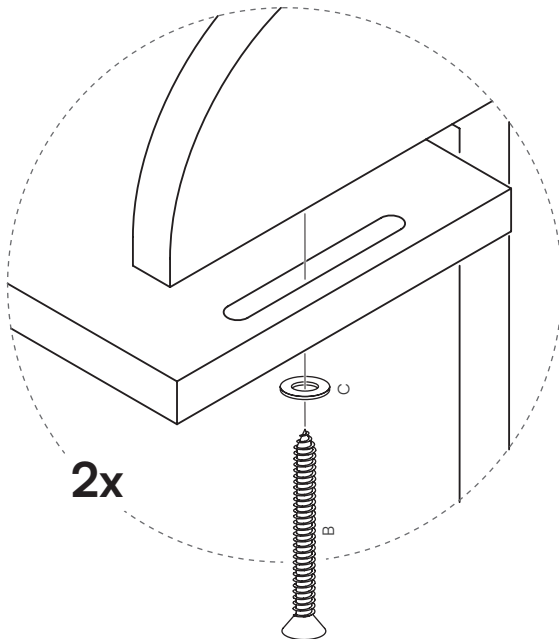
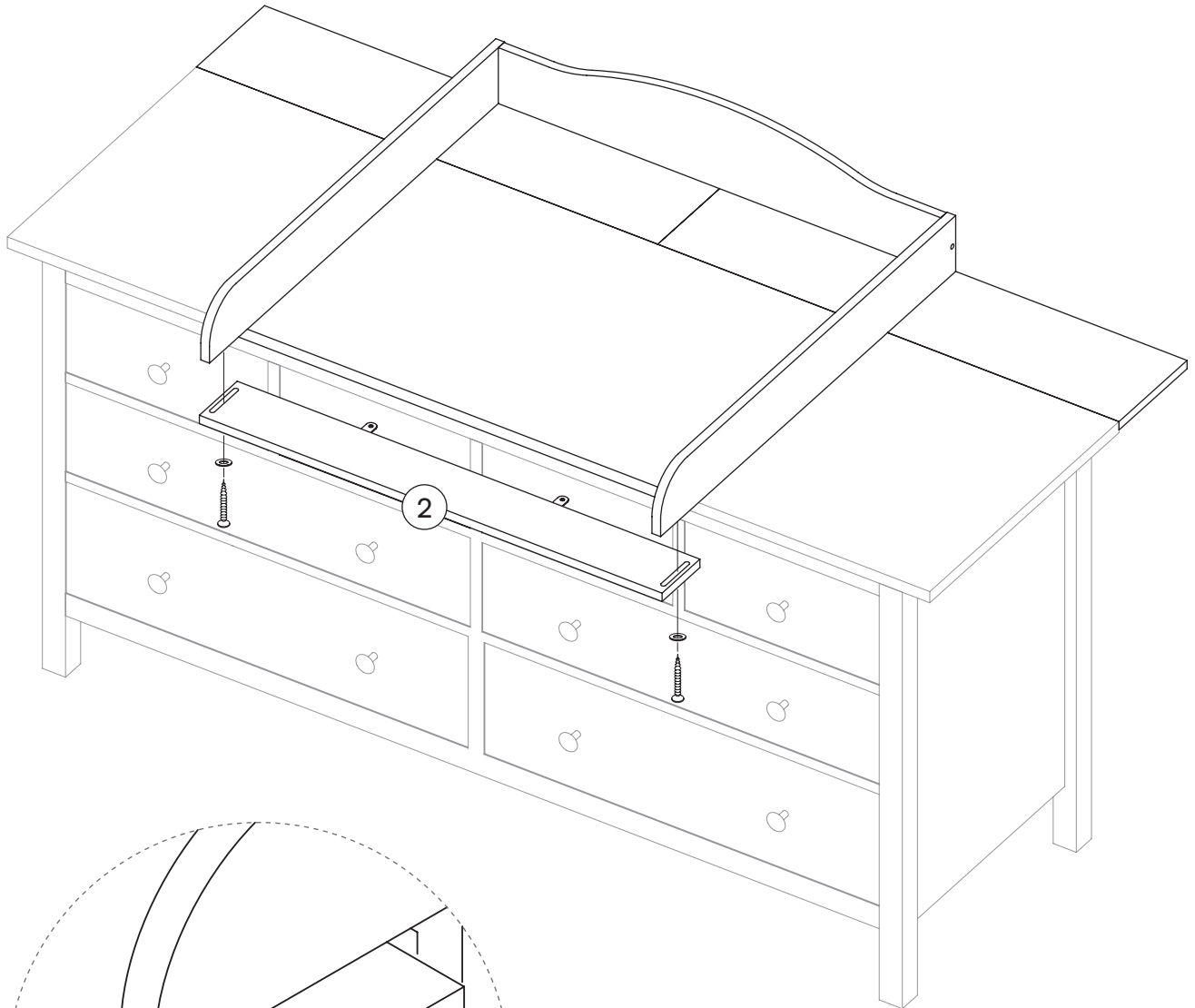
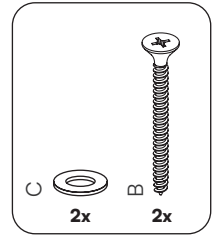

7

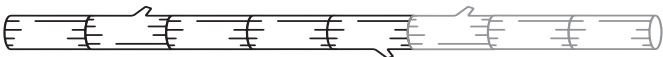
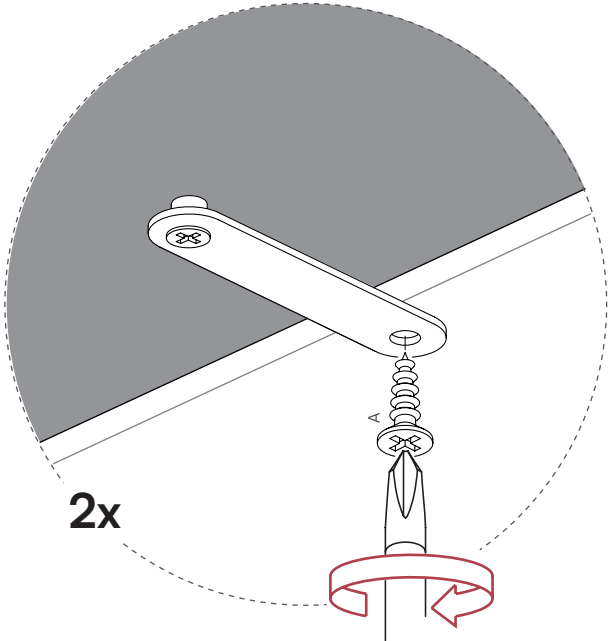
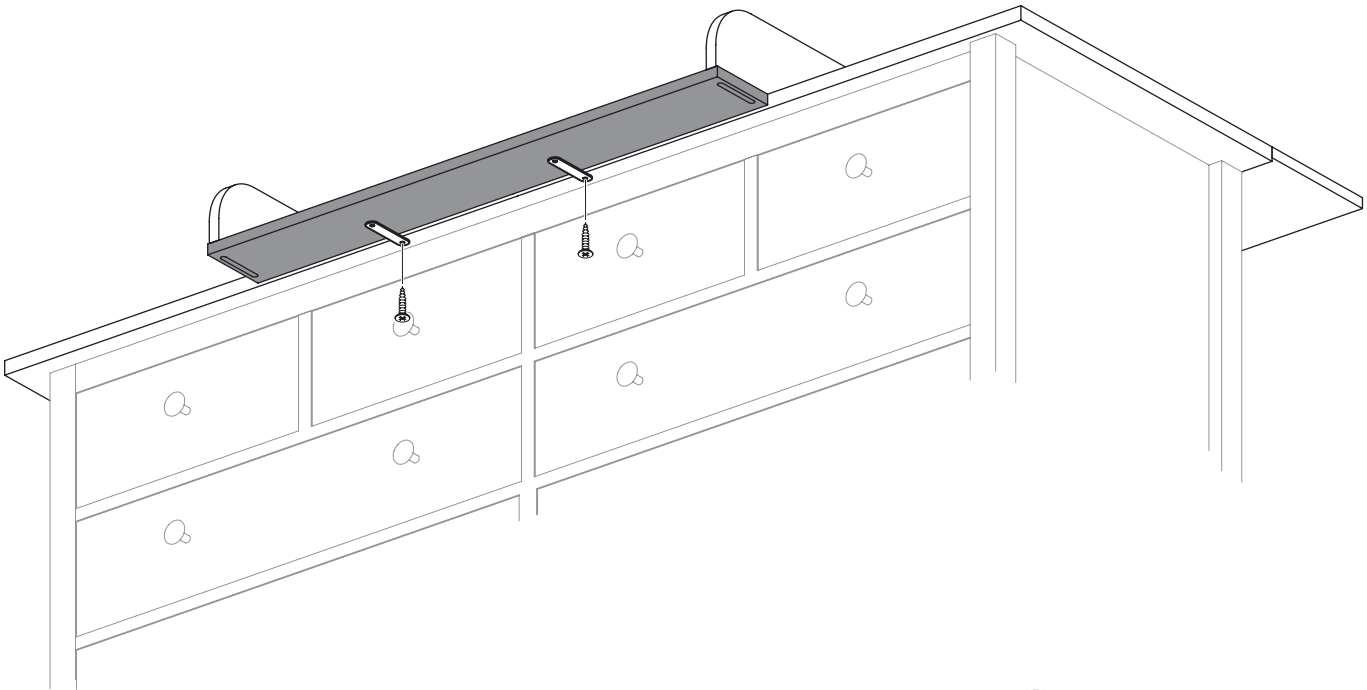
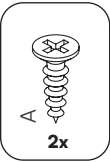

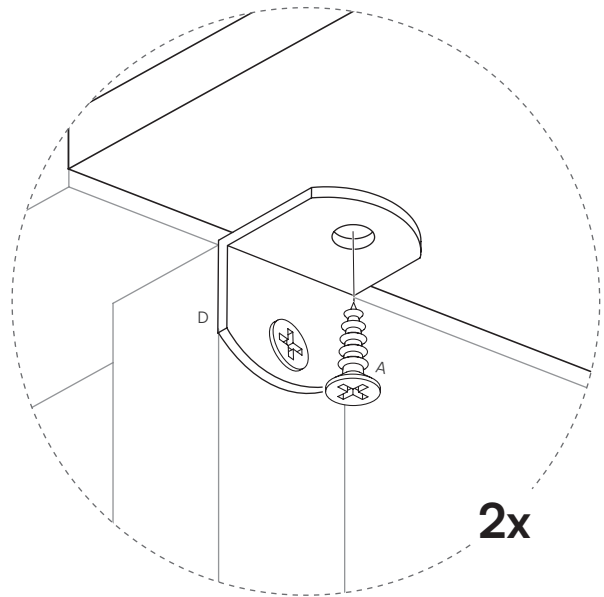
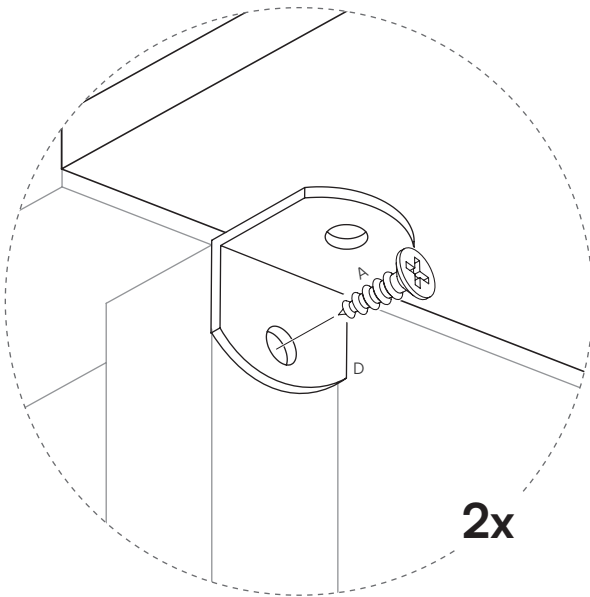
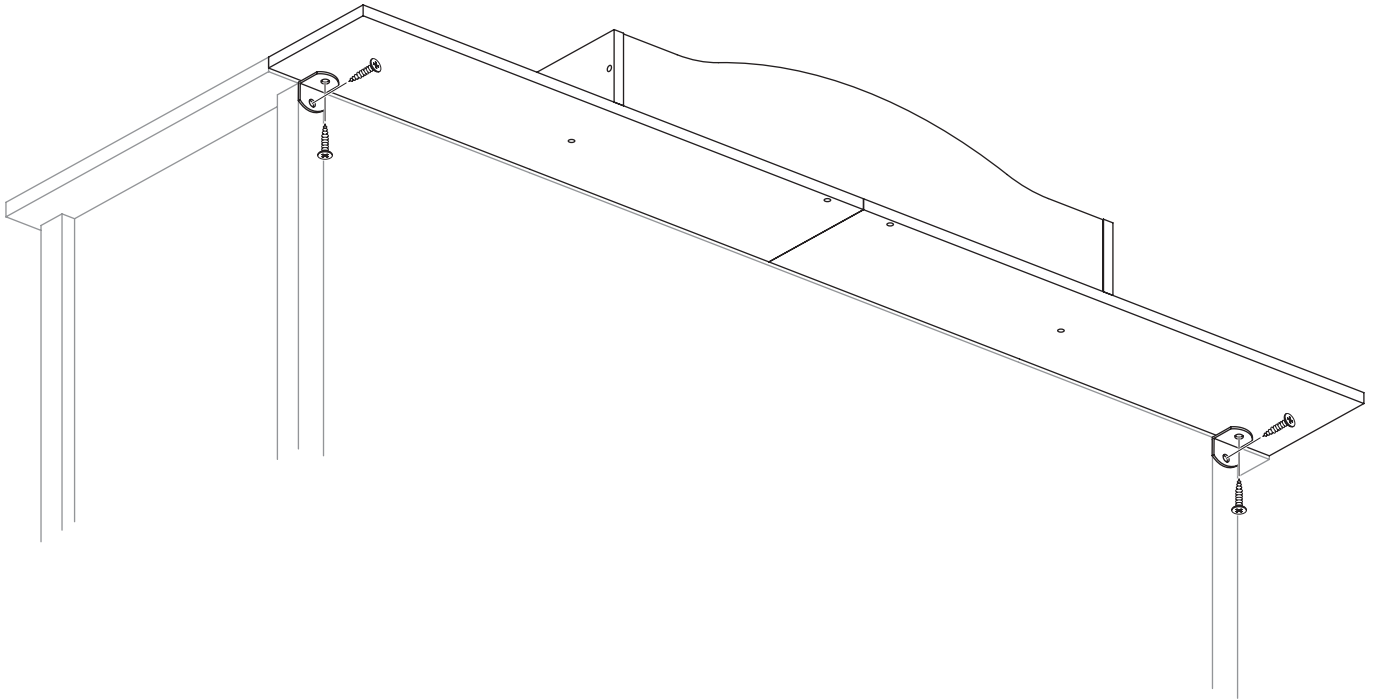
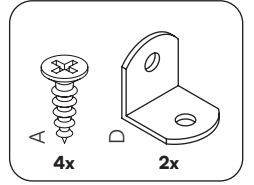

9

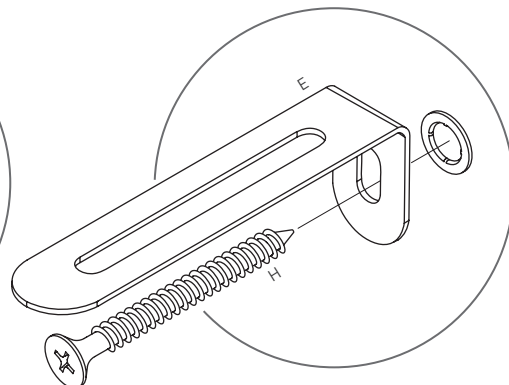
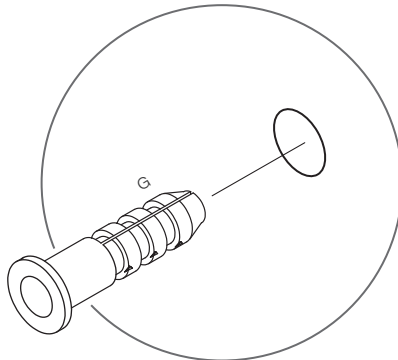
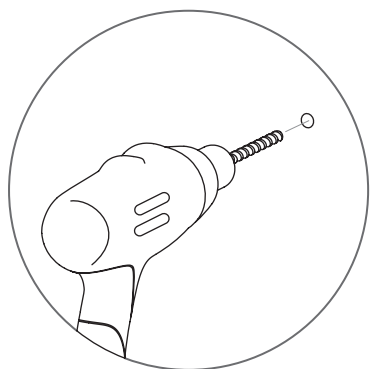
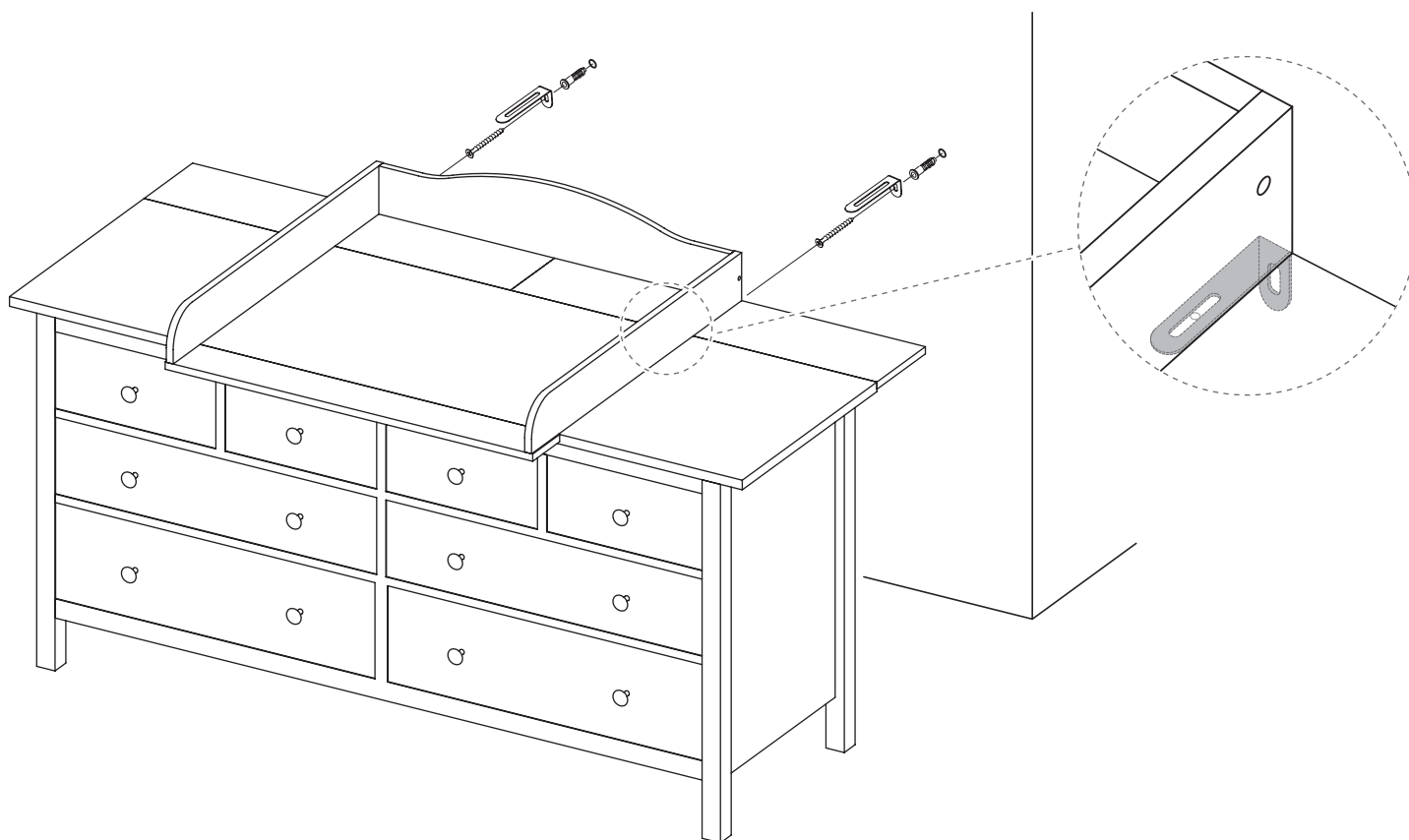
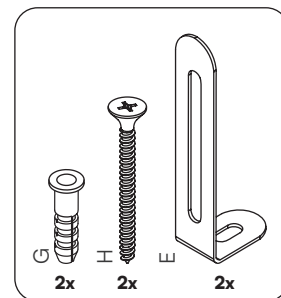
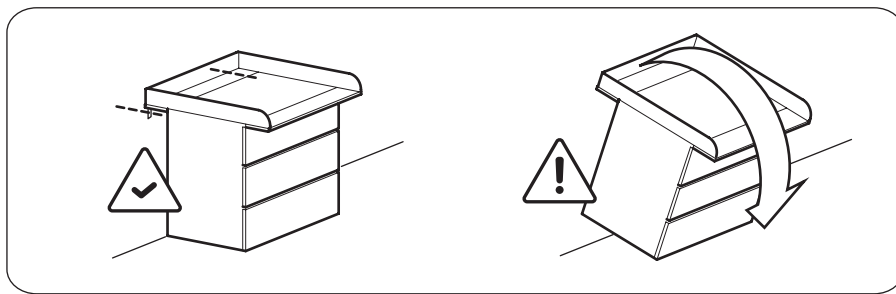

10

