

STEELSON

Mülltonnenbox 'Thoria'

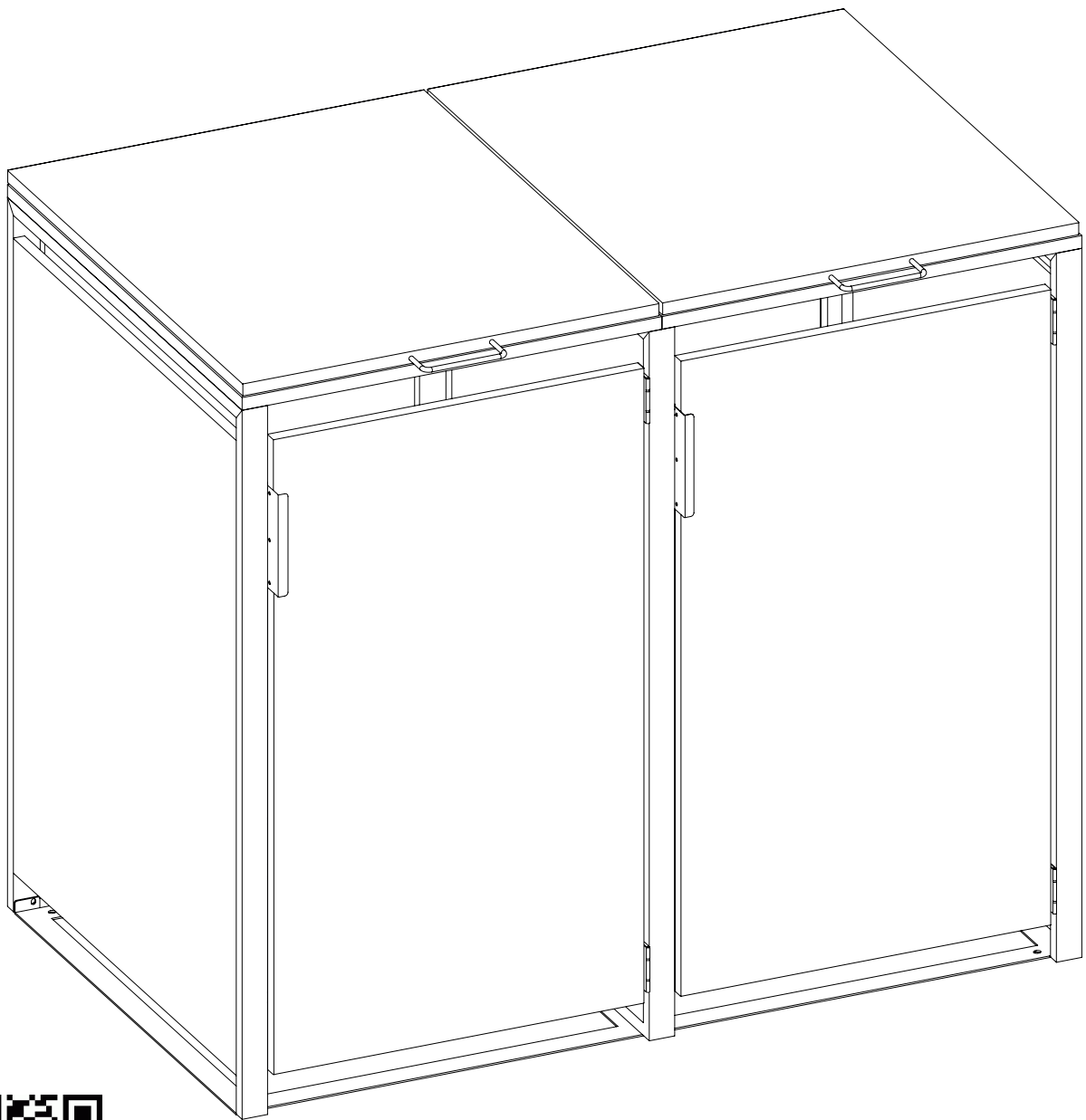

Hier geht's zum
Aufbauvideo



Hey,

wir freuen uns, dass Du Dich für unser Produkt entschieden hast. Beachte die kommenden Hinweise, um den Aufbau problemlos zu gestalten.

Viel Spaß mit Deinem Produkt!

50%

weniger Fehler beim Aufbau durch
sorgfältiges Lesen der Anleitung

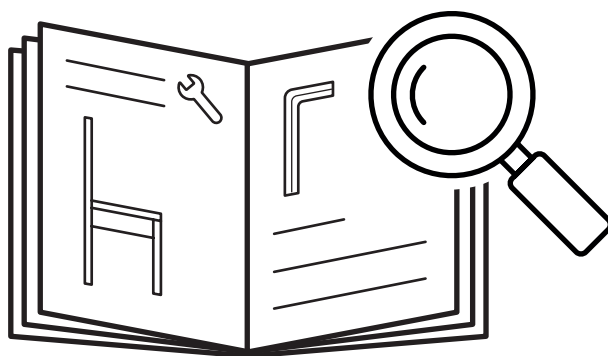

120-180

min

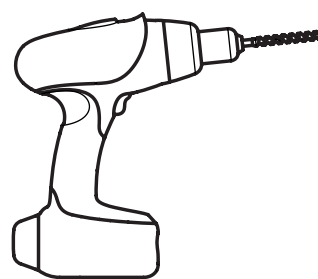

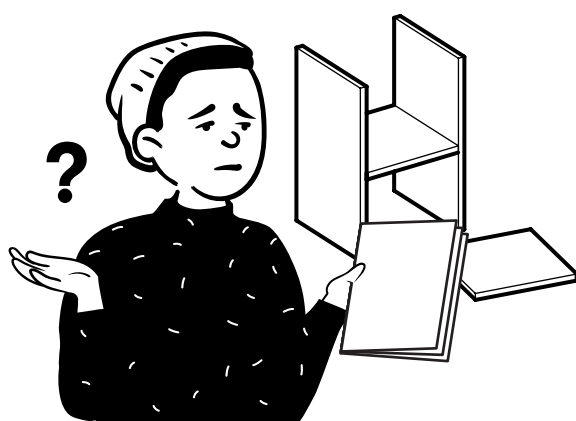
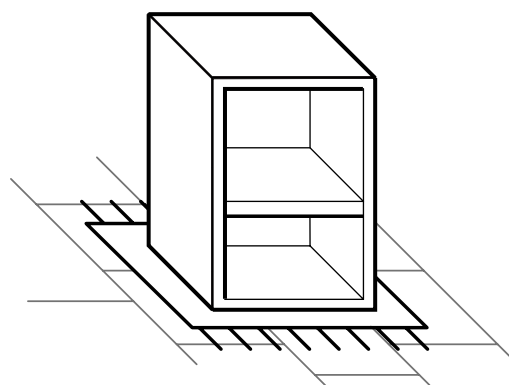
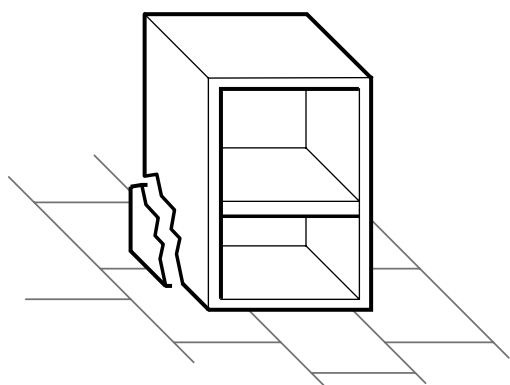

Fragen?

Wir sind für Dich da!



✉ service@bela-living.de

1.

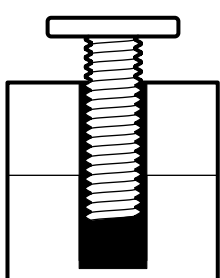

Ziehe die Schrauben während
des gesamten Aufbaus
zunächst per Hand an.

2.

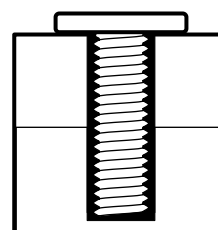

Justiere das Produkt final
und ziehe die Schrauben
vollständig an.

G24 - Kreuzschraube

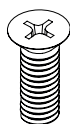

48x

G25 - Kreuzschraube

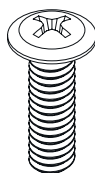

10x

G26 - Inbusschraube

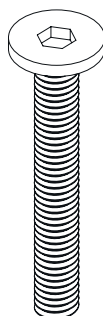

12x

G27 - Kreuzschraube

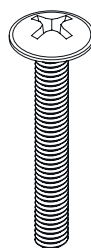

4x

A13 - Dübel und Schraube



8x

G28 - Kreuzschraube

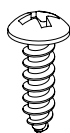

6x

A14 - Scharnier

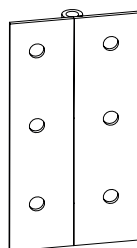

4x

A15 - Dämpfer



4x

A16 - Abdeckkappe

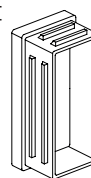

4x

A17 - Magnet

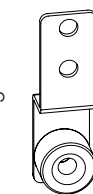

4x

A18 - Karabiner

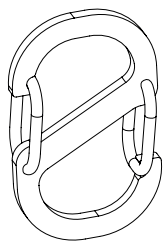

2x

A19 - Türgriff

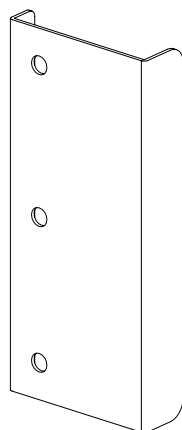

2x

A20 - Metallkette



2x

T10 - Inbusschlüssel

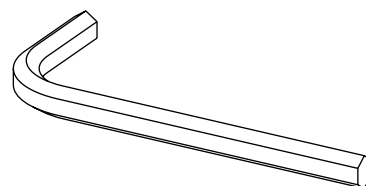

1x

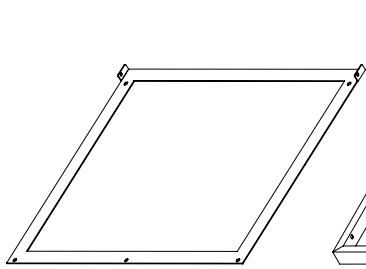

1 Unterer Rahmen
2x

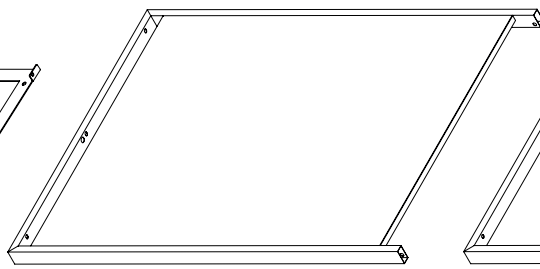

2 Linke Seitenwand
1x

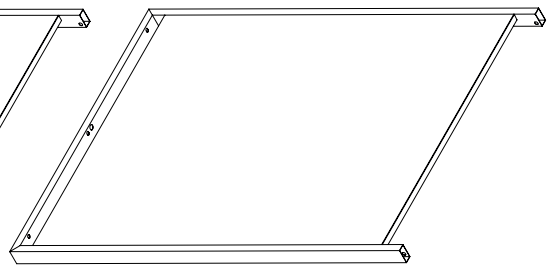

3 Rechte Seitenwand
1x

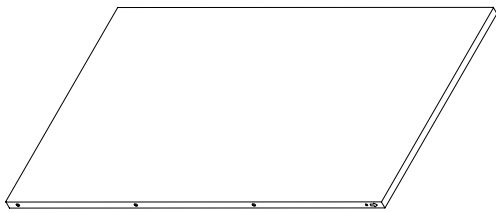

4 Rückwand
2x

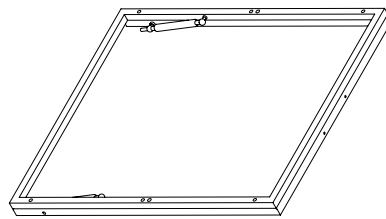

5a Linker Deckel
1x

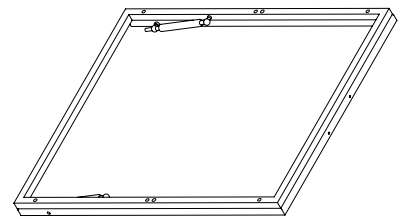

5b Rechter Deckel
1x

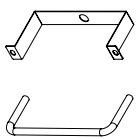

6 Griff
2x

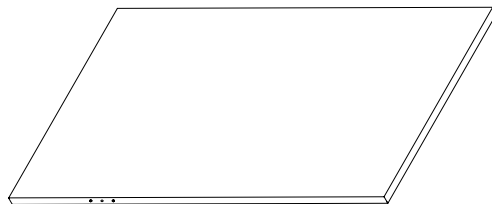

7 Tür
2x

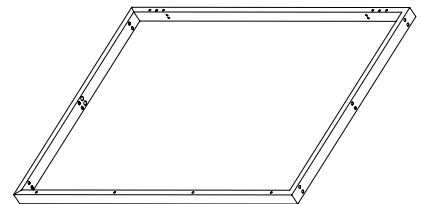

8 Mittelrahmen
1x

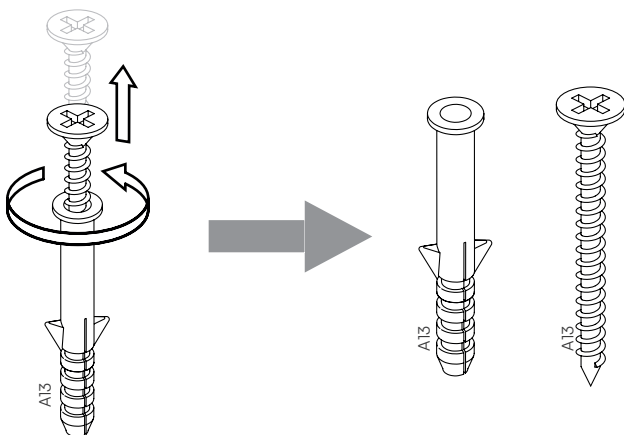

Ein letzter Check:

Bitte überprüfe, ob Du alle Teile hast.

Viel Spaß beim Aufbau!

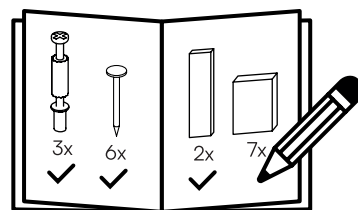

7



Hier geht's zum
Aufbauvideo

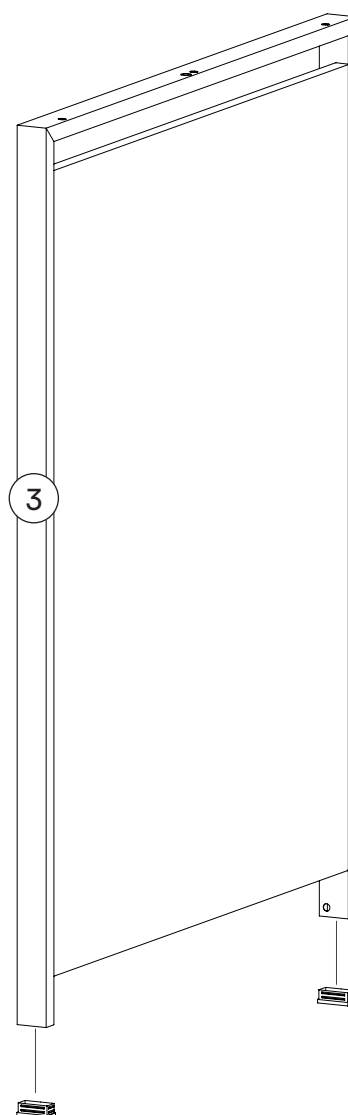
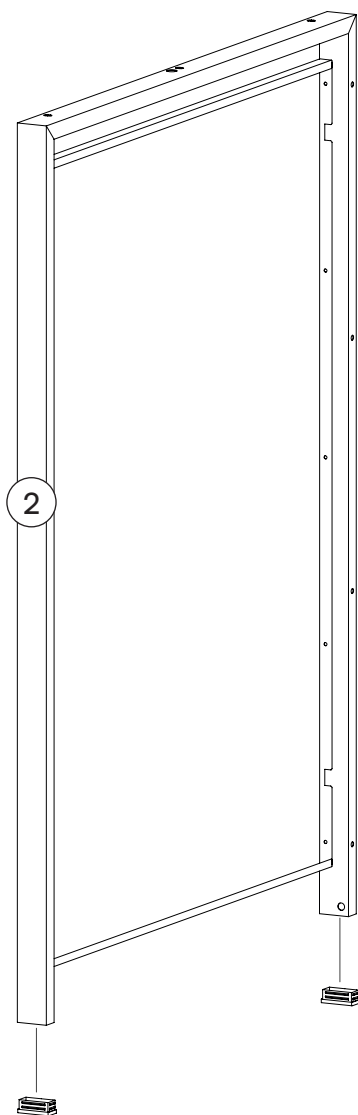
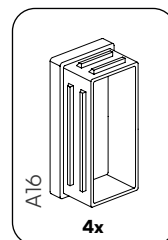

2

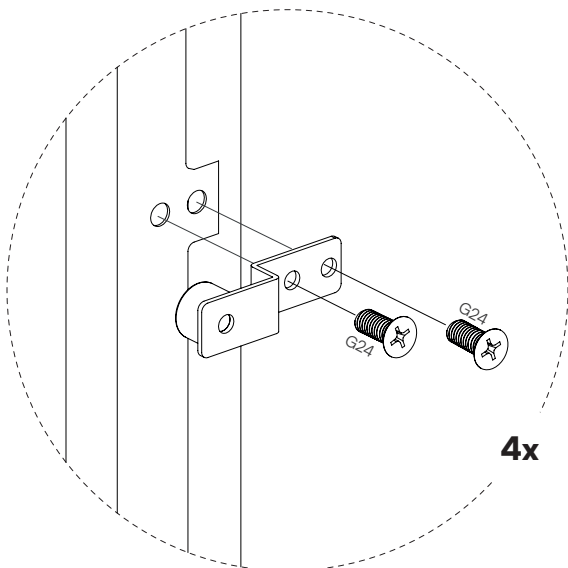
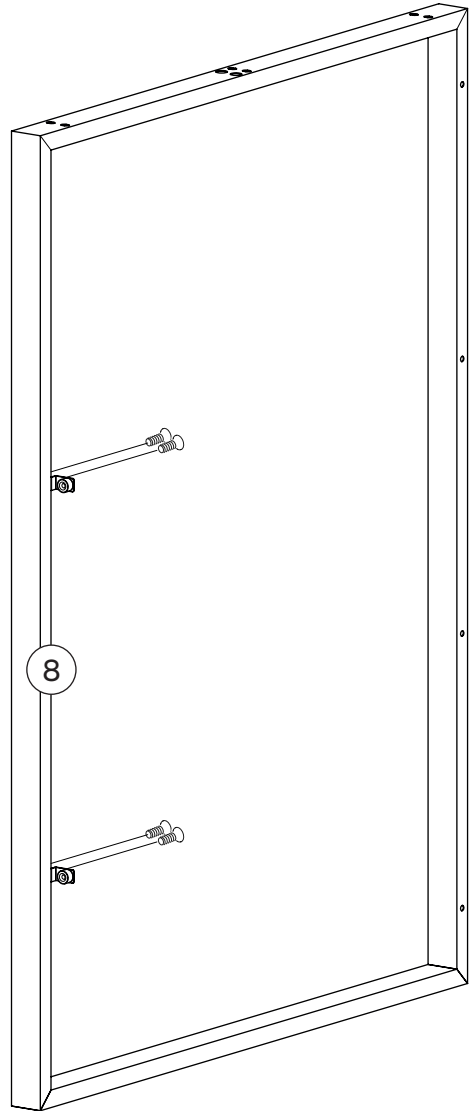
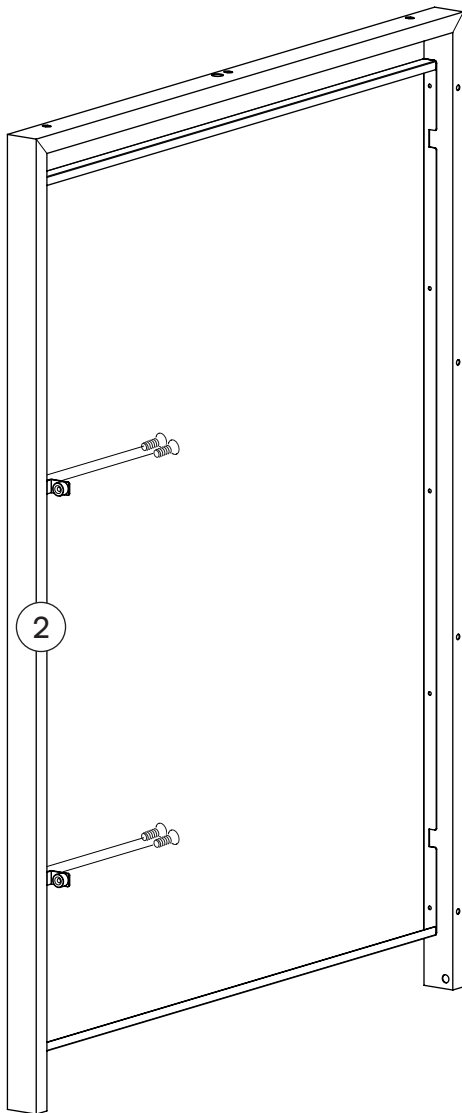
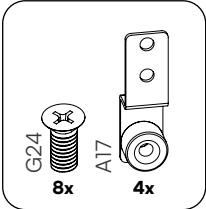

3

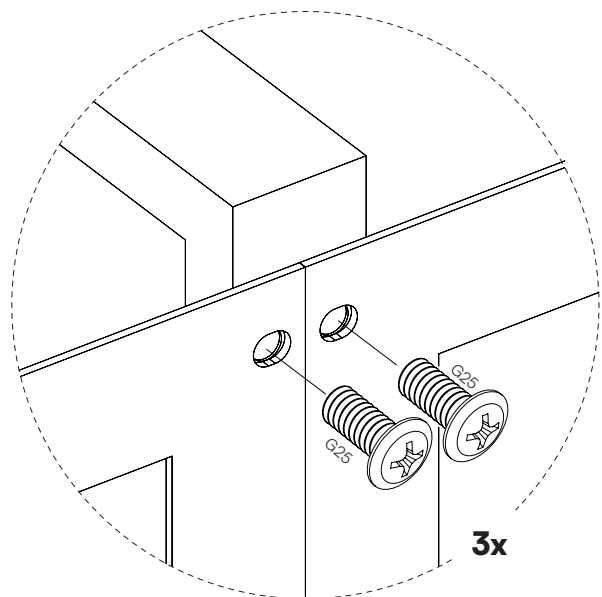
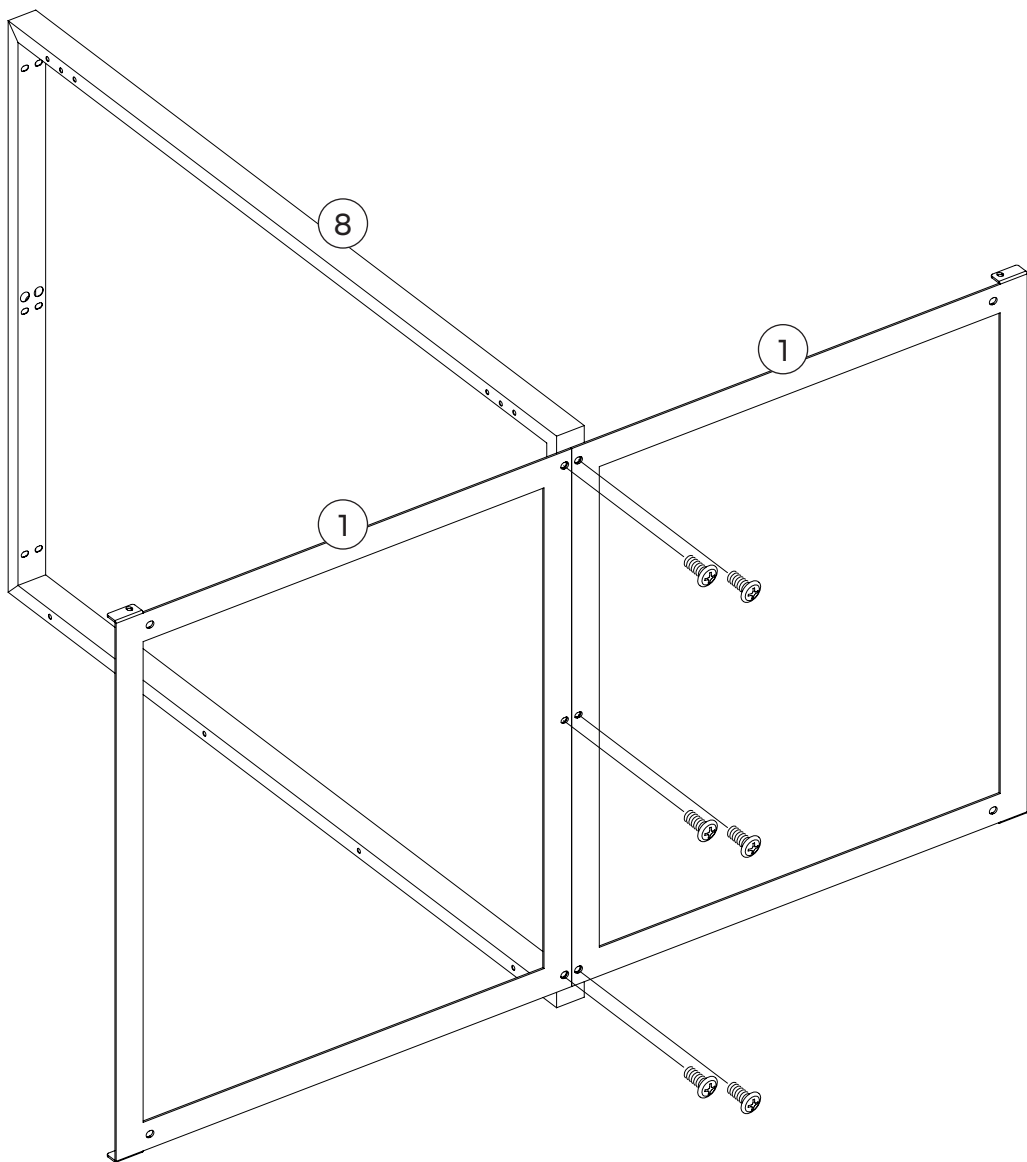

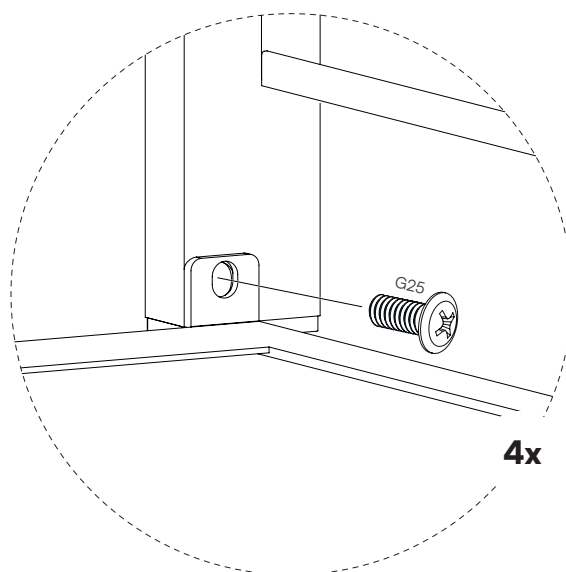
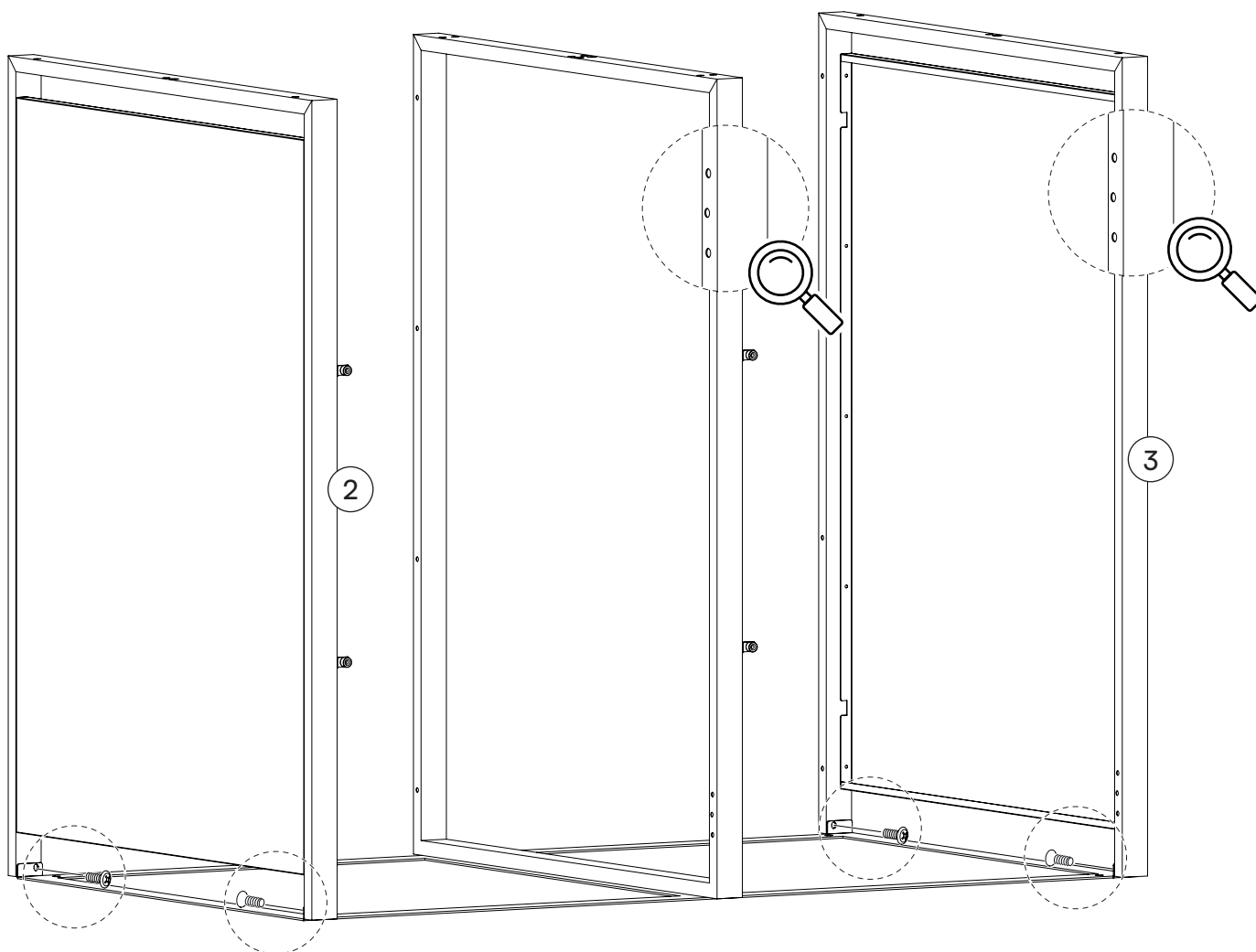

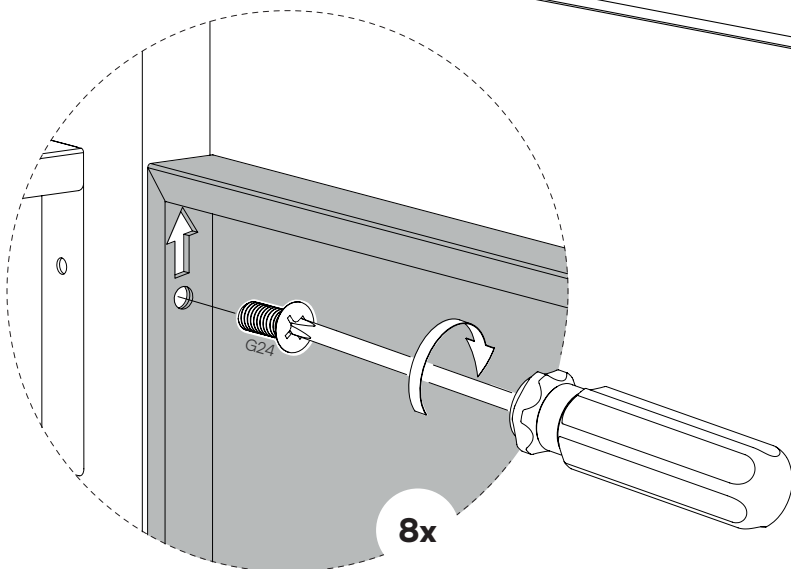
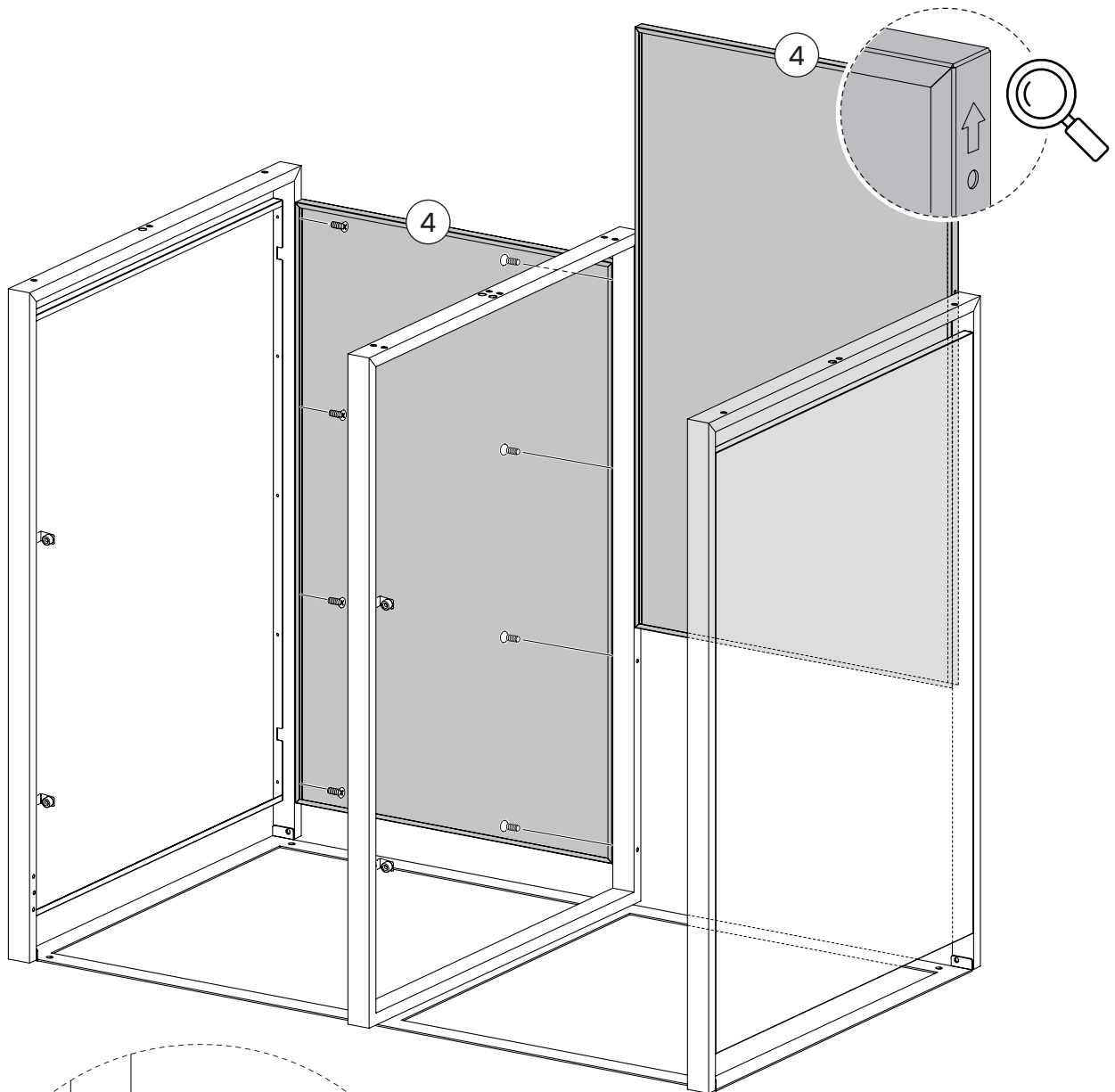

6

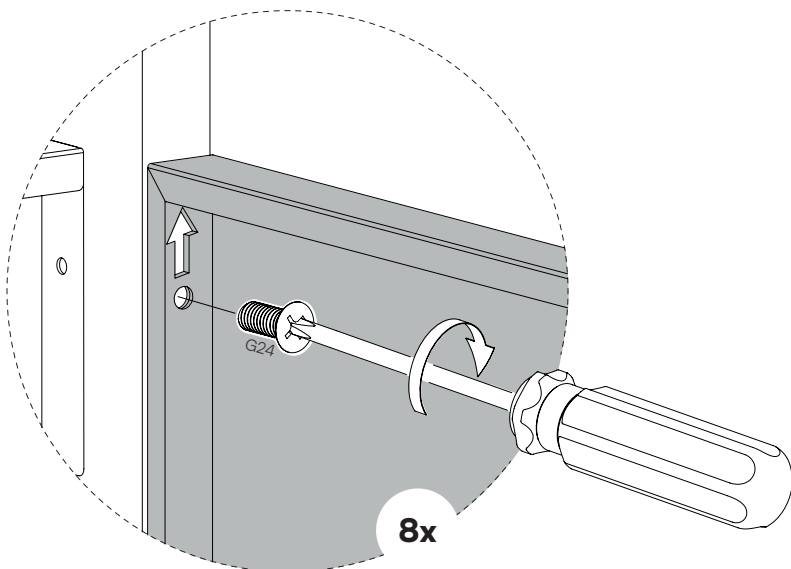
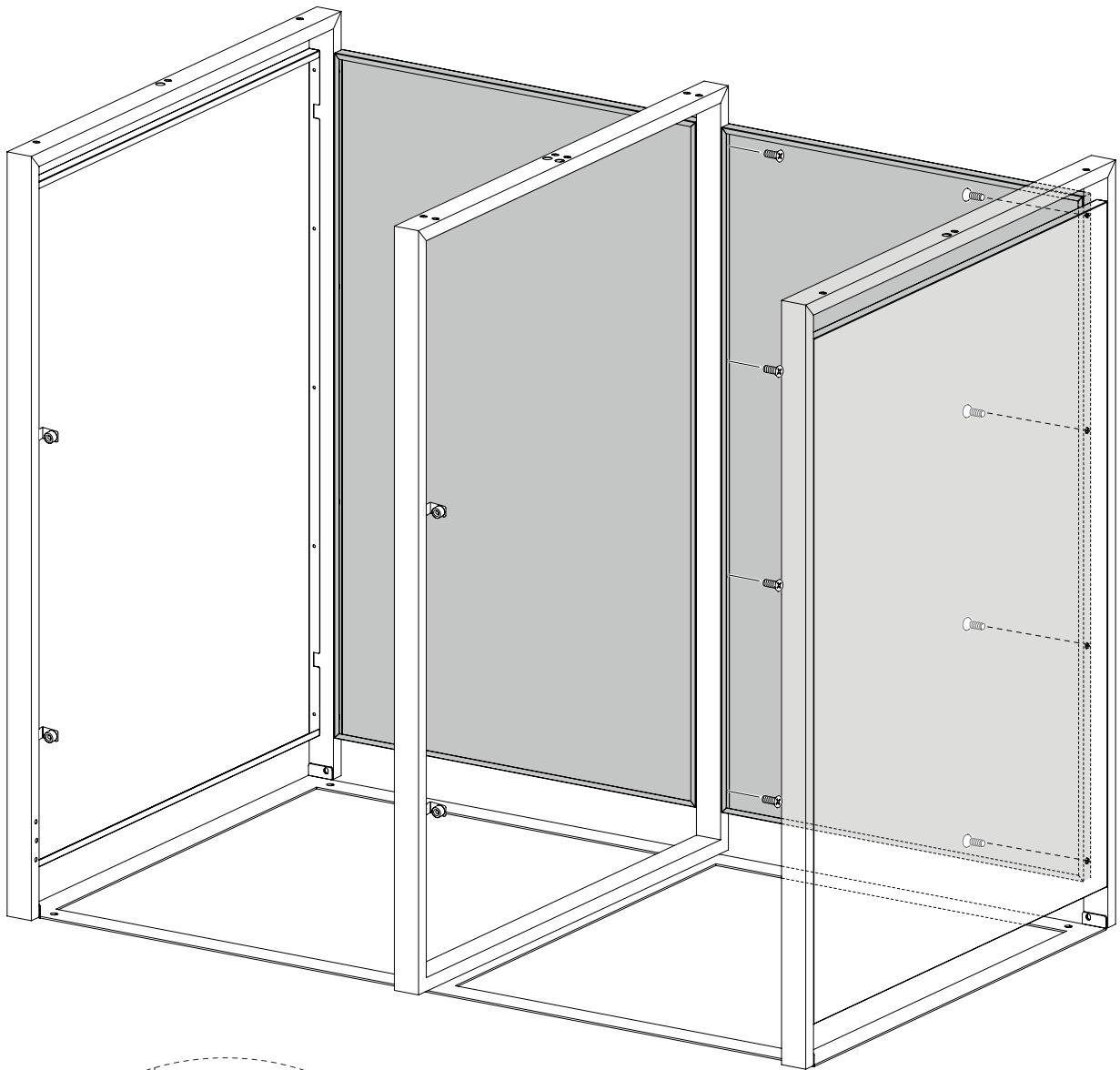

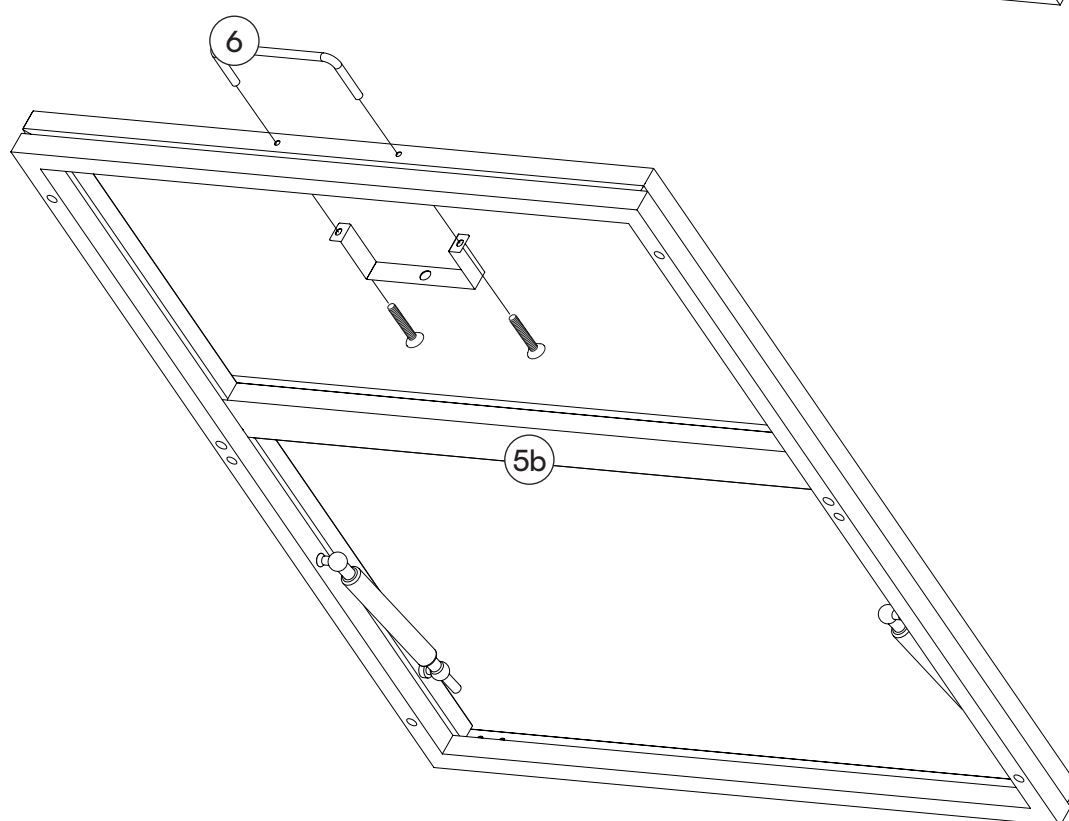
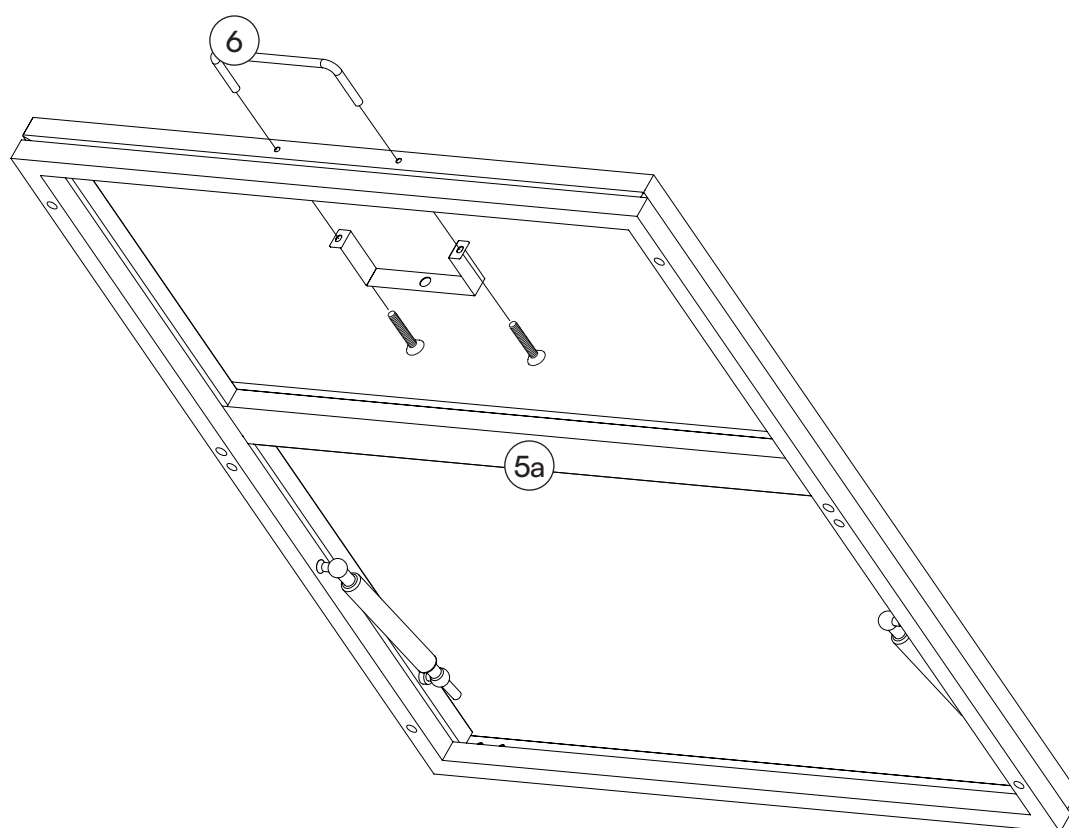
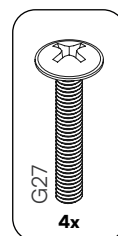

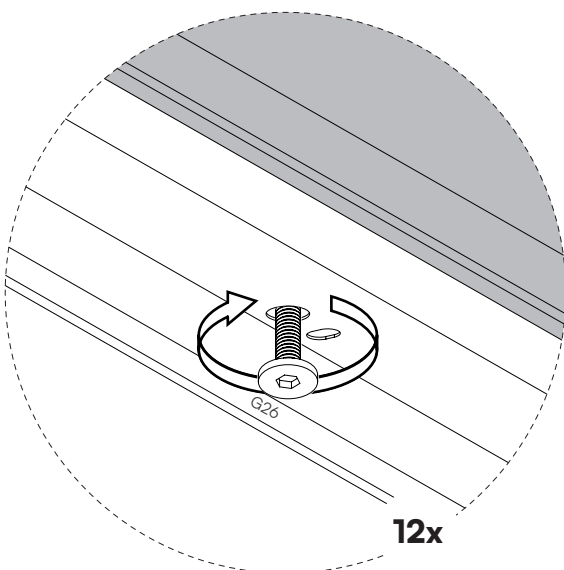
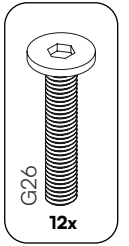
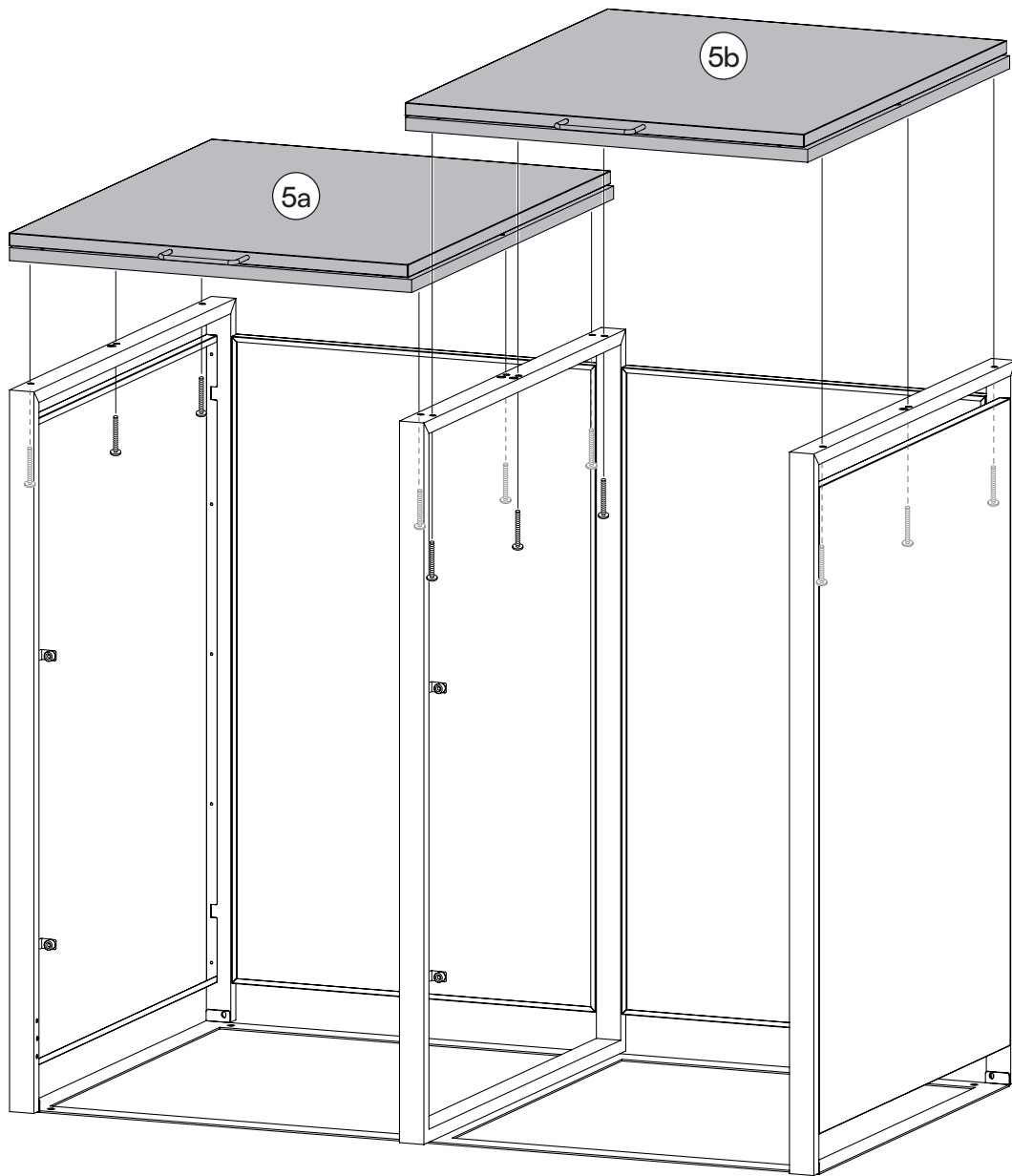

12x

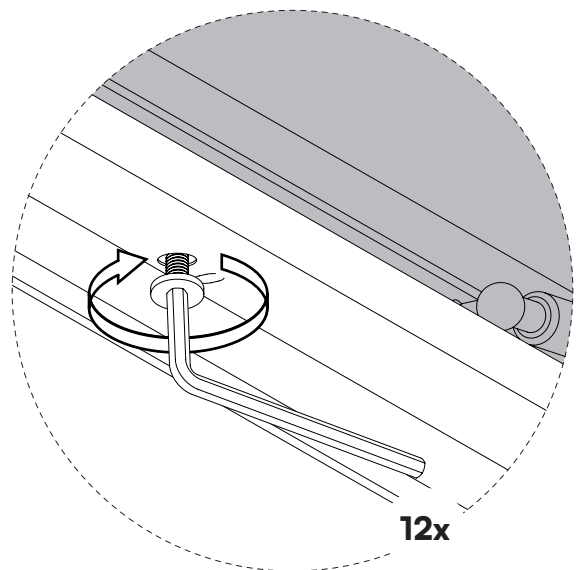

12x

9

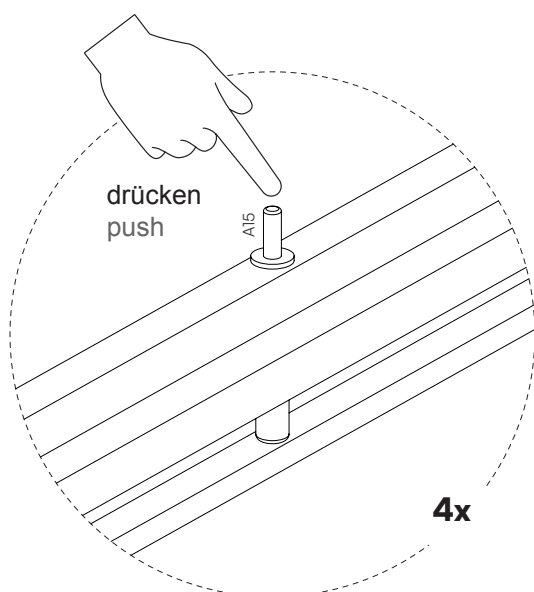
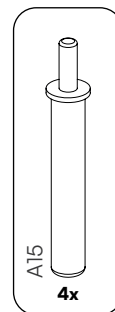
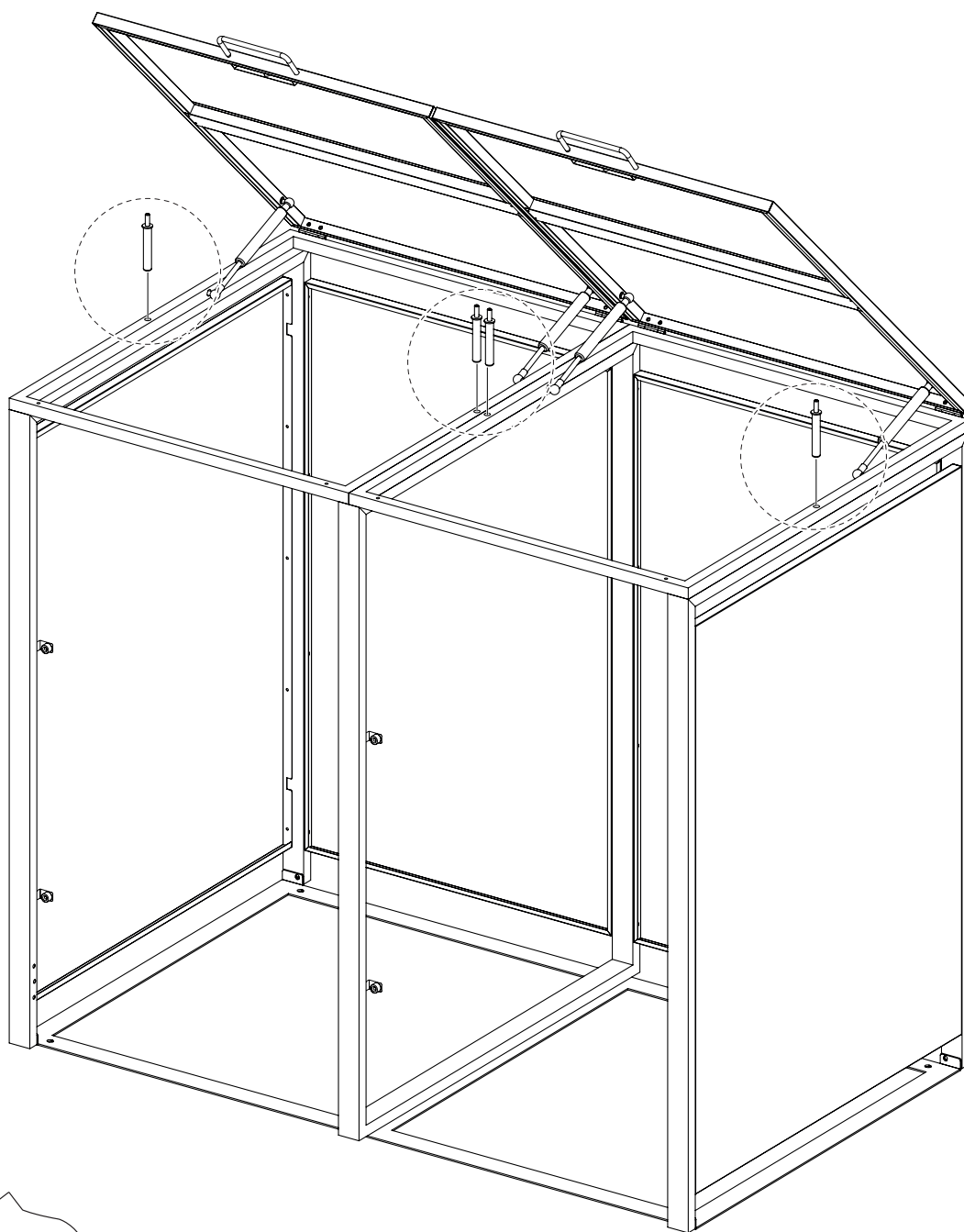

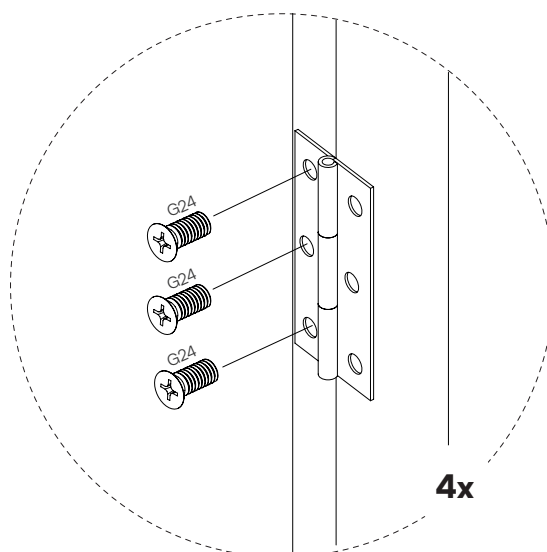
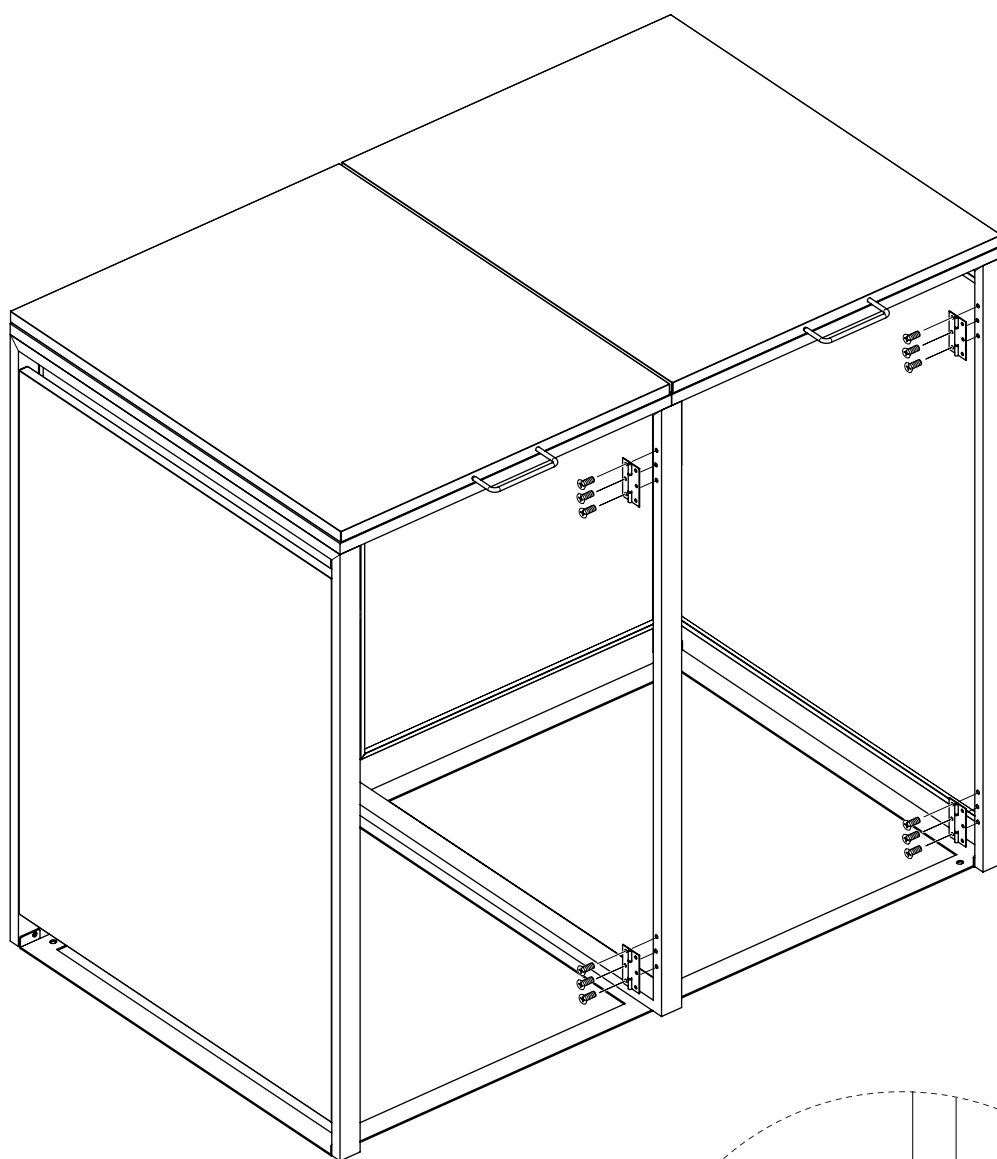
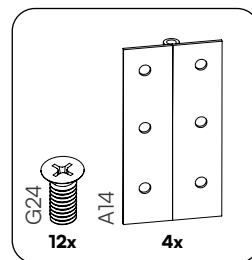

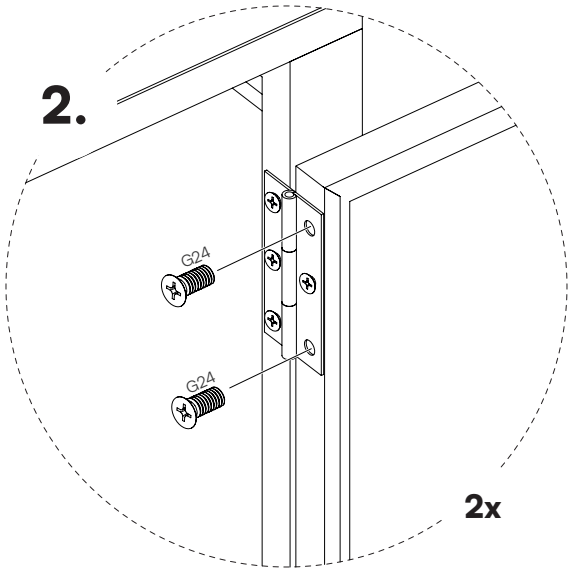
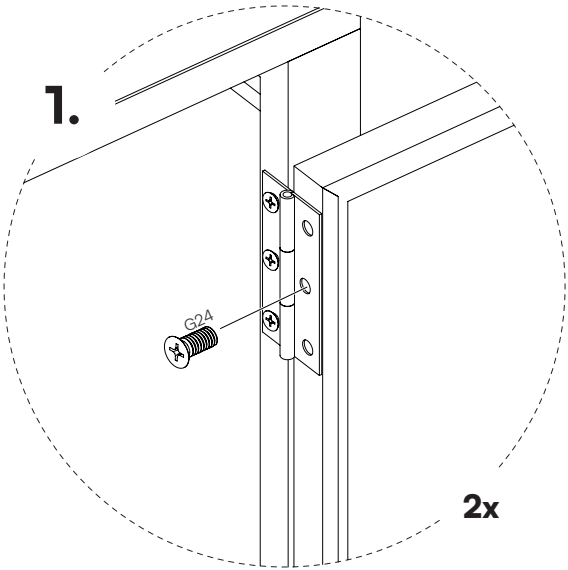
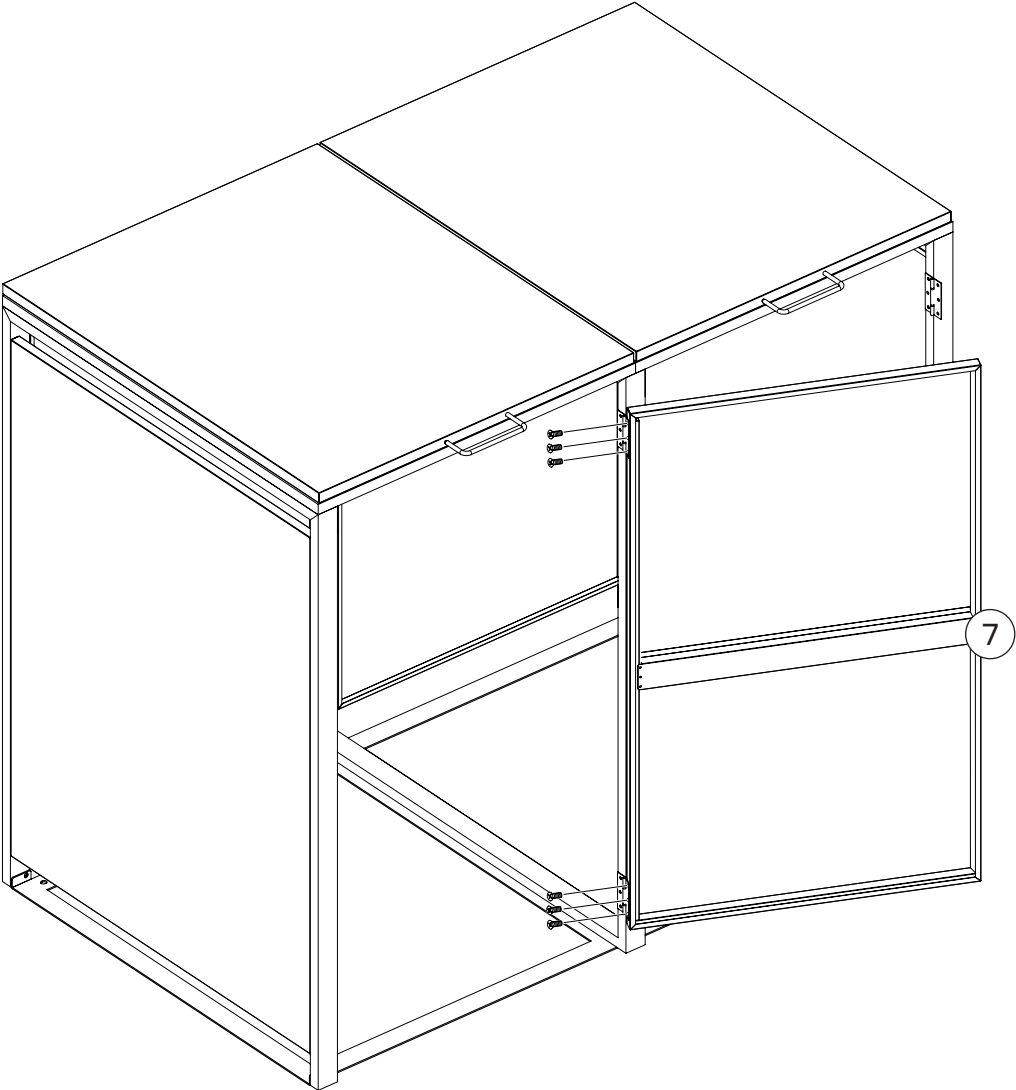

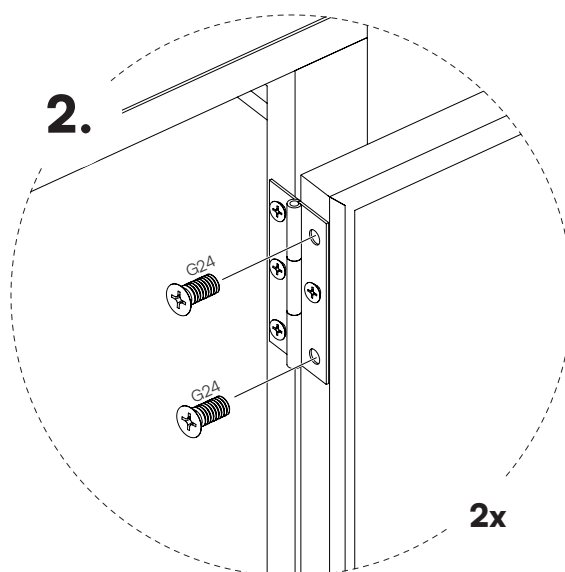
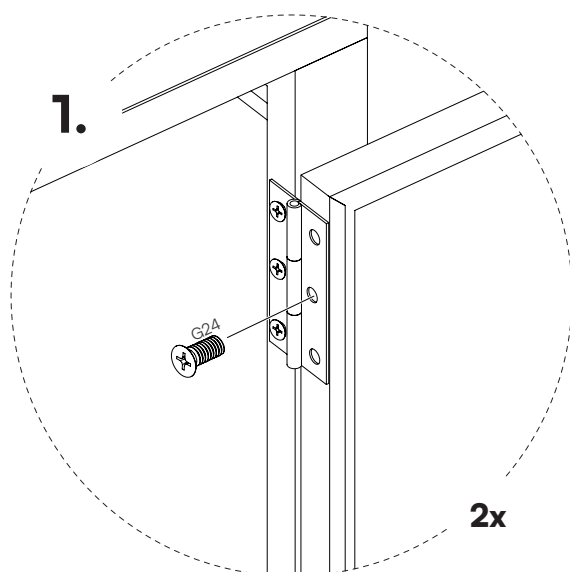
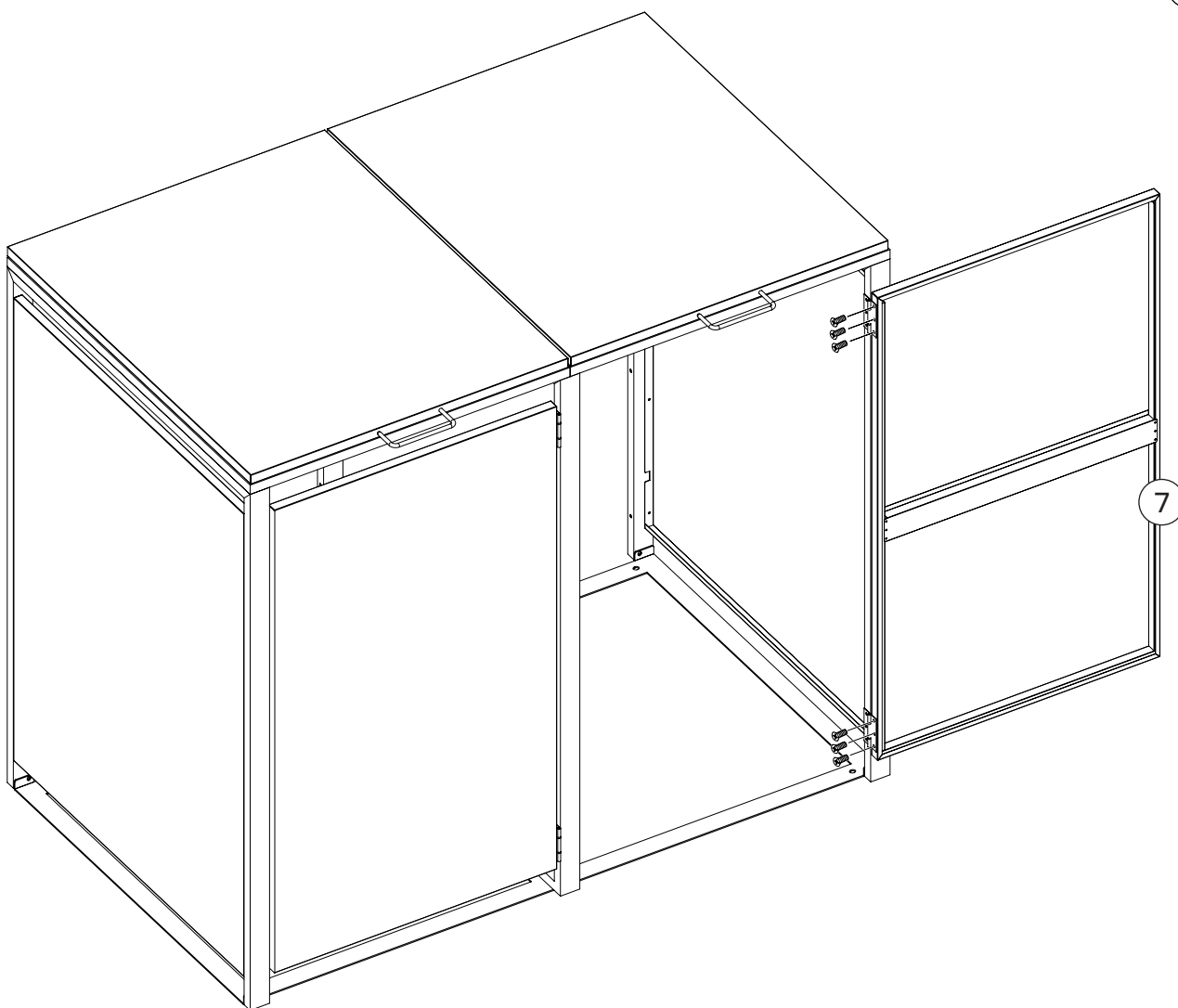

13

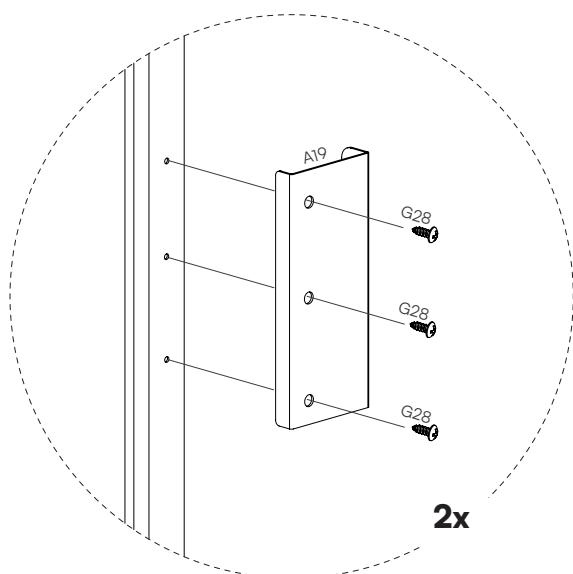
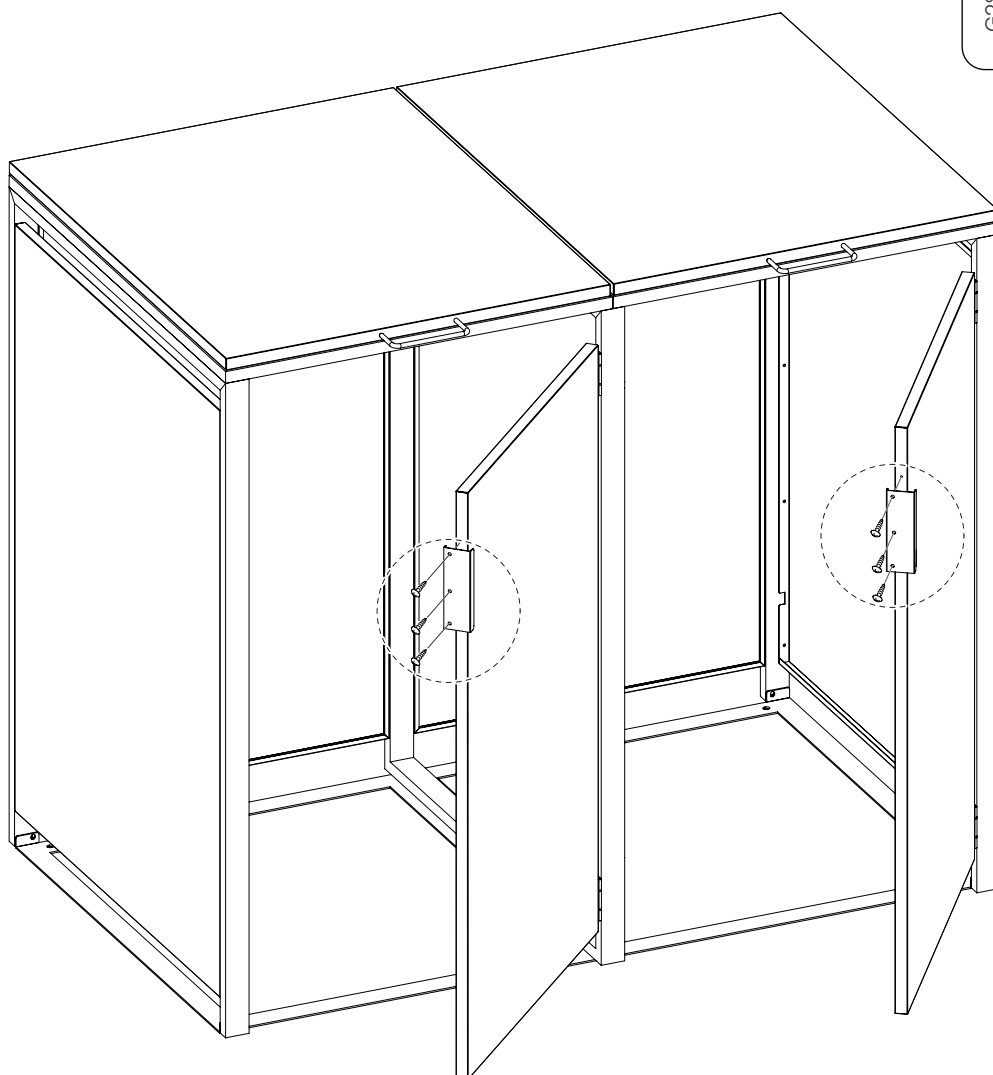
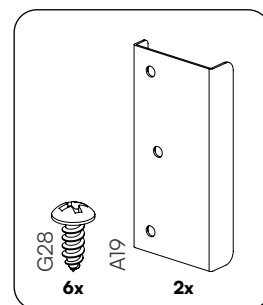

14

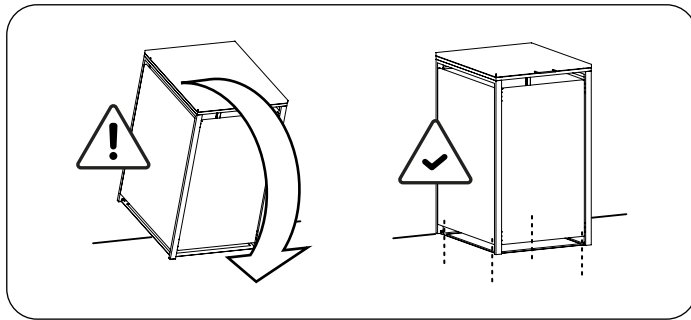

Für zusätzliche Stabilität empfehlen wir die Mülltonnenbox in den Boden zu verschrauben.

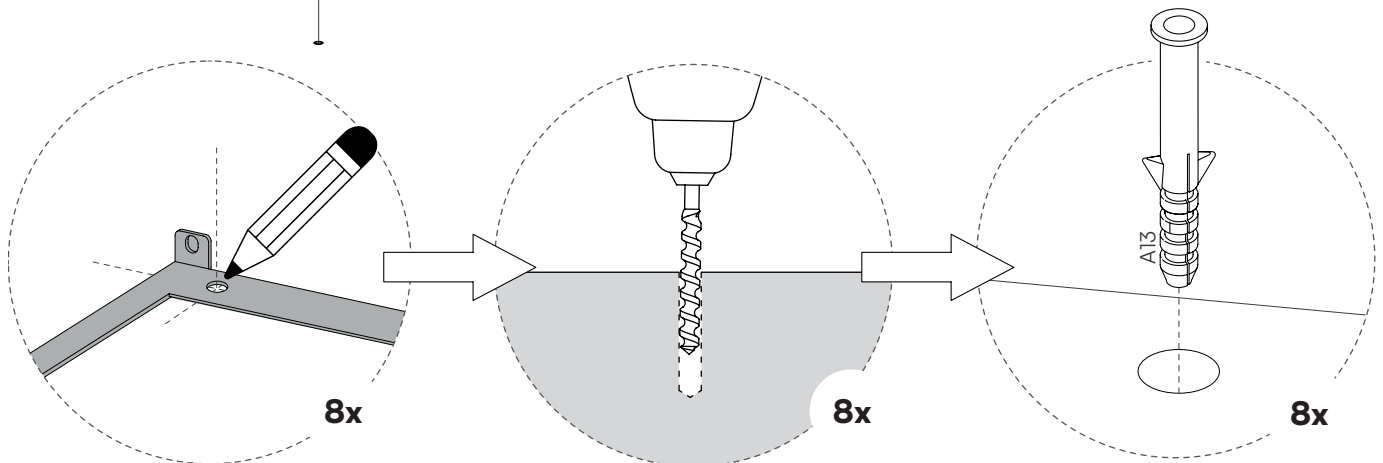
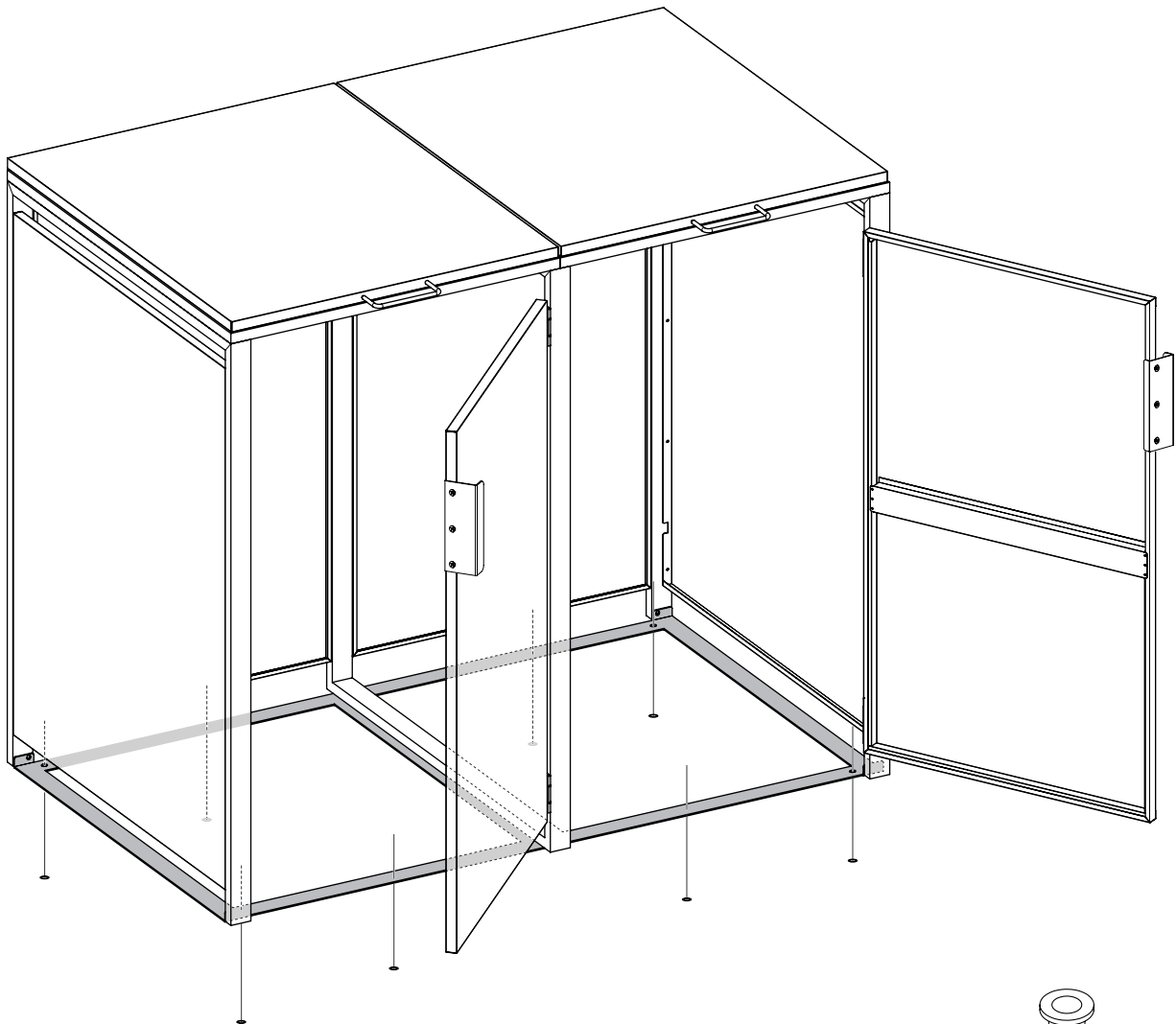
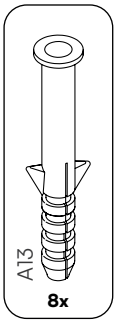

STEELSØN

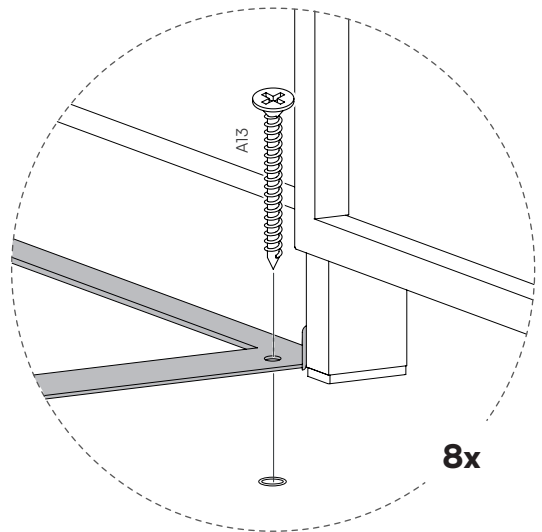
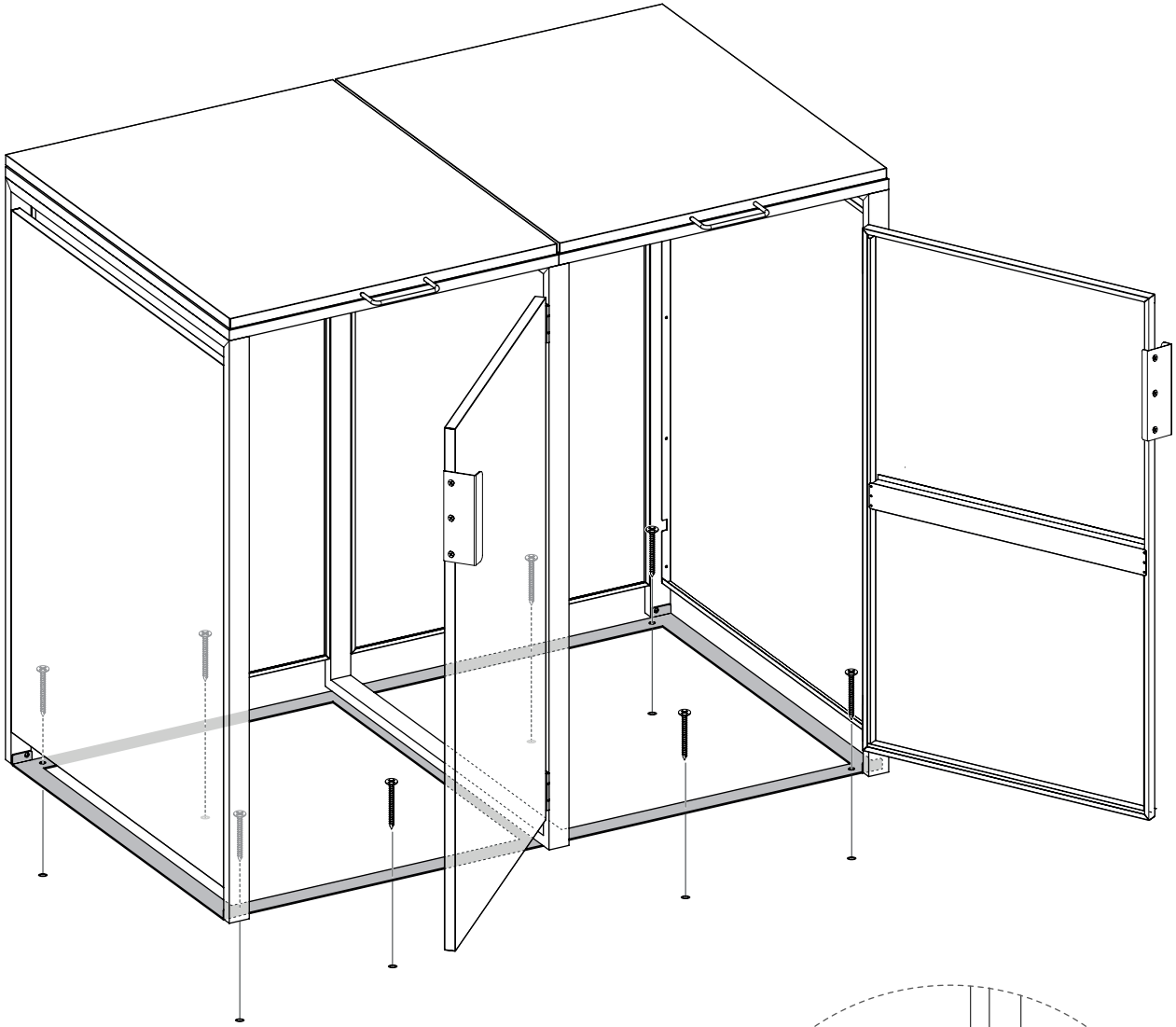
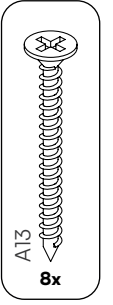

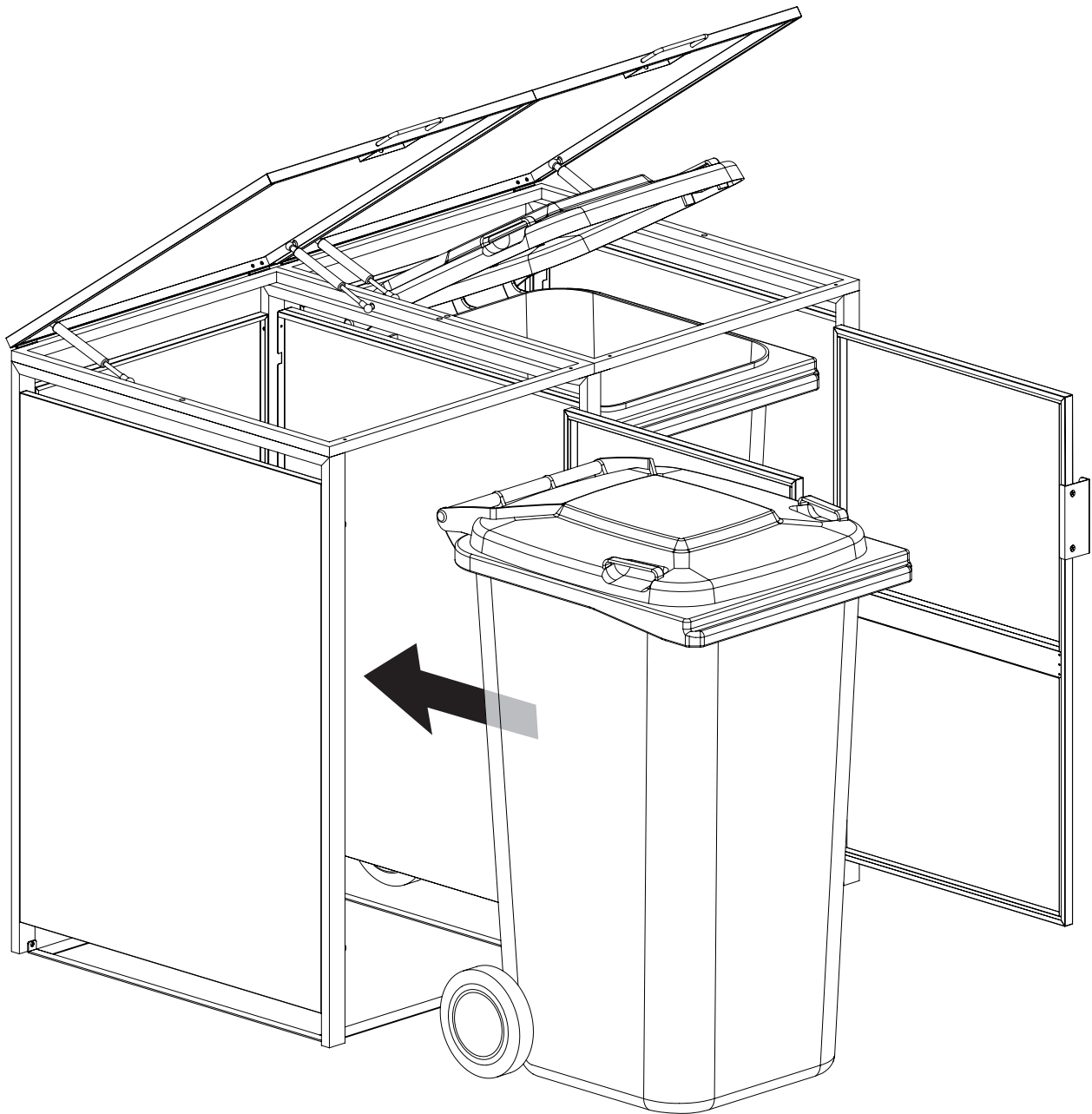

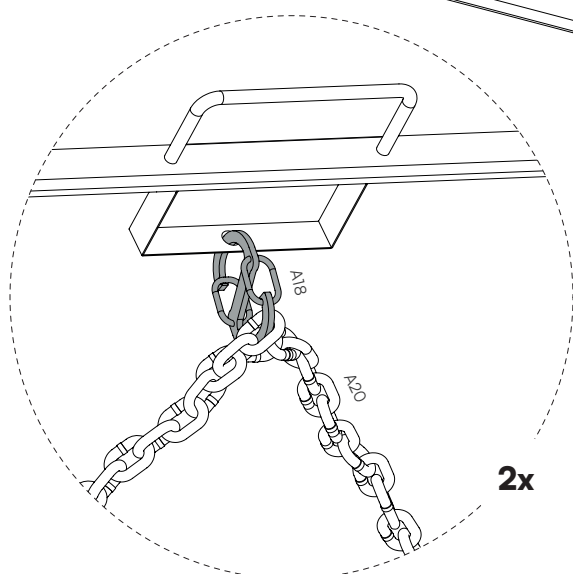
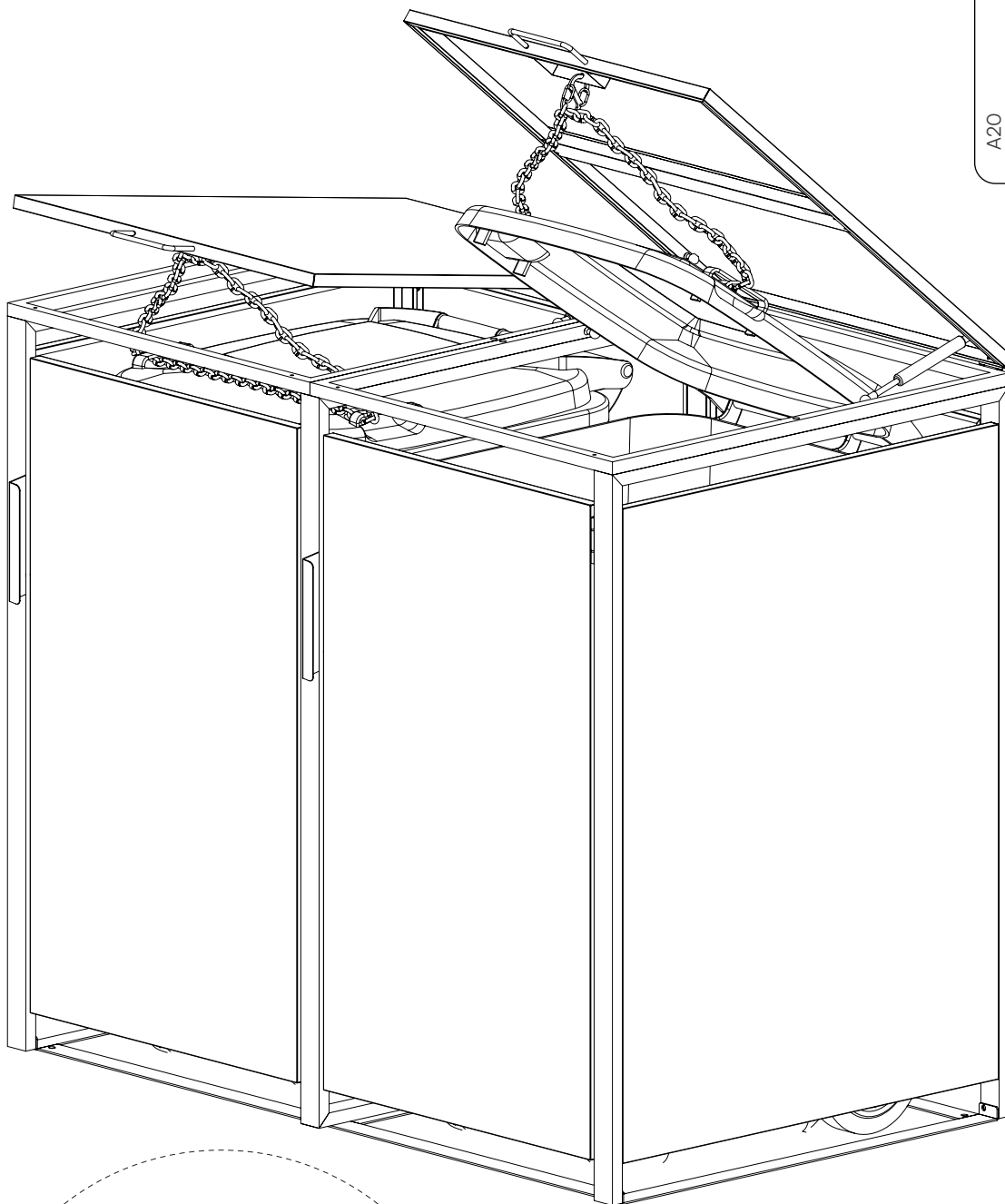
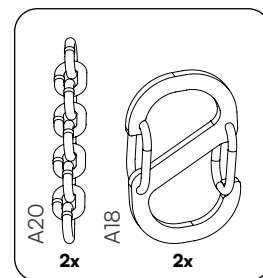



Fragen?

Wir sind für Dich da!

Scanne den QR-Code oder schreib uns an service@bela-living.de.
Gemeinsam kriegen wir jedes Problem gelöst!

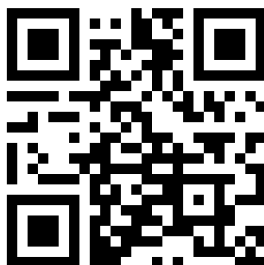
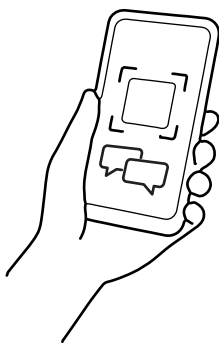

STEELSON

Mülltonnenbox 'Thoria'

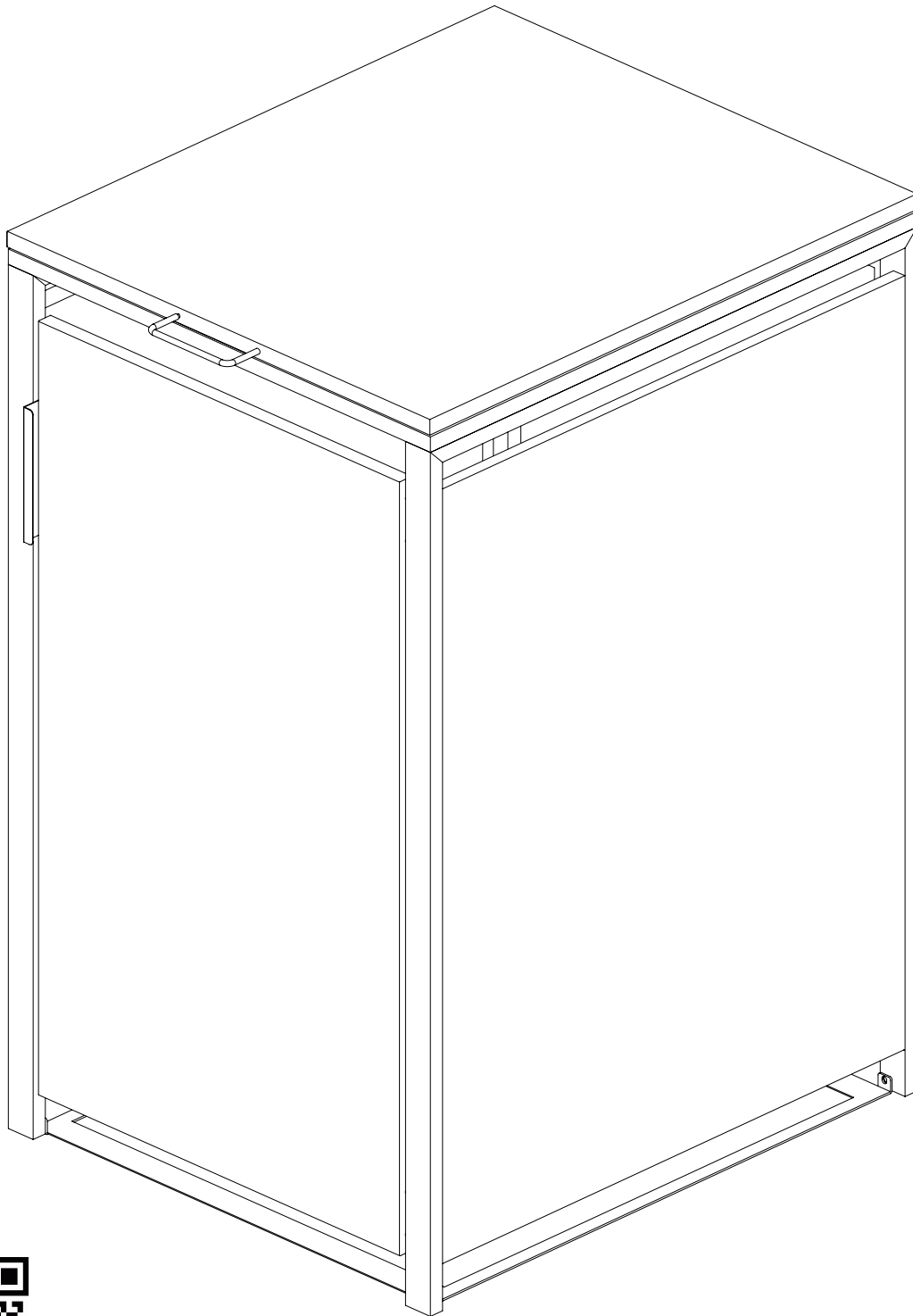

Hier geht's zum
Aufbauvideo



Hey,

wir freuen uns, dass Du Dich für unser Produkt entschieden hast. Beachte die kommenden Hinweise, um den Aufbau problemlos zu gestalten.

Viel Spaß mit Deinem Produkt!

50%

weniger Fehler beim Aufbau durch
sorgfältiges Lesen der Anleitung

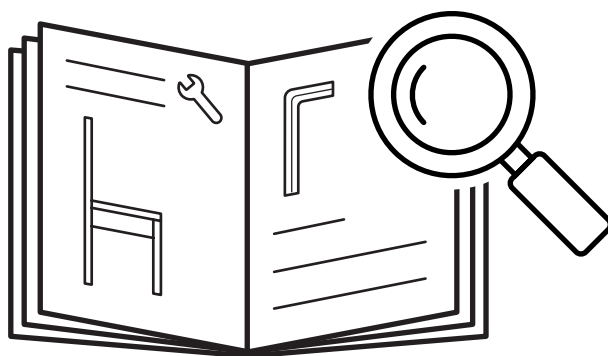

optional

60-90

min

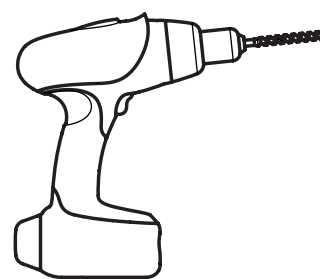

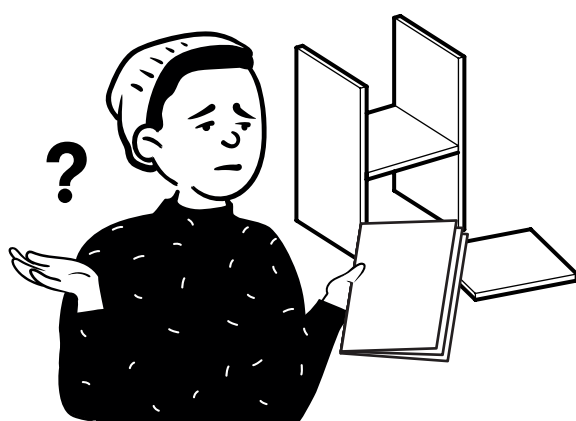
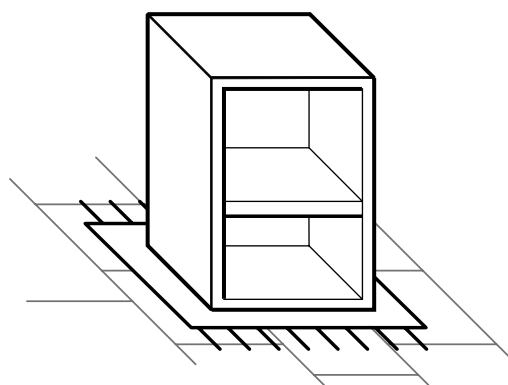
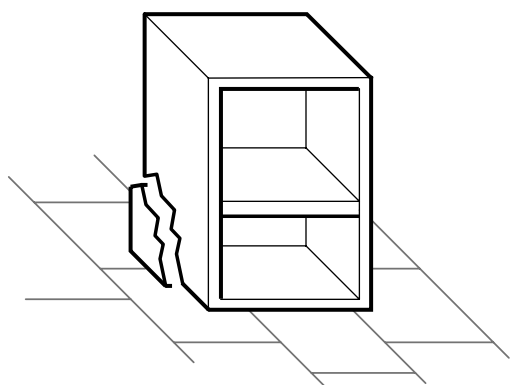

Fragen?

Wir sind für Dich da!



service@bela-living.de

1.

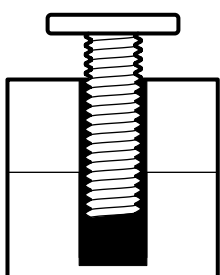

Ziehe die Schrauben während
des gesamten Aufbaus
zunächst per Hand an.

2.

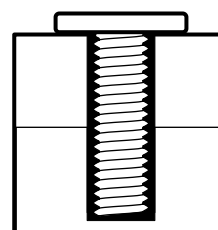

Justiere das Produkt final
und ziehe die Schrauben
vollständig an.

G24 - Kreuzschraube

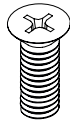

24x

G25 - Kreuzschraube

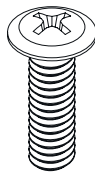

4x

G26 - Inbusschraube

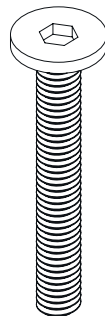

6x

G27 - Kreuzschraube

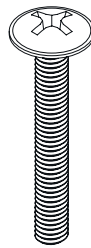

2x

A13 - Dübel und Schraube



4x

G28 - Kreuzschraube

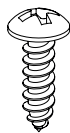

3x

A14 - Scharnier

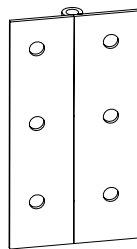

2x

A15 - Dämpfer

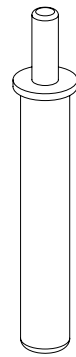

2x

A16 - Abdeckkappe

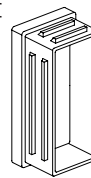

4x

A17 - Magnet

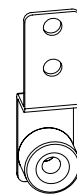

2x

A18 - Karabiner

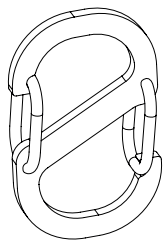

1x

A19 - Türgriff

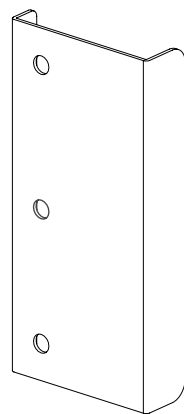

1x

A20 - Metallkette



1x

T10 - Inbusschlüssel

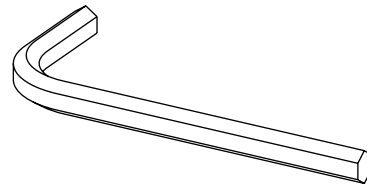

1x

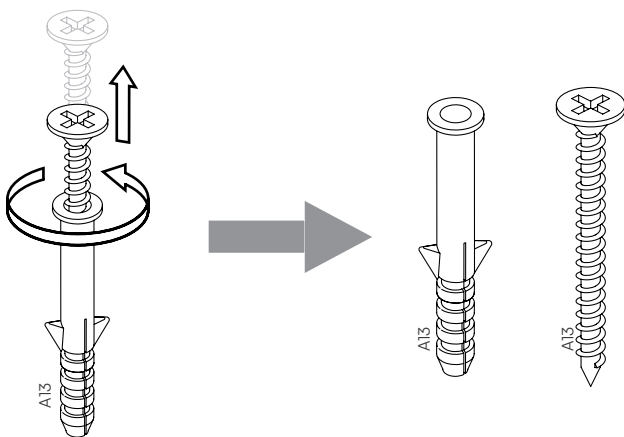
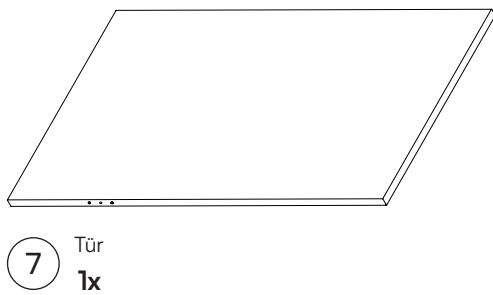
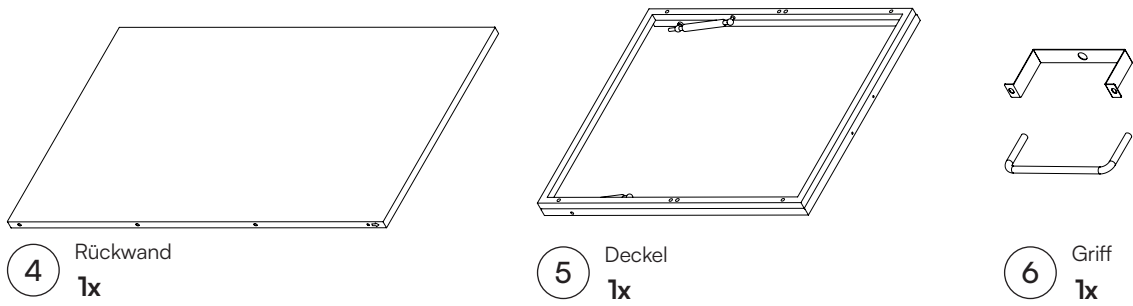
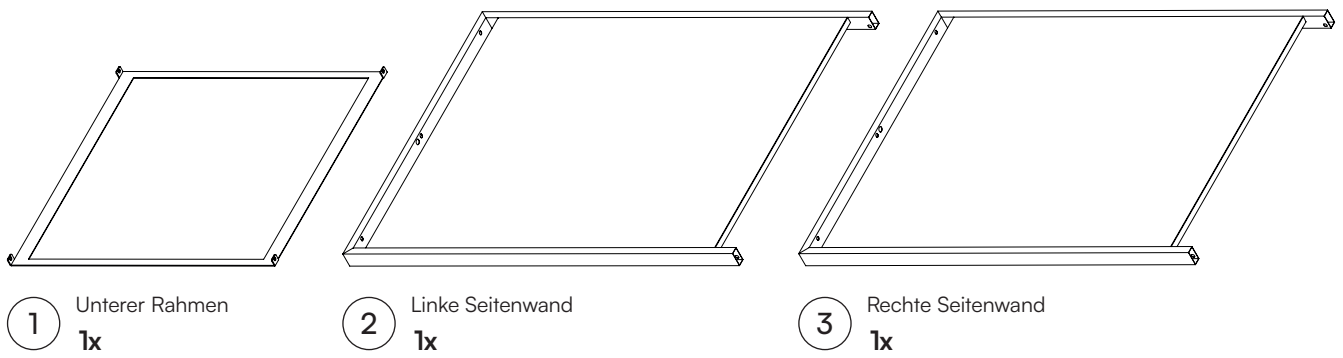

Ein letzter Check:

Bitte überprüfe, ob Du alle Teile hast.

Viel Spaß beim Aufbau!

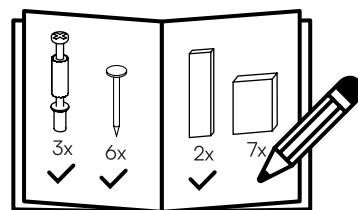

1



Hier geht's zum
Aufbauvideo

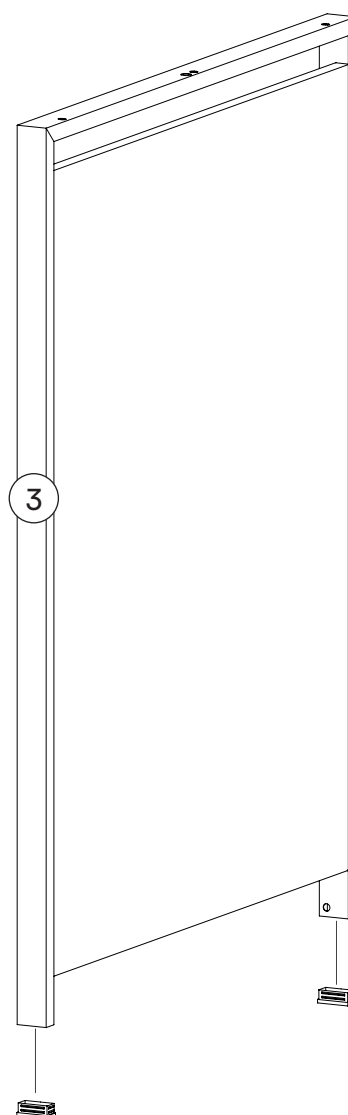
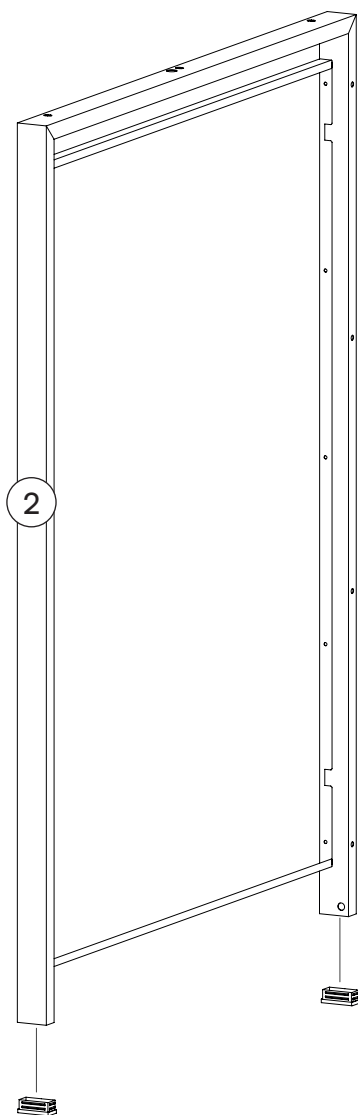
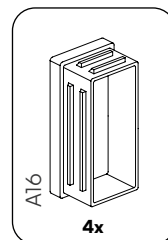

2

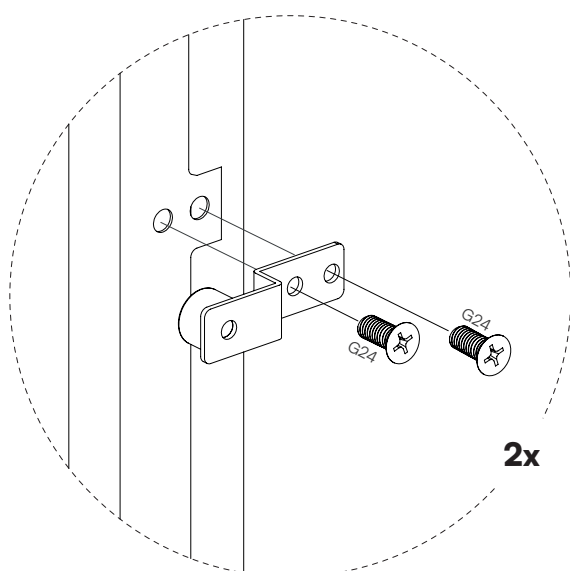
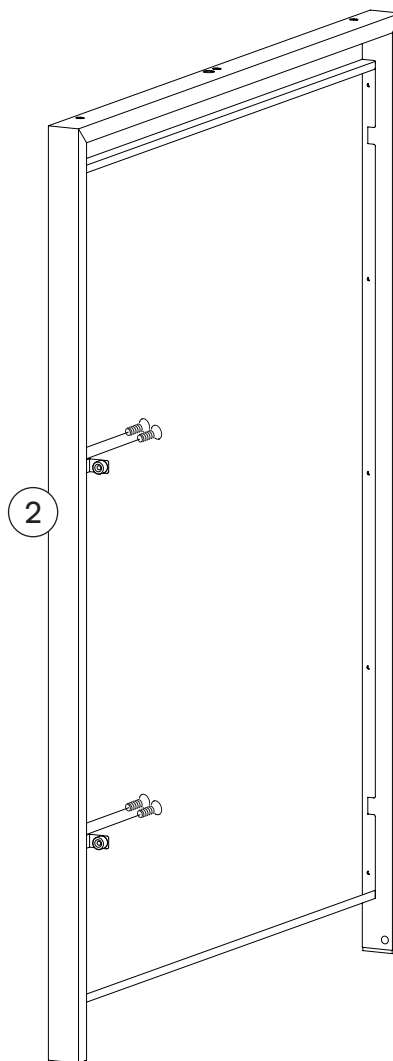
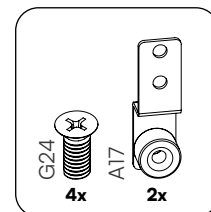

3

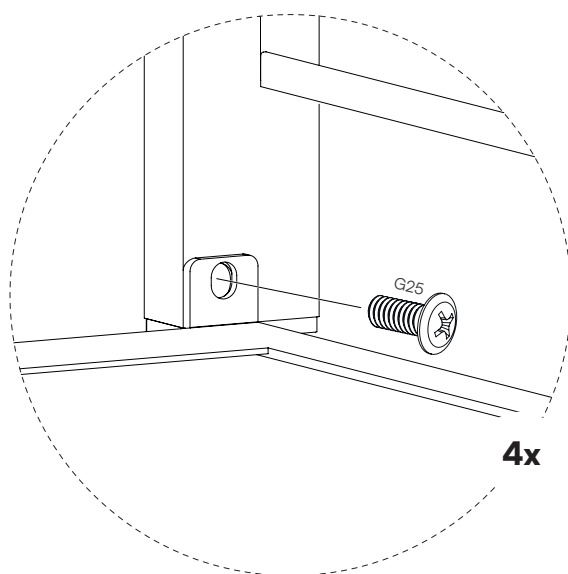
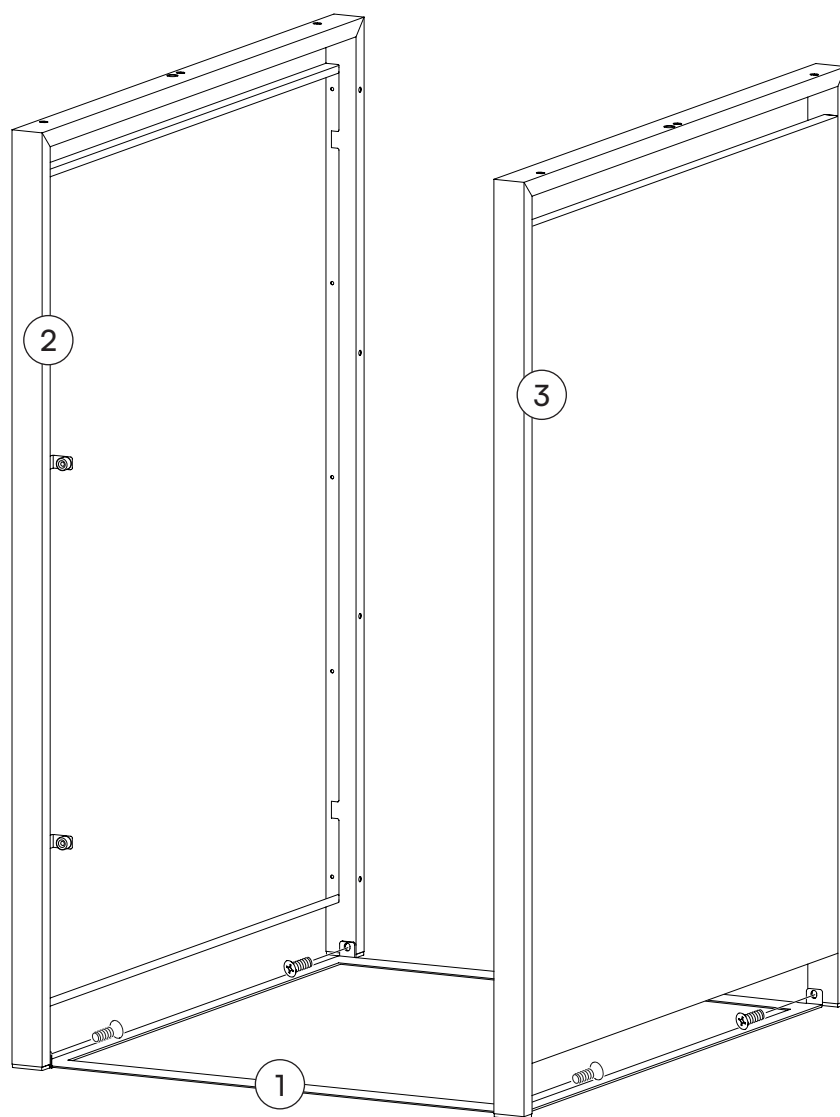

4

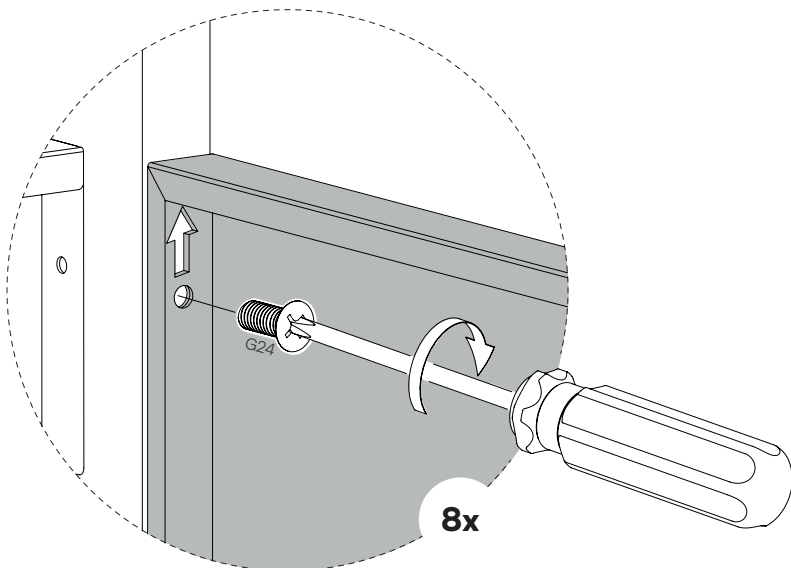
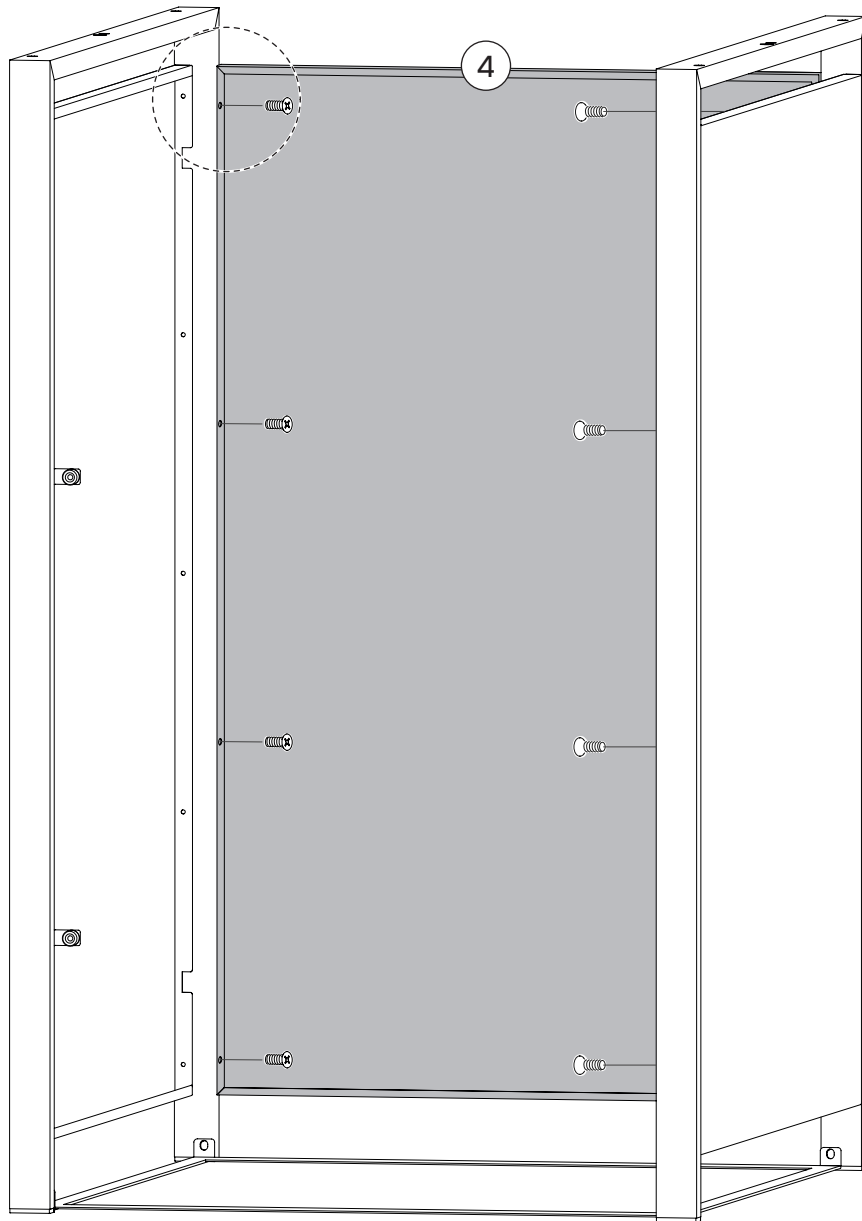

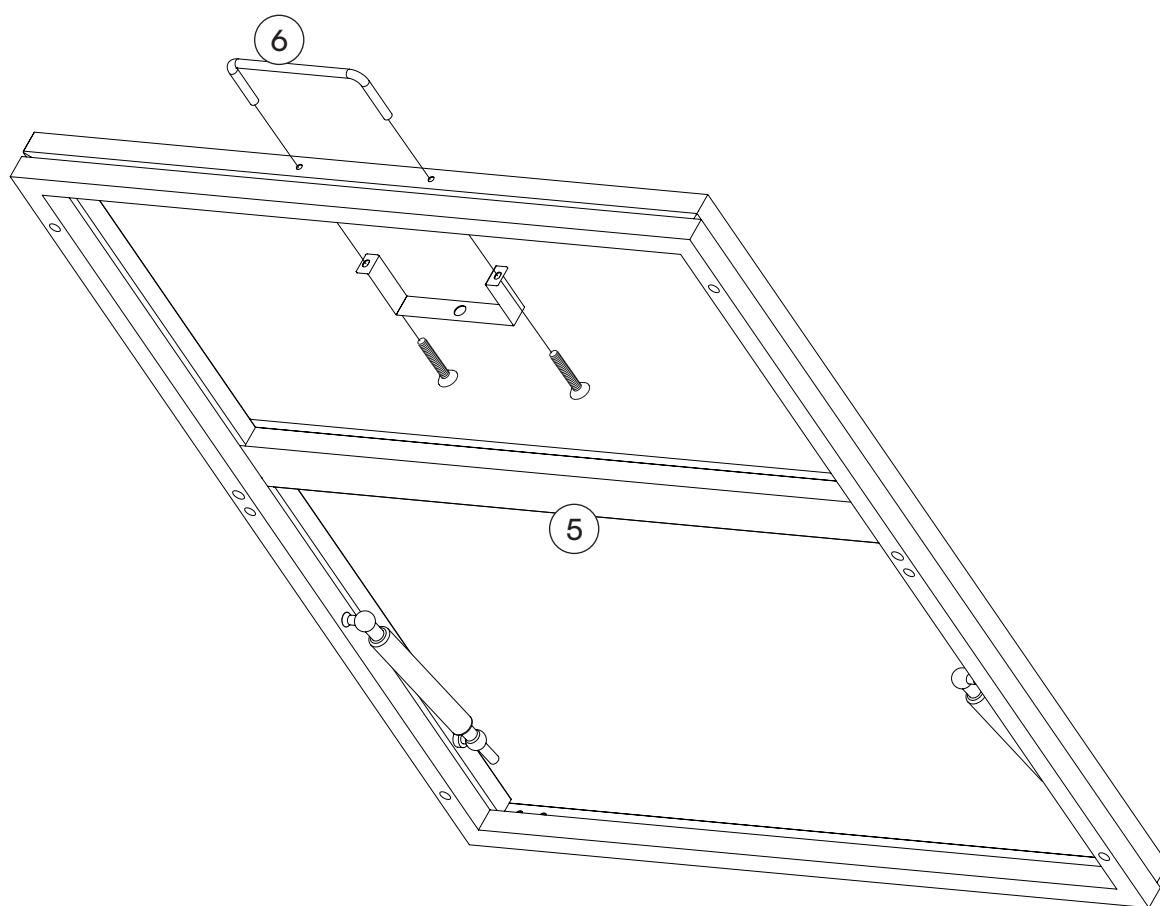
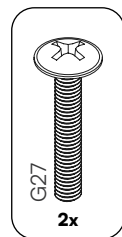

6

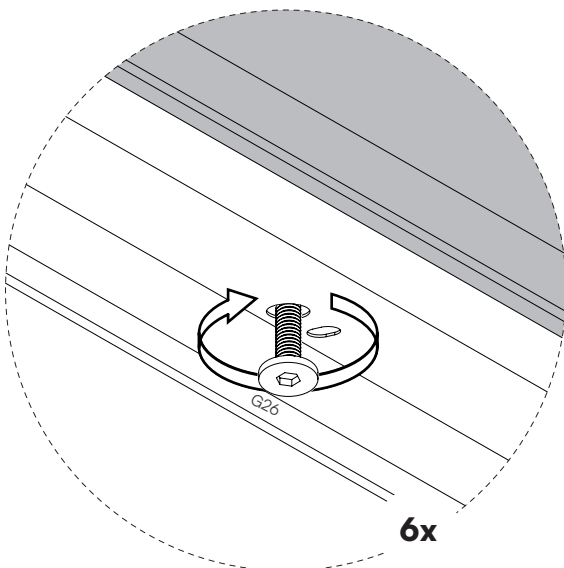
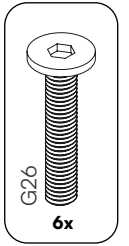
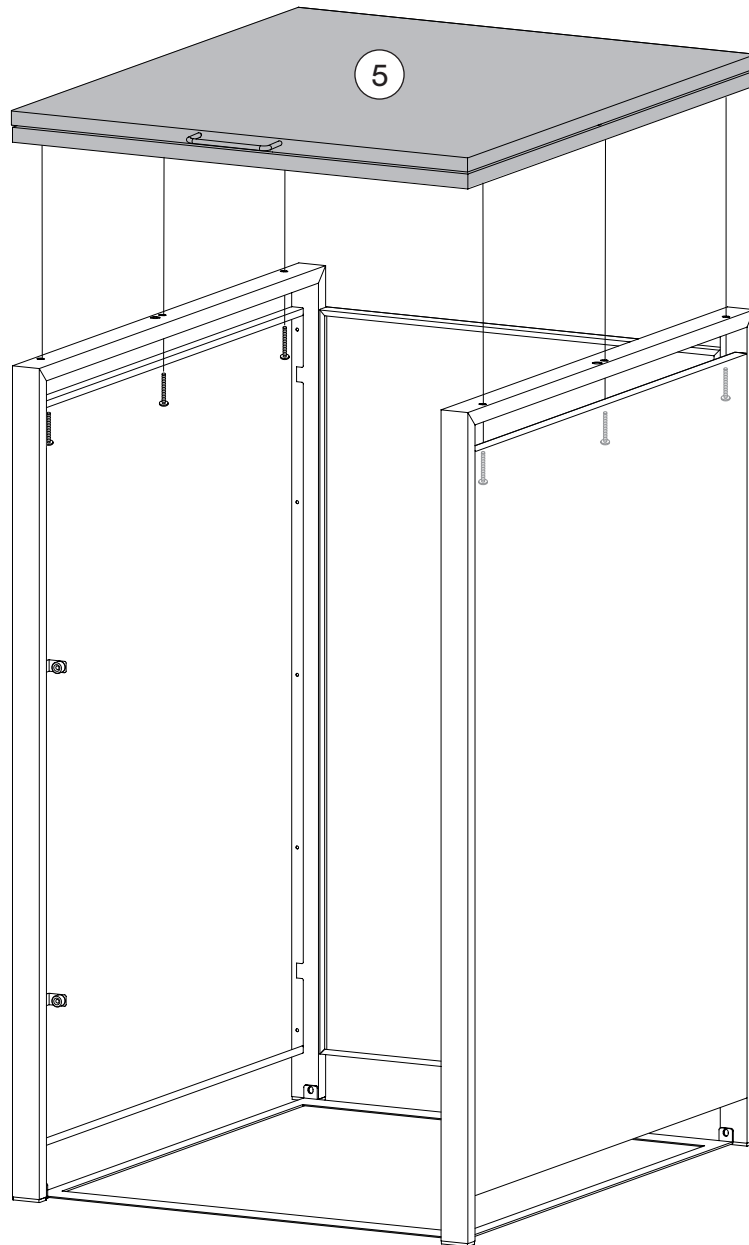

6x

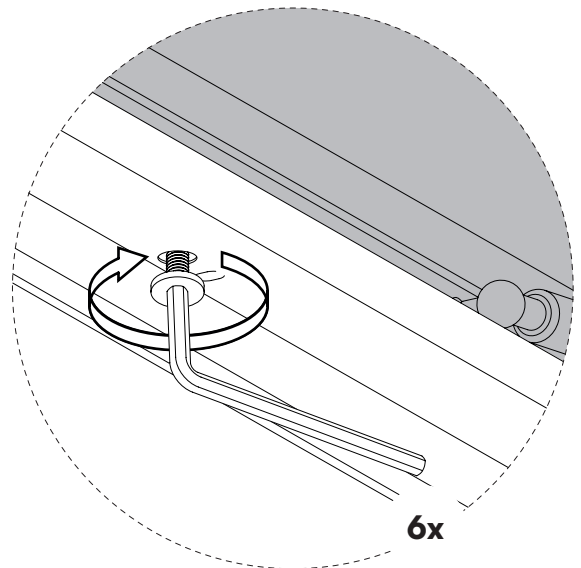

6x



STEELSON

7

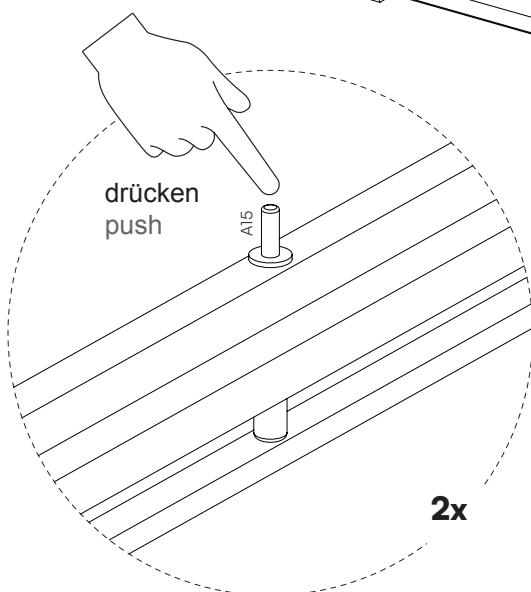
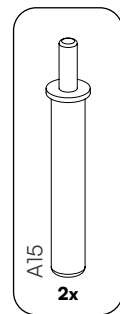
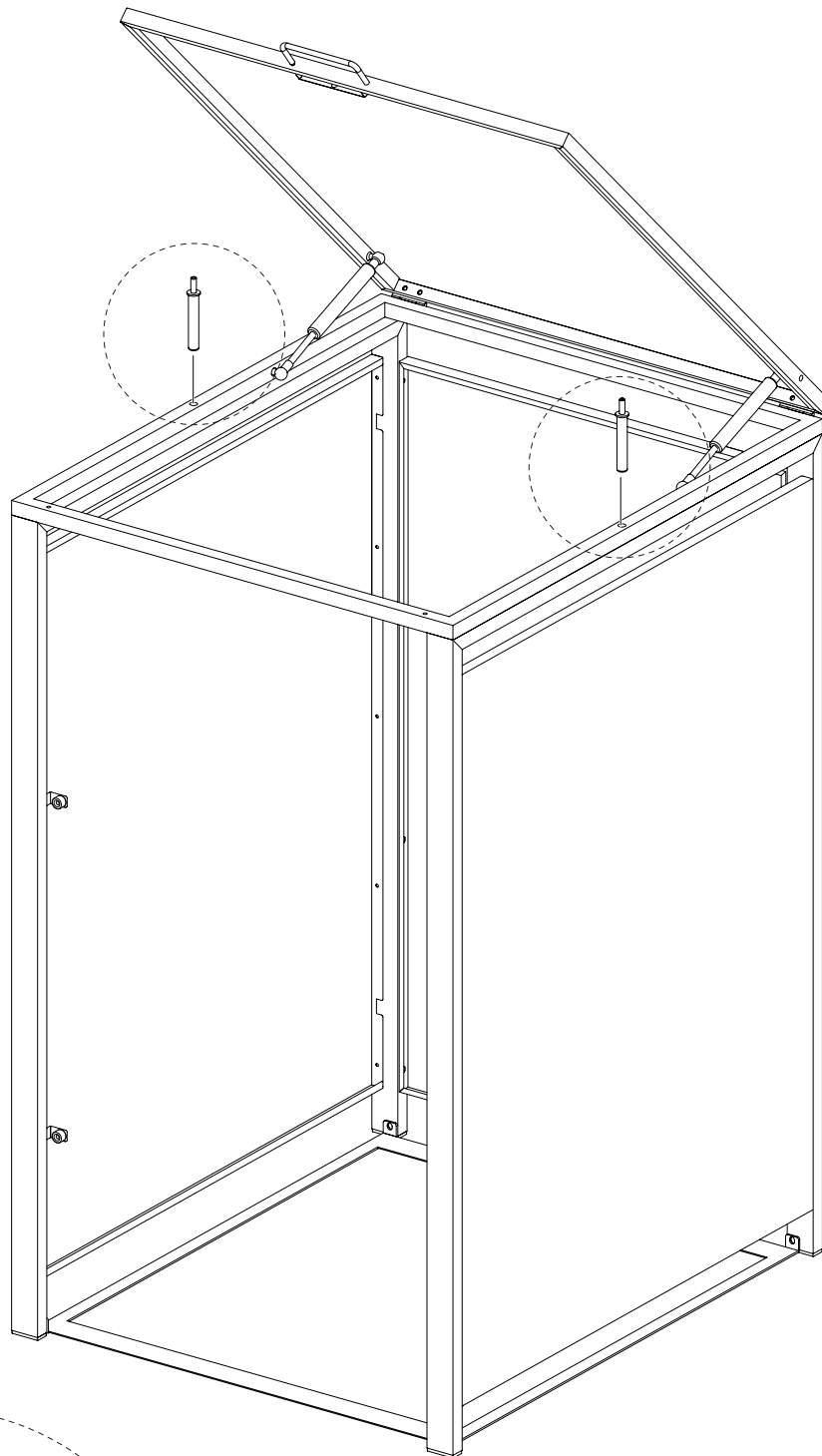

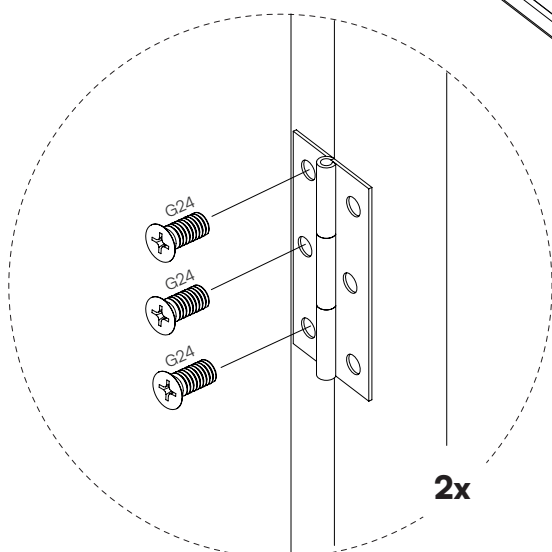
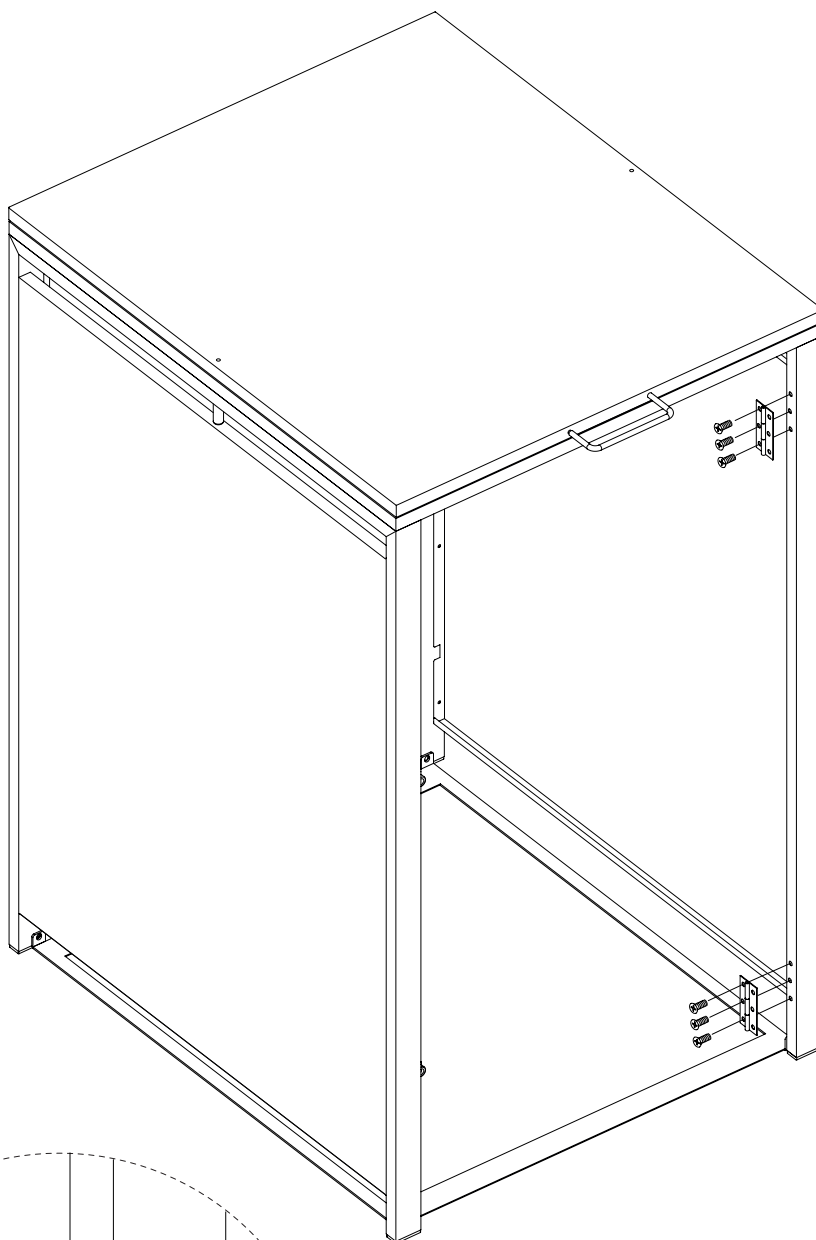
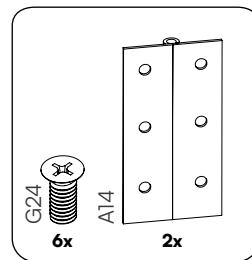

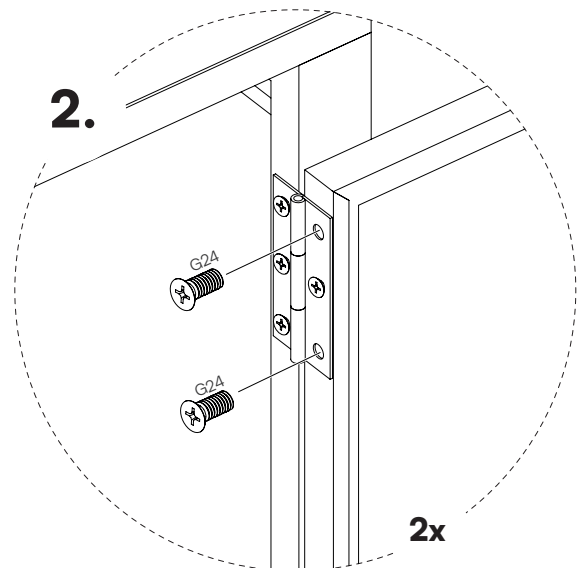
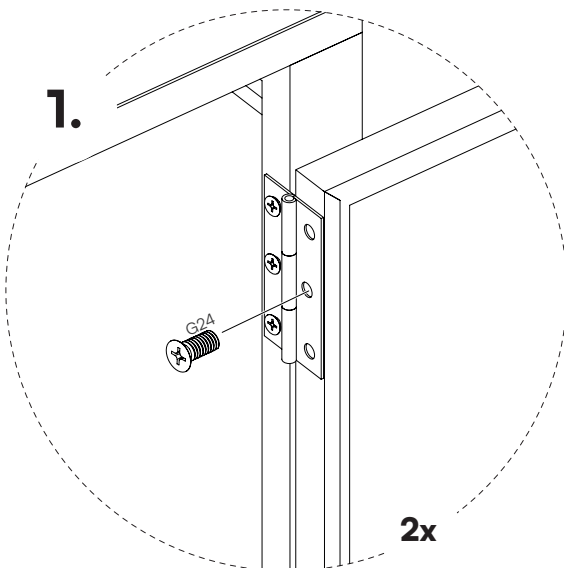
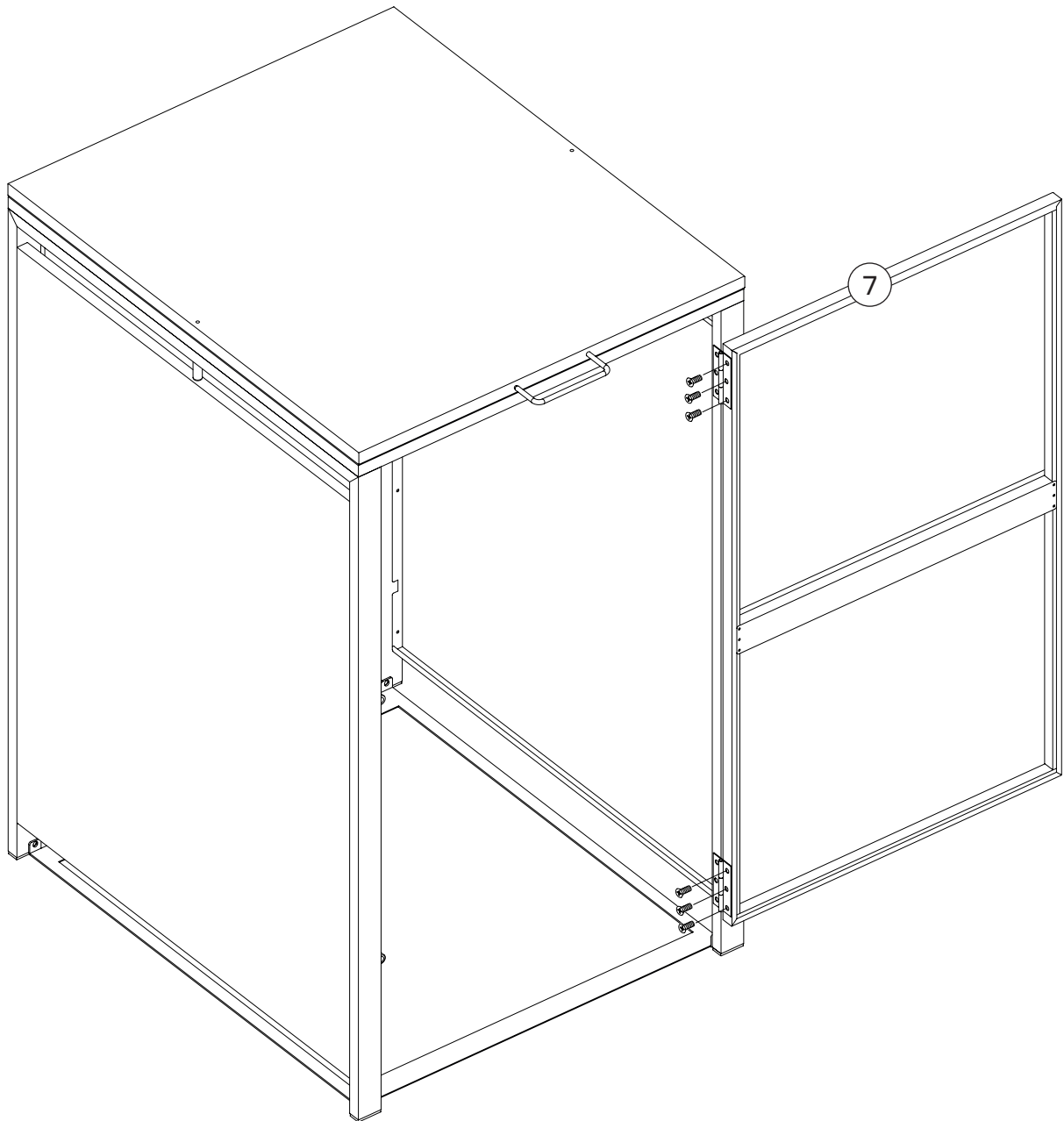

10

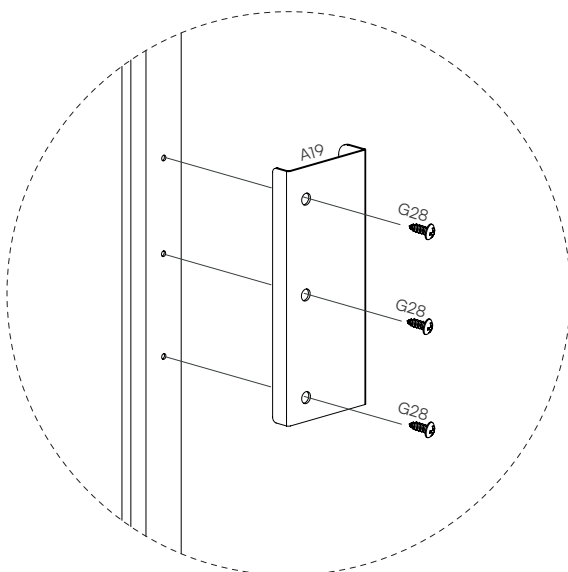
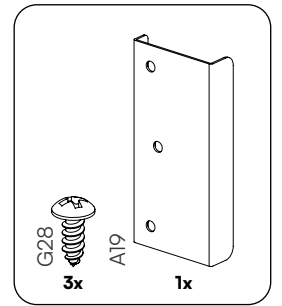
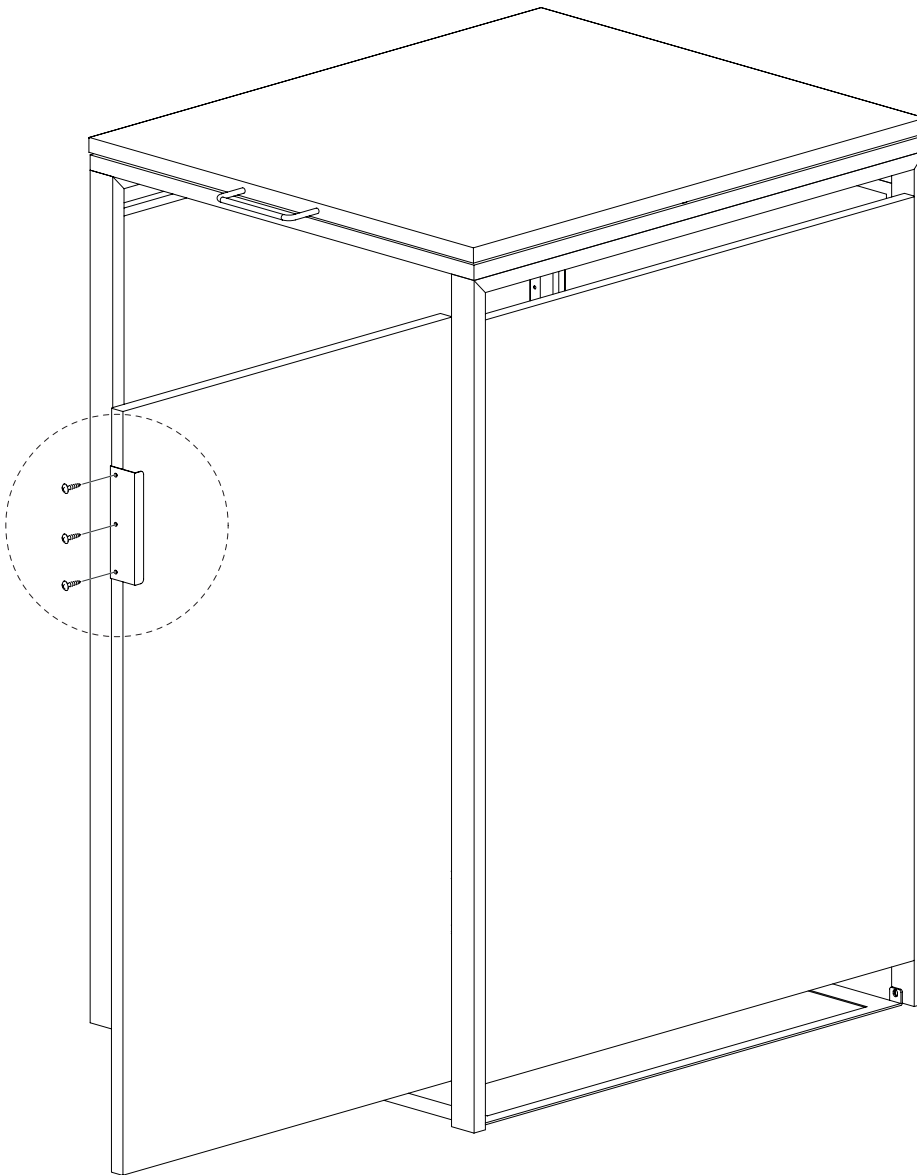

11

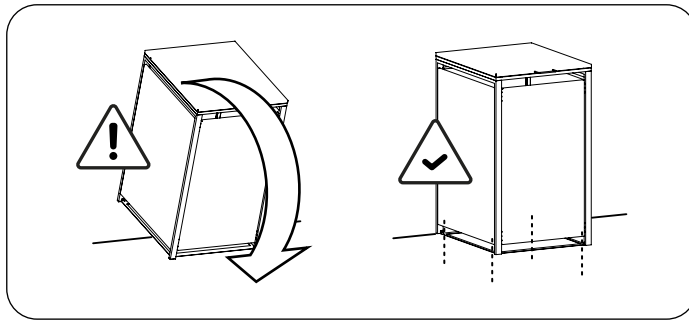

Für zusätzliche Stabilität empfehlen wir die Mülltonnenbox in den Boden zu verschrauben.

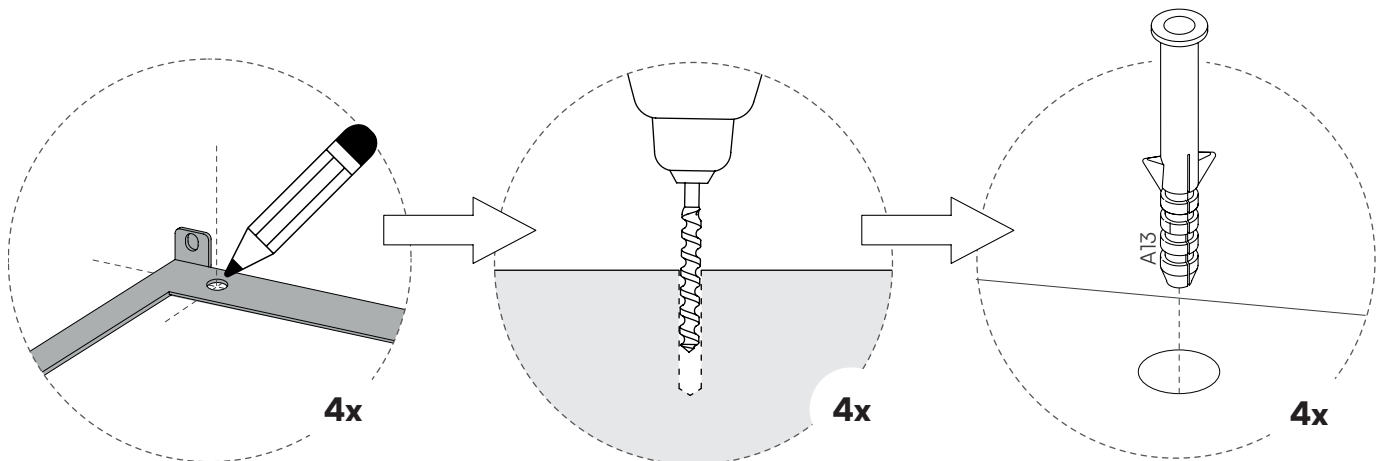
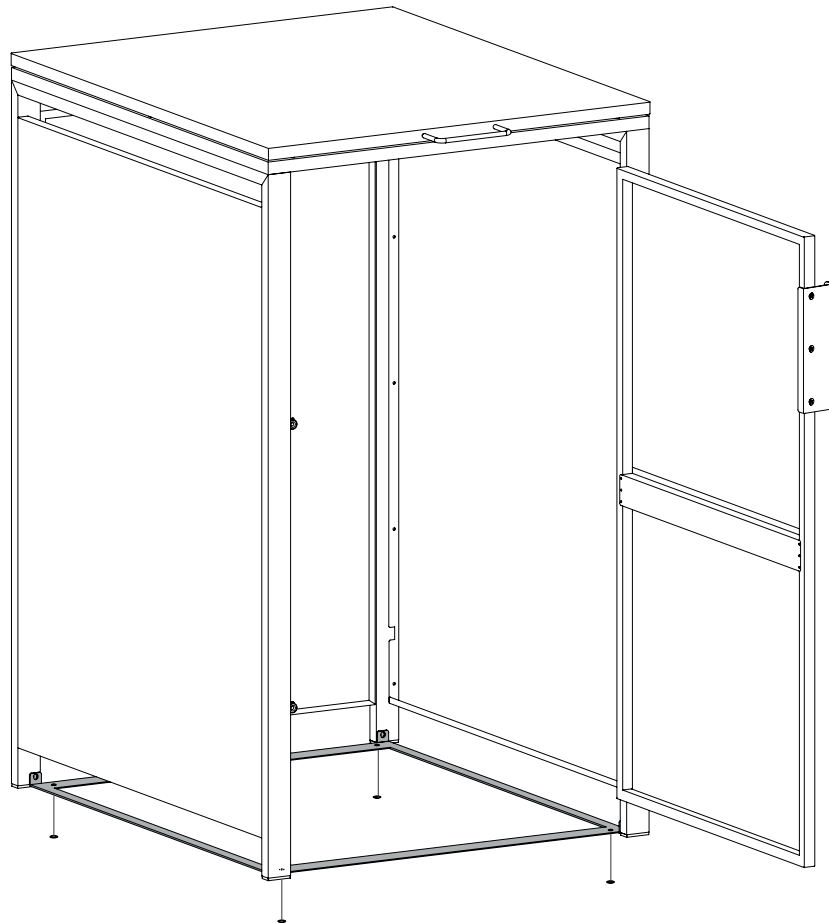
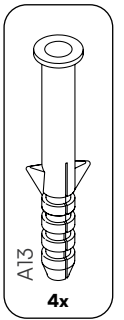

12

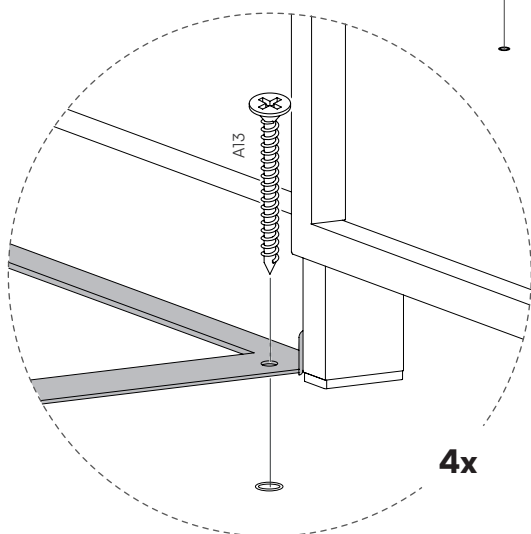
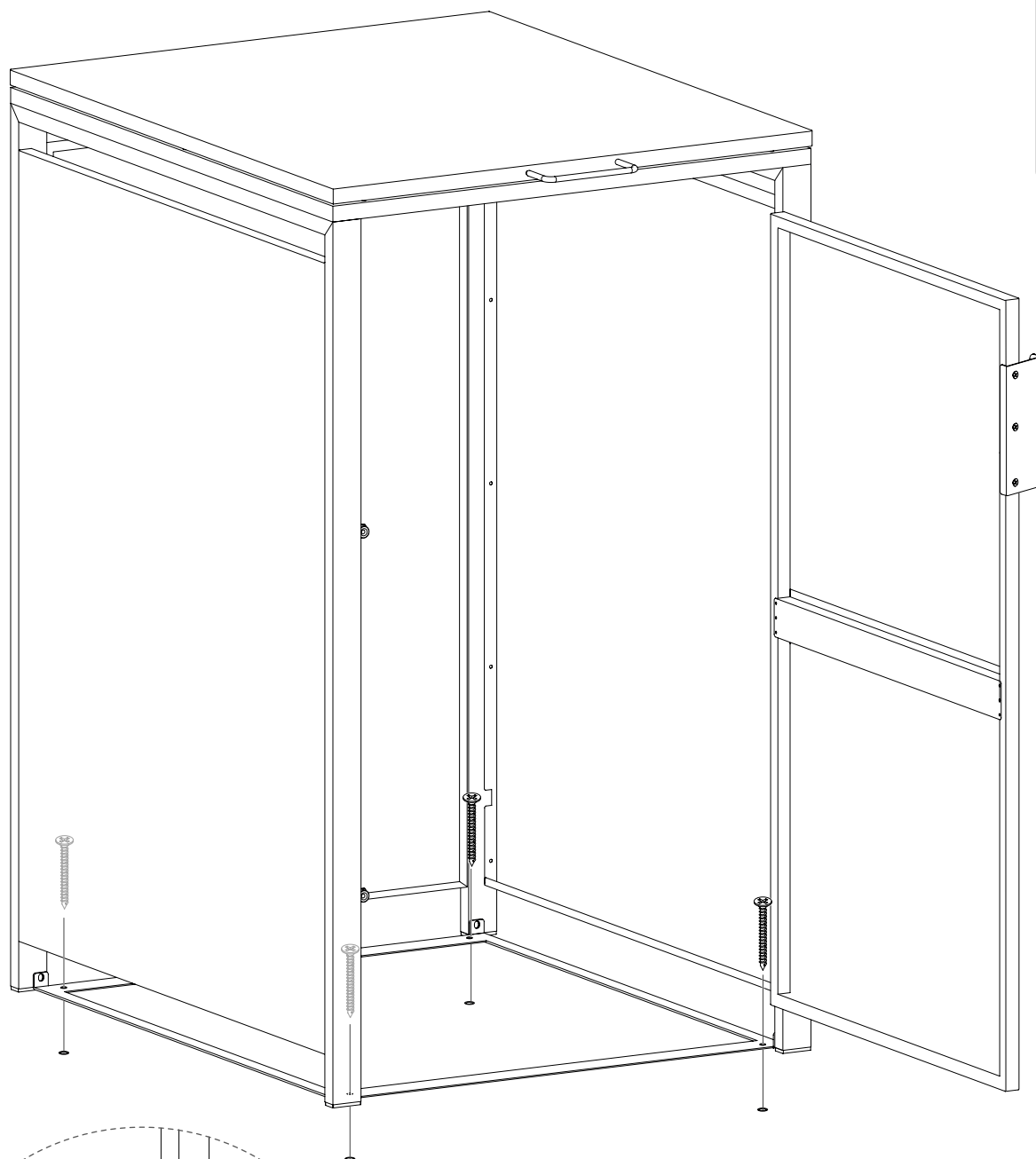
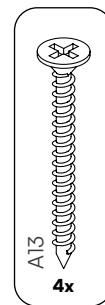

STEELSON

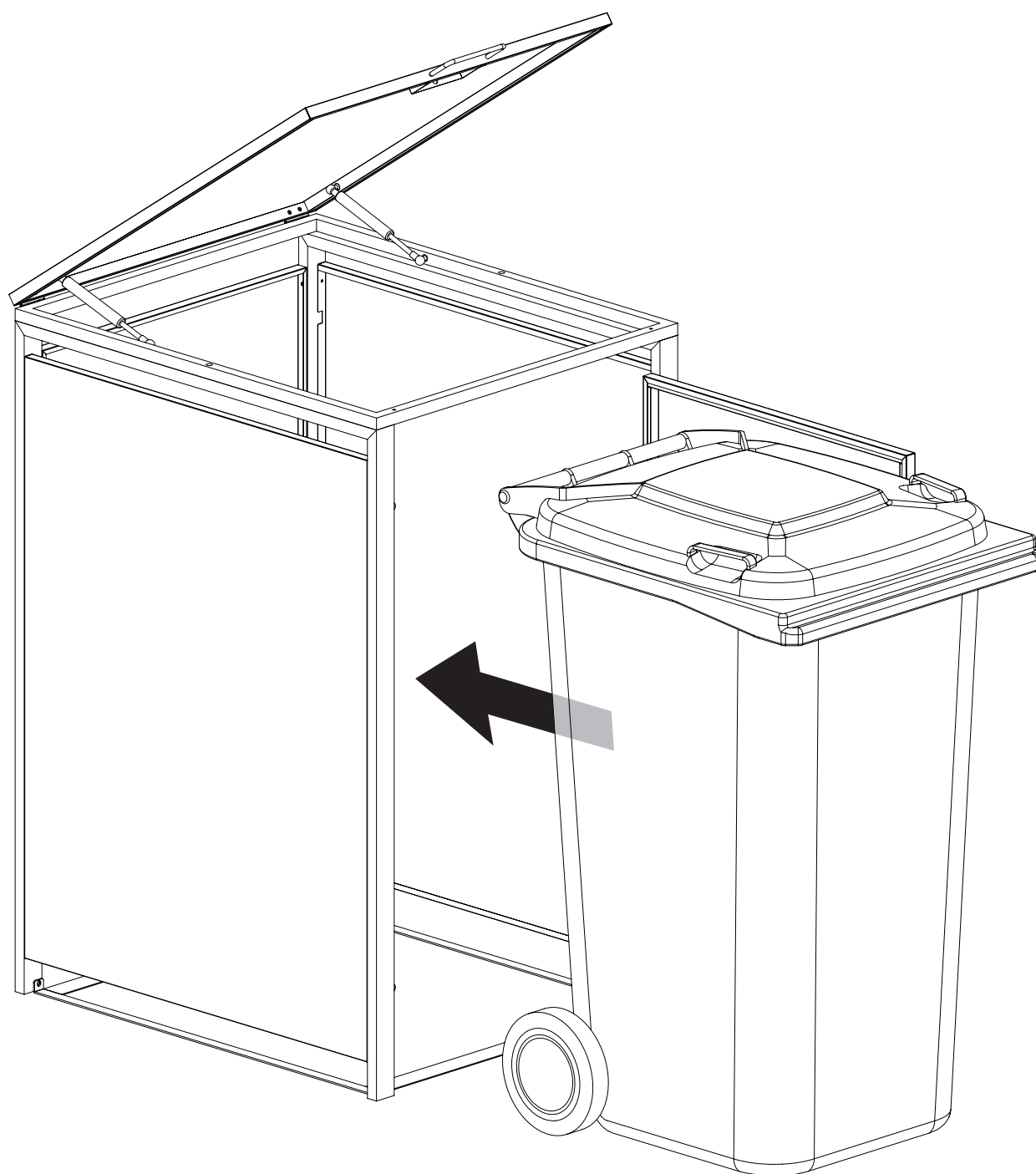

14

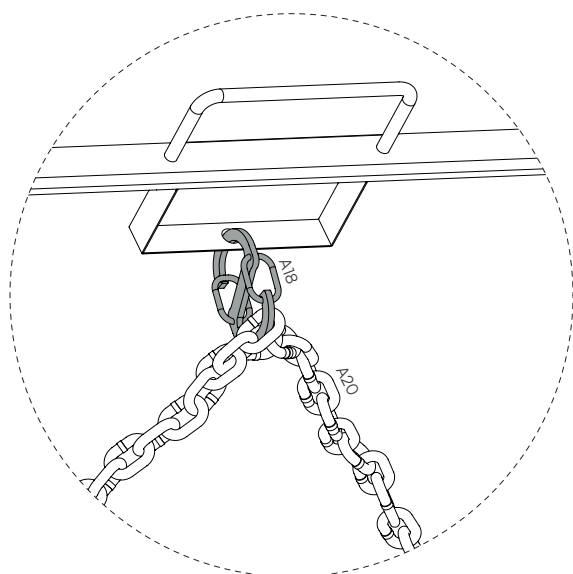
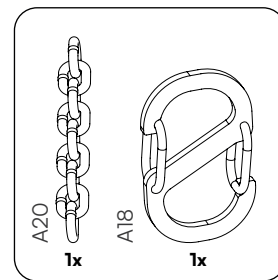
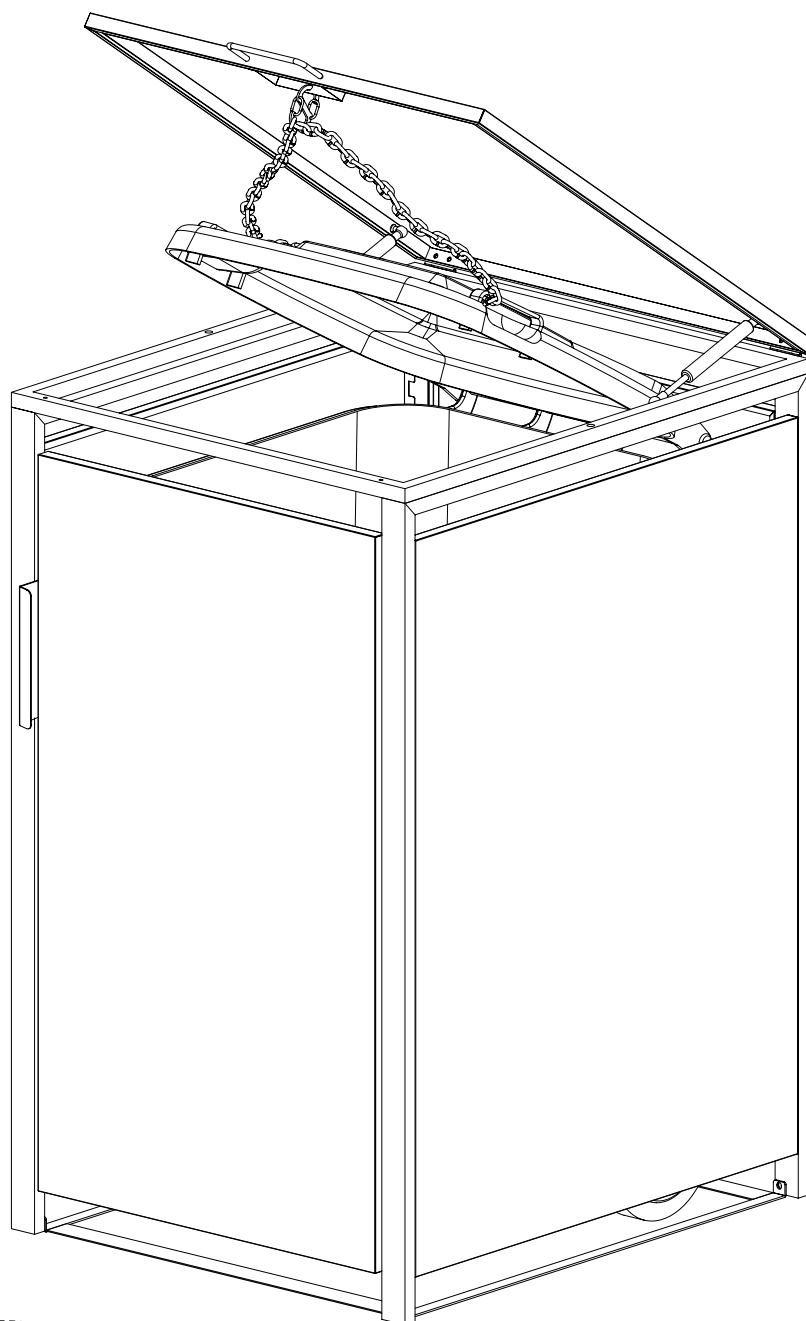

Geschafft!



STEELSON

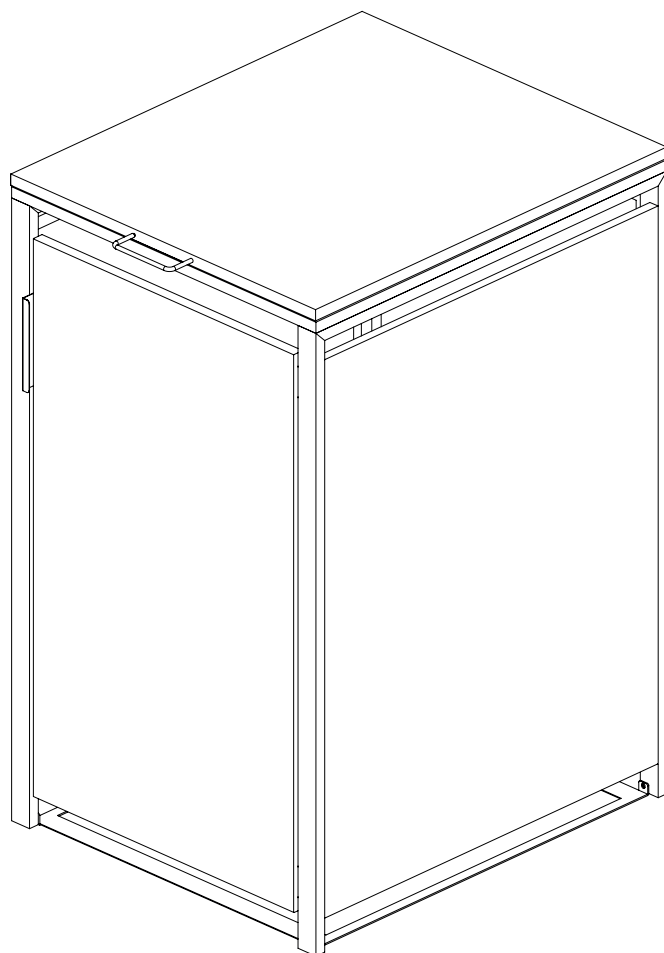

Fragen?

Wir sind für Dich da!

Scanne den QR-Code oder schreib uns an service@bela-living.de.
Gemeinsam kriegen wir jedes Problem gelöst!

