

Bella
bing

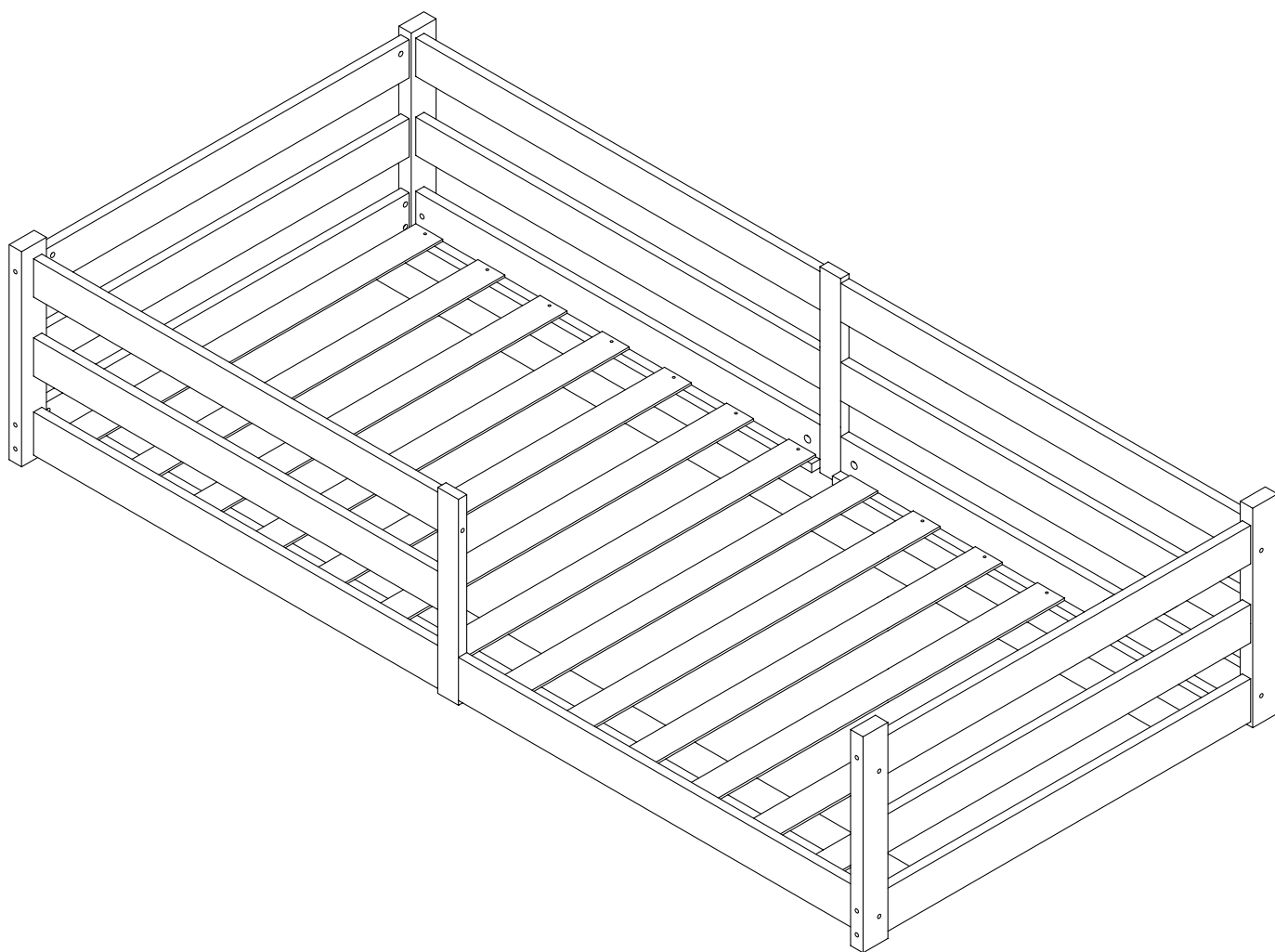

Bodenbett 'Iskri'

90 x 200 cm

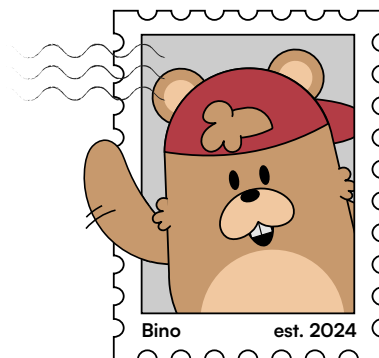
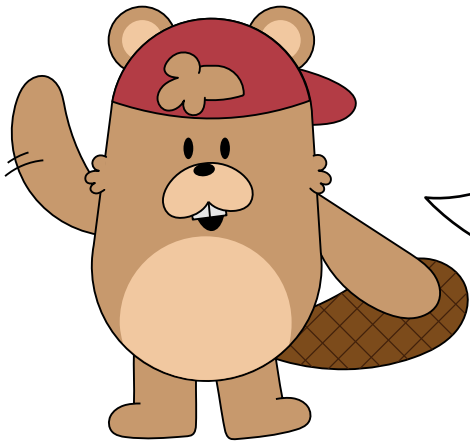

Hey,

ich freue mich, dass Du Dich für mein Produkt entschieden hast. Beachte die kommenden Hinweise, um den Aufbau problemlos zu gestalten.

Viel Spaß mit Deinem Produkt!

50%

weniger Fehler beim Aufbau durch
sorgfältiges Lesen der Anleitung

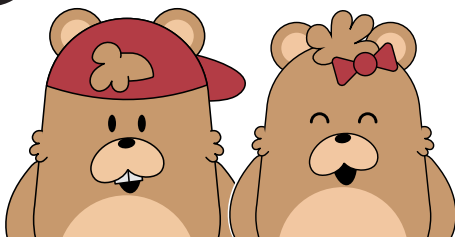
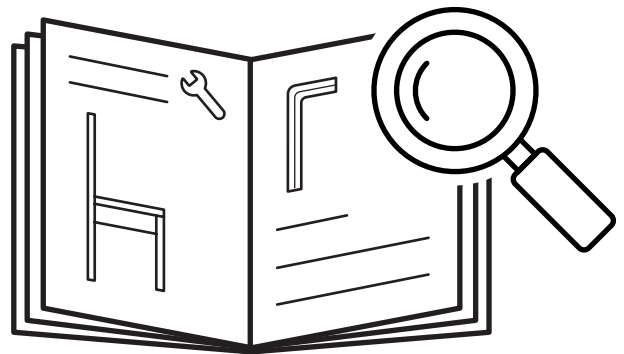

40-60

min

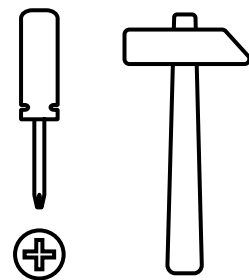

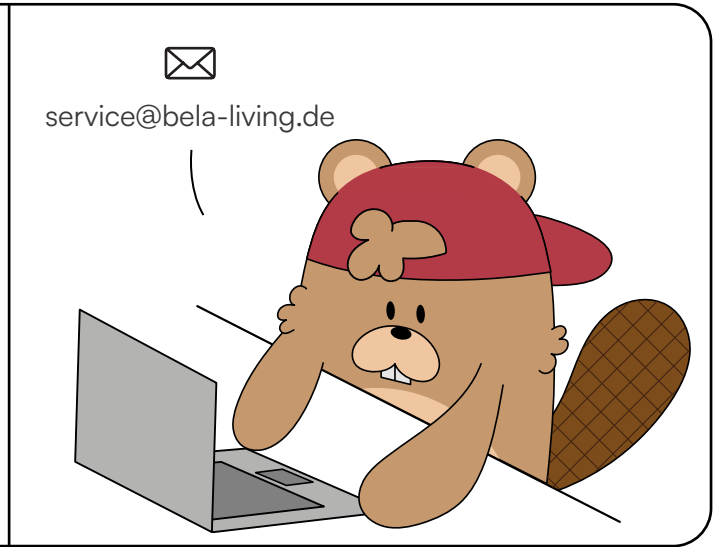
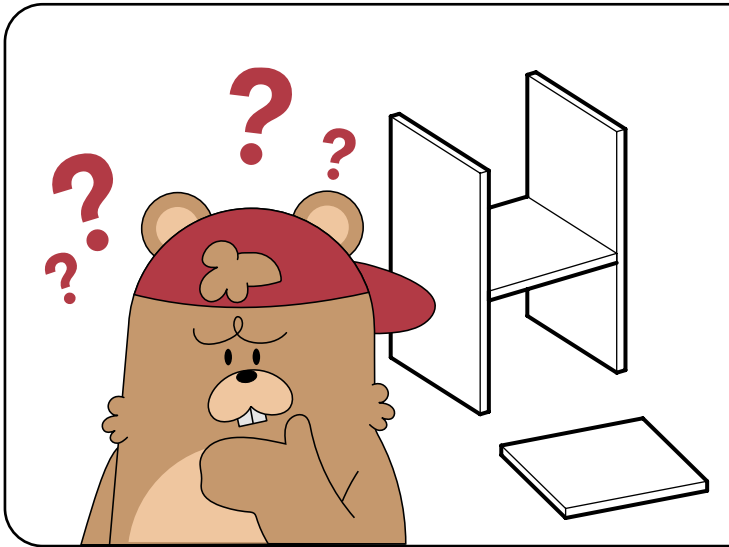
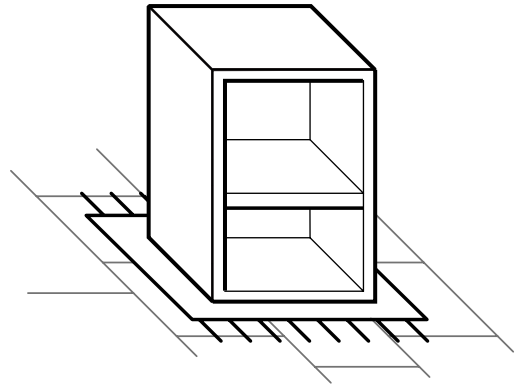
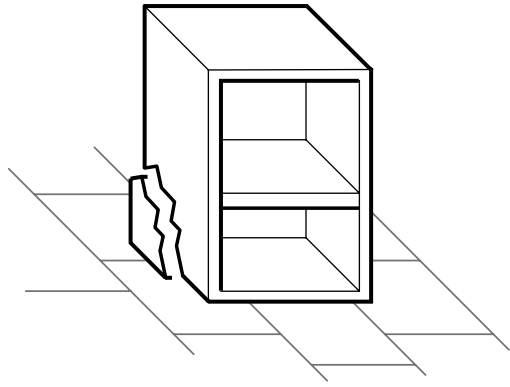

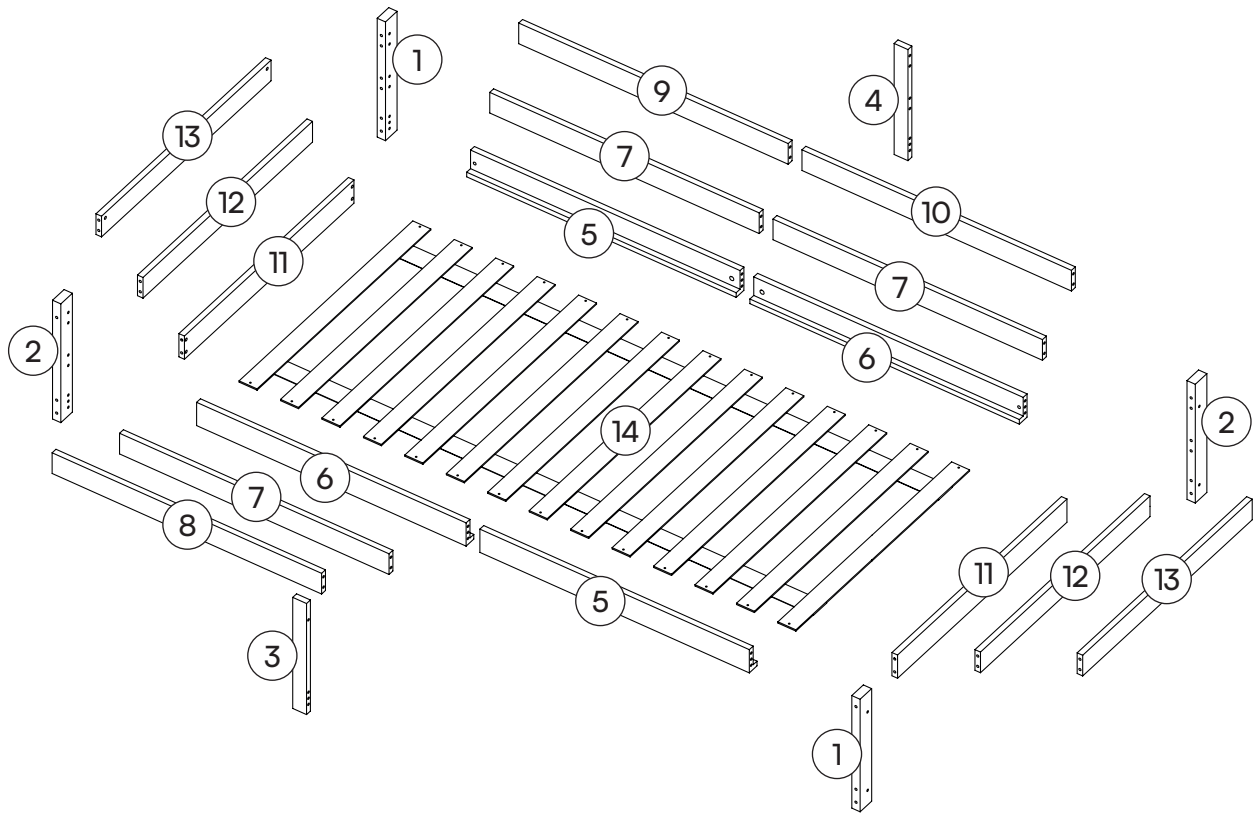



1 Äußere Stütze
2x

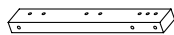

2 Äußere Stütze
2x

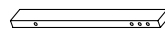

3 Vordere Zwischenstrebe



4 Hintere Zwischenstrebe

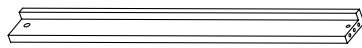

5 Bodenleiste
2x

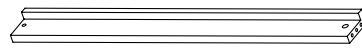

6 Bodenleiste
2x



7 Mittelleiste
3x



8 Obere Leiste



9 Obere Leiste

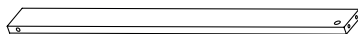

10 Obere Leiste

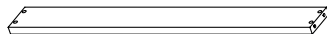

11 Untere Seitenstrebe
2x

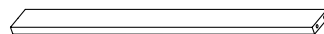

12 Mittlere Seitenstrebe
2x

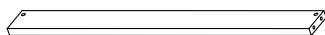

13 Obere Seitenstrebe
2x

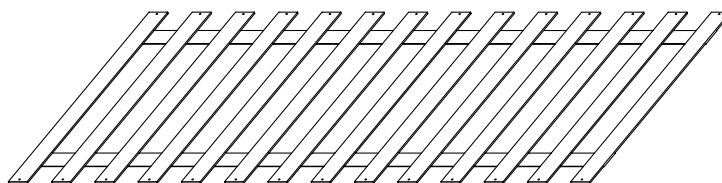

14 Lattenrost

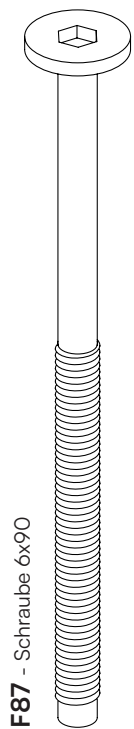

F87 - Schraube 6x90

13x

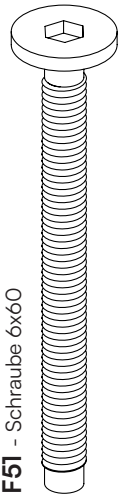

F51 - Schraube 6x60

7x



C30 - Einschraubdübel 6.5x40

6x

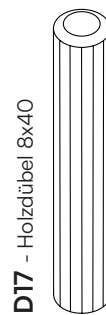

D17 - Holzdübel 8x40

46x



W44 - Kreuzschraube 4x30

28x

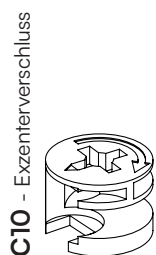

C10 - Exzenterverschluss

6x

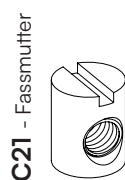

C21 - Fassmutter

20x

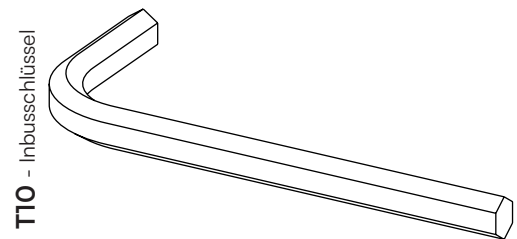

T10 - Inbusschlüssel

1x

Ein letzter Check:

Bitte überprüfe, ob Du alle Teile hast.

Viel Spaß beim Aufbau!

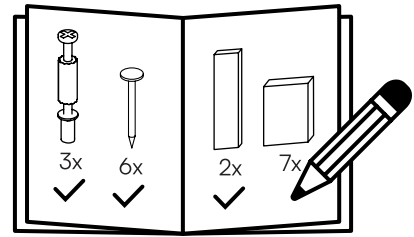

1 **2x**

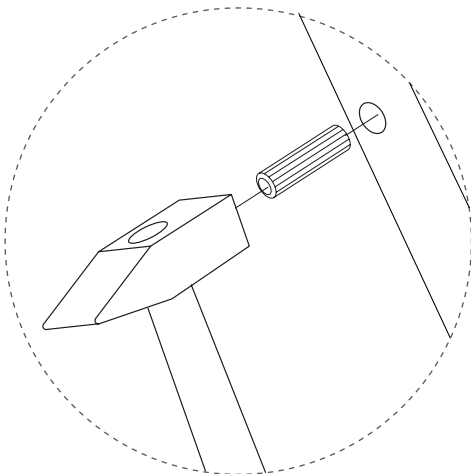
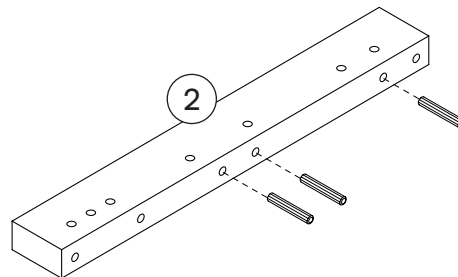
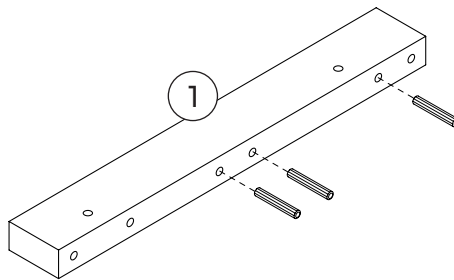
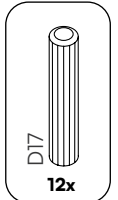

2 

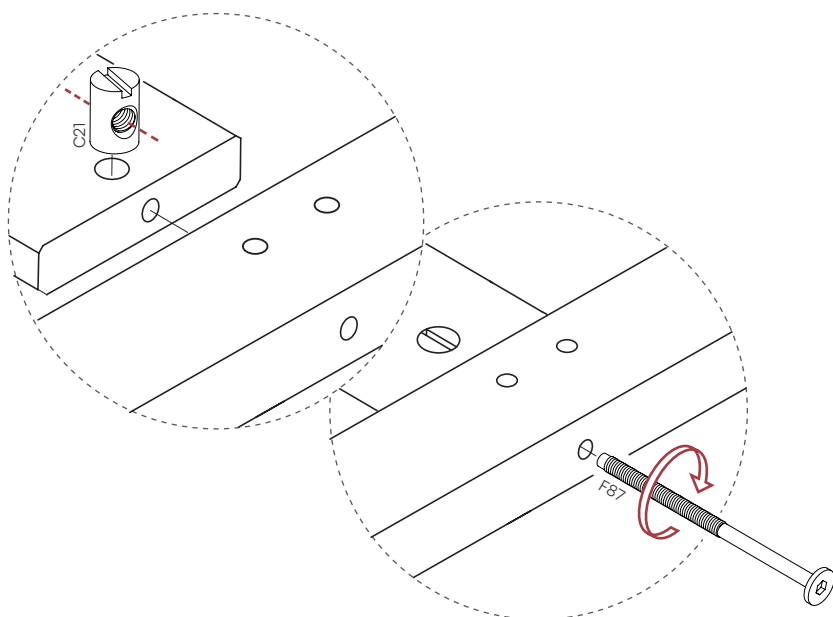
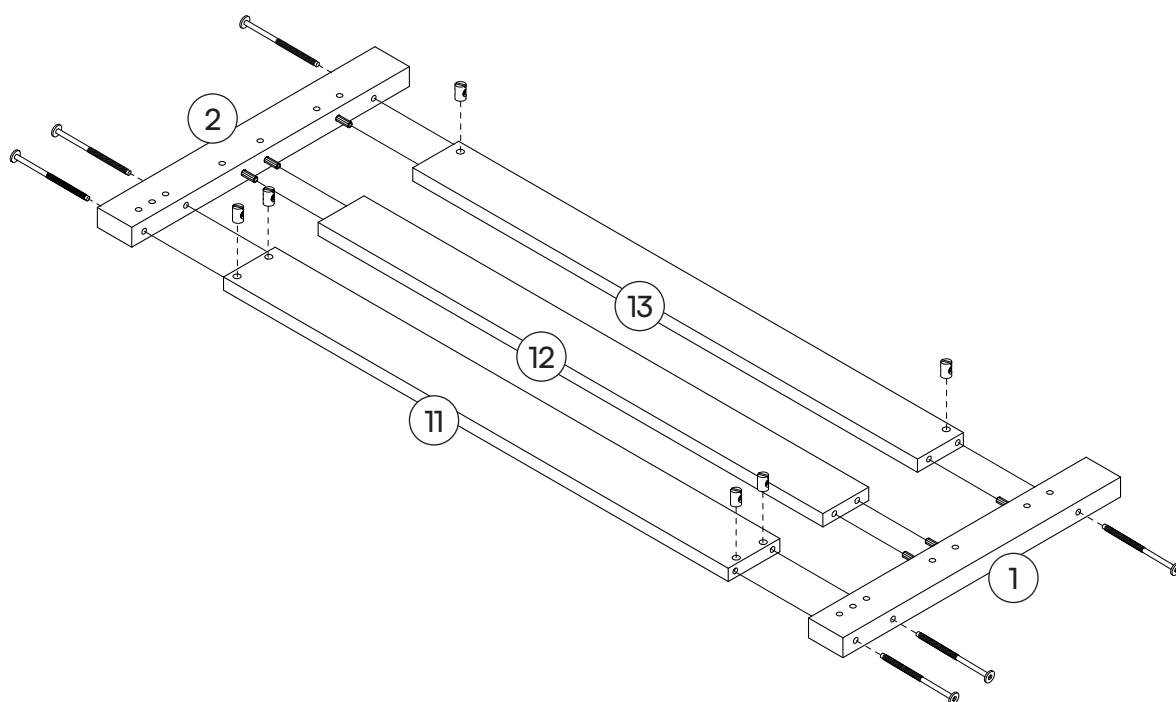
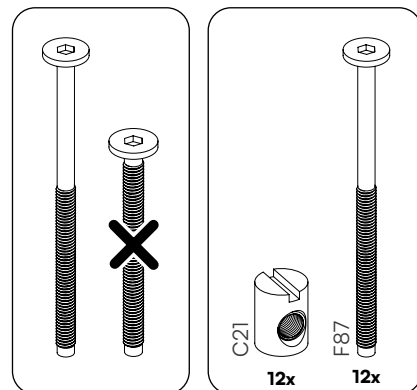

3

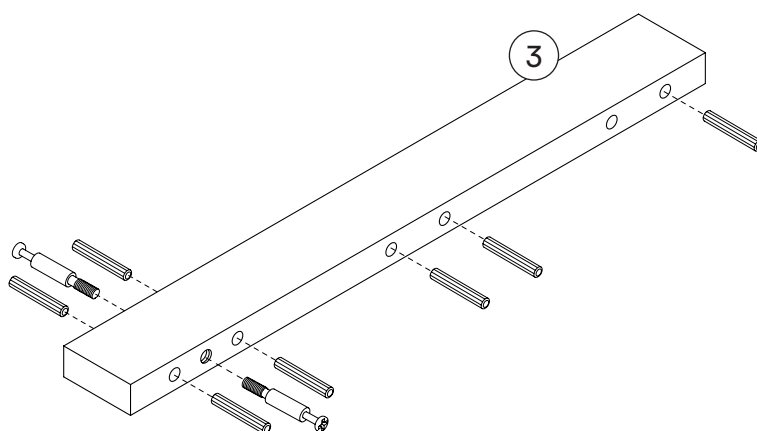
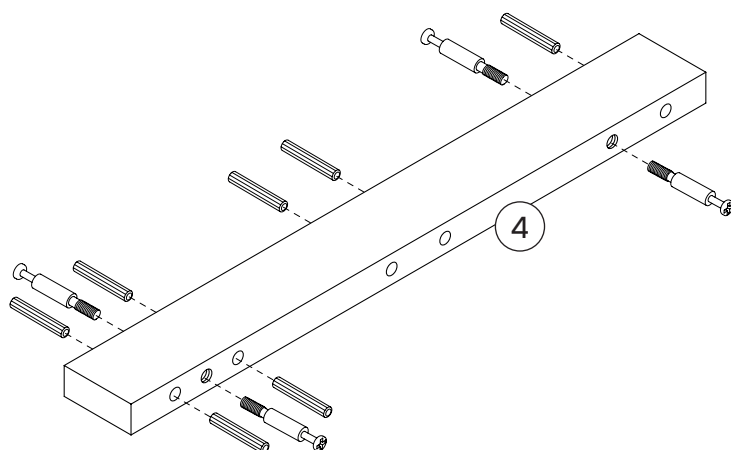
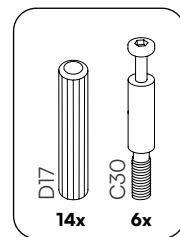

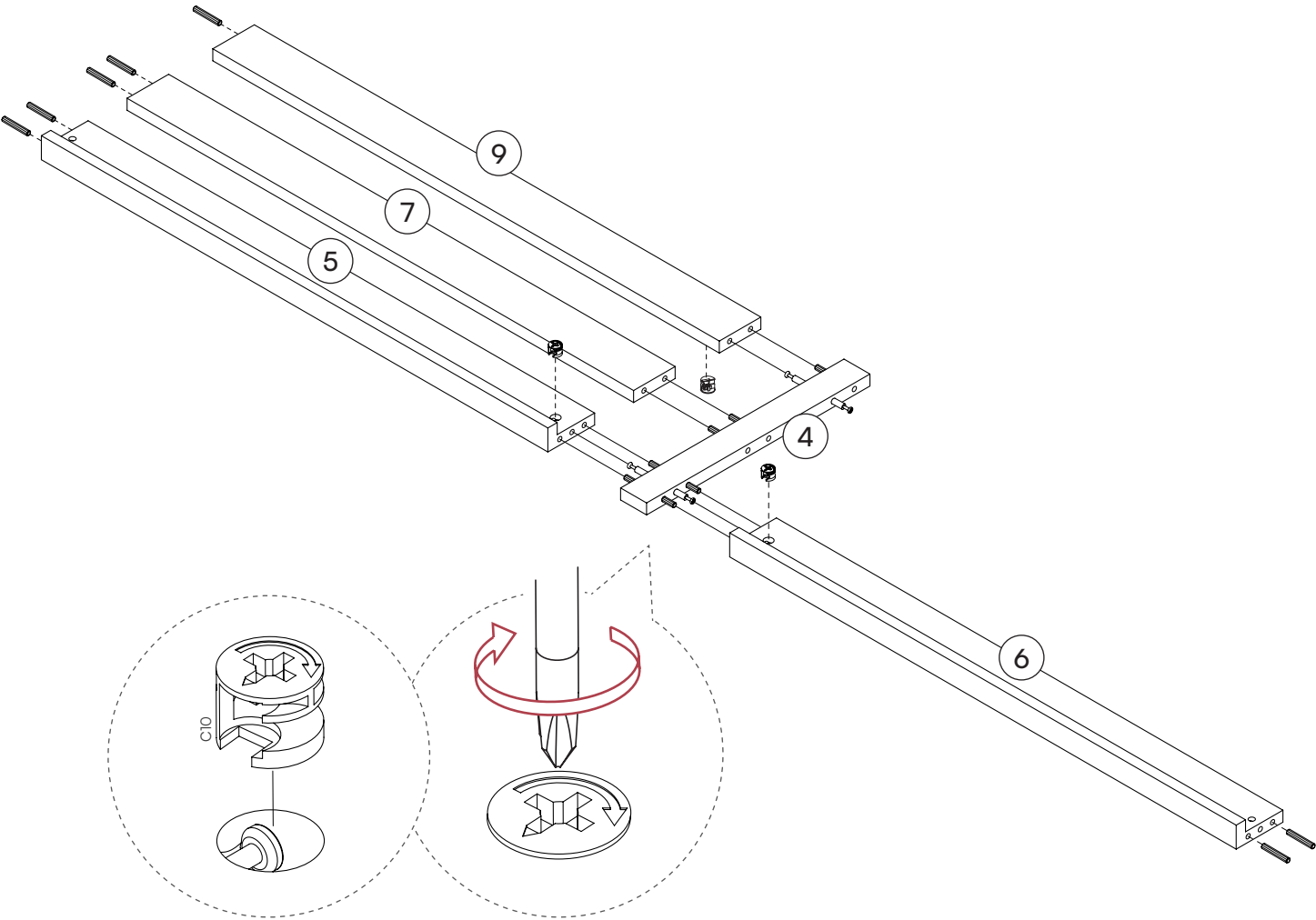
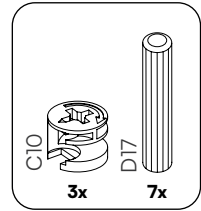

5

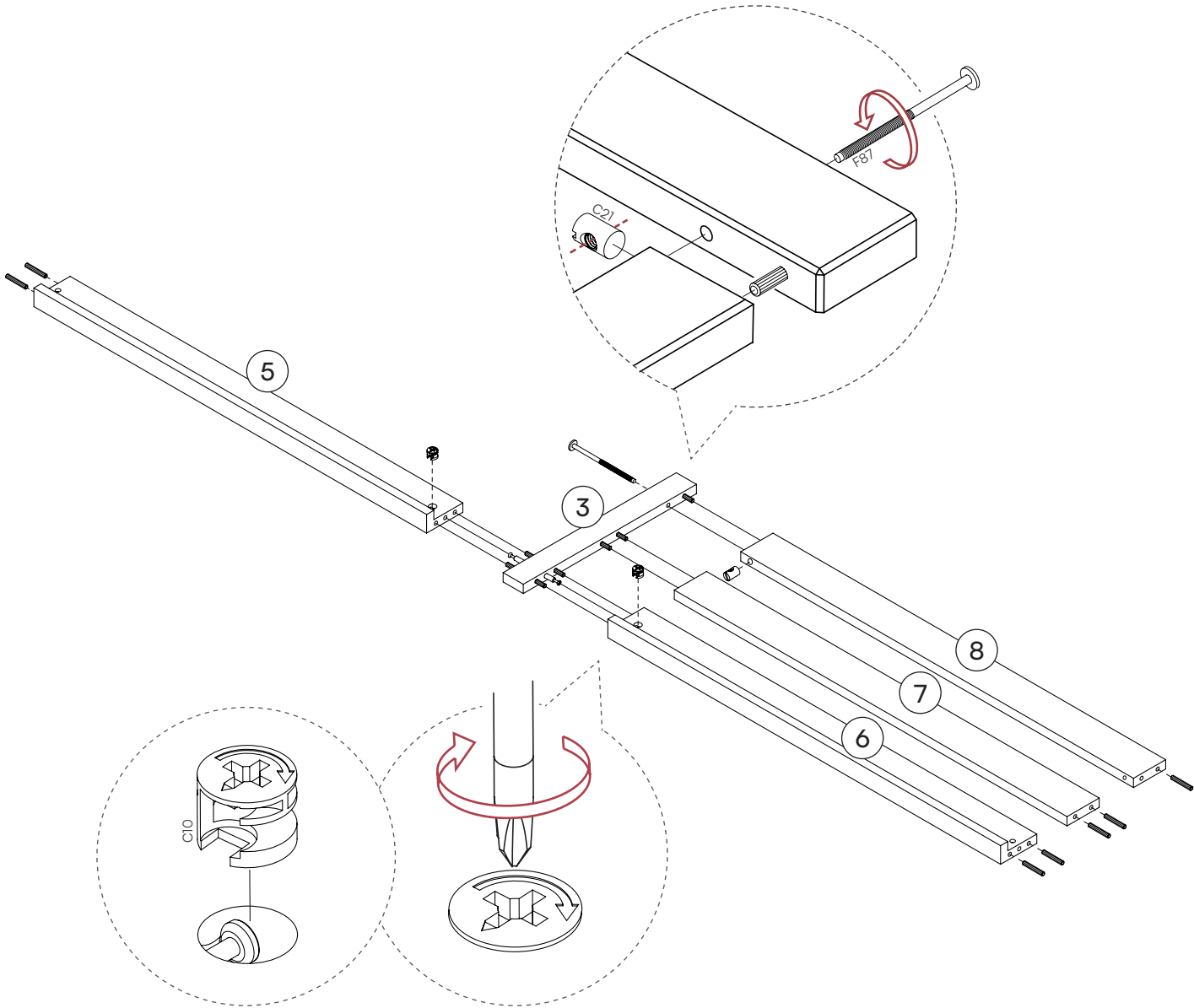
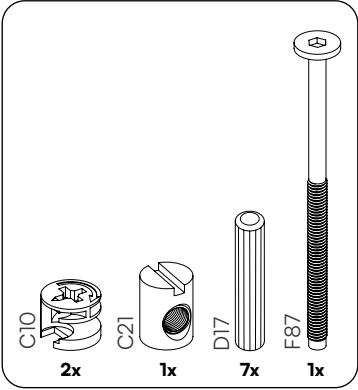

6

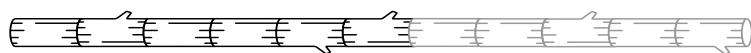
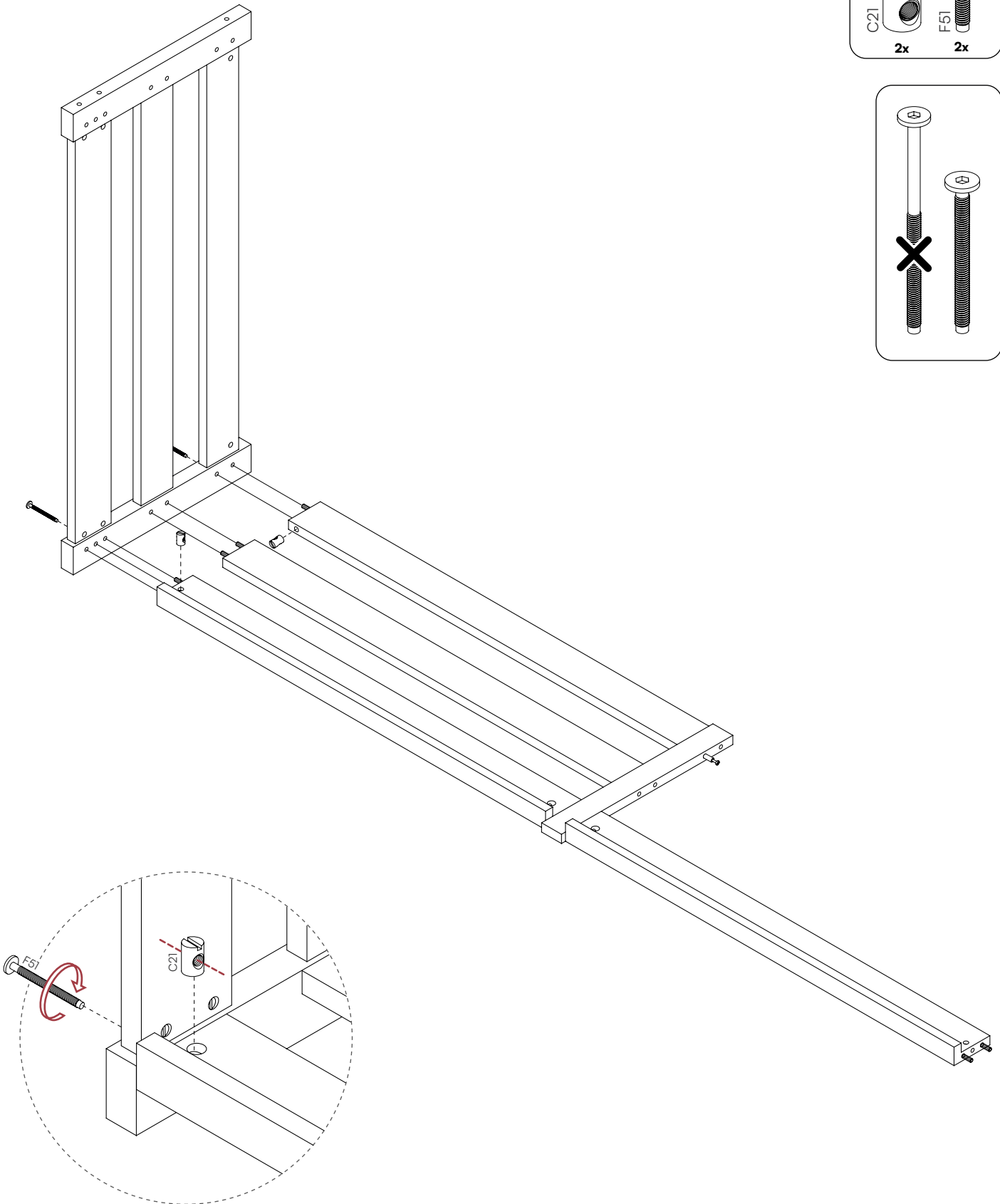
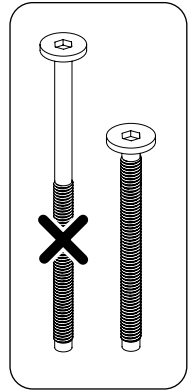
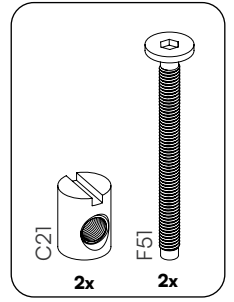

7

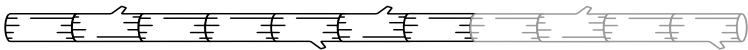
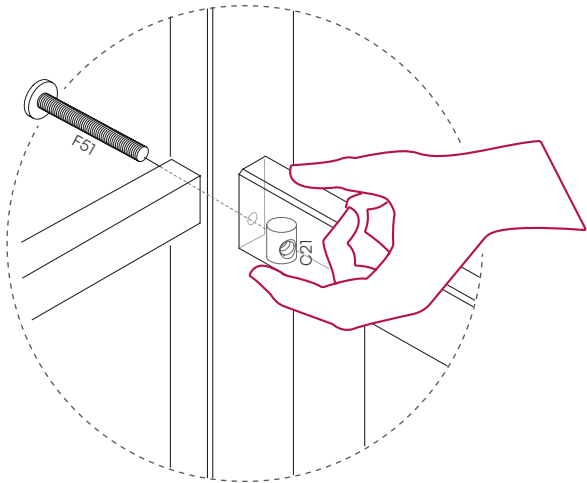
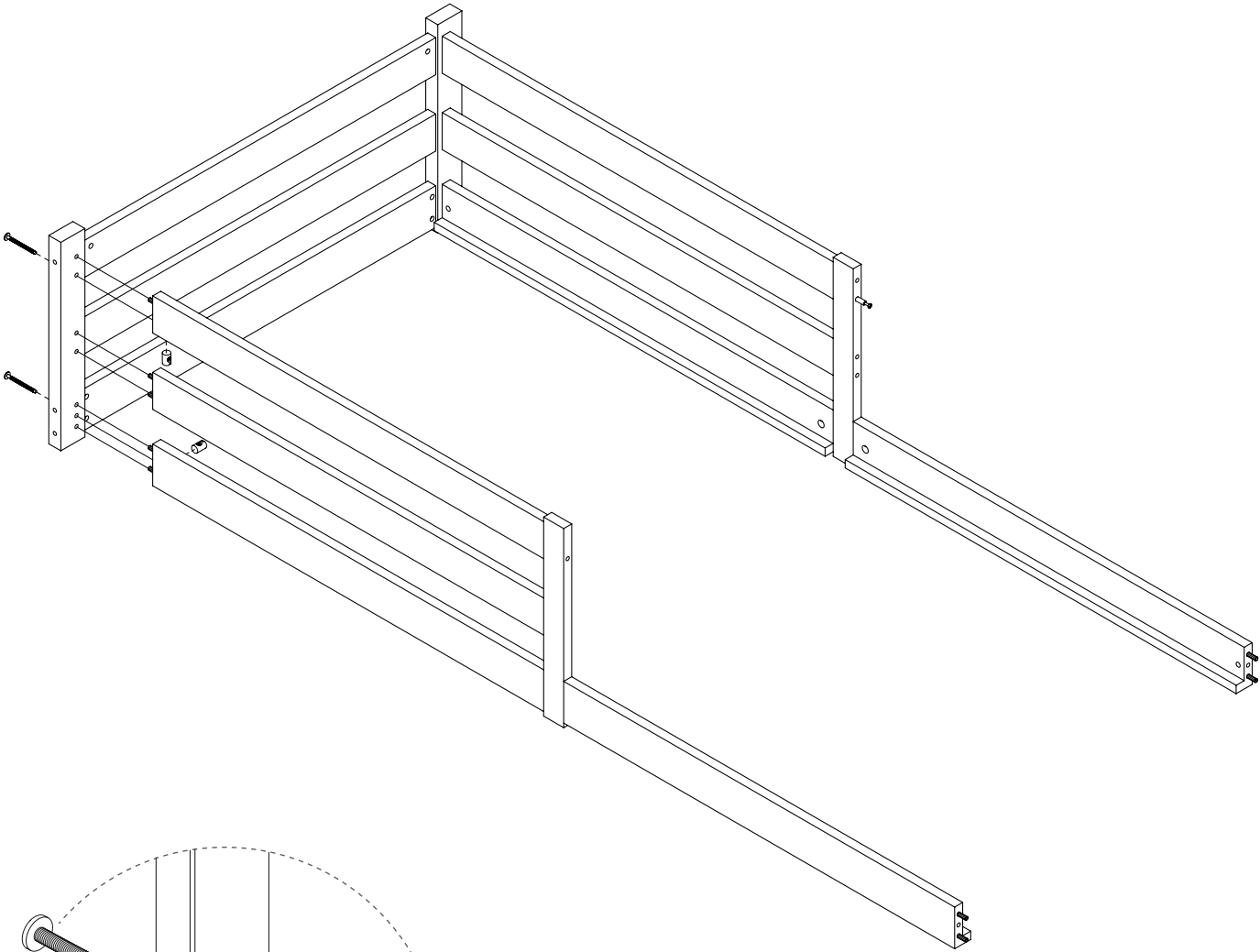
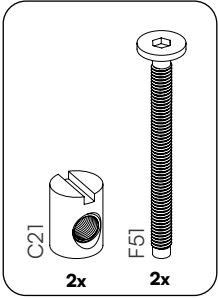

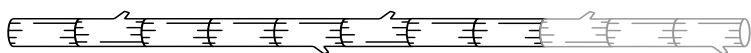
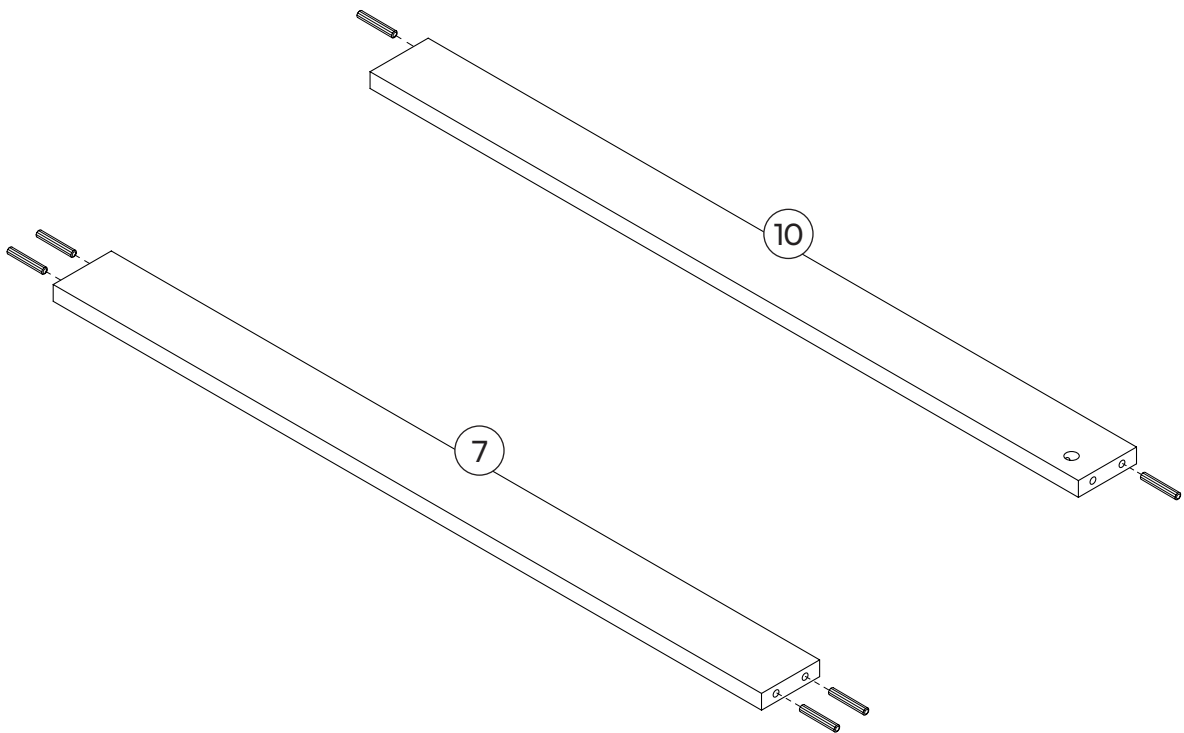
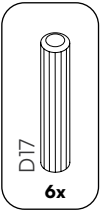

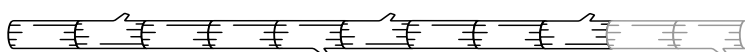
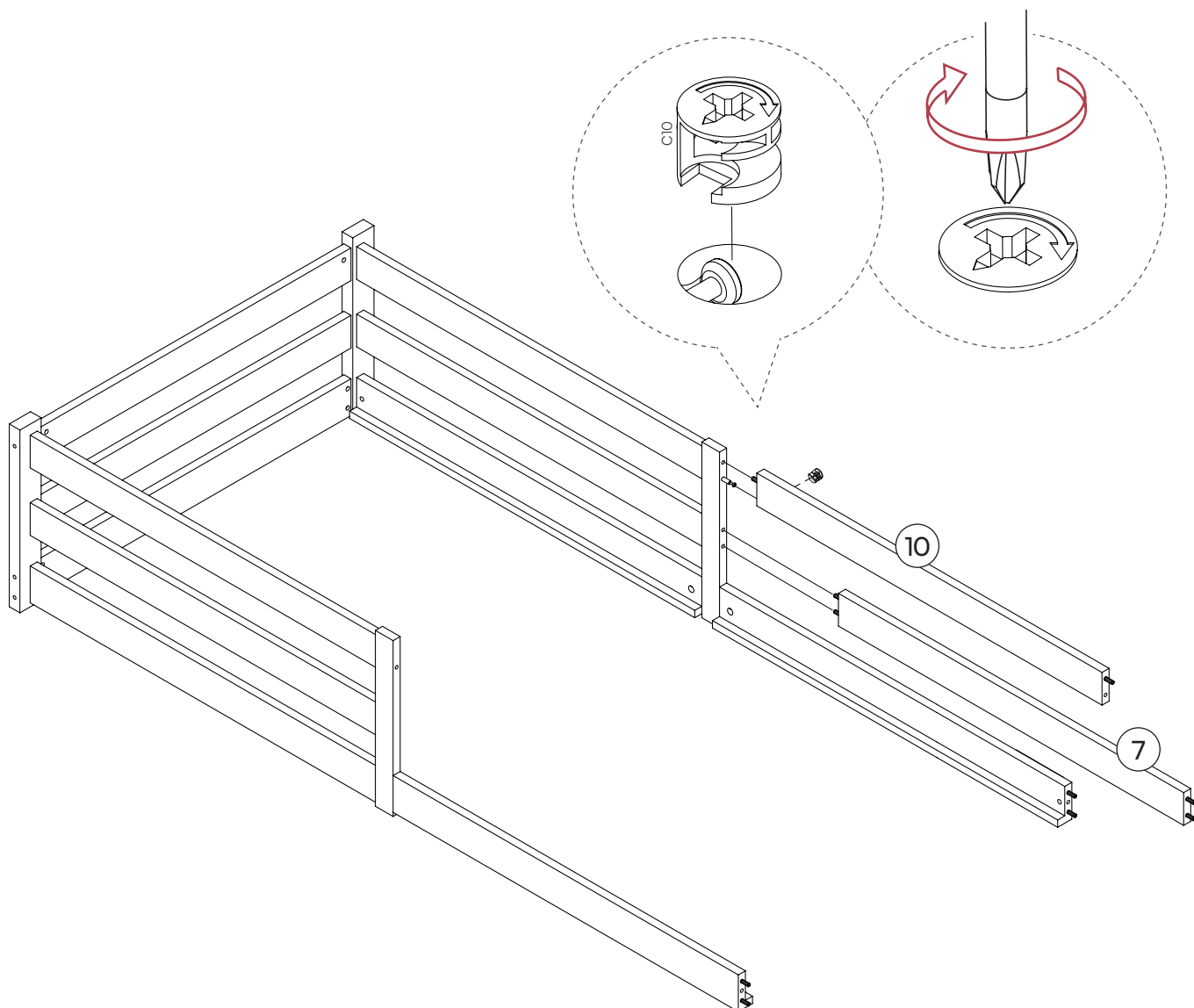
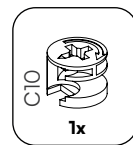

10

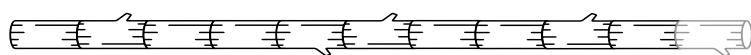
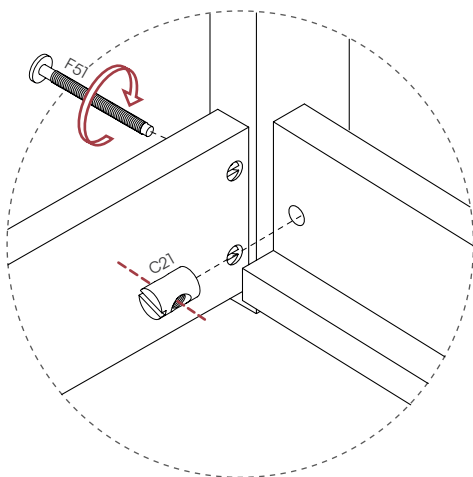
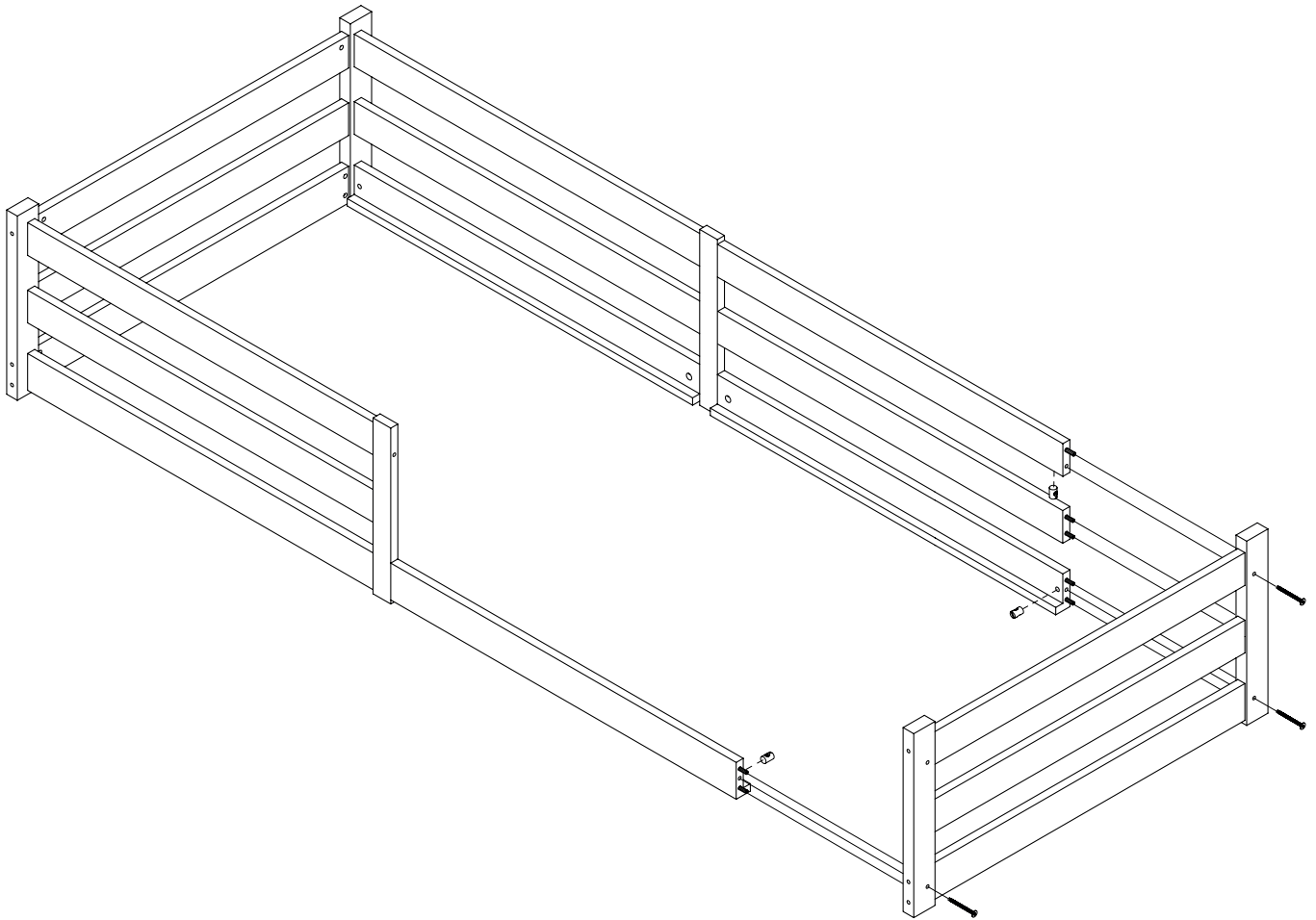
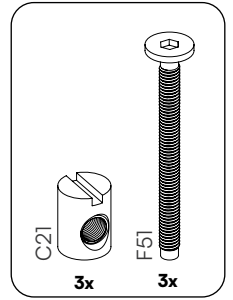

11

