

STEELSØN

Mülltonnenbox „Thoria“

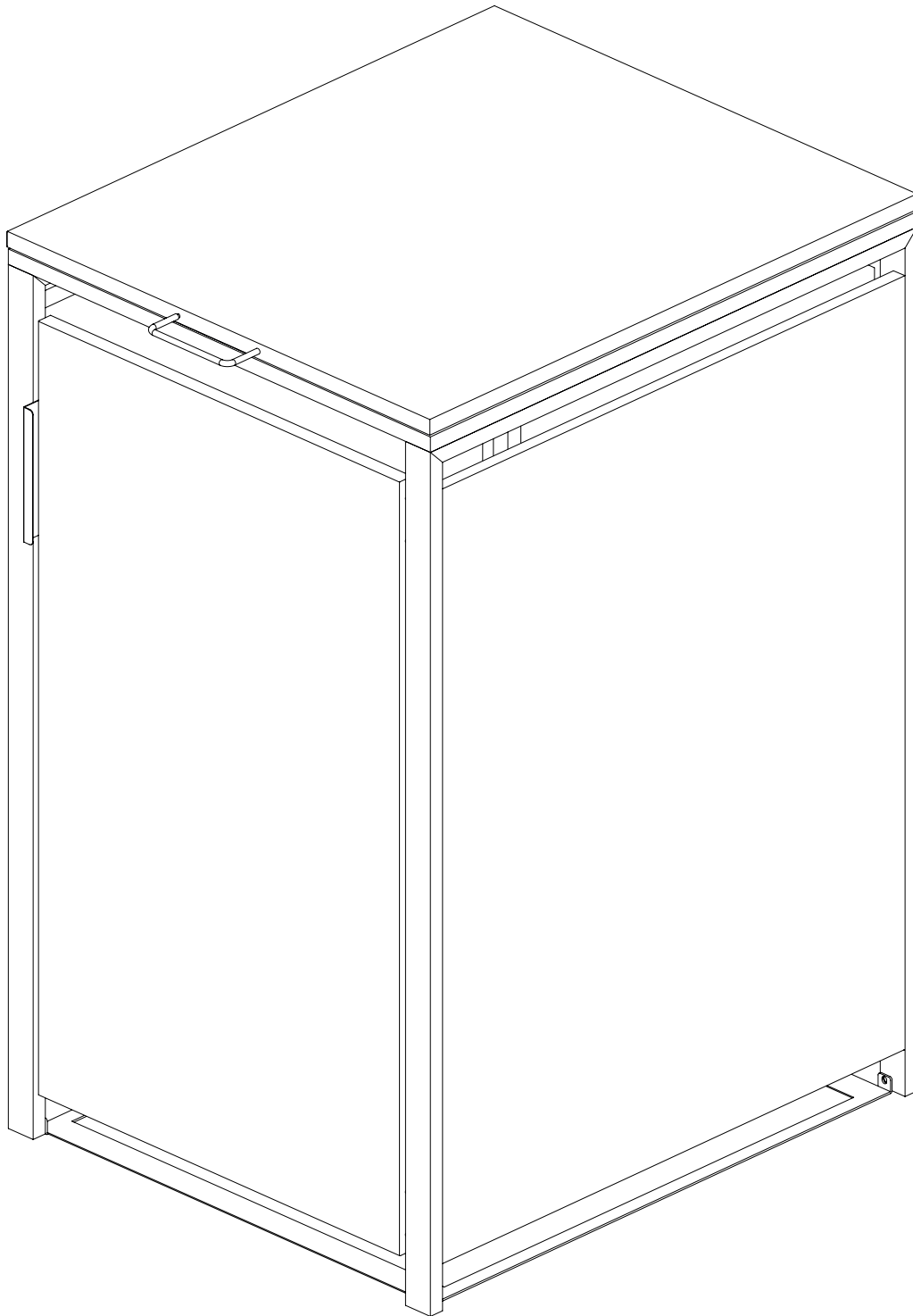



Hey,

wir freuen uns, dass Du Dich für unser Produkt entschieden hast. Beachte die kommenden Hinweise, um den Aufbau problemlos zu gestalten.

Viel Spaß mit Deinem Produkt!

50%

weniger Fehler beim Aufbau durch
sorgfältiges Lesen der Anleitung

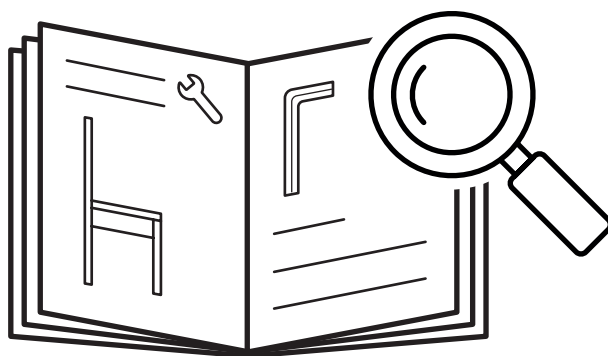

optional

60-90

min

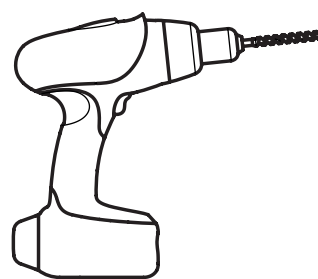

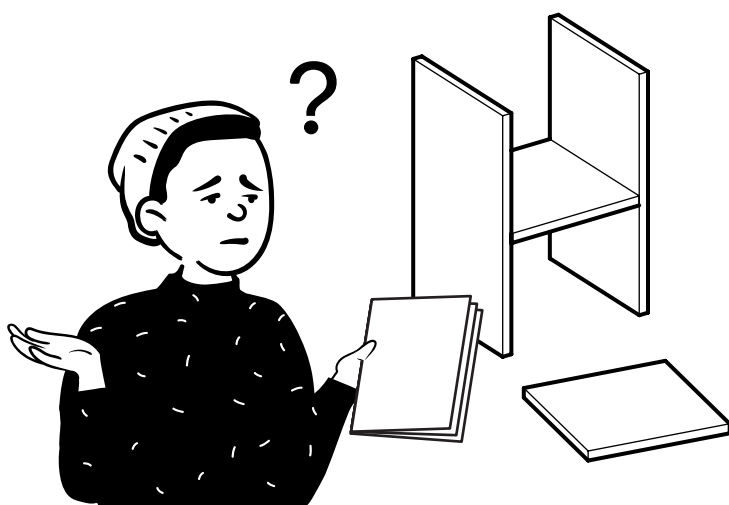
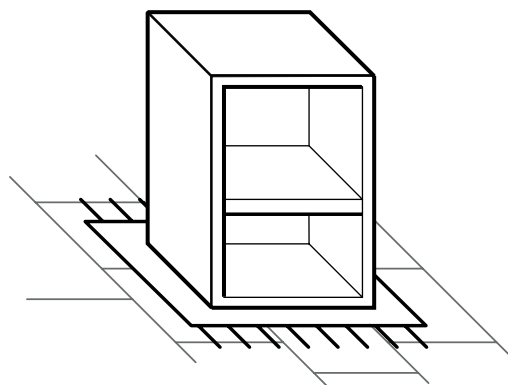
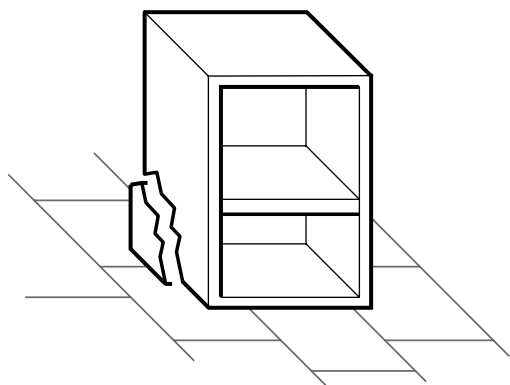

1.

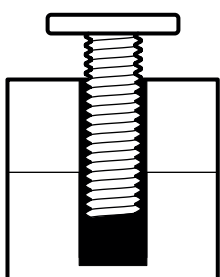

Ziehe die Schrauben während
des gesamten Aufbaus
zunächst per Hand an.

2.

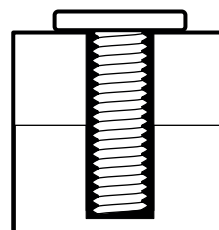

Justiere das Produkt final
und ziehe die Schrauben
vollständig an.

G24 - Kreuzschraube

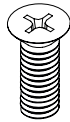

24x

G25 - Kreuzschraube

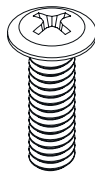

4x

G26 - Inbusschraube

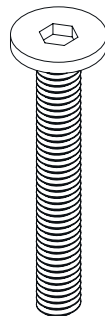

6x

G27 - Kreuzschraube

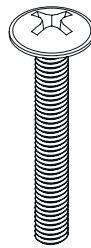

2x

A13 - Dübel und Schraube



4x

G28 - Kreuzschraube

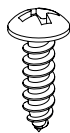

3x

A14 - Scharnier

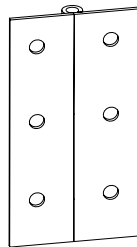

2x

A15 - Dämpfer

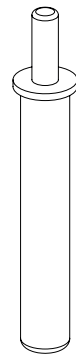

2x

A16 - Abdeckkappe

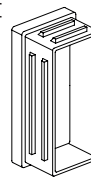

4x

A17 - Magnet

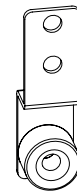

2x

A18 - Karabiner

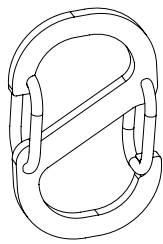

1x

A19 - Türgriff

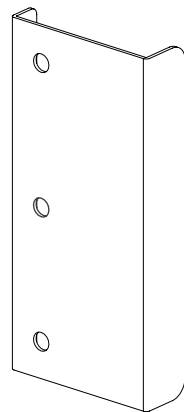

1x

A20 - Metallkette



1x

T10 - Inbusschlüssel

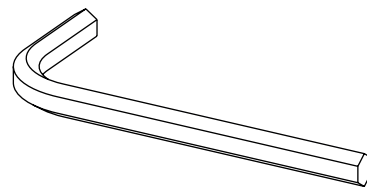

1x

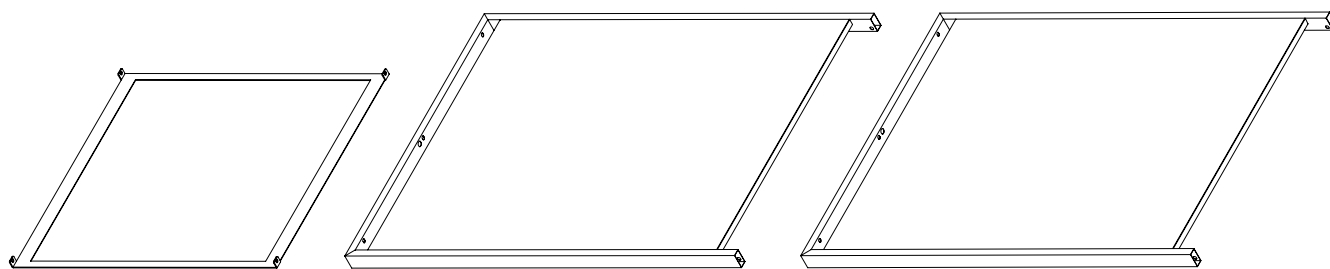

1 Unterer Rahmen
1x

2 Linke Seitenwand
1x

3 Rechte Seitenwand
1x

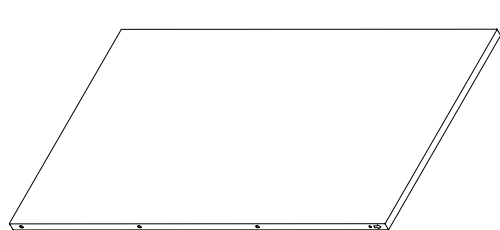

4 Rückwand
1x

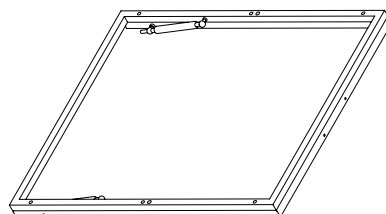

5 Deckel
1x

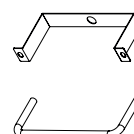

6 Griff
1x

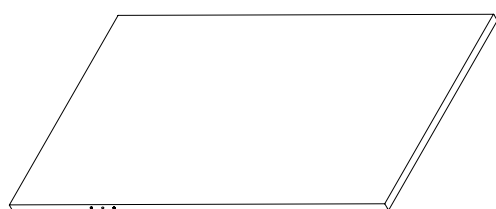

7 Tür
1x

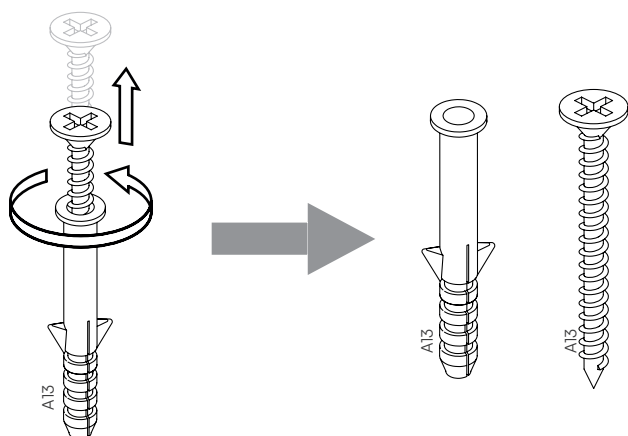

Ein letzter Check:

Bitte überprüfe, ob Du alle Teile hast.

Viel Spaß beim Aufbau!

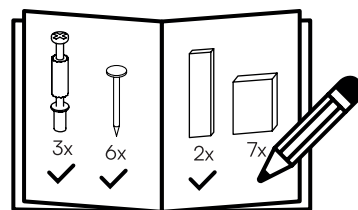

1

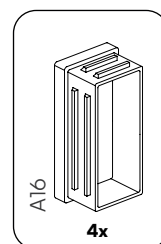
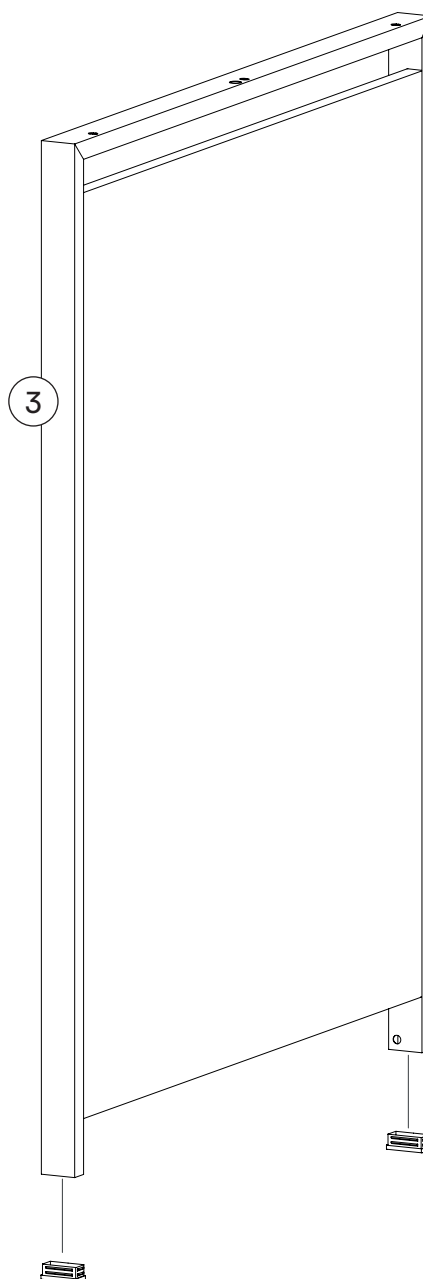
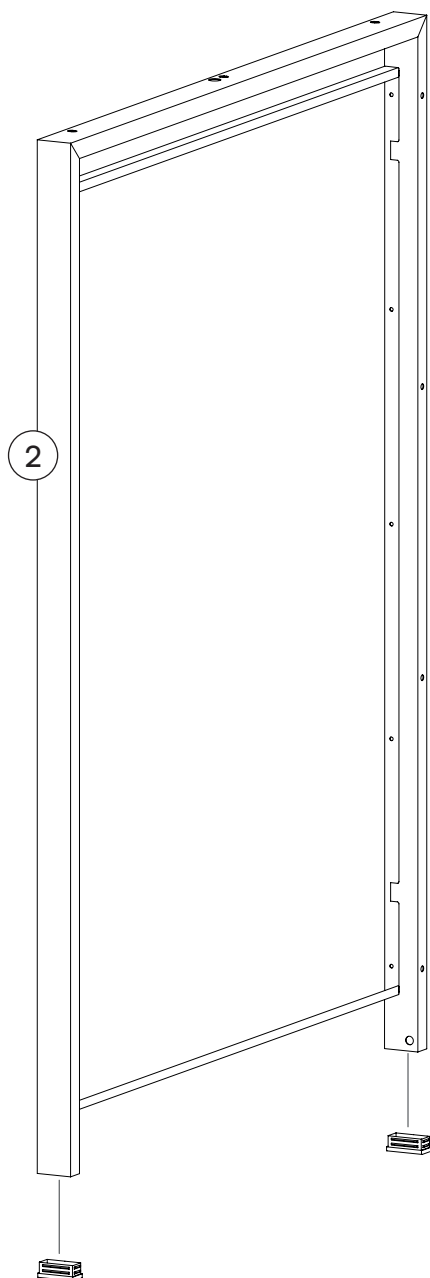

2

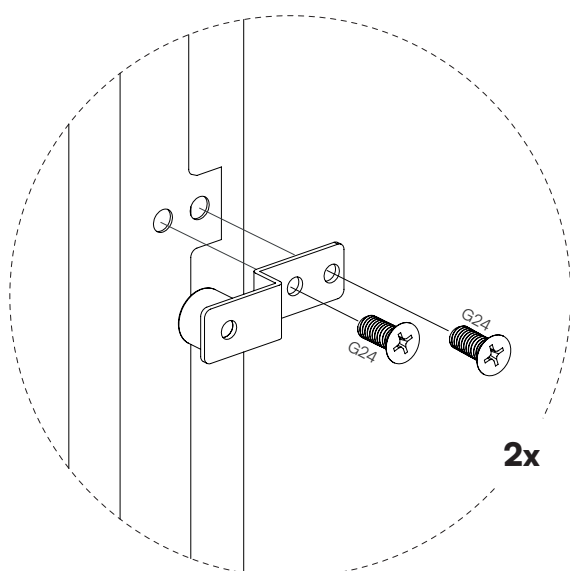
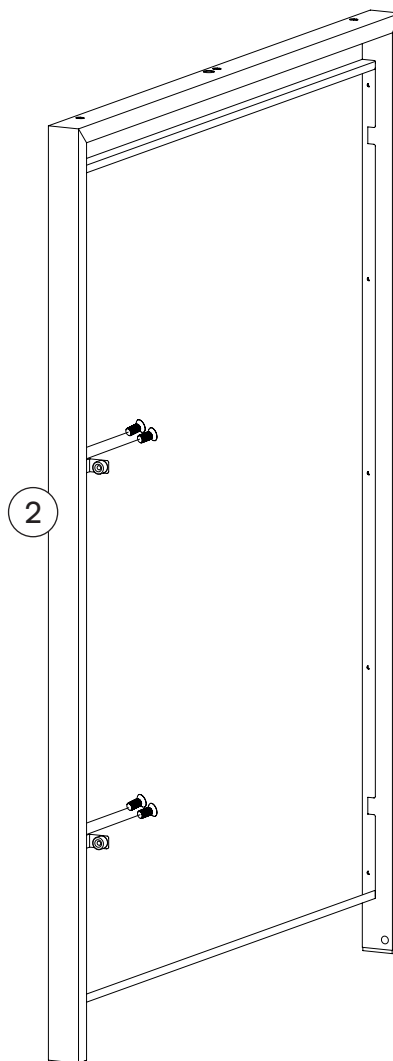
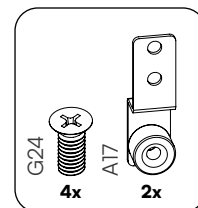

3

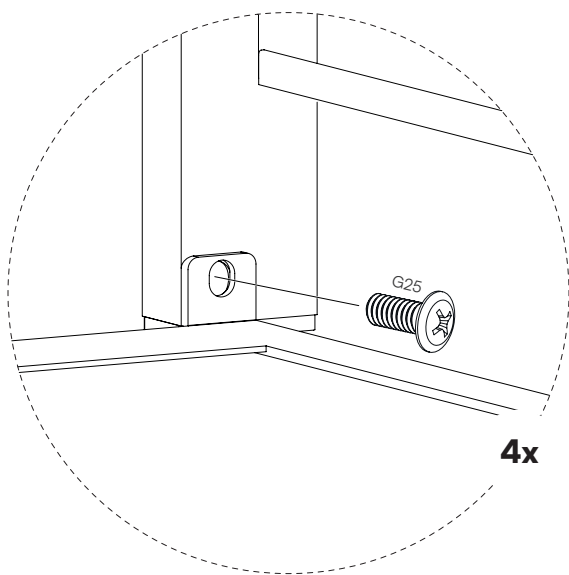
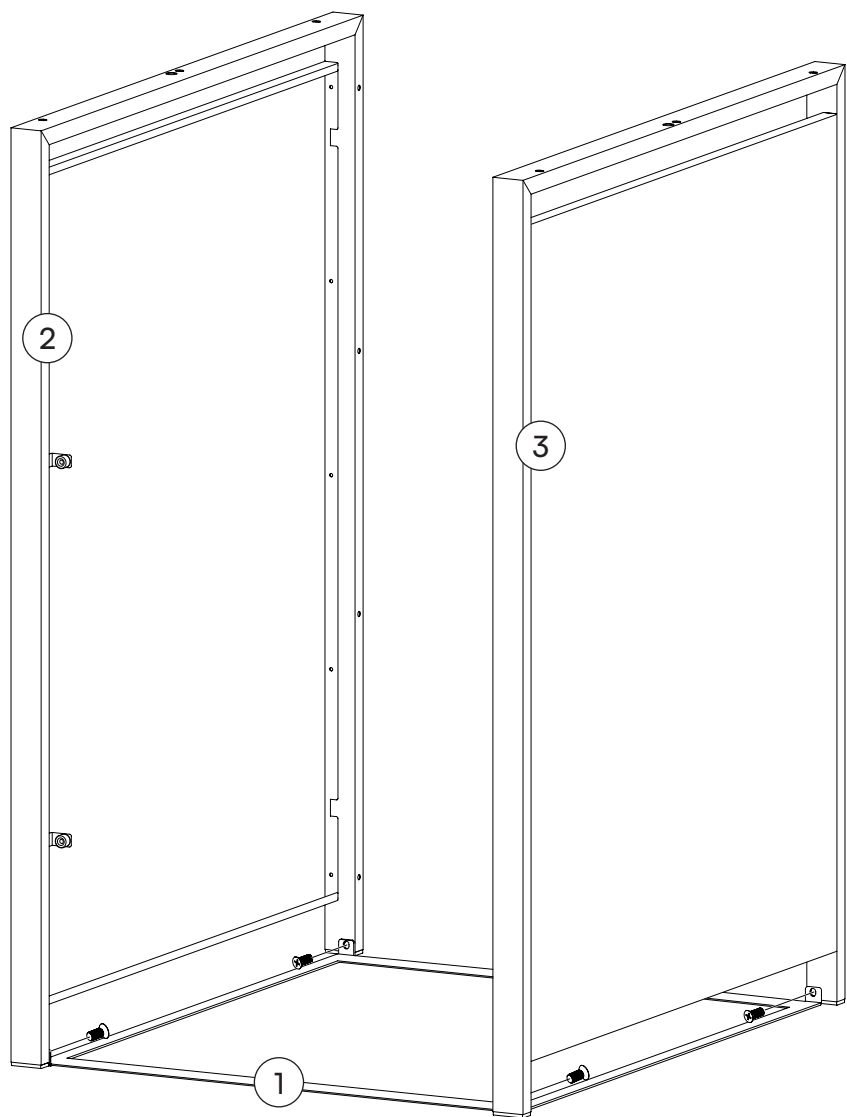

4

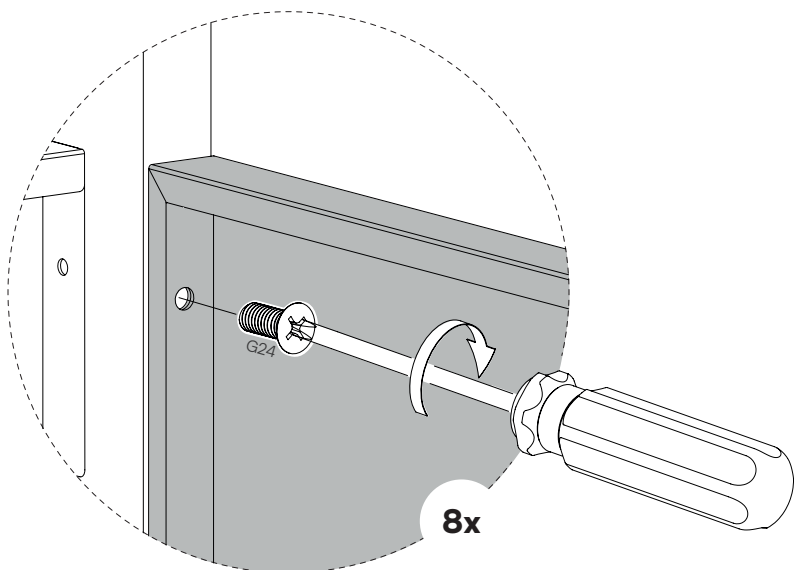
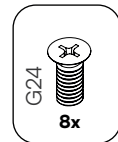
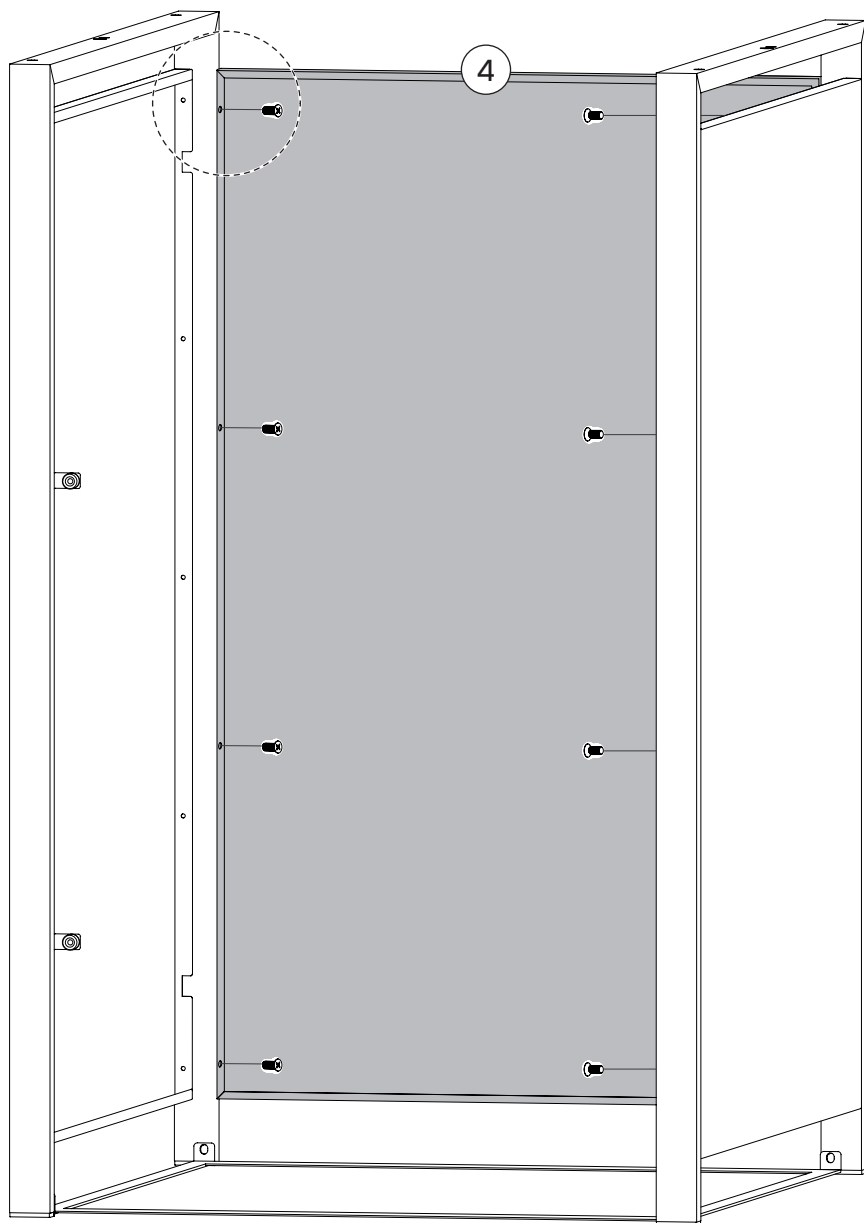

5

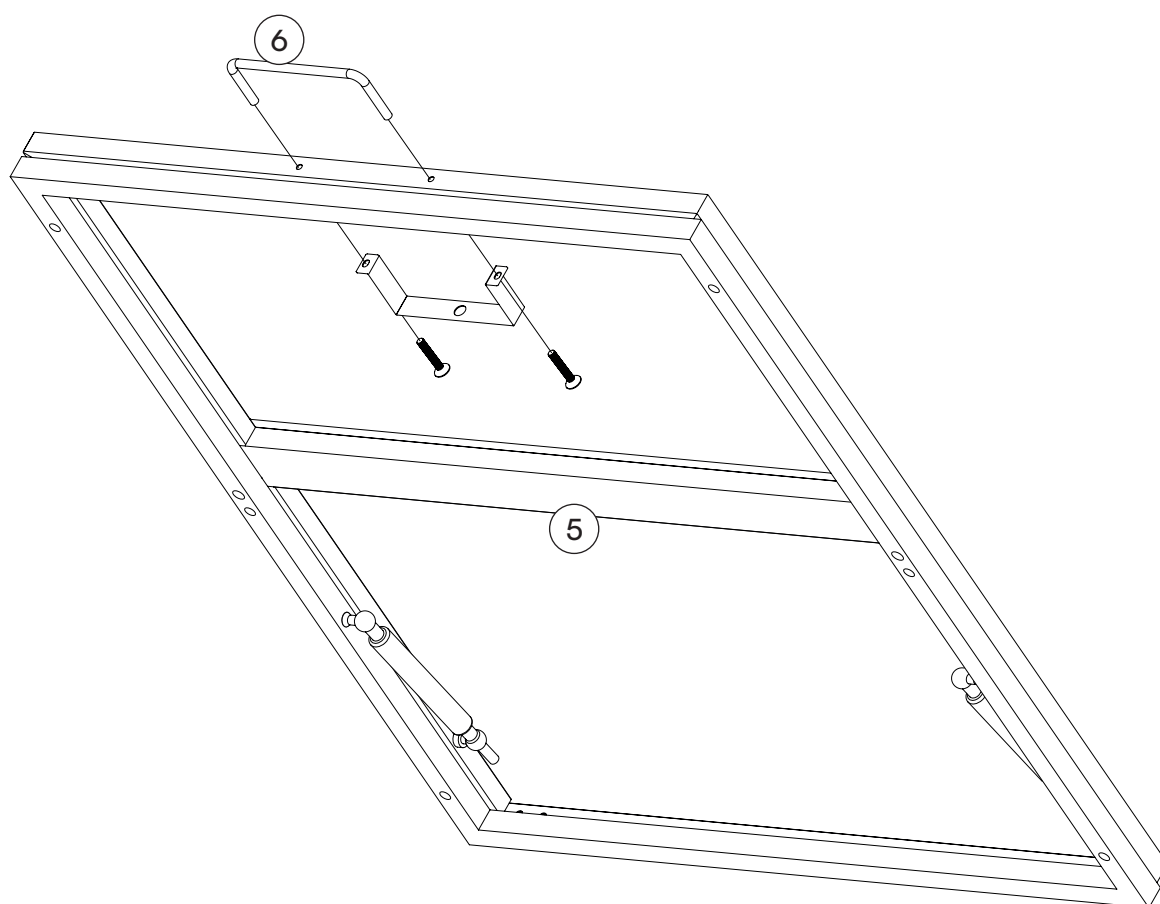
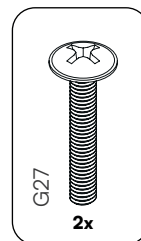

6

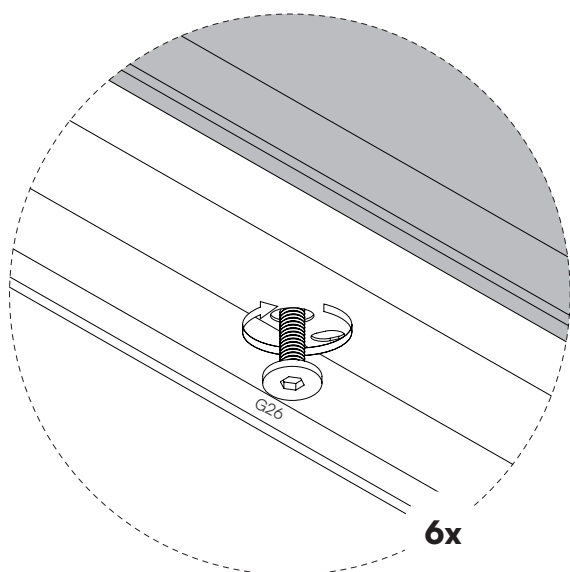
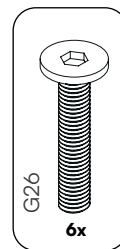

6x

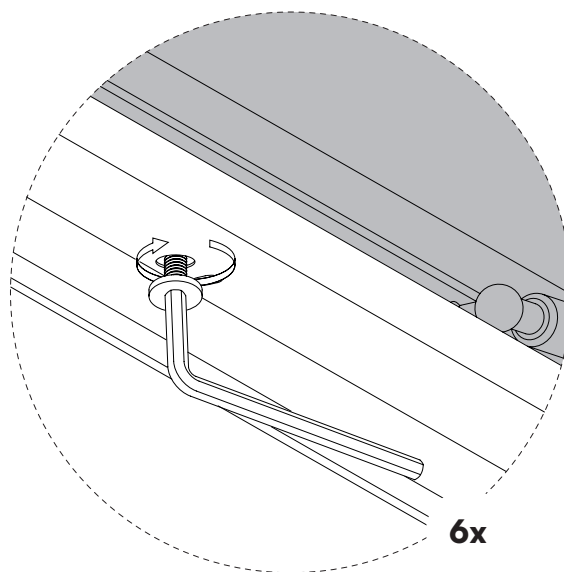

6x

7

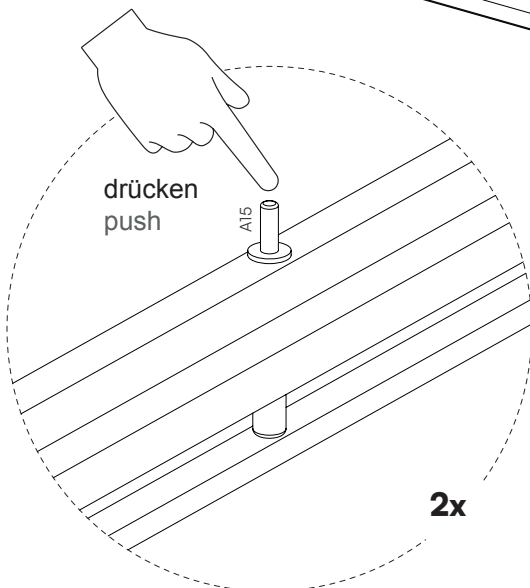
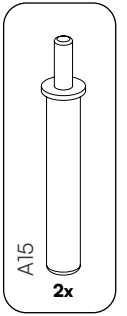
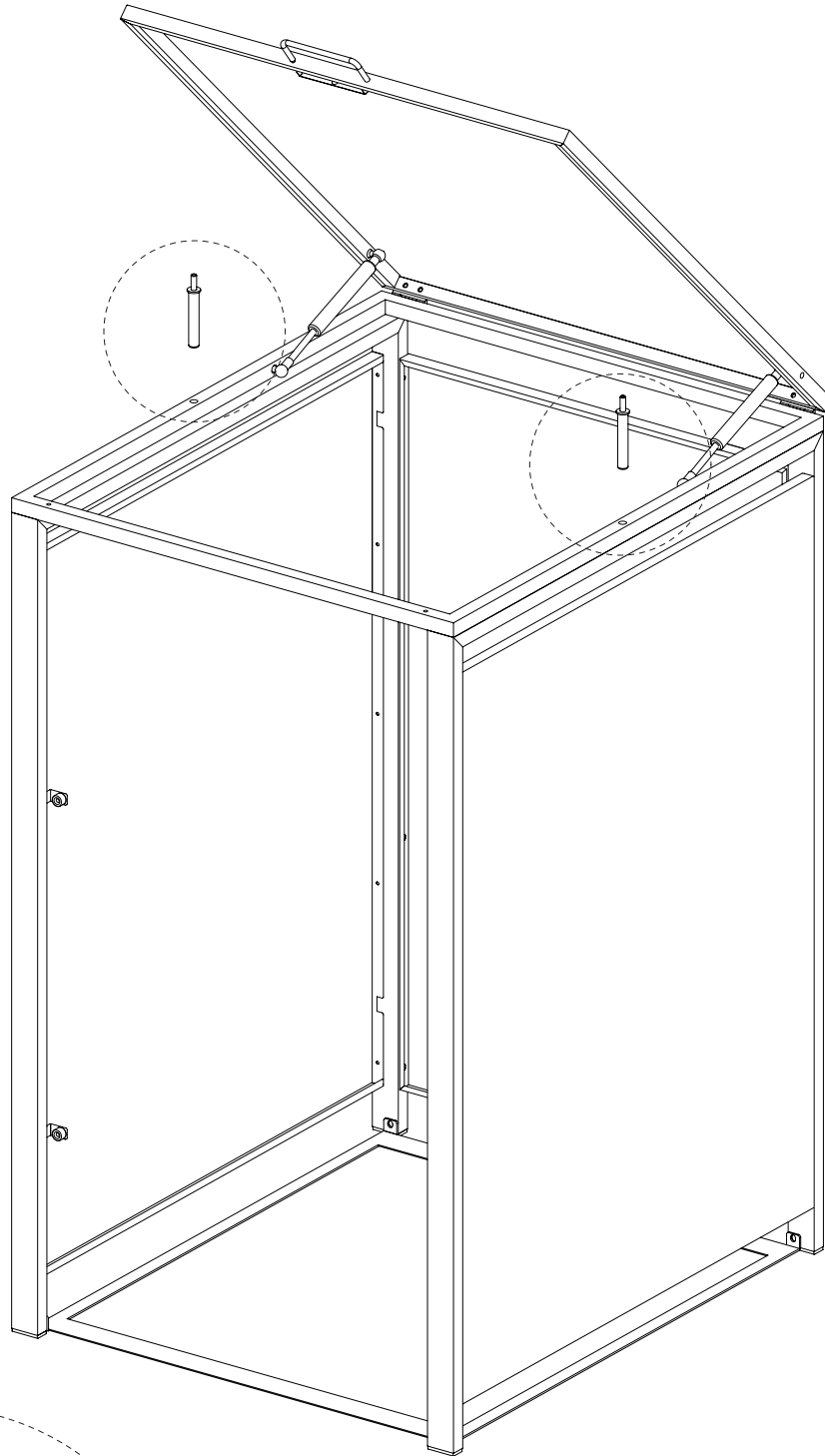

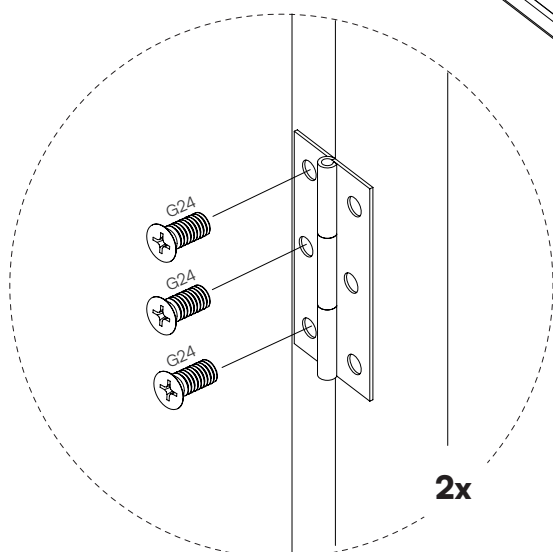
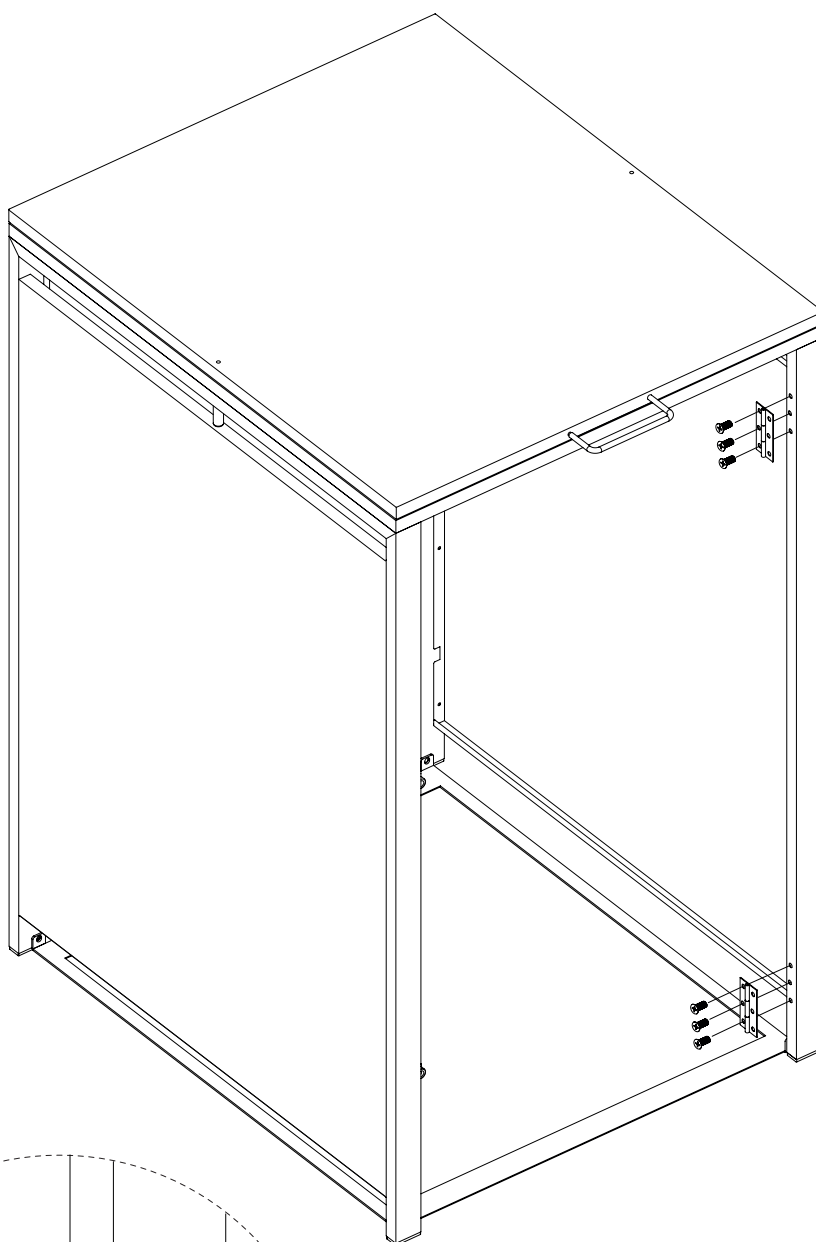
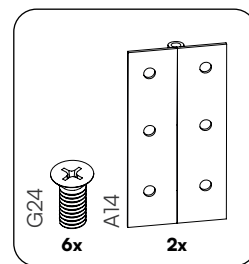

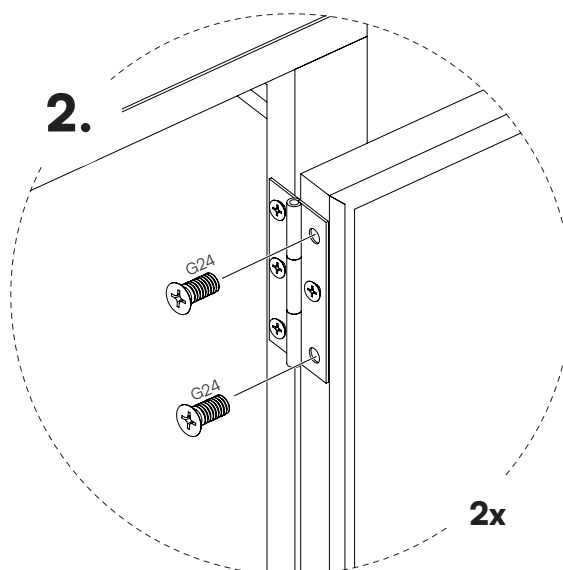
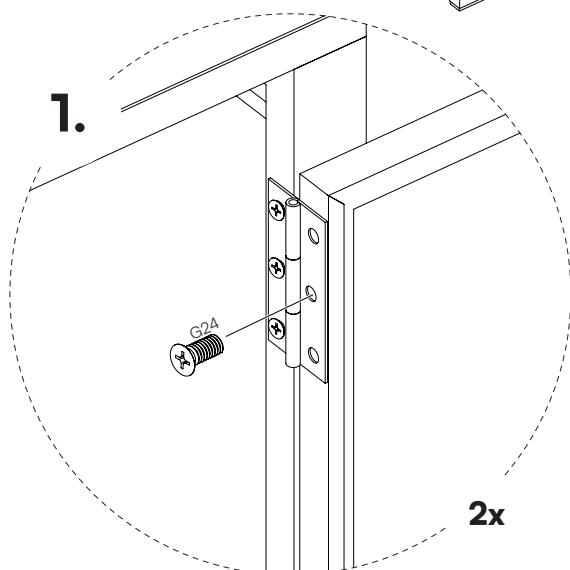
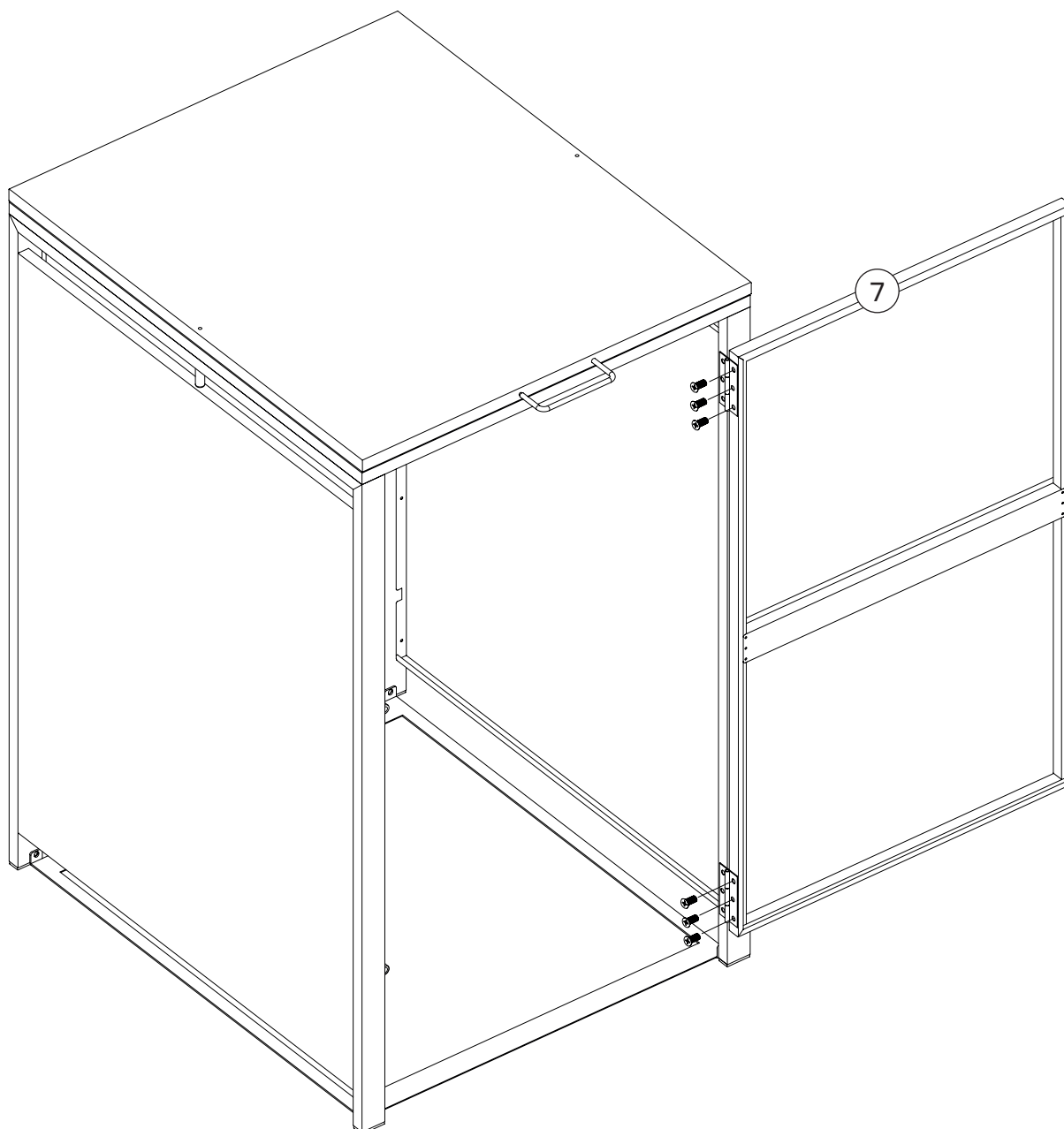
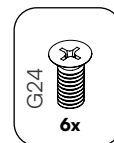

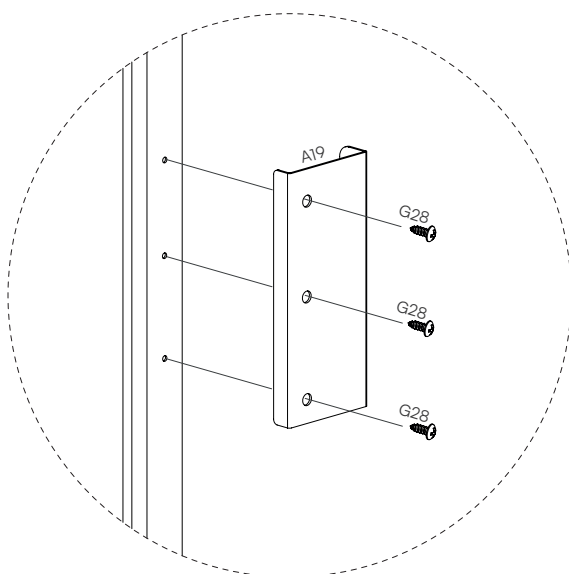
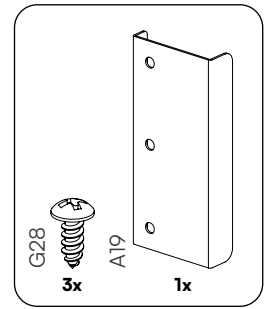
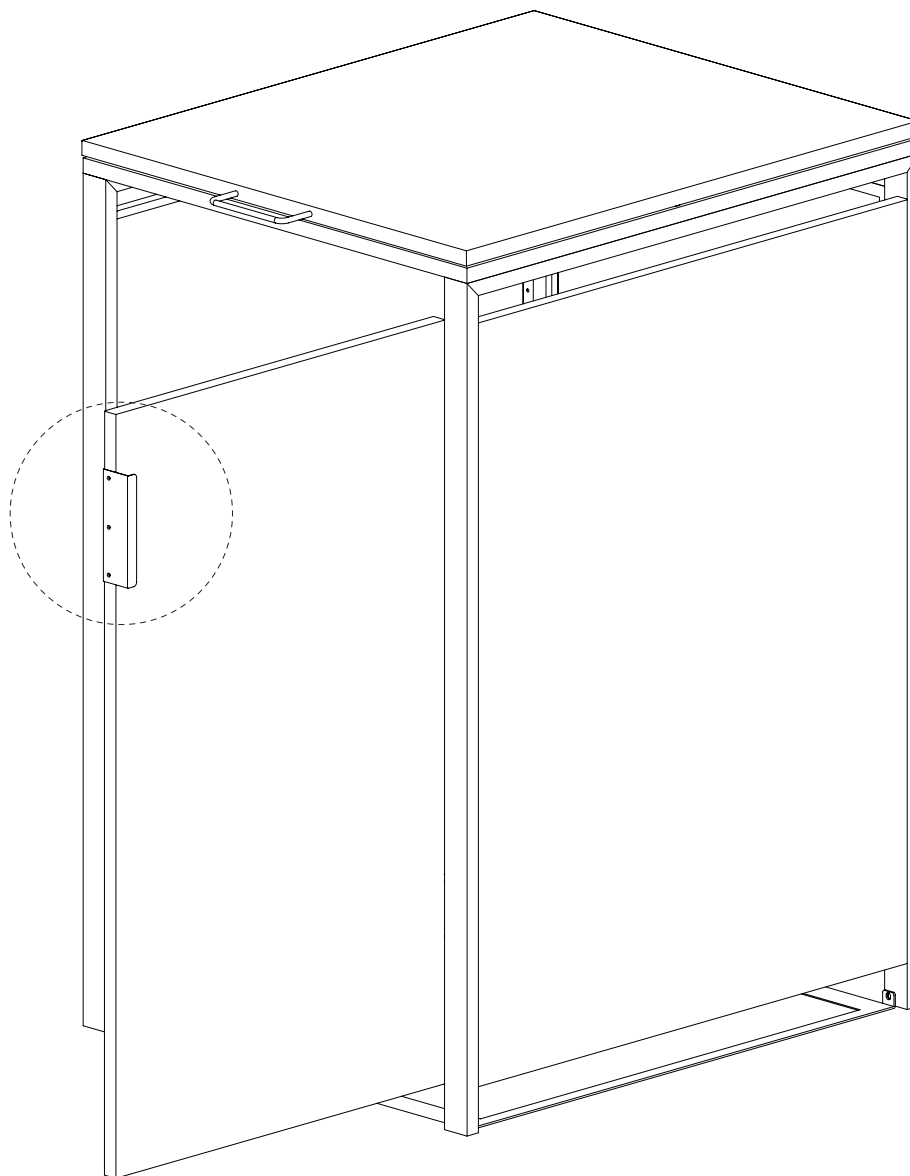

11

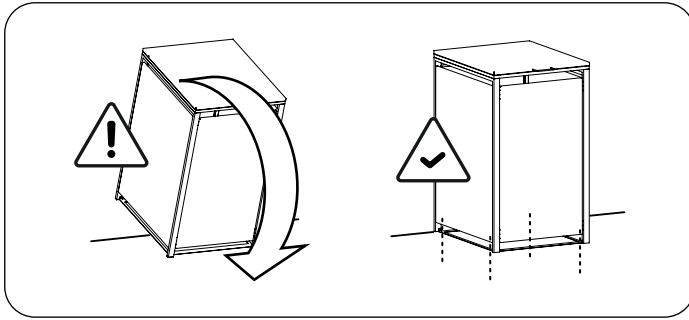

Für zusätzliche Stabilität empfehlen wir die Mülltonnenbox in den Boden zu verschrauben.

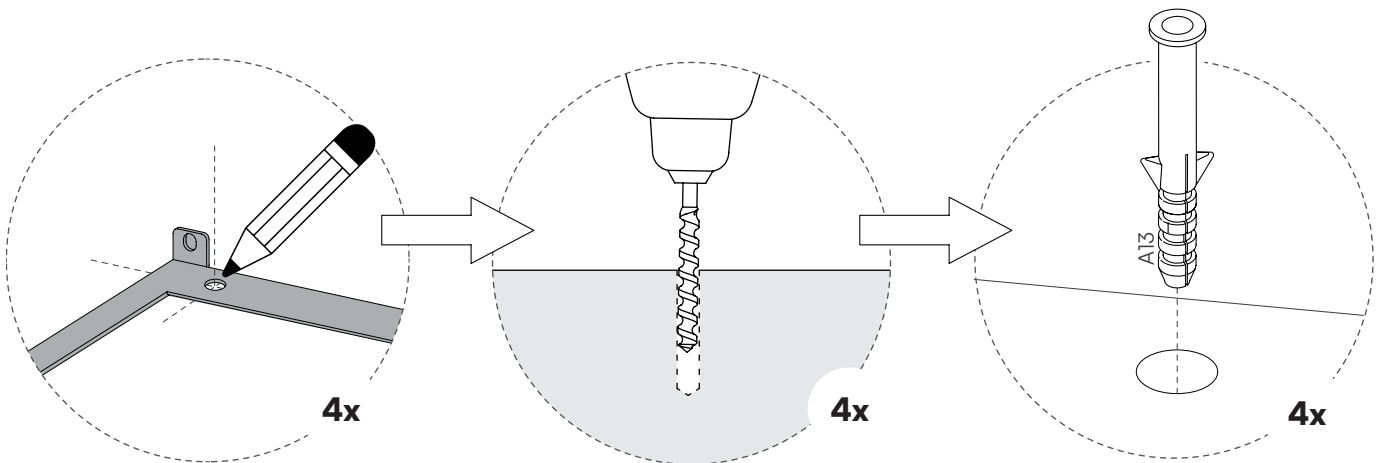
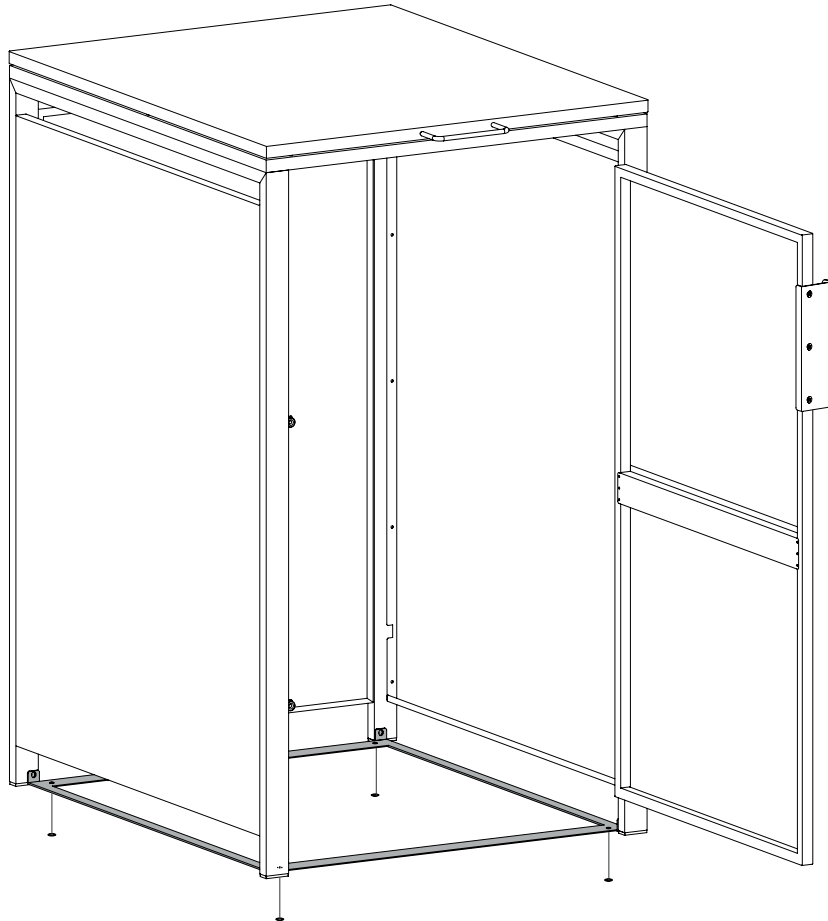
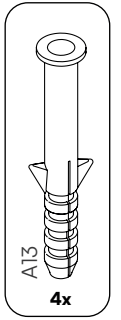

12

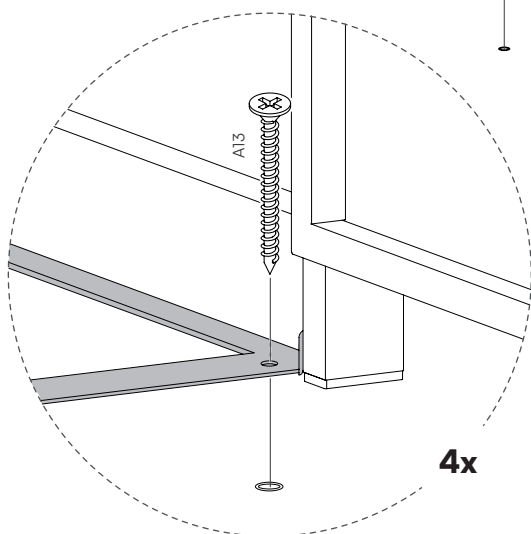
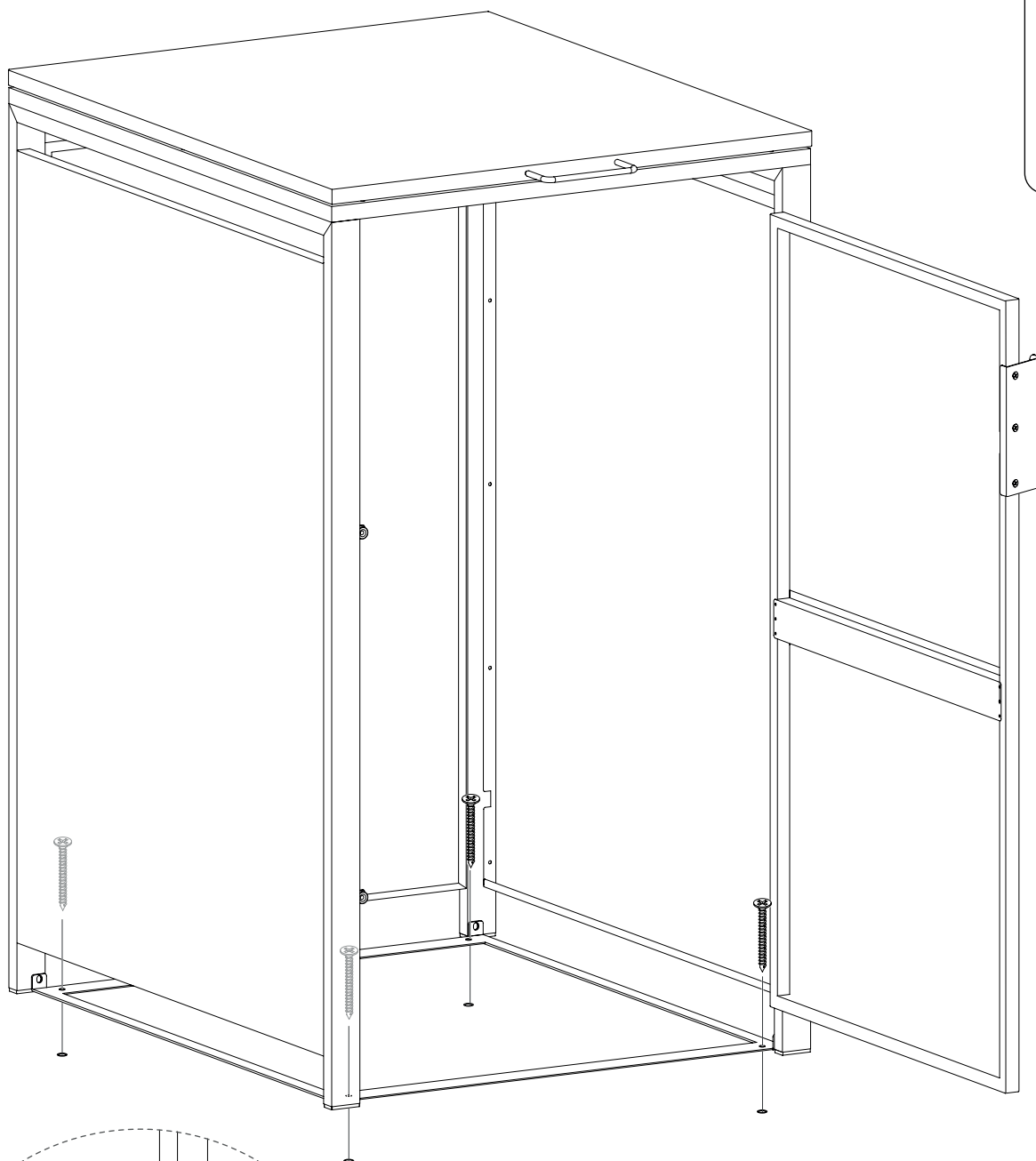
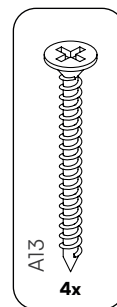

STEELSON

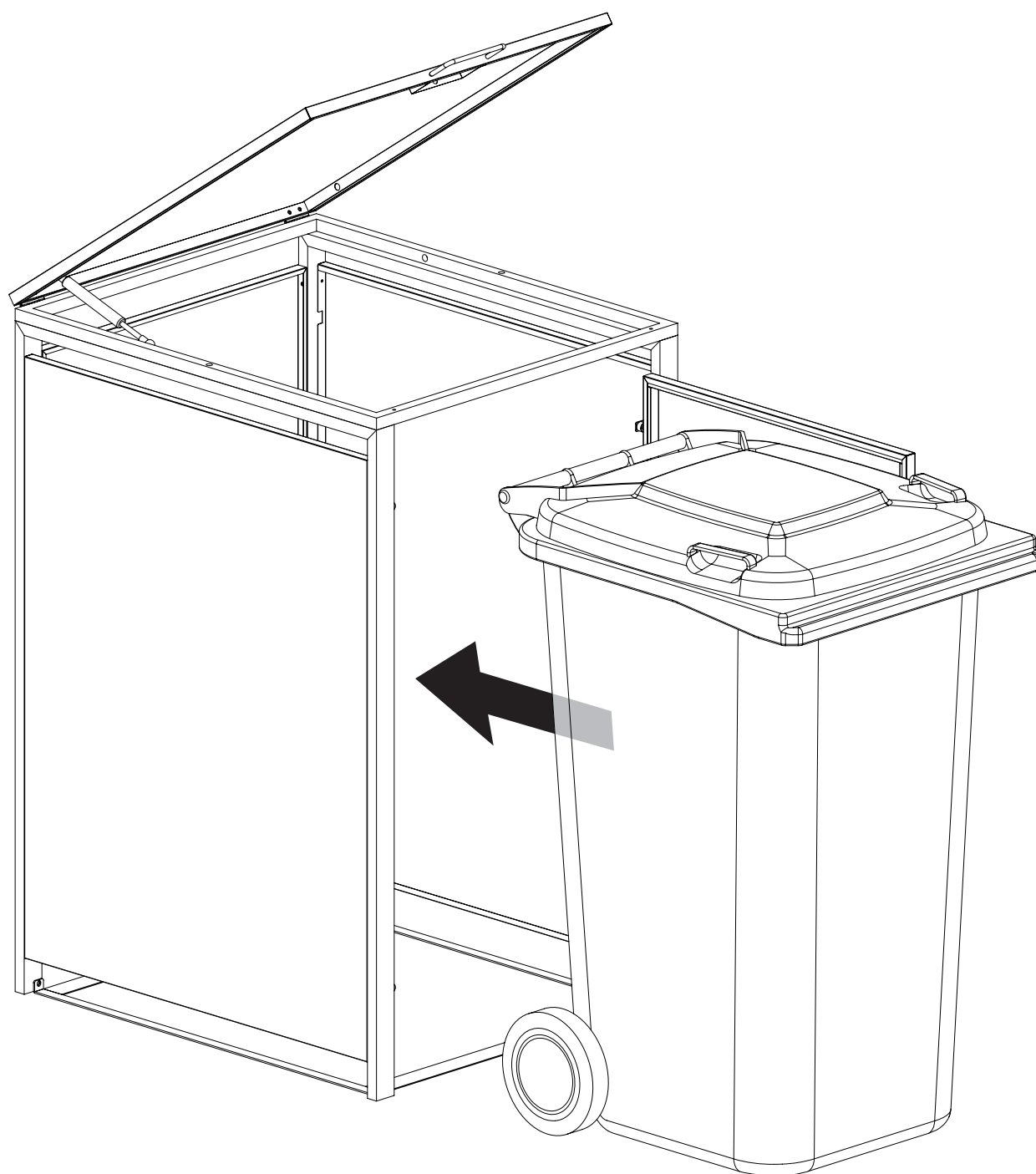

14

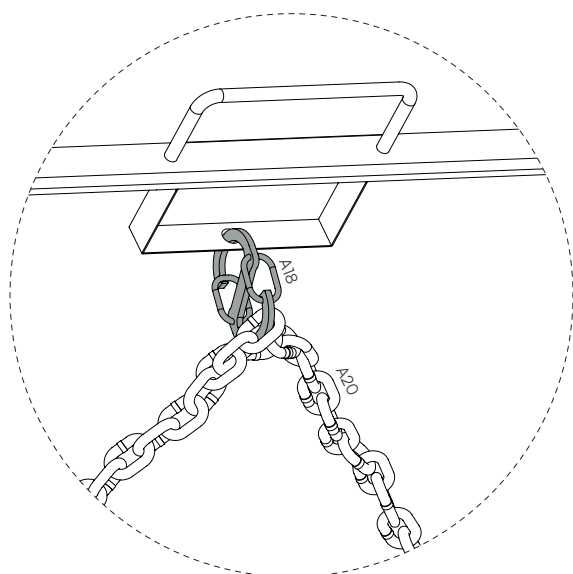
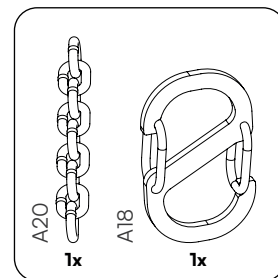
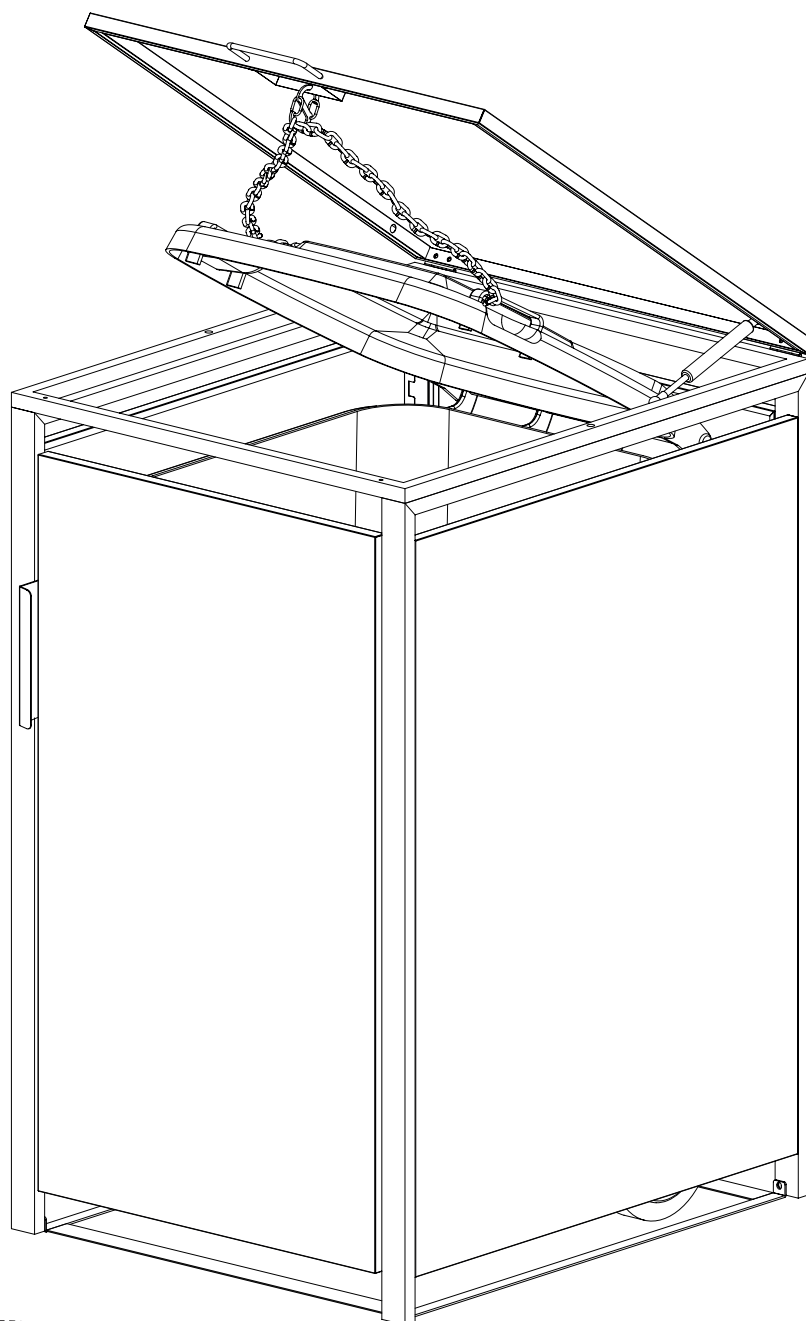

Geschafft!



STEELSON

