

CAISSON

Tool Required:

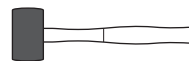

Mallet

Tool Provided:



T1 M4 Allen Key x 1



H1 Wooden Dowel
(8x35mm) x 4



H2 Bolt
(6x40mm) x 4

Step 1

Unpack and identify all the parts listed here. It is necessary to have **two people to carry and assemble** units weighing over 50 lbs. The assembly workspace should be a **non-marring surface, such as a carpet**

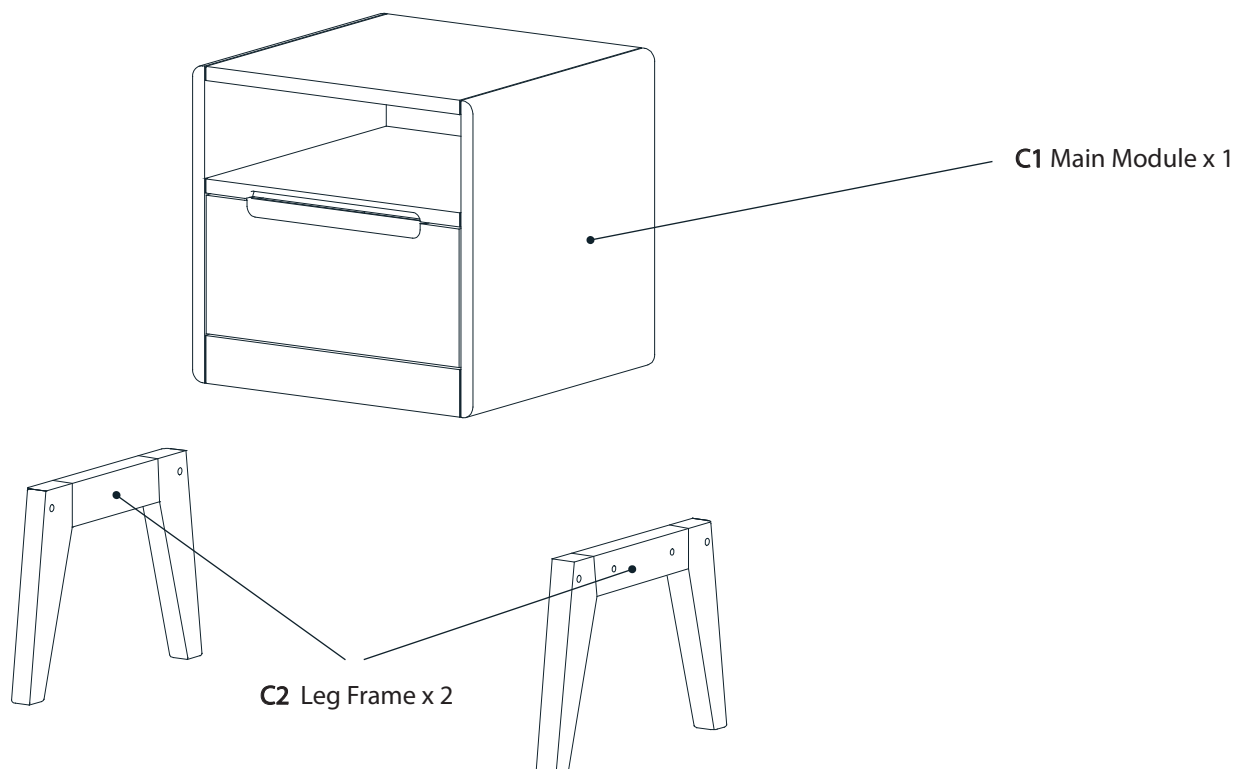

Step 2 - Insert dowels onto the gaps leg frames.

Insert **4 wooden dowels H1** onto the gaps **2 leg frames C2** by using a mallet.

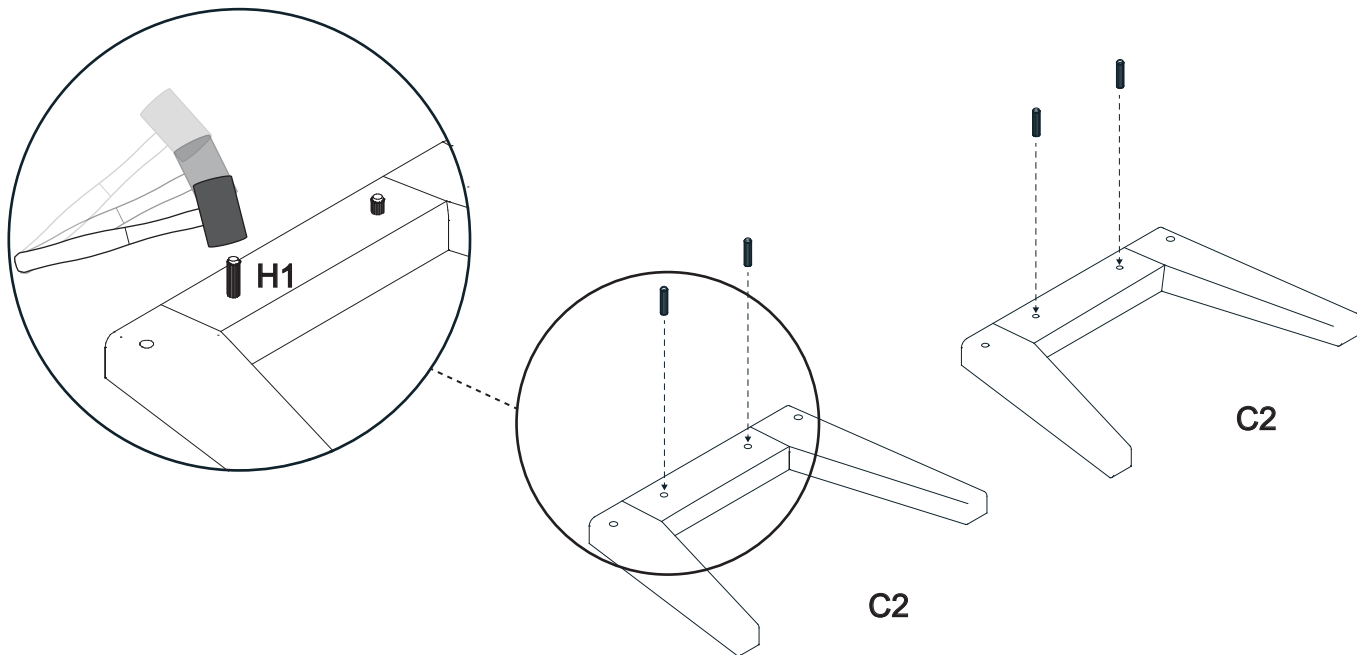

Step 3 - Attach the first leg frame to the main module.

Attach the **leg frame C2** to the **main module C1** by using **2 bolts H2** as shown below. Tighten using an **allen key T1**.

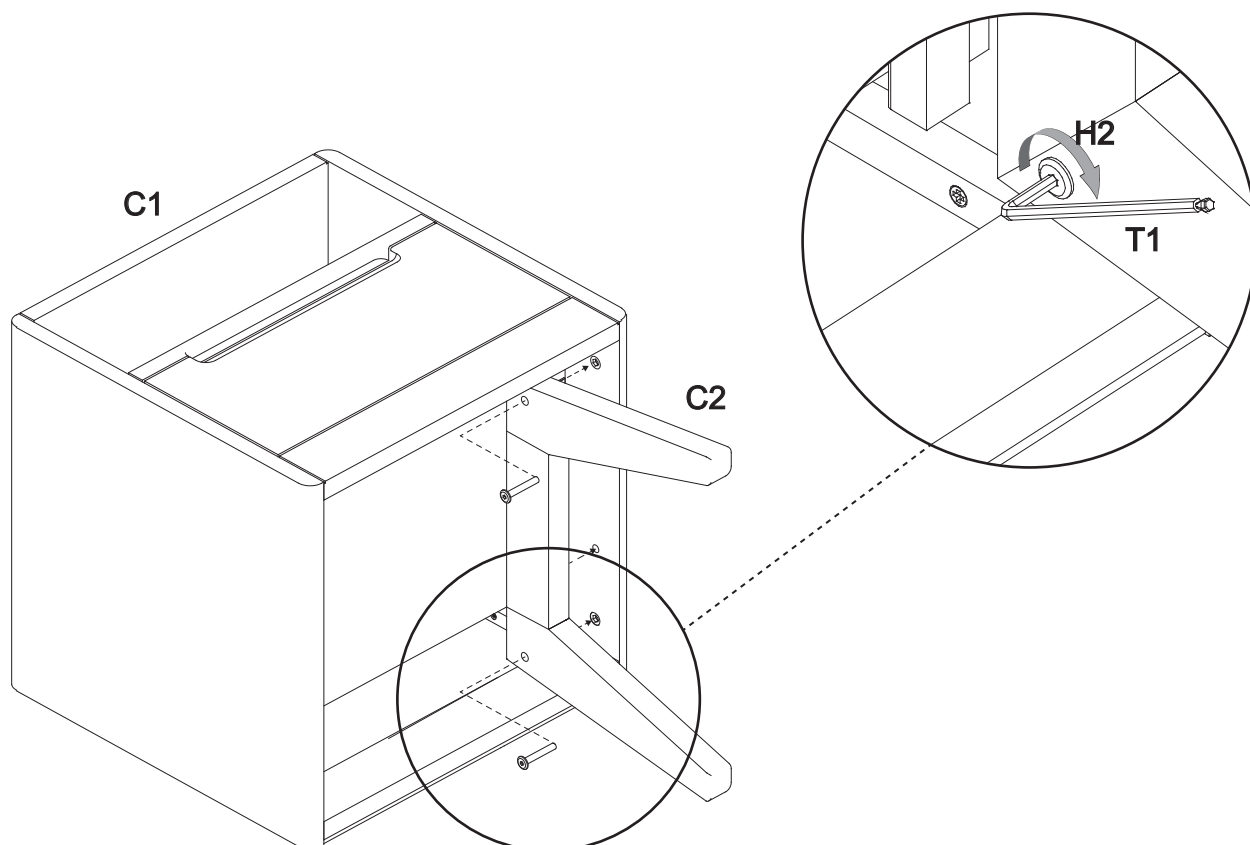

Step 4 - Attach the second leg frame to the main module.

Attach the **leg frame C2** to the **main module C1** by using **2 bolts H2** as shown below. Tighten using an **allen key T1**.

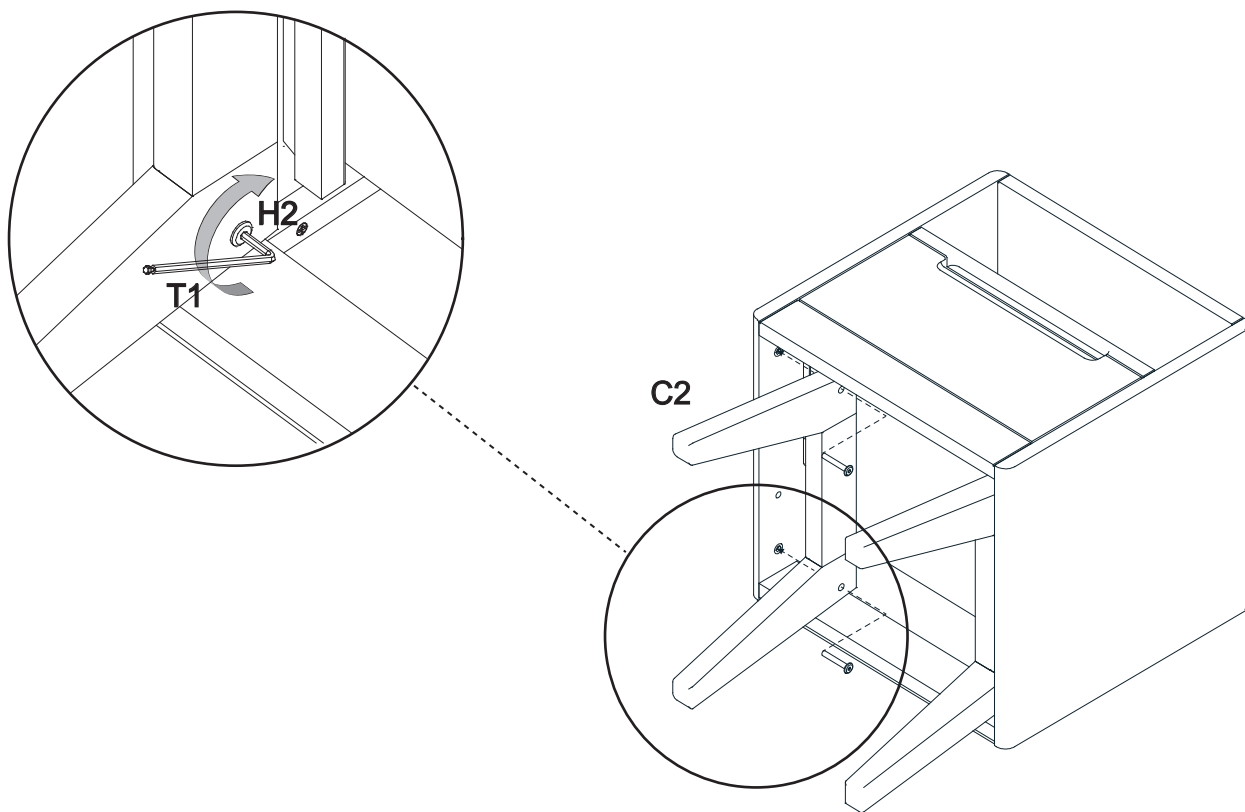

Step 5 - End of the assembly.

Lift the unit to standing position carefully.

