

# STEELSØN

Sonnenschirm 'Elaris'

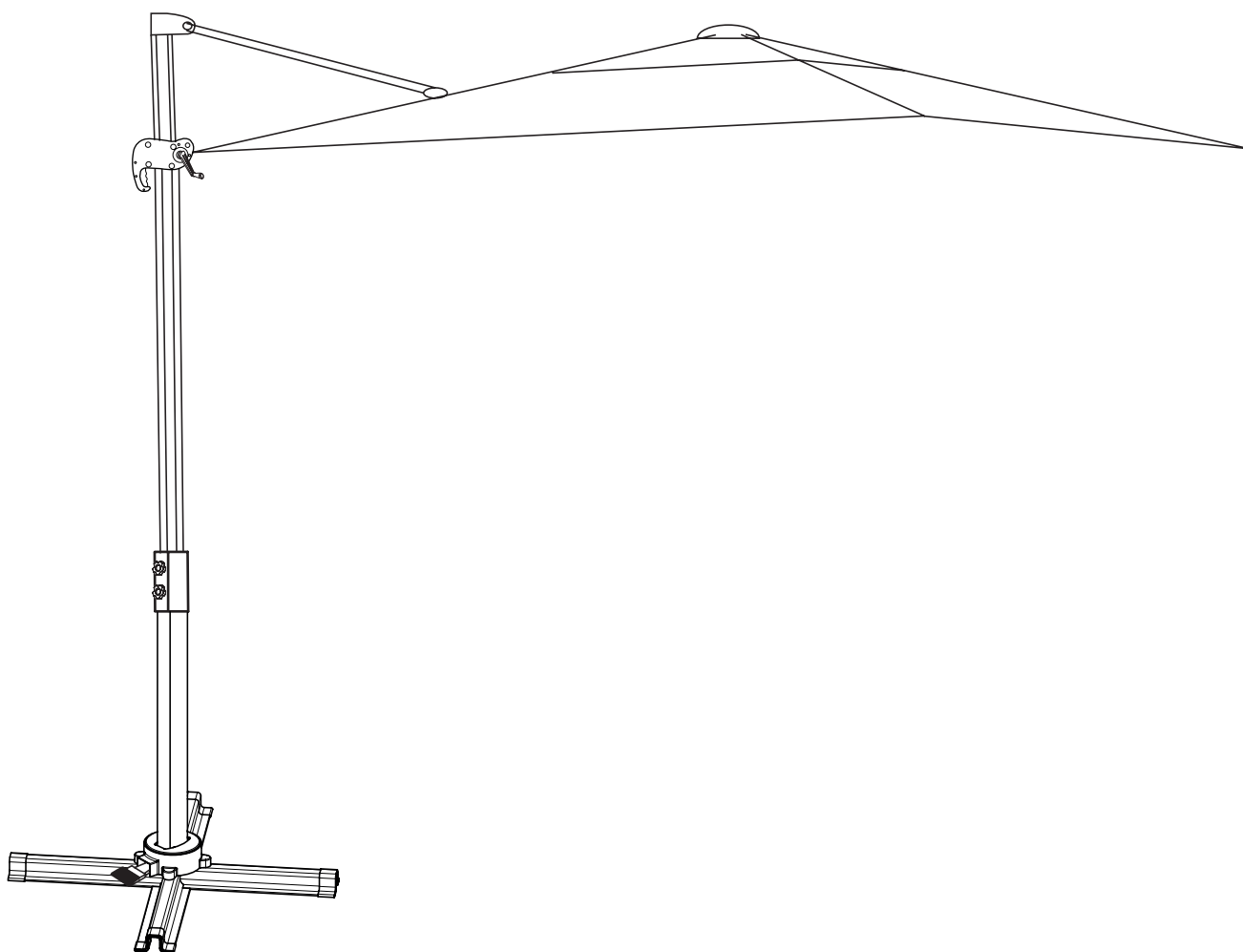



# Hey,

wir freuen uns, dass Du Dich für unser Produkt entschieden hast. Beachte die kommenden Hinweise, um den Aufbau problemlos zu gestalten.

**Viel Spaß mit Deinem Produkt!**

# 50%

weniger Fehler beim Aufbau durch  
sorgfältiges Lesen der Anleitung



# 20-40

min

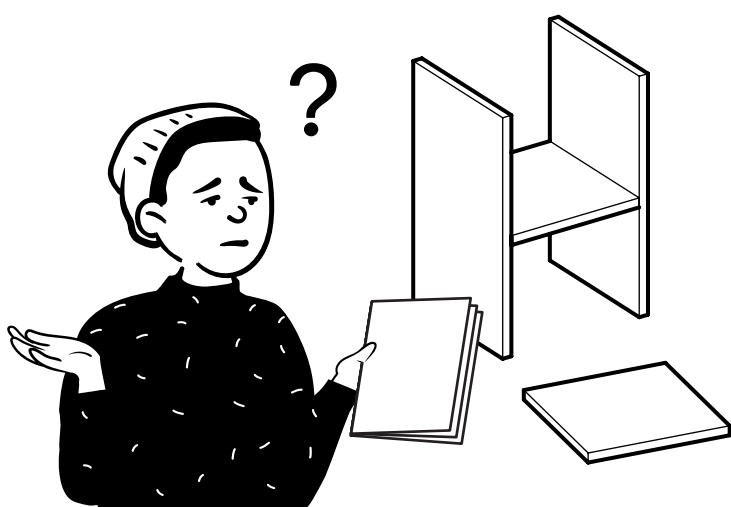
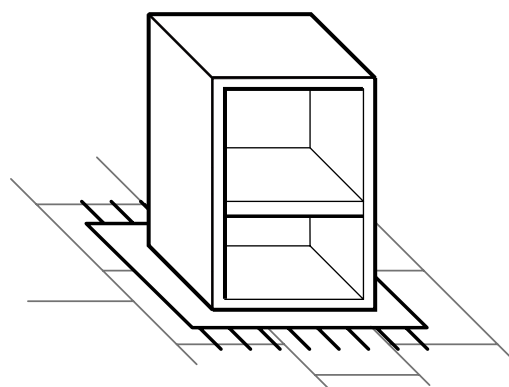
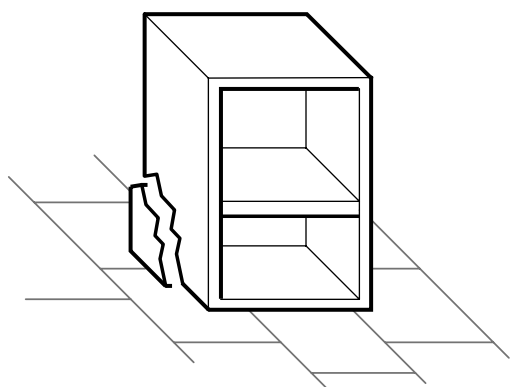

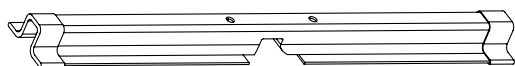

1 Fußteil, oben  
1x

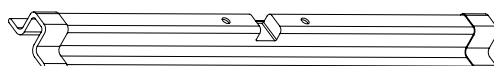

2 Fußteil, unten  
1x

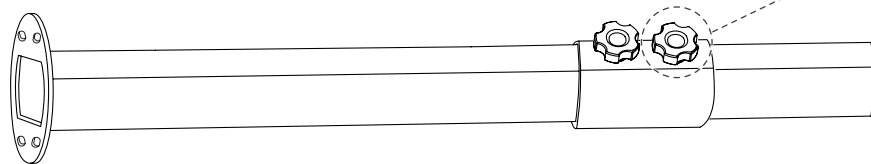

3 Basis  
1x

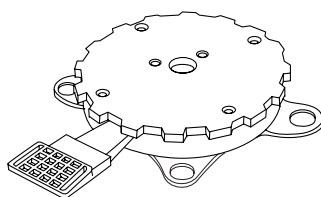
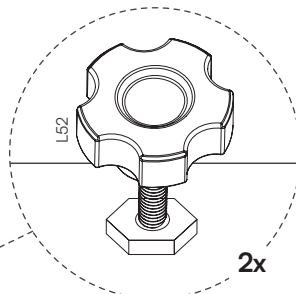

4 Rotationsplatte  
1x

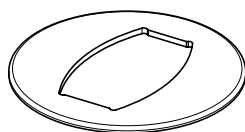

5 Abdeckkappe  
1x

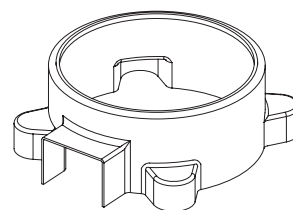

6 Abdeckung  
1x

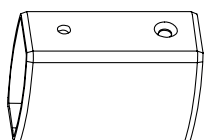

7 Abdeckung Stange  
1x

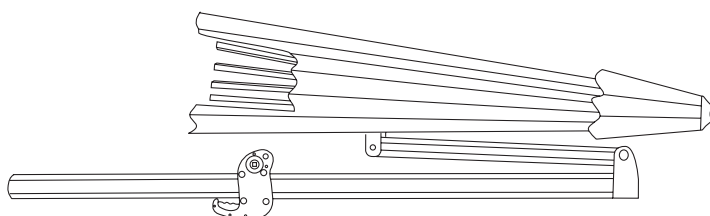

8 Sonnenschirm  
1x

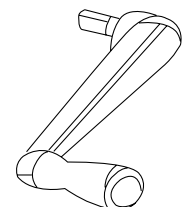

9 Kurbel  
1x

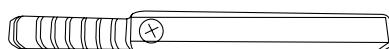

10 Rippenverlängerung  
4x

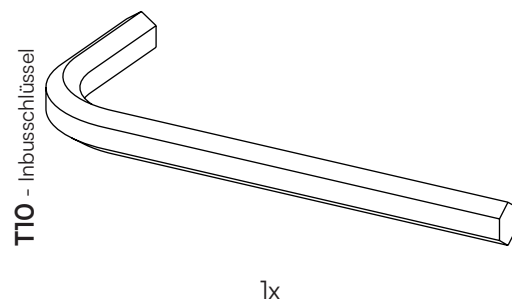

## Ein letzter Check:

Bitte überprüfe, ob Du alle Teile hast.

**Viel Spaß beim Aufbau!**

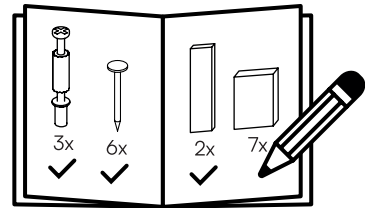

7

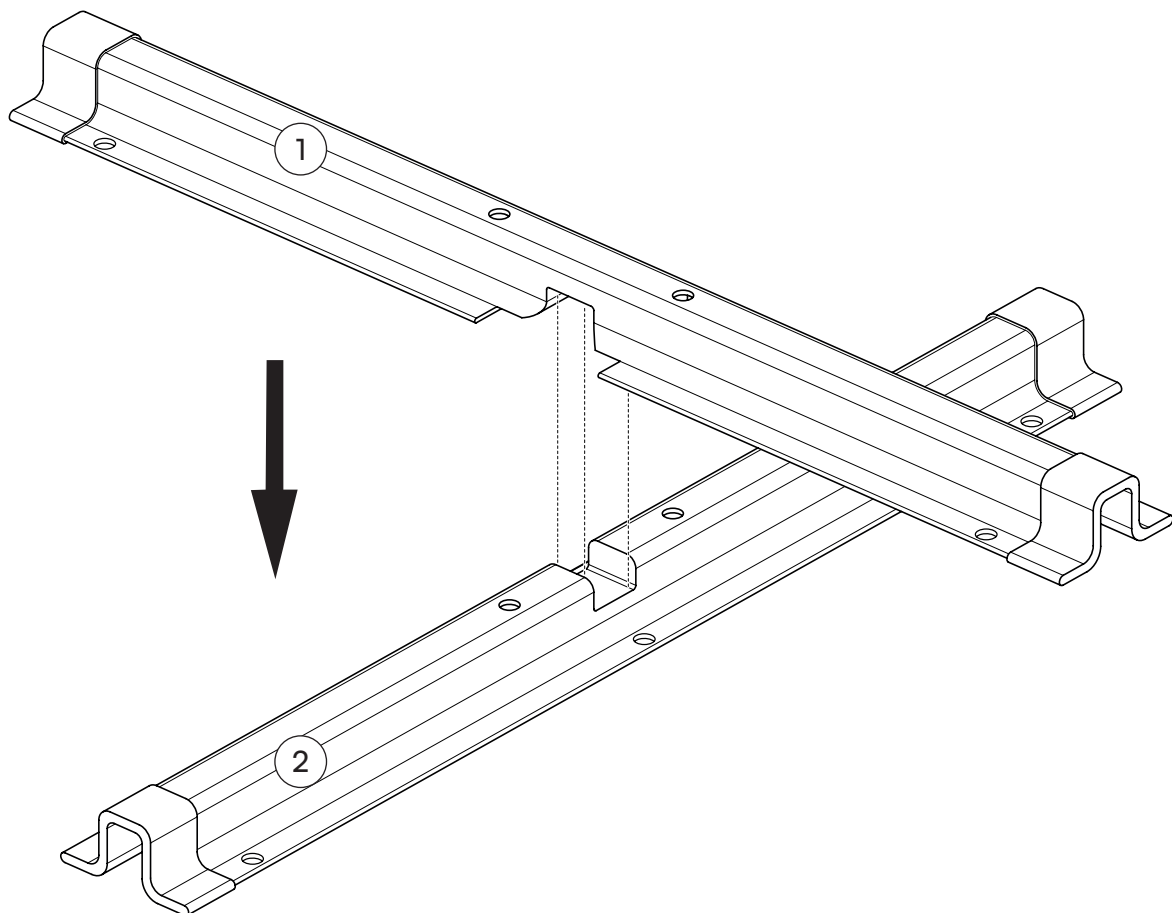

2

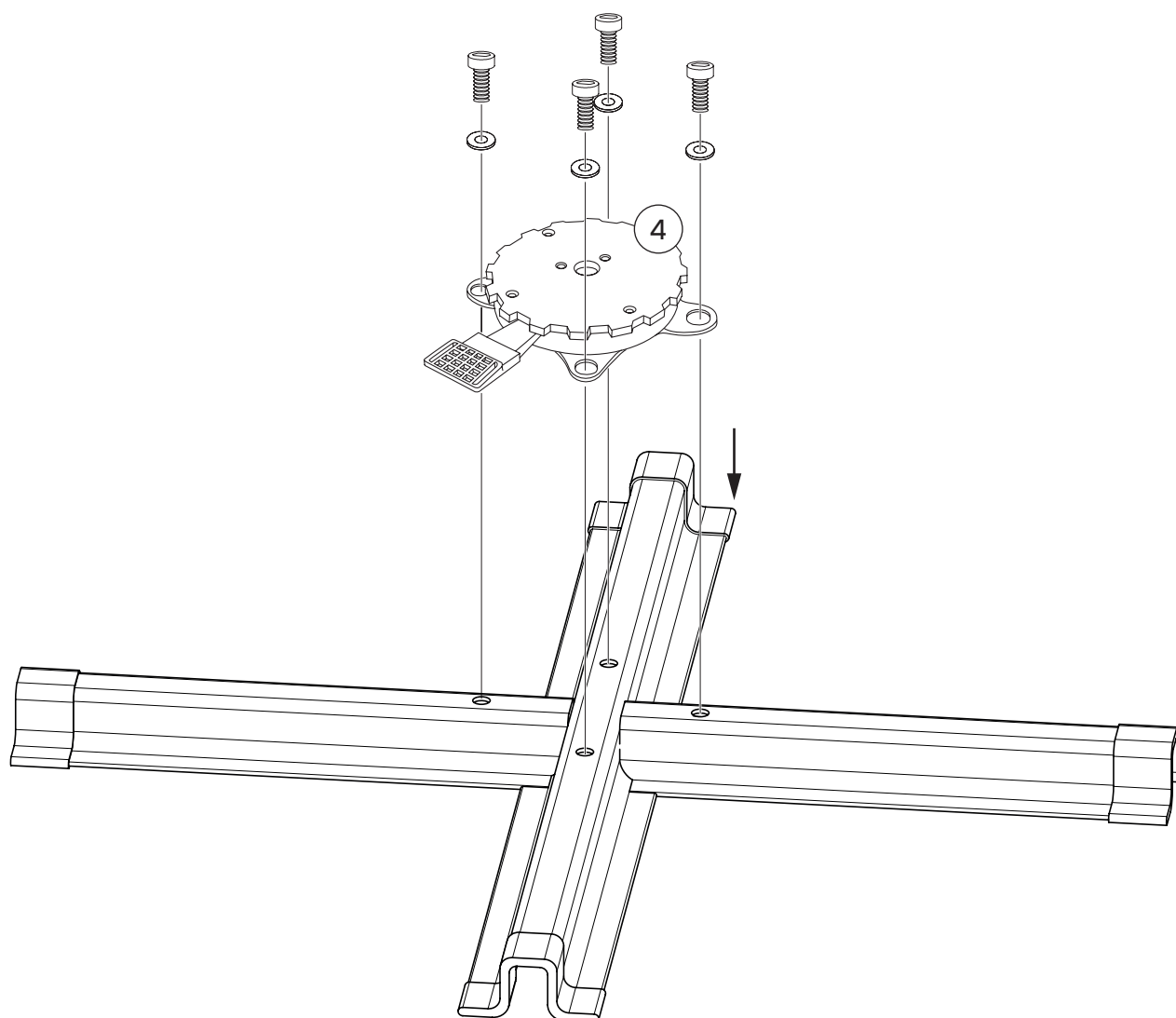
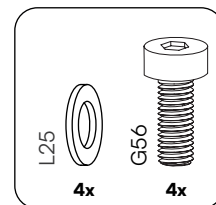

3

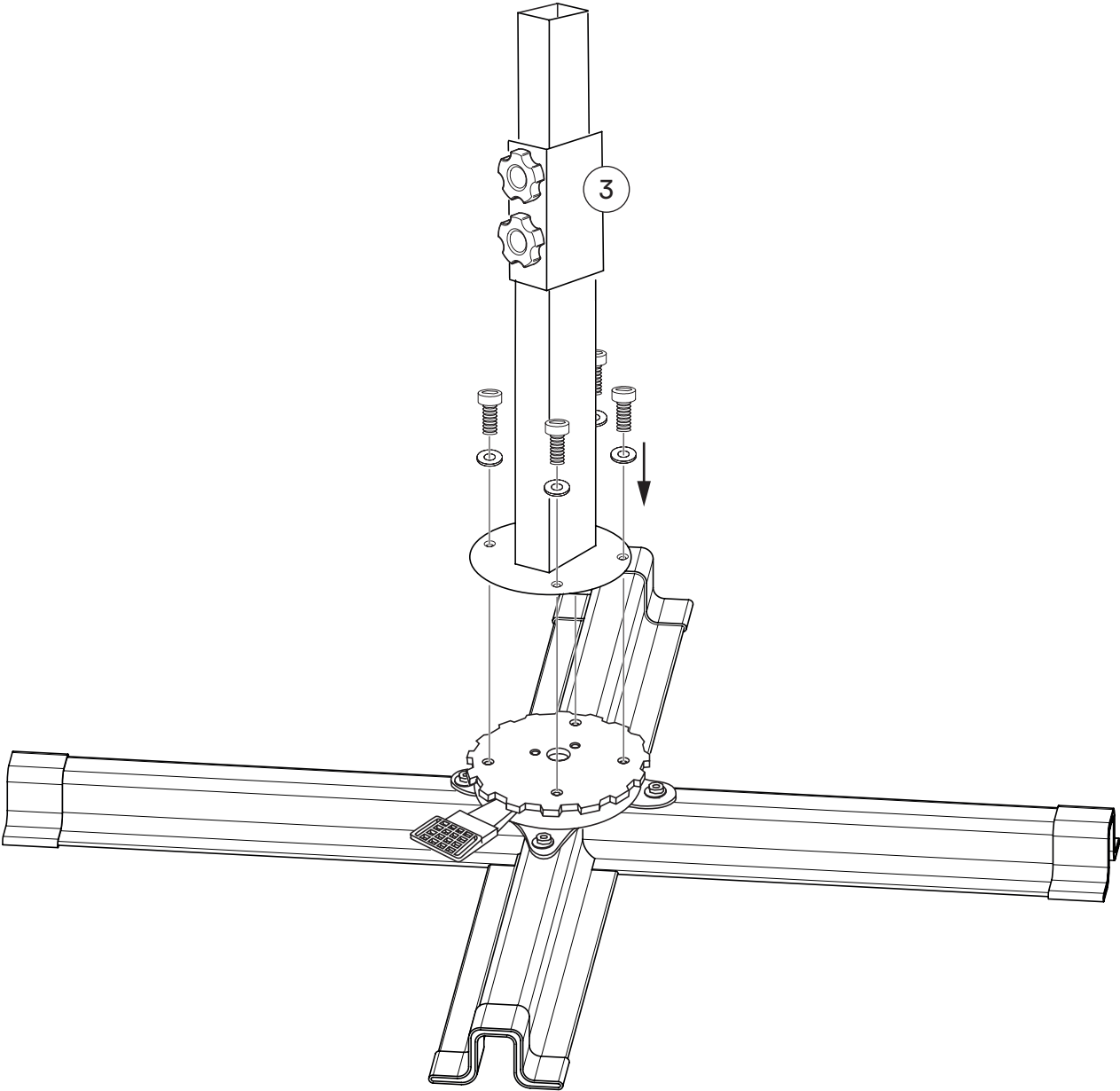
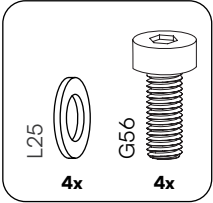





5

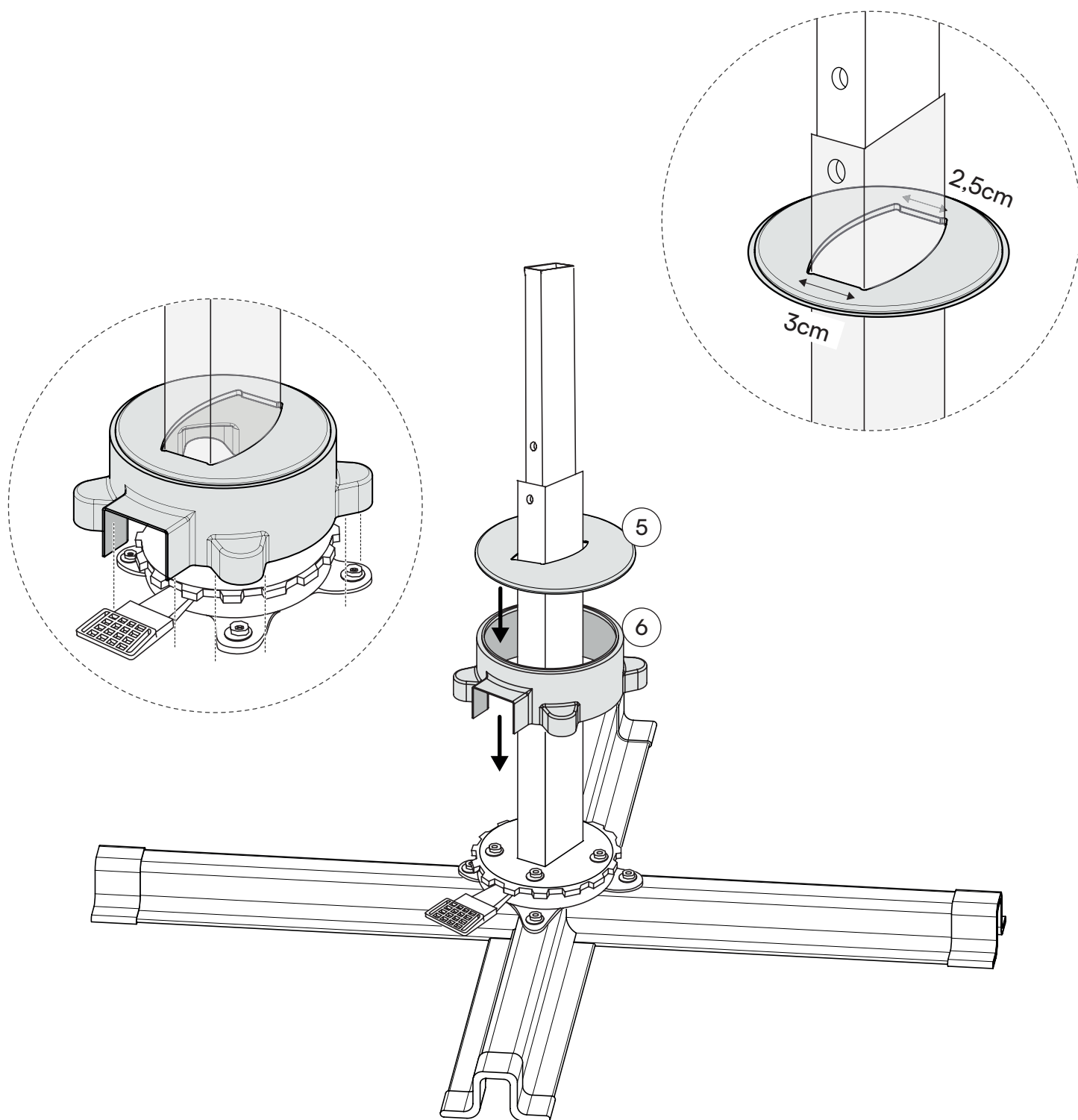

6

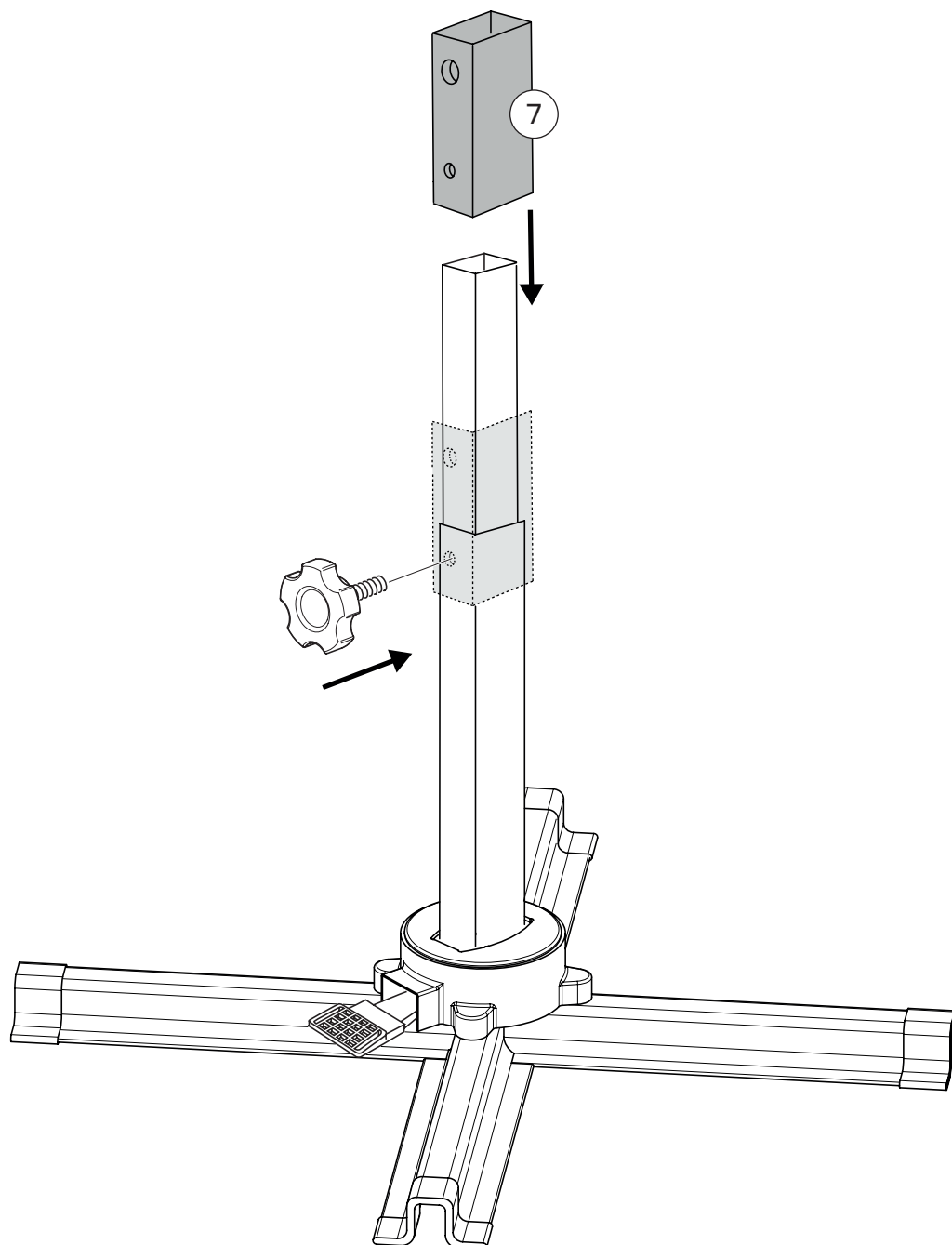

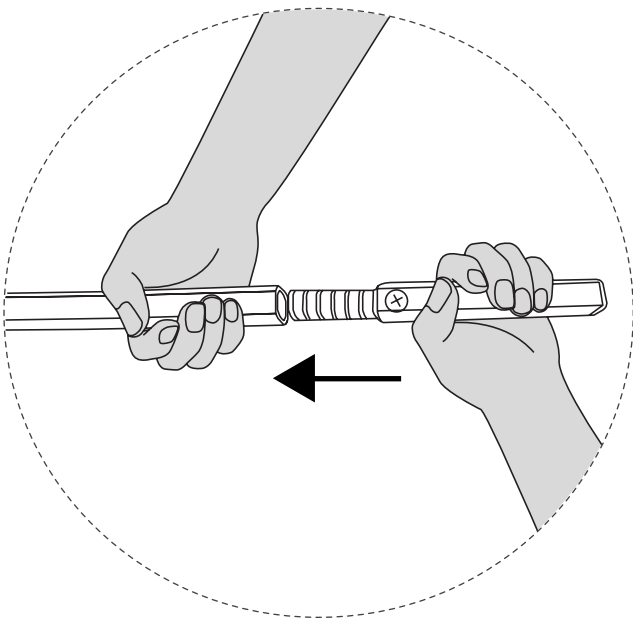
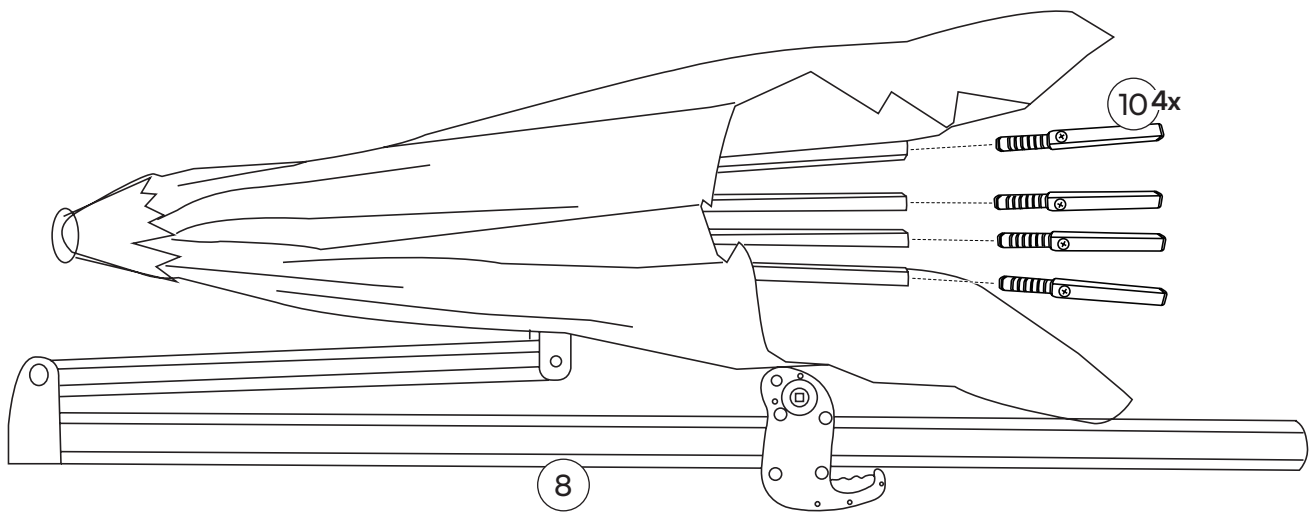

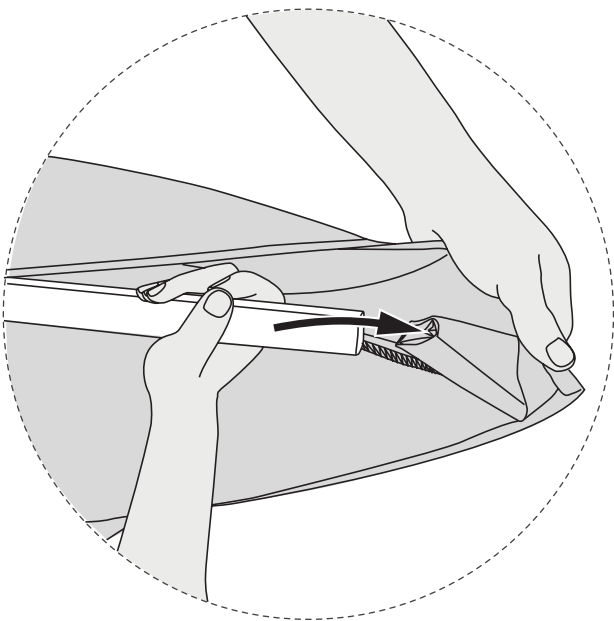
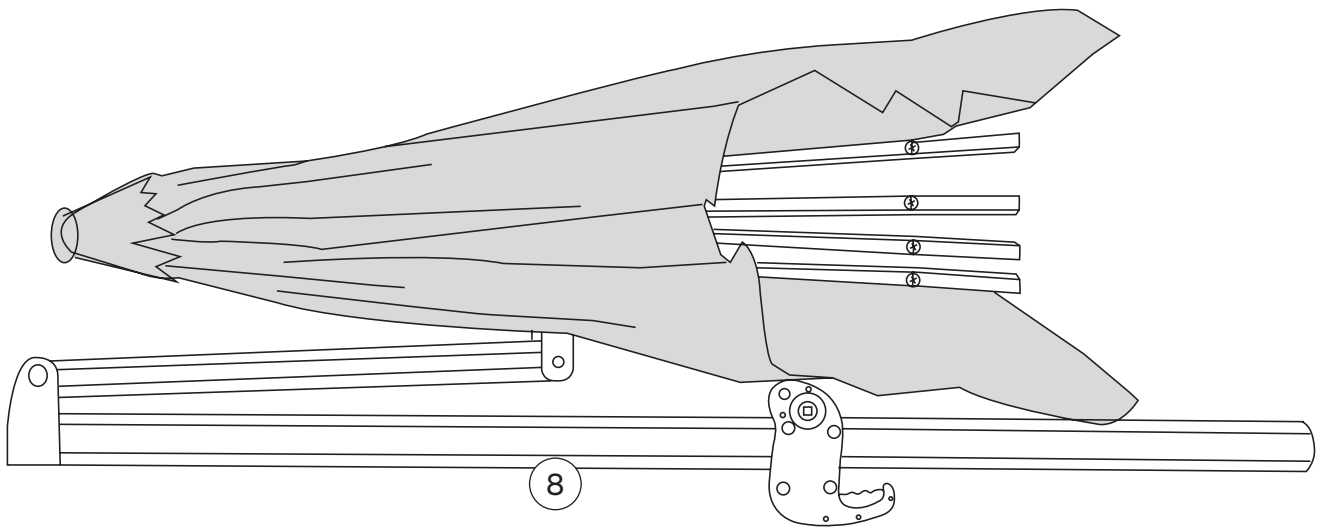

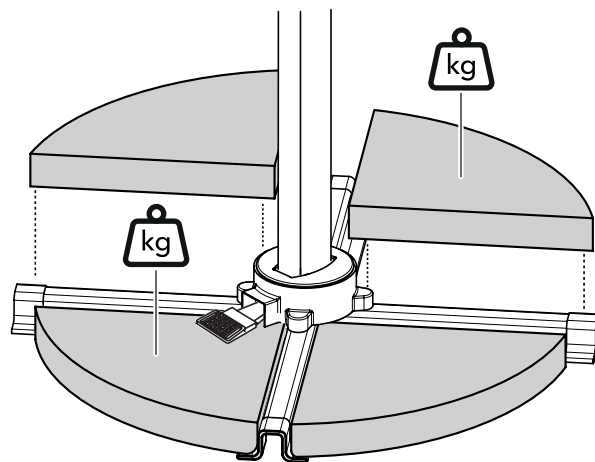
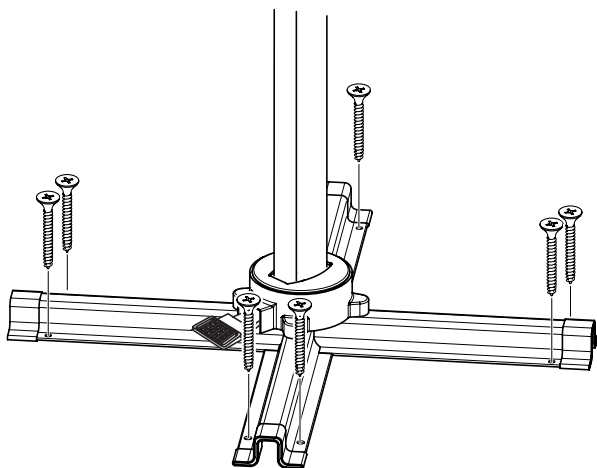

### Befestigung des Sonnenschirms:

Es ist wichtig, dass der Sonnenschirm sicher befestigt ist, damit er stabil steht und nicht kippt. Es gibt mehrere Möglichkeiten:

**Bodenbefestigung:** Schraube den Sonnenschirm fest im Boden.

**Gewichte:** Nutze Gewichte oder andere schwere Befestigungen. Das empfohlene Gesamtgewicht beträgt **mindestens 60 kg**.

Elemente zur Befestigung sind im Lieferumfang nicht enthalten.

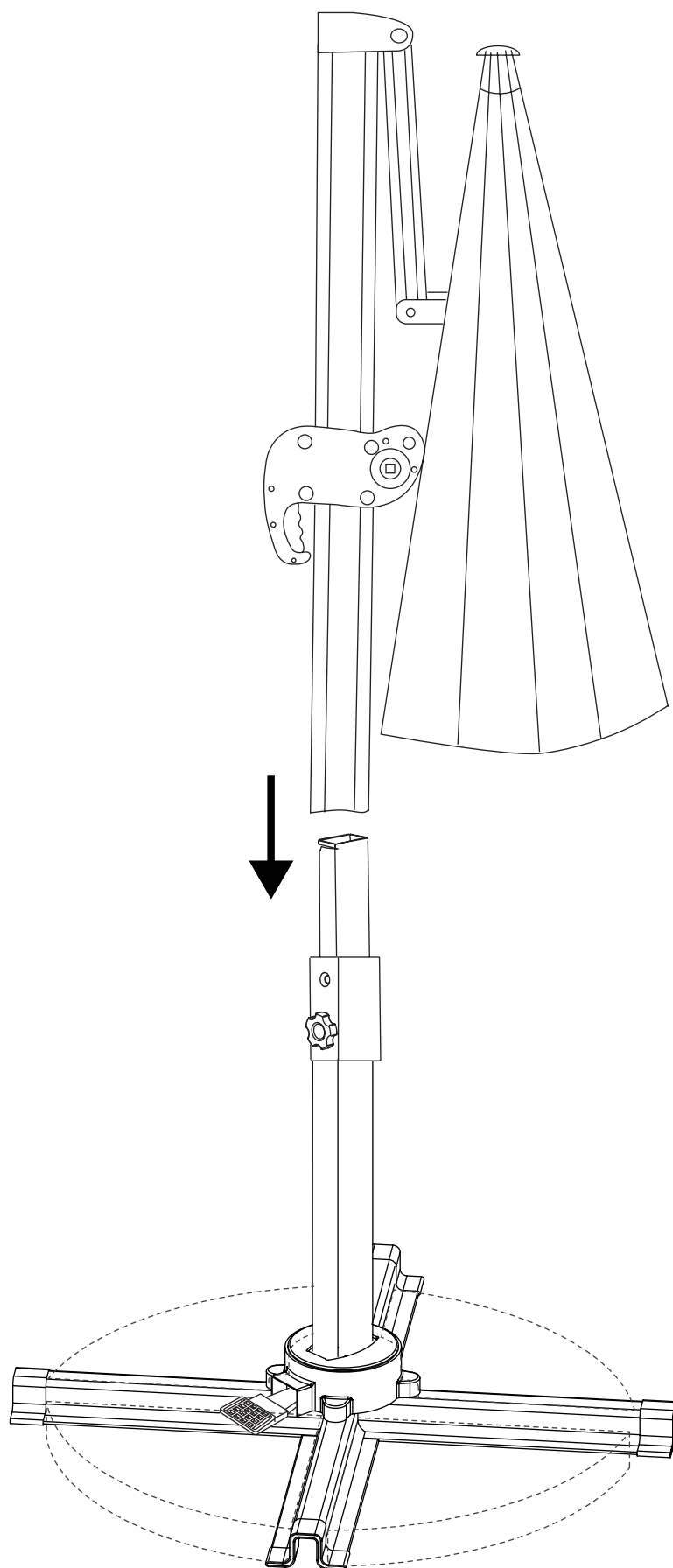

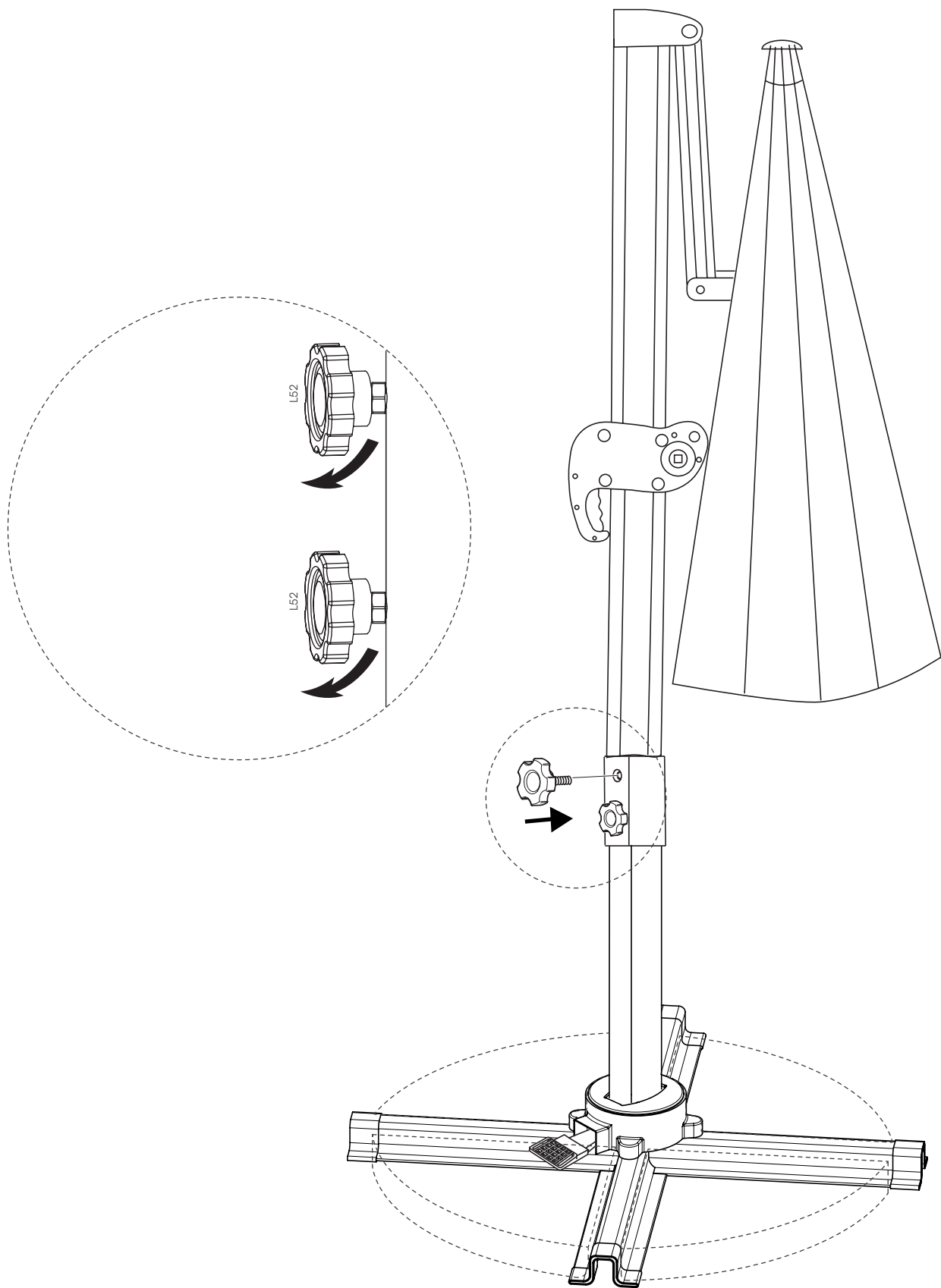



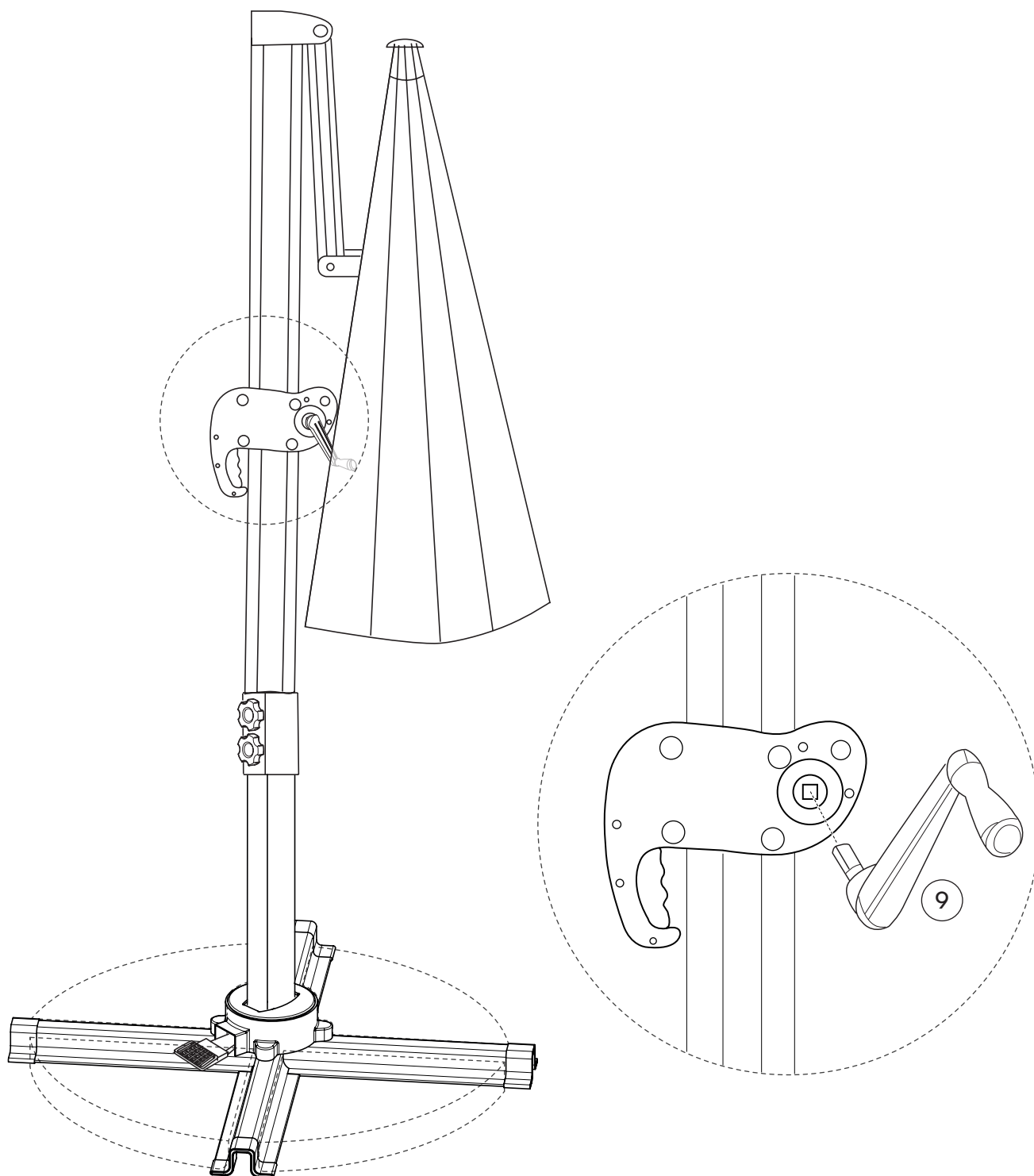

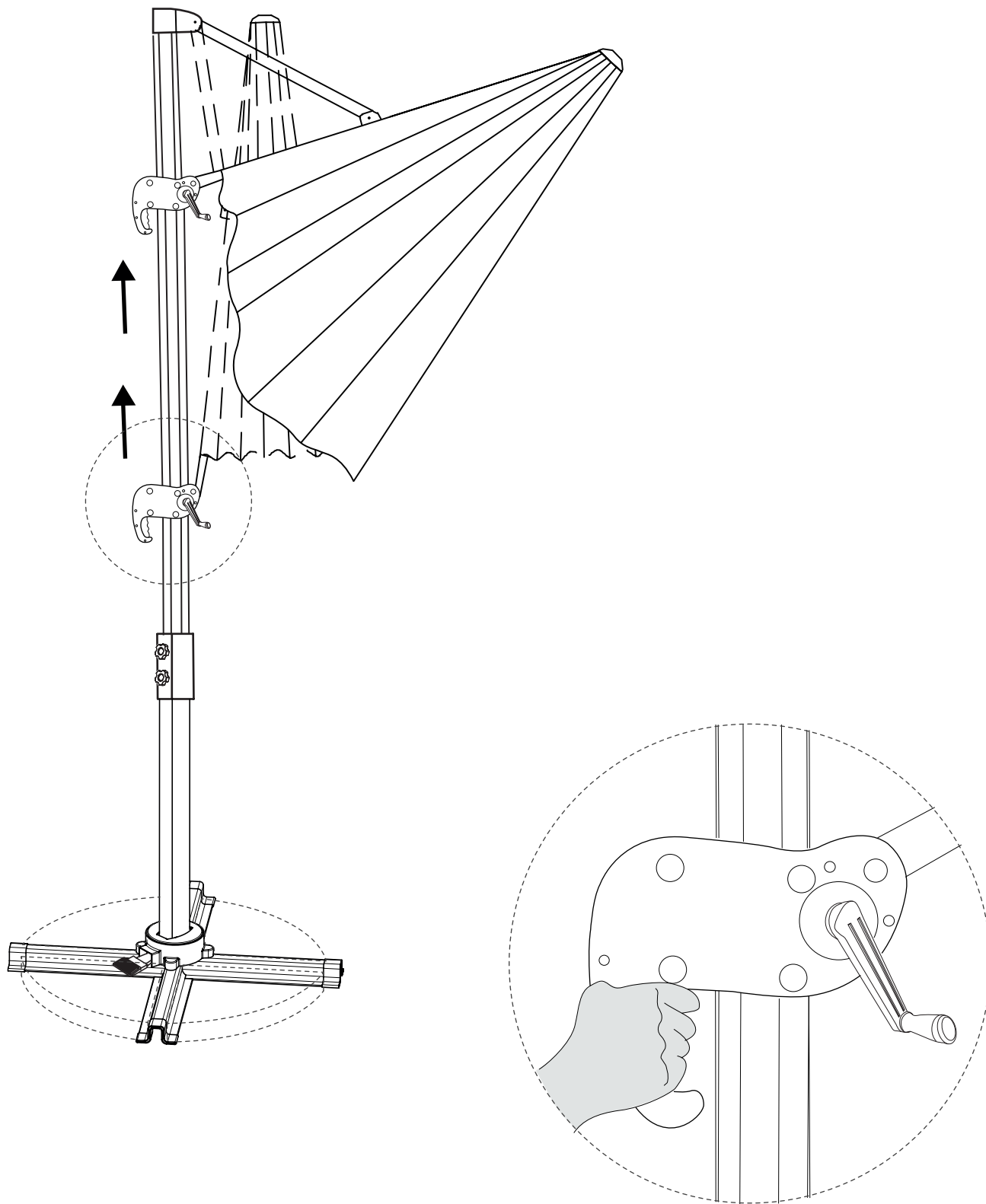

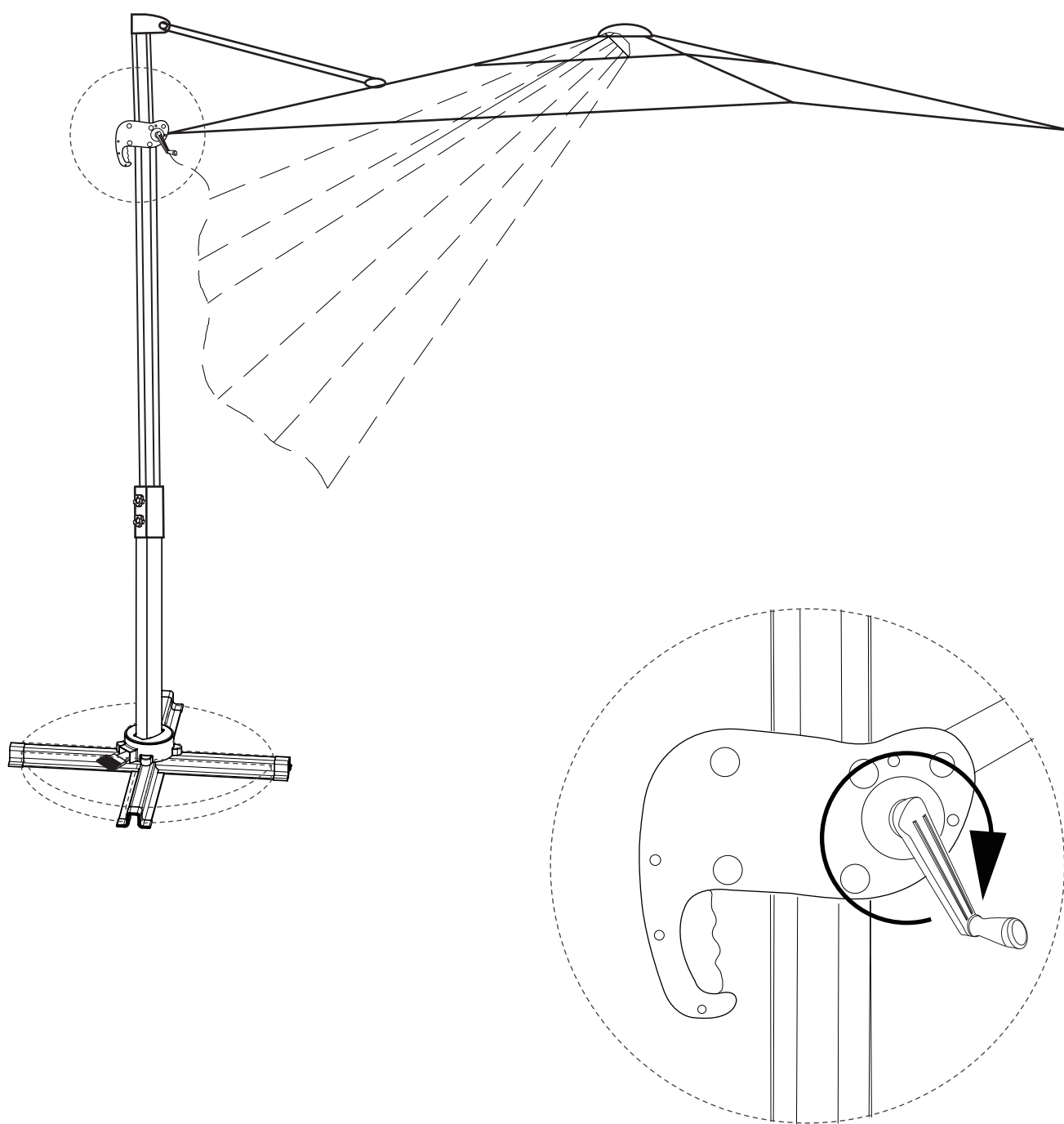

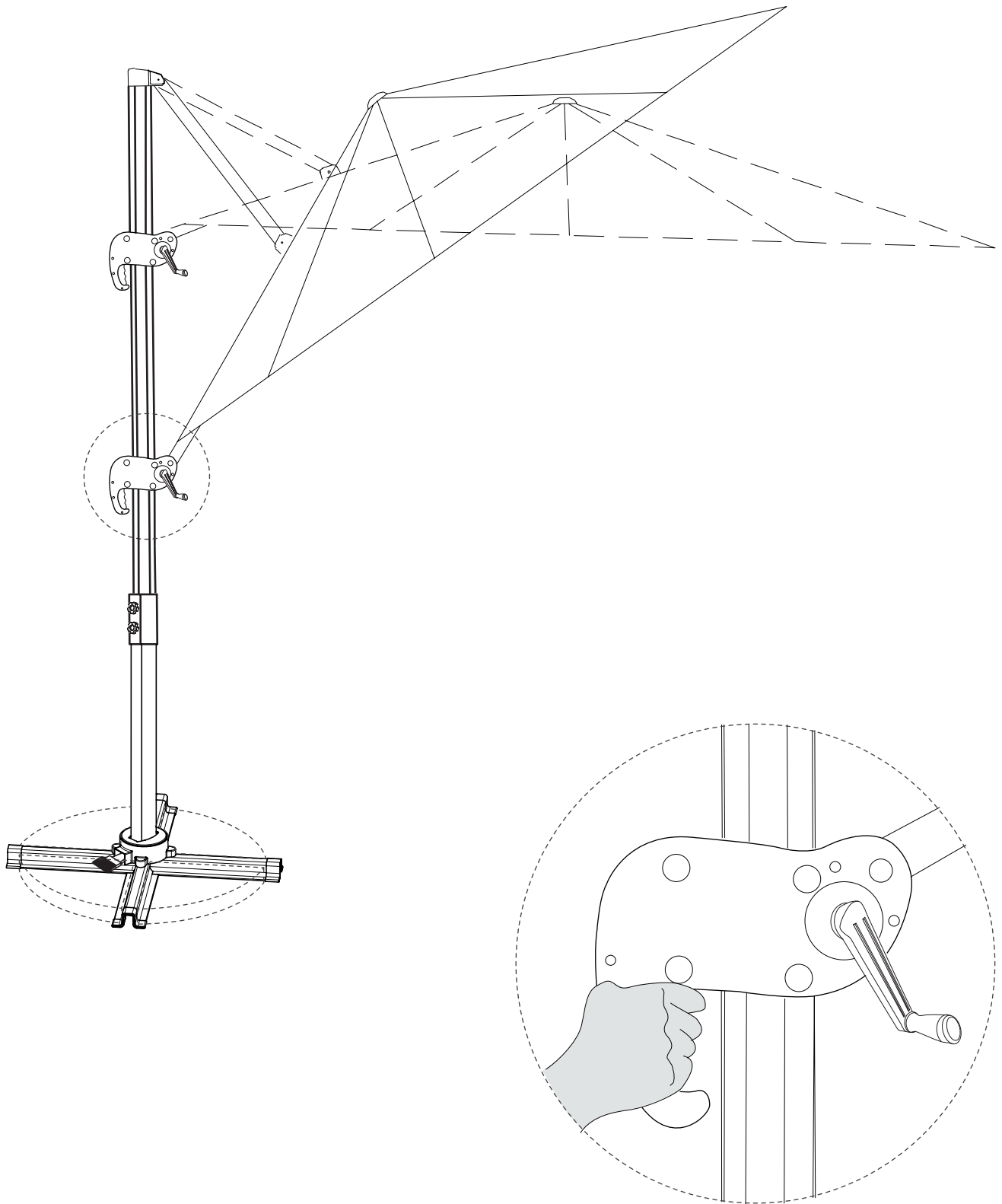

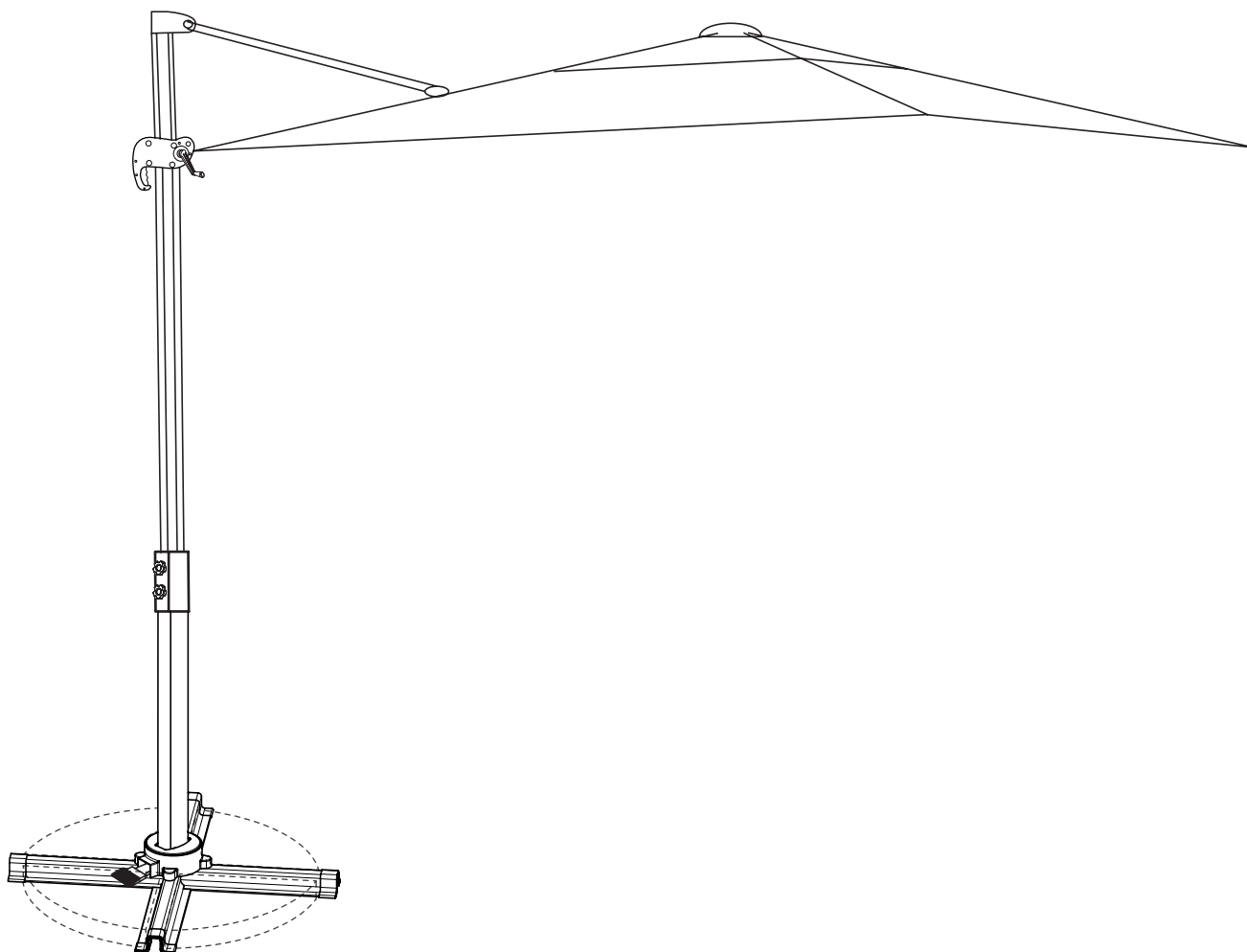

Geschafft!



