

skølm.

Izar
Schränk

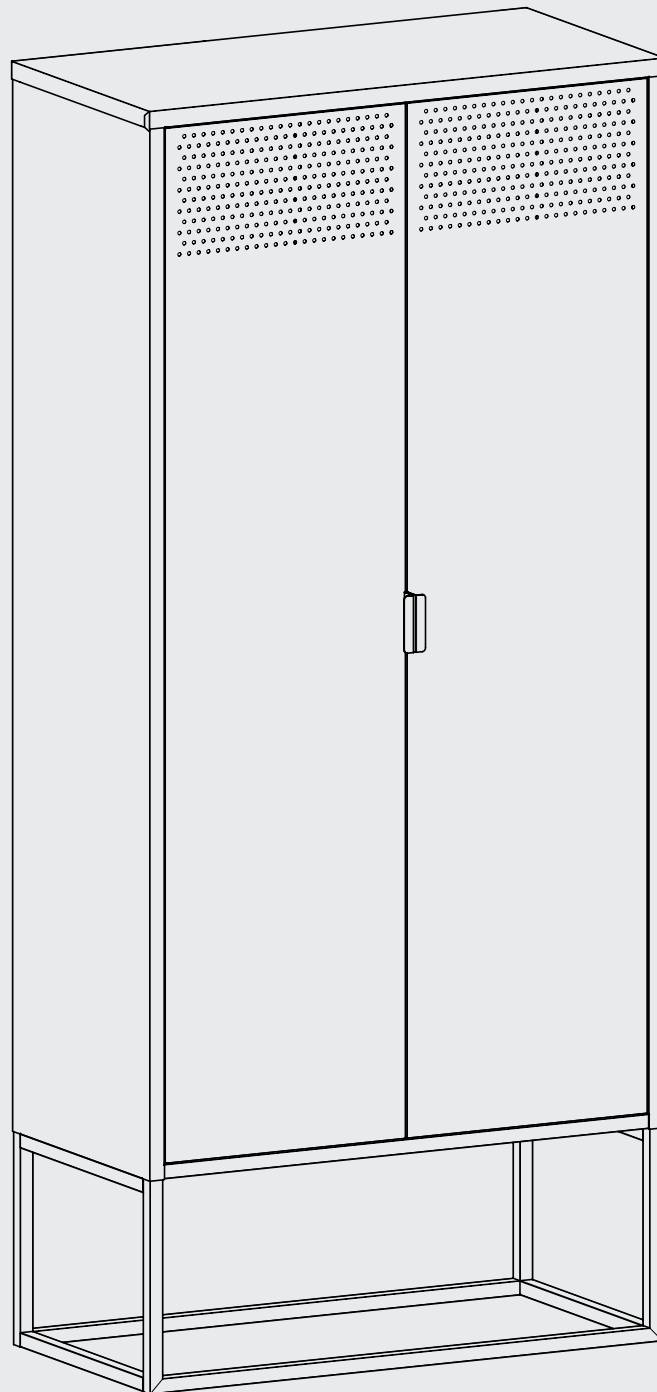



Hey,

wir freuen uns, dass Du Dich für unser Produkt entschieden hast. Beachte die kommenden Hinweise, um den Aufbau problemlos zu gestalten.

Viel Spaß mit Deinem Produkt!

50%

weniger Fehler beim Aufbau durch
sorgfältiges Lesen der Anleitung



30-40
min



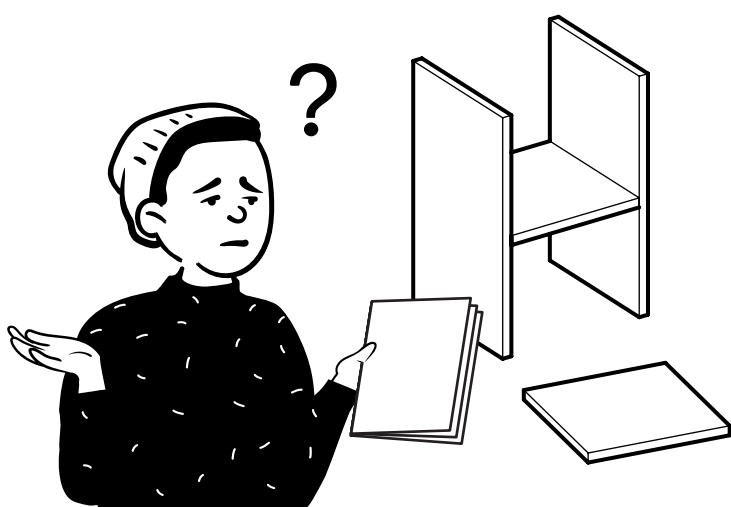
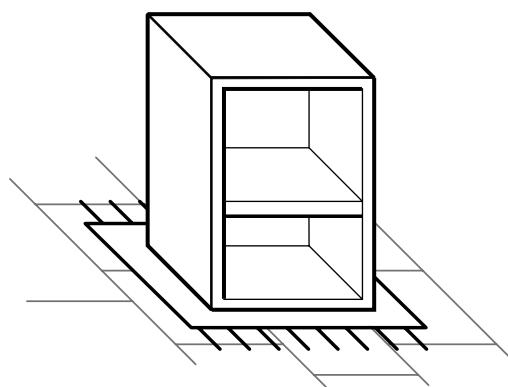
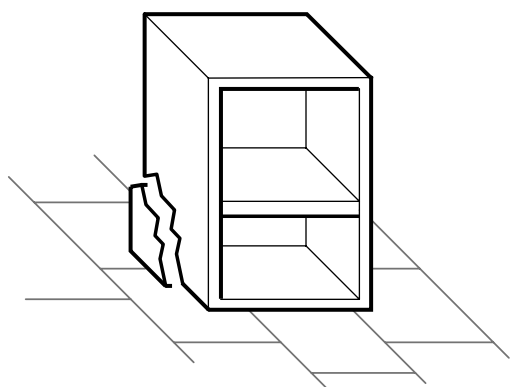

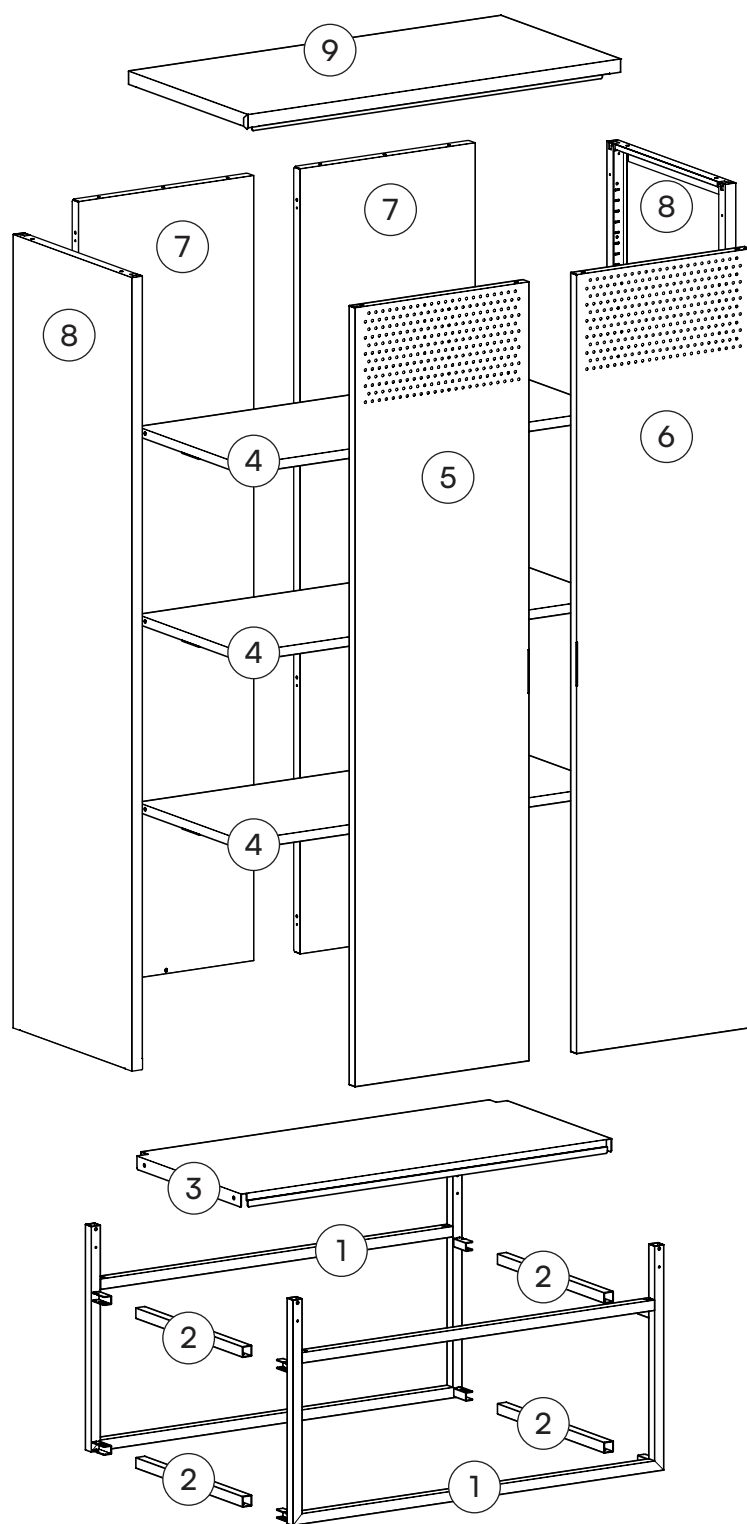

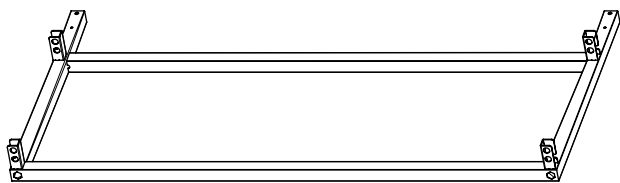

1 Rahmen Fußgestell
2x

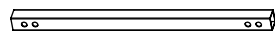

2 Verbindungsleiste Fußgestell
4x



3 Unterboden
1x



4 Fachboden
3x

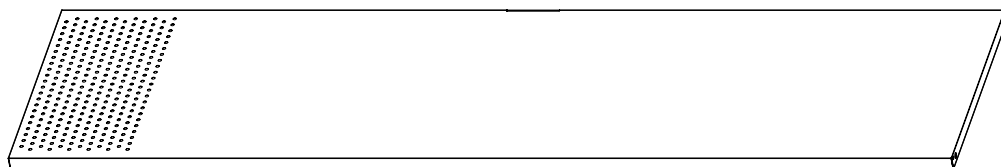

5 Tür, links
1x



6 Tür, rechts
1x

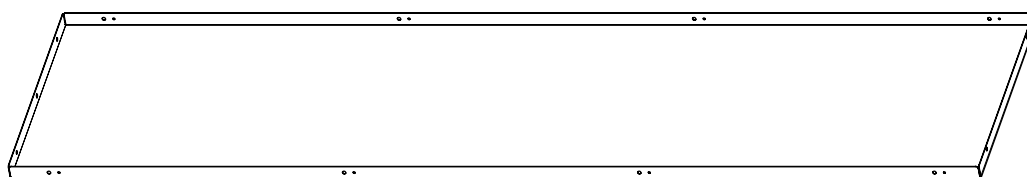

7 Rückwand
2x

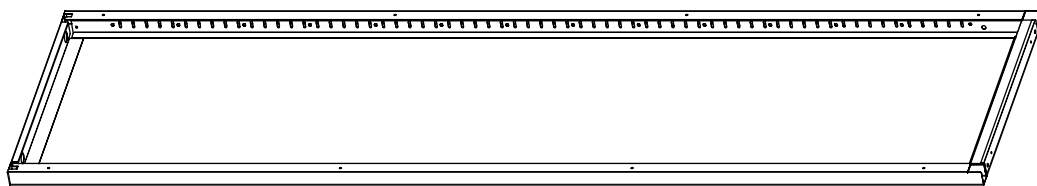

8 Seitenteil
2x

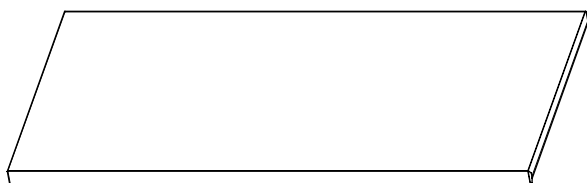

9 Oberboden
1x

K10 - Schraube, groß



24x

K13 - Schraube, klein



4x

G25 - Kreuzschraube

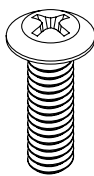

16x

L18 - Magnet

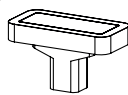

4x

L20 - Fuß

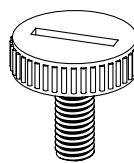

4x

L19 - Beilagscheibe



2x

C14 - Bolzen

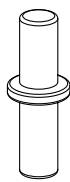

2x

L21 - Regalhalter

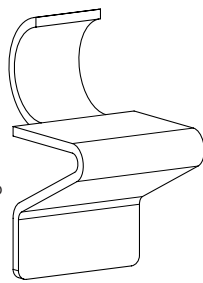

12x

L35 - Griff

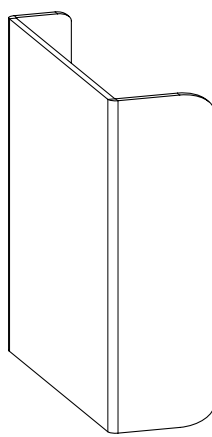

2x

L22 - Schutzkappe



4x

Ein letzter Check:

Bitte überprüfe, ob Du alle Teile hast.

Viel Spaß beim Aufbau!

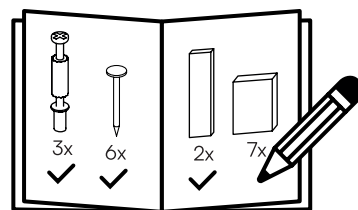

7

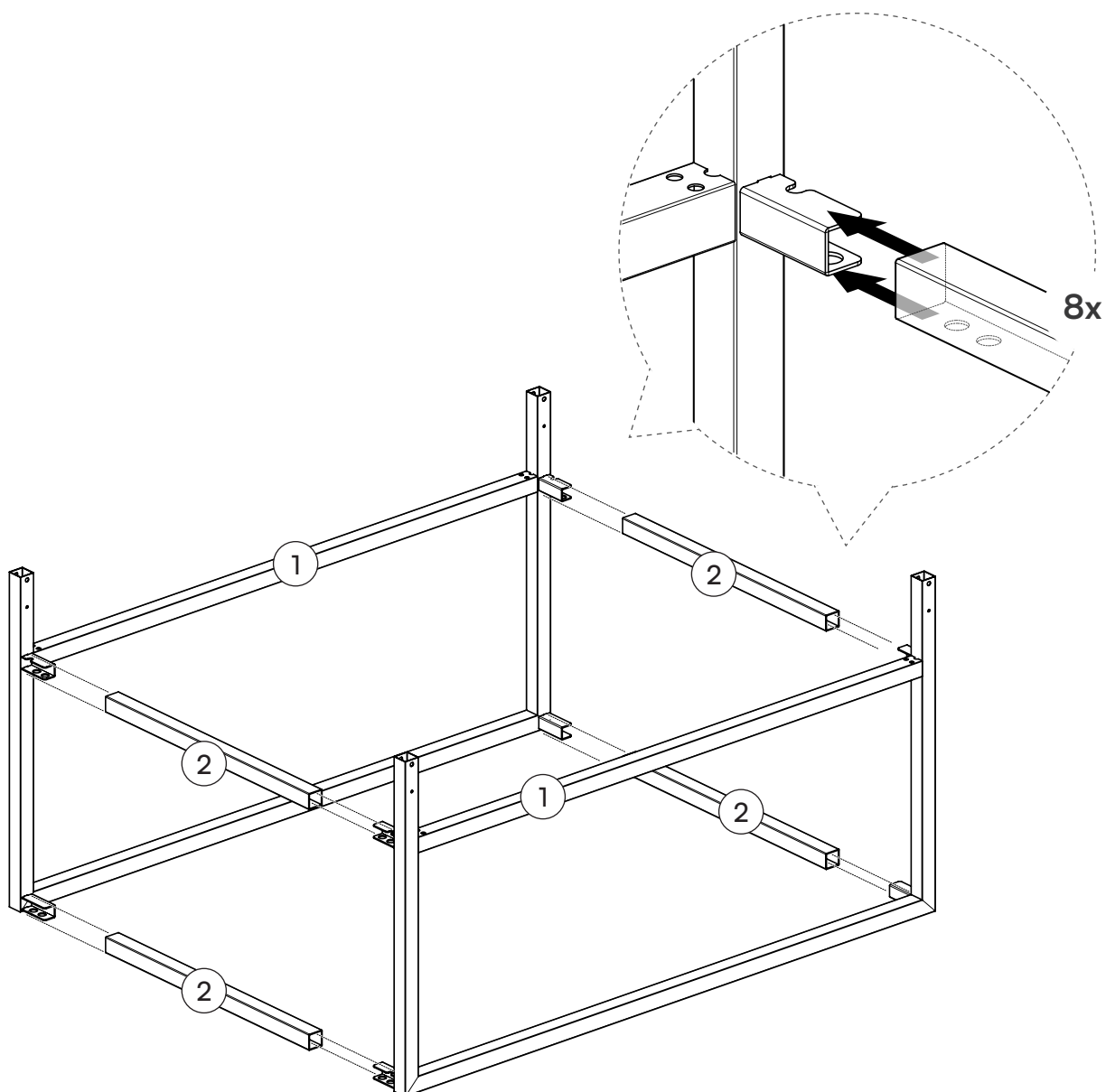

2

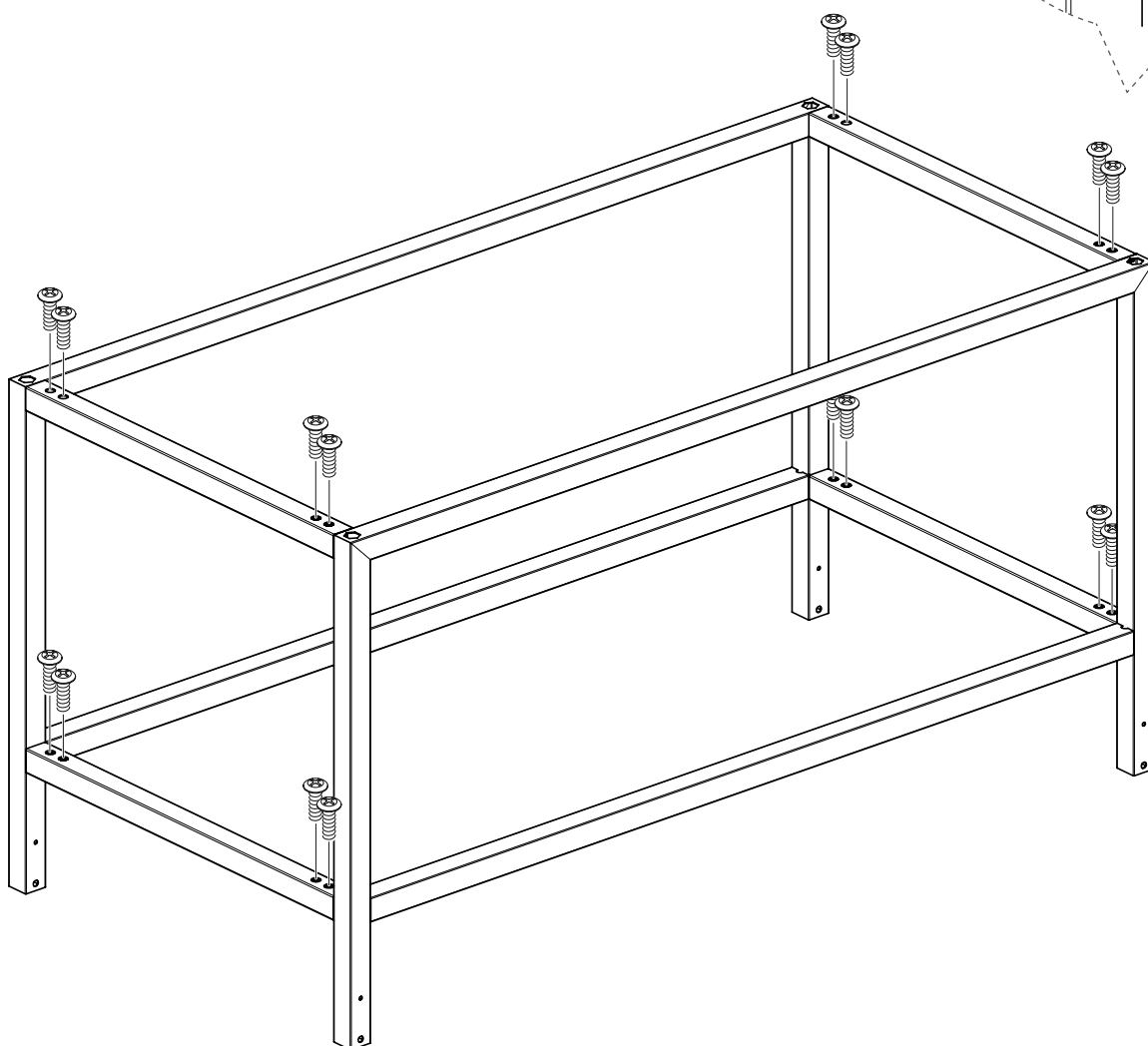
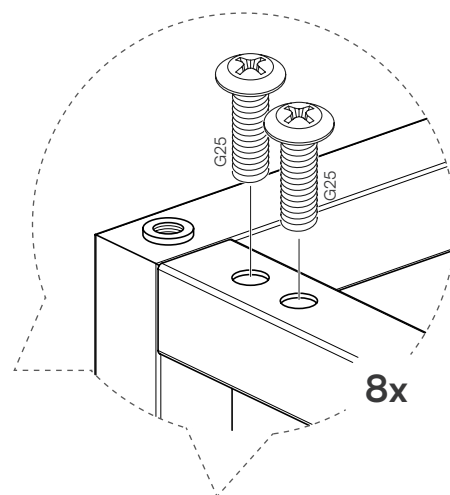
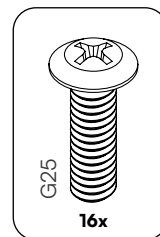
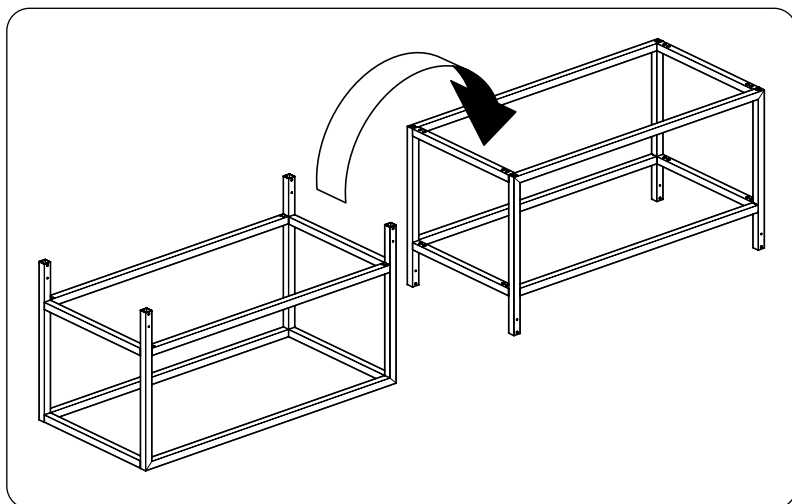

3

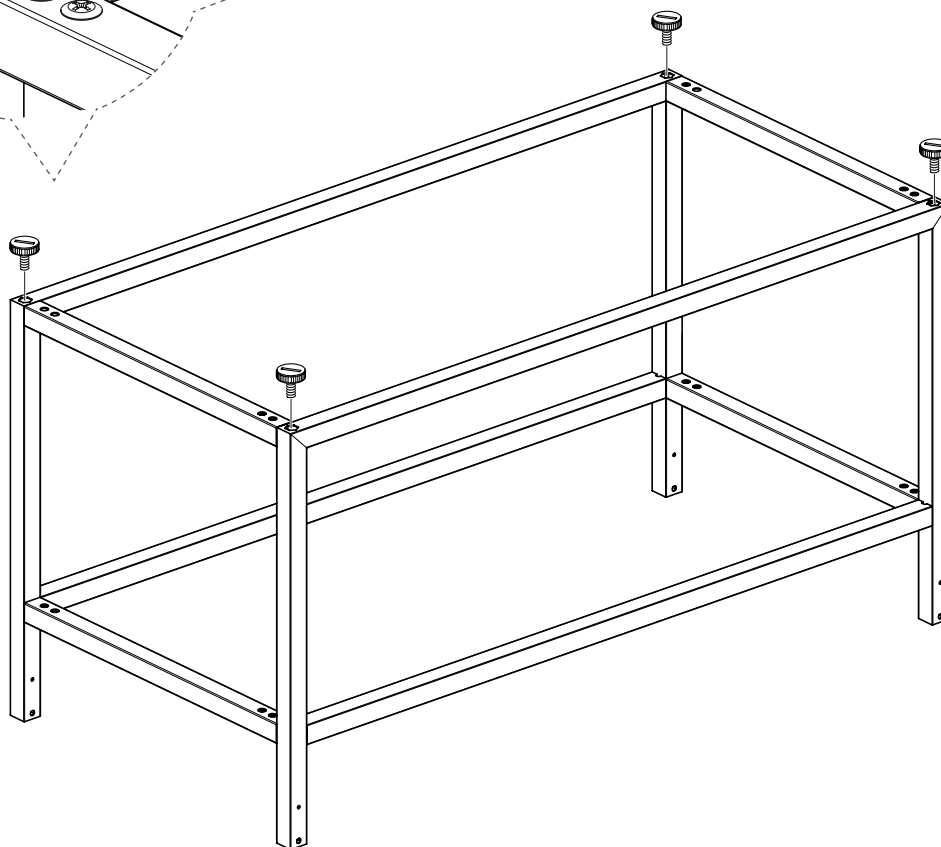
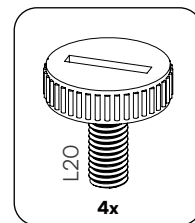
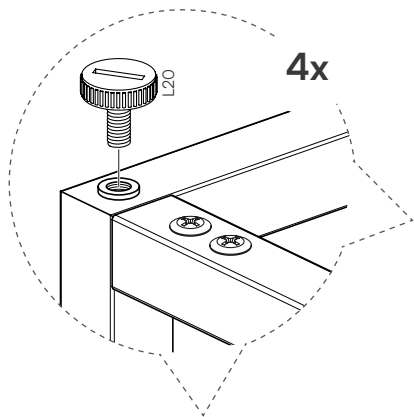

4

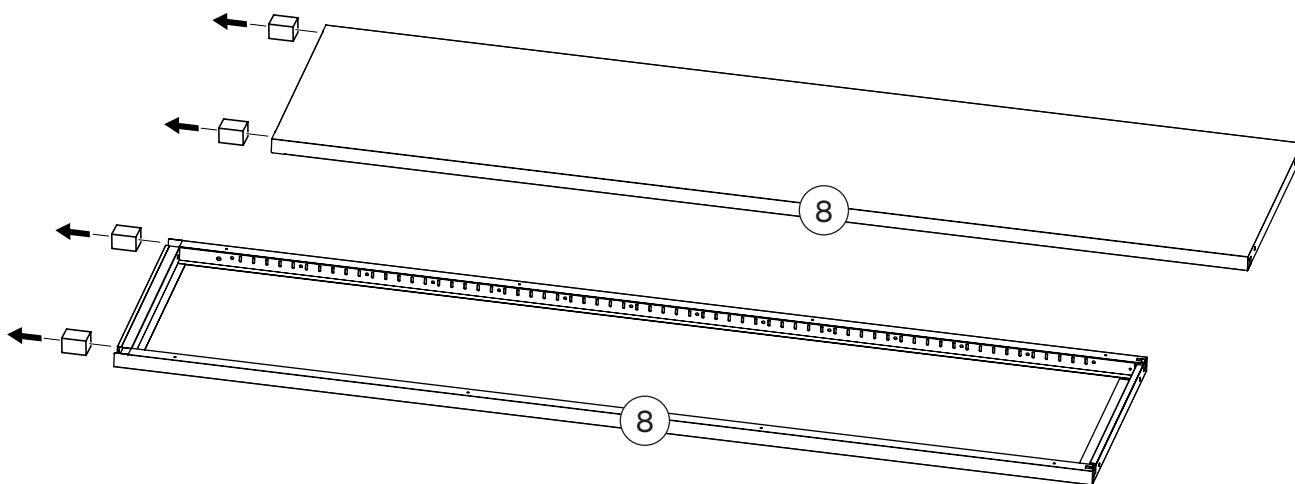

5

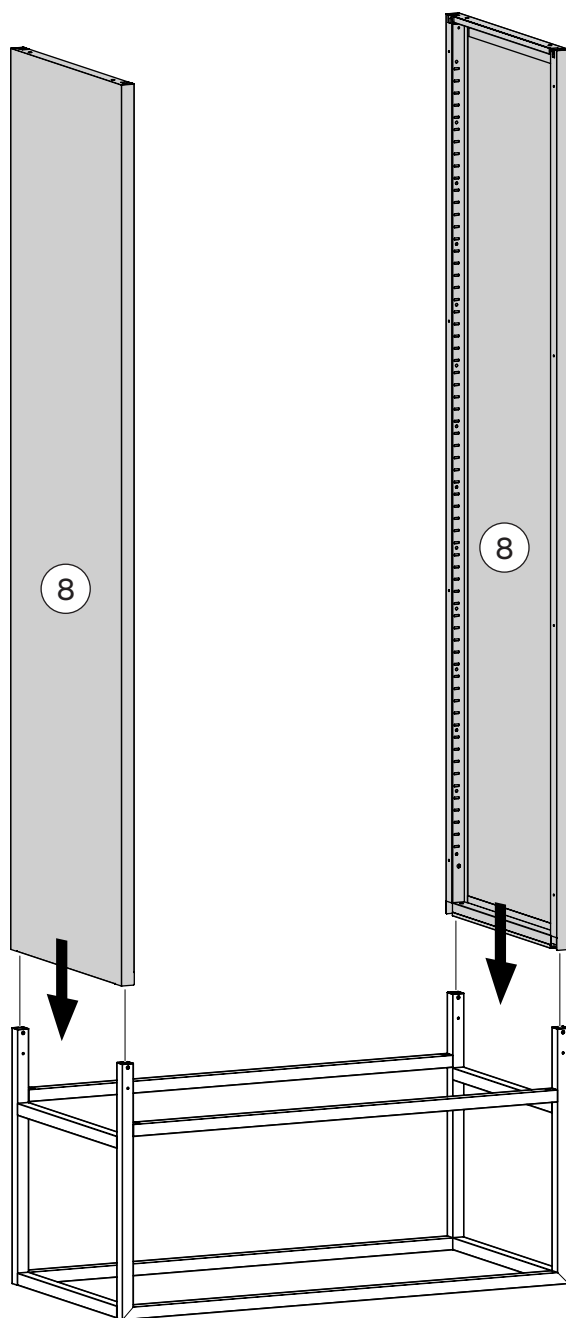
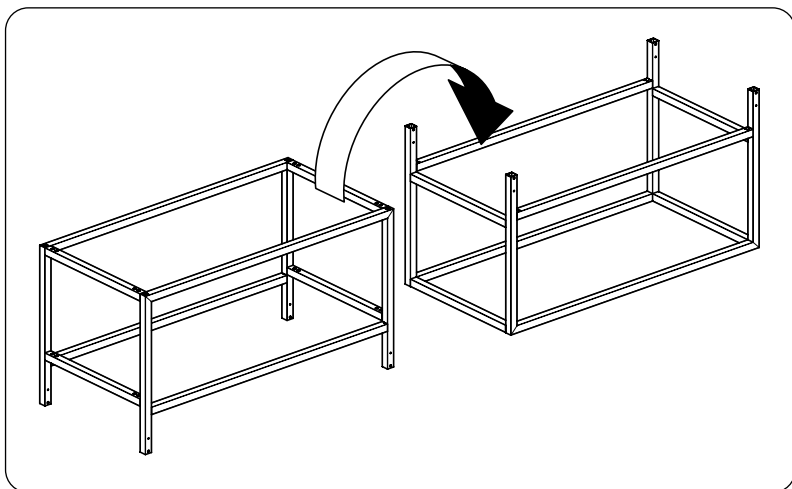

6

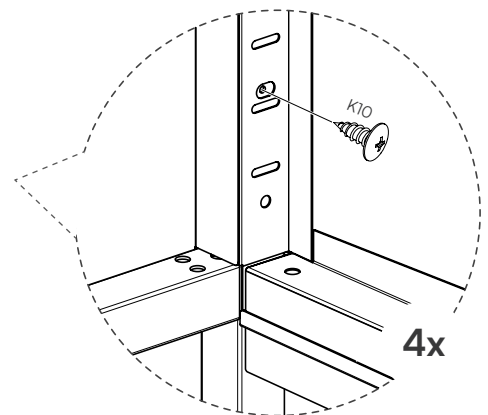
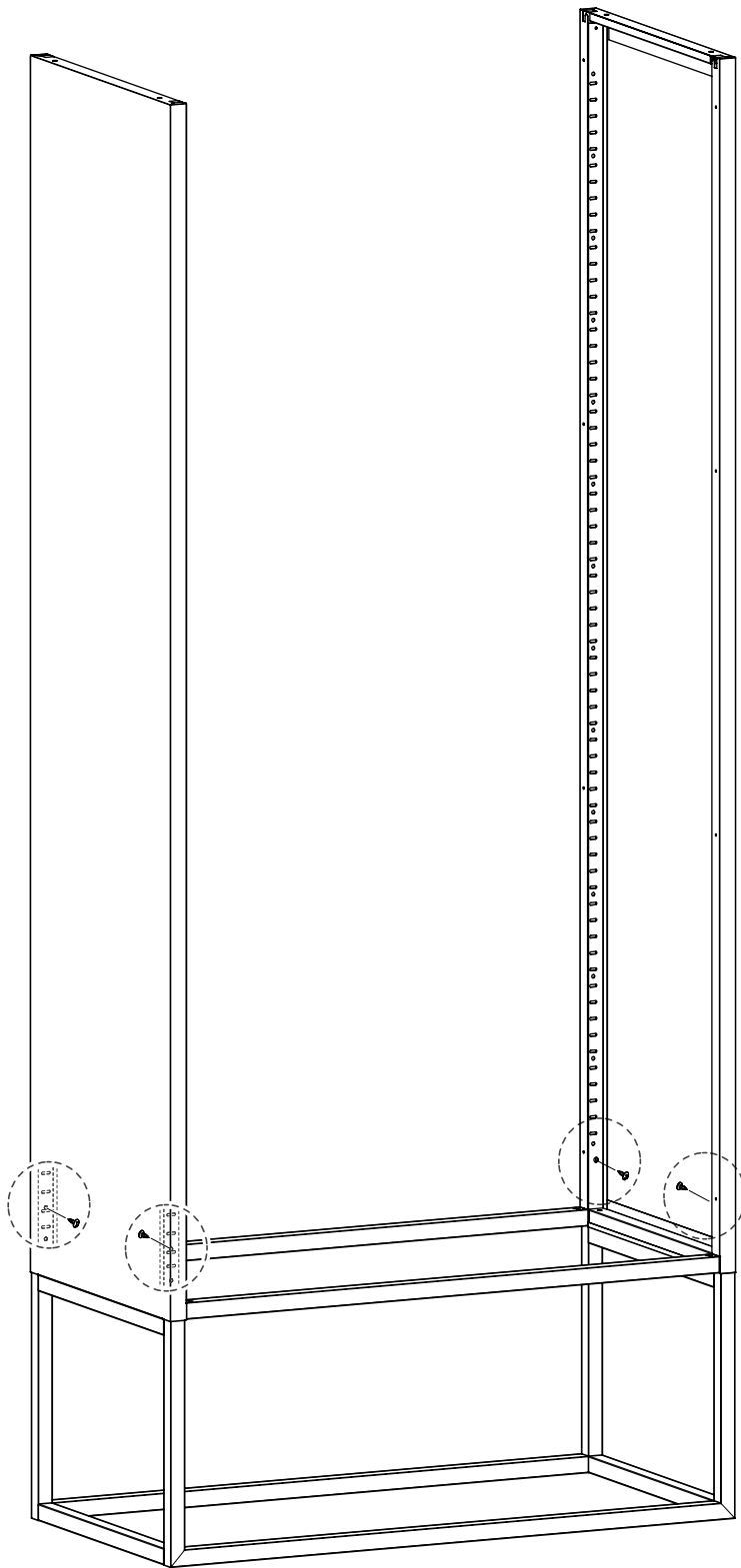

7

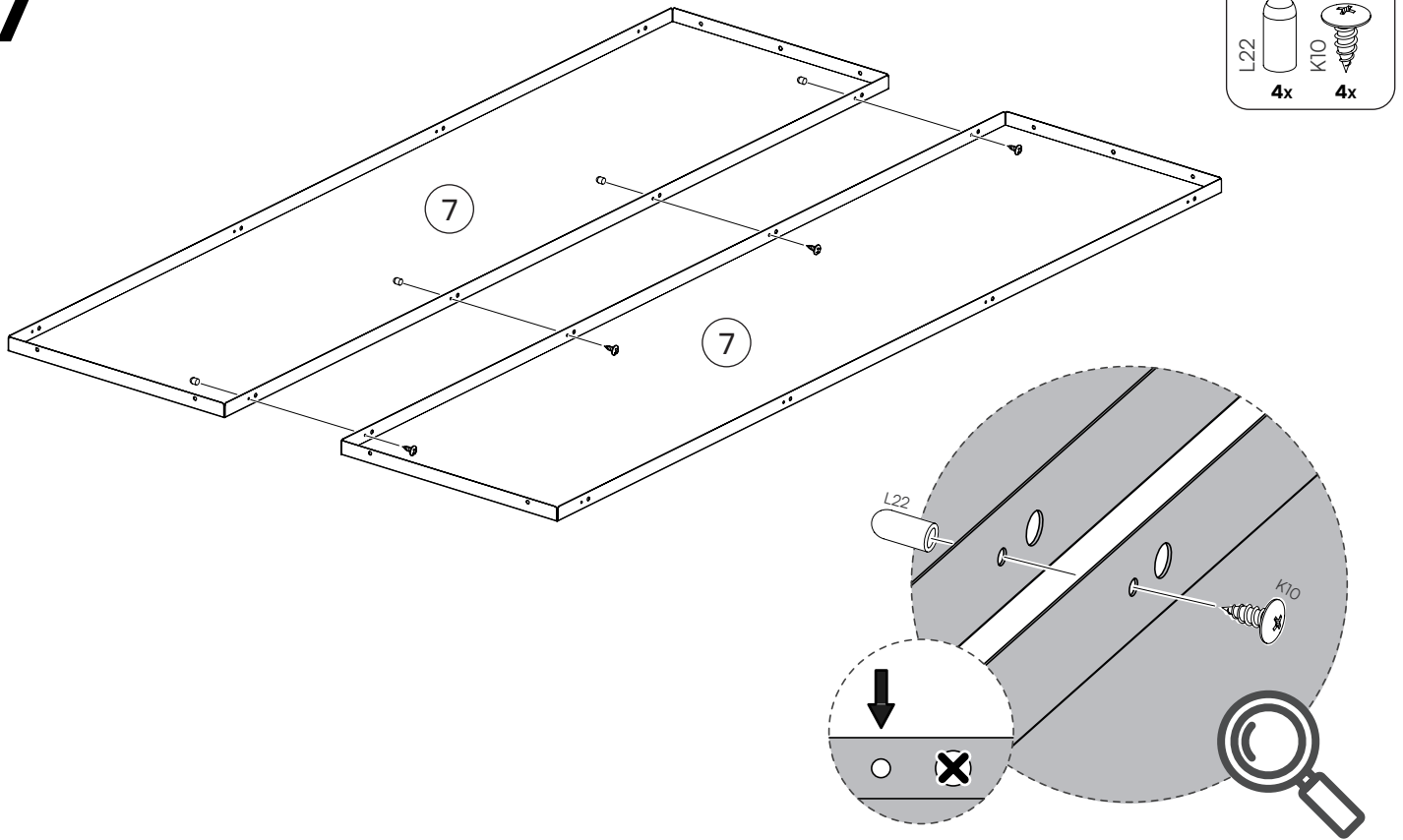

8

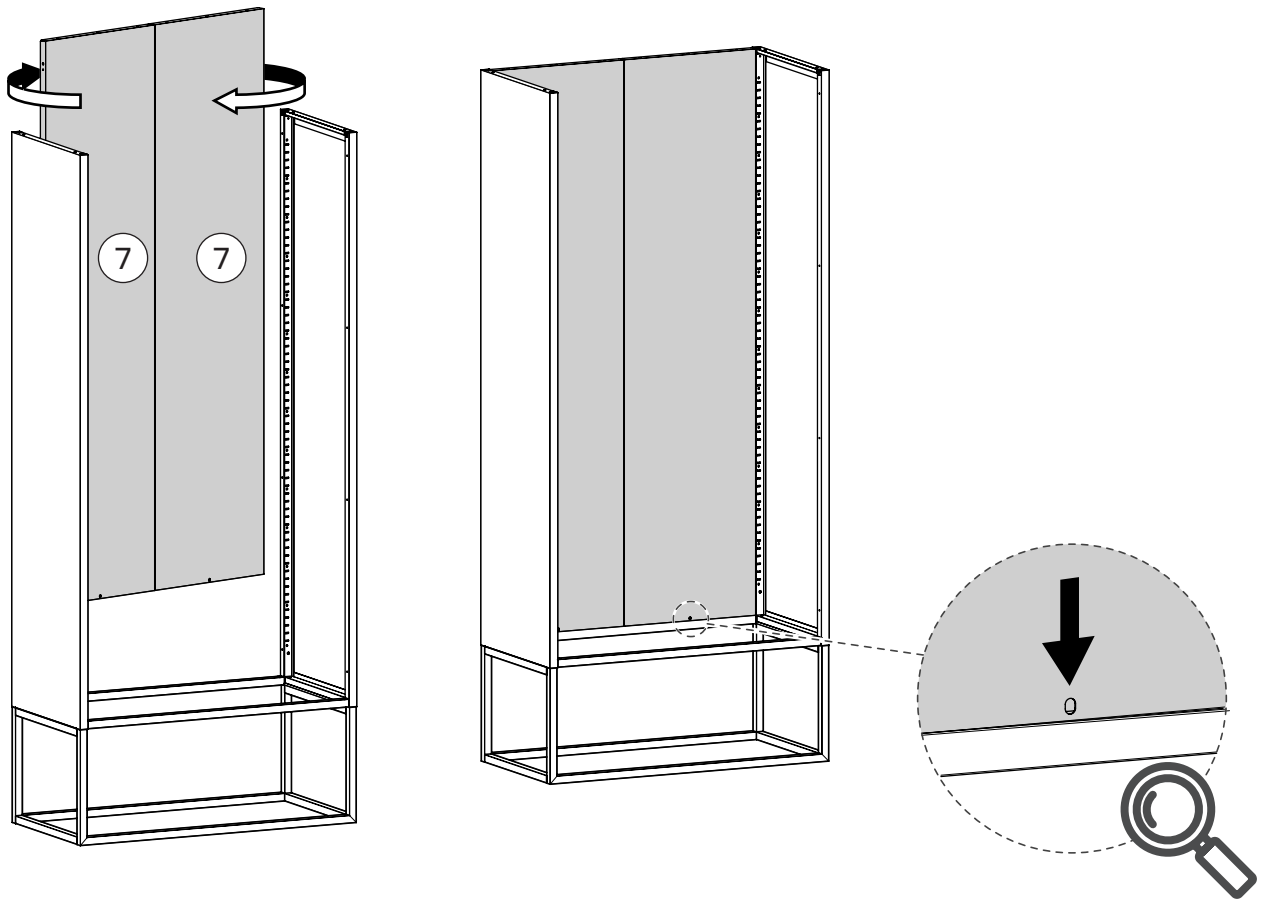

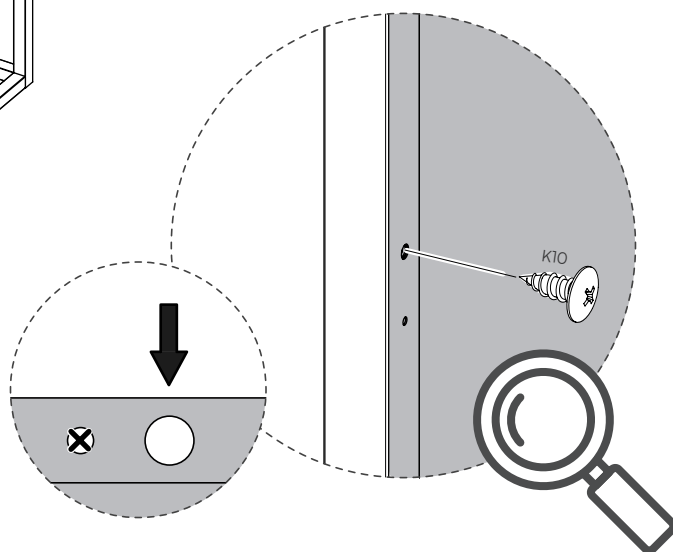
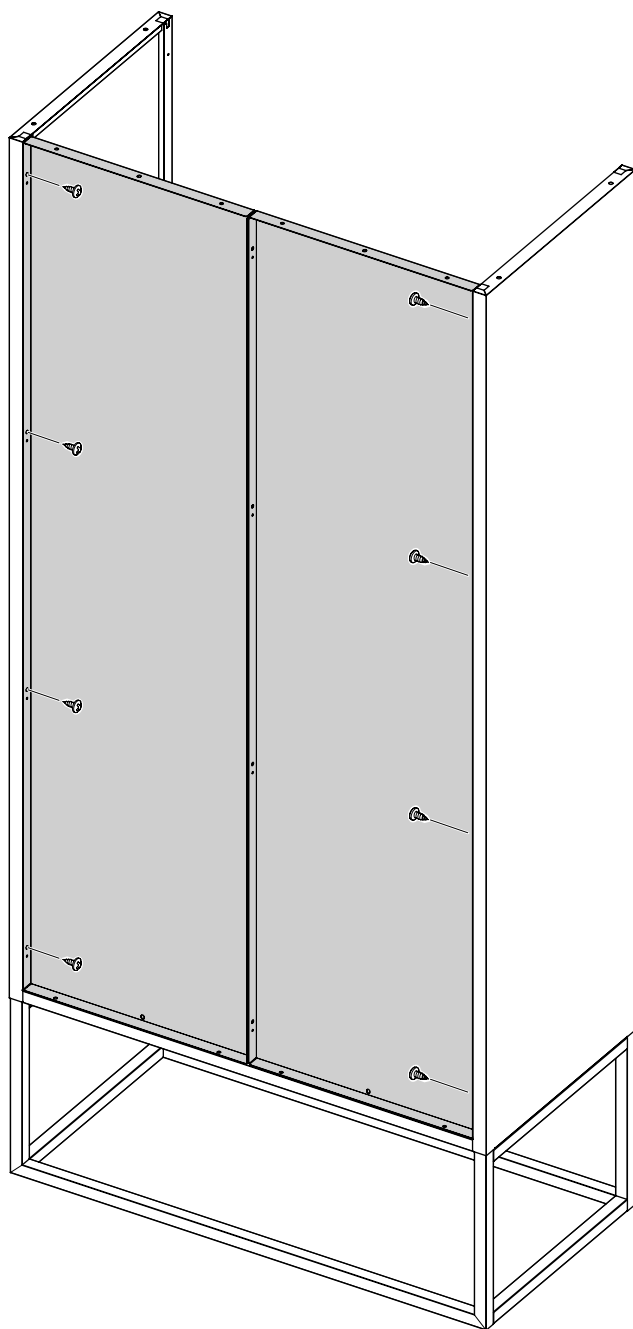
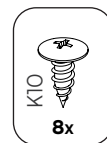

10

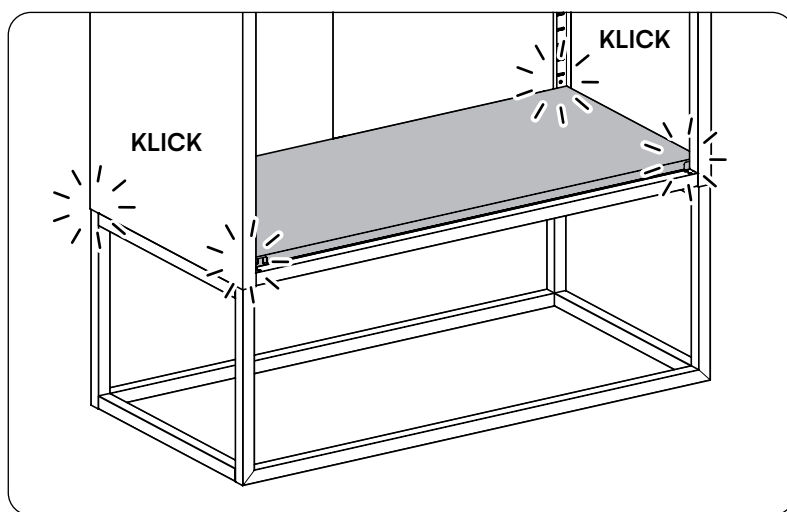
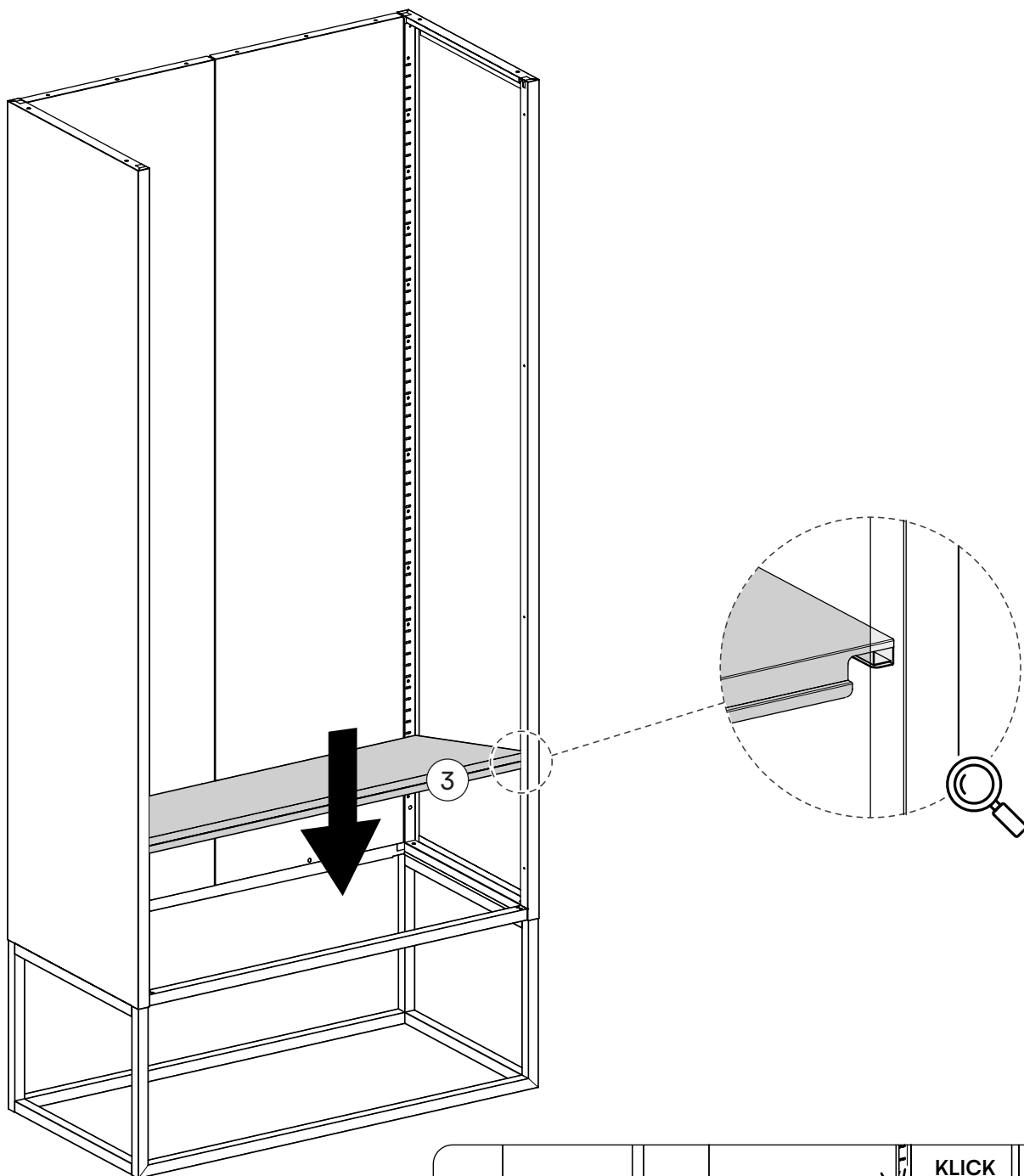

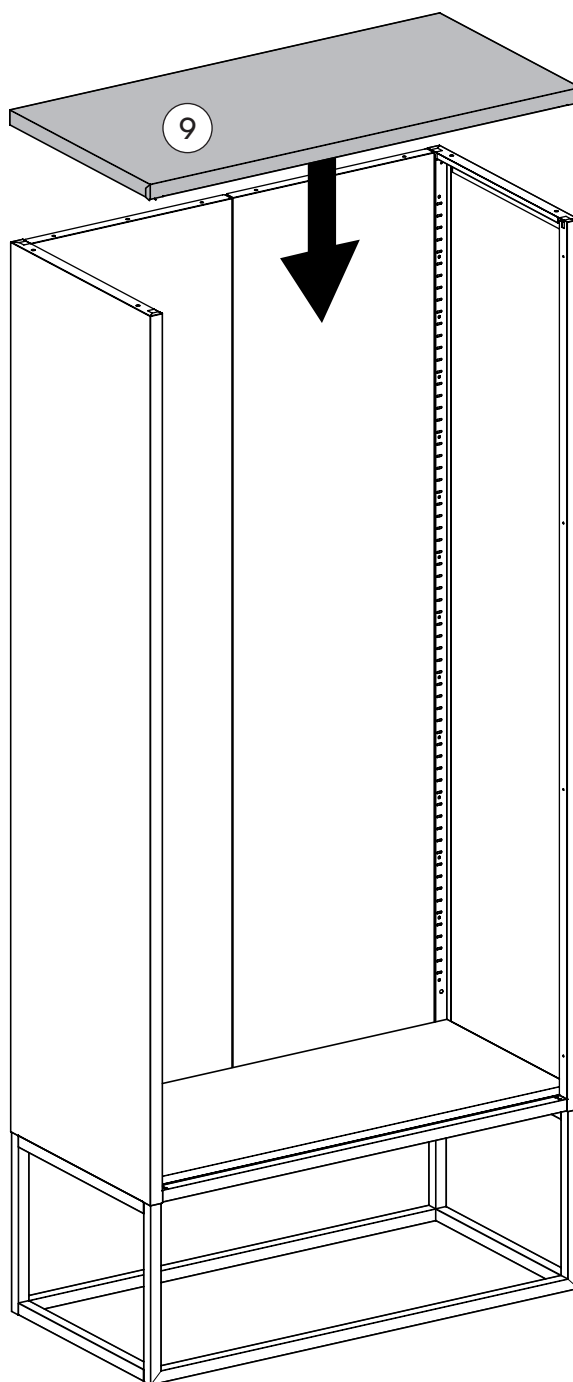
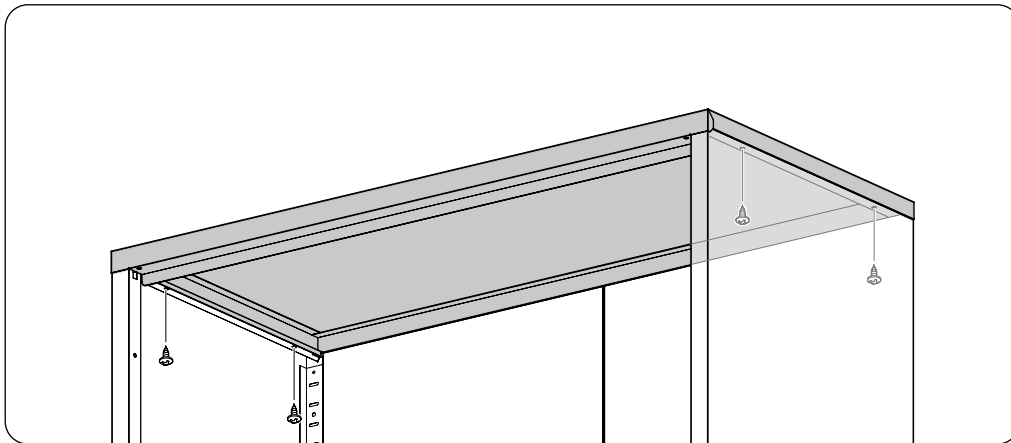

12

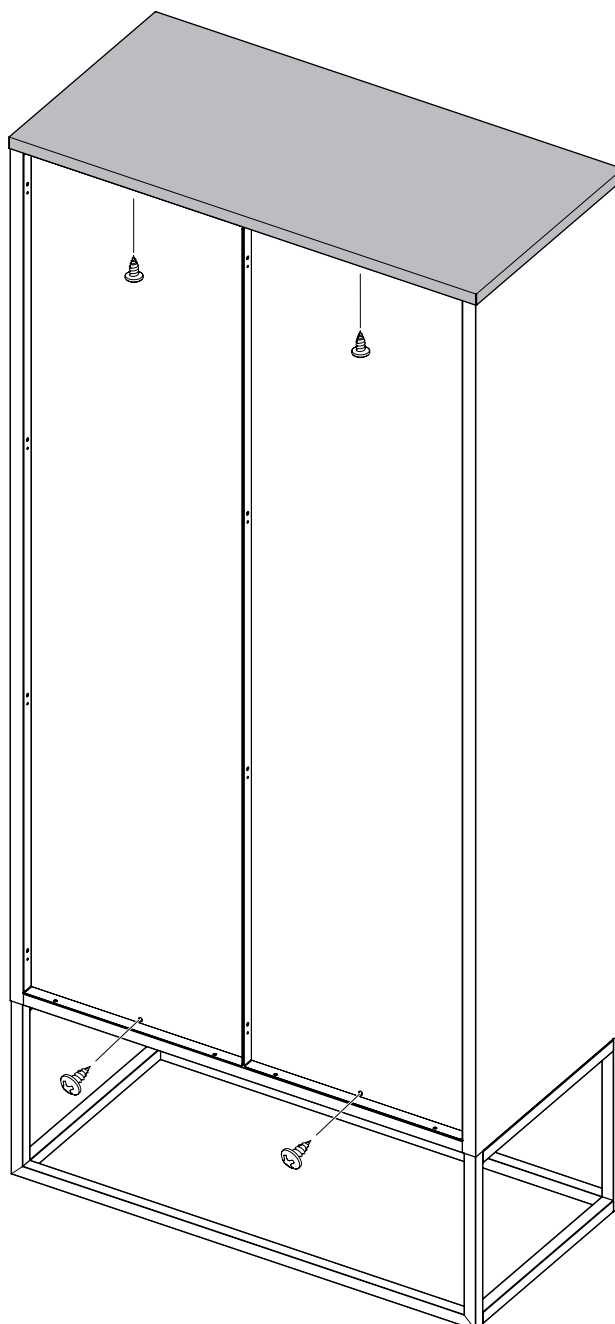
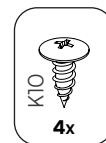
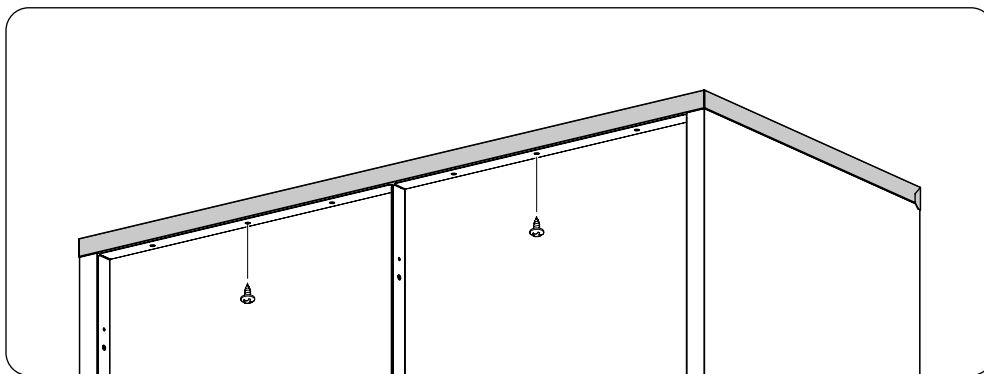

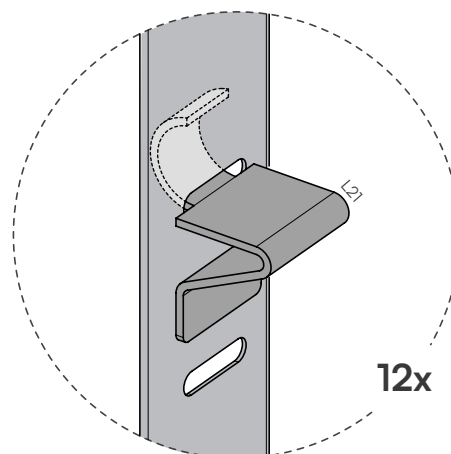
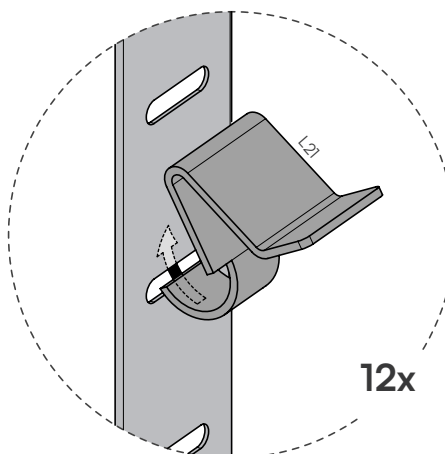
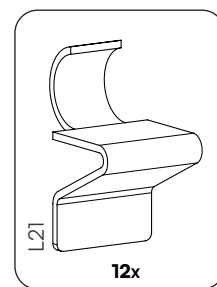
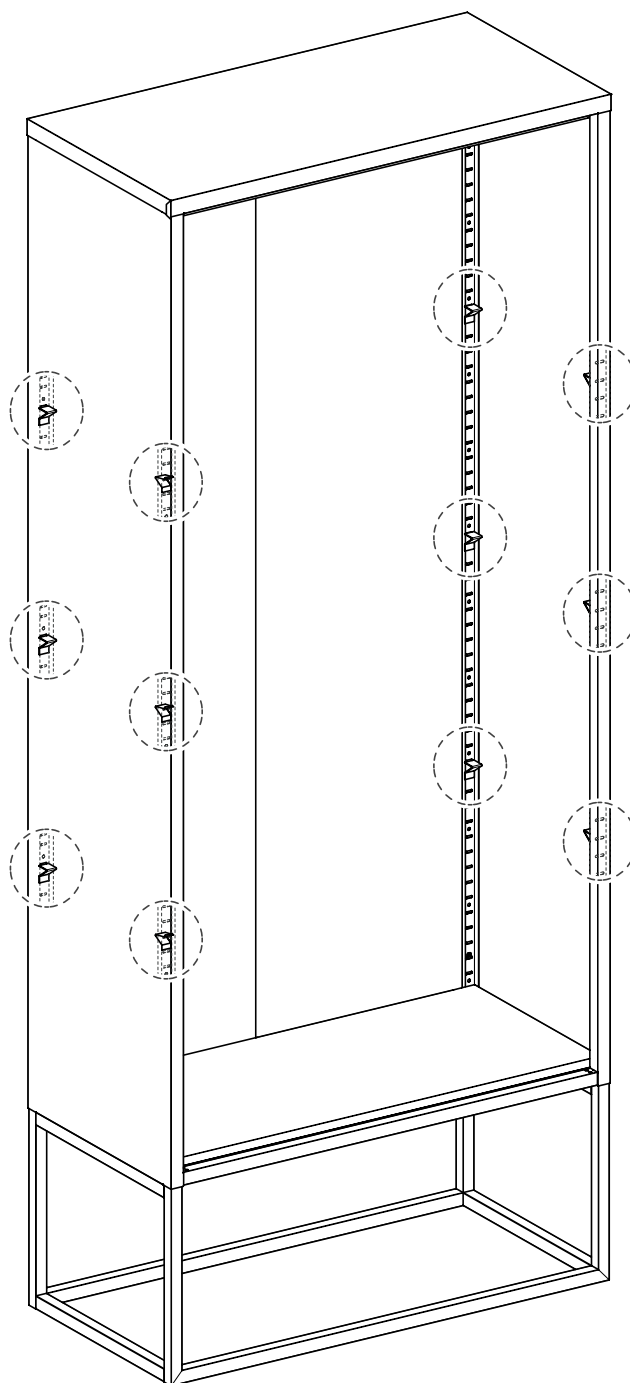

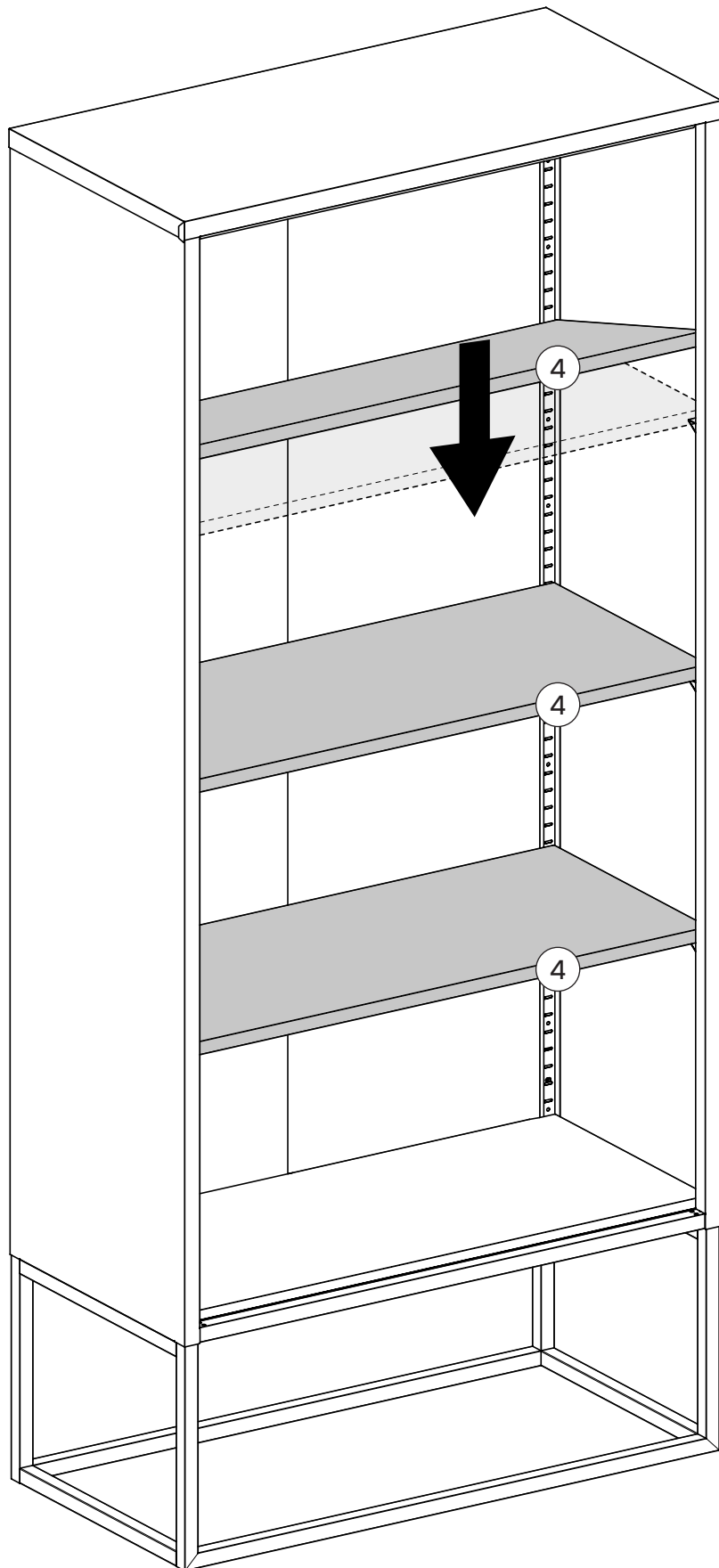

15

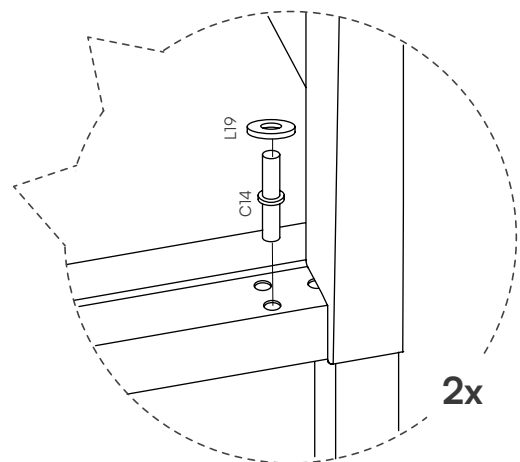
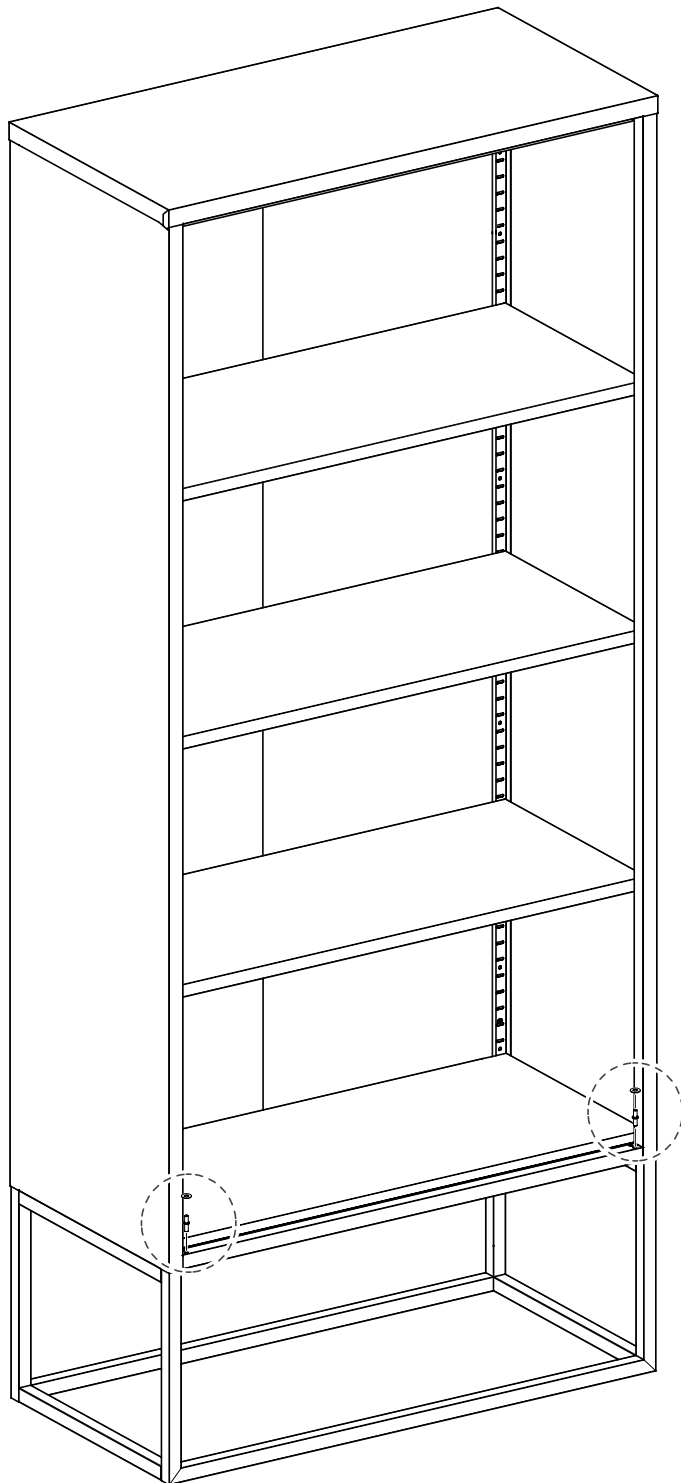
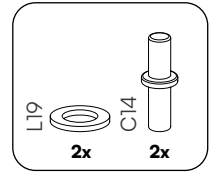

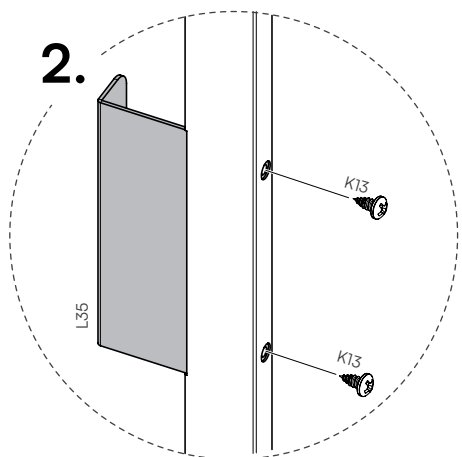
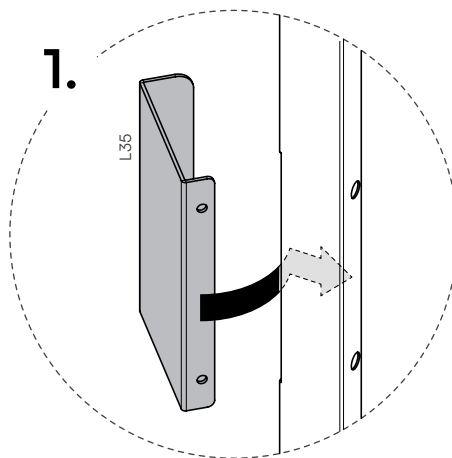
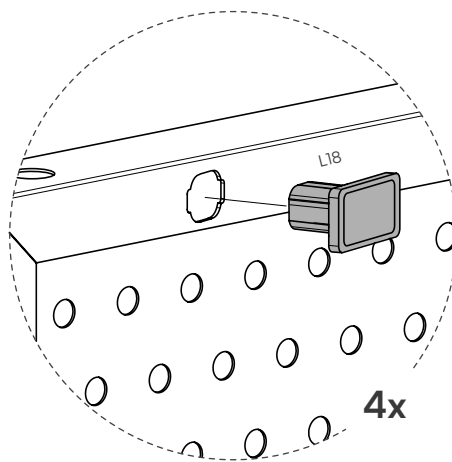
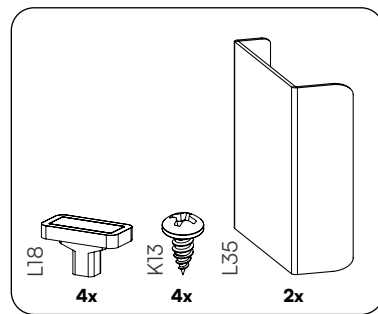
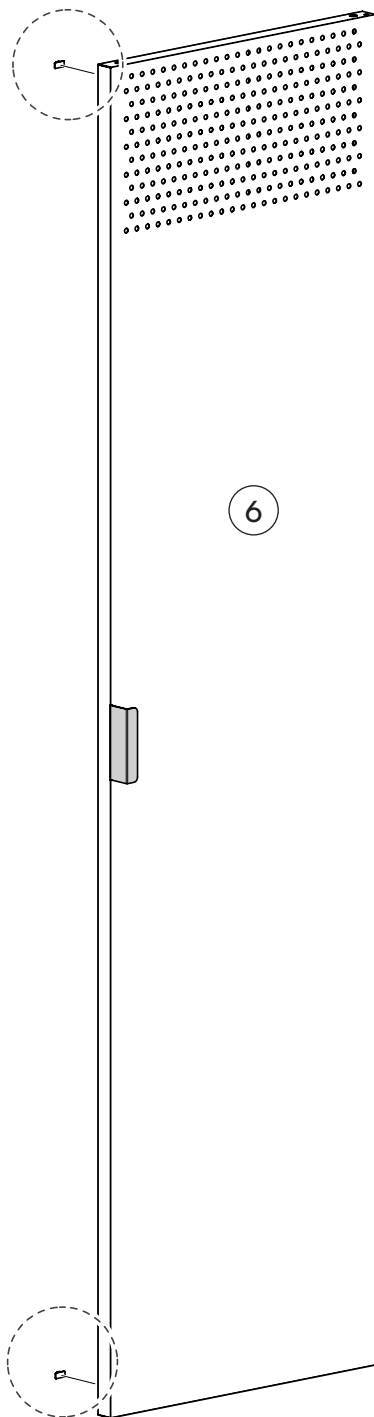
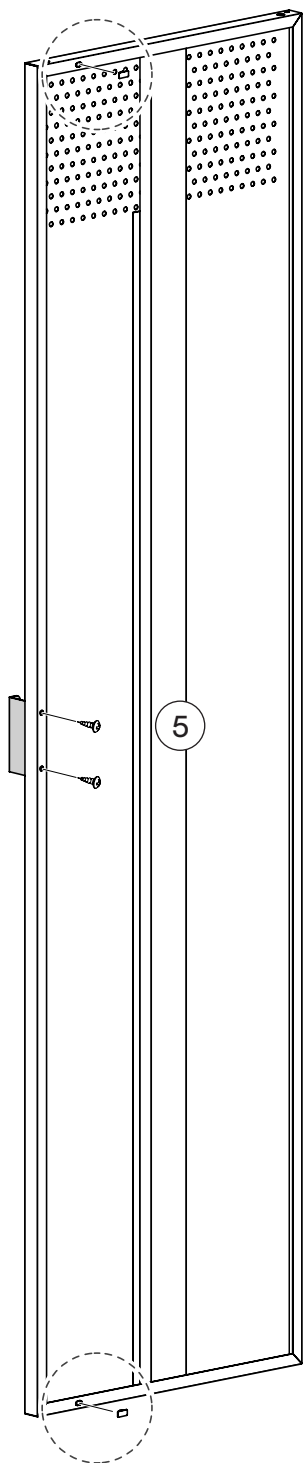

17

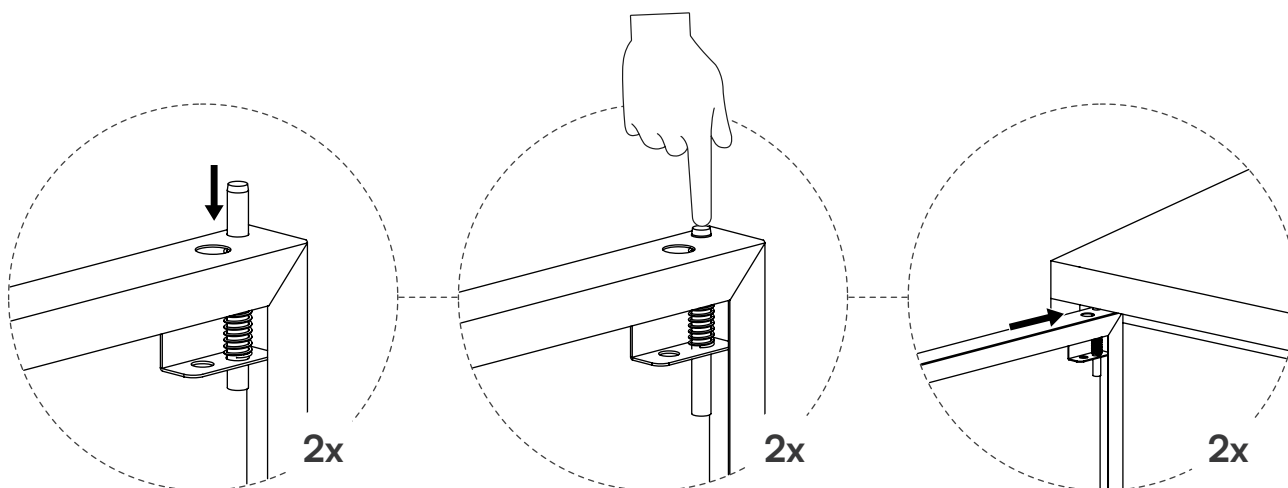
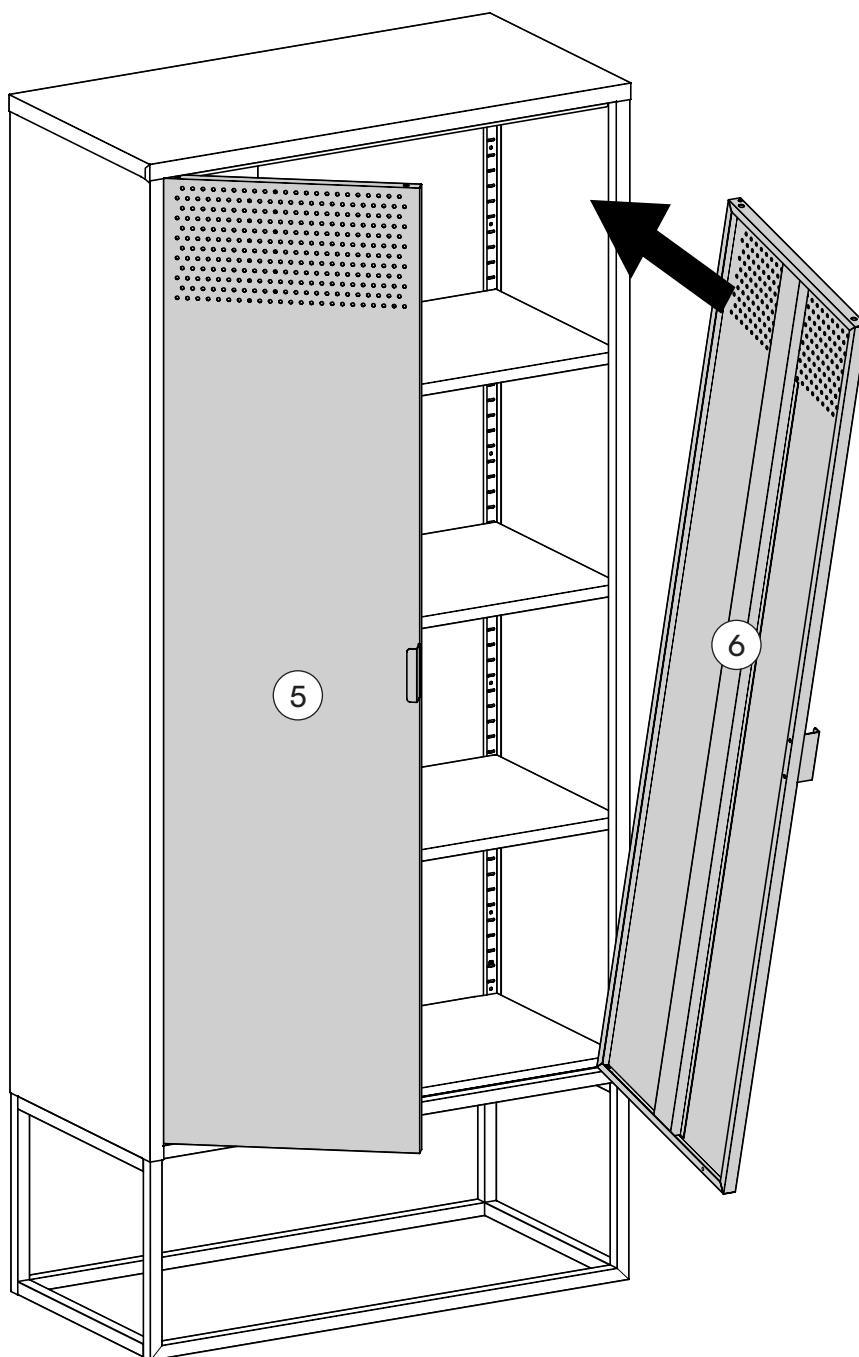

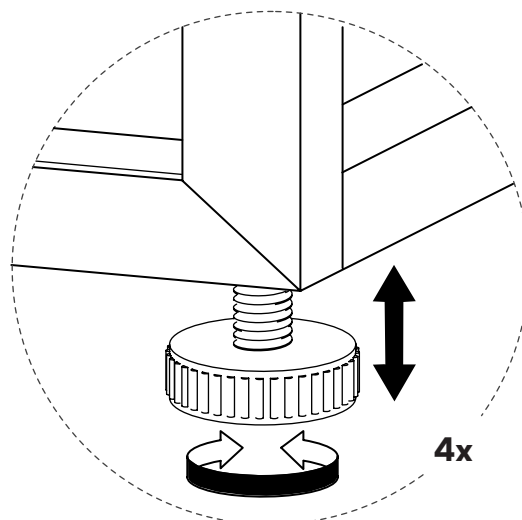
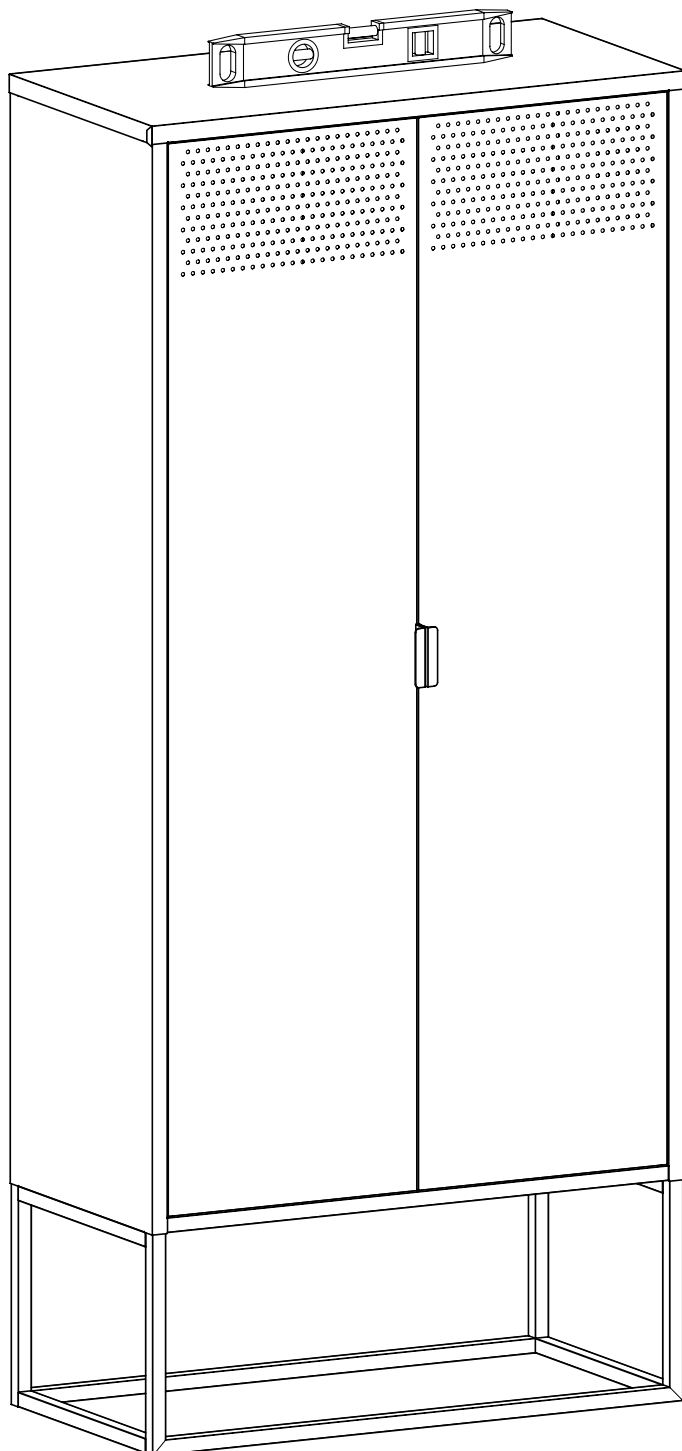
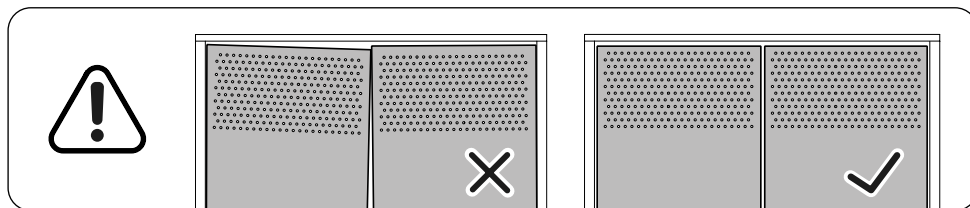

Geschafft!



