

# STEELSØN

Wäschesammler 'Rigil', 3 Körbe

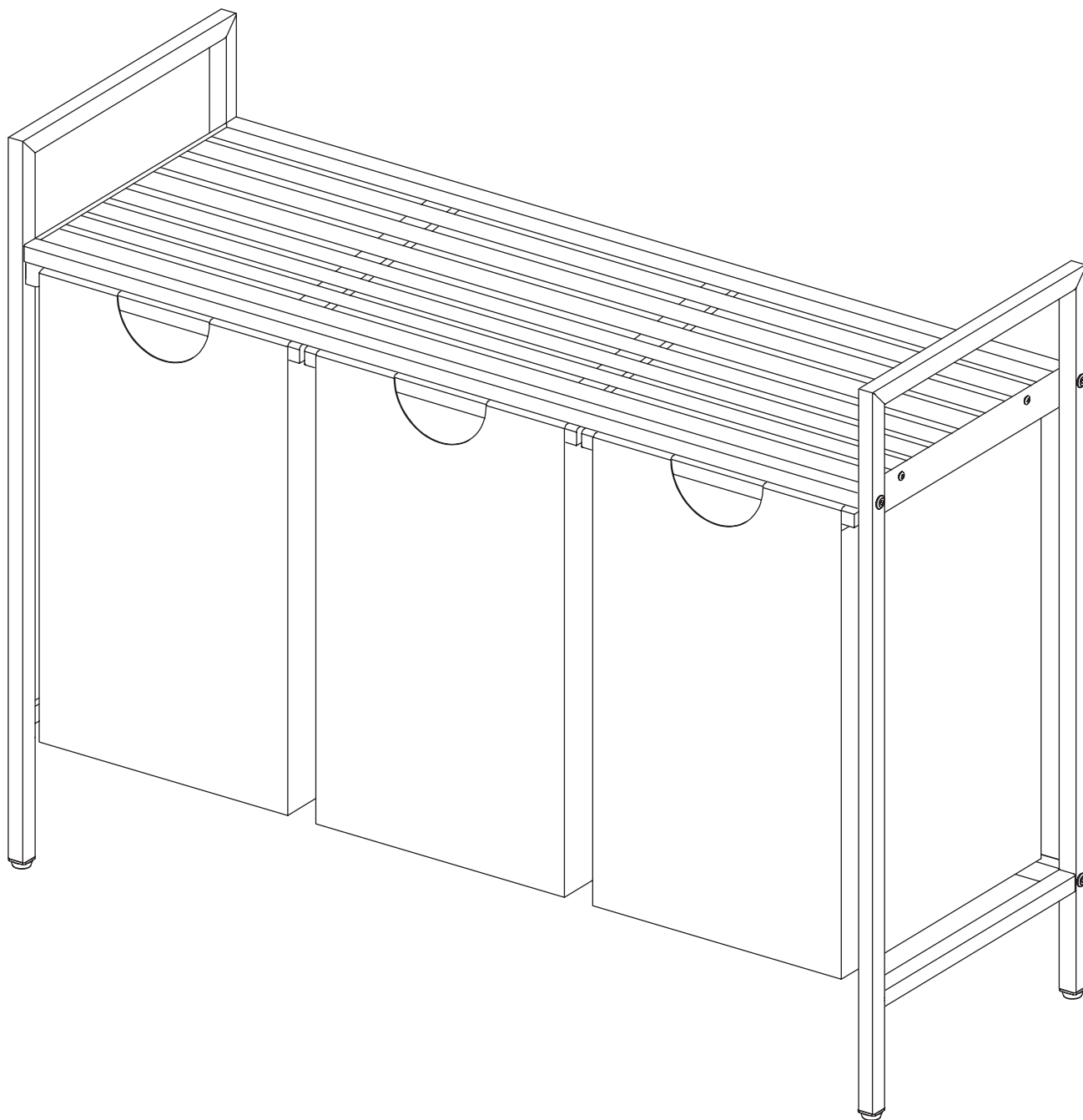



# Hey,

wir freuen uns, dass Du Dich für unser Produkt entschieden hast. Beachte die kommenden Hinweise, um den Aufbau problemlos zu gestalten.

**Viel Spaß mit Deinem Produkt!**

# 50%

weniger Fehler beim Aufbau durch  
sorgfältiges Lesen der Anleitung



## 15-25

min



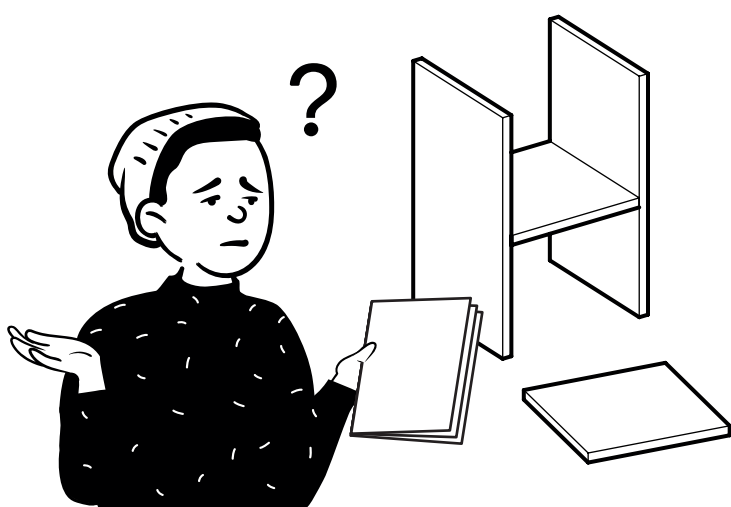
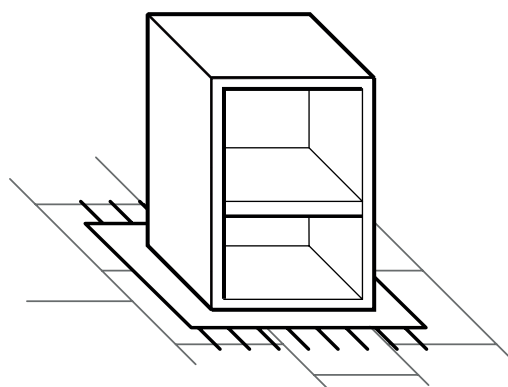
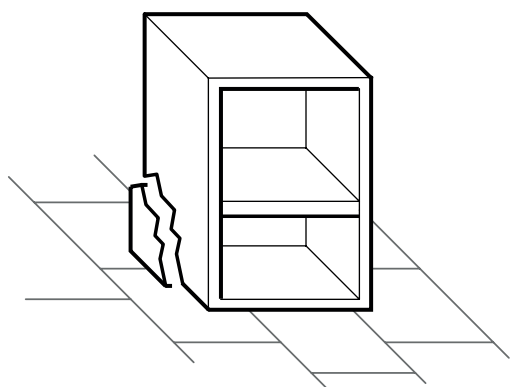

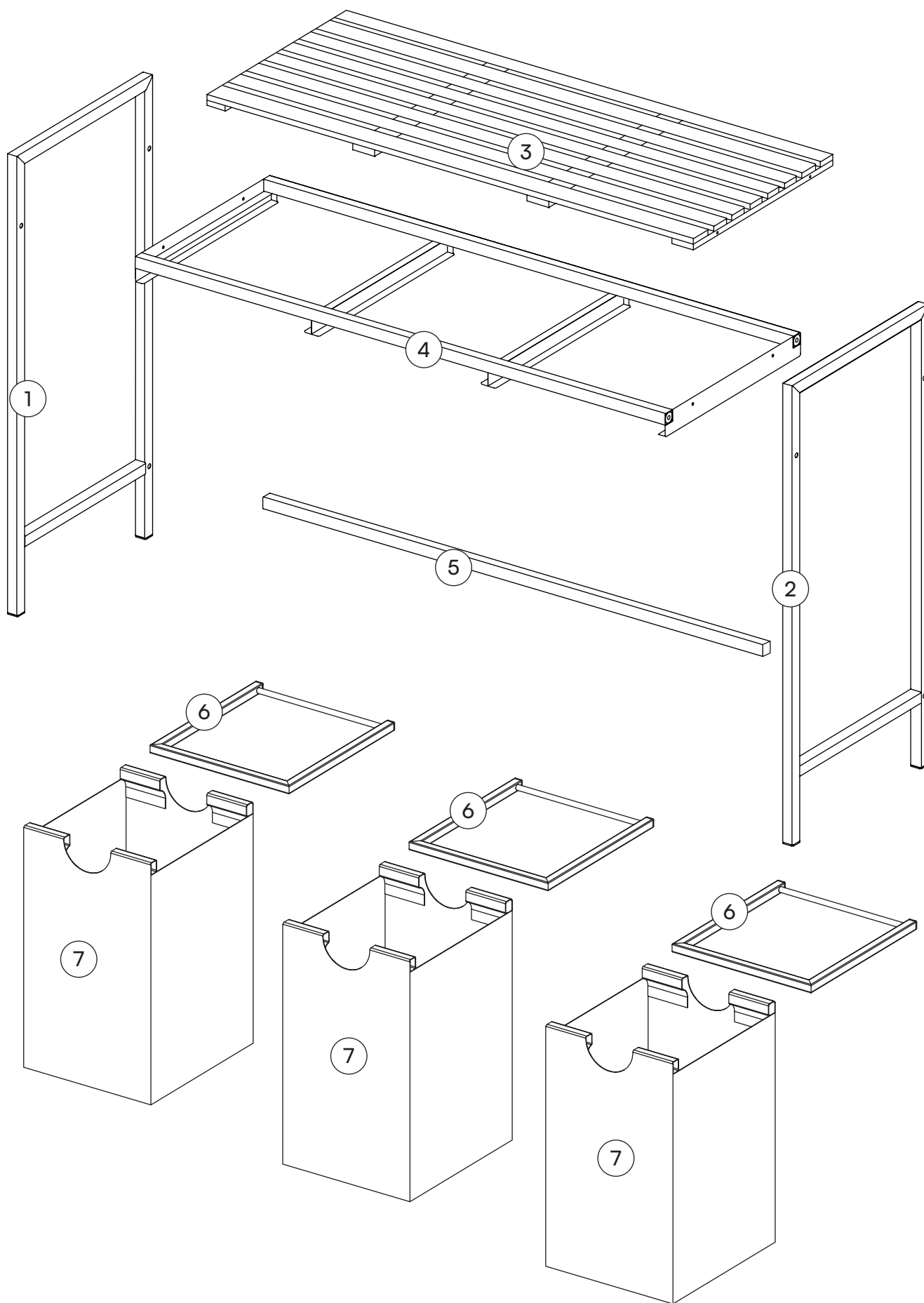

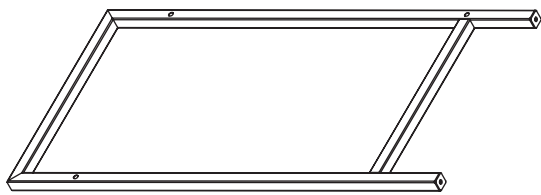

1 Seitenteil, links  
1x

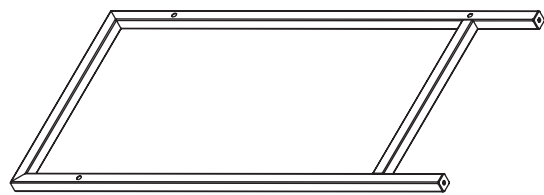

2 Seitenteil, rechts  
1x

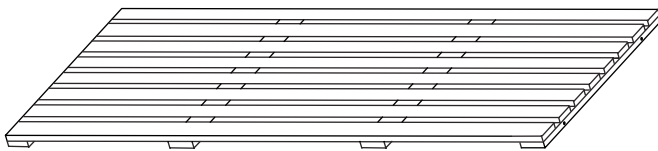

3 Obere Abdeckplatte  
1x

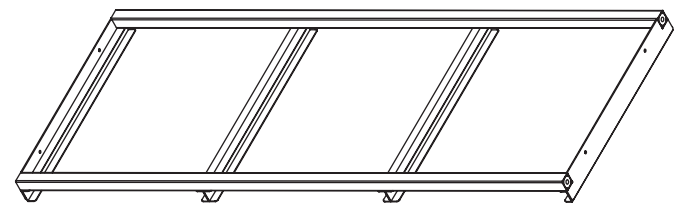

4 Stabilisierungsplatte  
1x



5 Mittelleiste  
1x

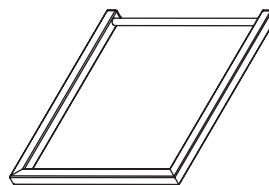

6 Halterung  
3x

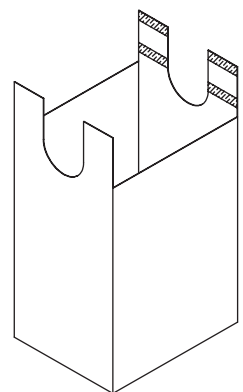

7 Wäschekorb  
3x

Schrauben Maßstab 1:1  
Maßeinheit in mm

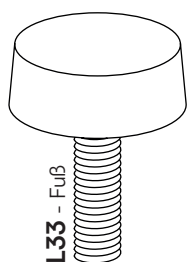

**L33** - Fuß

4x

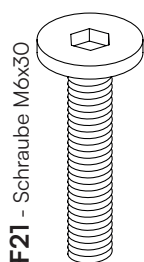

**F21** - Schraube M6x30

6x



**F22** - Schraube 4x14

4x

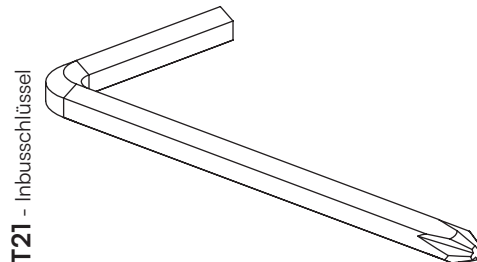

**T21** - Inbusschlüssel

1x

# Ein letzter Check:

Bitte überprüfe, ob Du alle Teile hast.

**Viel Spaß beim Aufbau!**

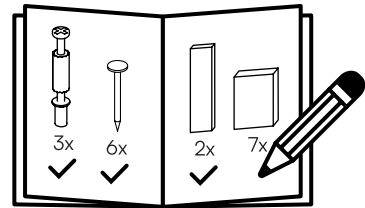

# 1

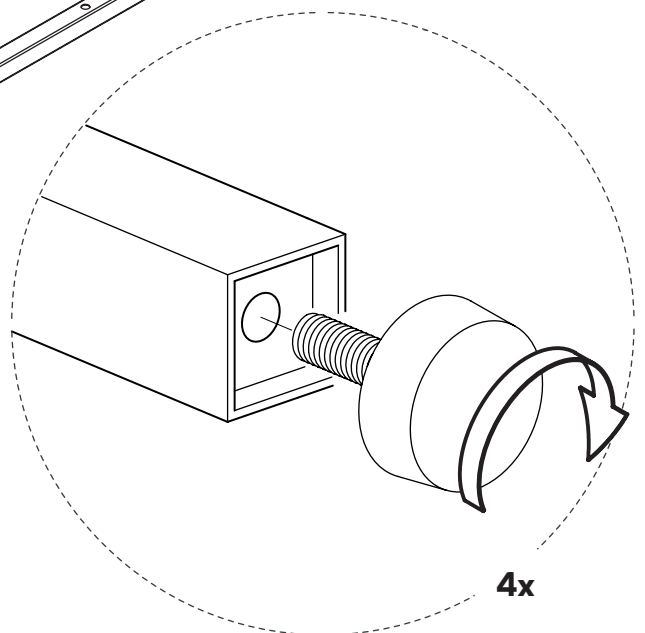
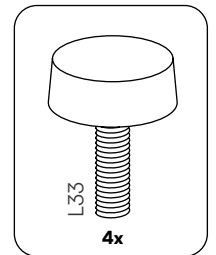
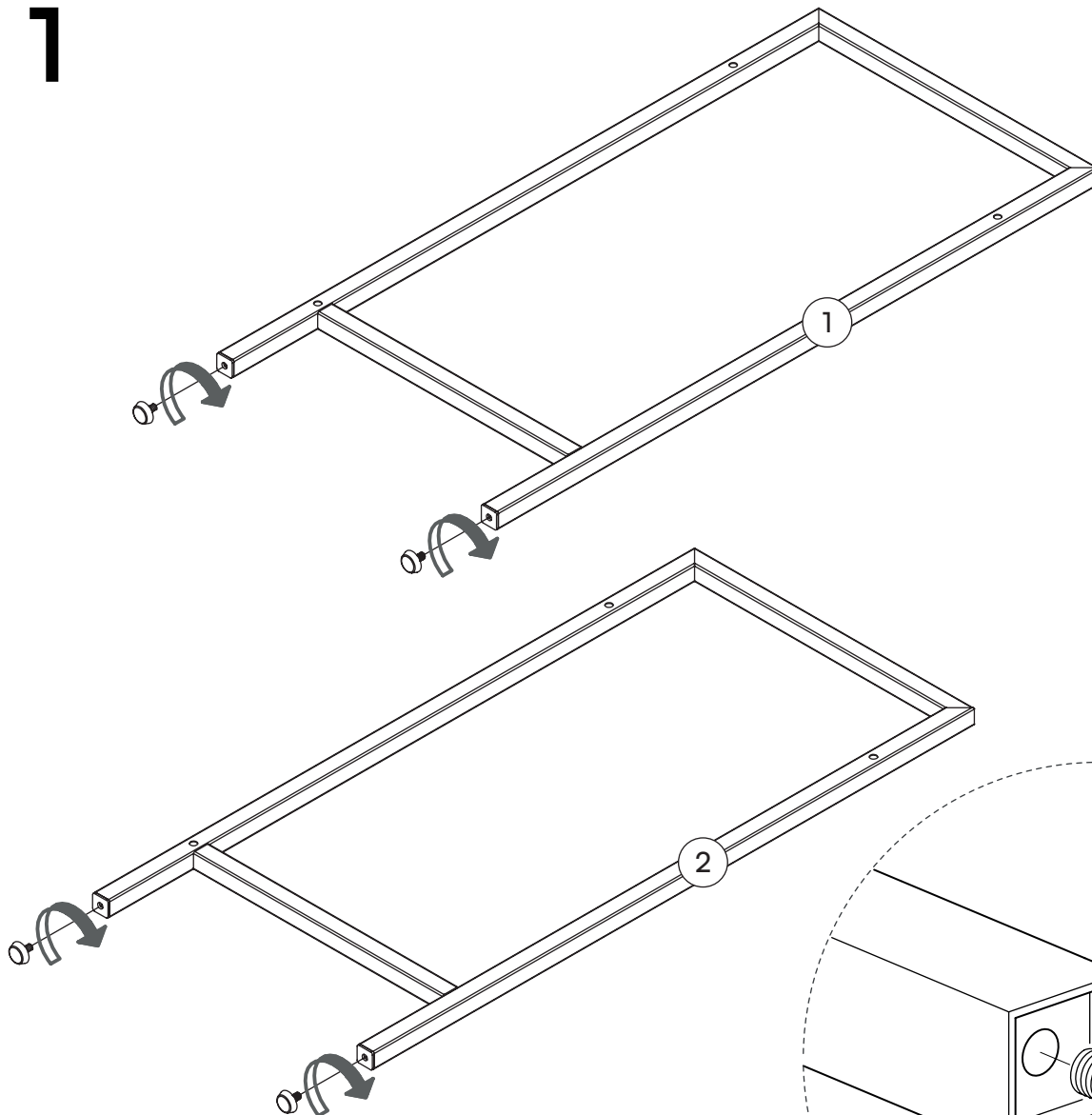

2

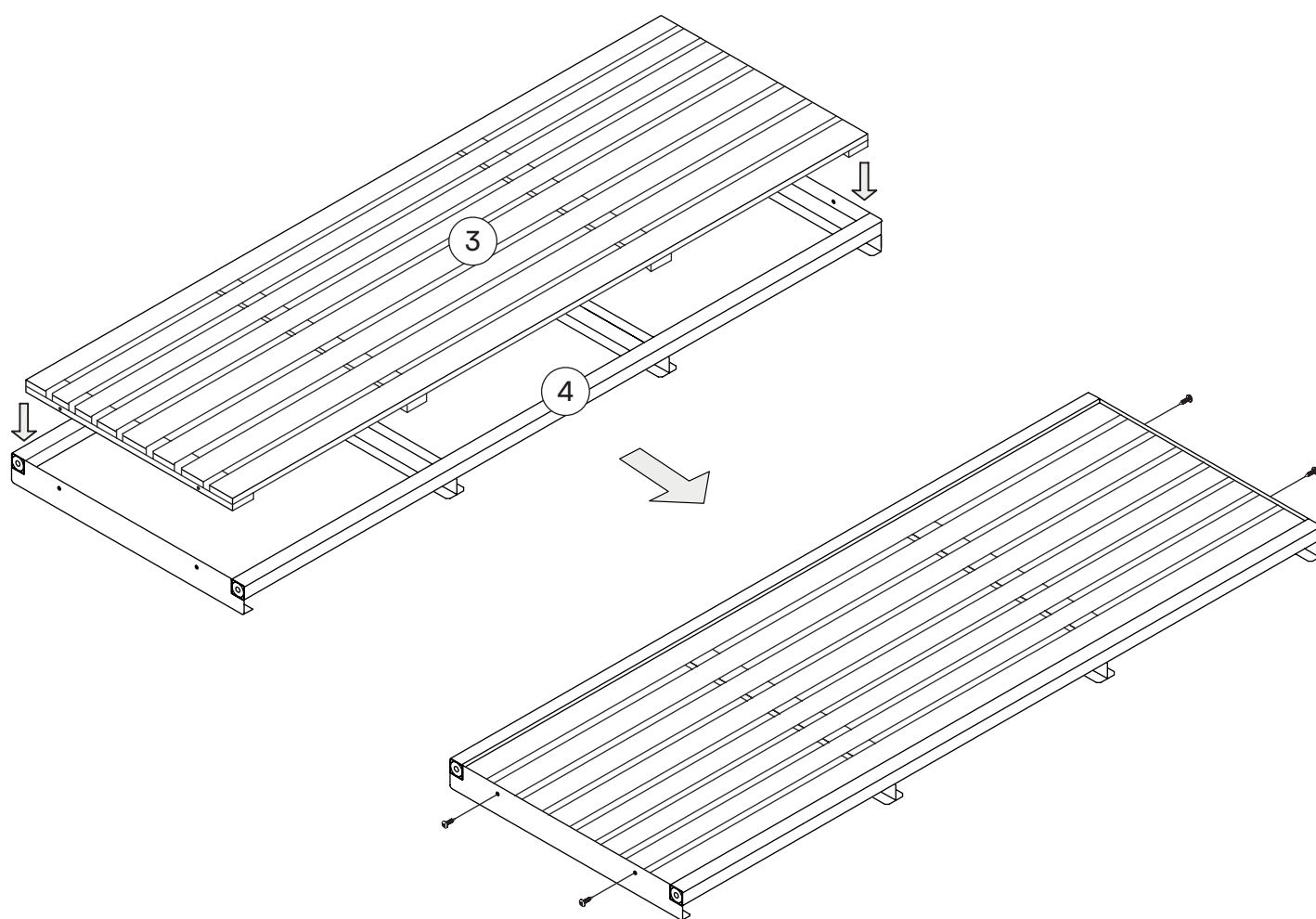
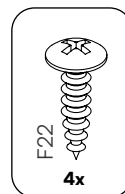



# 3

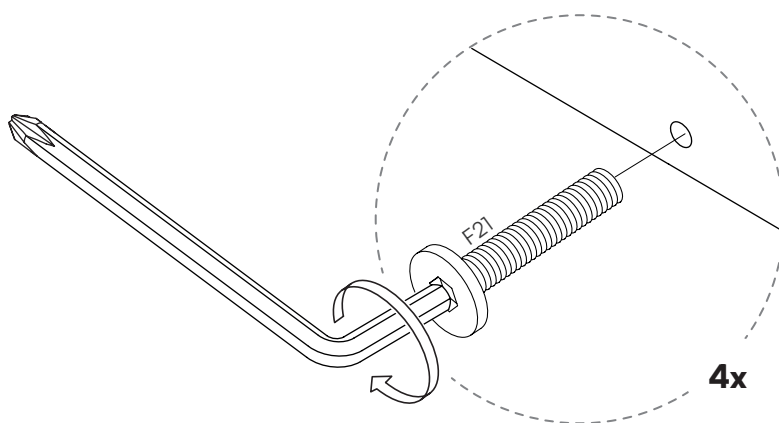
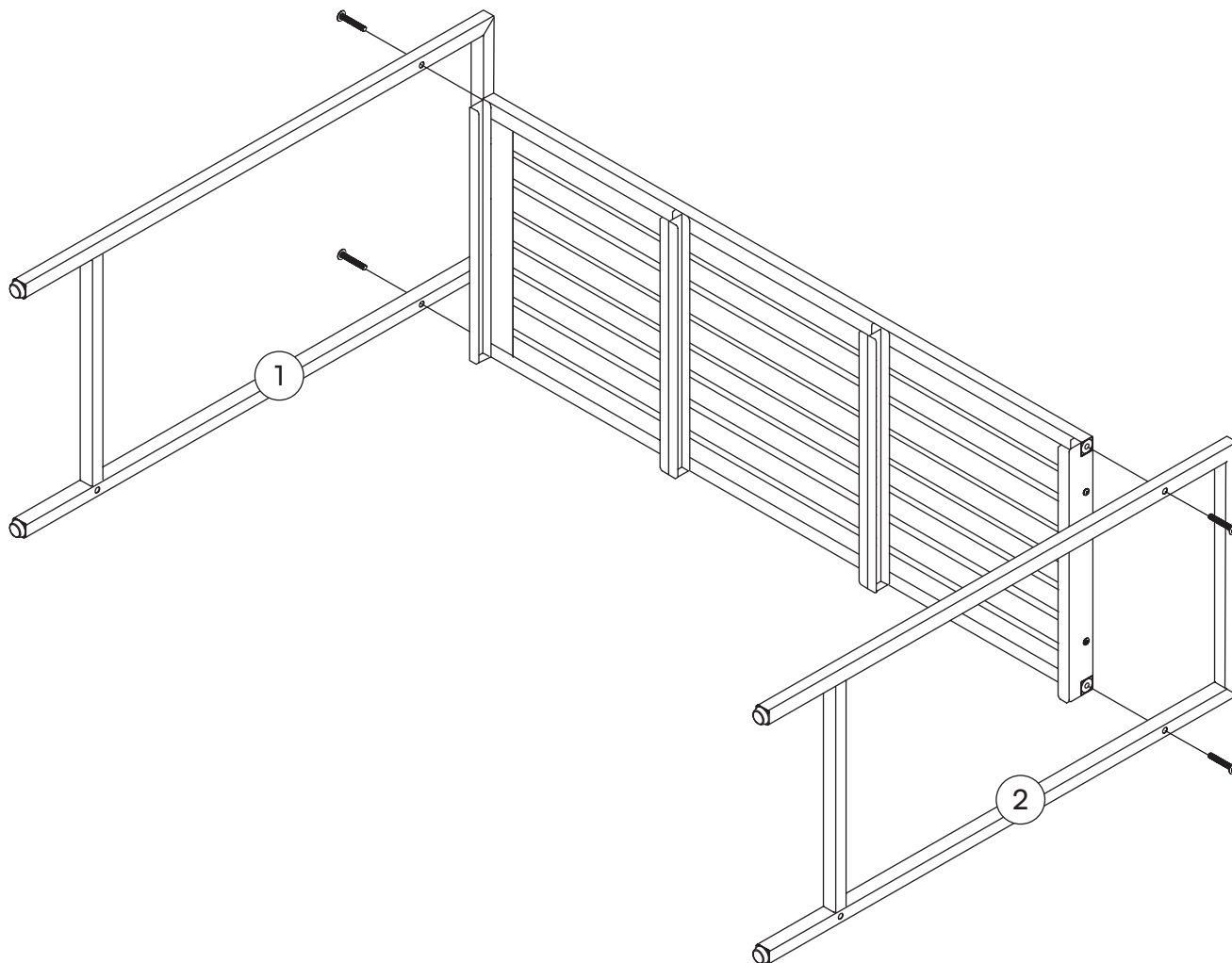
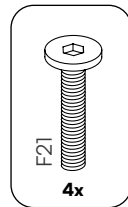

4

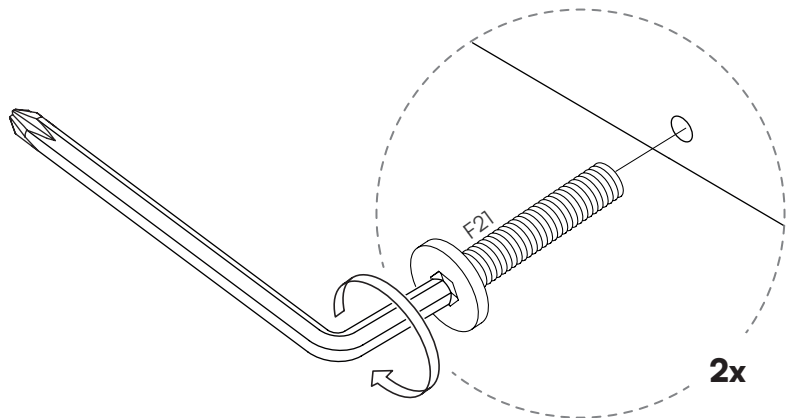
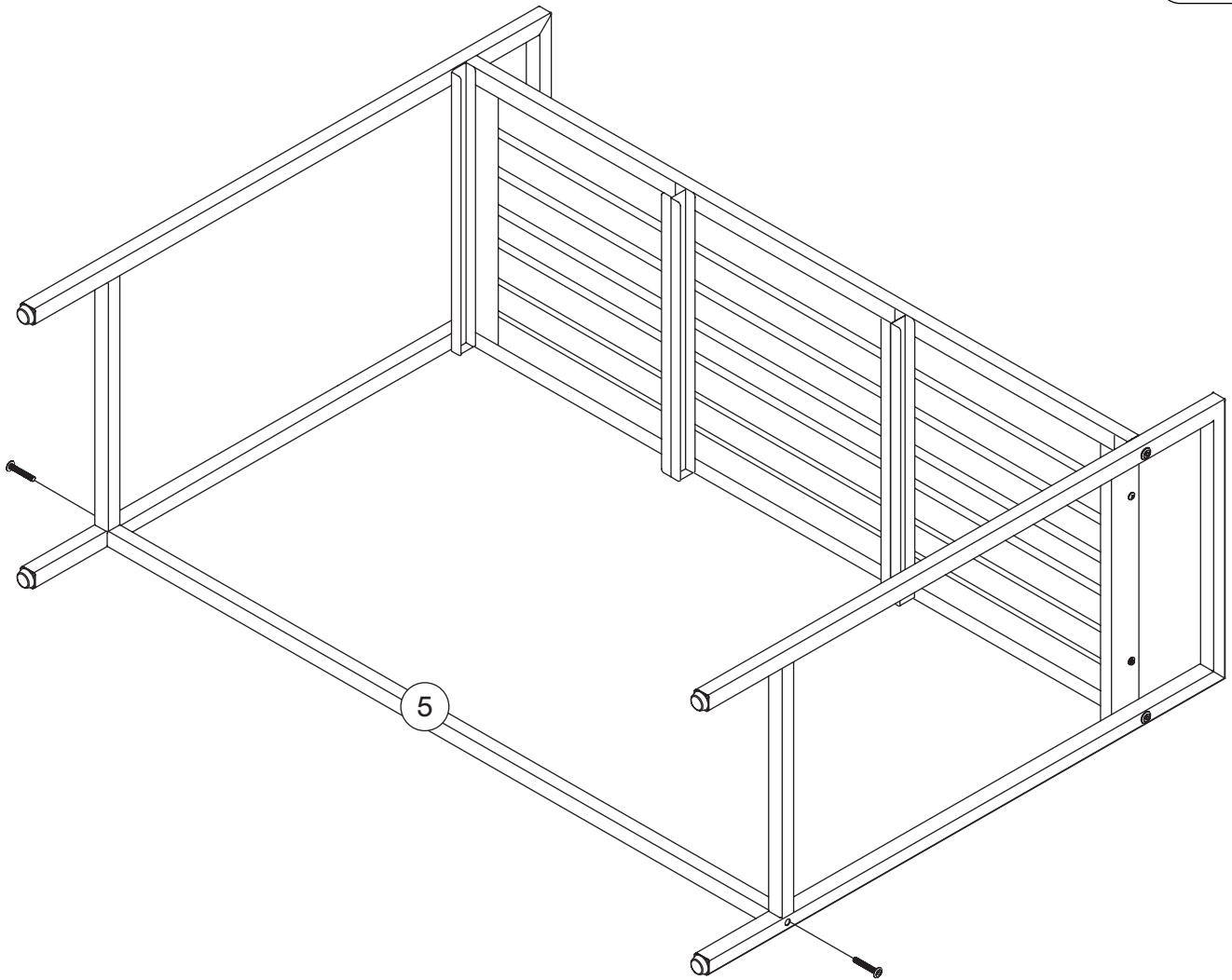
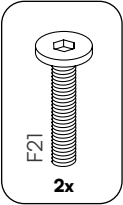

5 

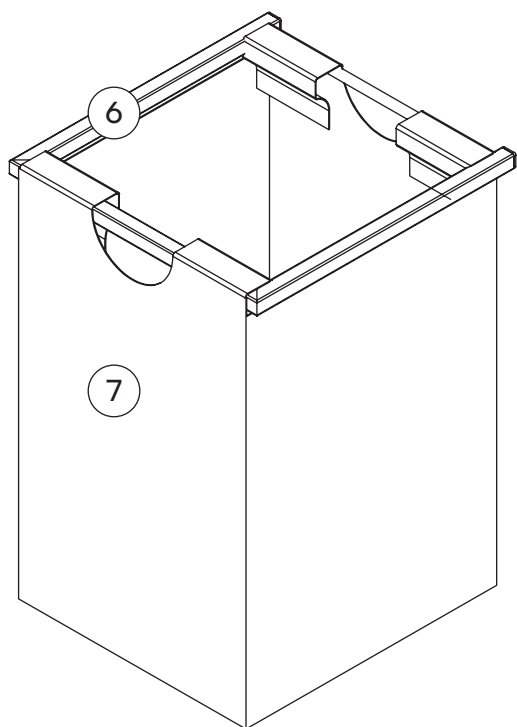
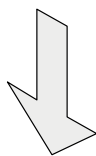
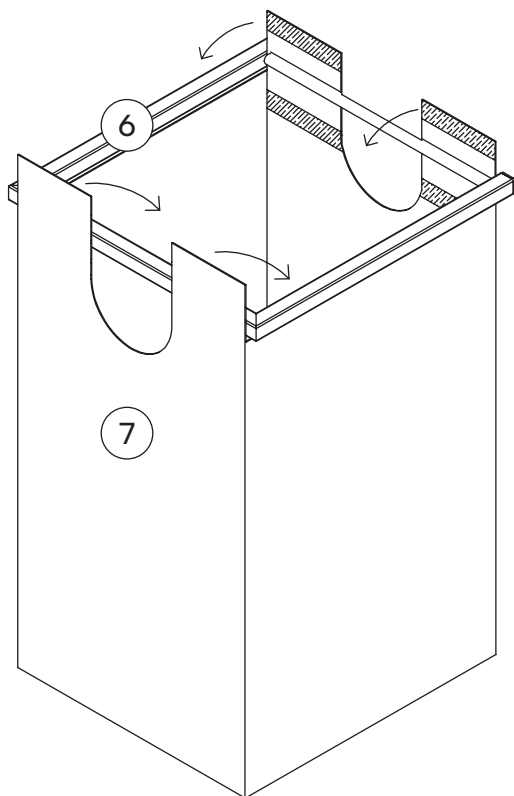

6

