

# skølm.

## Atria

Metallkommode, 4 Schubladen

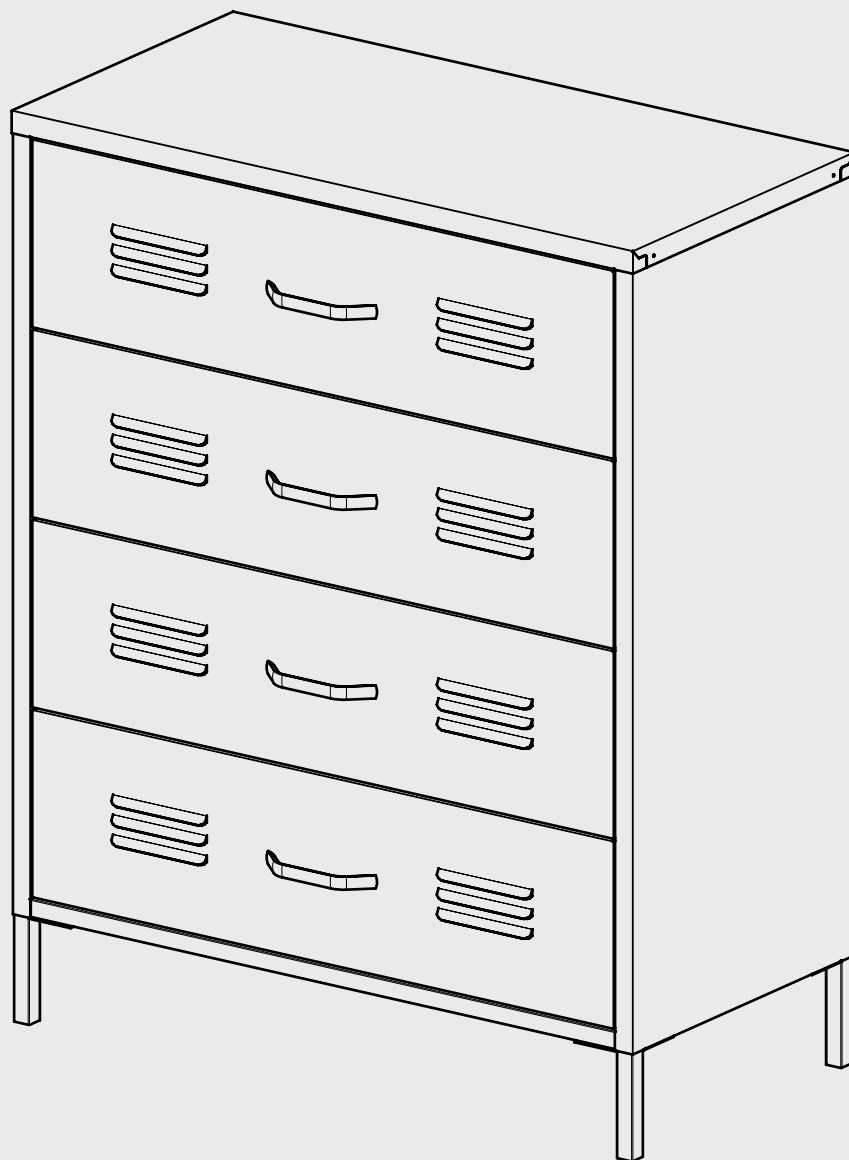



# Hey,

wir freuen uns, dass Du Dich für unser Produkt entschieden hast. Beachte die kommenden Hinweise, um den Aufbau problemlos zu gestalten.

**Viel Spaß mit Deinem Produkt!**

# 50%

weniger Fehler beim Aufbau durch  
sorgfältiges Lesen der Anleitung



## 45-60

min



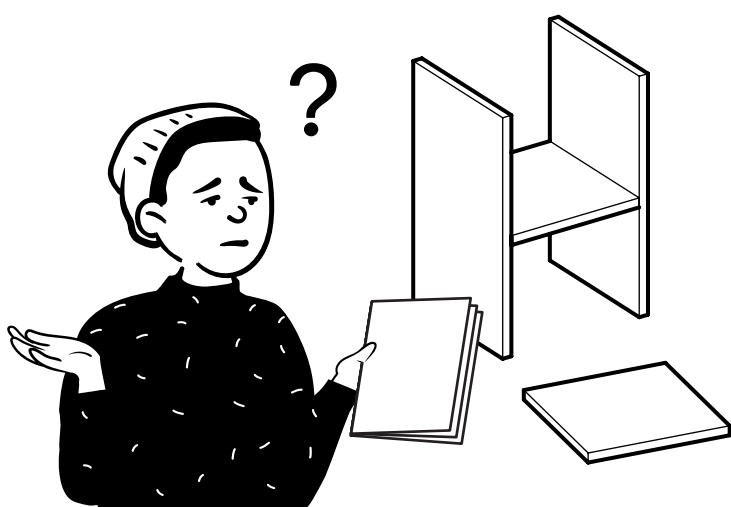
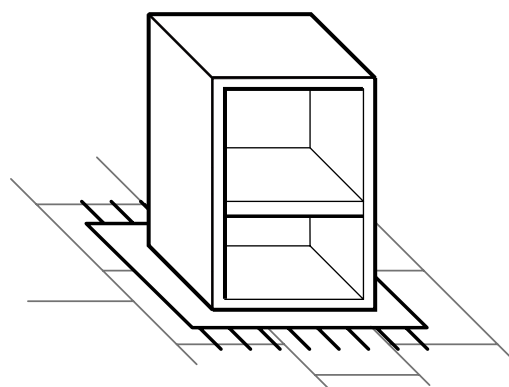
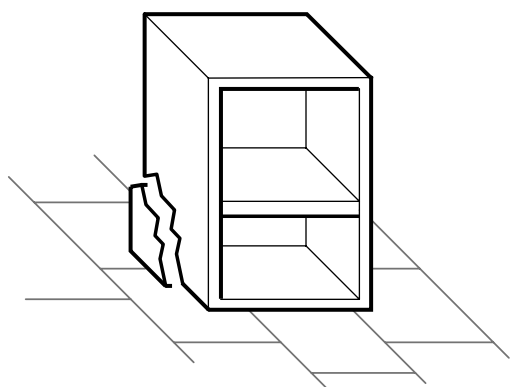

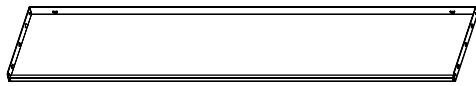

1 Schubladenrückwand  
4x

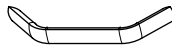

2 Griff  
4x

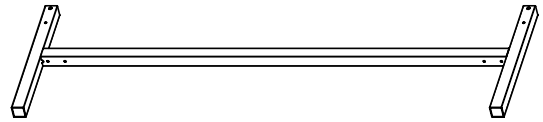

3 Beine  
2x

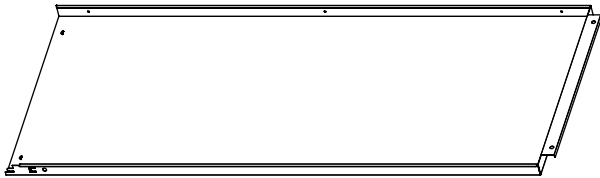

4 Rückwand, links  
1x

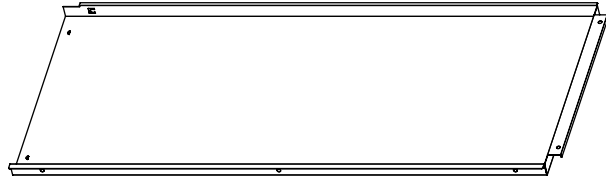

5 Rückwand, rechts  
1x

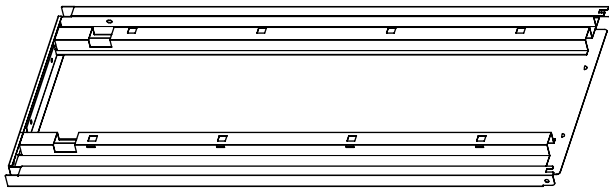

6 Seitenteil, links  
1x

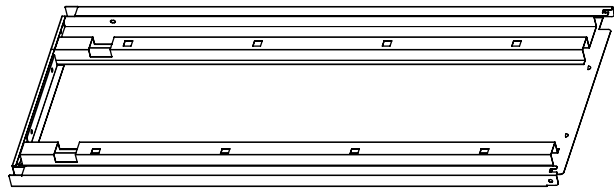

7 Seitenteil, rechts  
1x

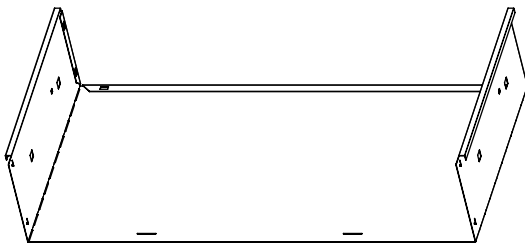

8 Schlade, Korpus  
4x

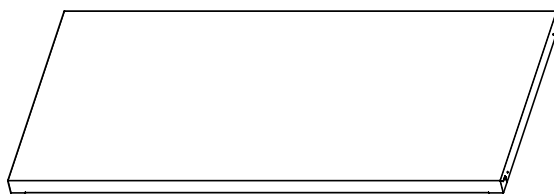

9 Deckplatte  
1x

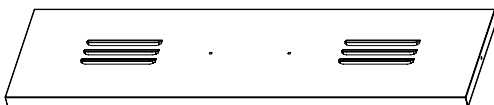

10 Schubladenfront  
4x

**K10** - Schraube

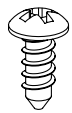

27x

**K11** - Schraube mit Unterlegscheibe

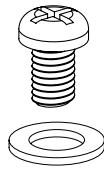

8x

**L20** - Fuß

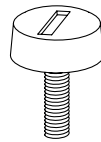

4x

**L34** - Eckverbinder

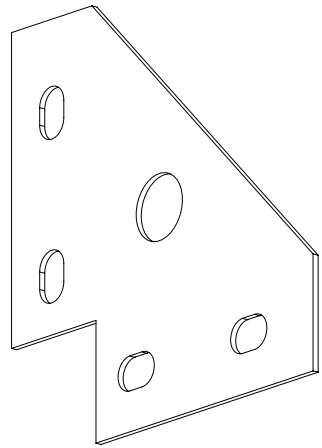

4x

**H12/H13** - Führungsschienen (Paar)

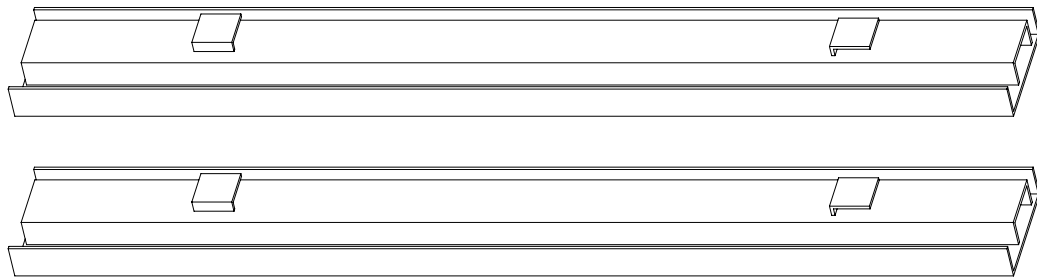

4x

## Ein letzter Check:

Bitte überprüfe, ob Du alle Teile hast.

**Viel Spaß beim Aufbau!**

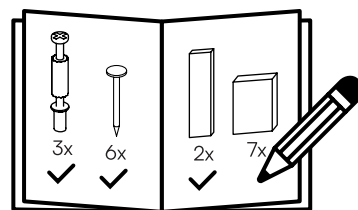

7

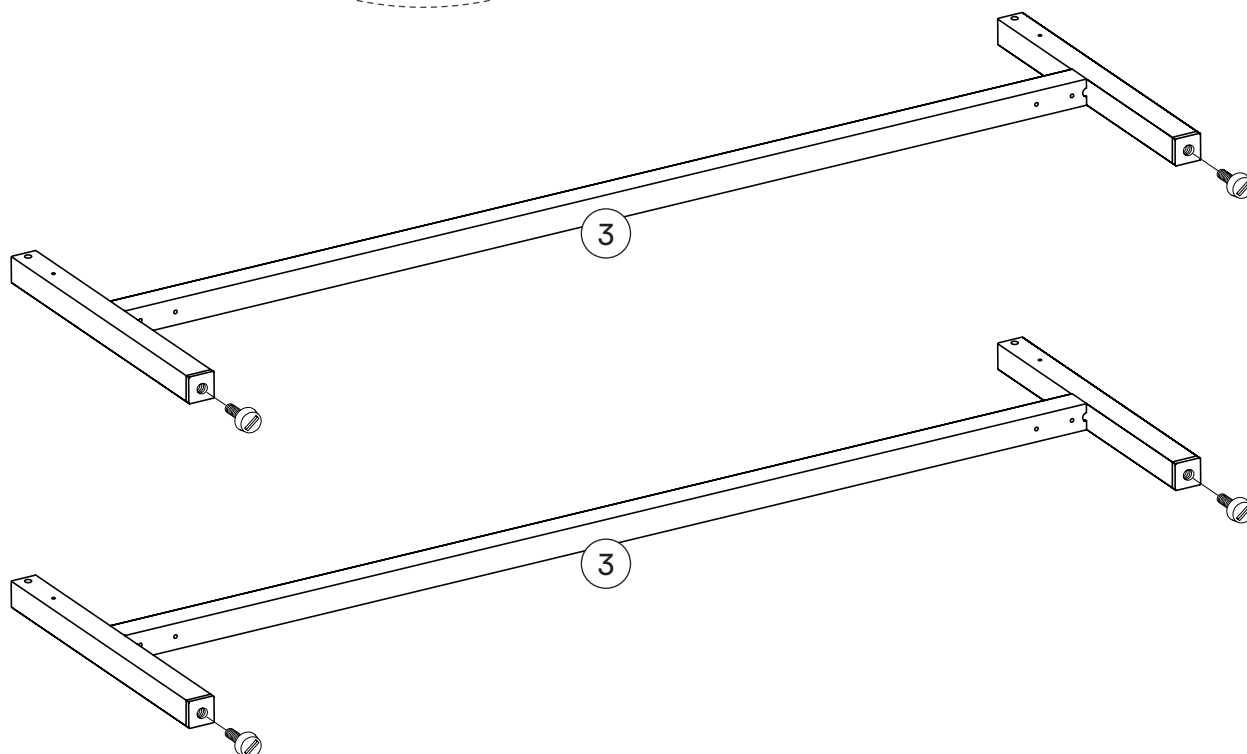
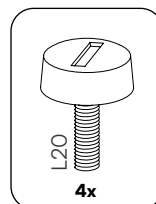
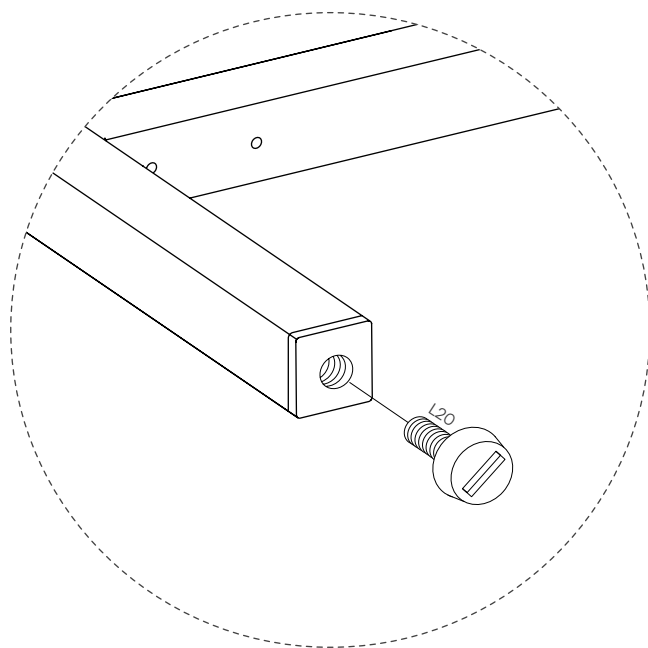

# 2

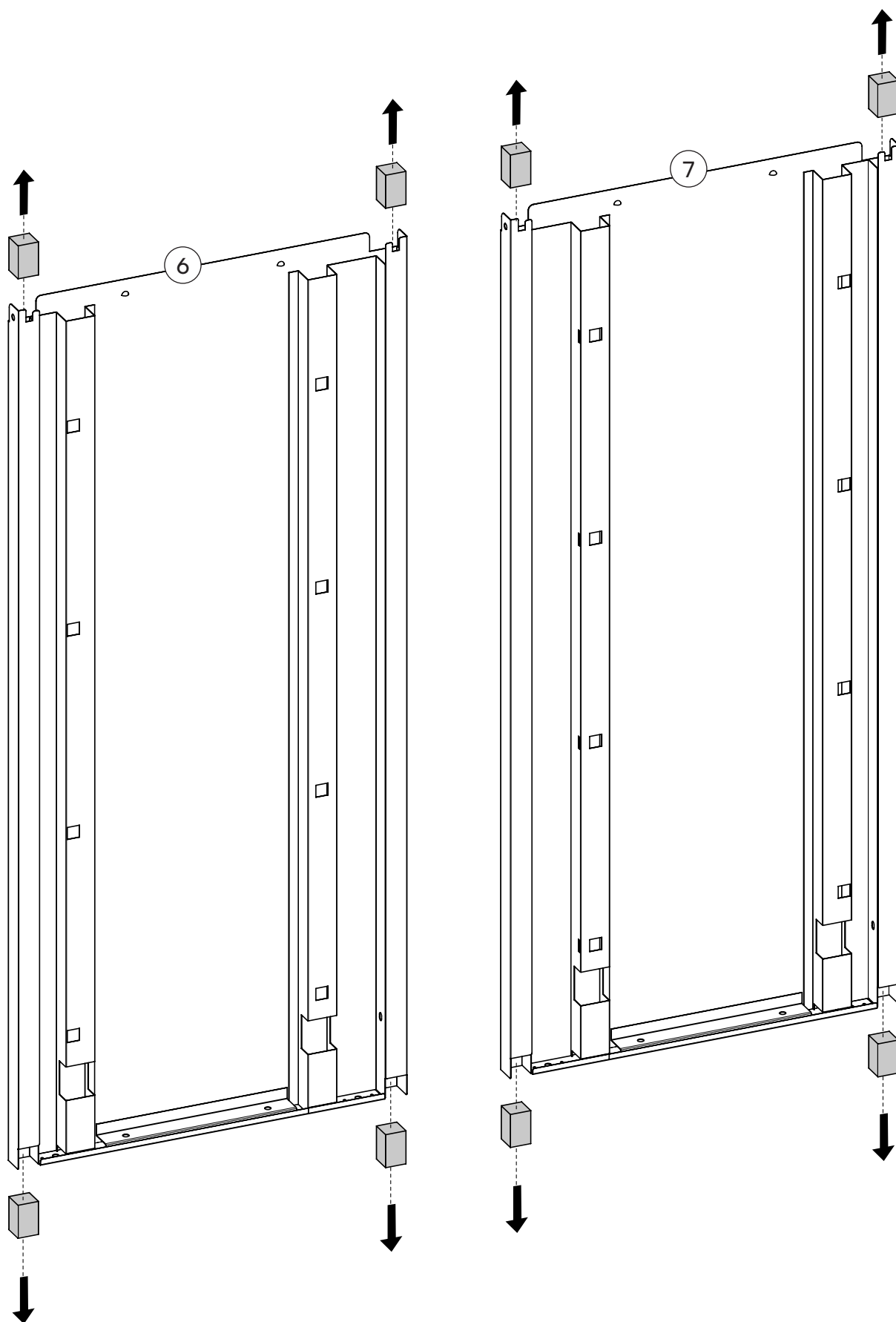

3

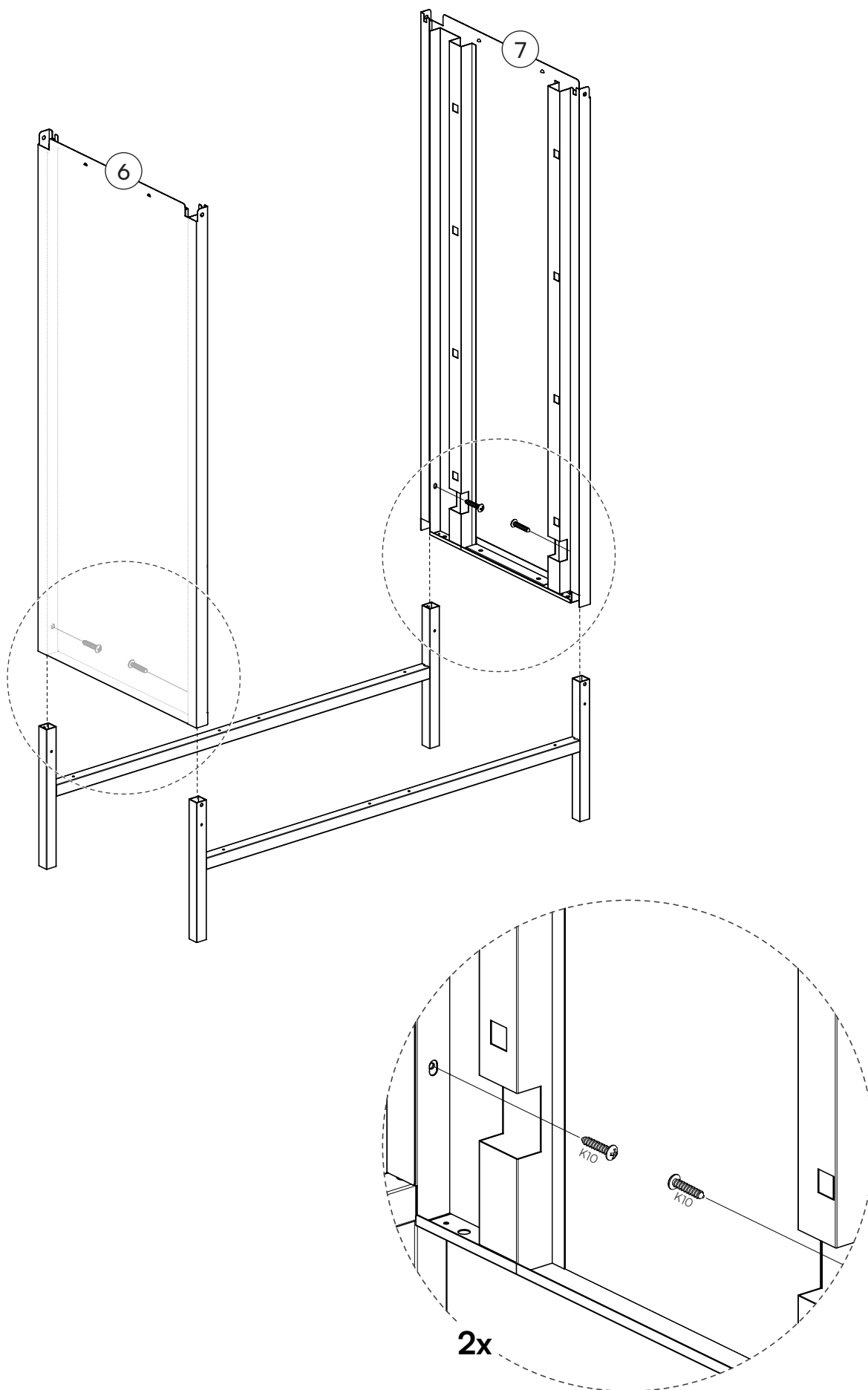



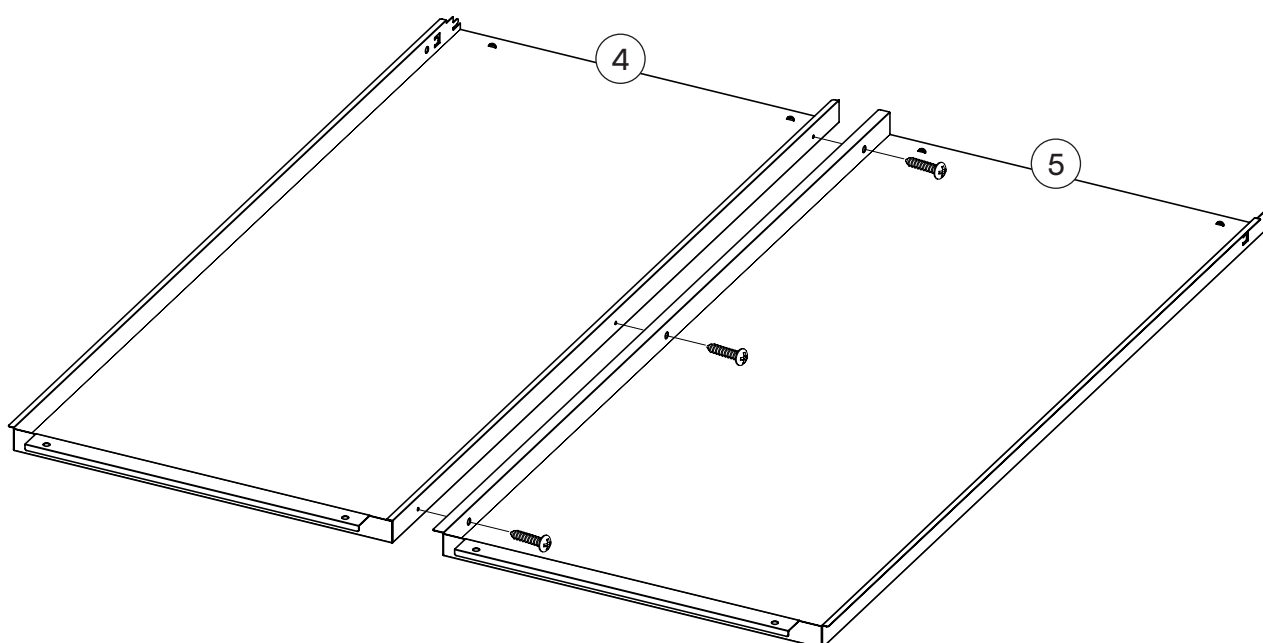
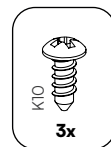

5

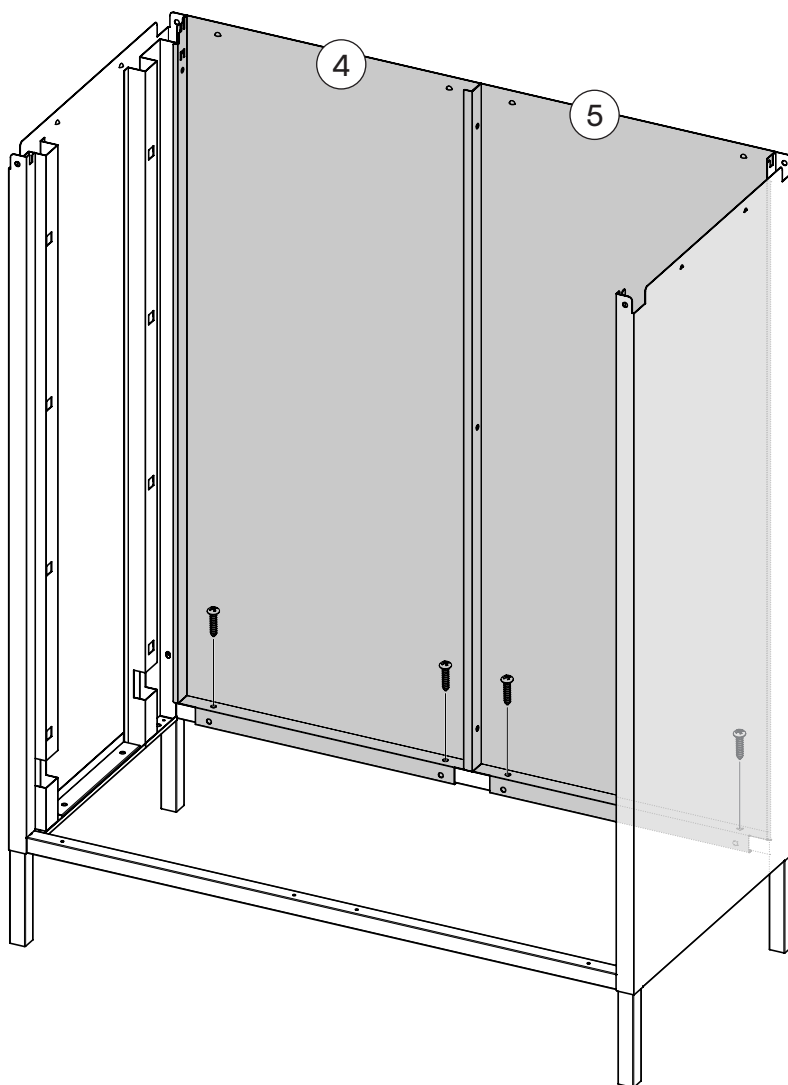
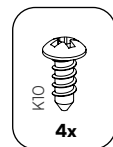
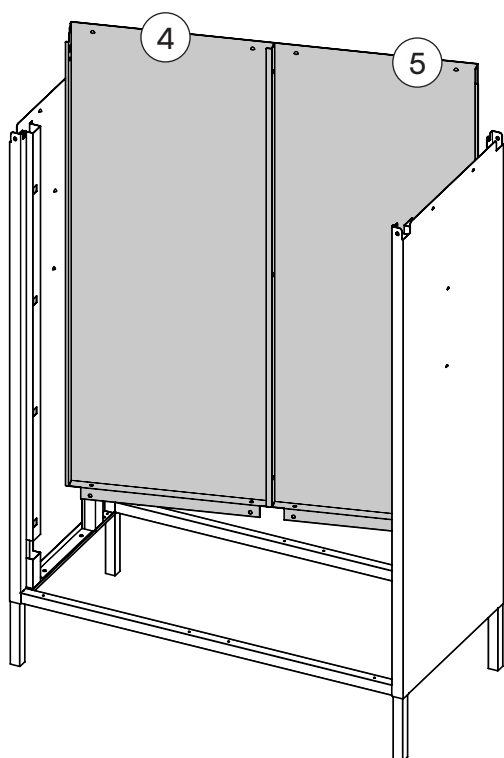

6

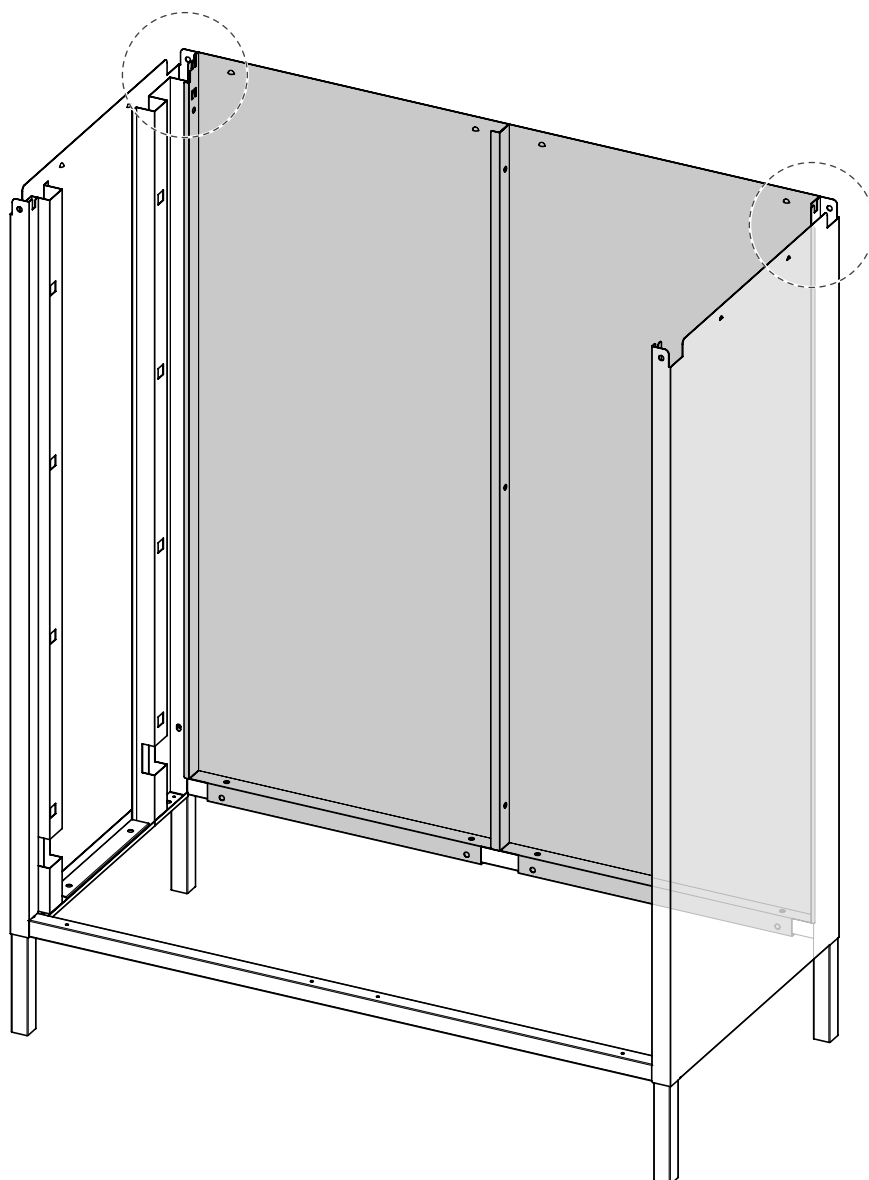
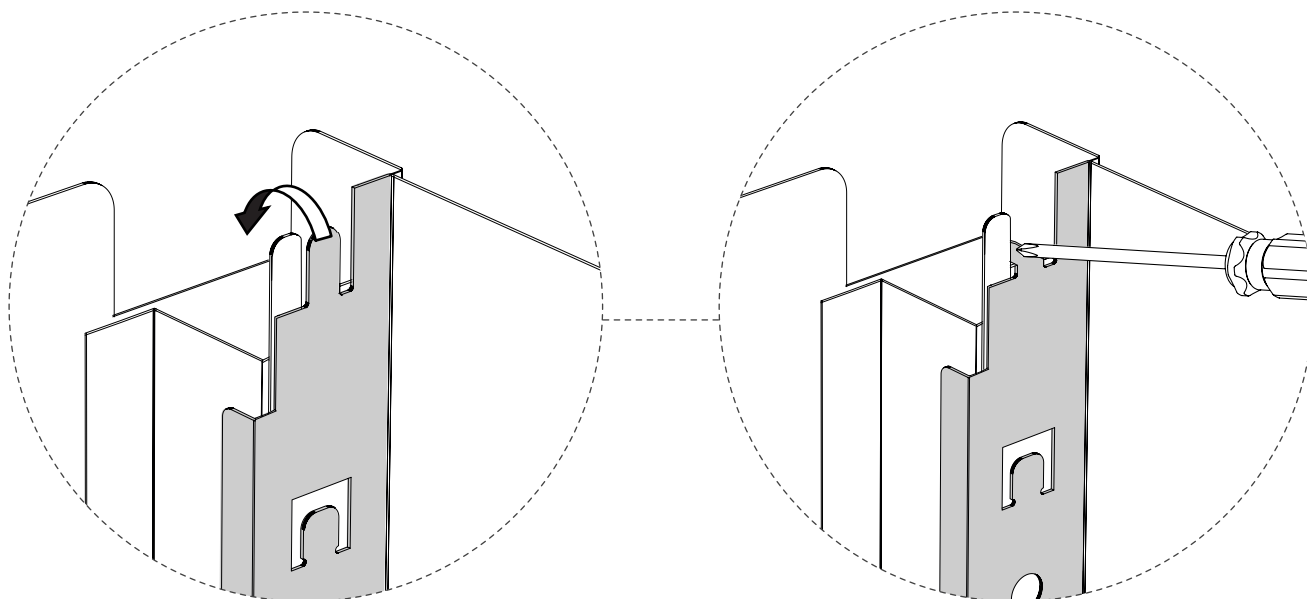

7

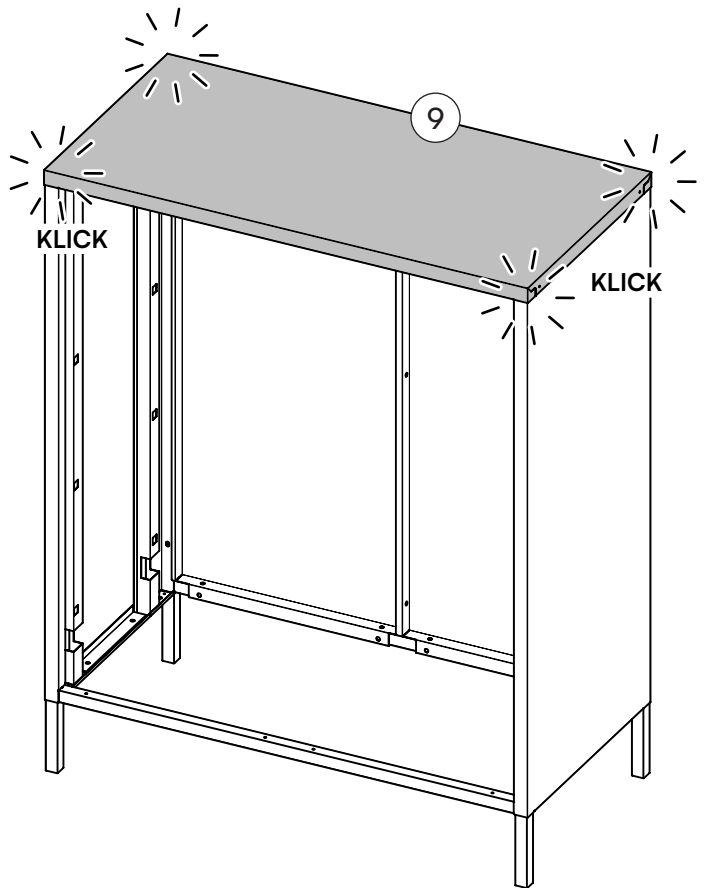
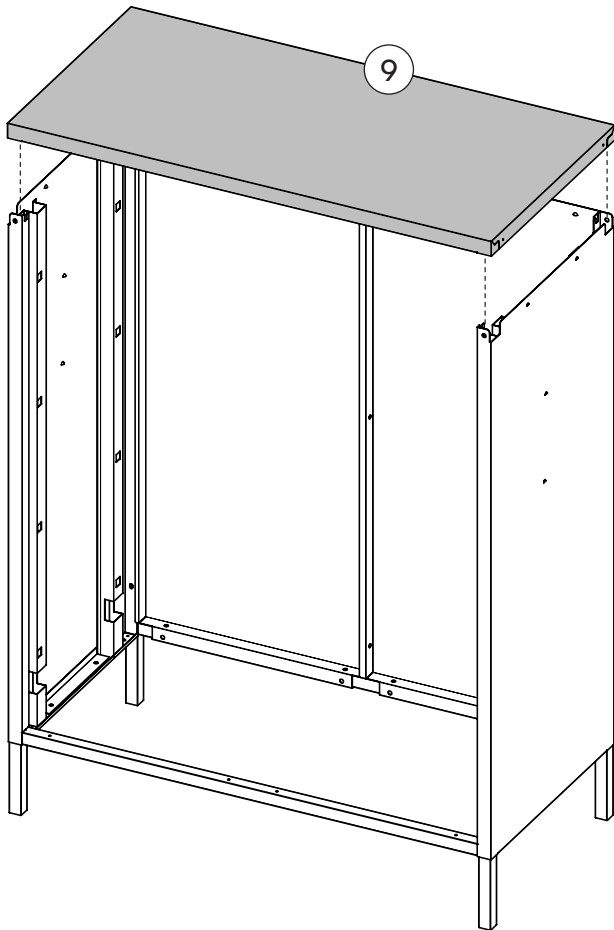
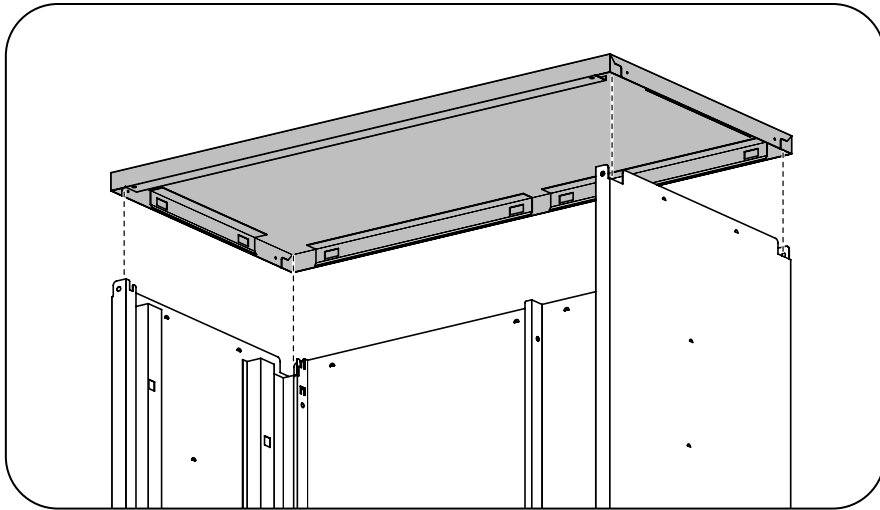

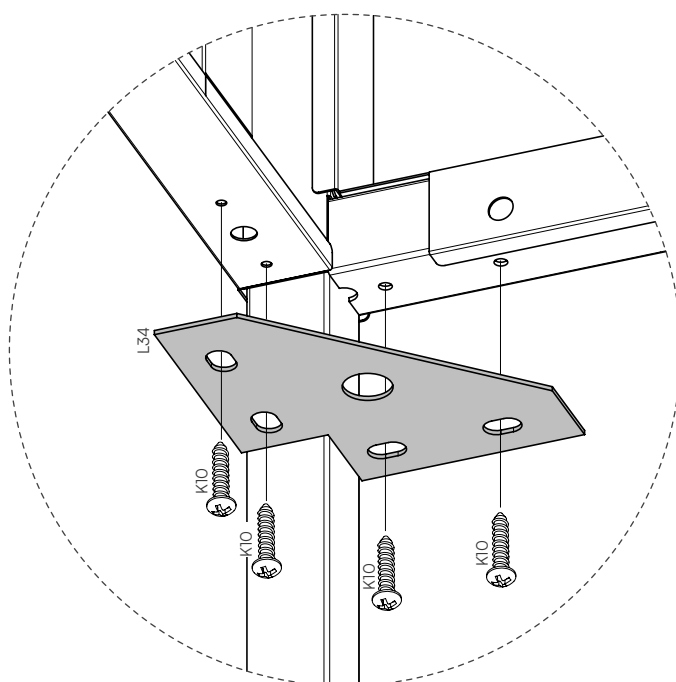
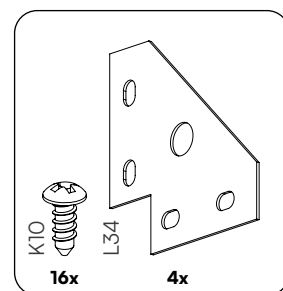
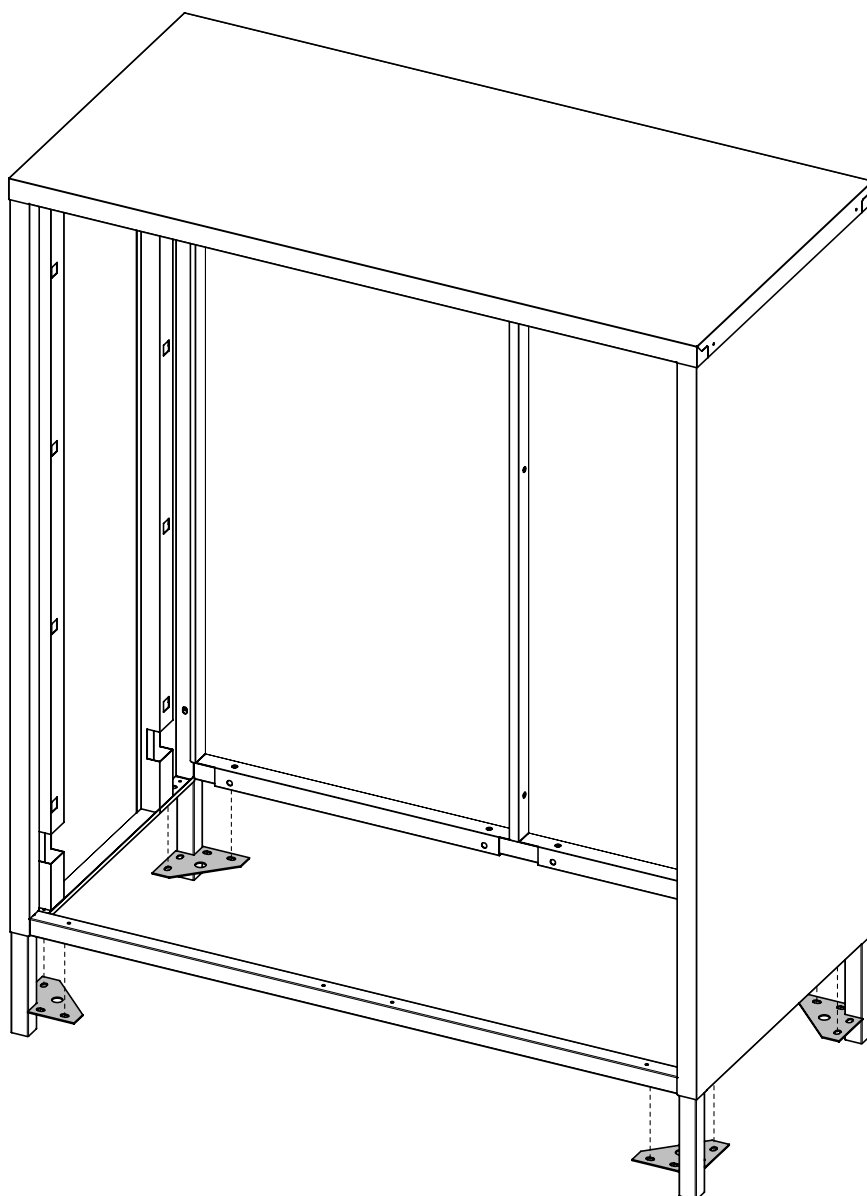

9 

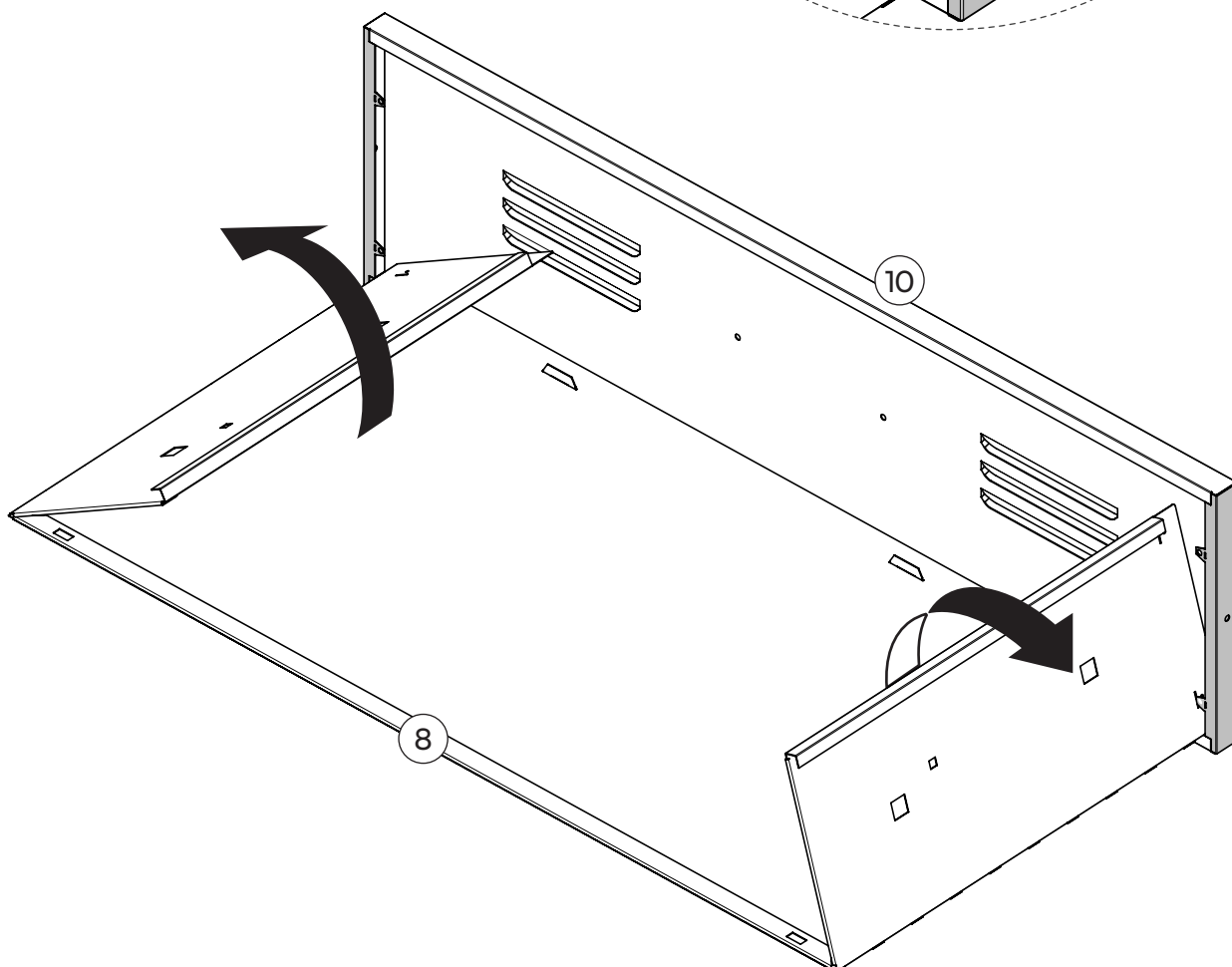
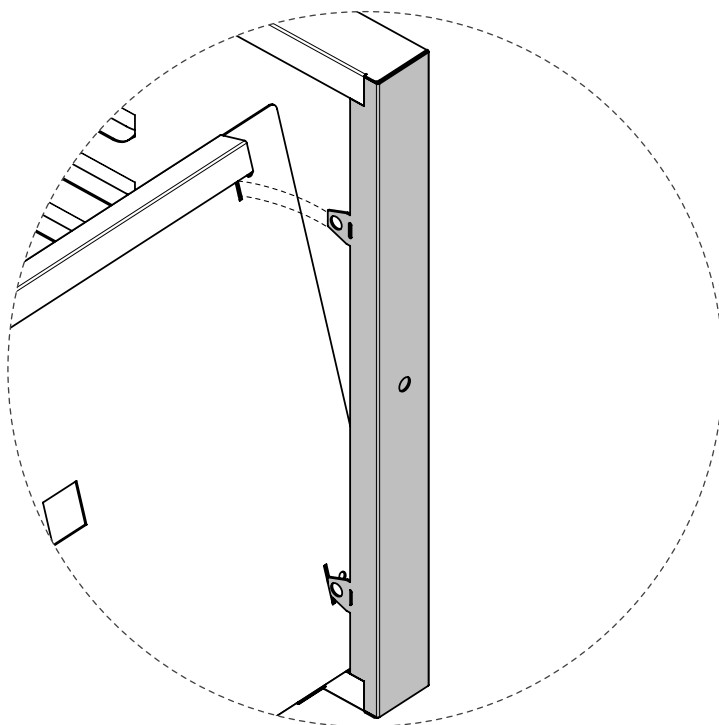

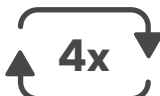
10 

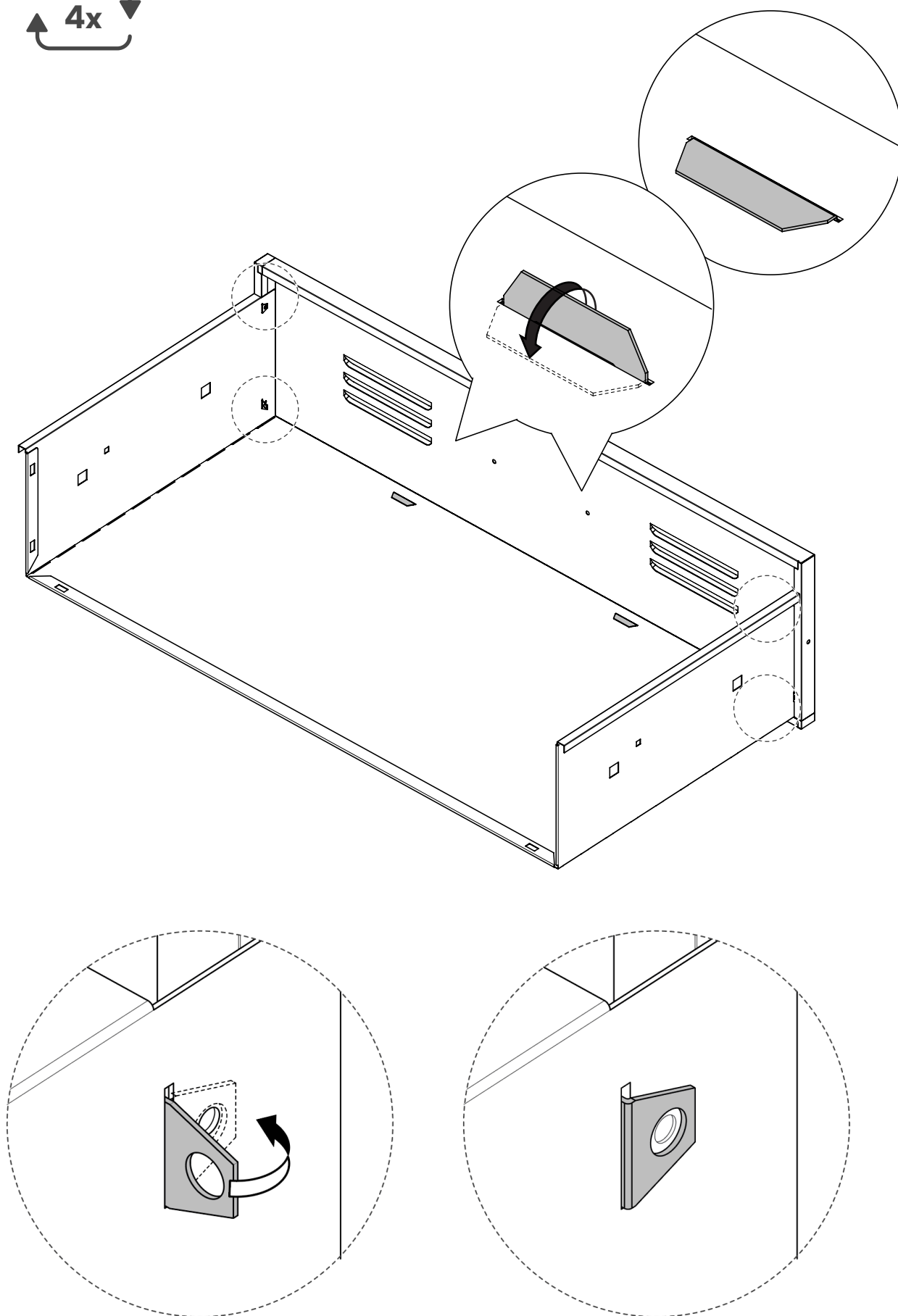

11 

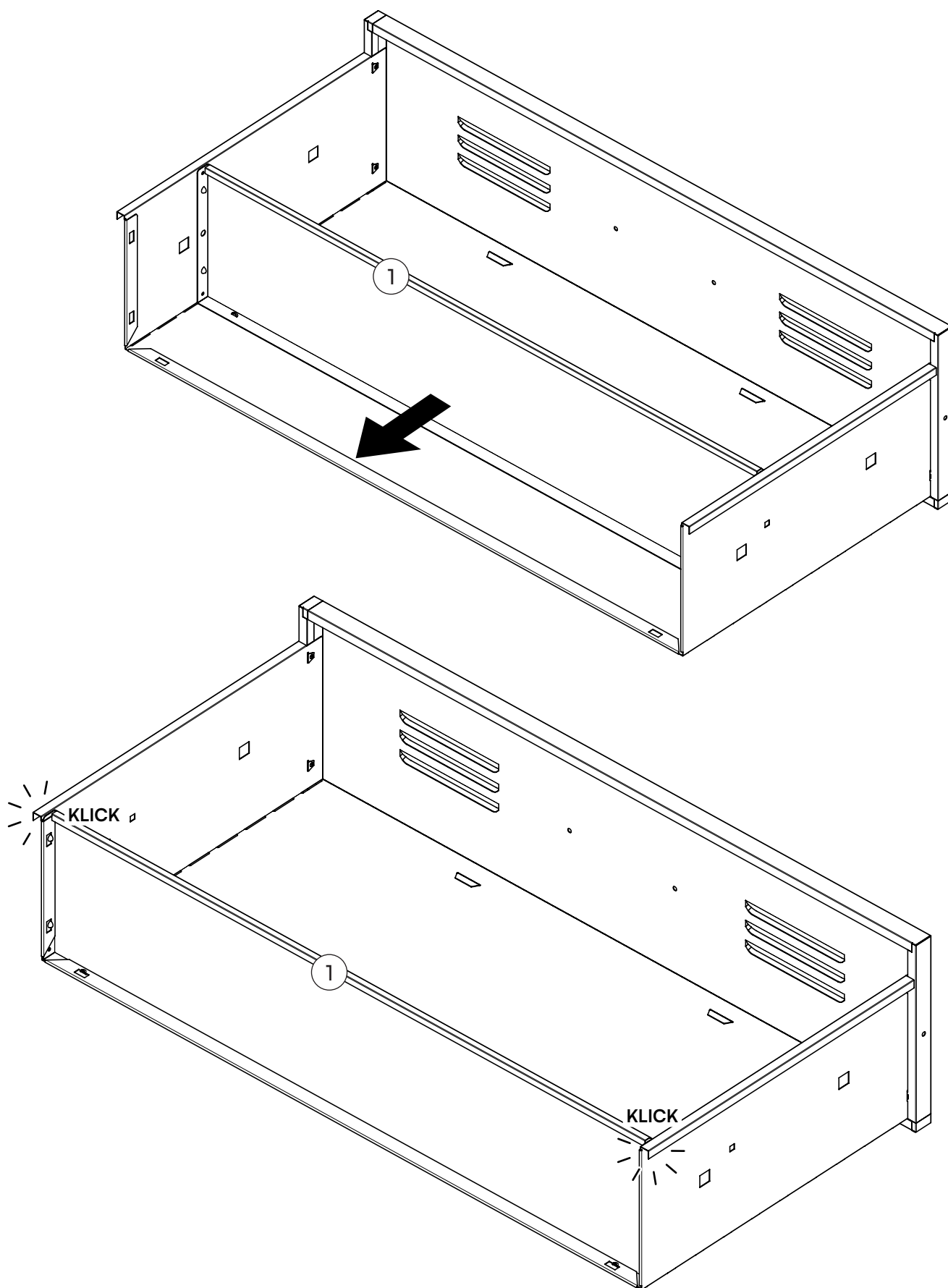



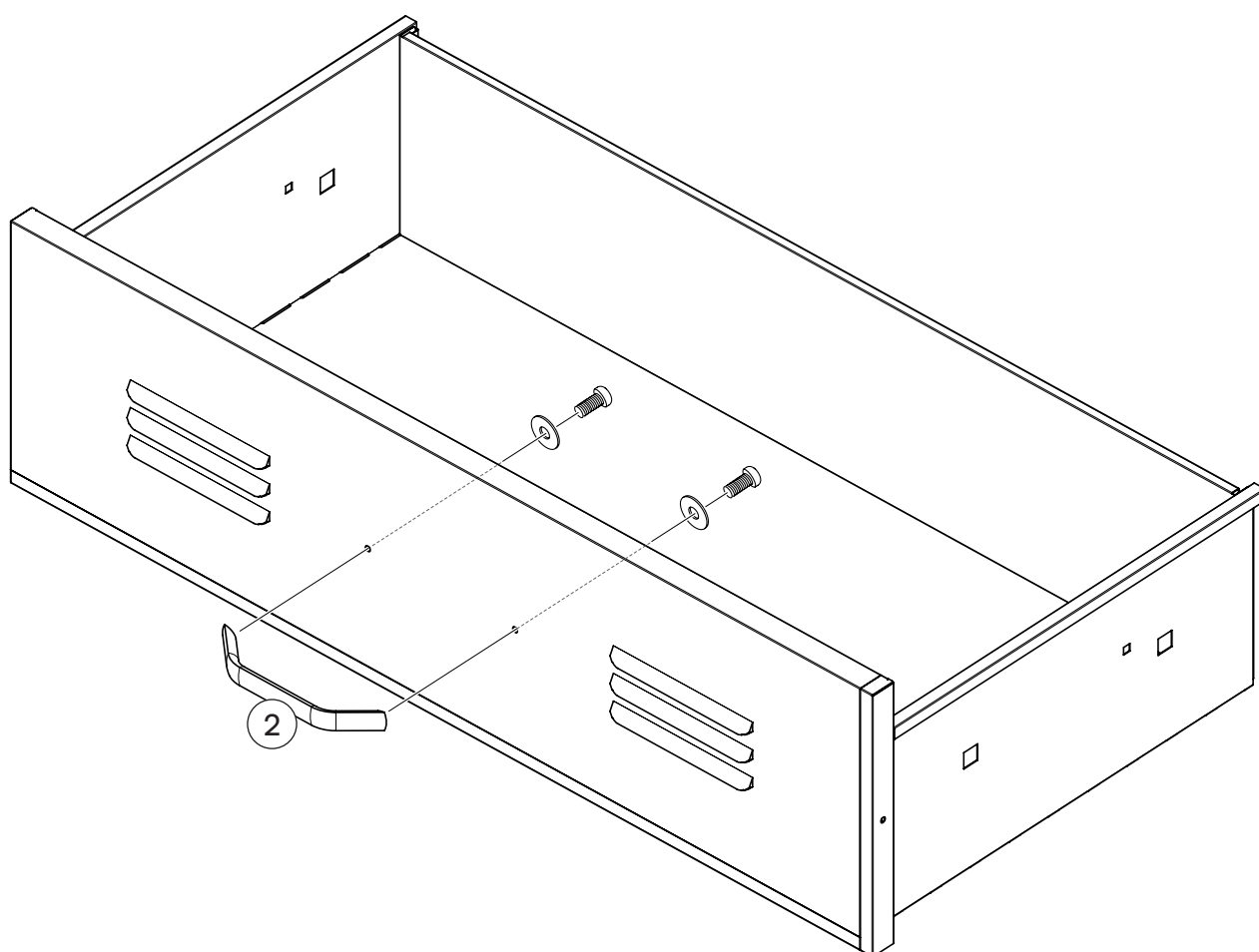

# 13

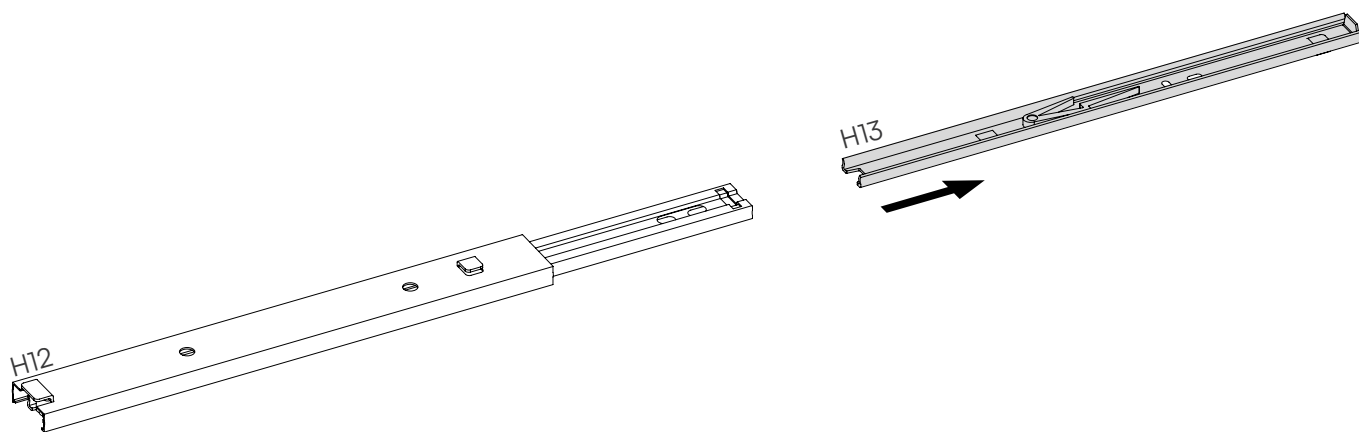
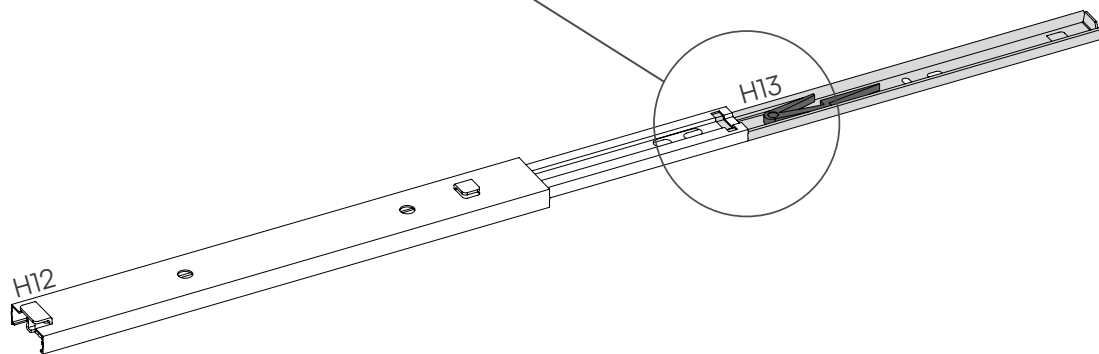
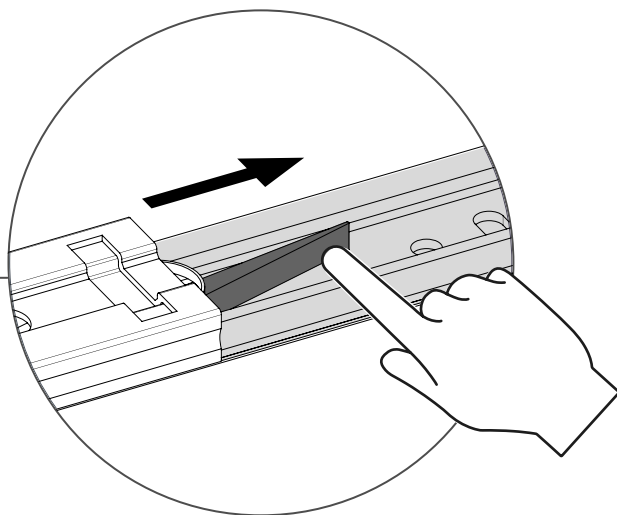
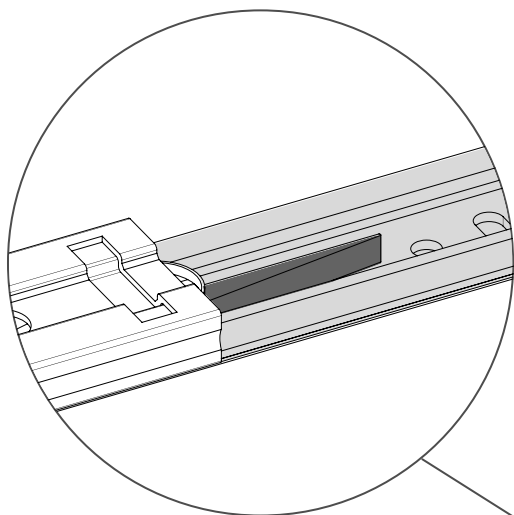
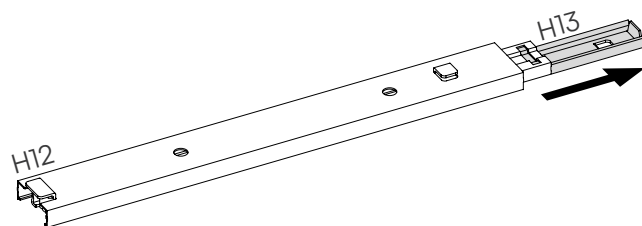



**8x**



H13

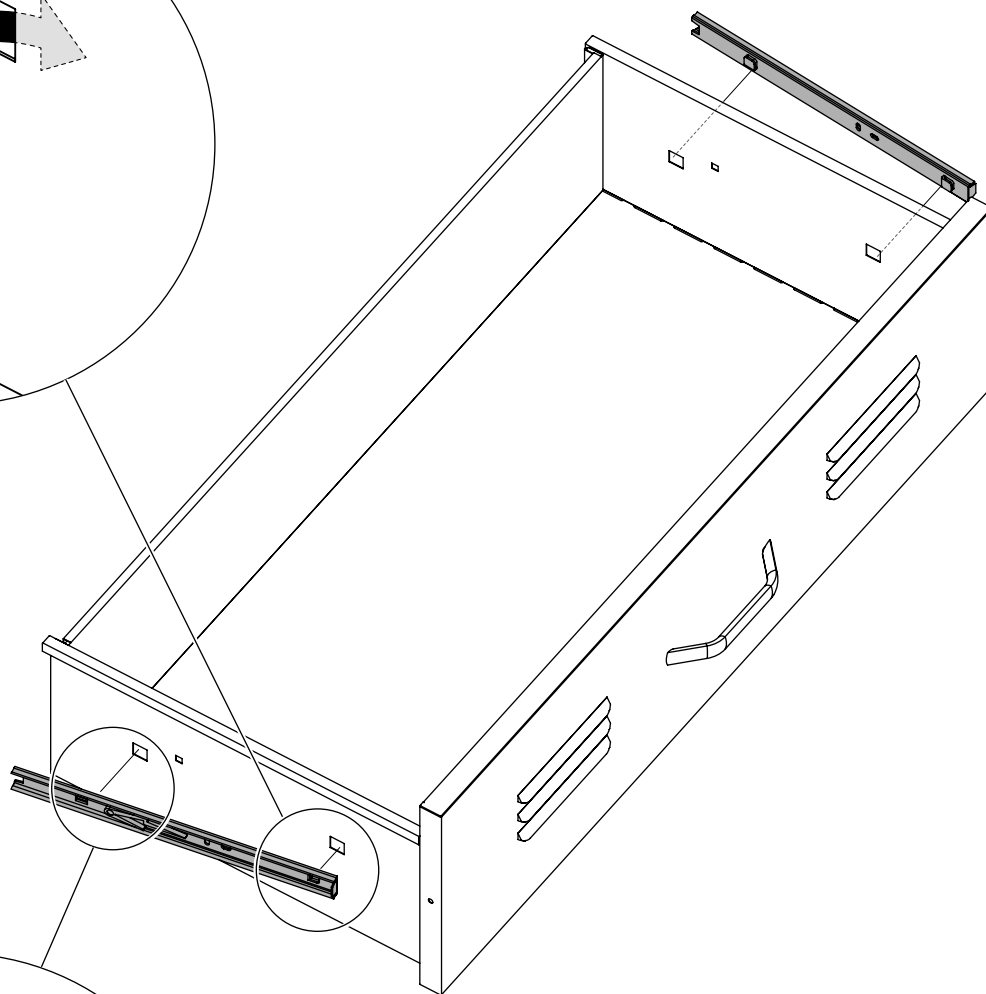

H13

**skølm.**

# 15

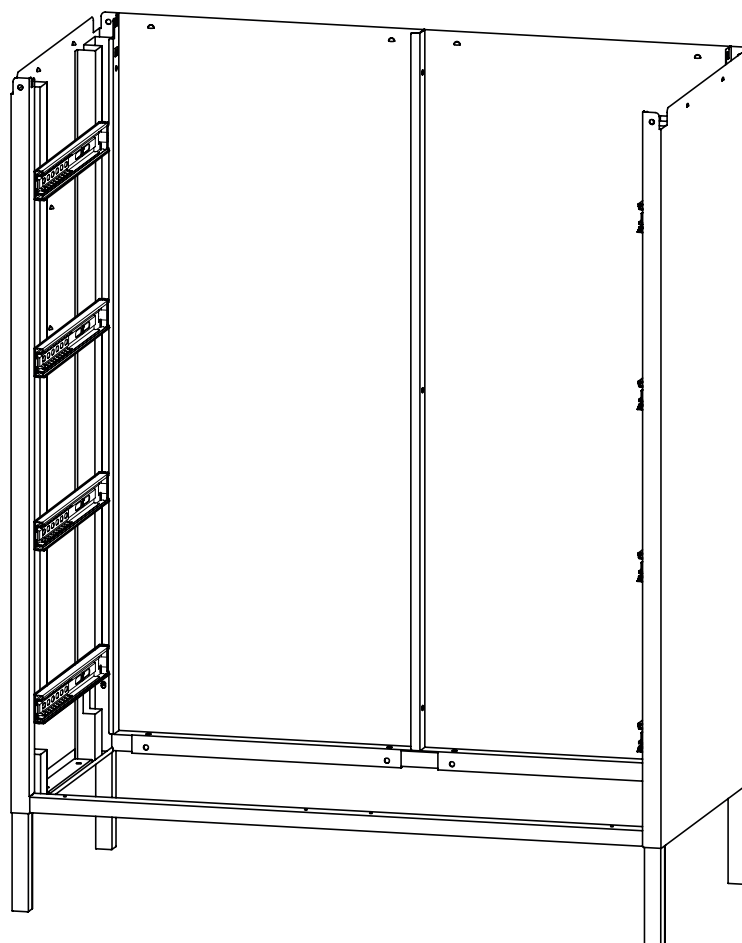
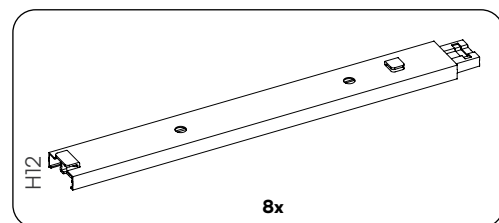
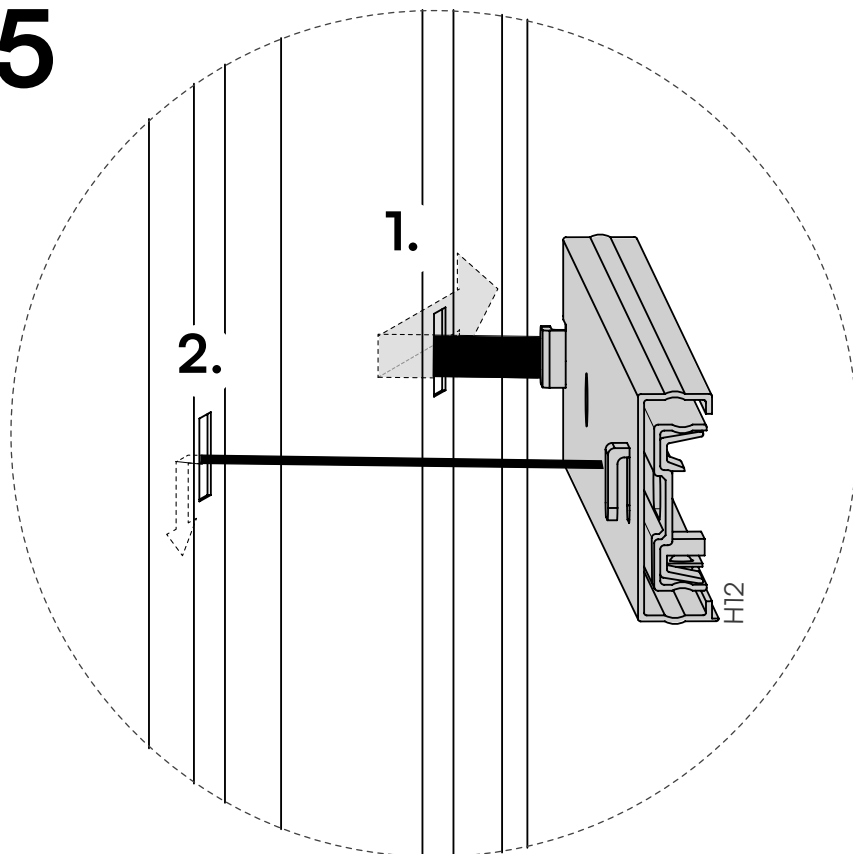

# 16

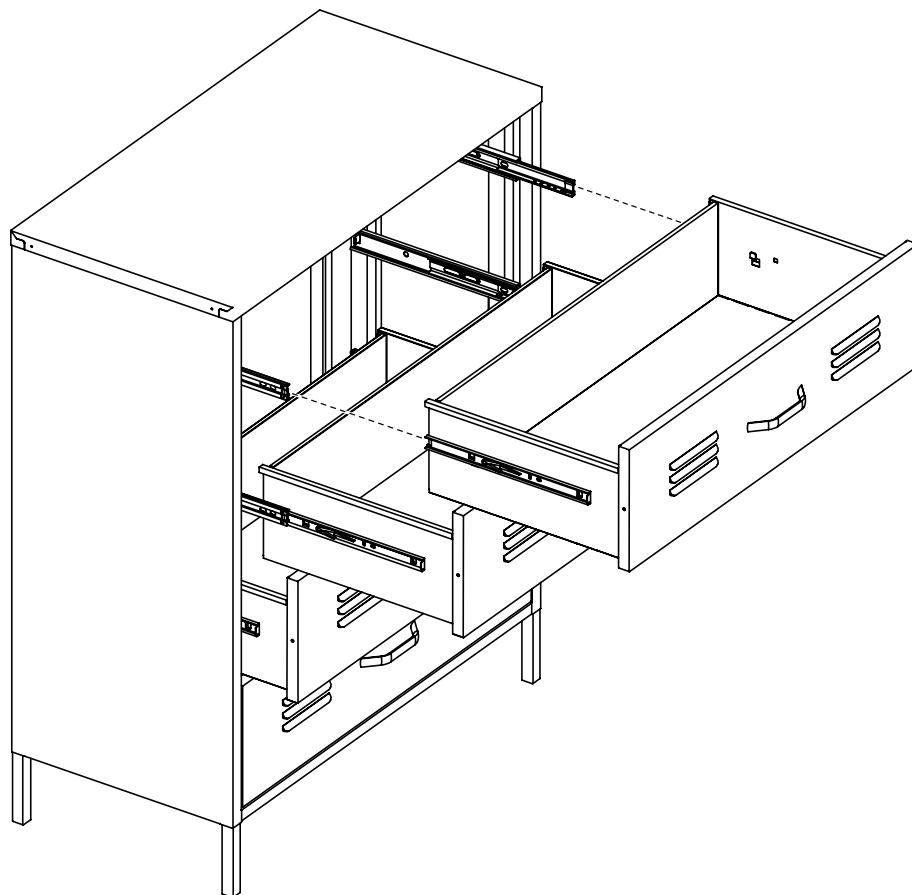

# 17

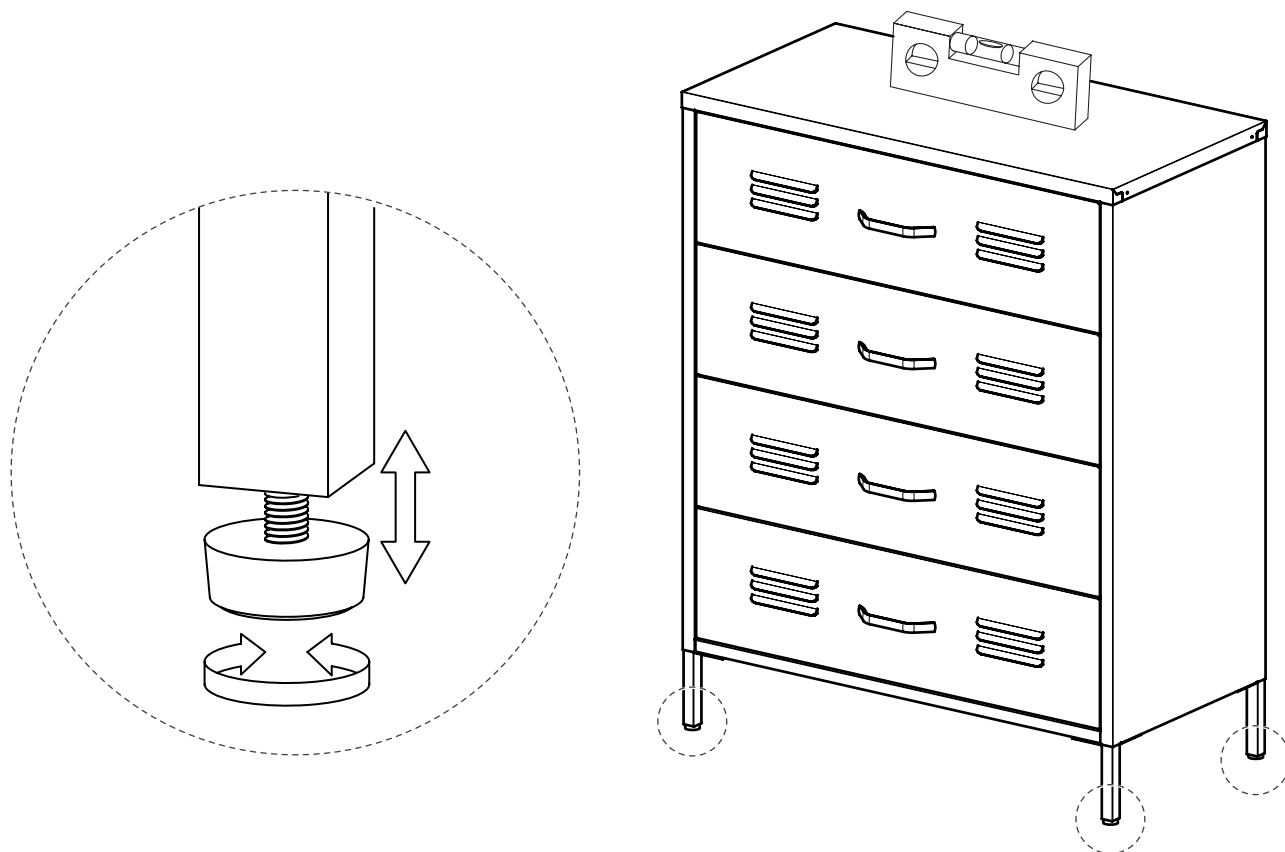

Geschafft!



skølm.

