

**Bellamio**

**Meli**  
Schreibtischstuhl



# Hey,

wir freuen uns, dass Du Dich für unser Produkt entschieden hast. Beachte die kommenden Hinweise, um den Aufbau problemlos zu gestalten.

**Viel Spaß mit Deinem Produkt!**

# 50%

weniger Fehler beim Aufbau durch  
sorgfältiges Lesen der Anleitung



# 15-20

min

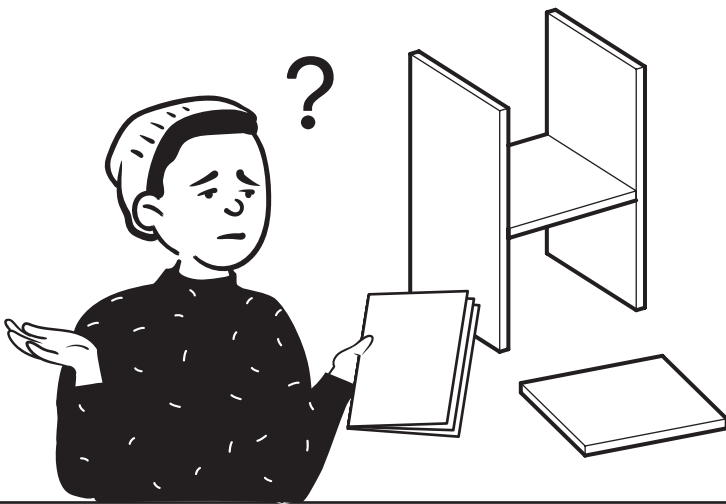
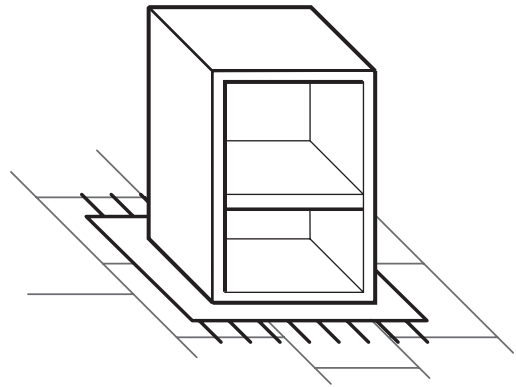
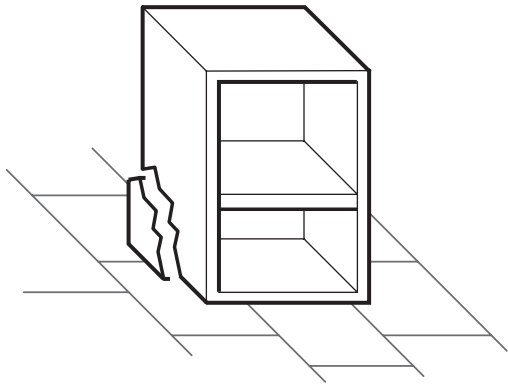

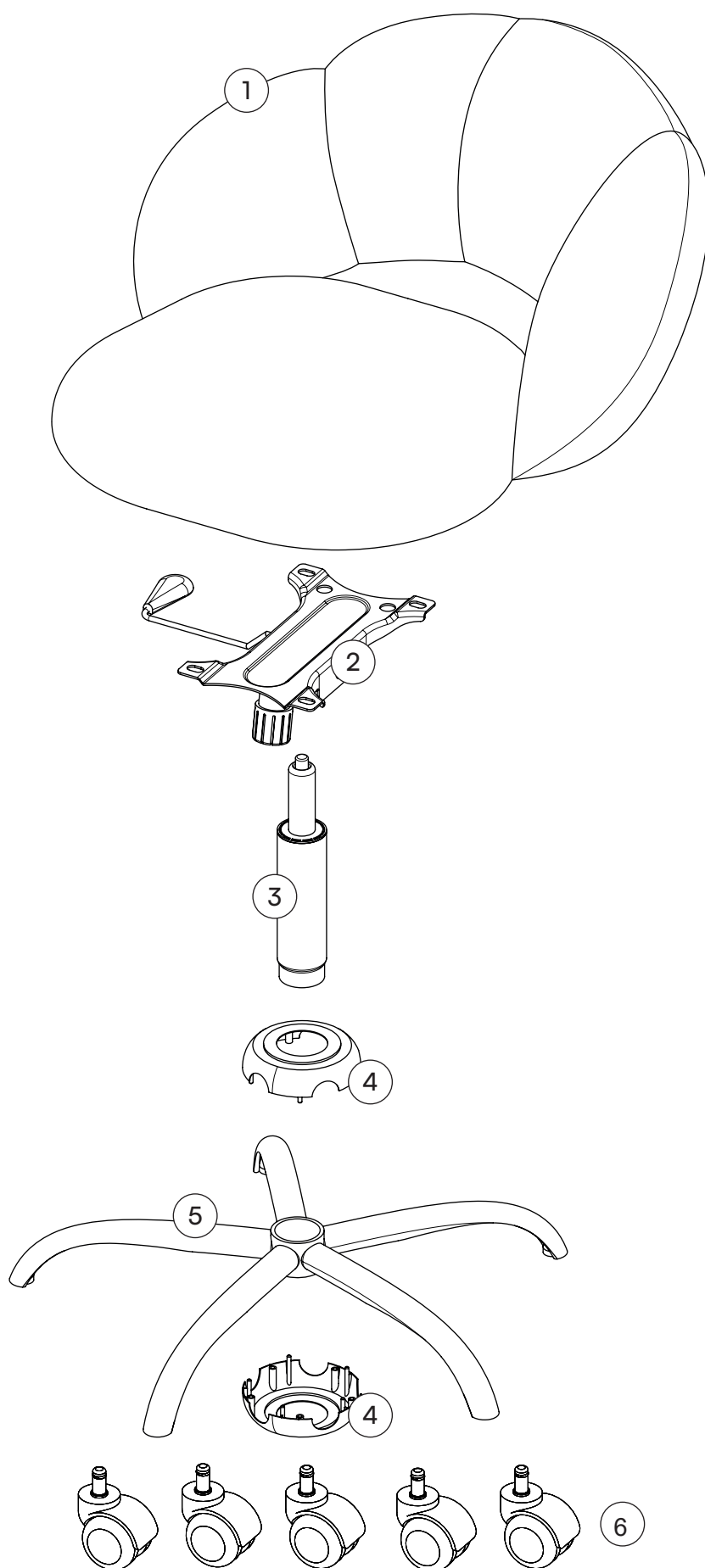

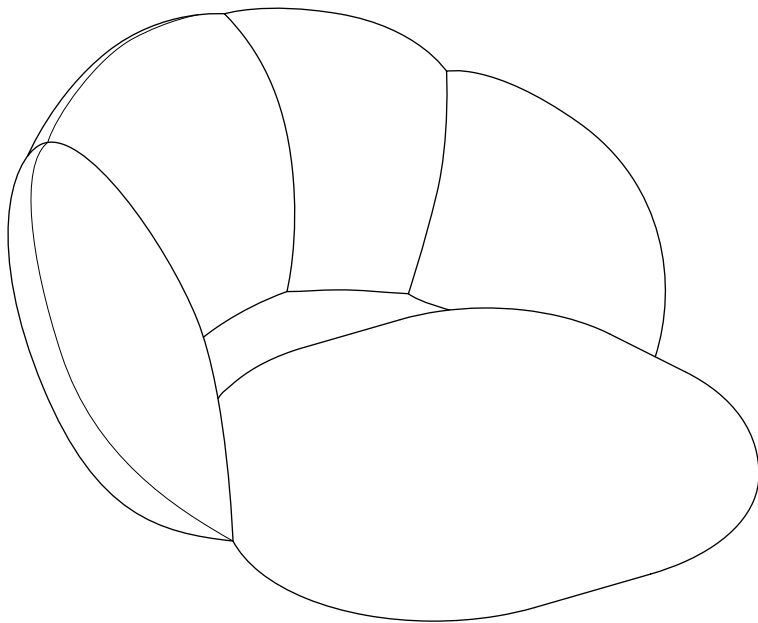

1 Sitzpolster  
1x

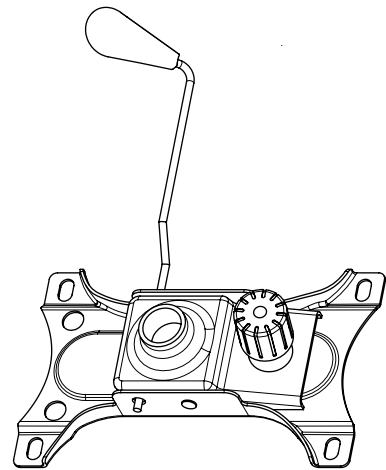

2 Sitzmechanik  
1x



3 Höhengasdruckfeder  
1x

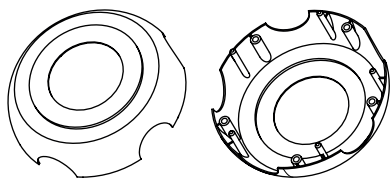

4 Fußkreuzverkleidung  
1x

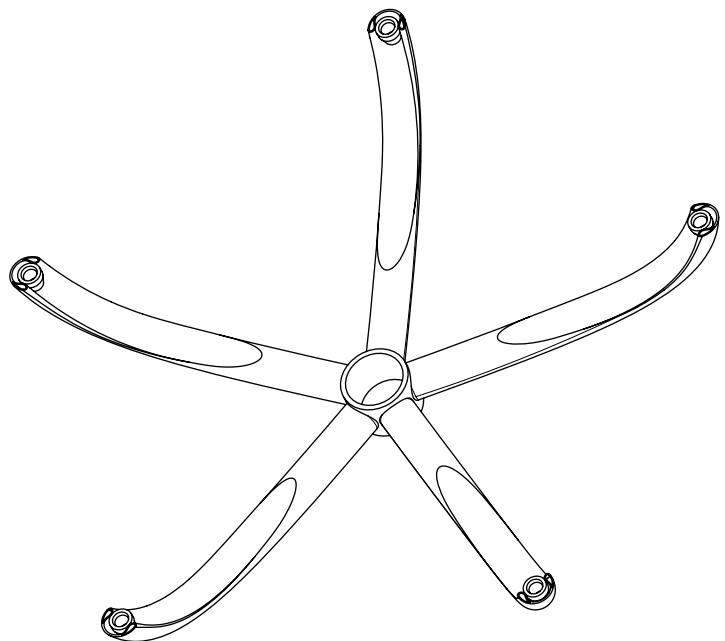

5 Fußkreuz  
1x

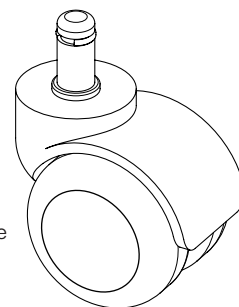

Rolle  
6 5x

**F14** - Schraube M6 x 25

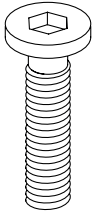

4x

**L91** - Beilagscheibe  $\varnothing 6$

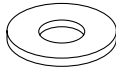

4x

**T10** - Inbusschlüssel

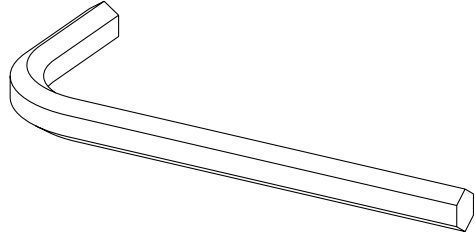

1x

# Ein letzter Check:

Bitte überprüfe, ob Du alle Teile hast.

**Viel Spaß beim Aufbau!**

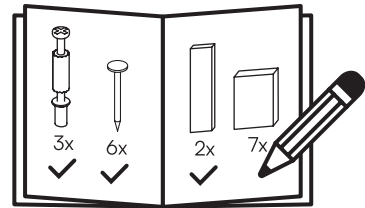

# 1

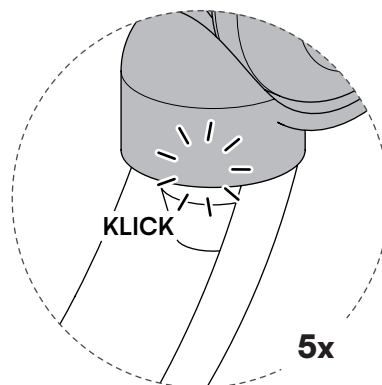
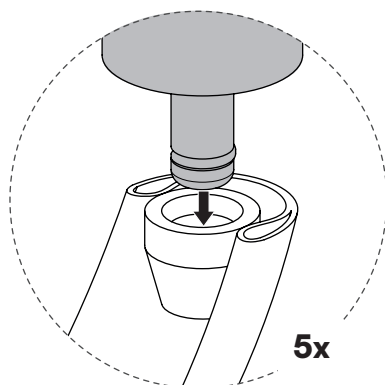
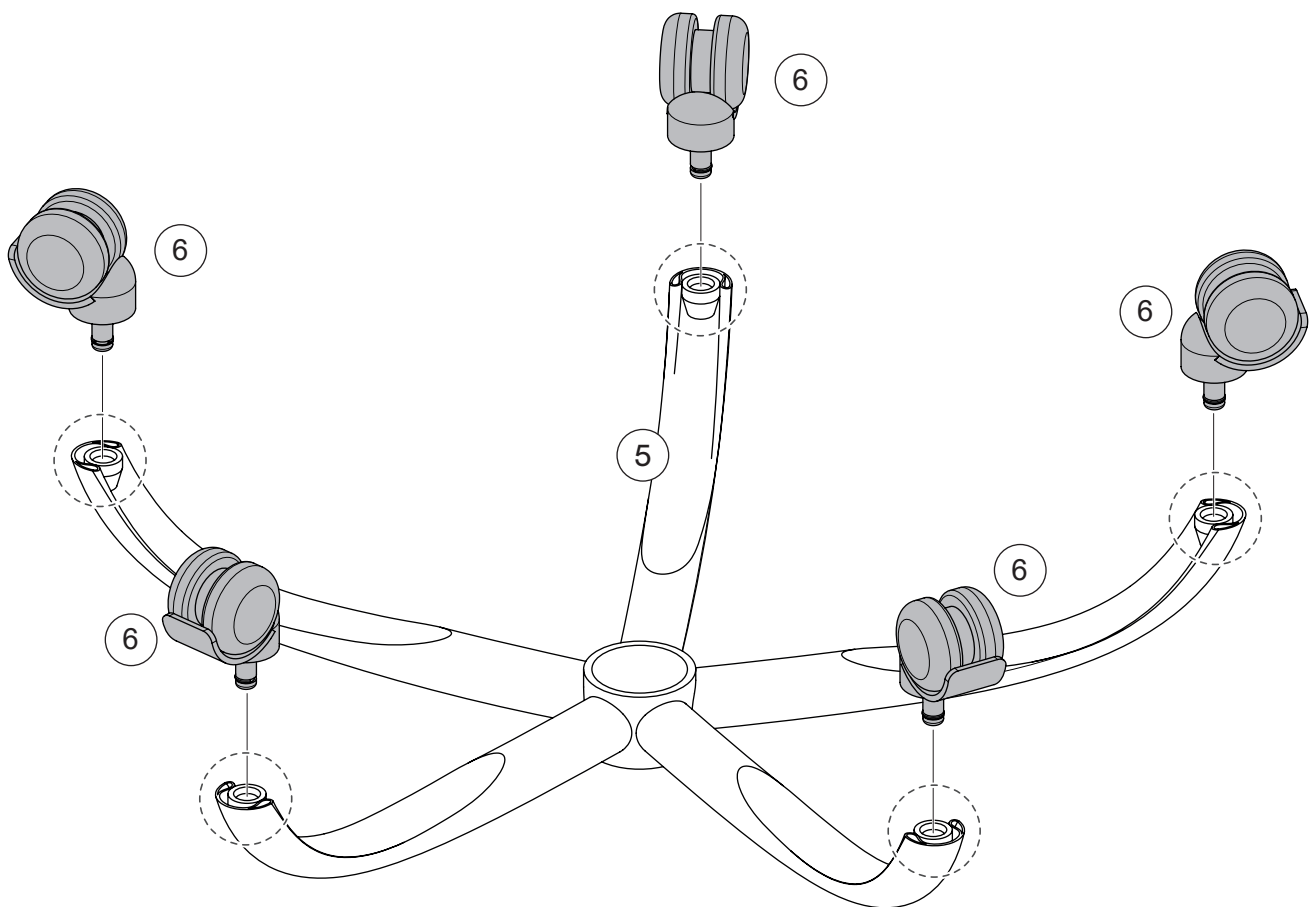

2

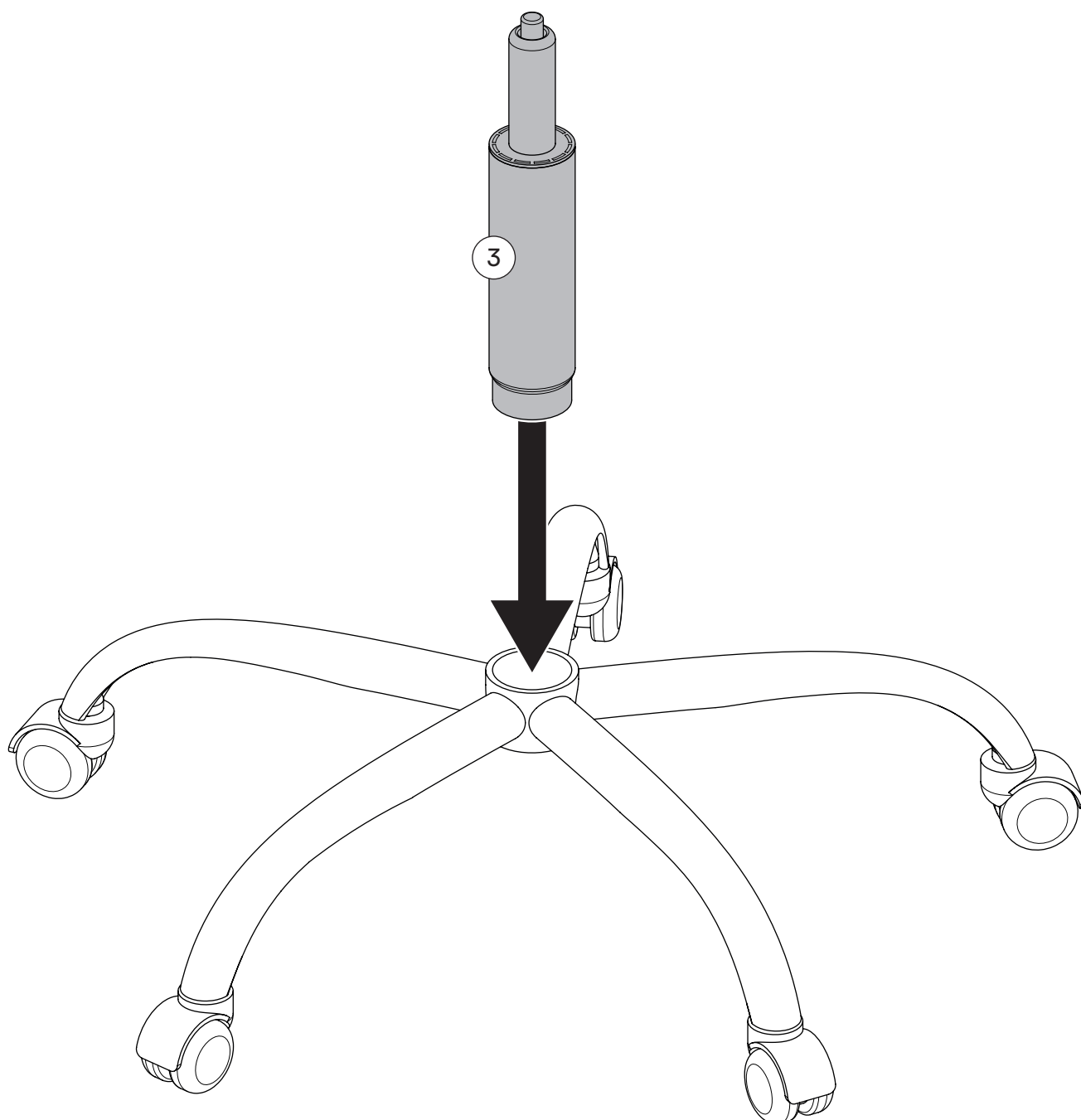



3

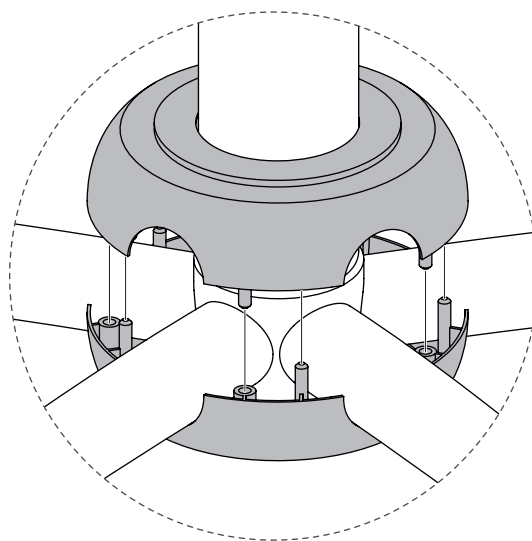
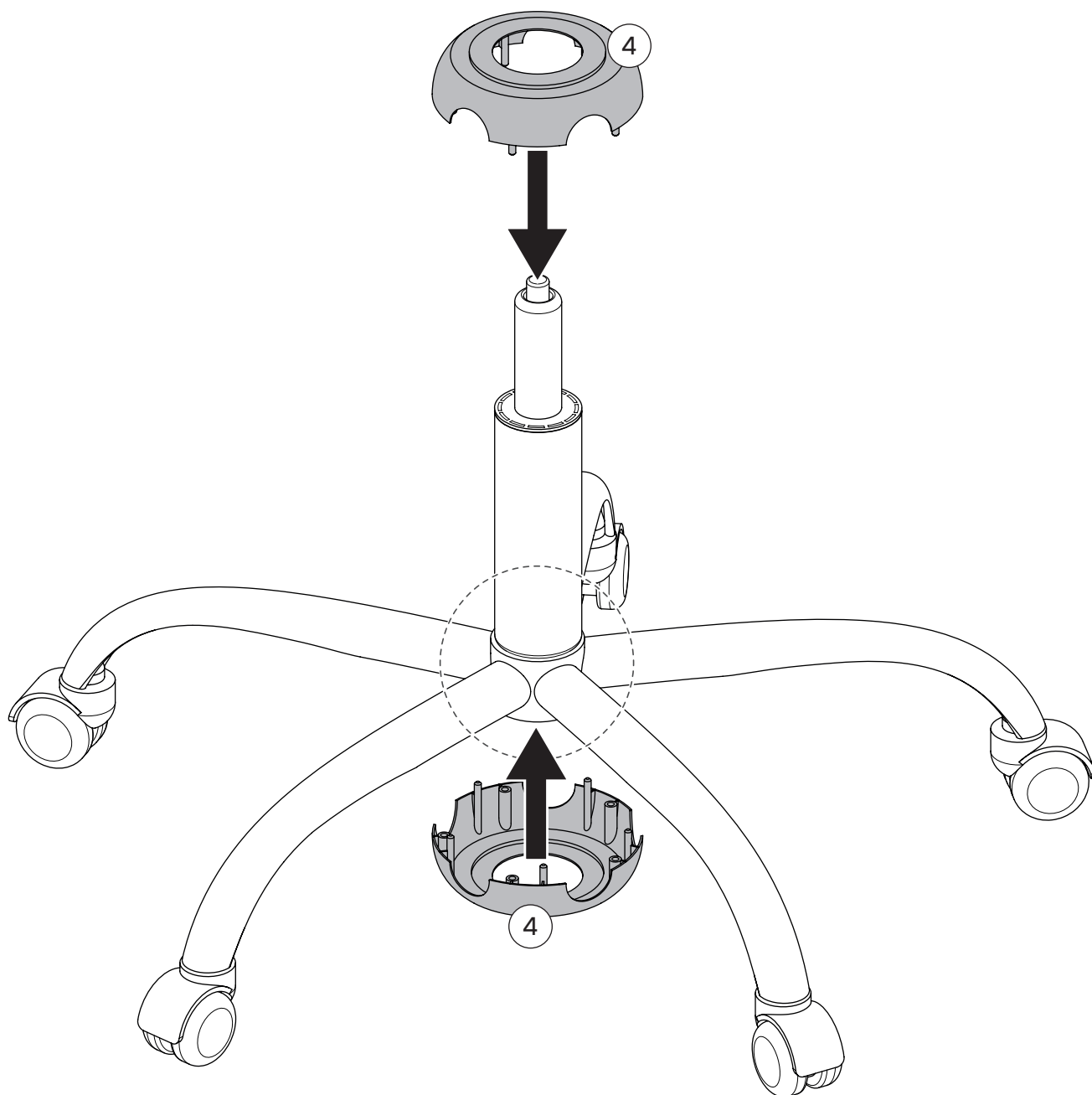

4

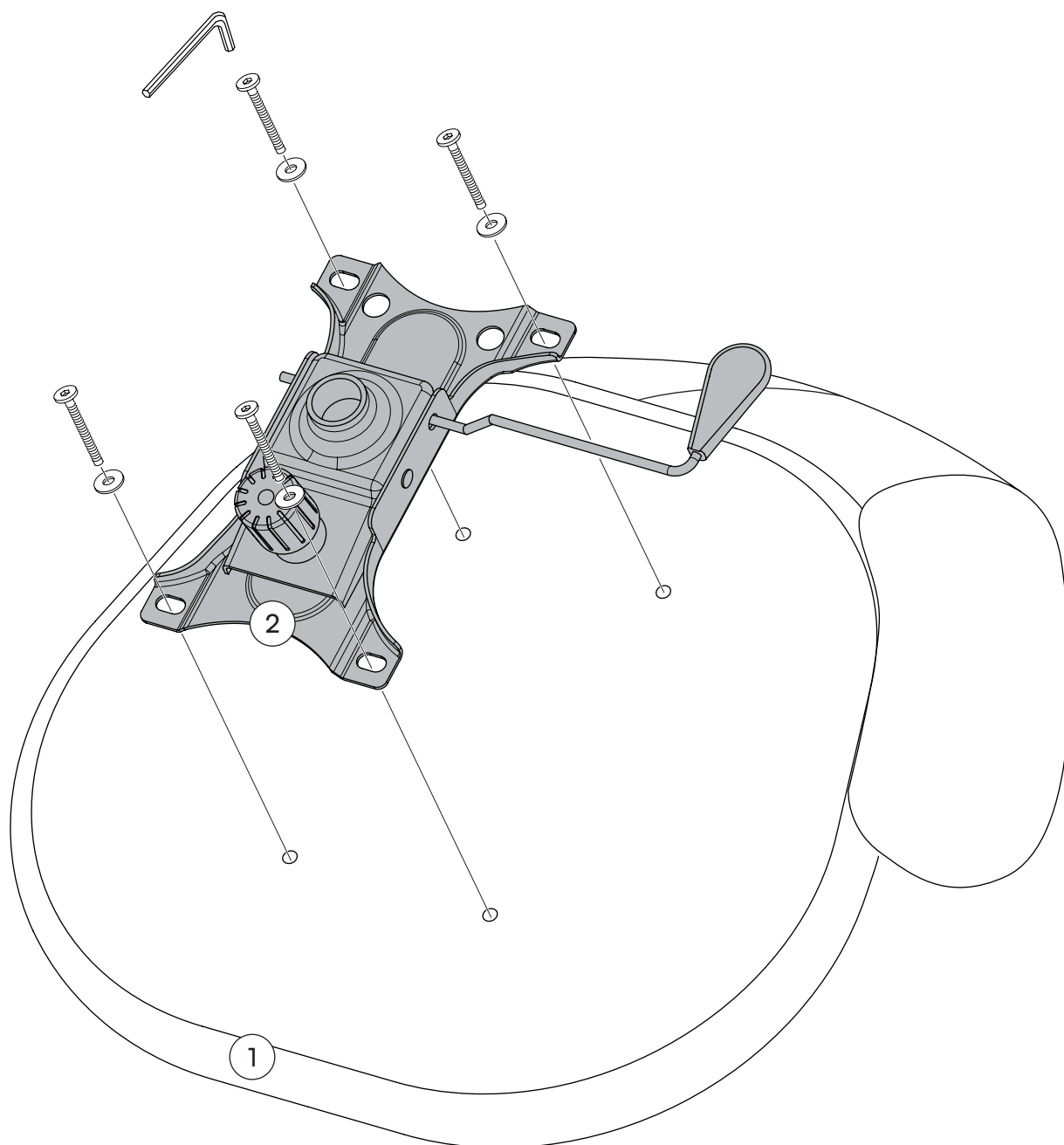
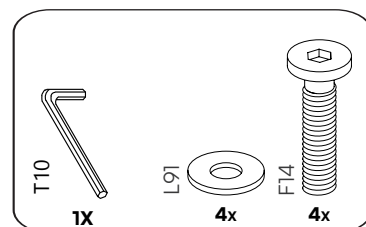

5

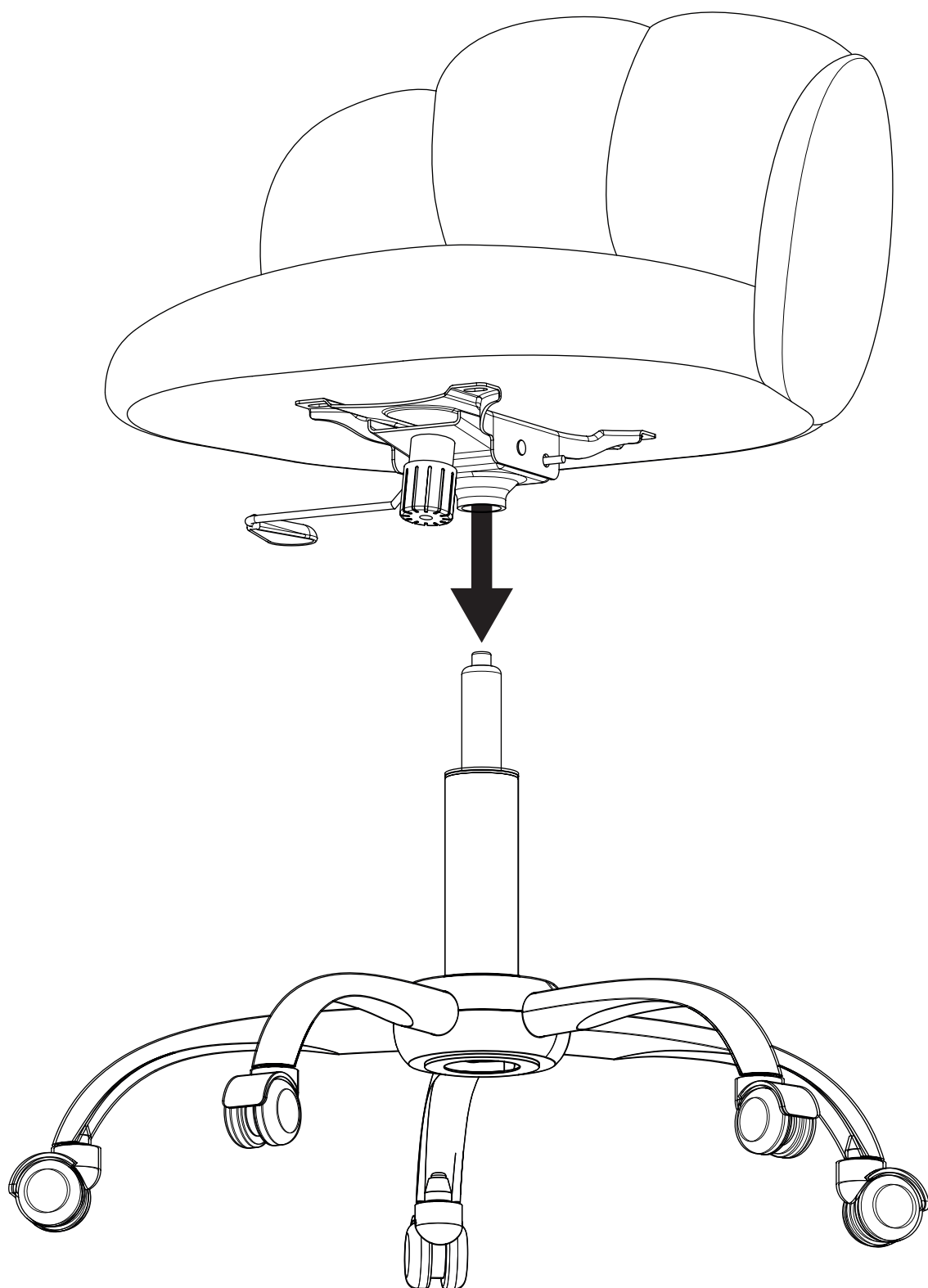

6

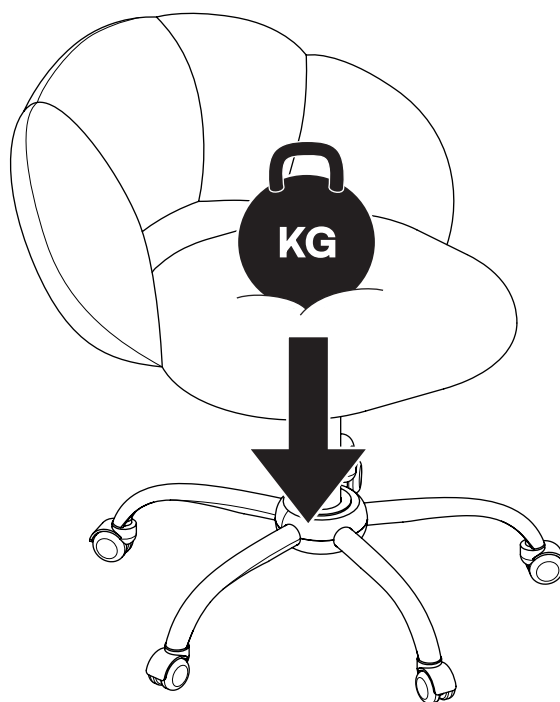
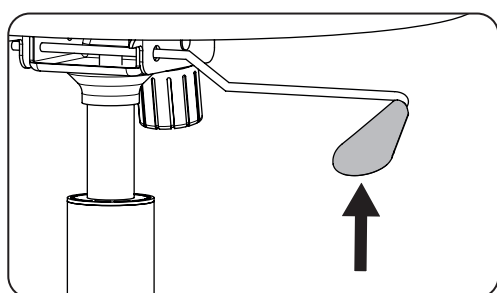
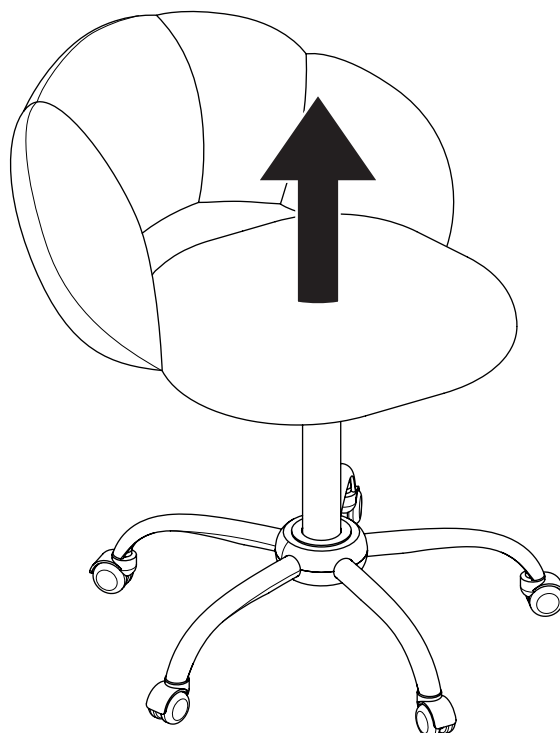
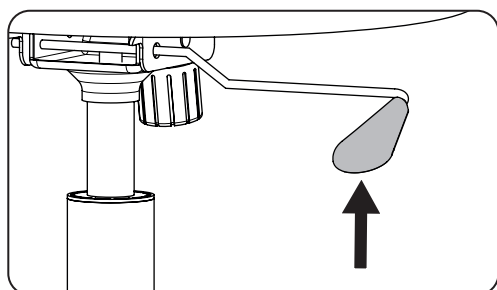

7

