

Bellamio

Kavir
Bett 120/140 x 200 cm



Hey,

wir freuen uns, dass Du Dich für unser Produkt entschieden hast. Beachte die kommenden Hinweise, um den Aufbau problemlos zu gestalten.

Viel Spaß mit Deinem Produkt!

50%

weniger Fehler beim Aufbau durch
sorgfältiges Lesen der Anleitung

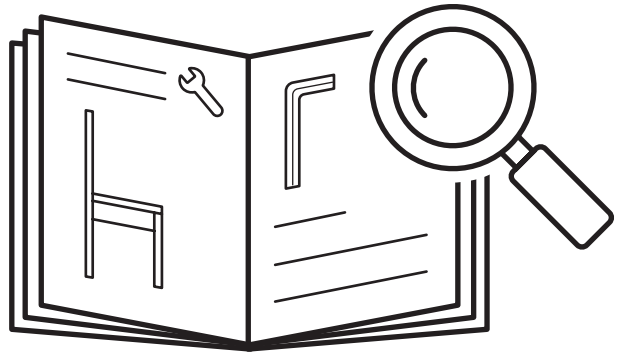

50-60

min

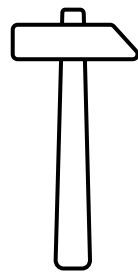

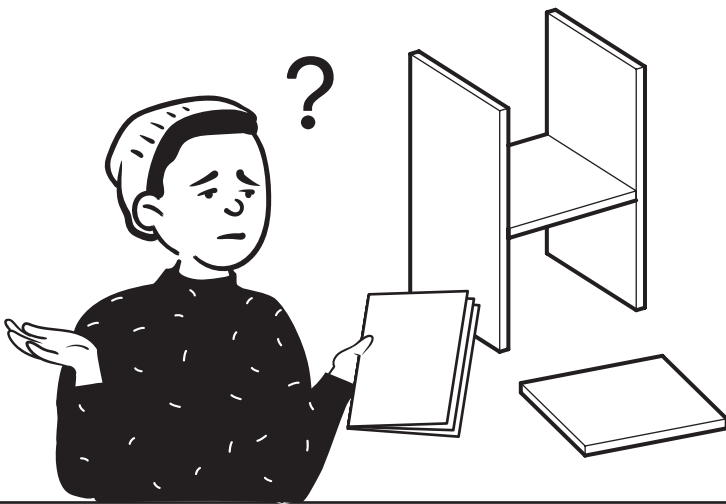
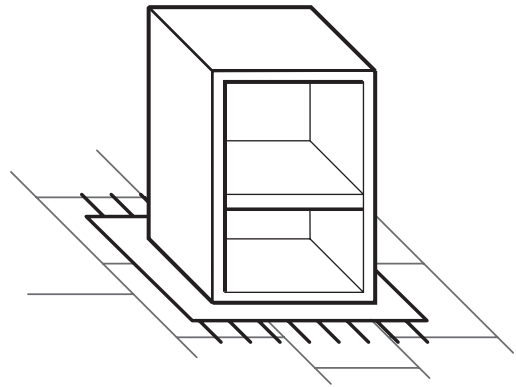
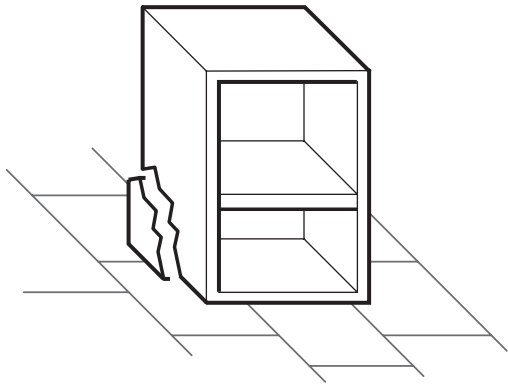

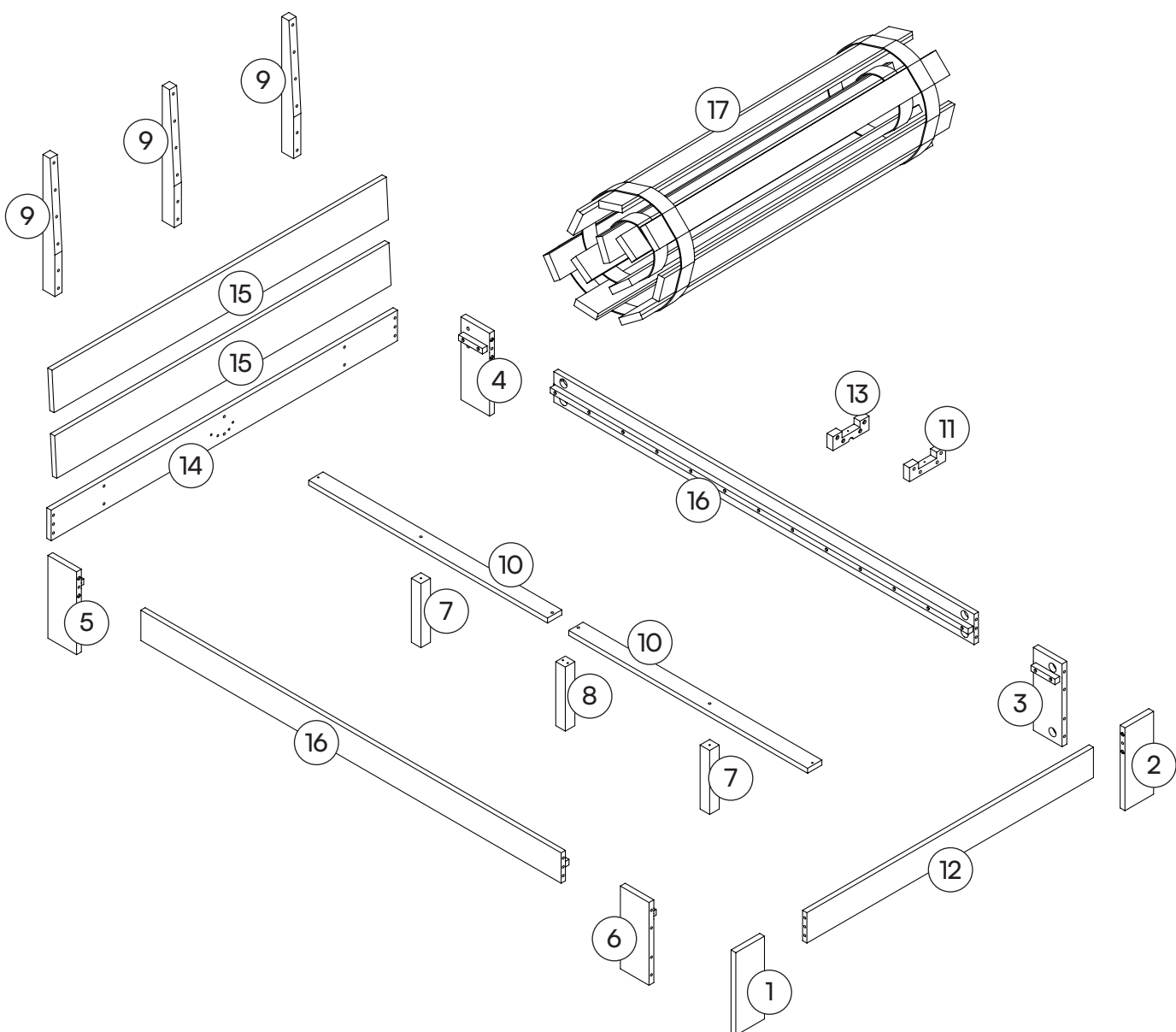

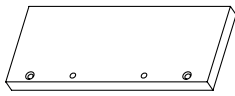

1 Fuß
1x

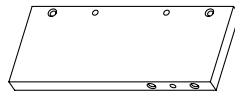

2 Fuß
1x

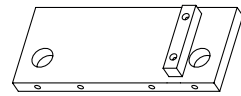

3 Fuß
1x

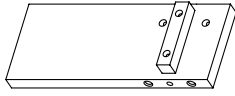

4 Fuß
1x

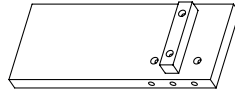

5 Fuß
1x

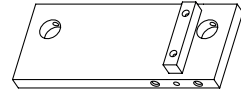

6 Fuß
1x

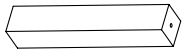

7 Mittelfuß
2x

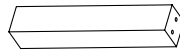

8 Mittelfuß
1x

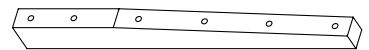

9 Kopfteilstrebe
3x



10 Mittelbalken
2x

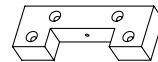

11 Mittelbalken
1x

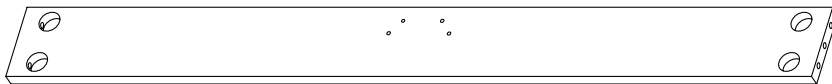

12 Fußleiste
1x



13 Mittelbalken
1x

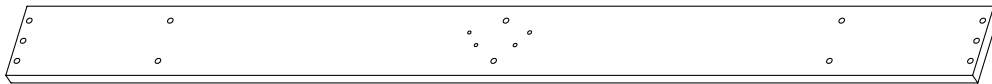

14 Kopfleiste
1x

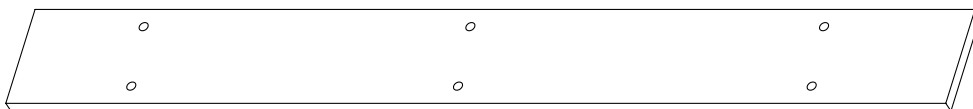

15 Kopfteil
2x

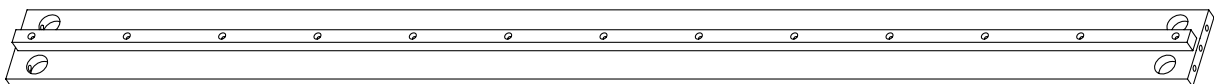

16 Seitenteil
2x

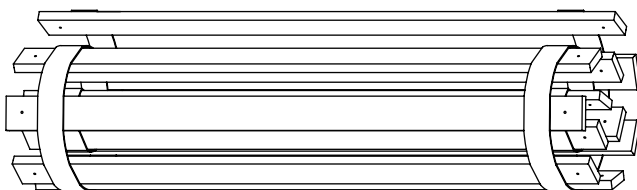

17 Lattenrost
1x

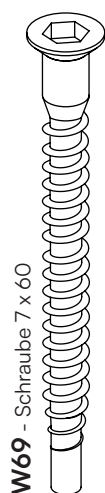

W69 - Schraube 7 x 60

4x

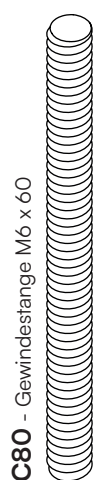

C80 - Gewindestange M6 x 60

16x

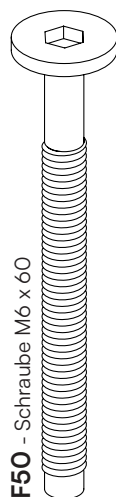

F50 - Schraube M6 x 60

10x

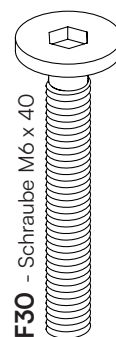

F30 - Schraube M6 x 40

12x

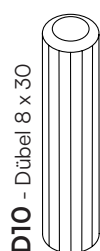

D10 - Dübel 8 x 30

12x



W44 - Schraube 4 x 30

38x

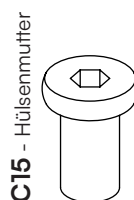

C15 - Hülsenmutter

6x



C21 - Fassmutter

4x

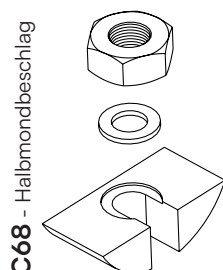

C68 - Halbmondbeschlag

16x

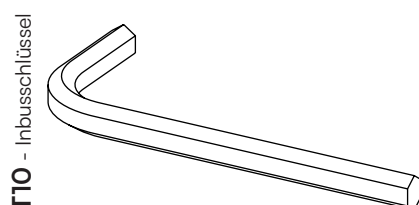

T10 - Inbusschlüssel

2x

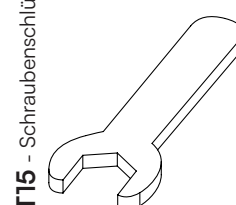

T15 - Schraubenschlüssel

1x

Ein letzter Check:

Bitte überprüfe, ob Du alle Teile hast.

Viel Spaß beim Aufbau!

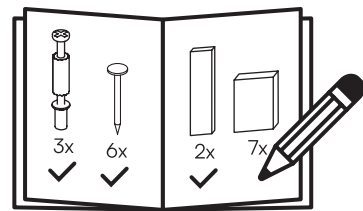

1

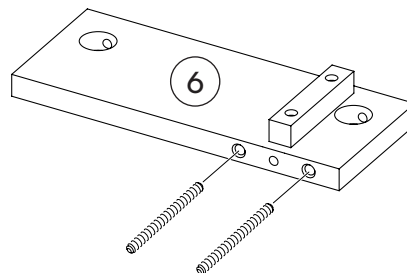
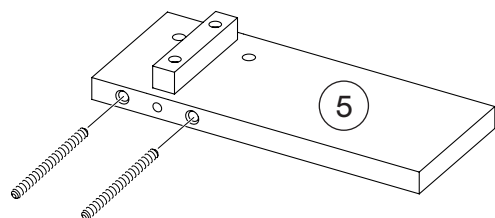
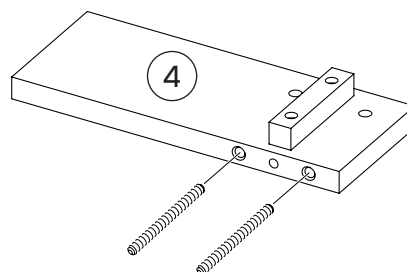
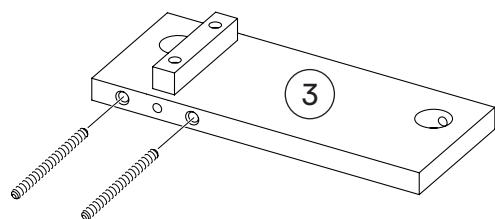
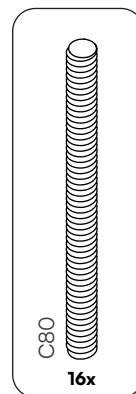
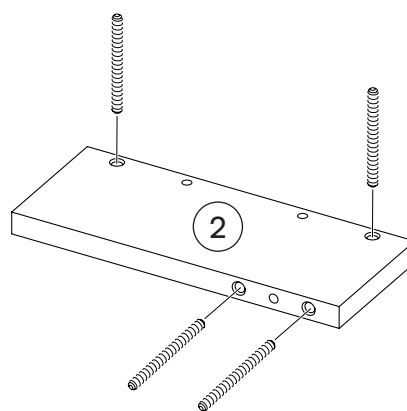
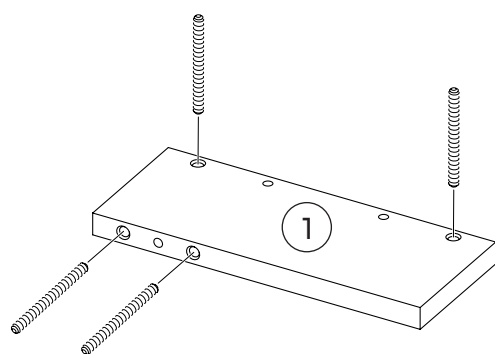

2

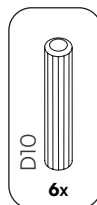
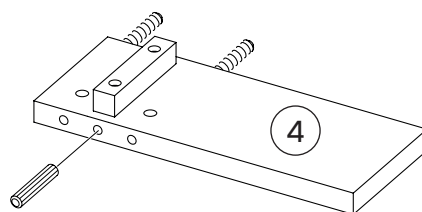
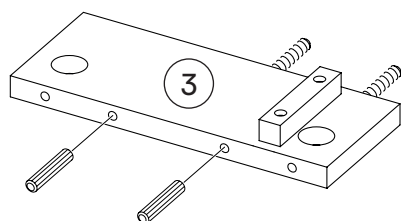
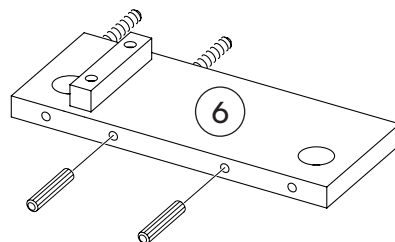
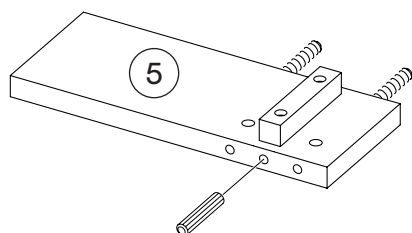

3

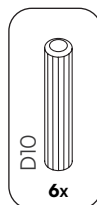
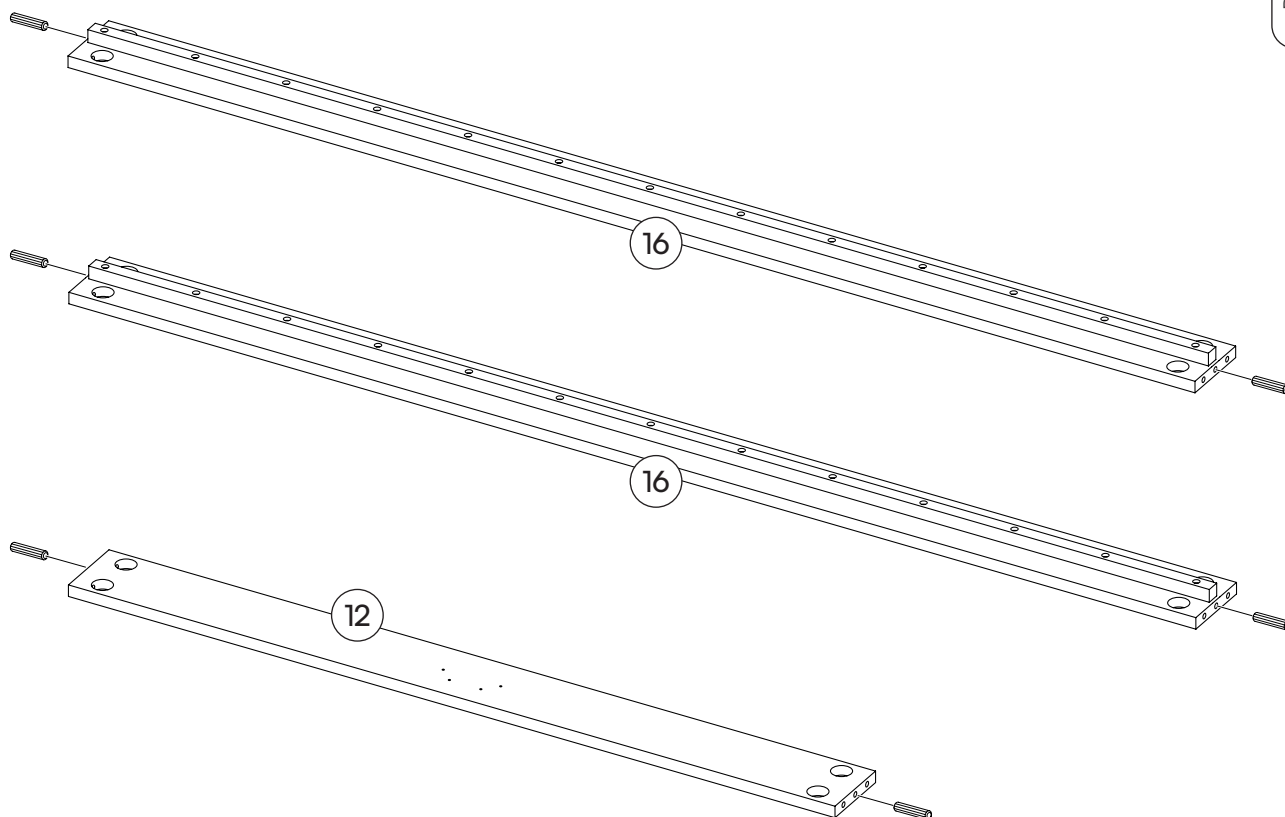

4

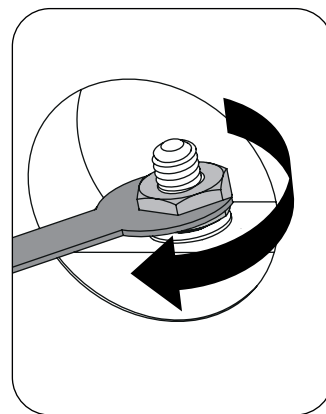
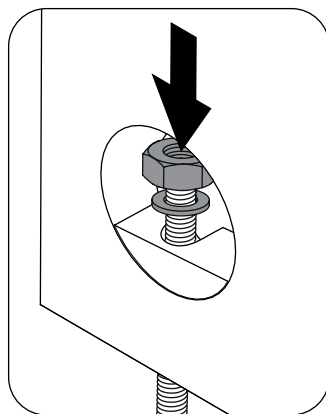
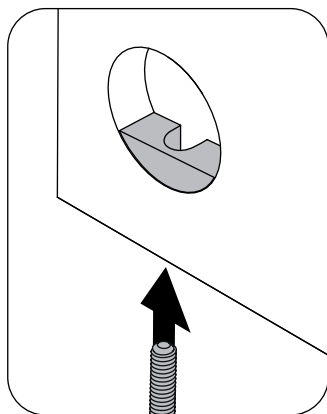
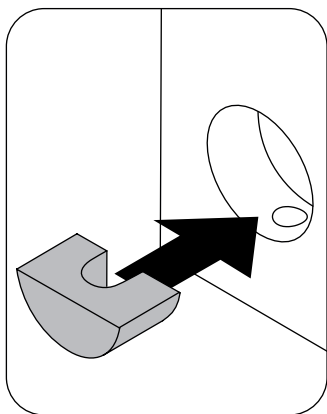
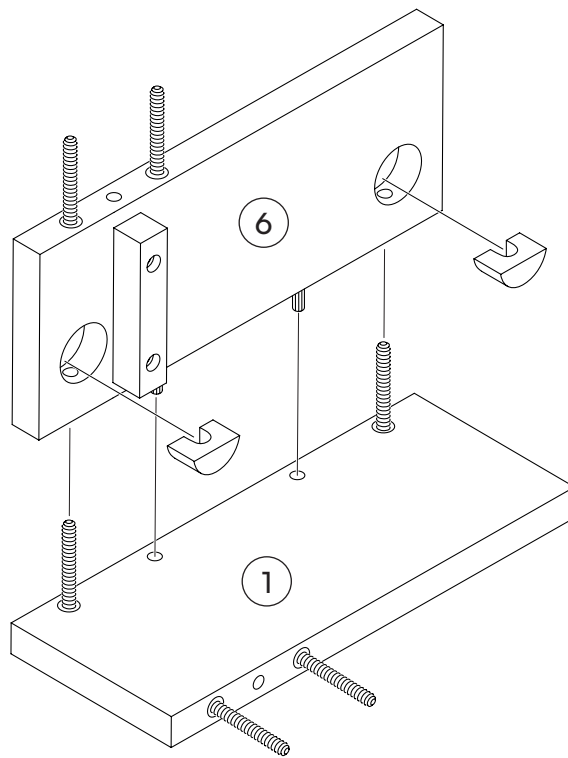
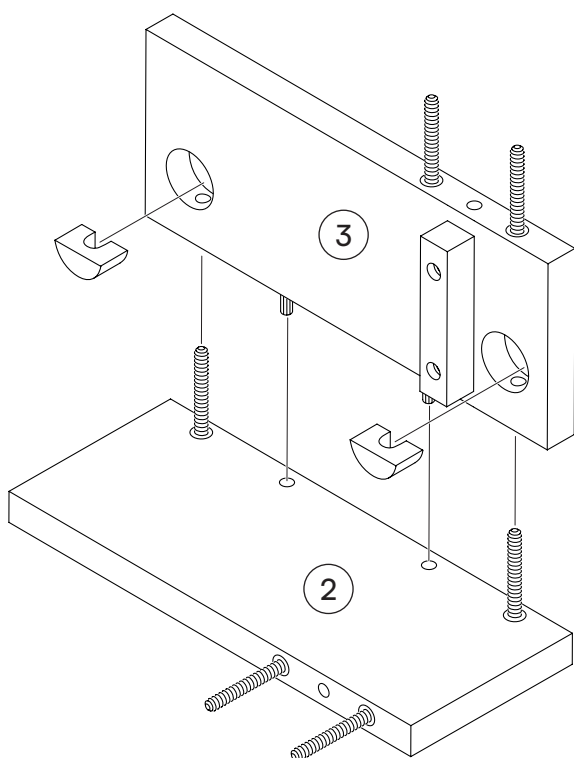
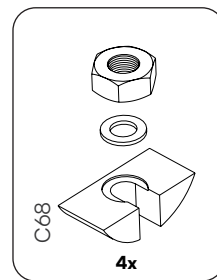

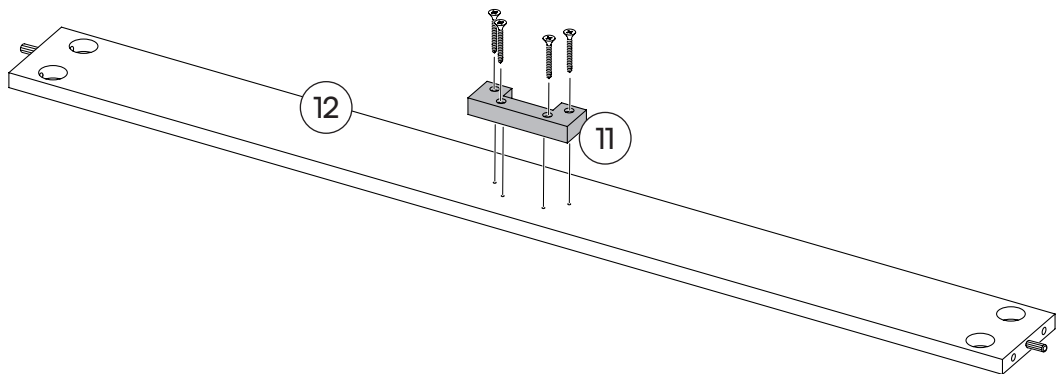
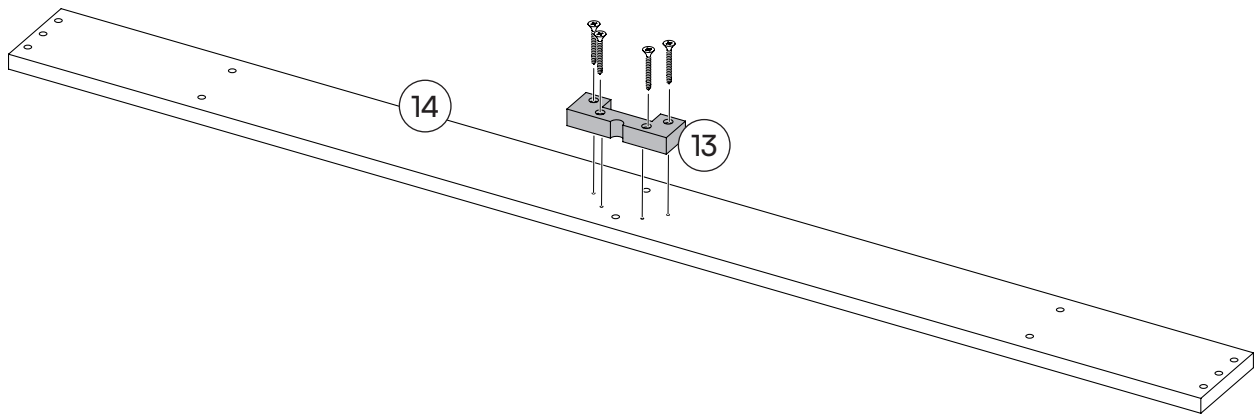
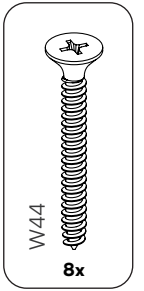

6

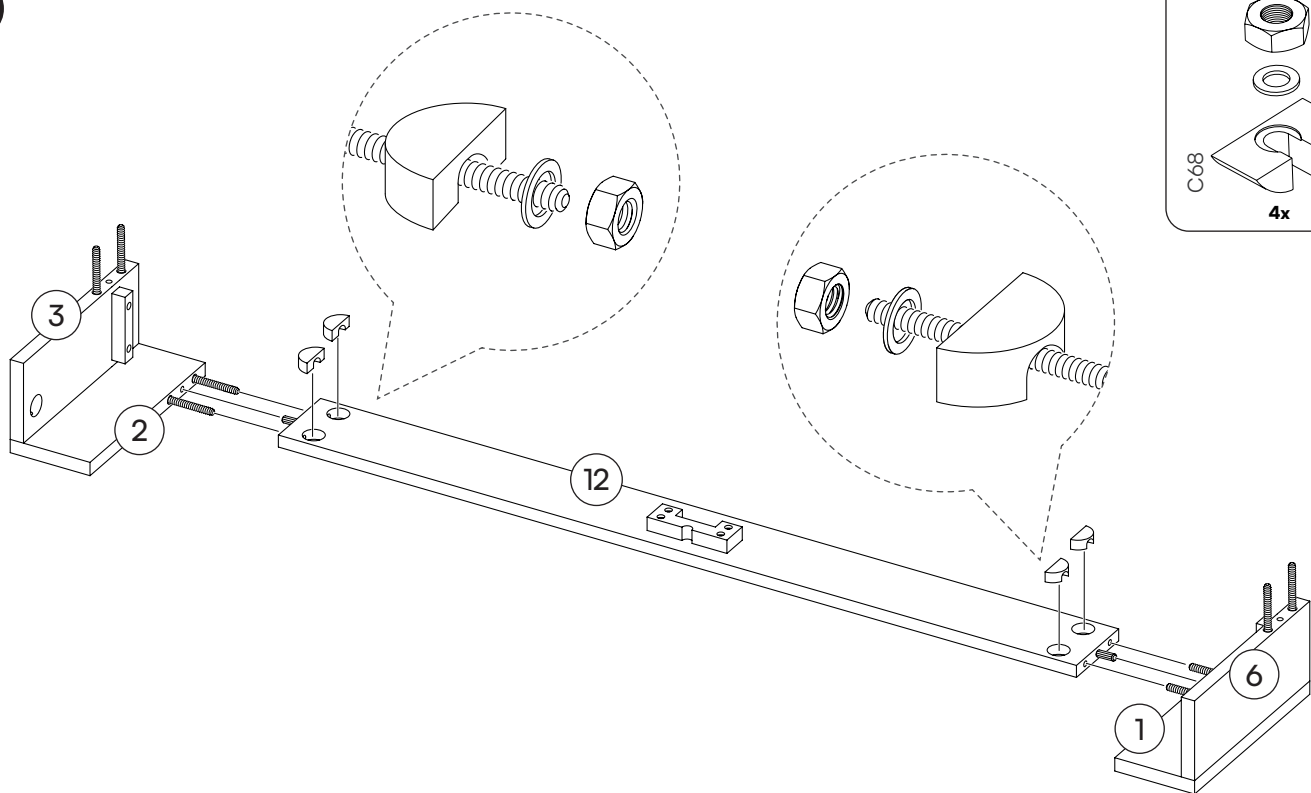

7

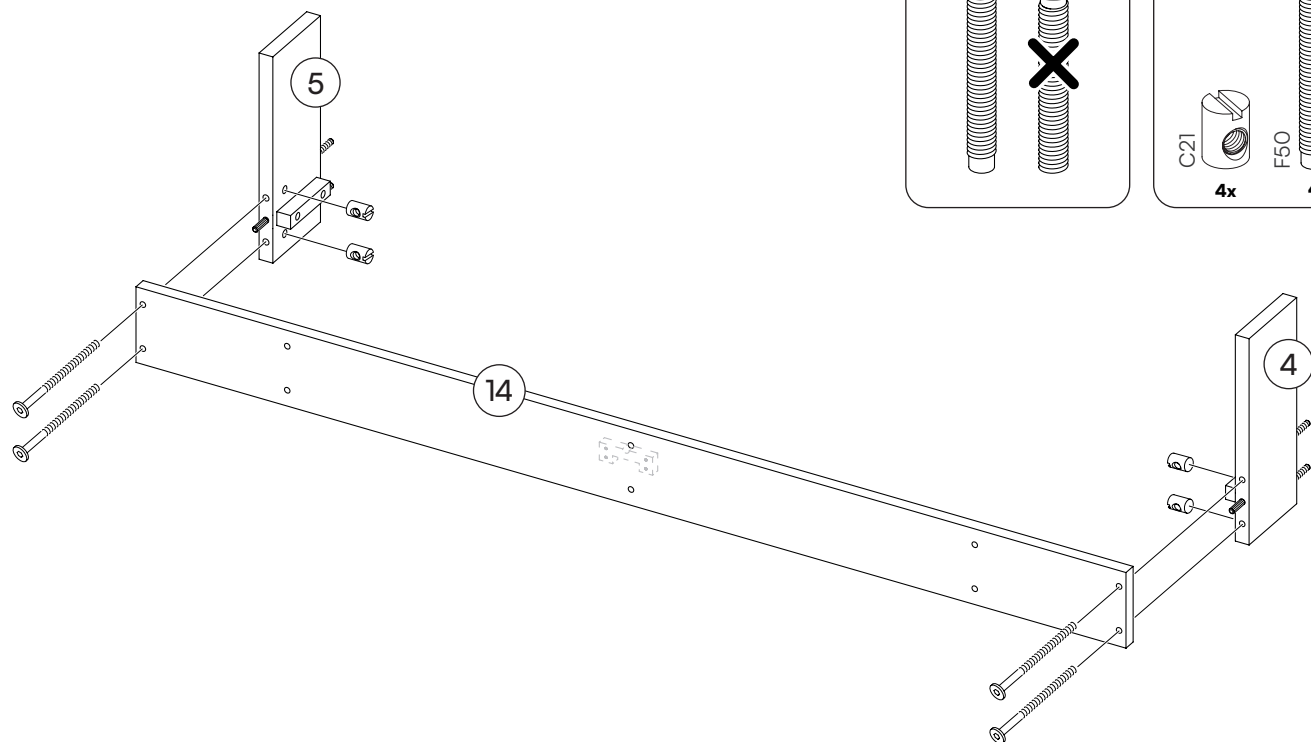

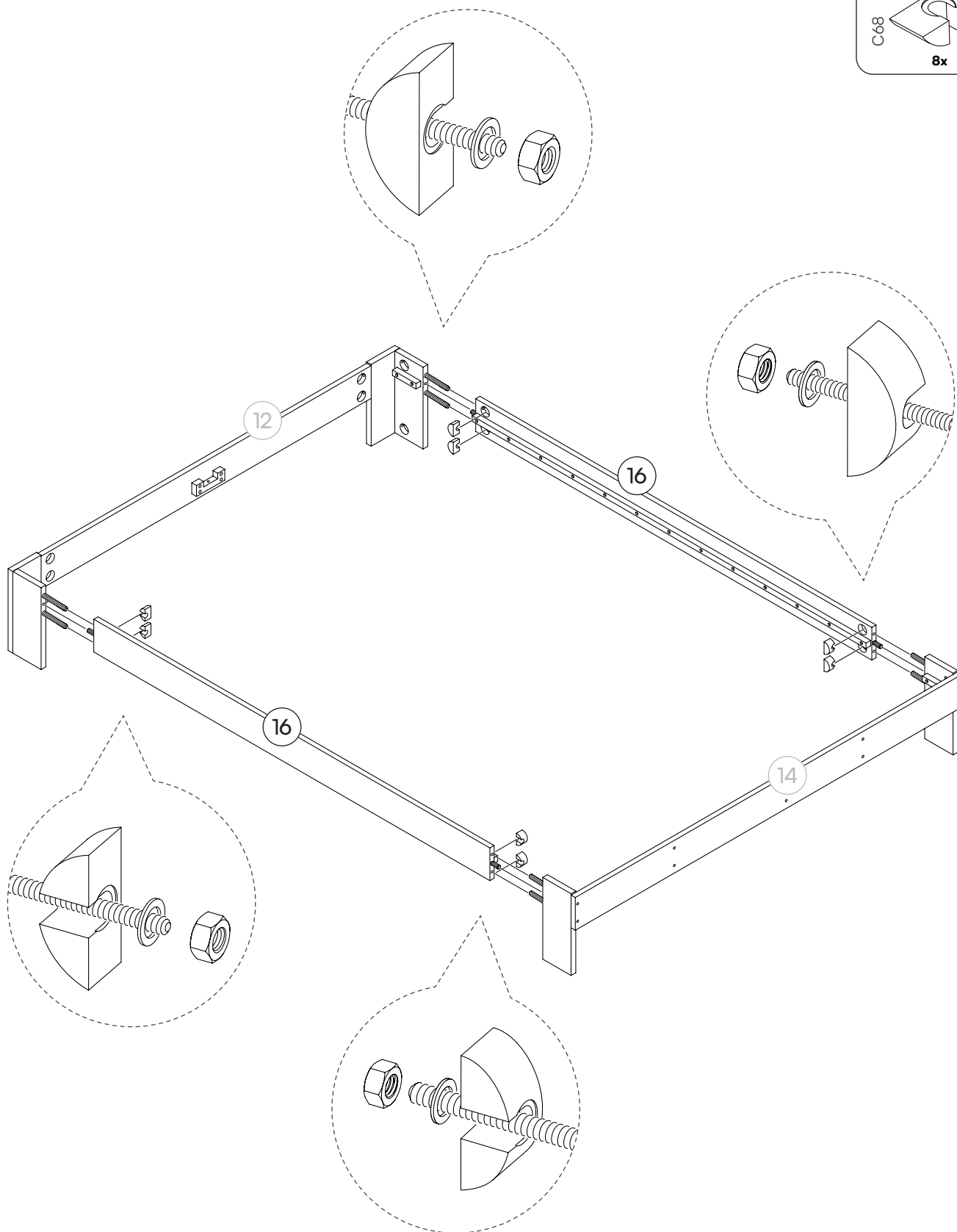
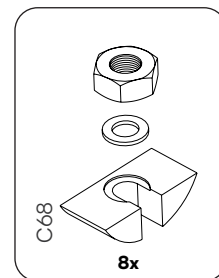

9

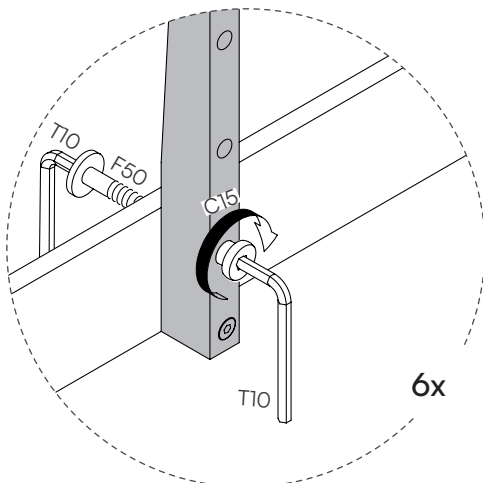
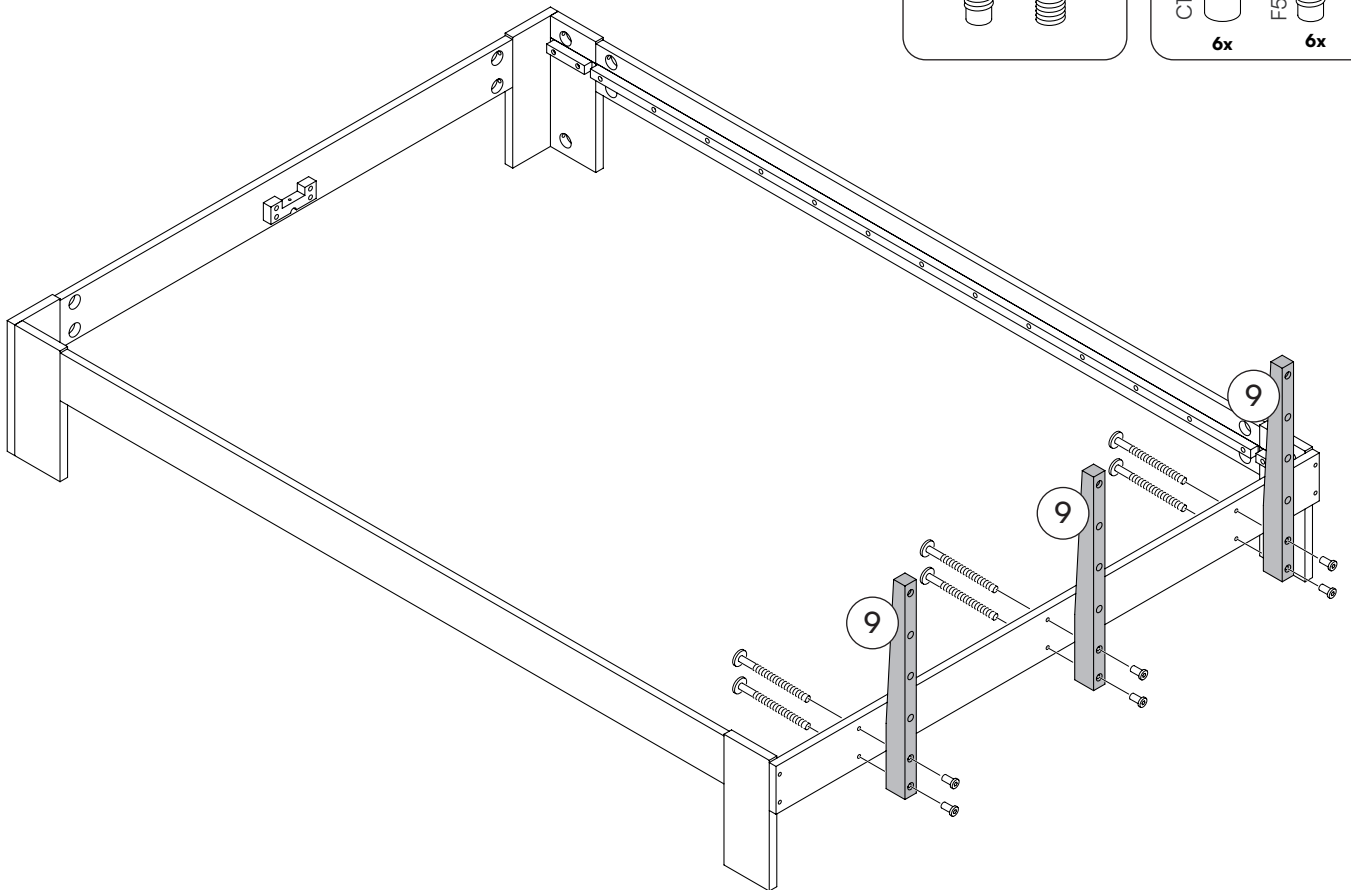
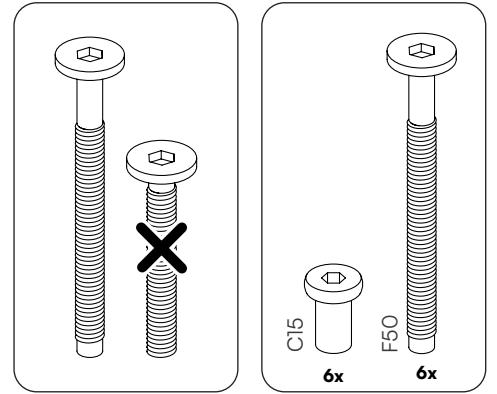

10

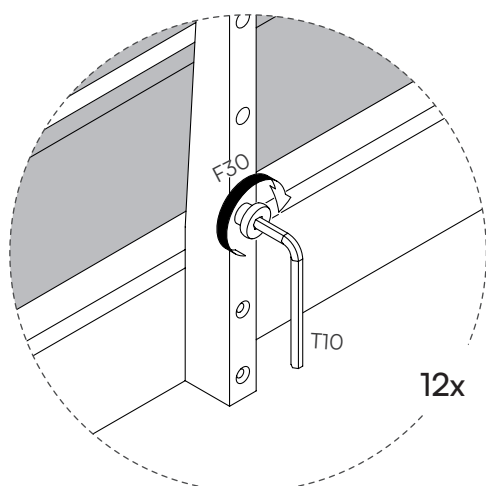
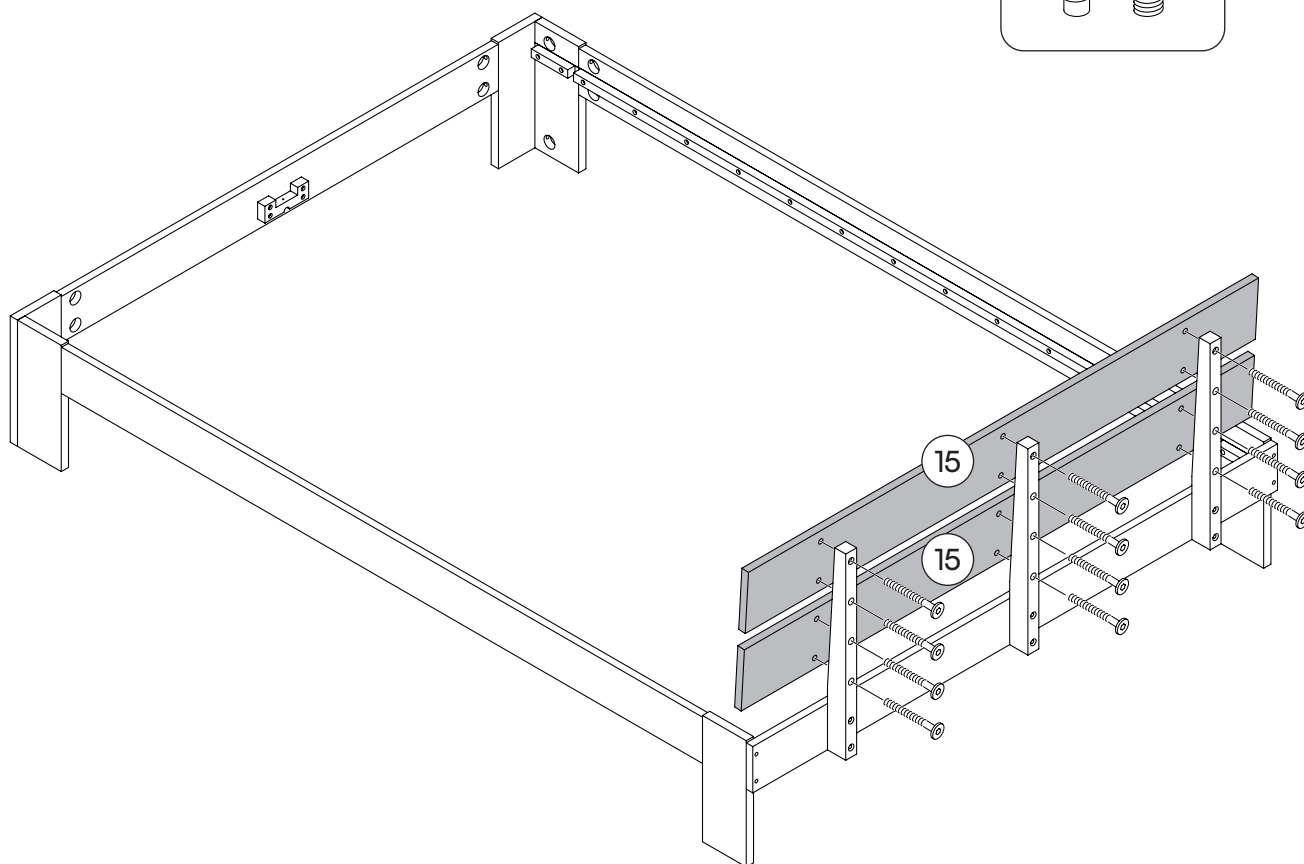
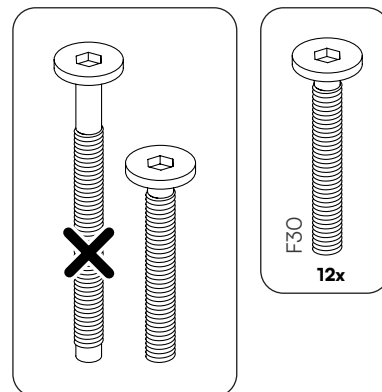

11

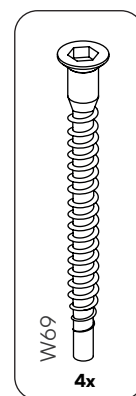
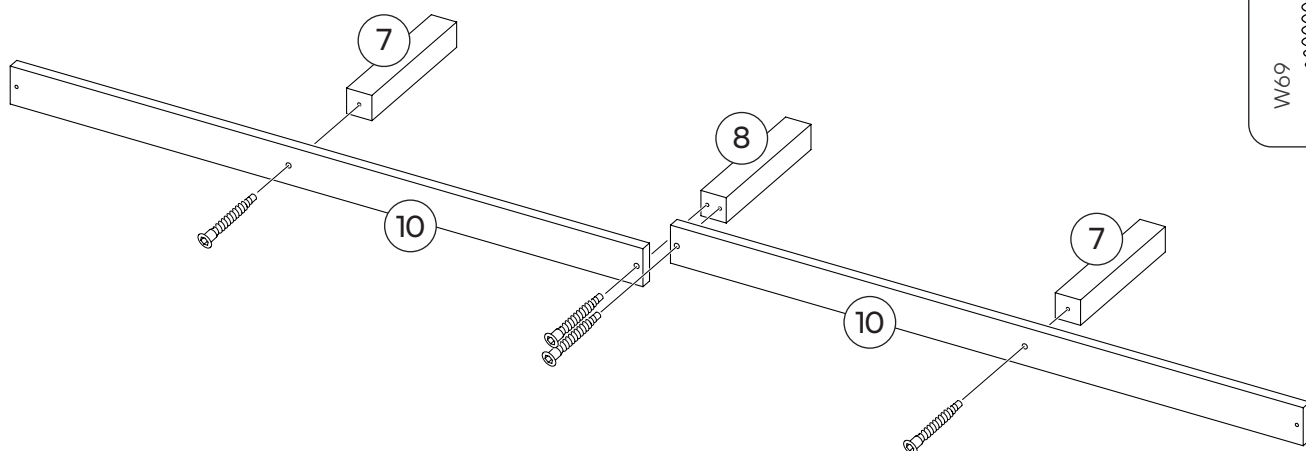

12

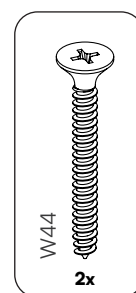
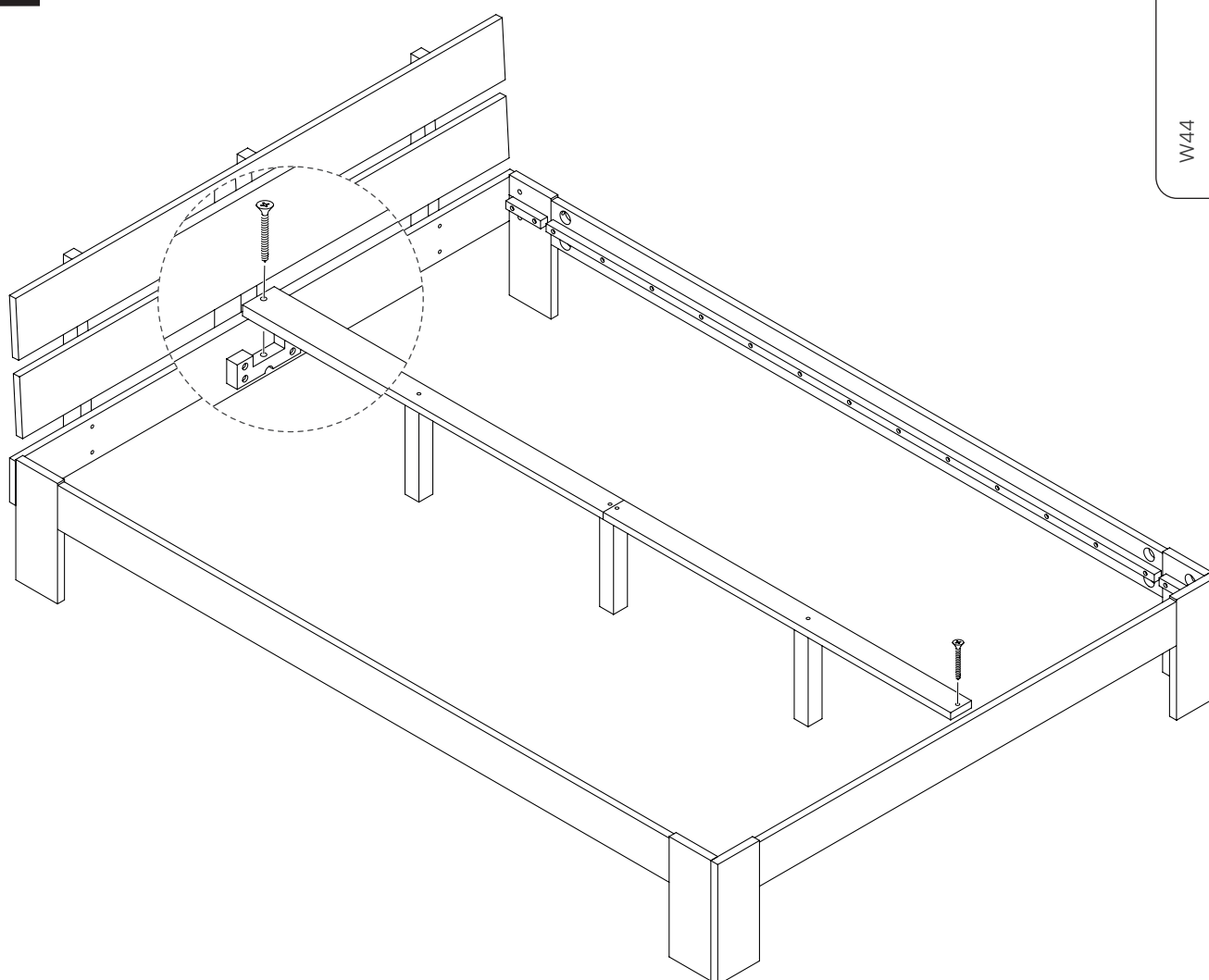

13

