

STEELSON

Mülltonnenbox 'Thoria'

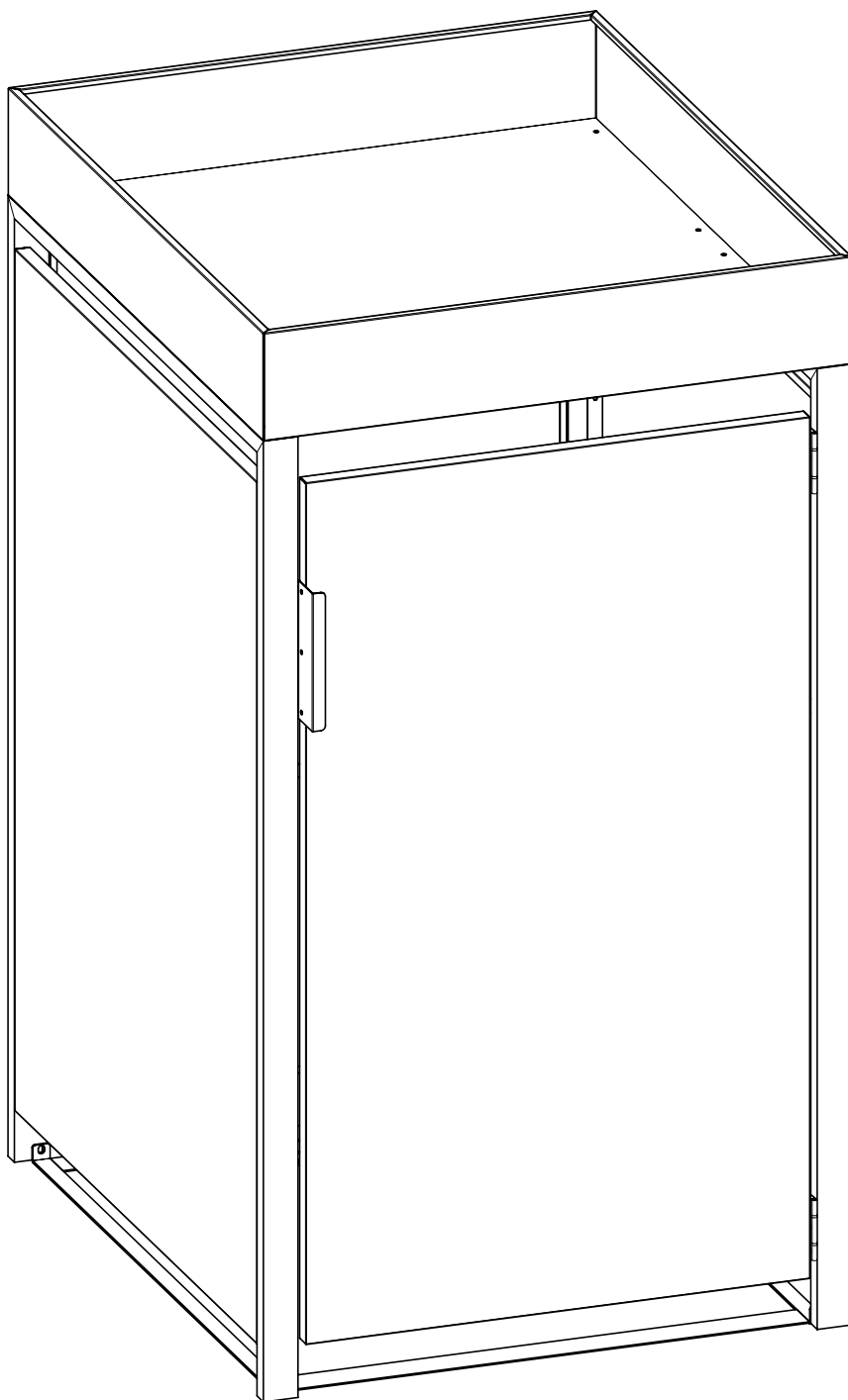

Hier geht's zum
Aufbauvideo



Hey,

wir freuen uns, dass Du Dich für unser Produkt entschieden hast. Beachte die kommenden Hinweise, um den Aufbau problemlos zu gestalten.

Viel Spaß mit Deinem Produkt!

50%

weniger Fehler beim Aufbau durch
sorgfältiges Lesen der Anleitung

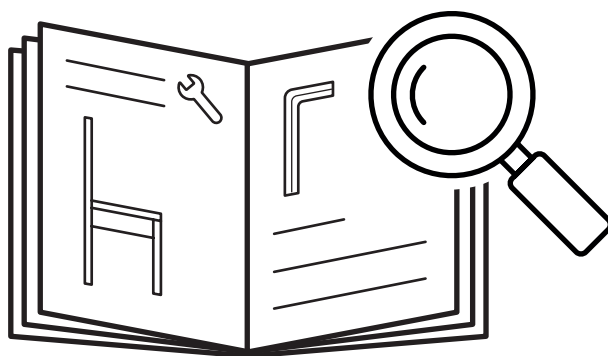

optional

60-90

min



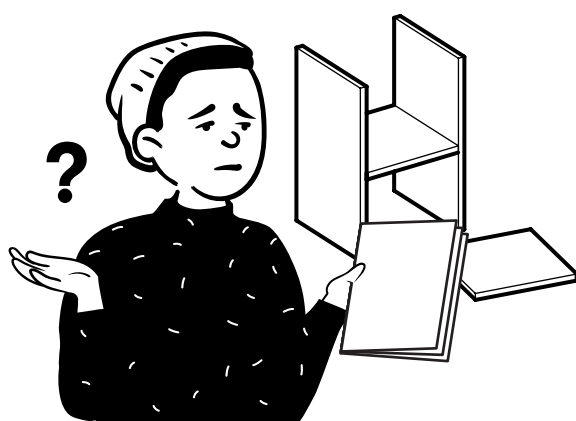
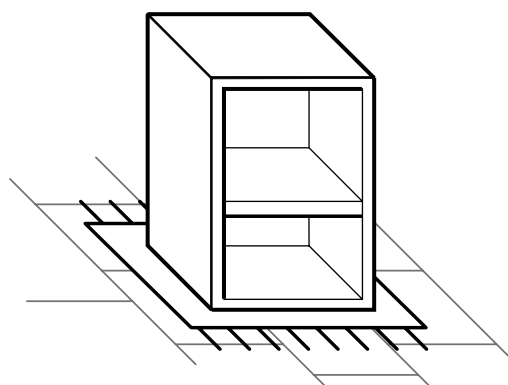
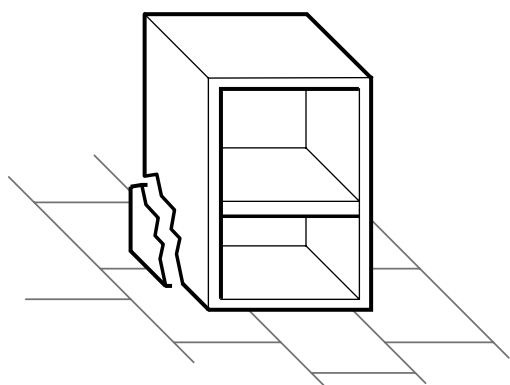

Fragen?

Wir sind für Dich da!



✉ service@bela-living.de

1.

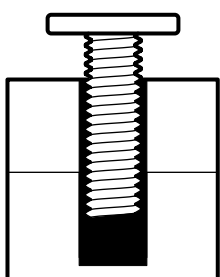

Ziehe die Schrauben während
des gesamten Aufbaus
zunächst per Hand an.

2.

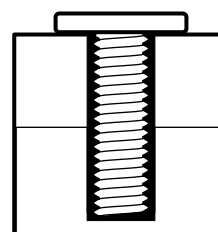

Justiere das Produkt final
und ziehe die Schrauben
vollständig an.

G24 - Kreuzschraube

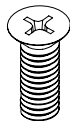

24x

G25 - Kreuzschraube

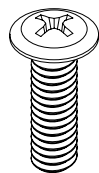

4x

K10 - Schraube



8x

L19 - Beilagscheibe



8x

A13 - Dübel und Schraube



4x

G28 - Kreuzschraube

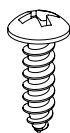

3x

A14 - Scharnier

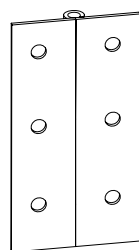

2x

A16 - Abdeckkappe

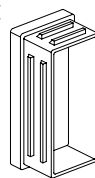

4x

A17 - Magnet

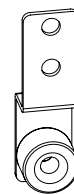

2x

L77 - Karabiner

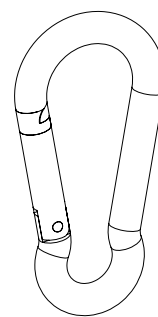

2x

A19 - Türgriff

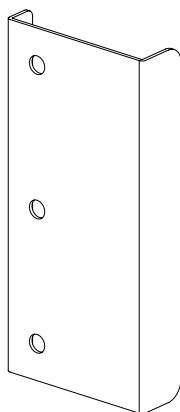

1x

A20 - Metallkette

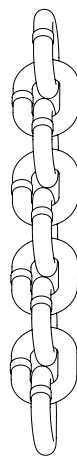

1x

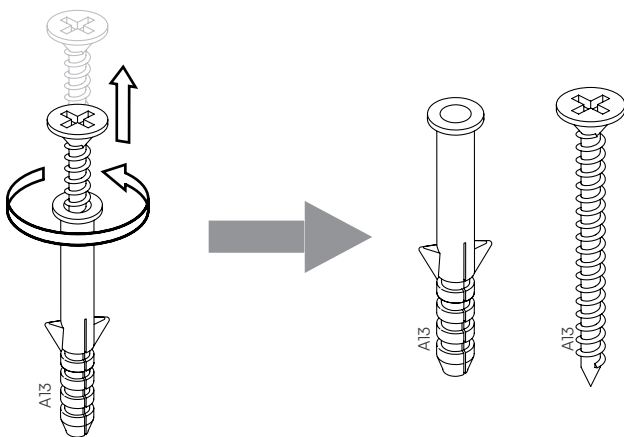
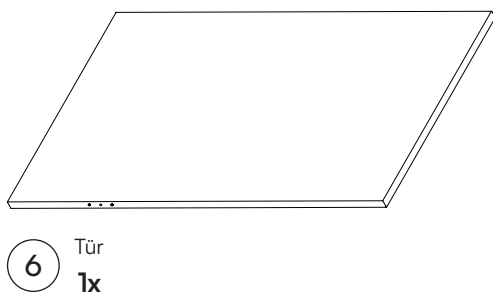
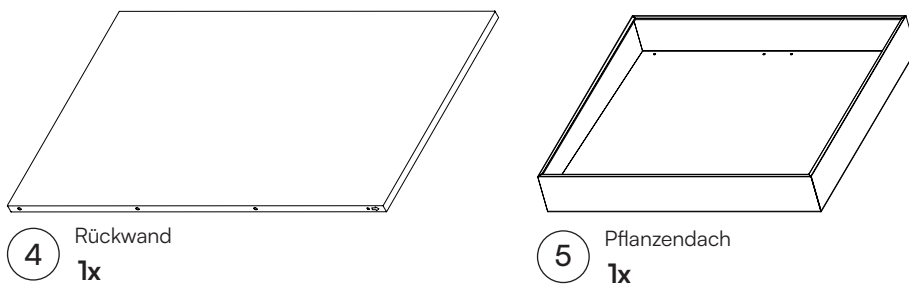
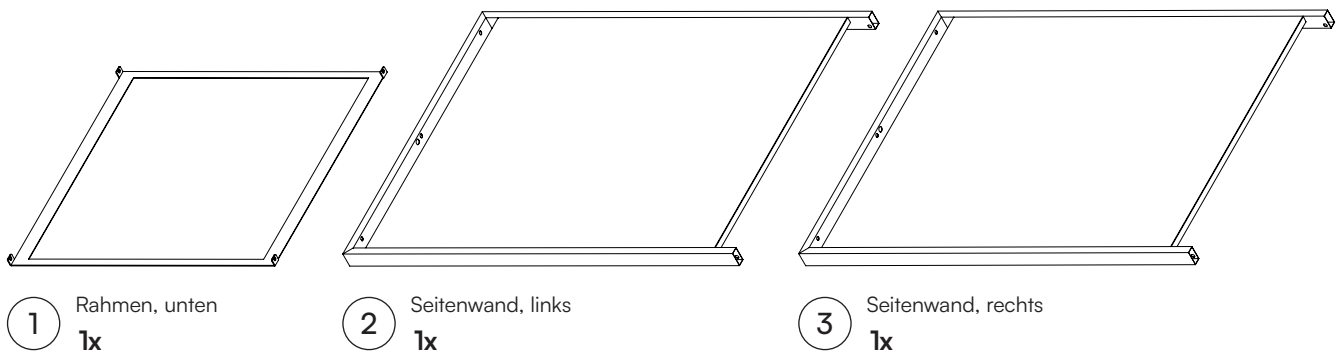

Ein letzter Check:

Bitte überprüfe, ob Du alle Teile hast.

Viel Spaß beim Aufbau!

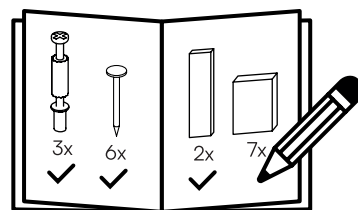

7



Hier geht's zum
Aufbauvideo

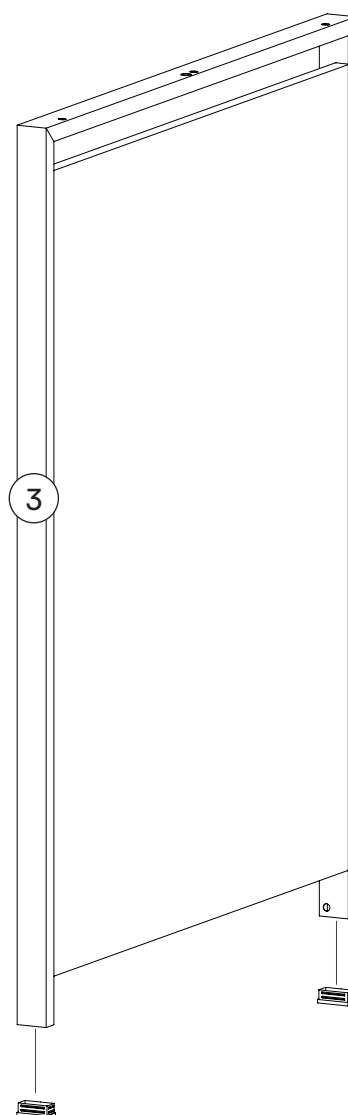
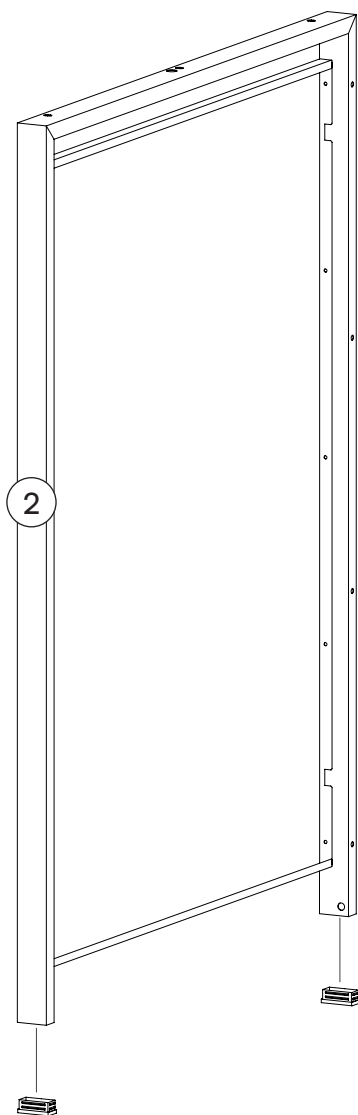
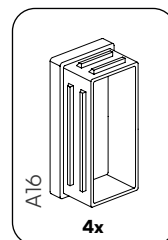

2

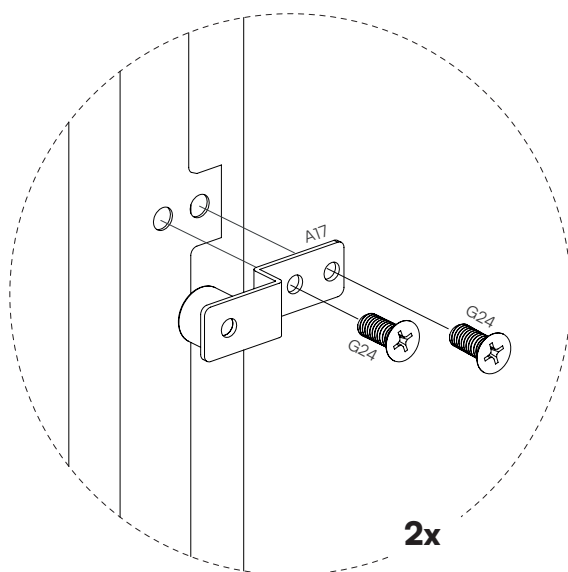
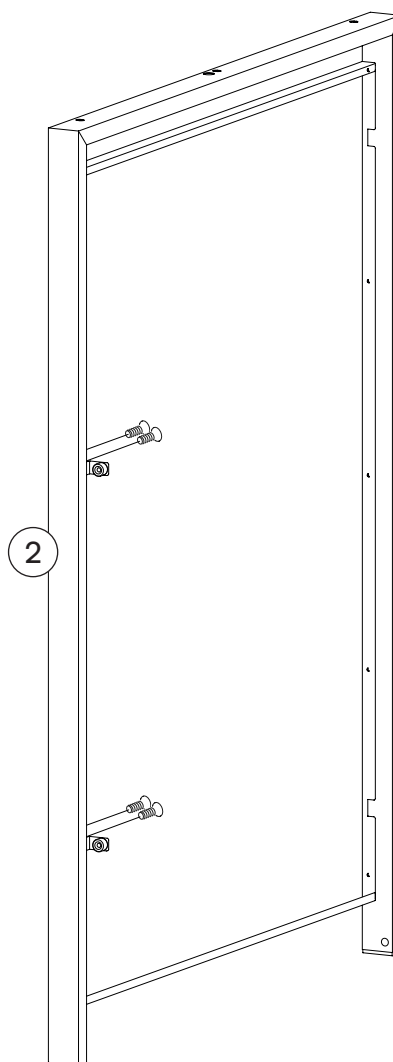
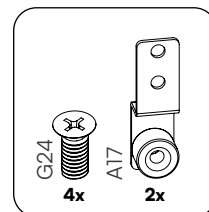
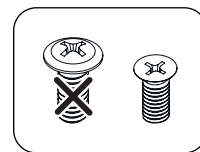

3

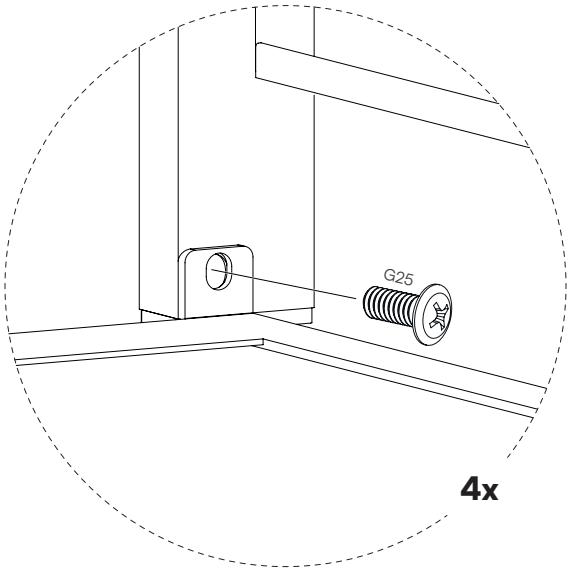
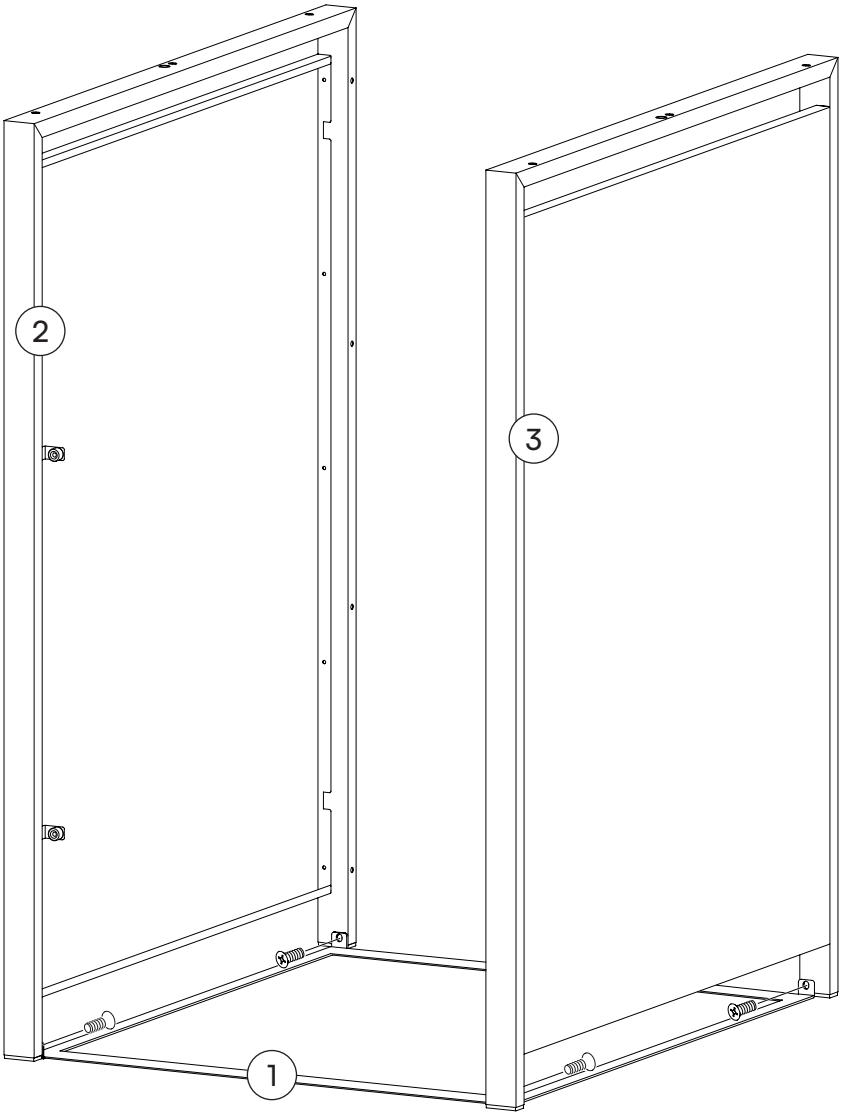
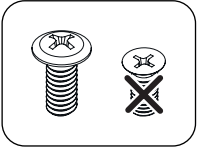

4

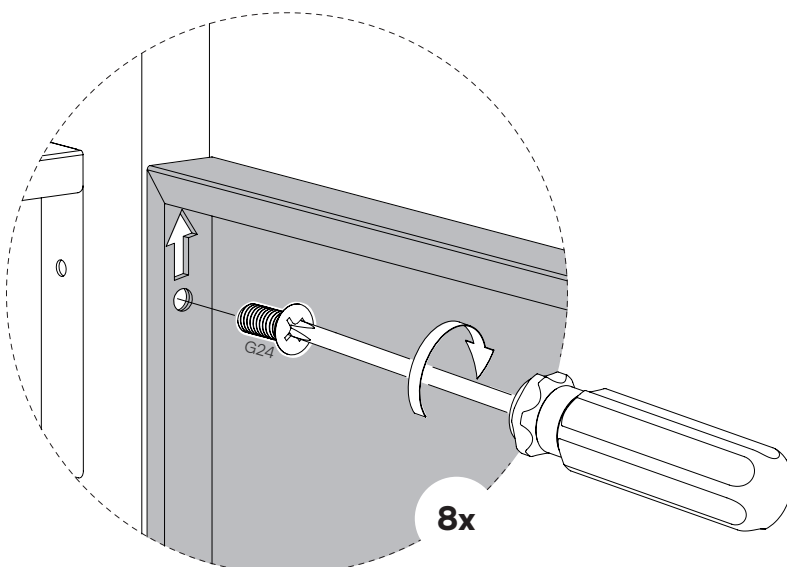
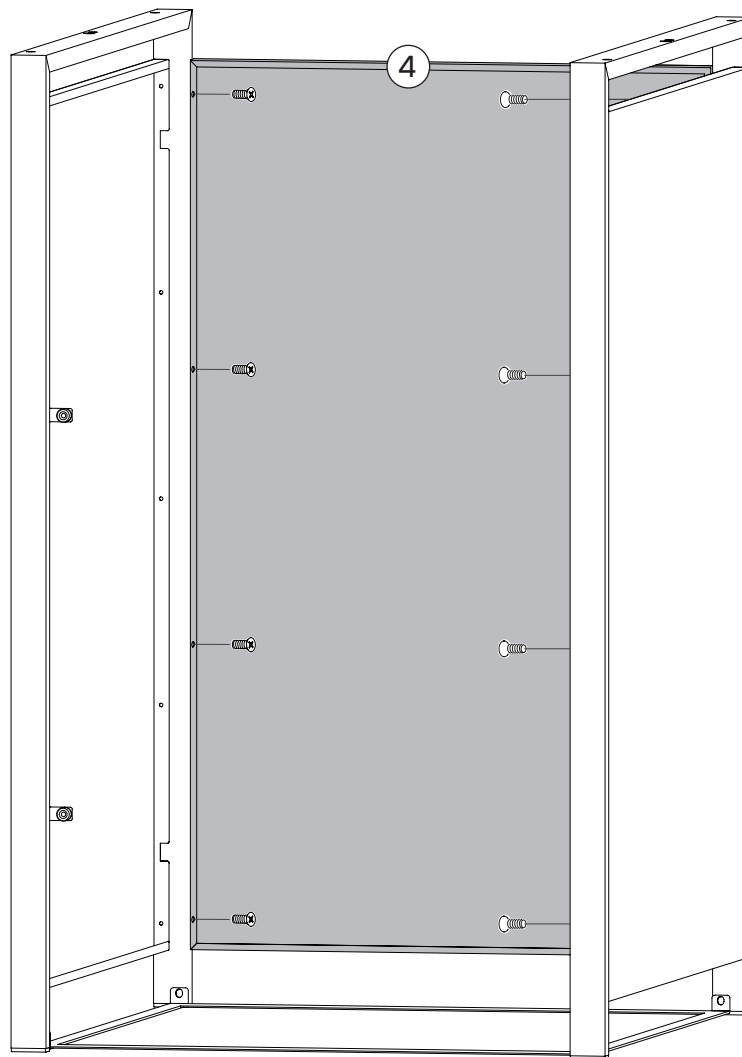
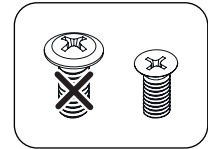

5

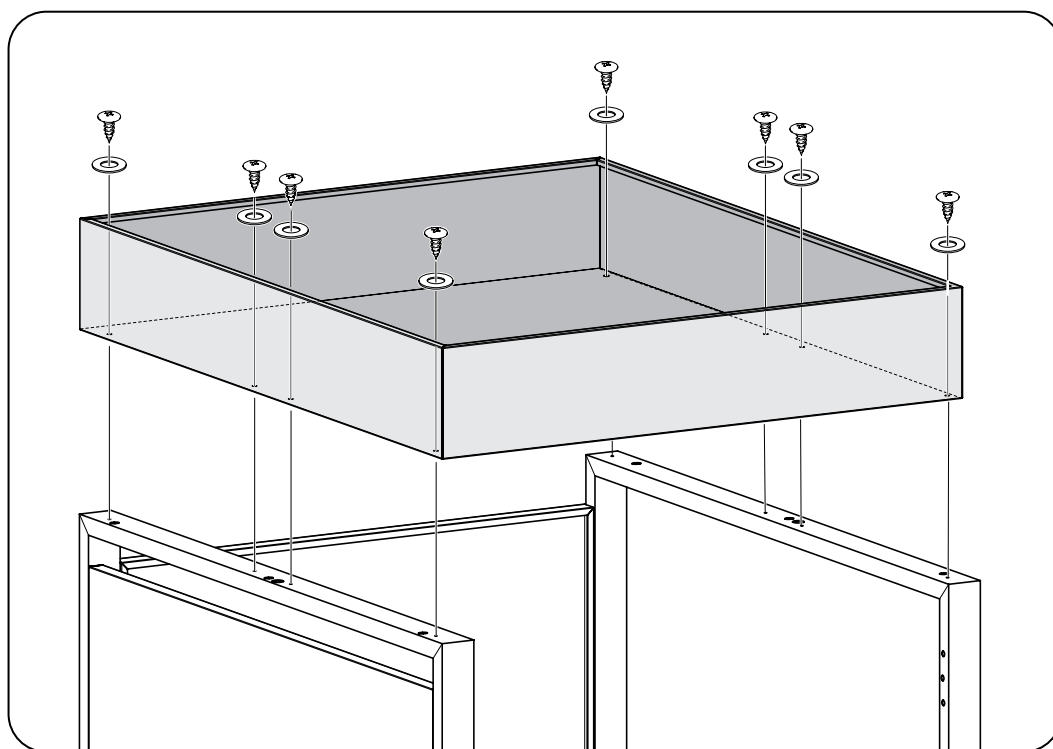
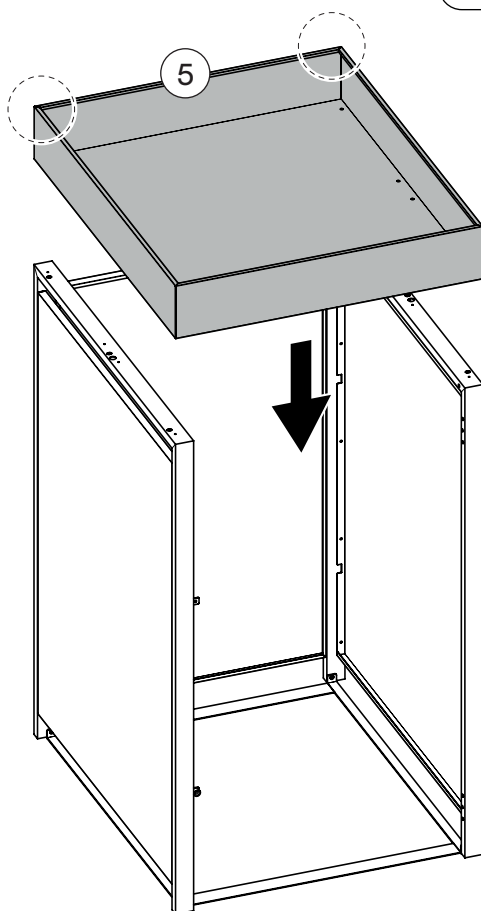
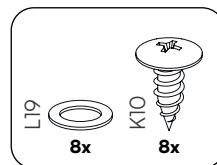
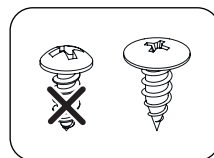
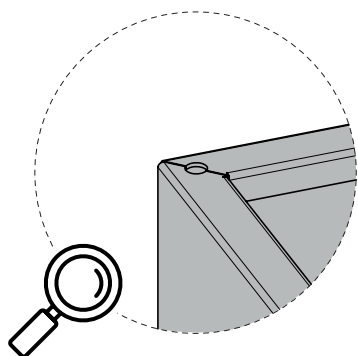

6

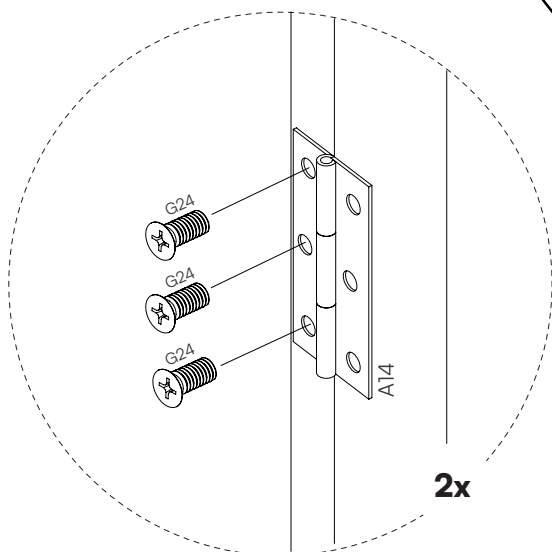
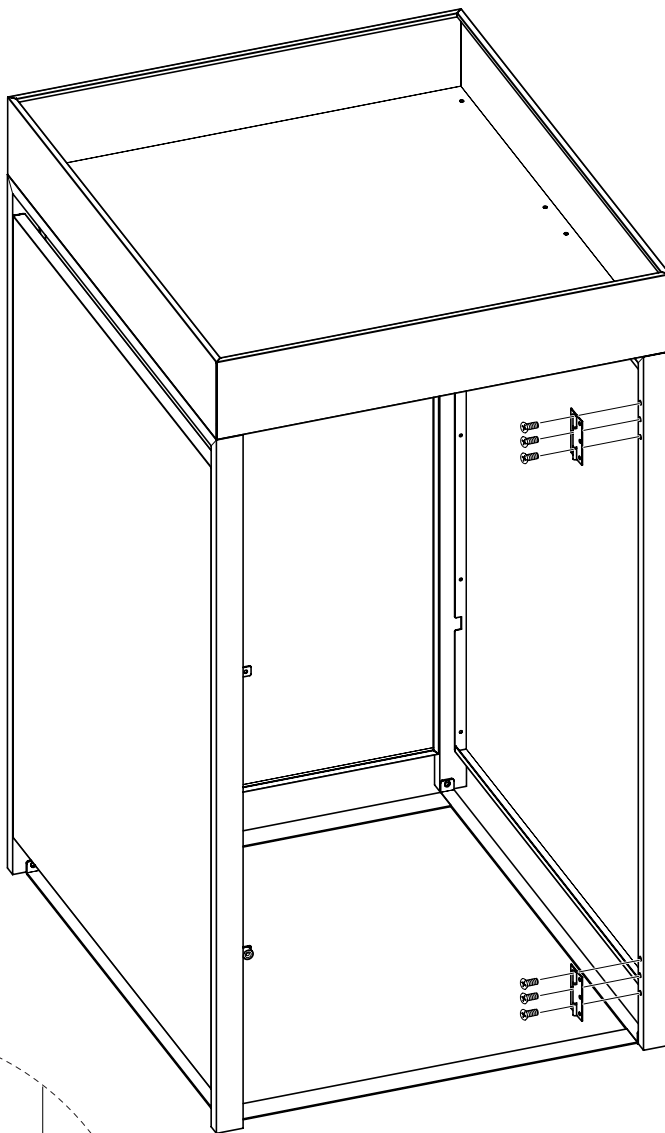
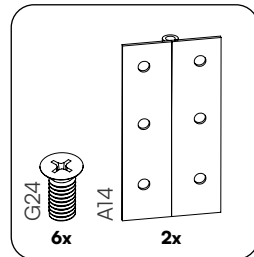
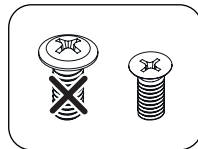

7

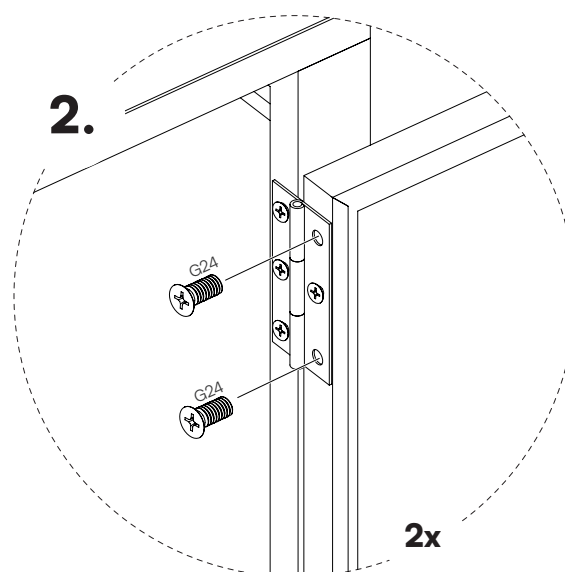
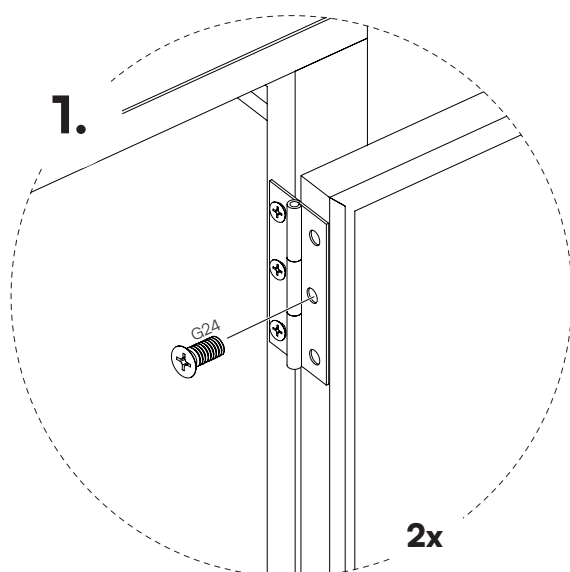
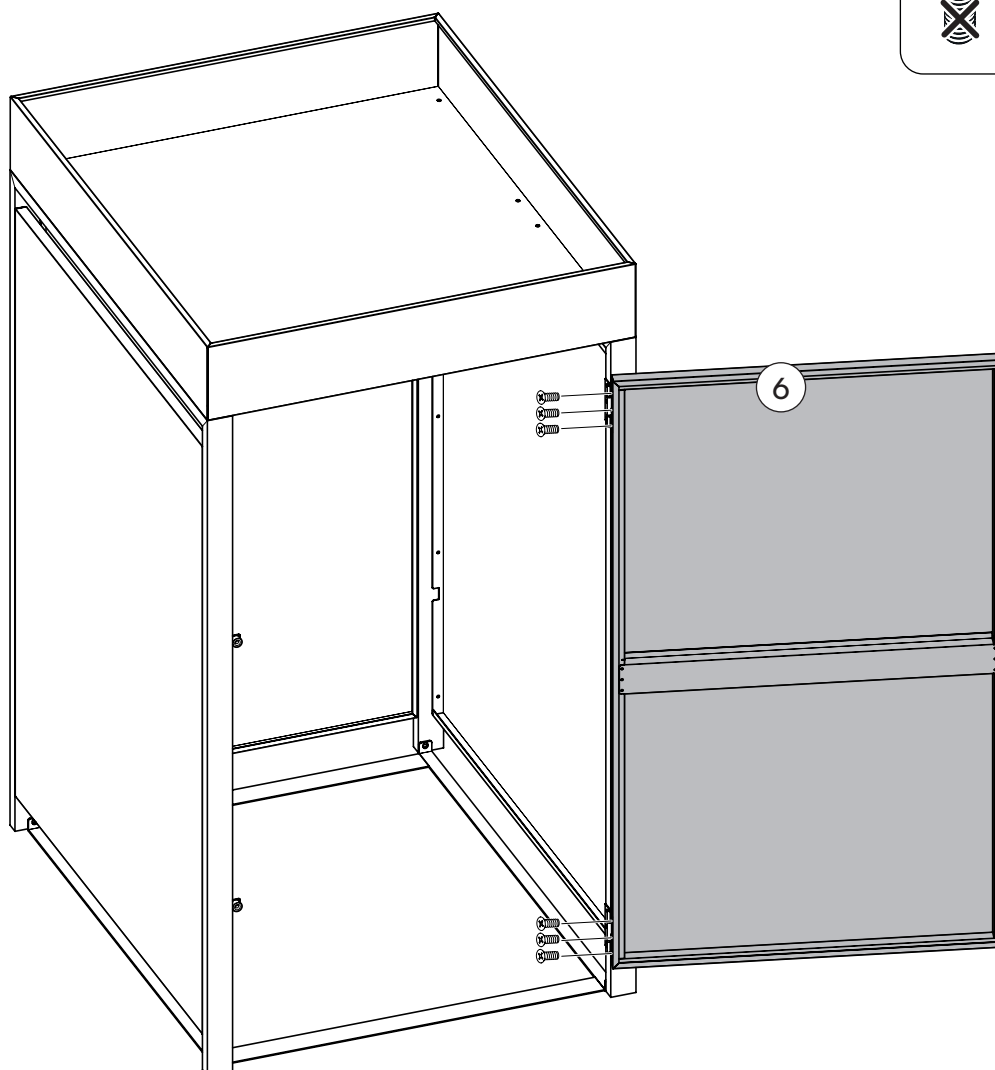
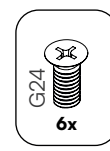
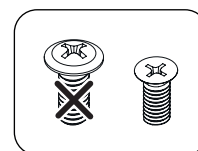

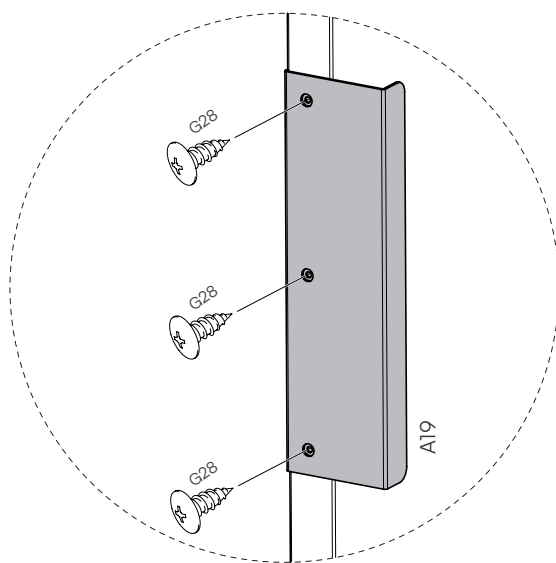
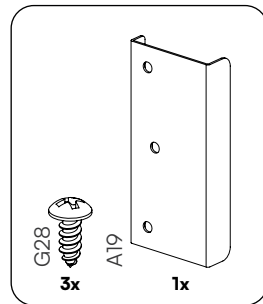
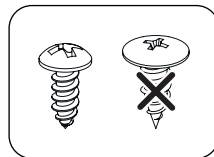
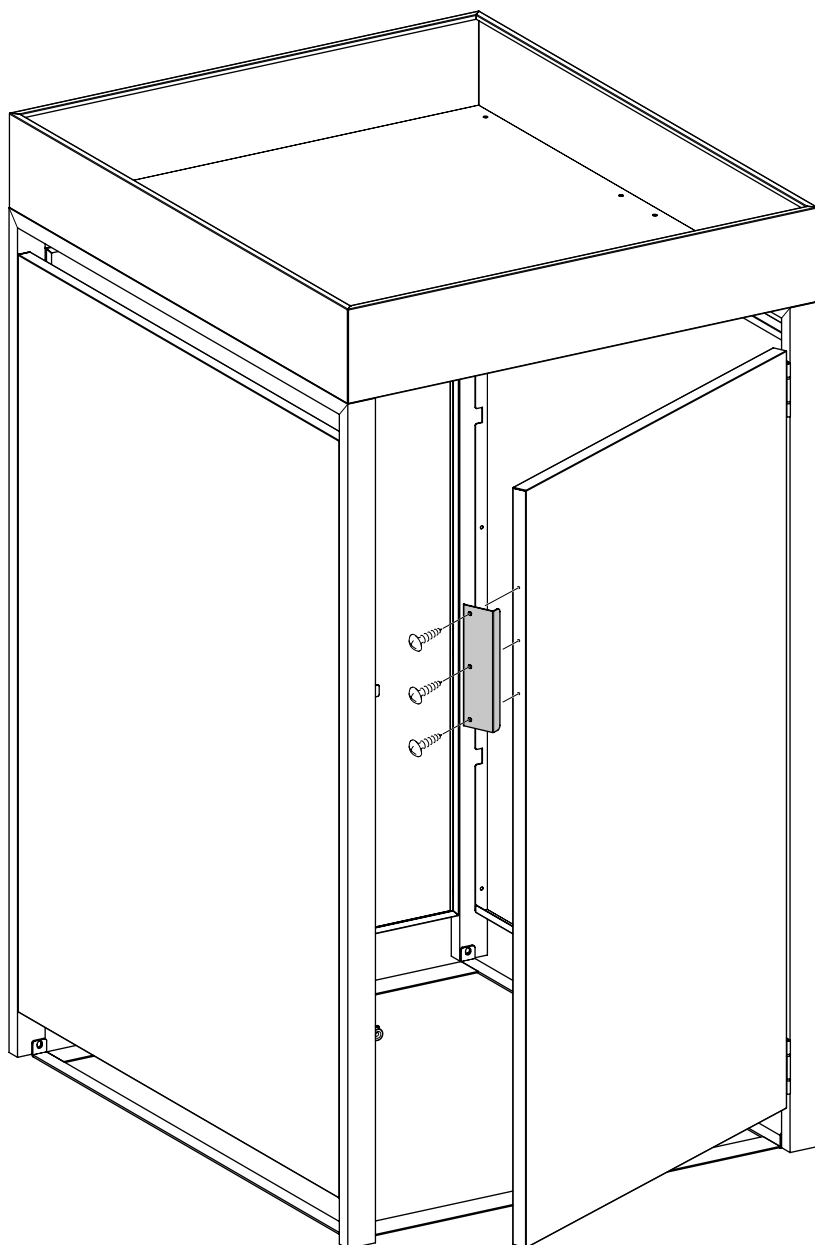

9

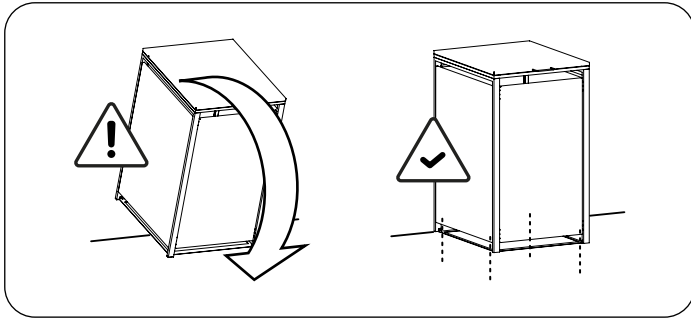

Für zusätzliche Stabilität empfehlen wir die Mülltonnenbox in den Boden zu verschrauben.

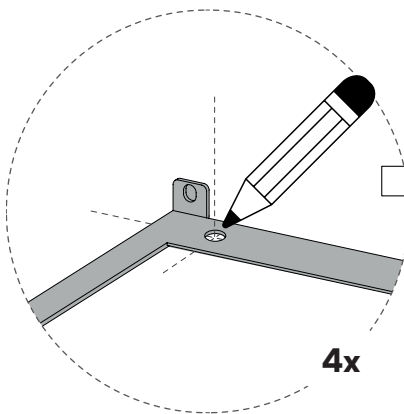
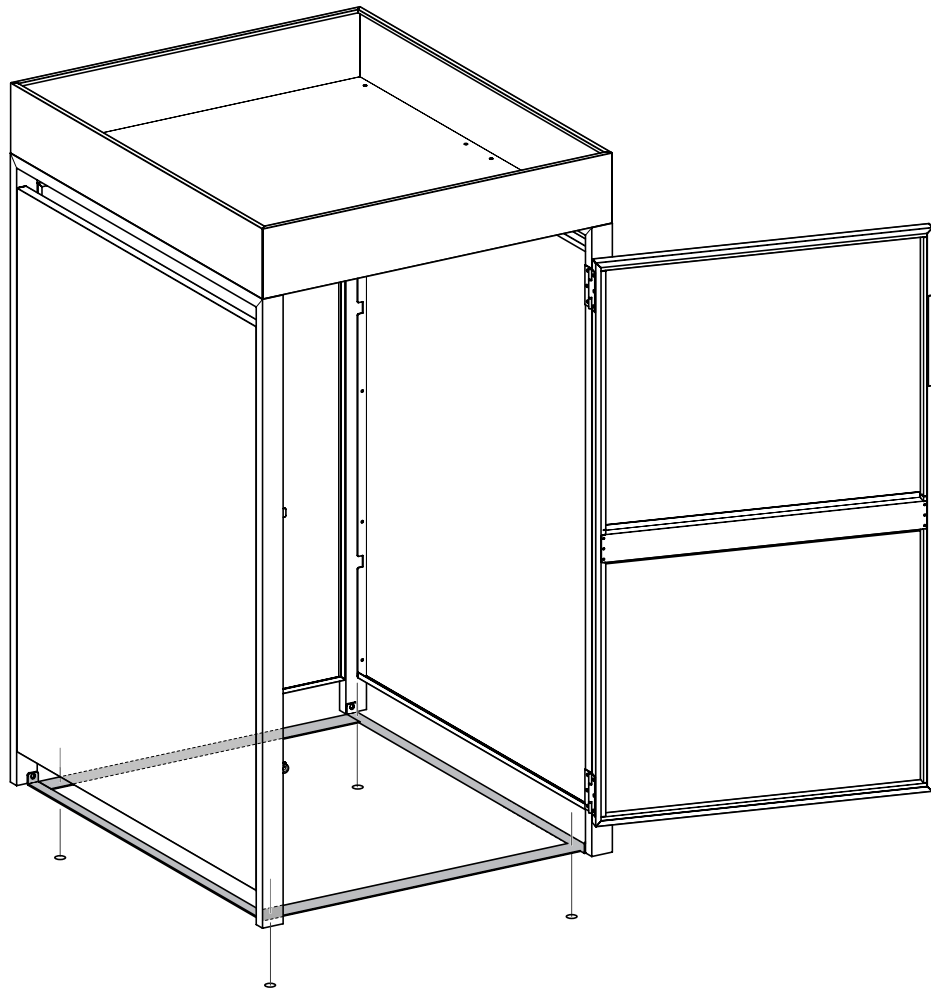
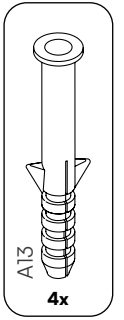

4x

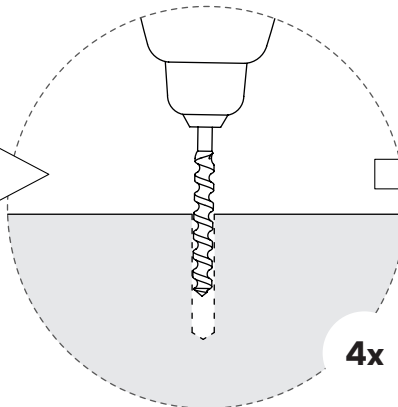
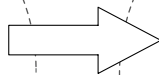

4x

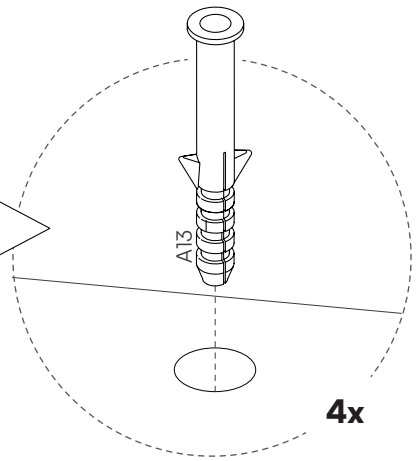
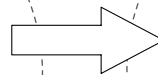

4x

10

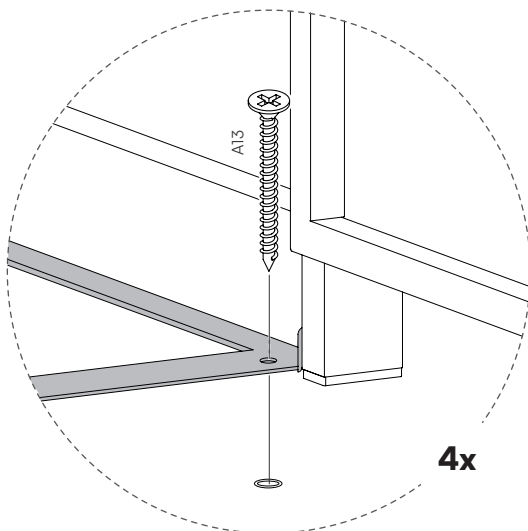
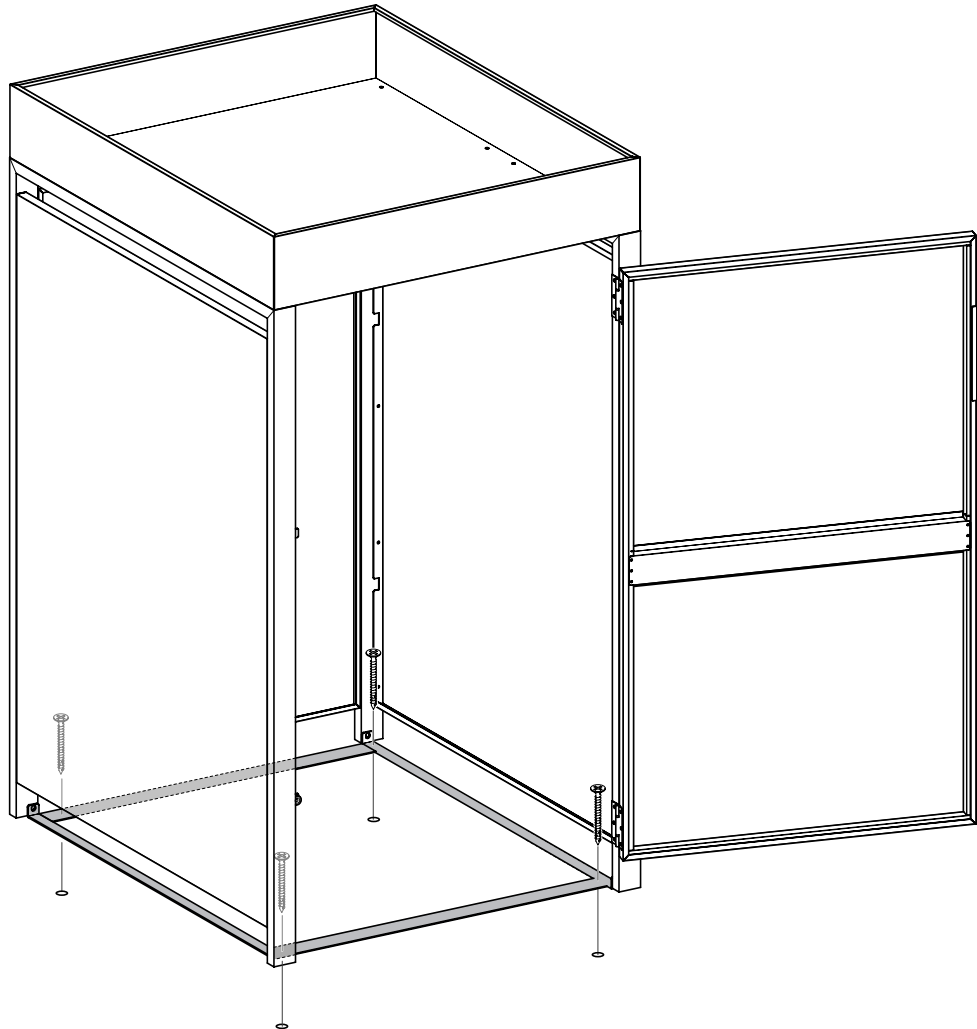
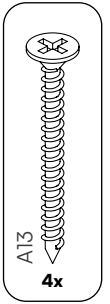

11

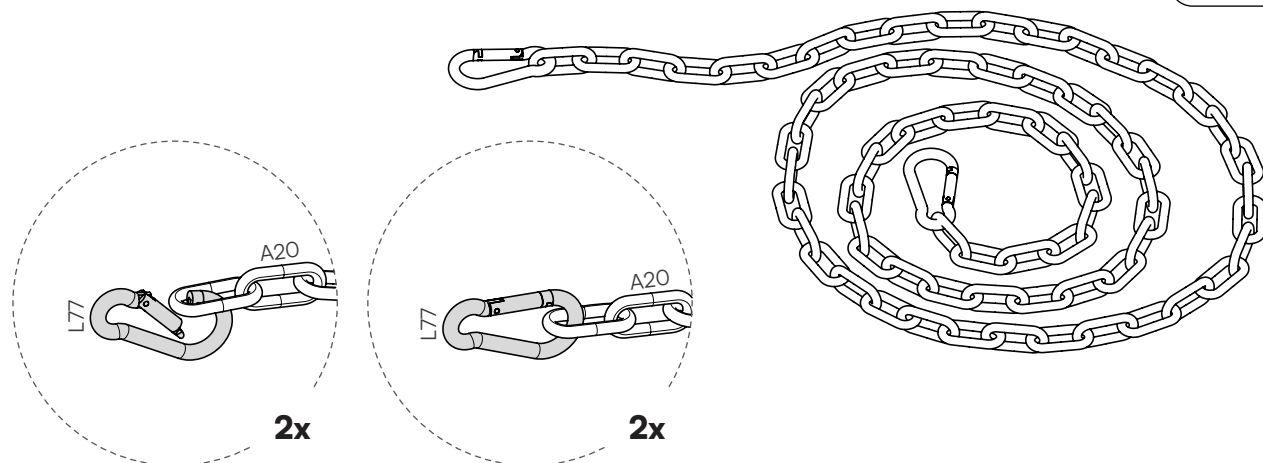

12

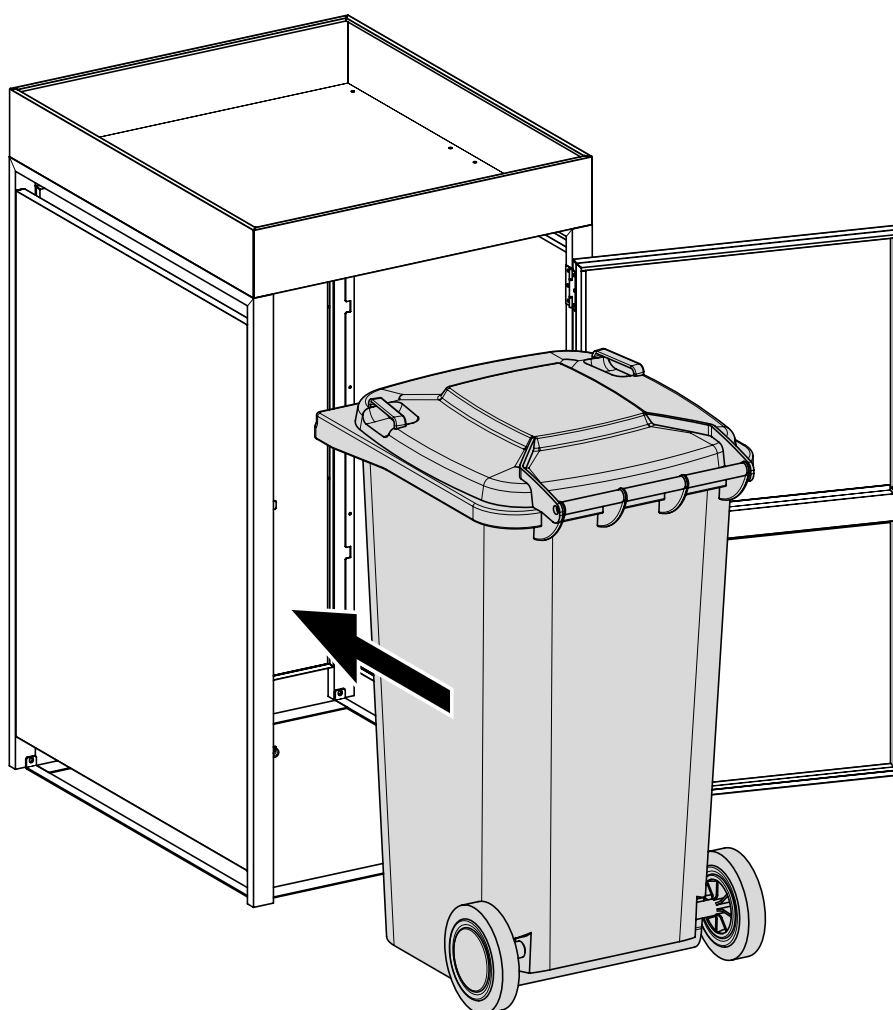

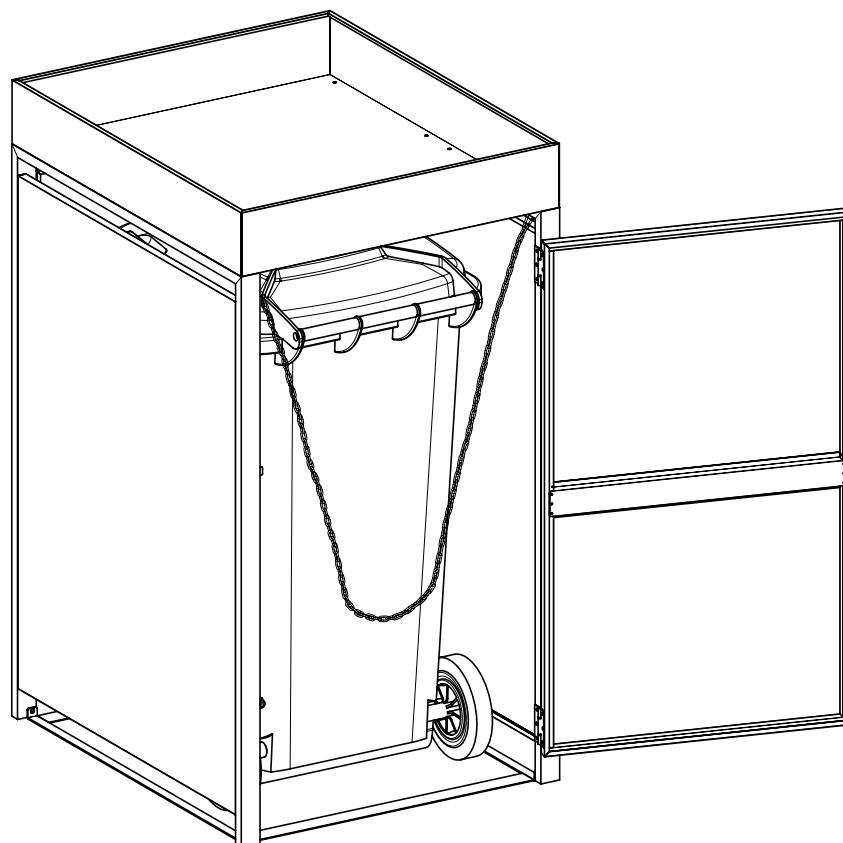
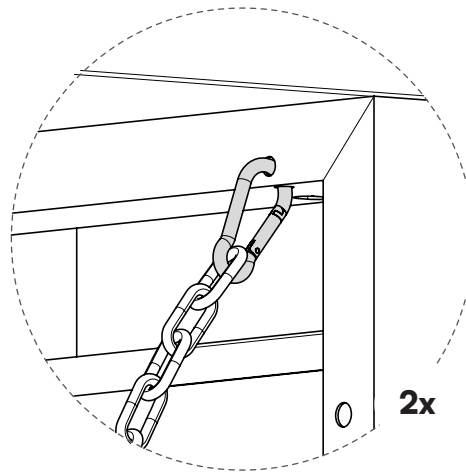
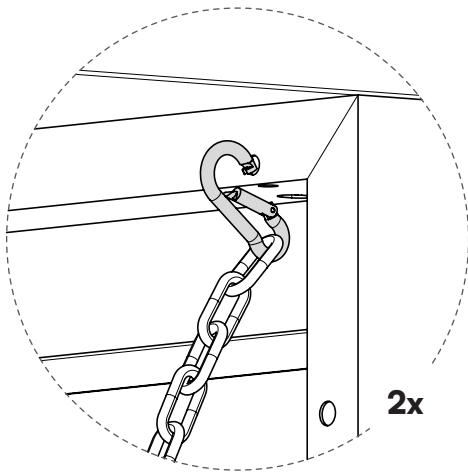
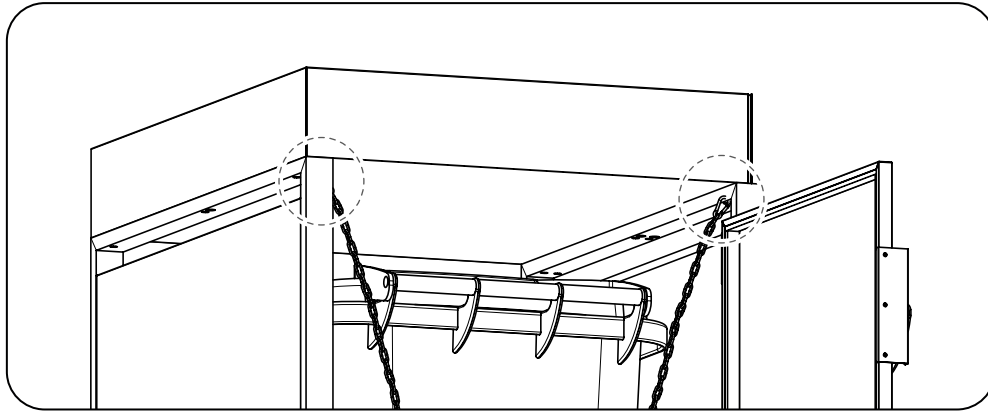

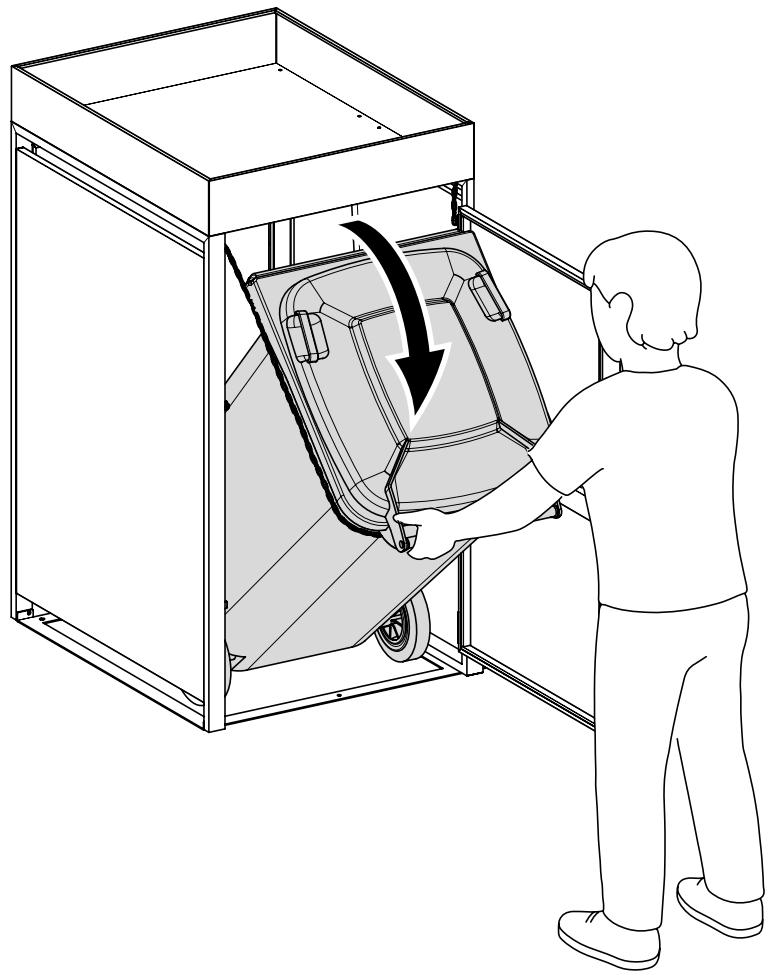

Geschafft!



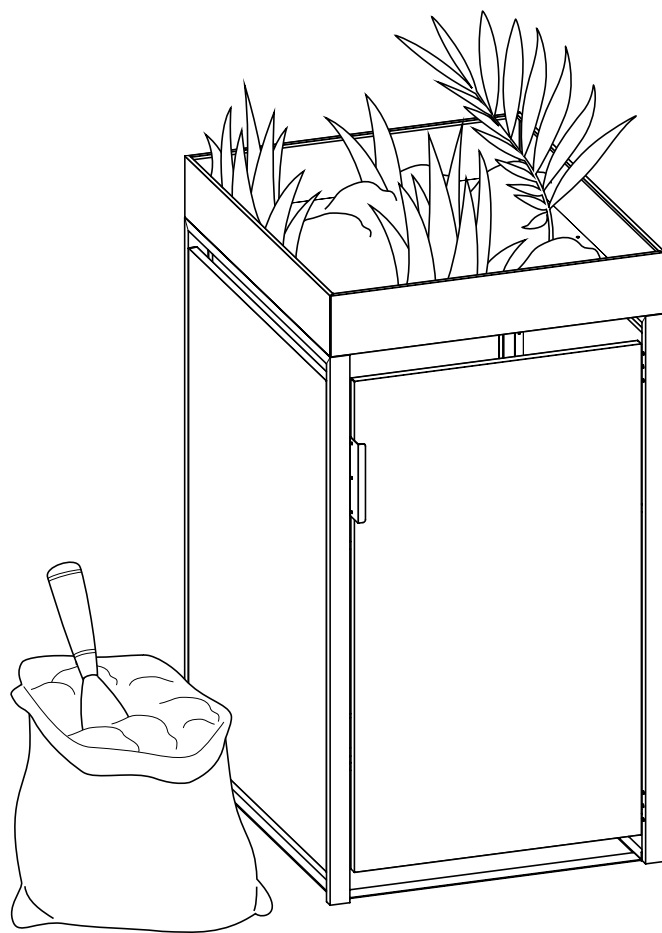

Fragen?

Wir sind für Dich da!

Scanne den QR-Code oder schreib uns an service@bela-living.de.
Gemeinsam kriegen wir jedes Problem gelöst!

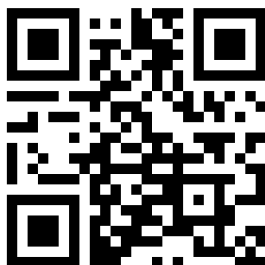
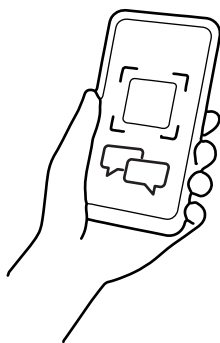

STEELSON

Mülltonnenbox 'Thoria'

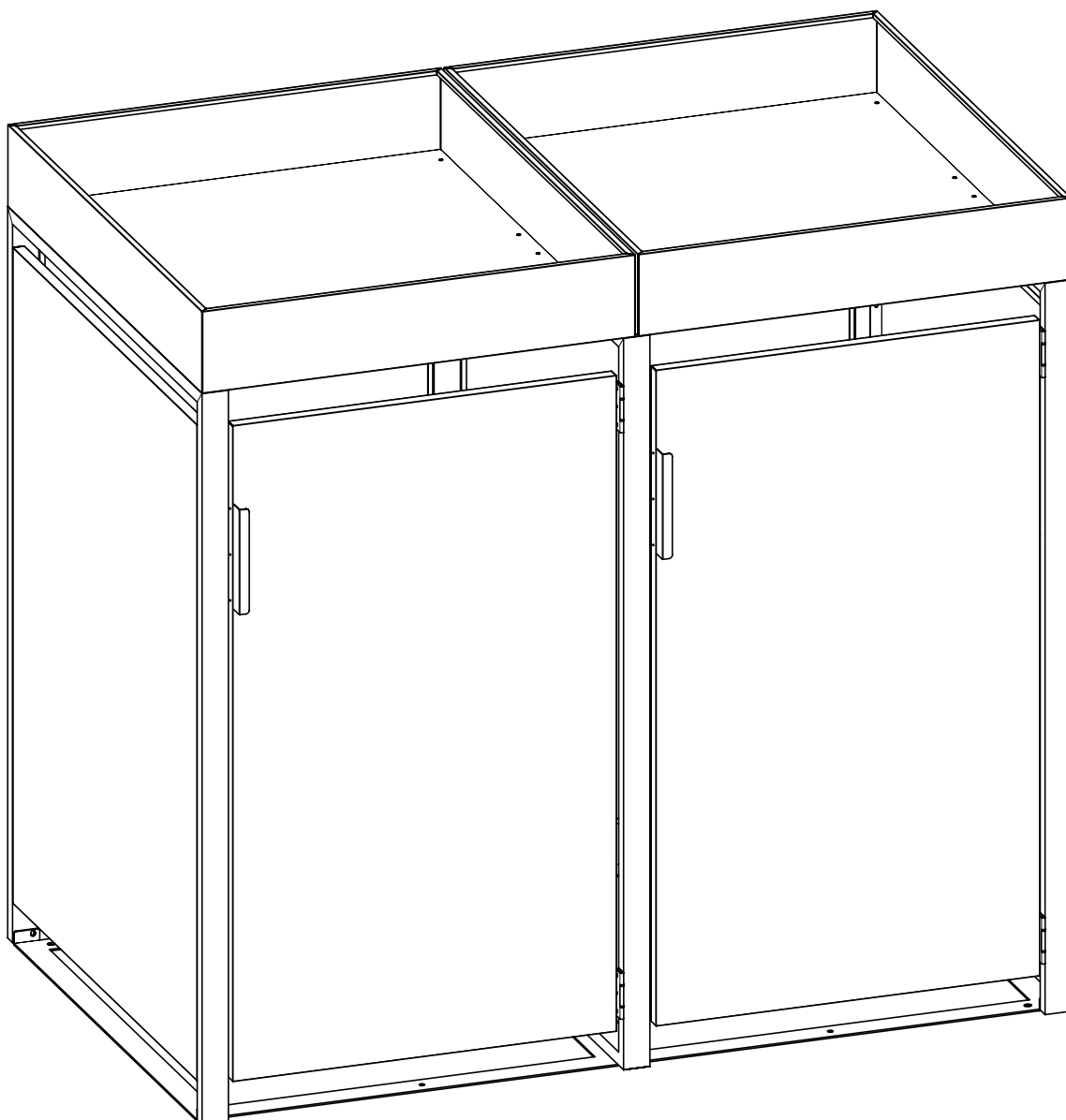

Hier geht's zum
Aufbauvideo



Hey,

wir freuen uns, dass Du Dich für unser Produkt entschieden hast. Beachte die kommenden Hinweise, um den Aufbau problemlos zu gestalten.

Viel Spaß mit Deinem Produkt!

50%

weniger Fehler beim Aufbau durch
sorgfältiges Lesen der Anleitung

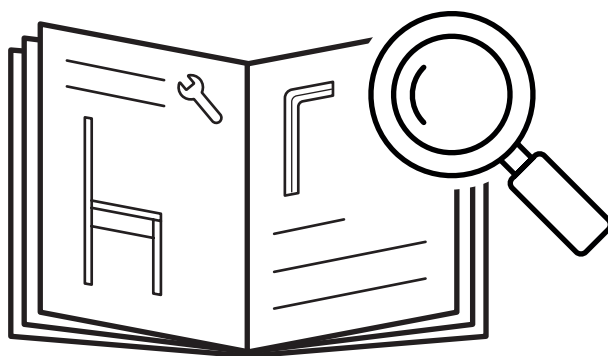

120-180

min

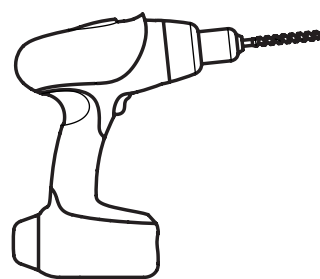

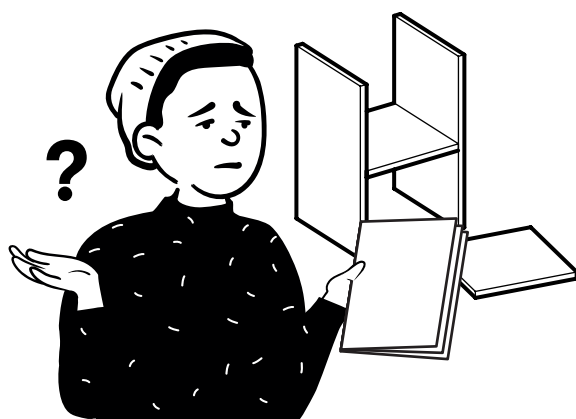
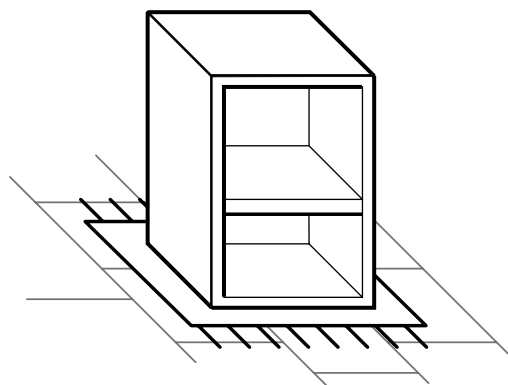
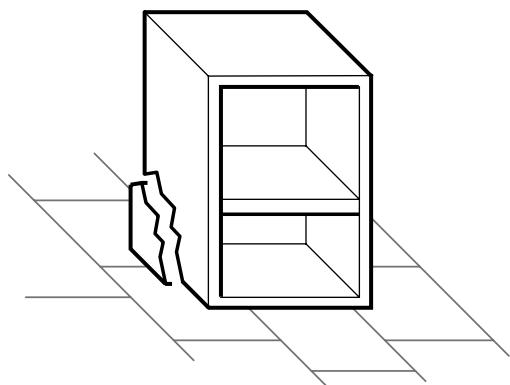

Fragen?

Wir sind für Dich da!



✉ service@bela-living.de

1.

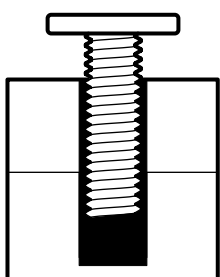

Ziehe die Schrauben während
des gesamten Aufbaus
zunächst per Hand an.

2.

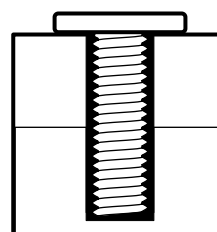

Justiere das Produkt final
und ziehe die Schrauben
vollständig an.

G24 - Kreuzschraube

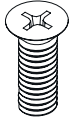

48x

G25 - Kreuzschraube

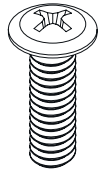

10x

L19 - Beilagscheibe



16x

K10 - Kreuzschraube



16x

G28 - Kreuzschraube

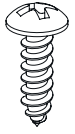

6x

A14 - Scharnier

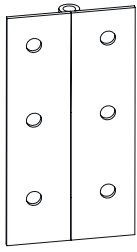

4x

A16 - Abdeckkappe

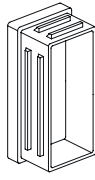

4x

A17 - Magnet

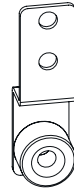

4x

L77 - Karabiner

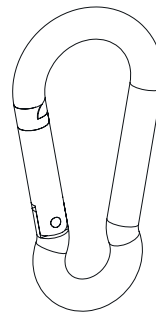

4x

A13 - Dübel und Schraube



8x

A19 - Türgriff

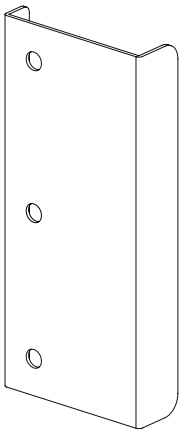

2x

A20 - Metallkette

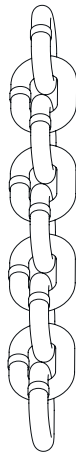

2x

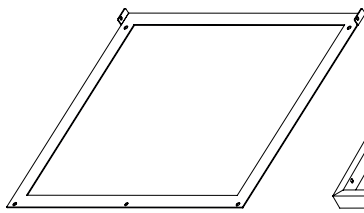

1 Rahmen, unten
2x

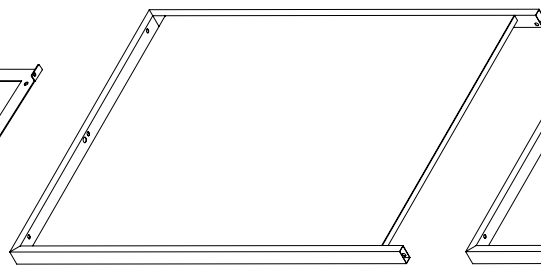

2 Seitenwand, links
1x

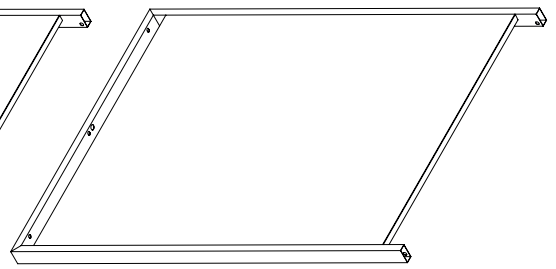

3 Seitenwand, rechts
1x

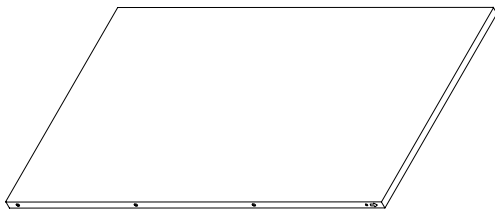

4 Rückwand
2x

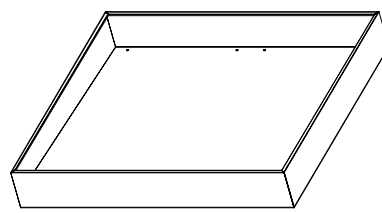

5 Pflanzendach
2x

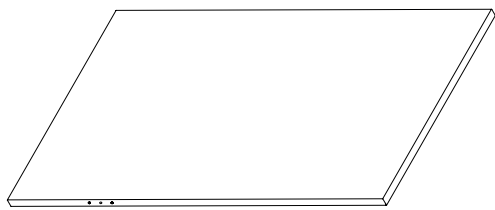

6 Tür
2x

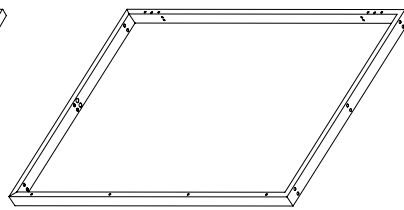

7 Mittelrahmen
1x

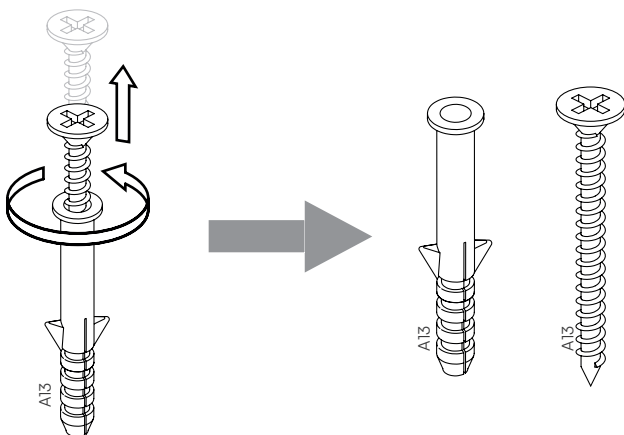

Ein letzter Check:

Bitte überprüfe, ob Du alle Teile hast.

Viel Spaß beim Aufbau!

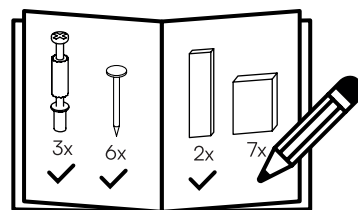

7



Hier geht's zum
Aufbauvideo

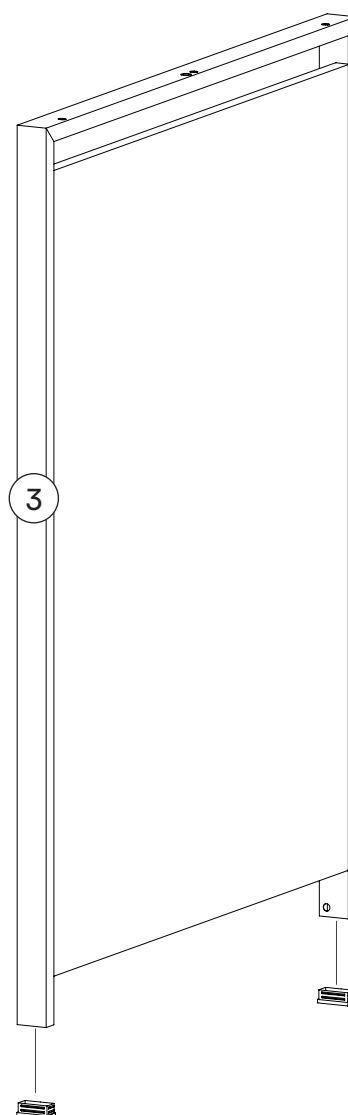
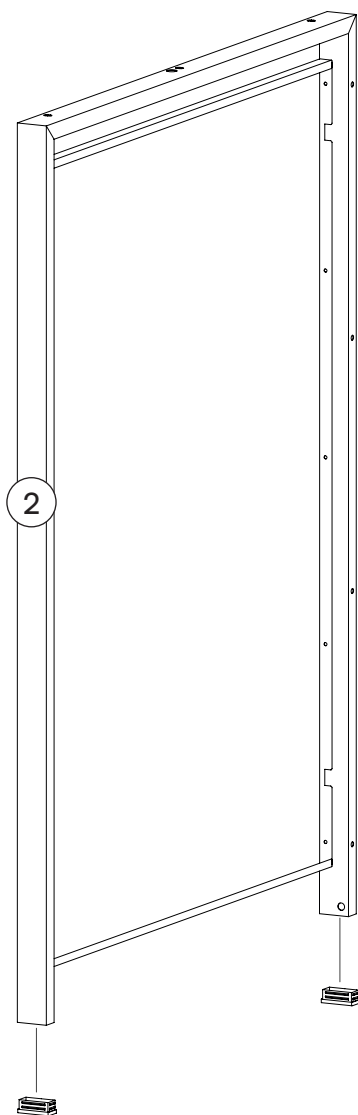
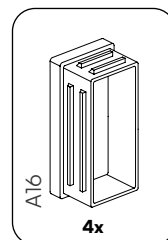

2

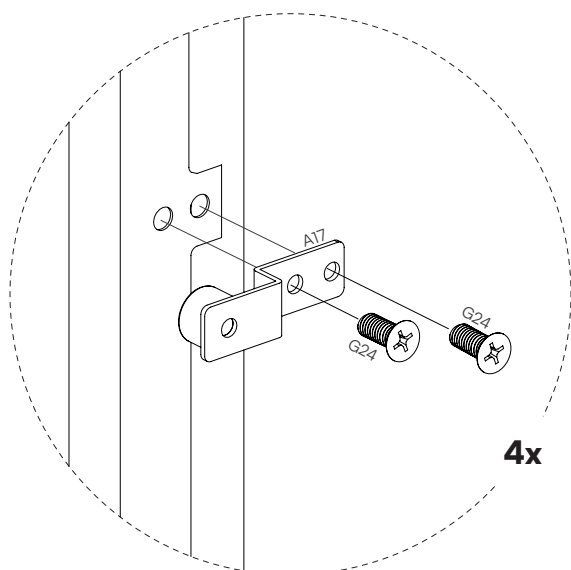
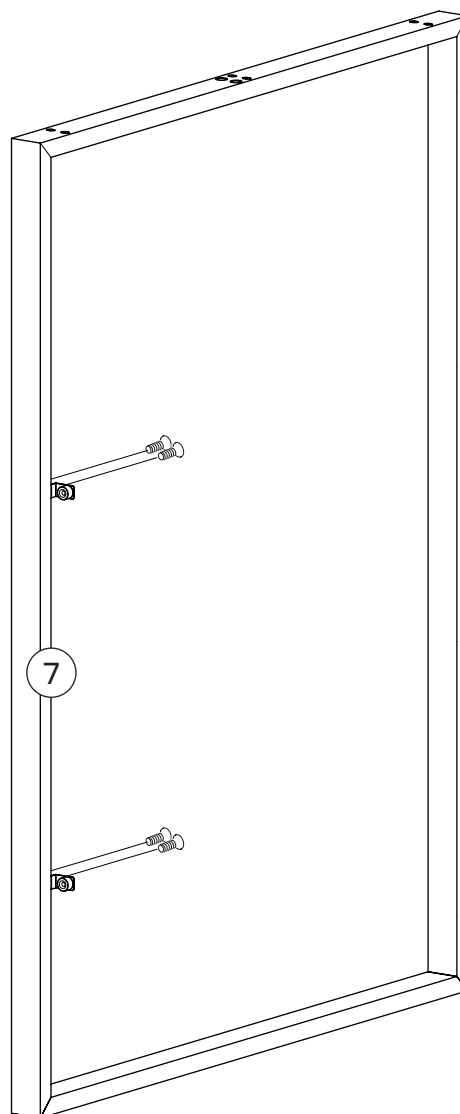
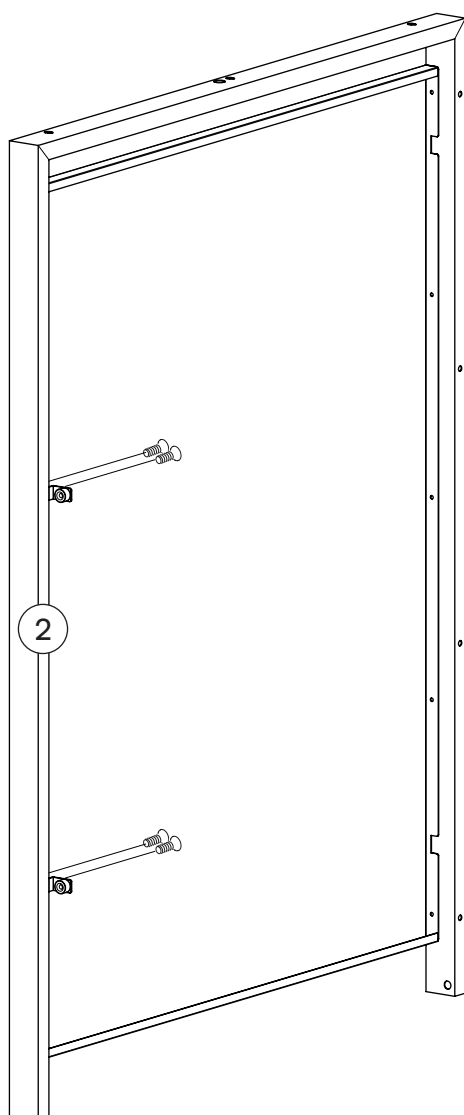
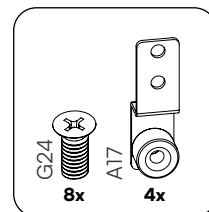
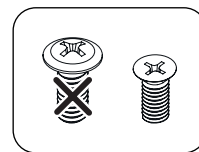

3

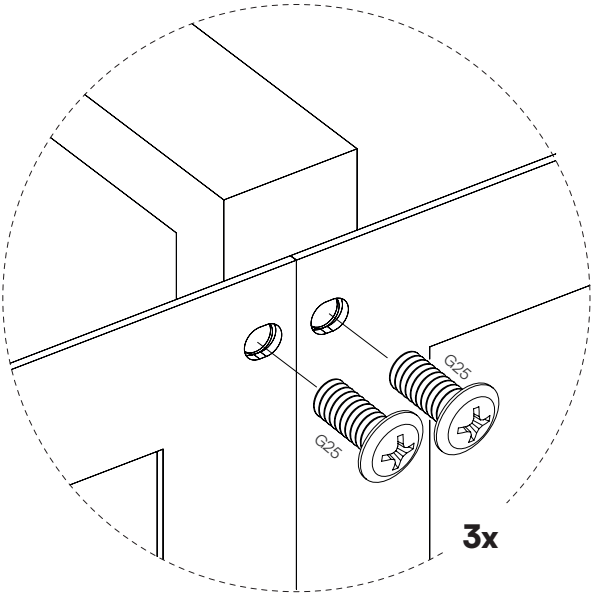
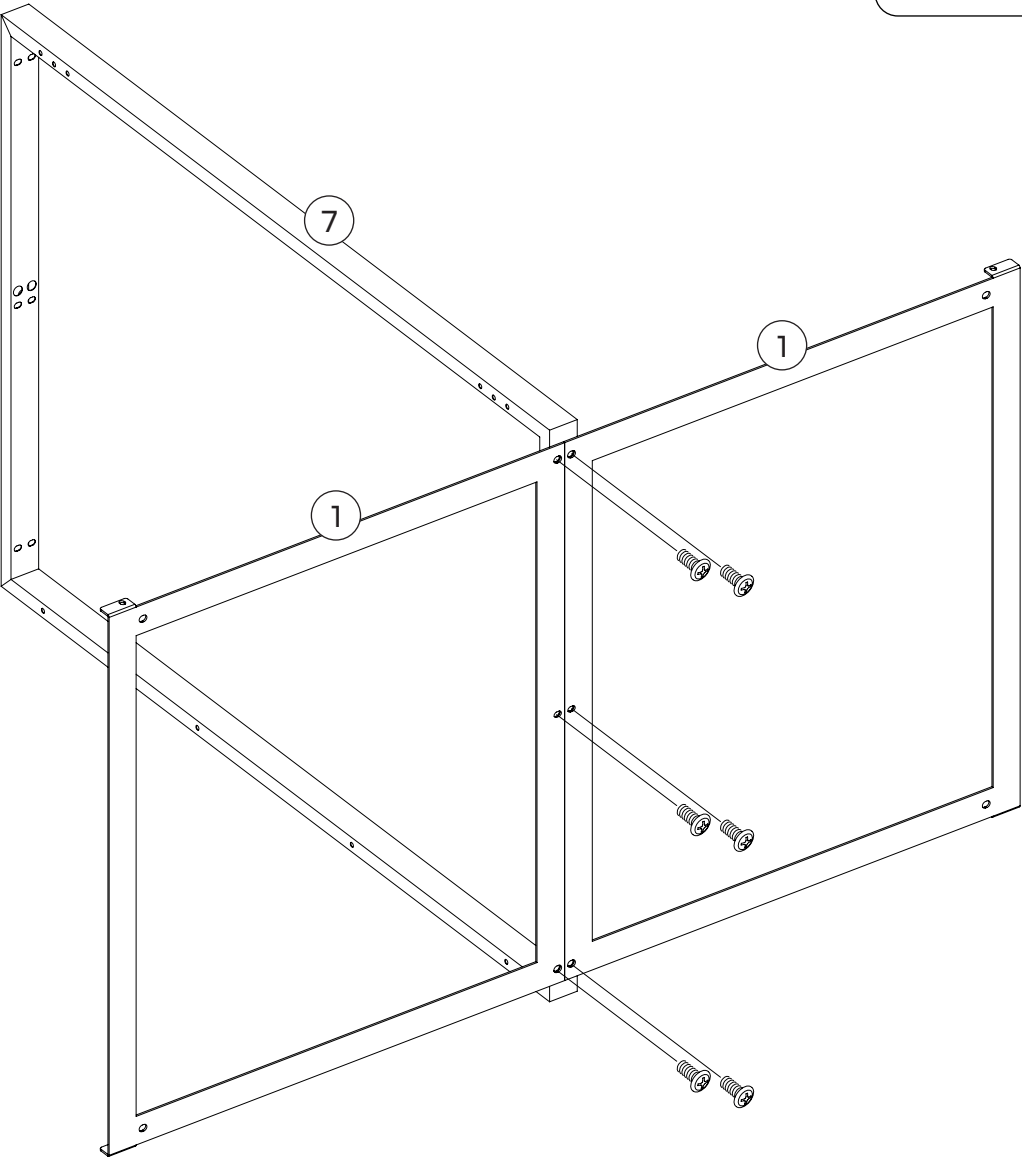
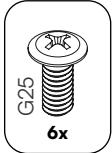
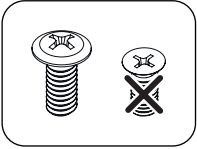

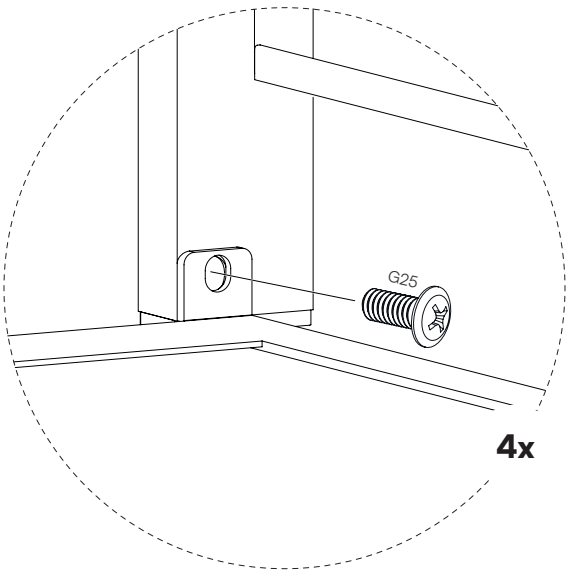
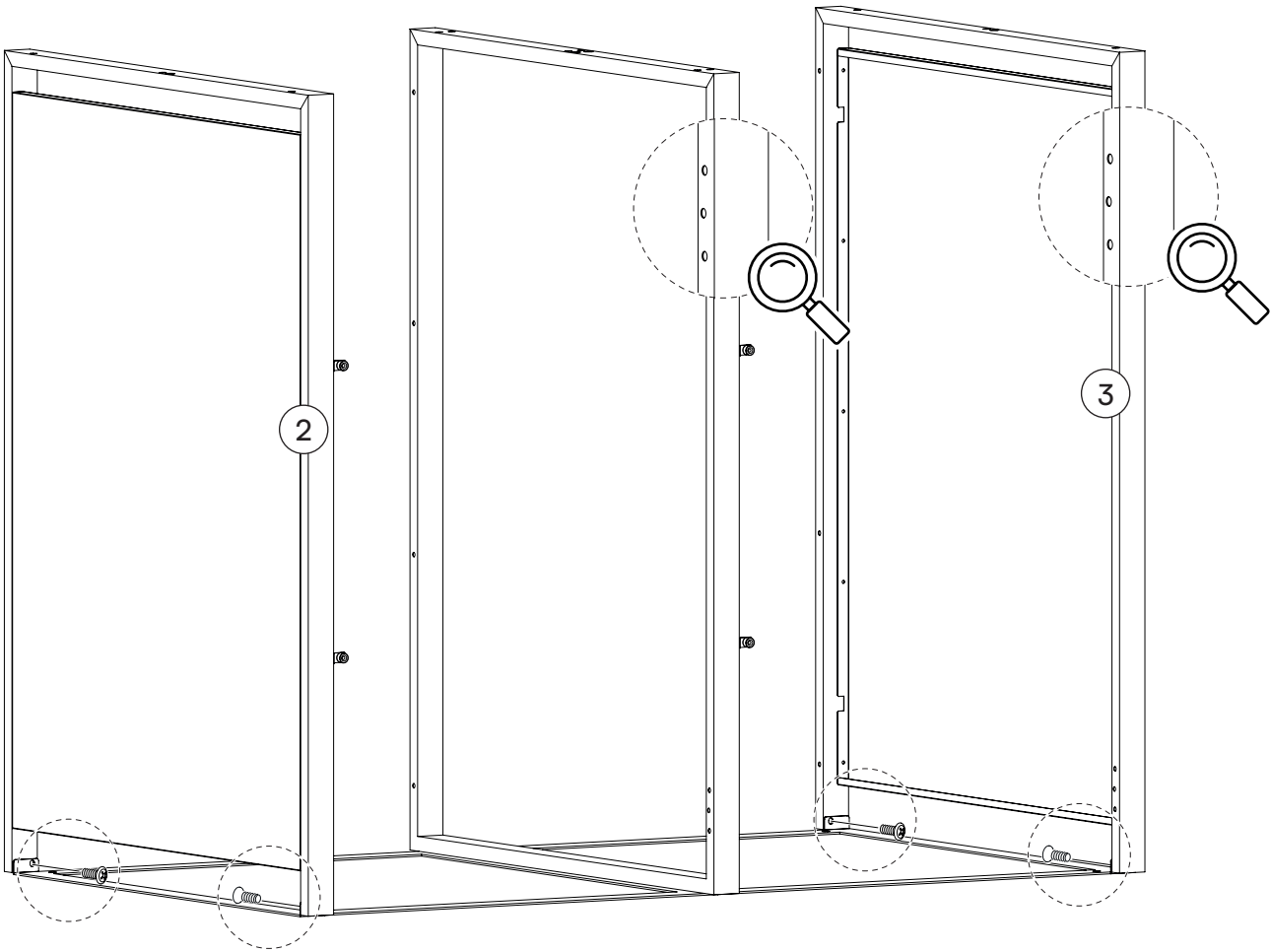
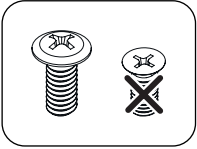

5

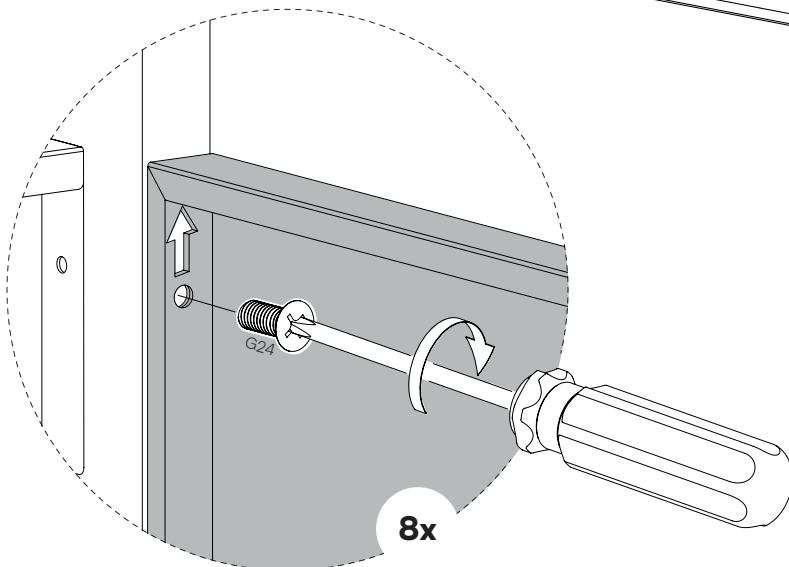
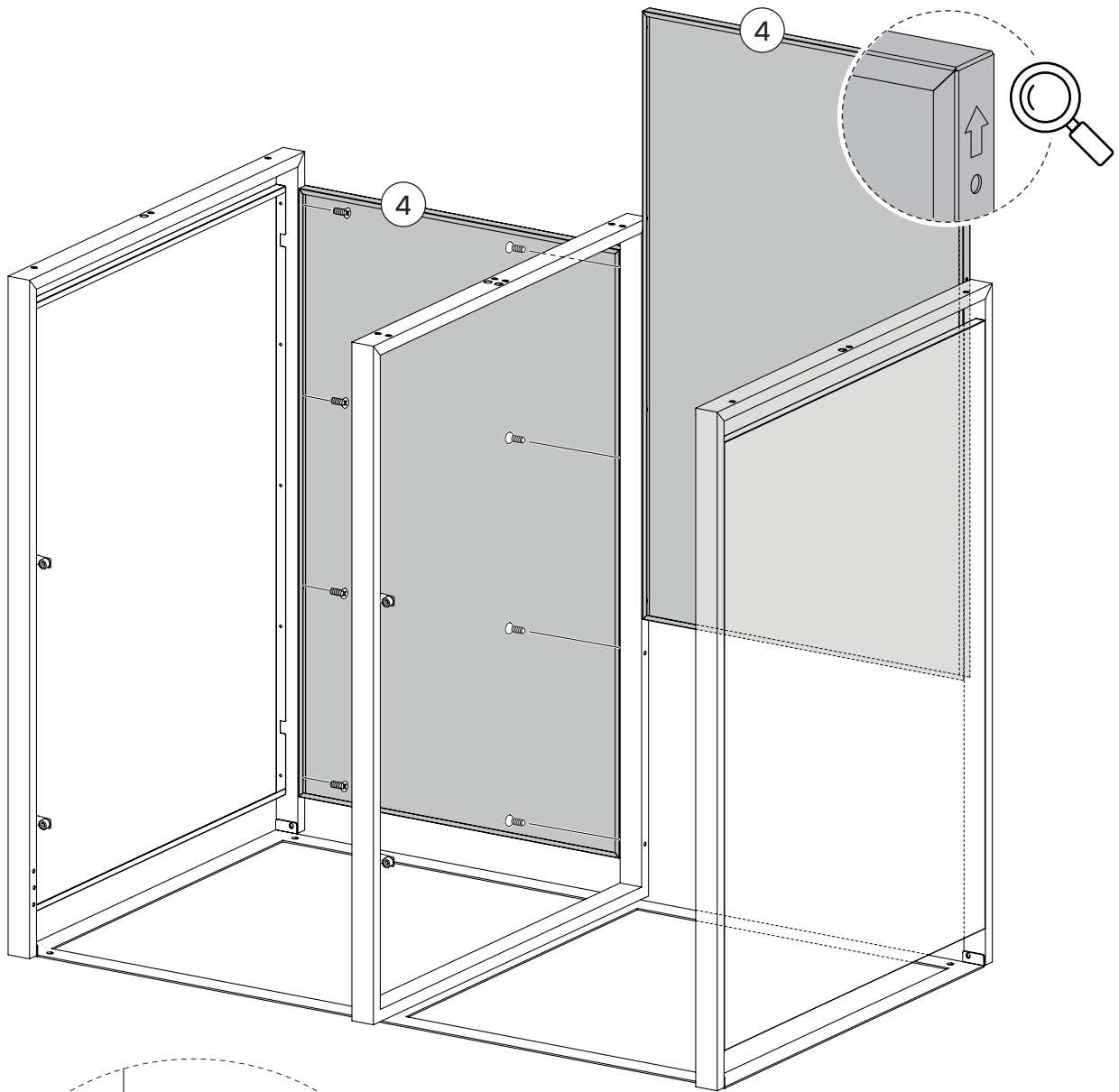
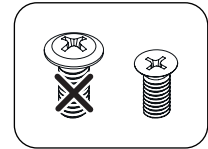

6

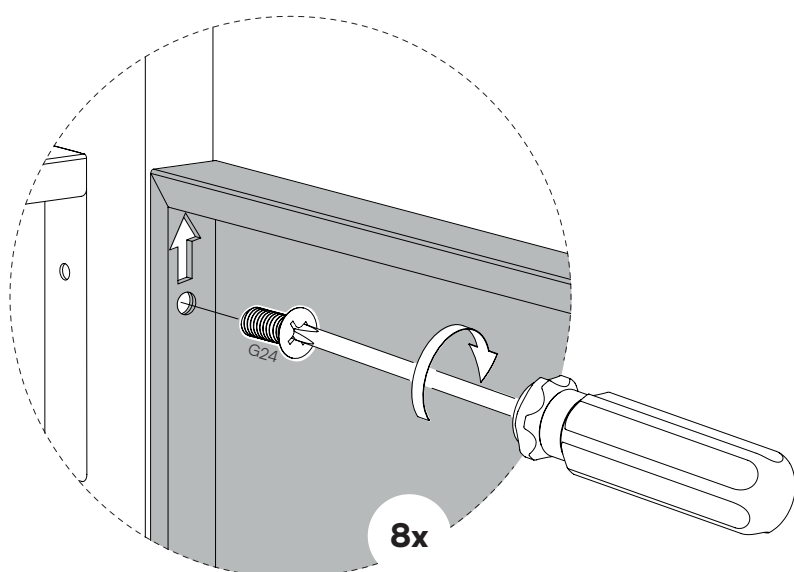
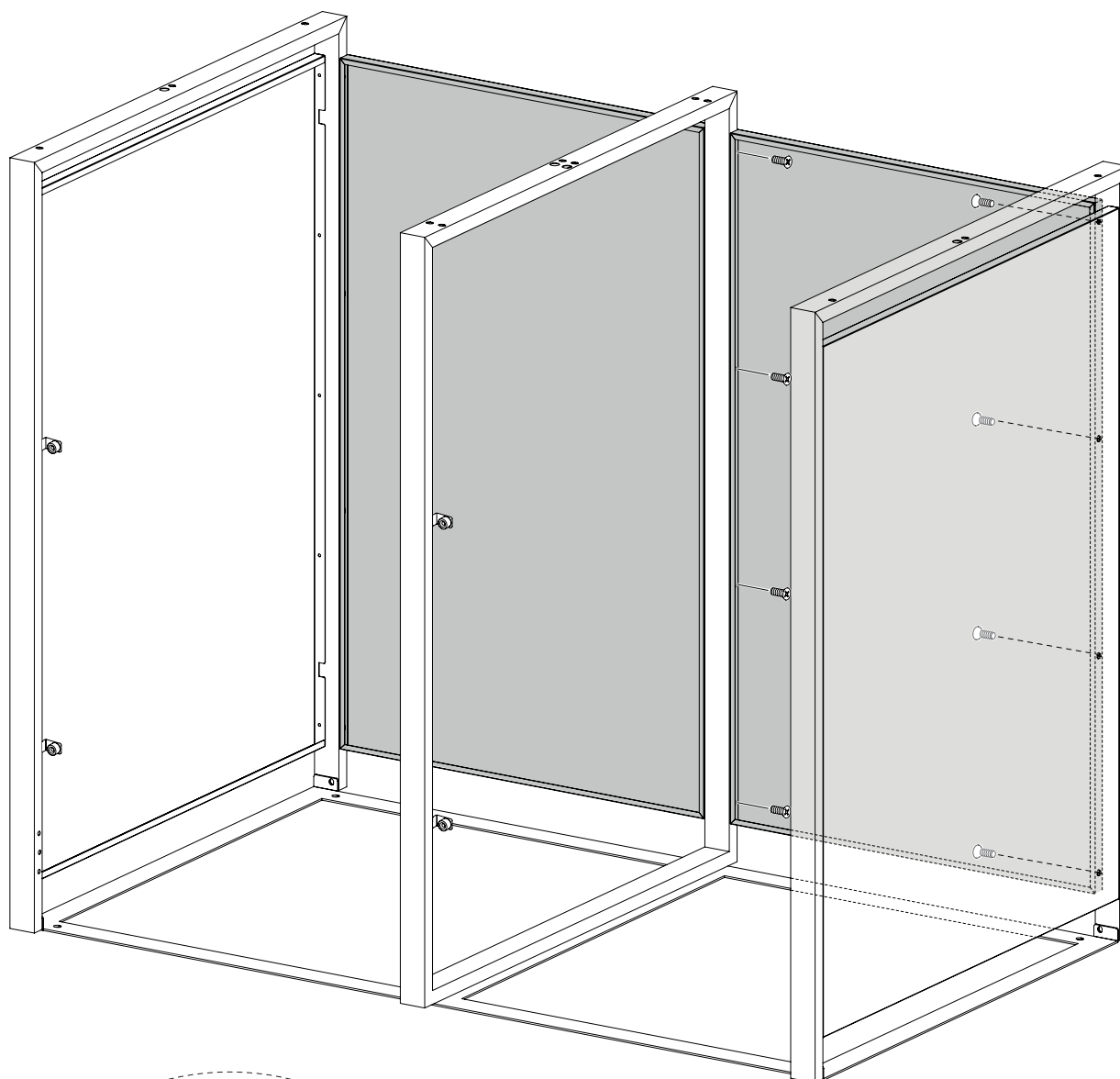
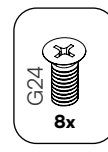
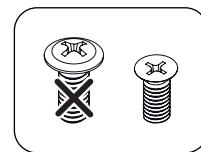

STEELSON

7

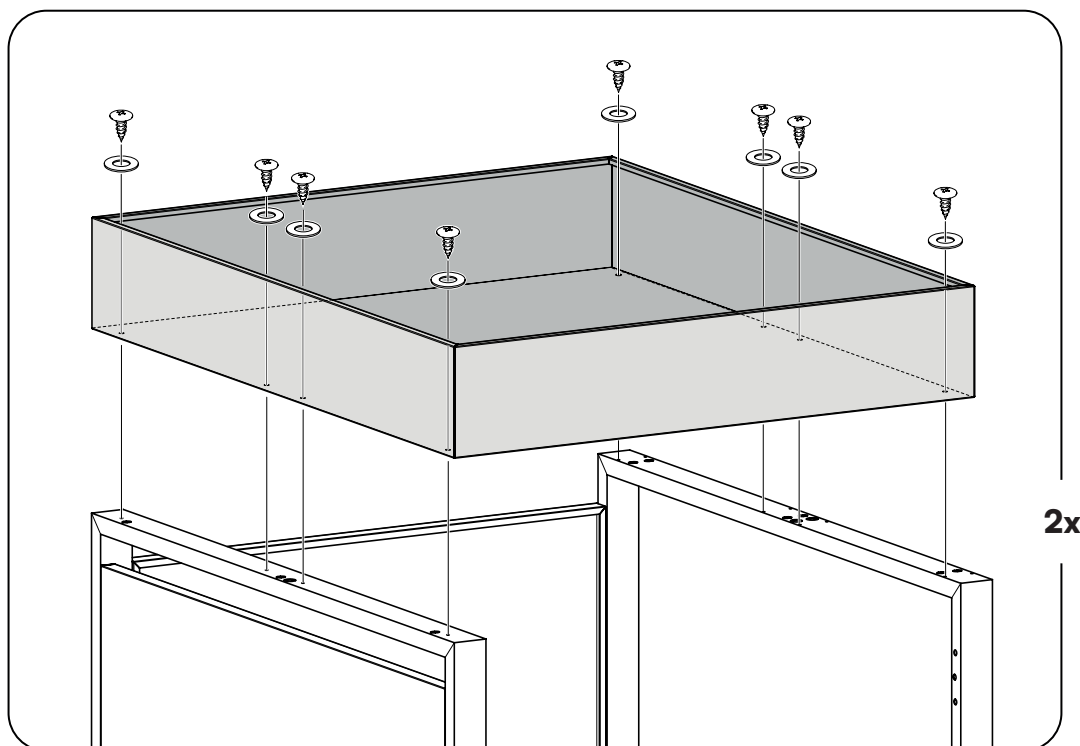
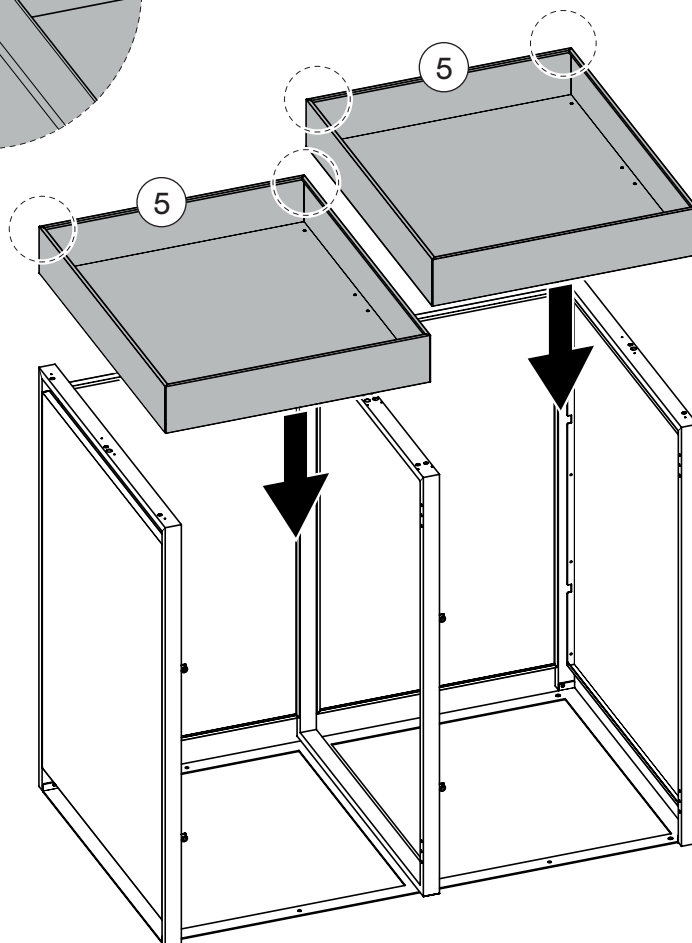
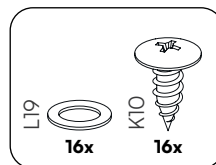
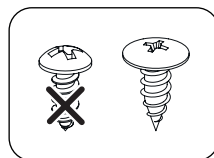
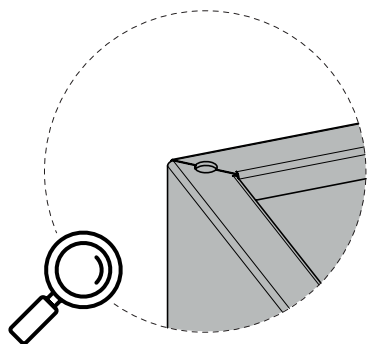

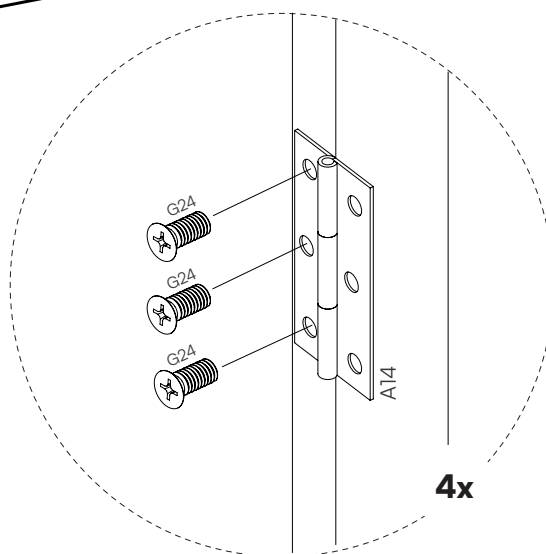
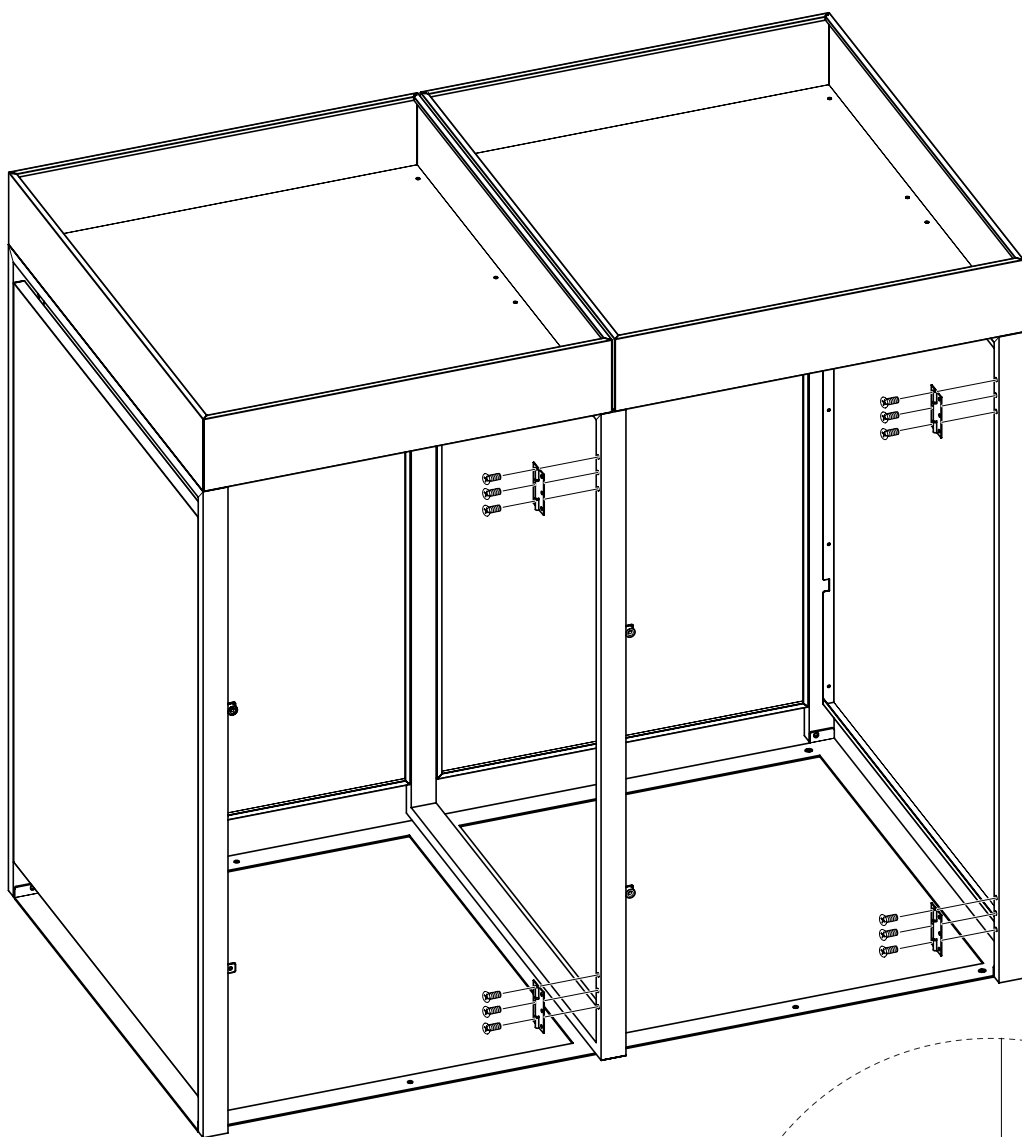
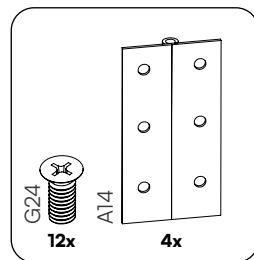
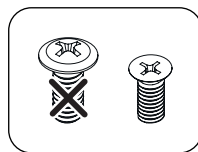

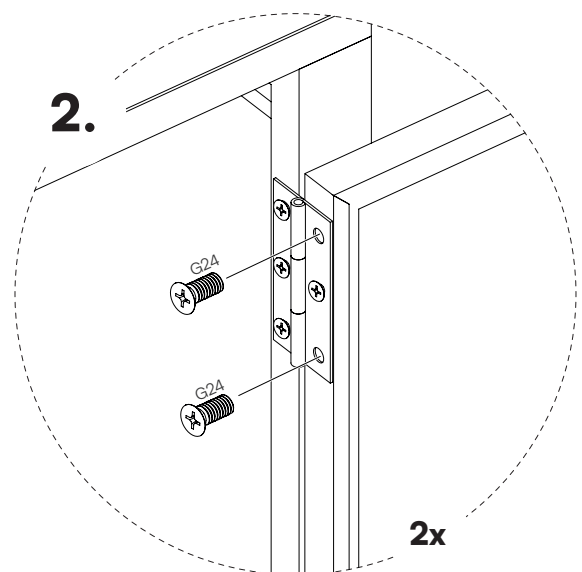
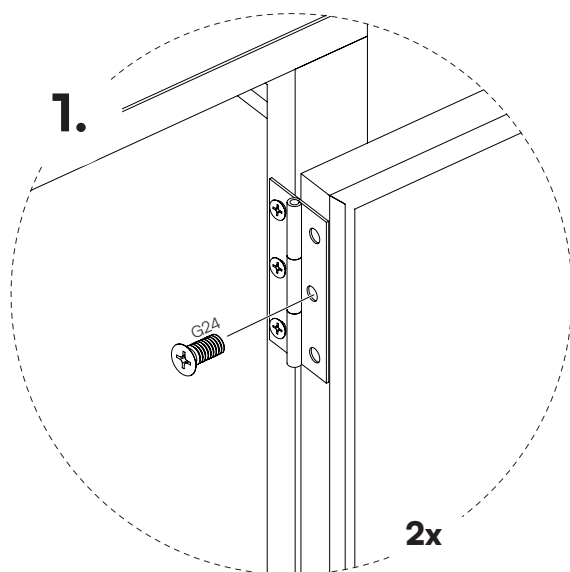
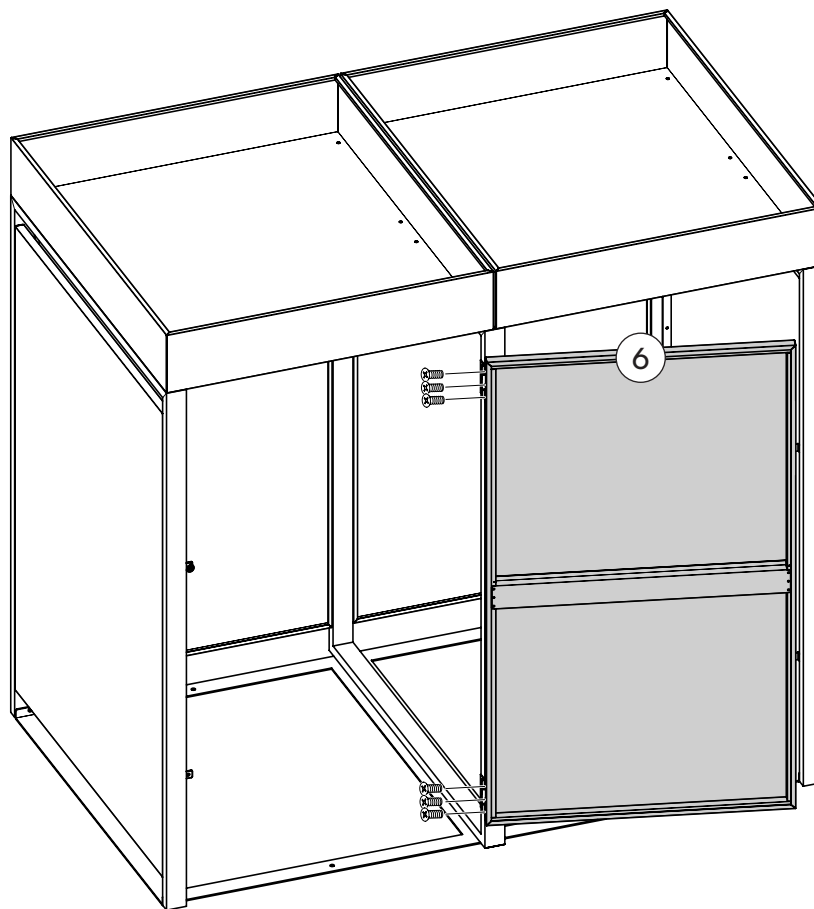
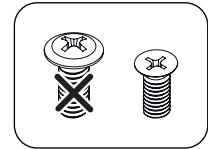

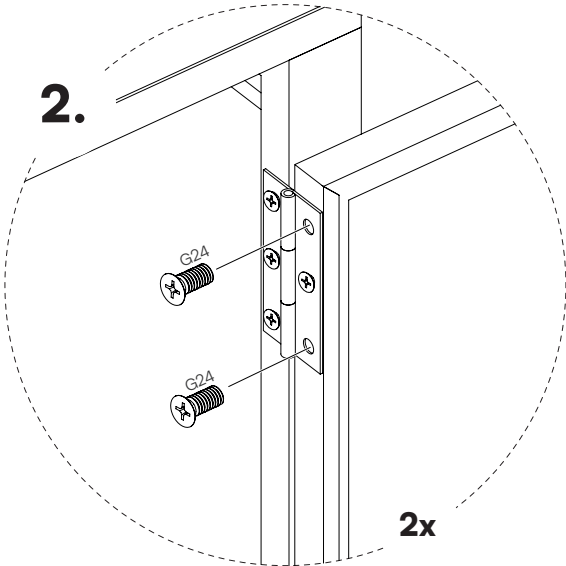
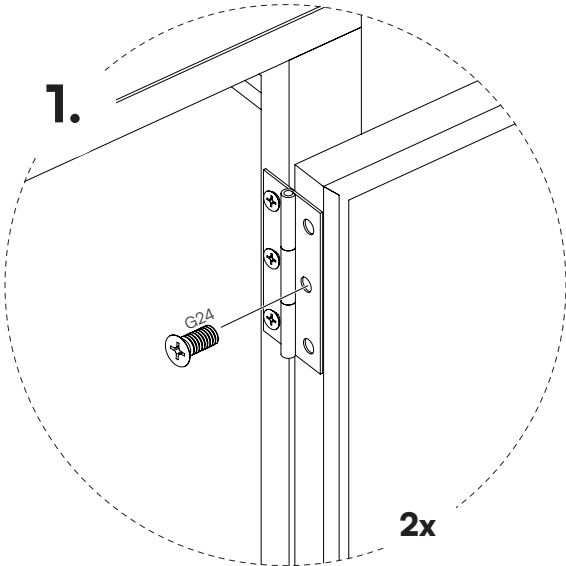
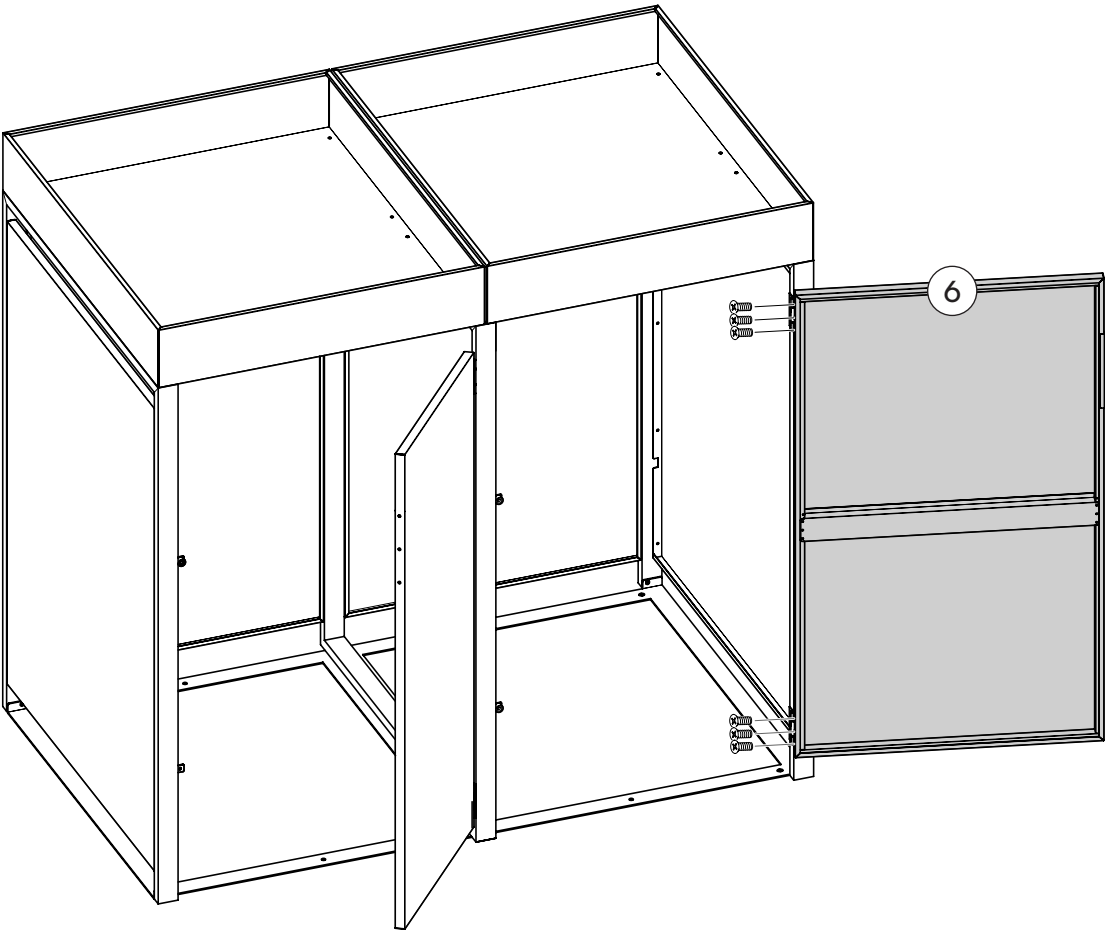
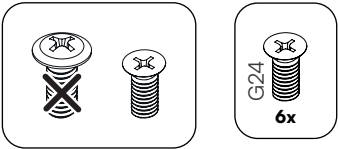

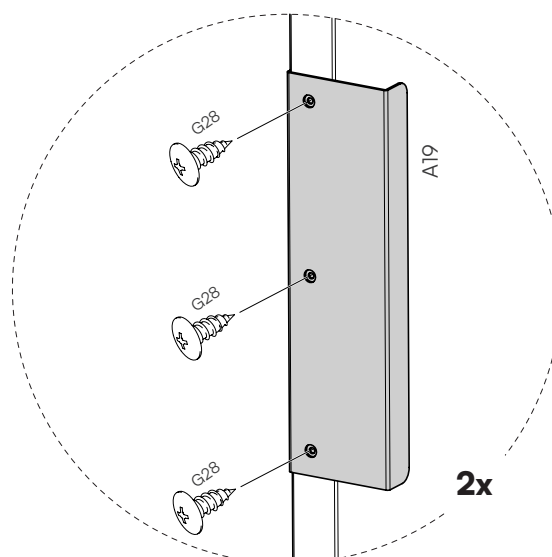
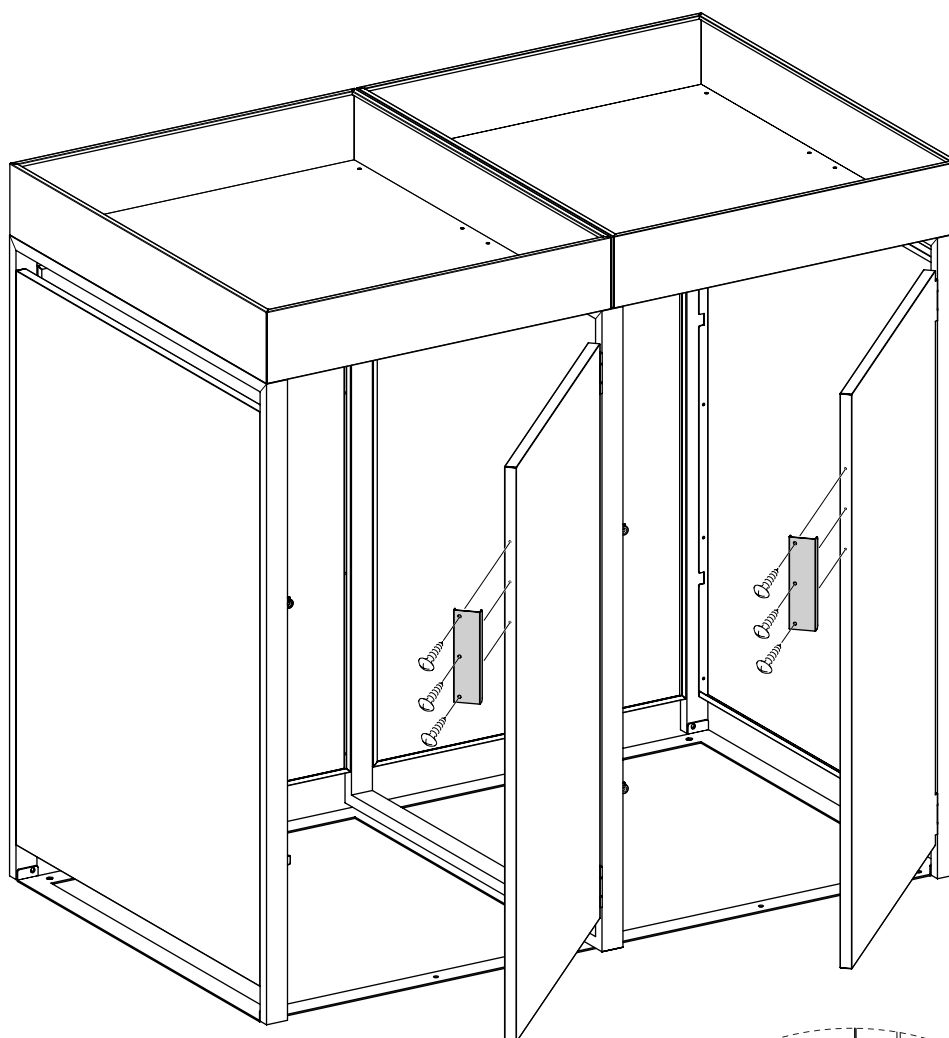
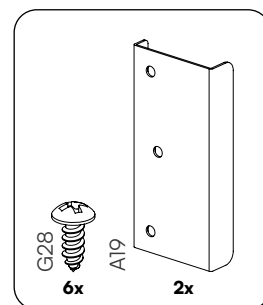
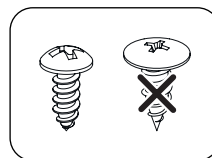

12

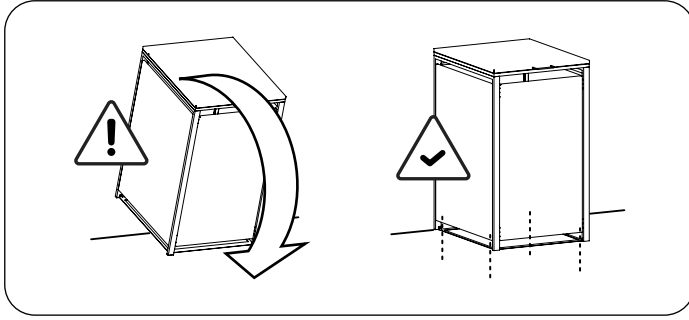

Für zusätzliche Stabilität empfehlen wir die Mülltonnenbox in den Boden zu verschrauben.

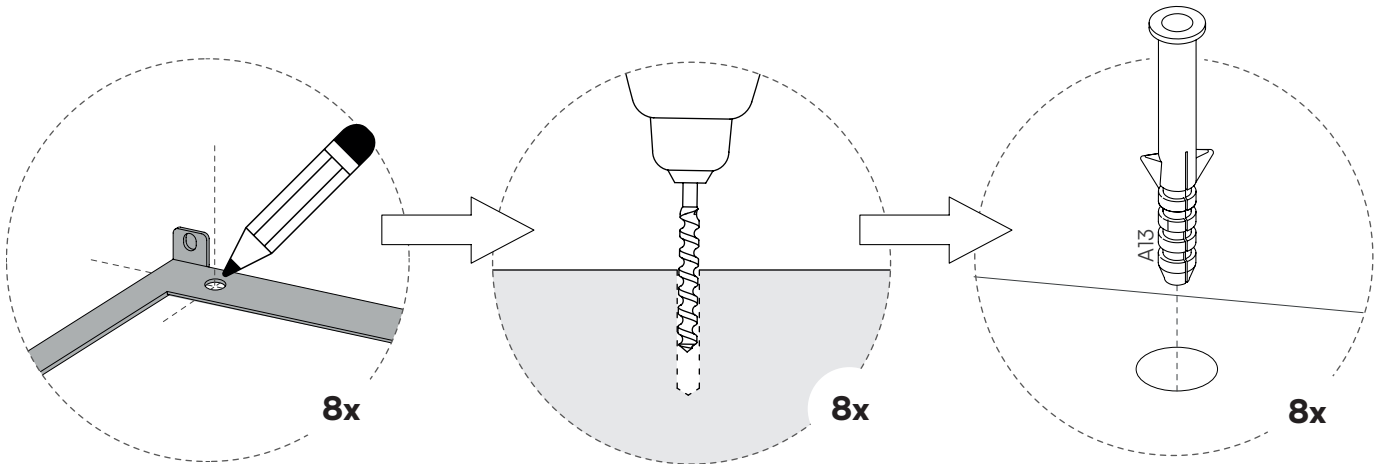
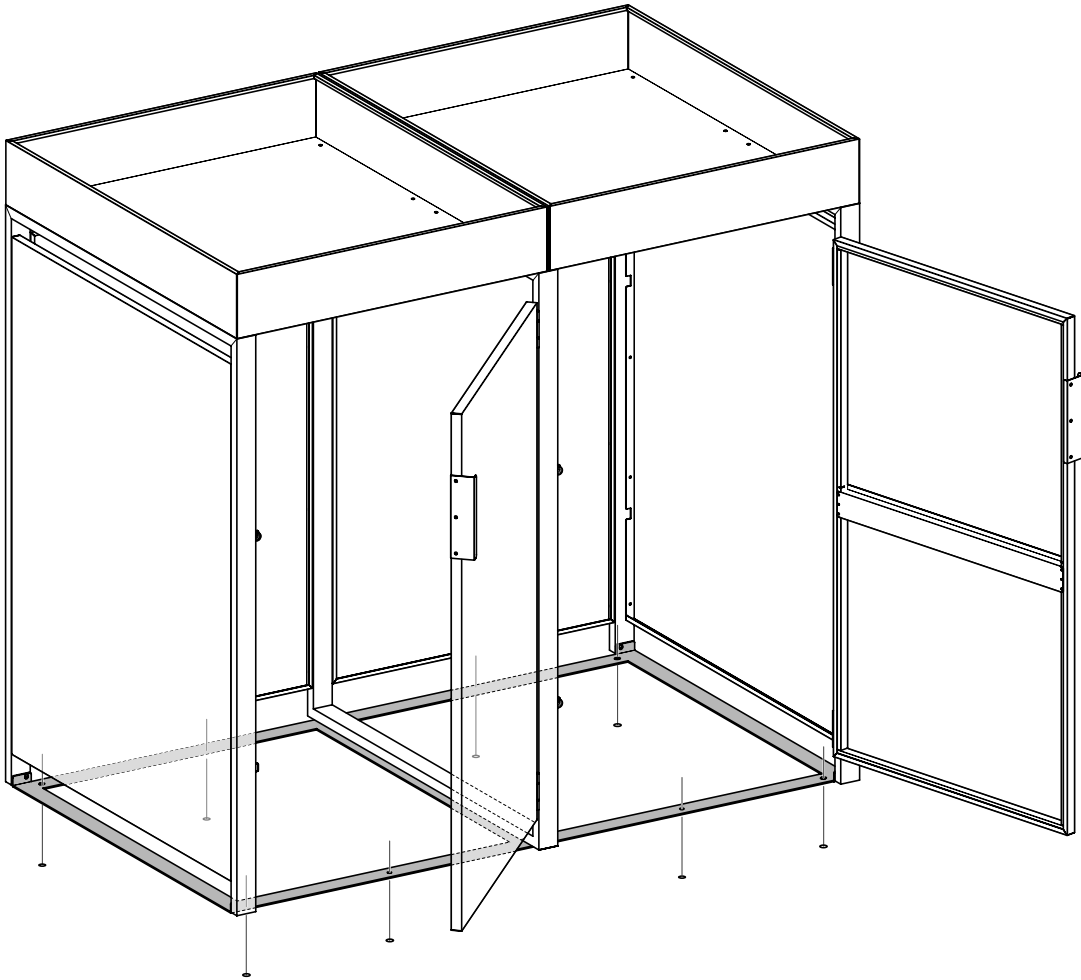
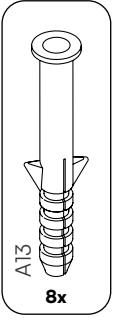

STEELSON

13

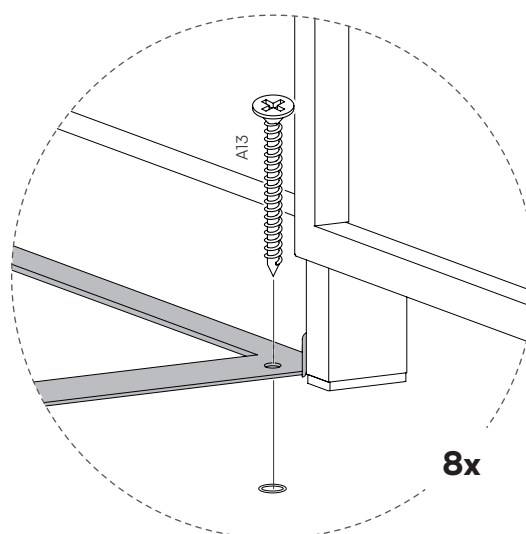
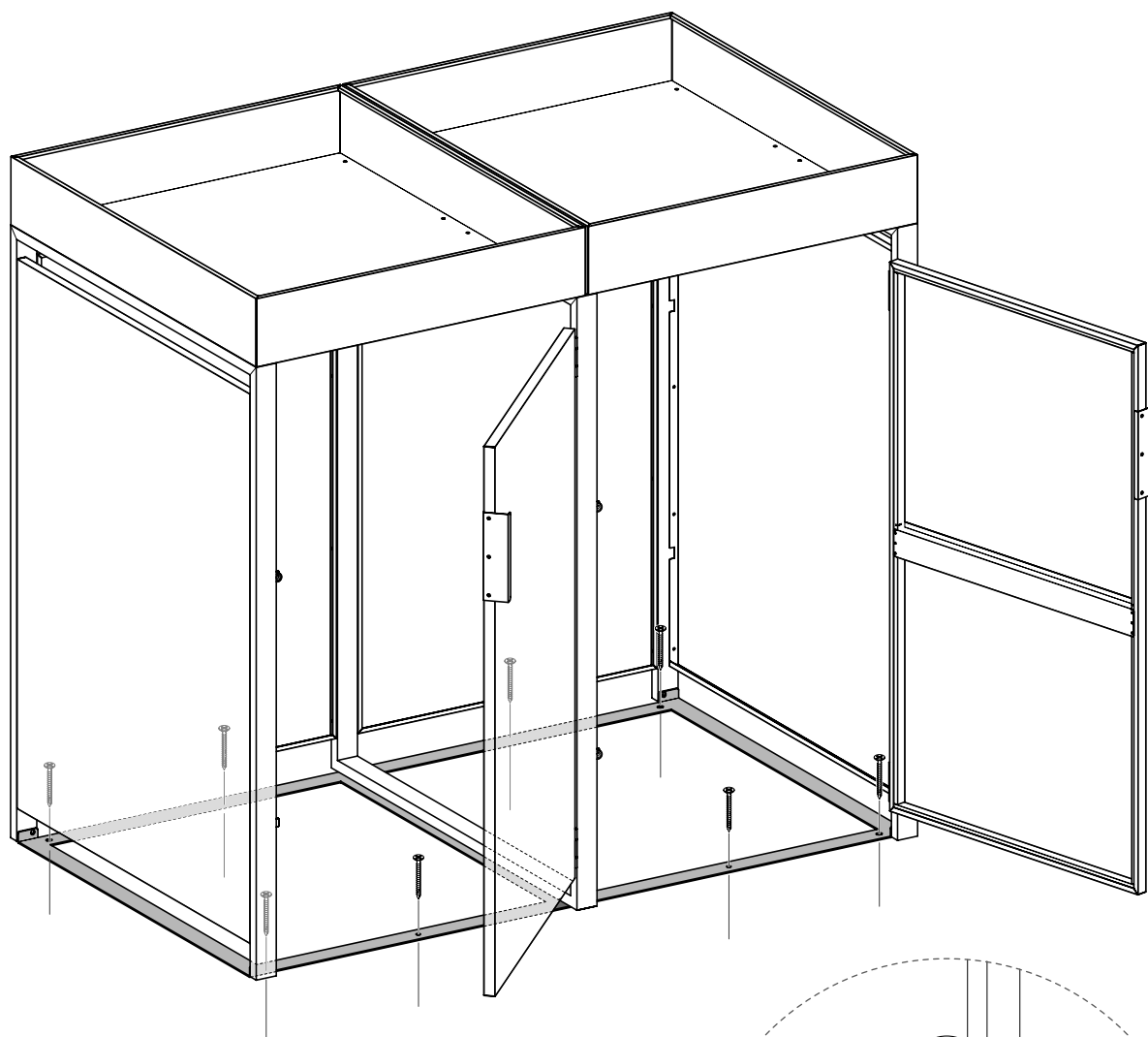
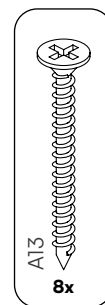

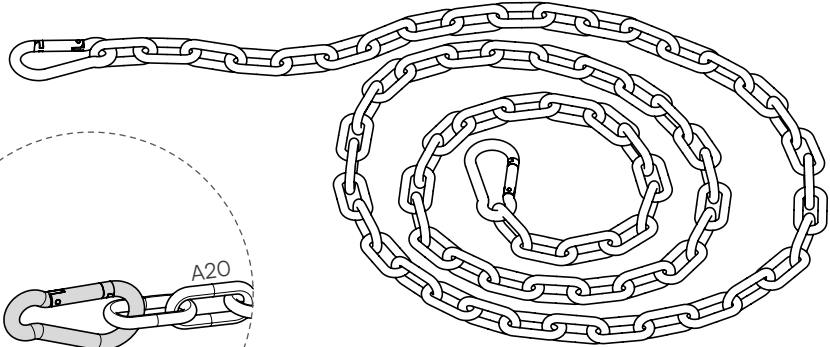
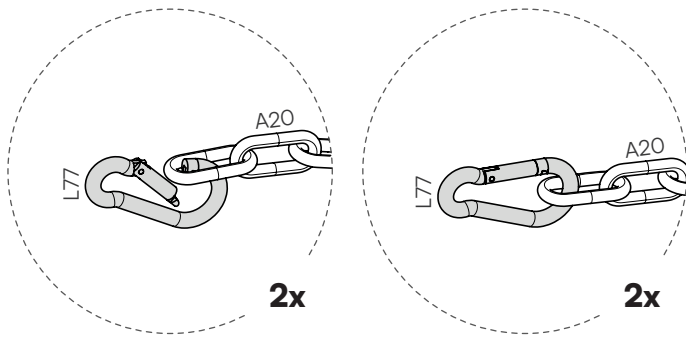

STEELSØN

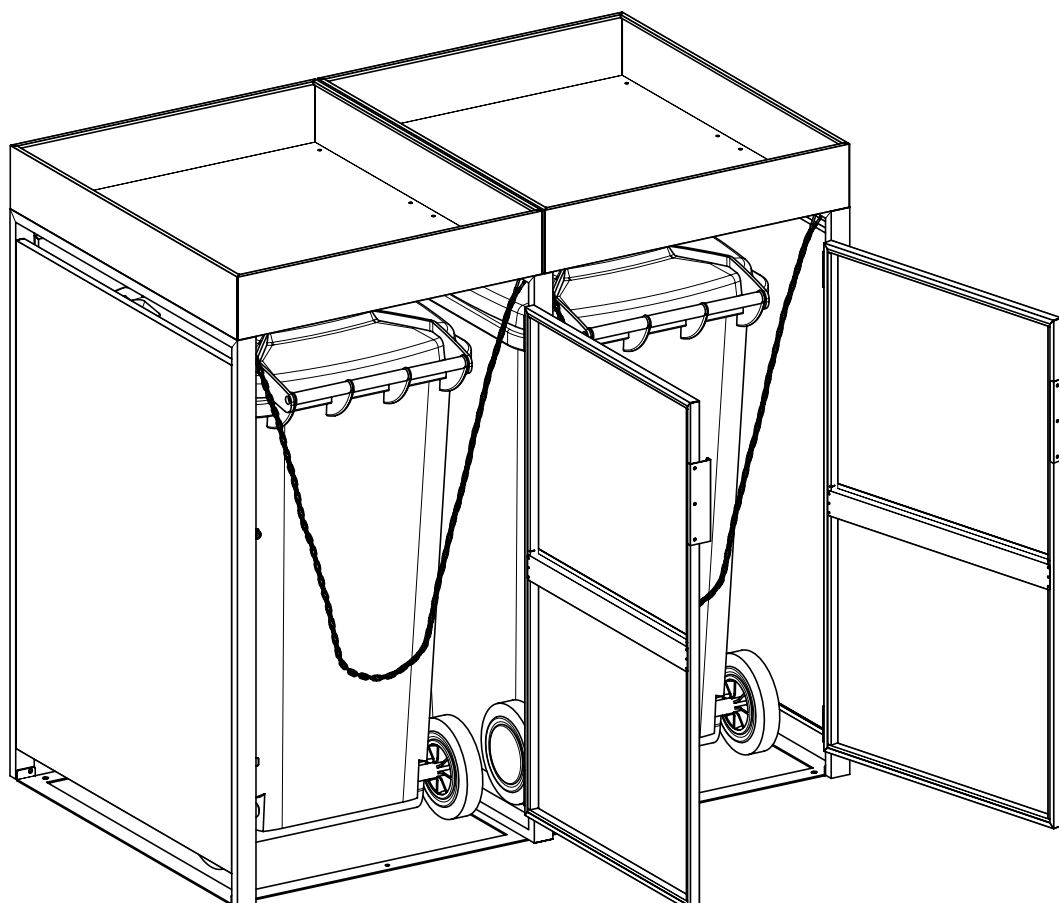
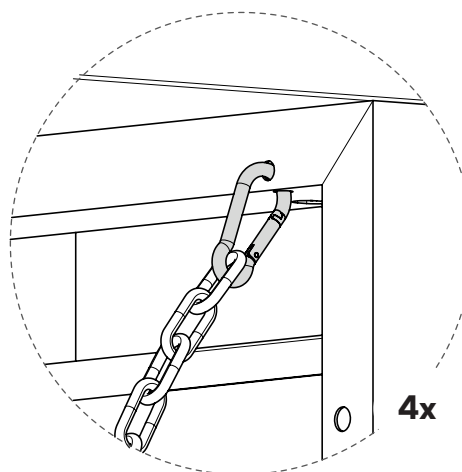
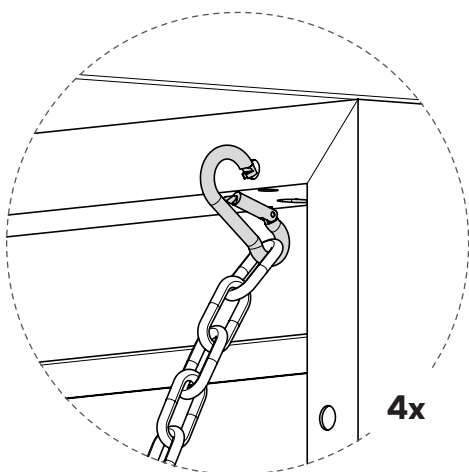
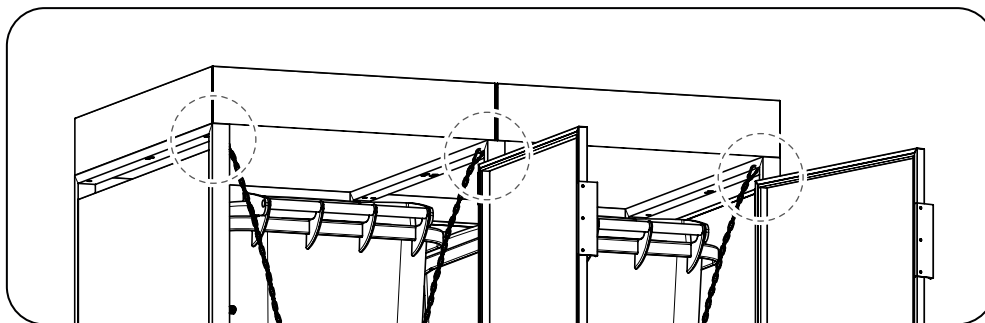

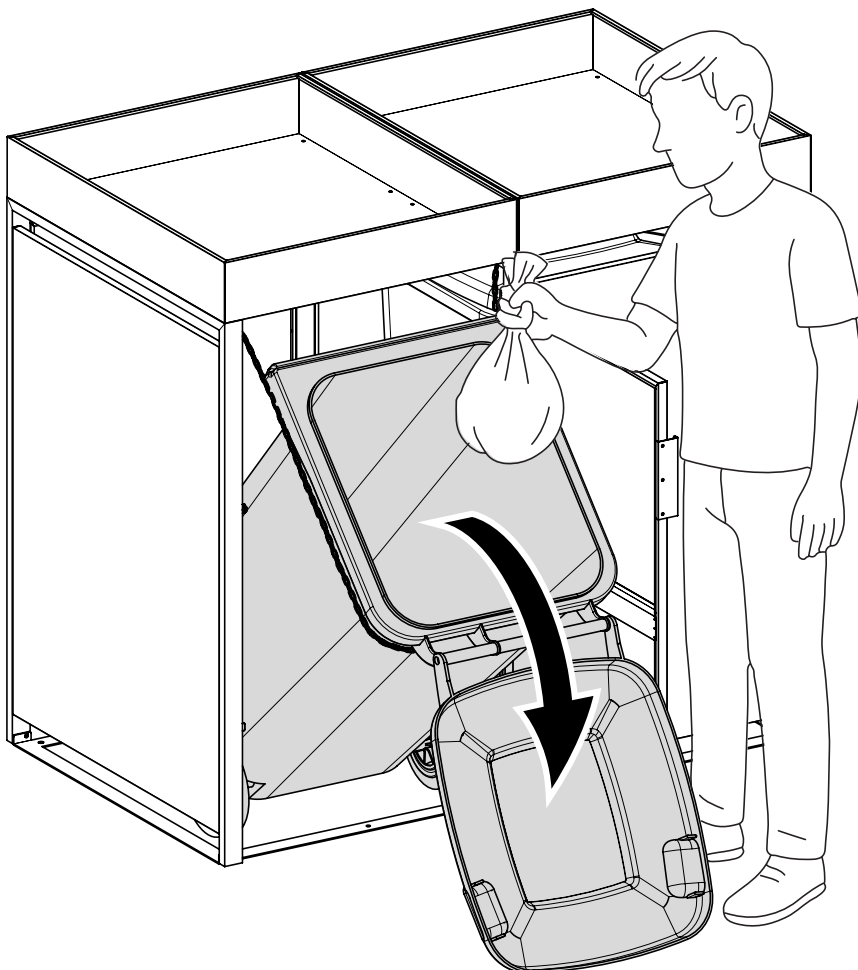
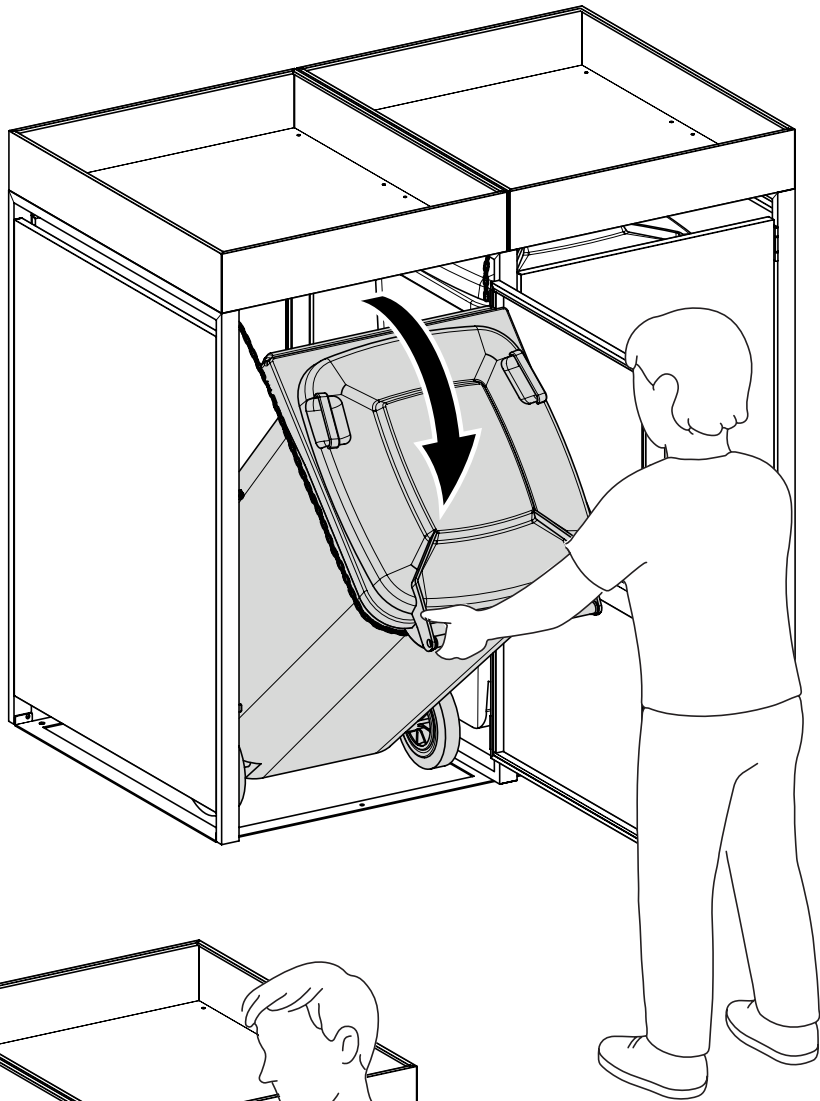

Geschafft!



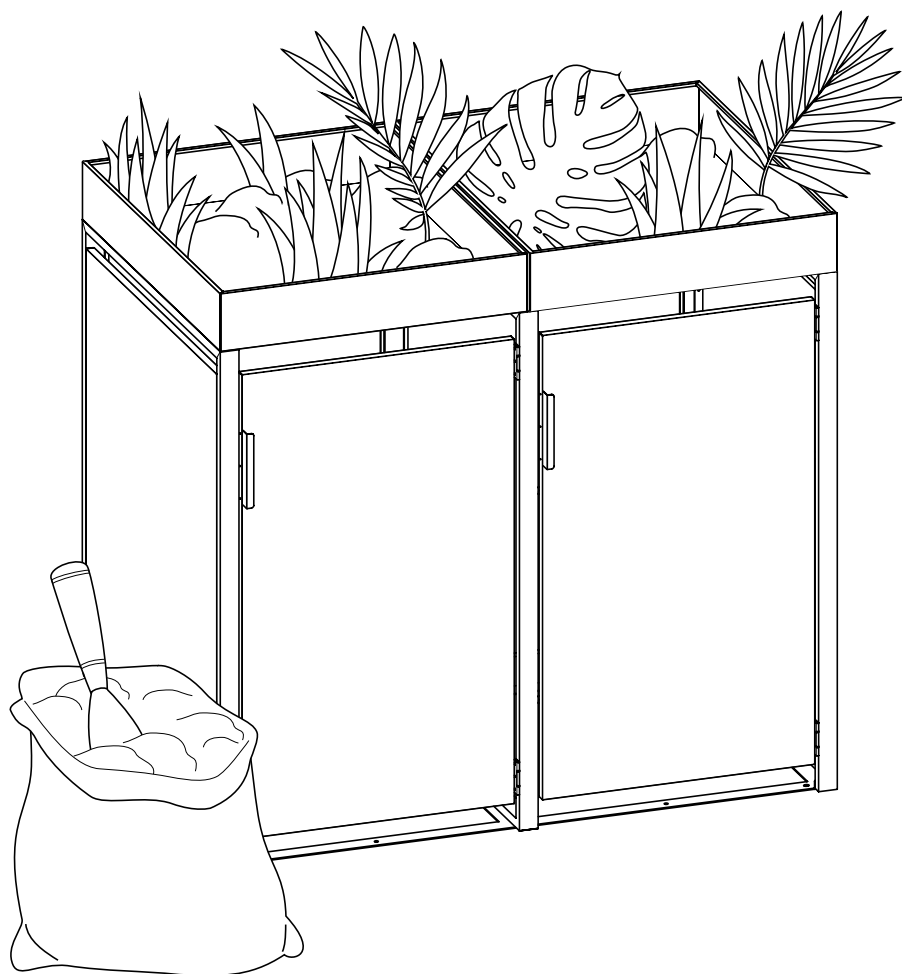

Fragen?

Wir sind für Dich da!

Scanne den QR-Code oder schreib uns an service@bela-living.de.
Gemeinsam kriegen wir jedes Problem gelöst!

