

Bellamio

**Kavir**  
Bett 90 x 200 cm



# Hey,

wir freuen uns, dass Du Dich für unser Produkt entschieden hast. Beachte die kommenden Hinweise, um den Aufbau problemlos zu gestalten.

**Viel Spaß mit Deinem Produkt!**

# 50%

weniger Fehler beim Aufbau durch  
sorgfältiges Lesen der Anleitung



## 50-60

min

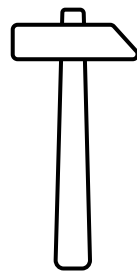

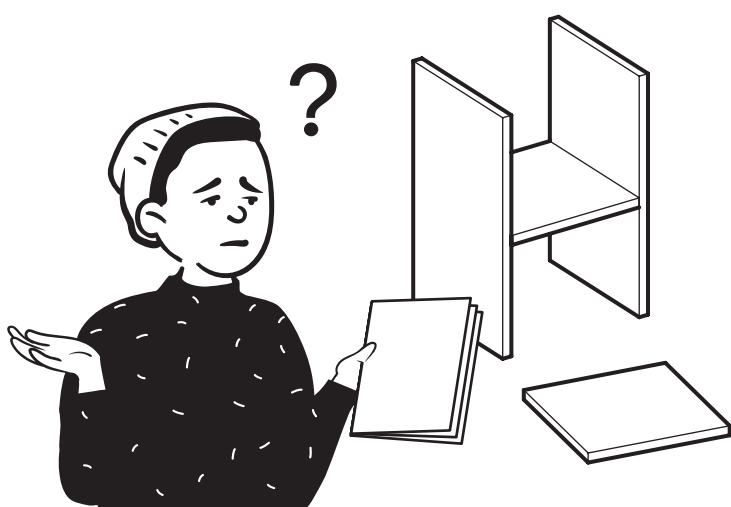
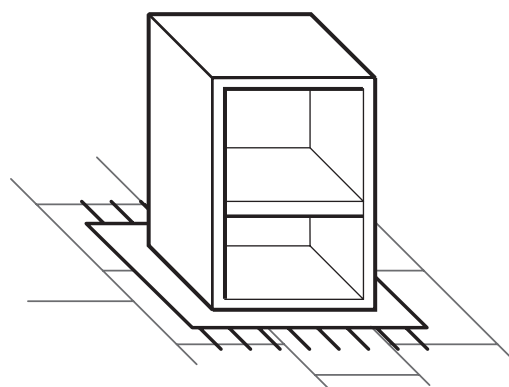
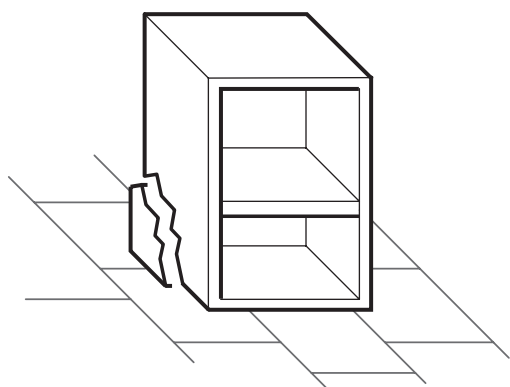

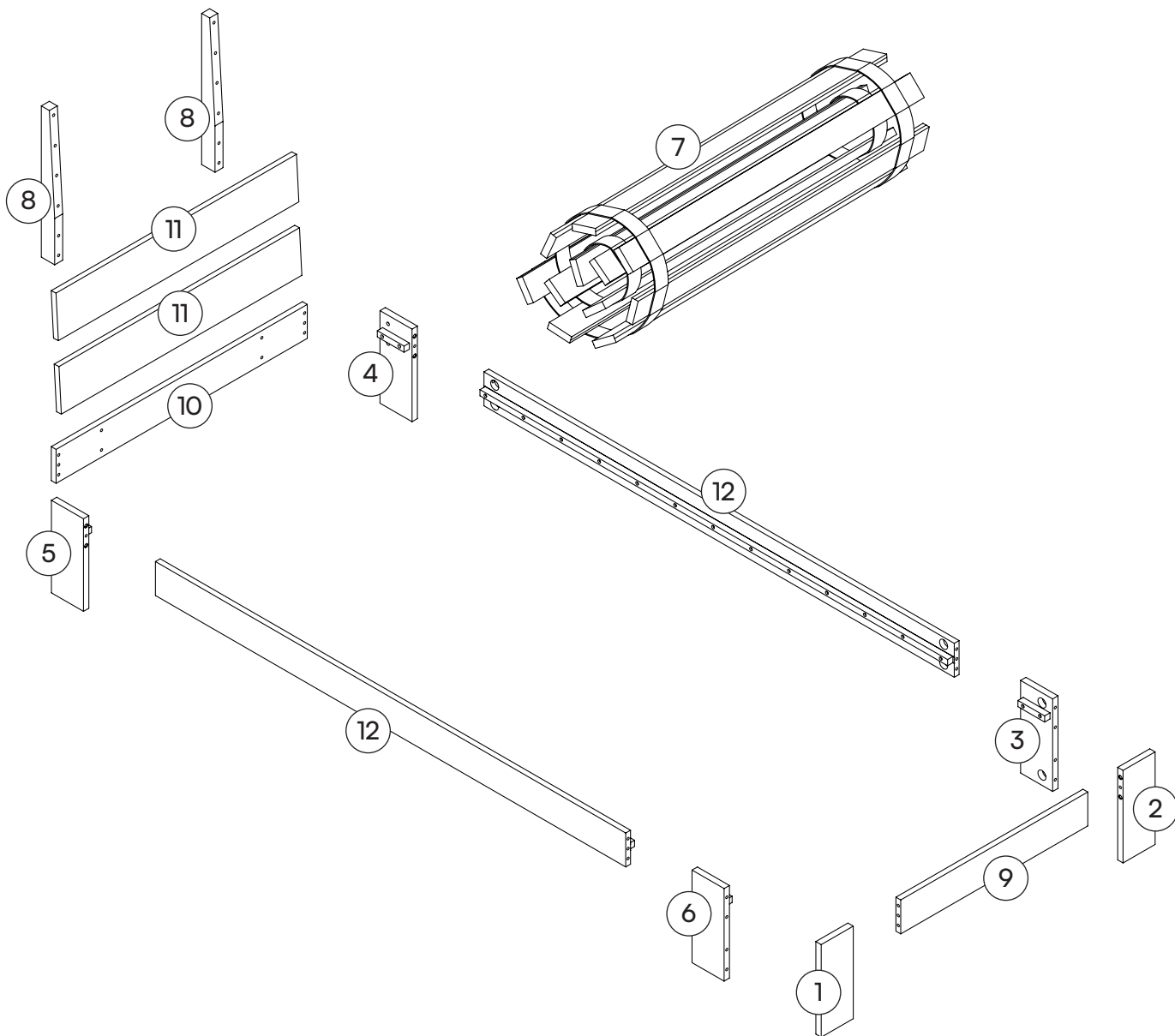

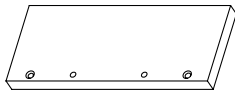

1 Fuß  
1x

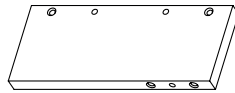

2 Fuß  
1x

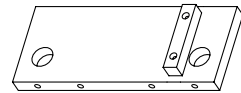

3 Fuß  
1x

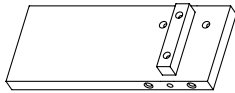

4 Fuß  
1x

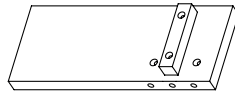

5 Fuß  
1x

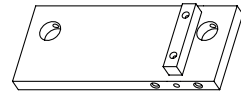

6 Fuß  
1x

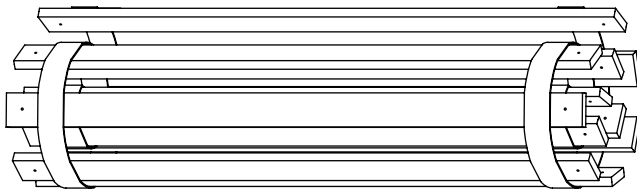

7 Lattenrost  
1x

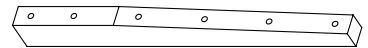

8 Kopfteilstrebe  
2x

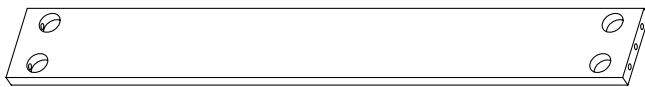

9 Fußbleiste  
1x

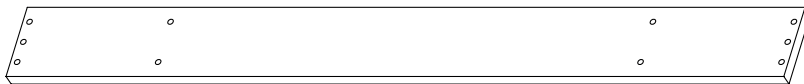

10 Kopfleiste  
1x



11 Kopfteil  
2x

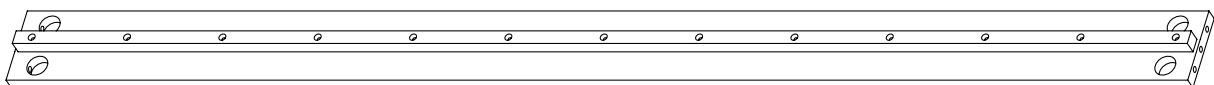

12 Seitenteil  
2x

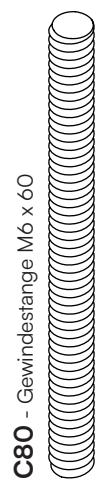

**C80** - Gewindestange M6 x 60

16x

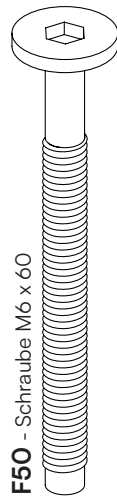

**F50** - Schraube M6 x 60

8x

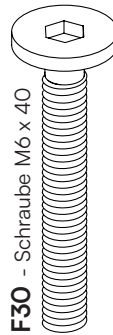

**F30** - Schraube M6 x 40

8x



**D10** - Dübel 8 x 30

12x

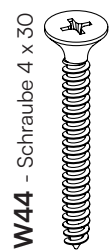

**W44** - Schraube 4 x 30

28x

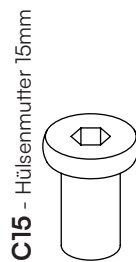

**C15** - Hülsenmutter 15mm

4x



**C21** - Fassmutter M6

4x

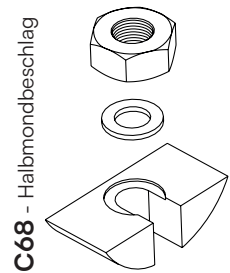

**C68** - Halbmondbeschlag

16x

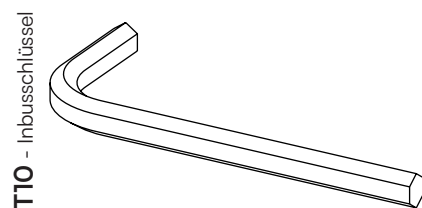

**T10** - Inbusschlüssel

2x

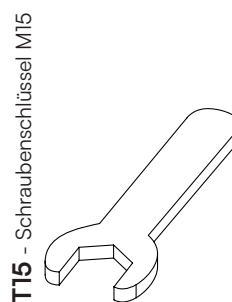

**T15** - Schraubenschlüssel M15

1x

# Ein letzter Check:

Bitte überprüfe, ob Du alle Teile hast.

**Viel Spaß beim Aufbau!**

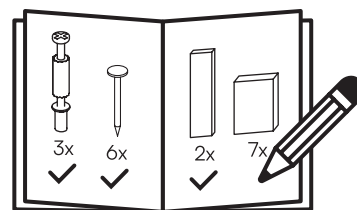

# 1

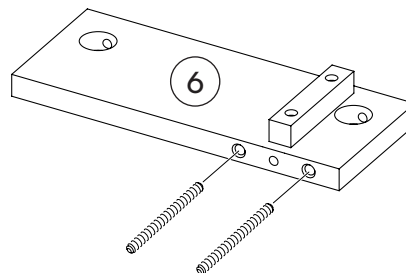
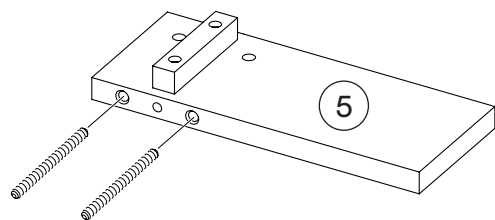
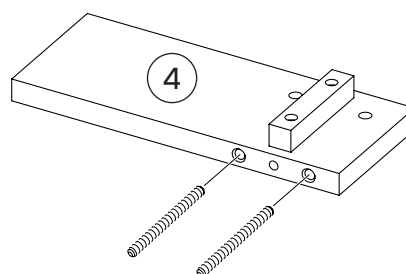
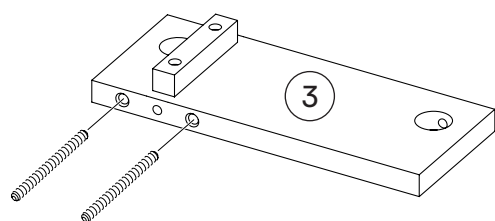
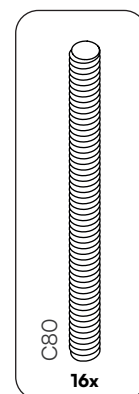
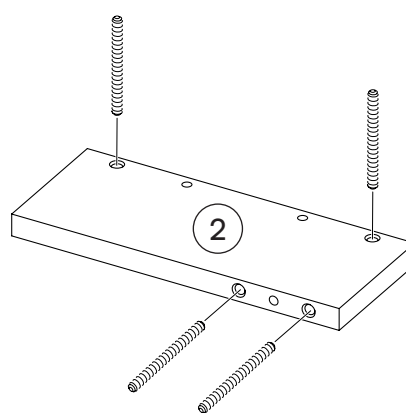
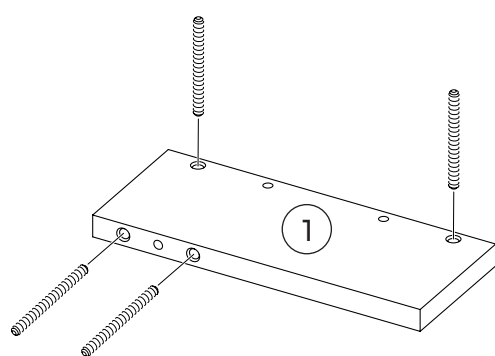

# 2

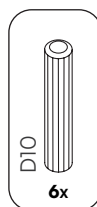
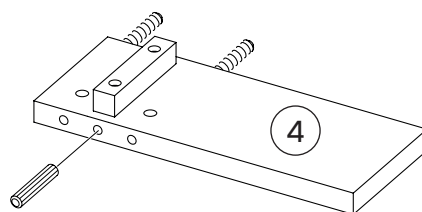
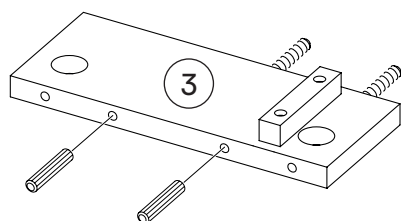
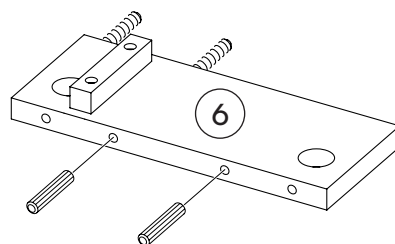
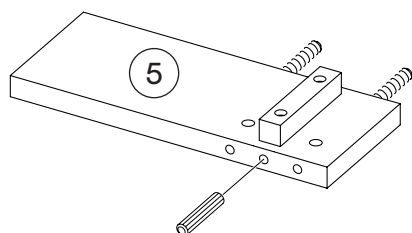

# 3

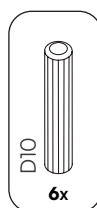
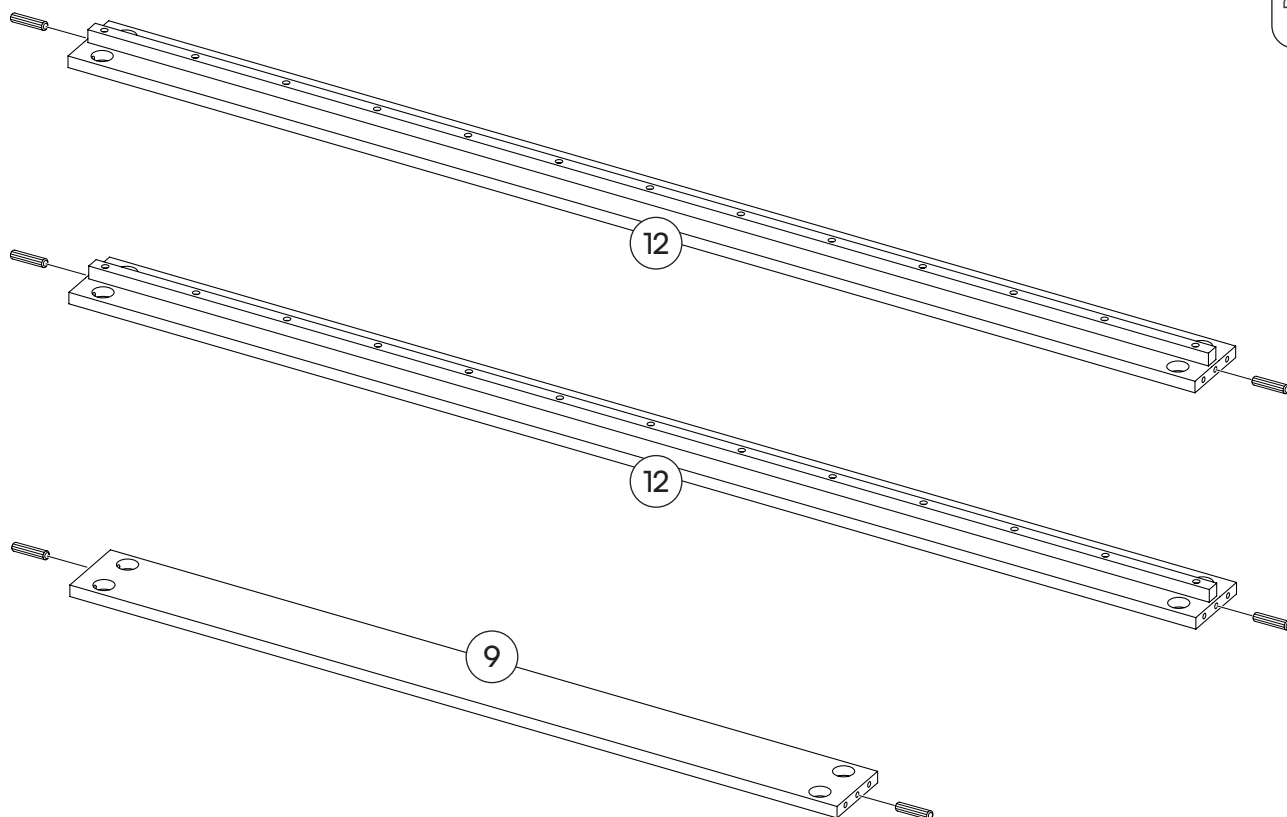



# 4

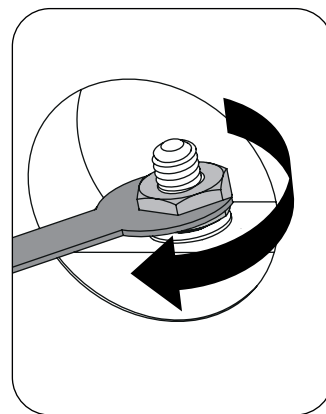
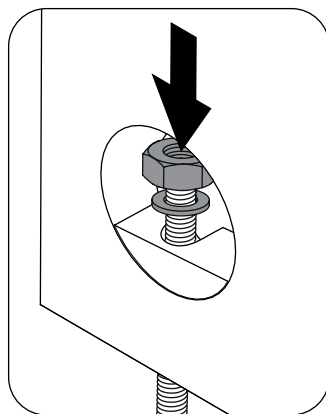
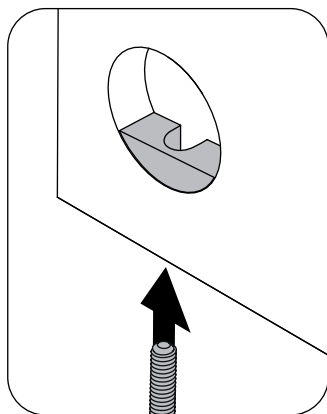
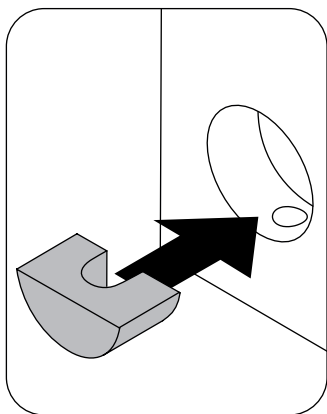
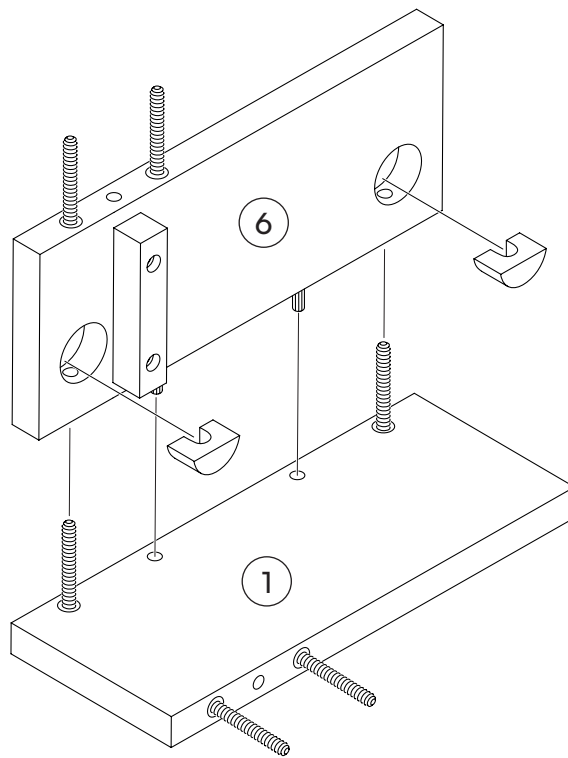
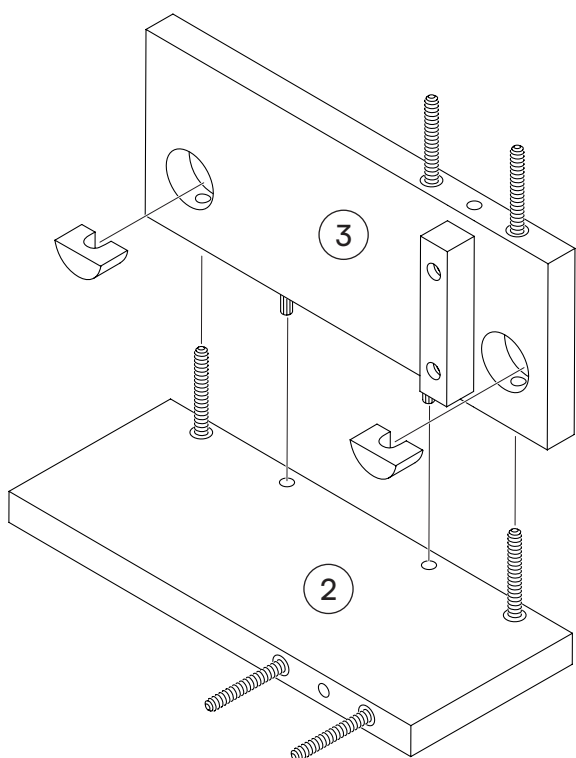
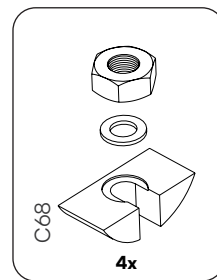

# 5

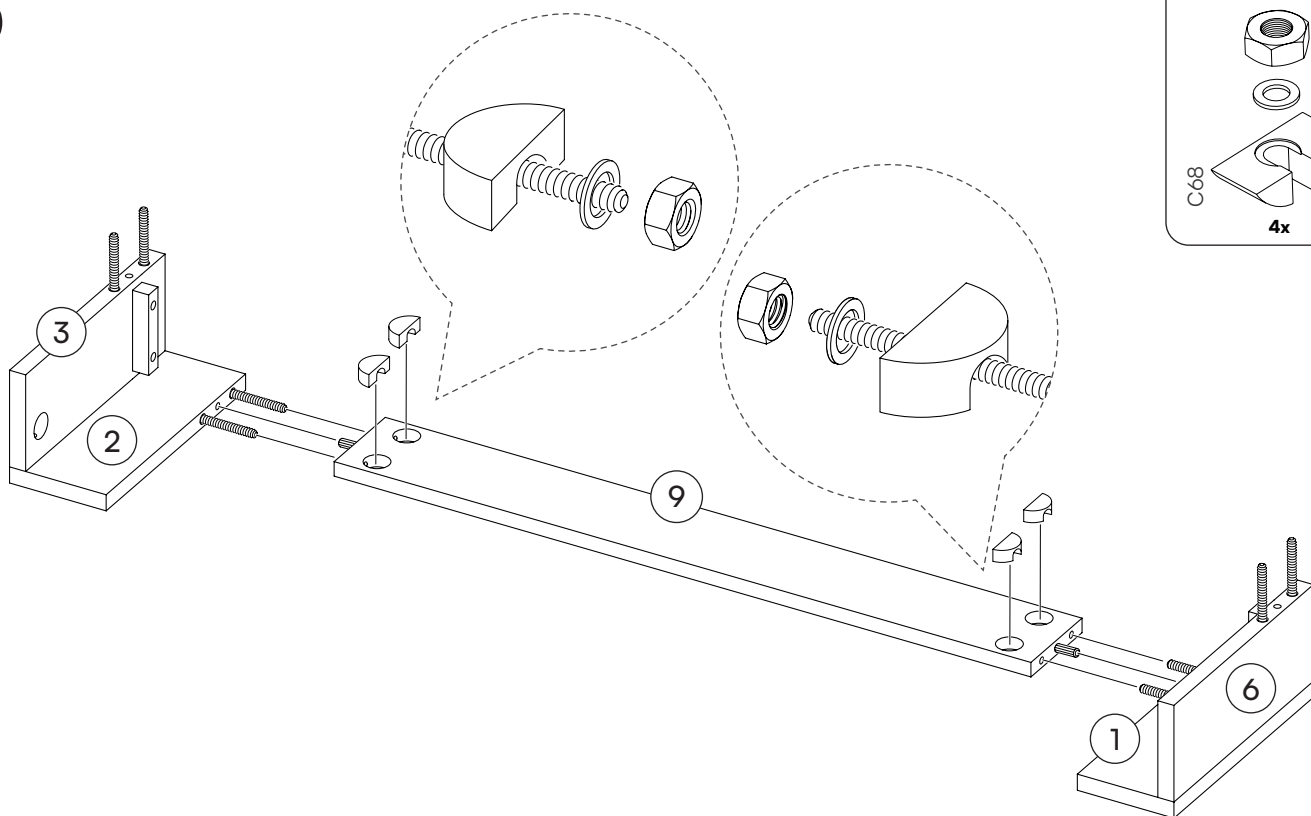

# 6

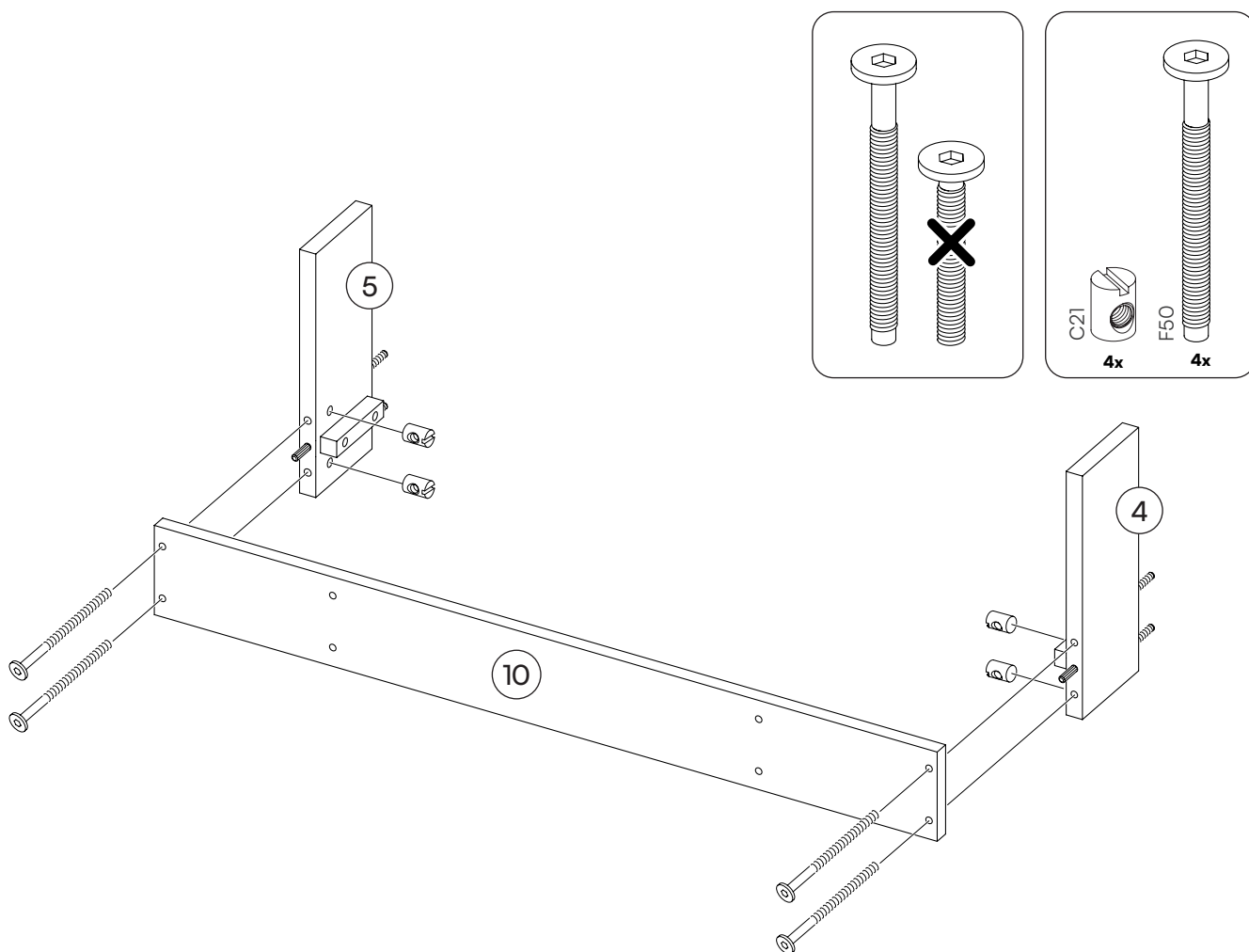

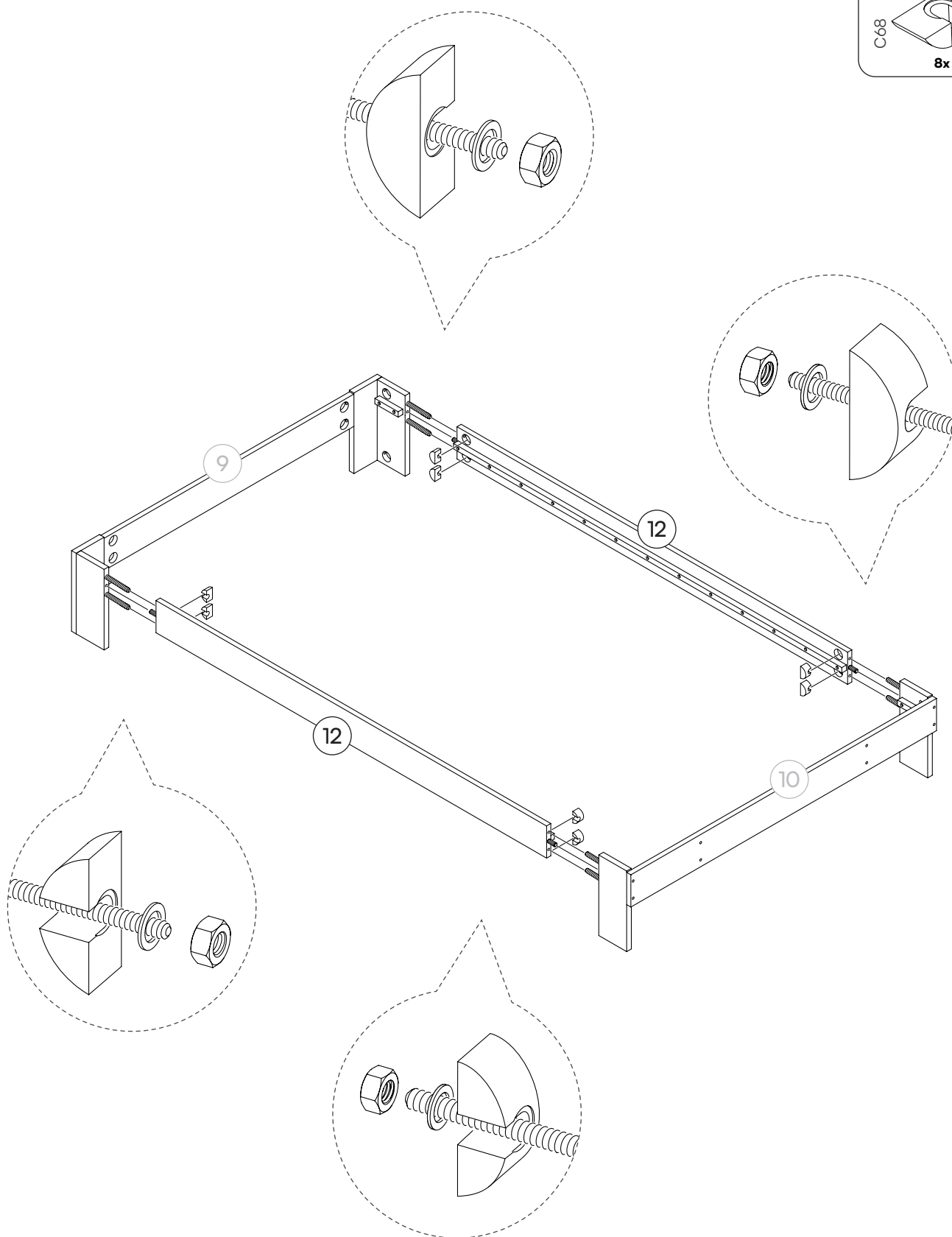
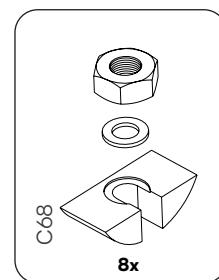

# 8

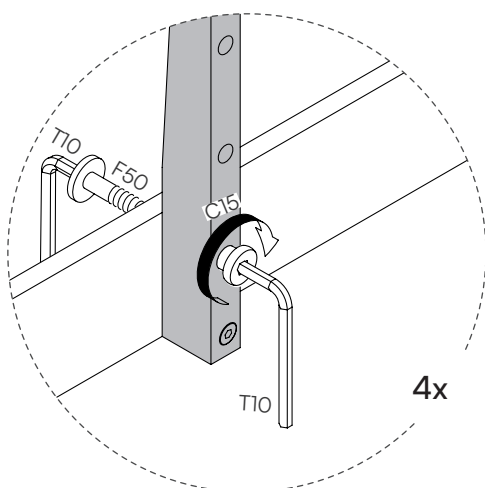
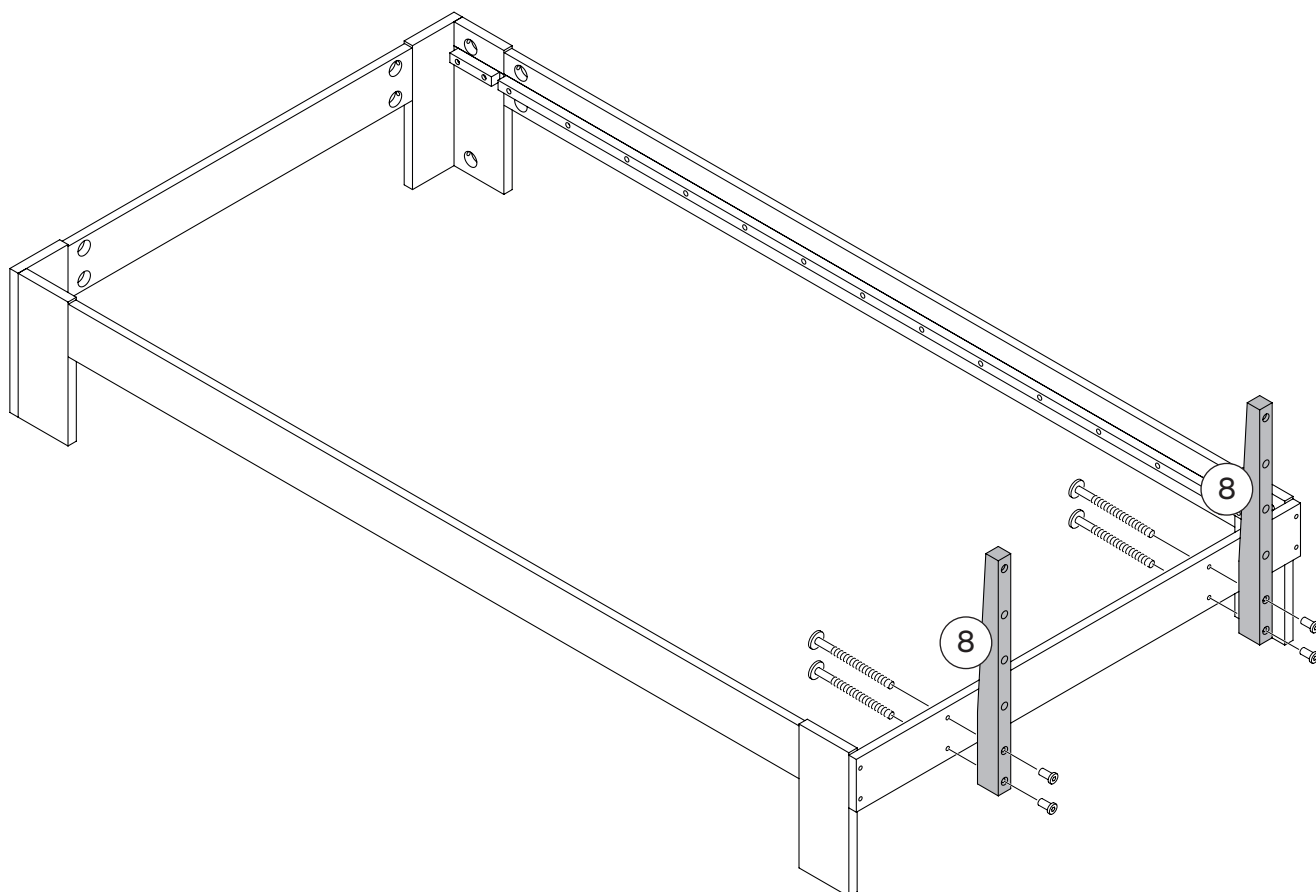
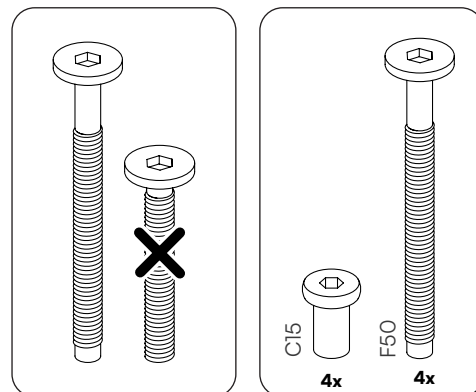

9

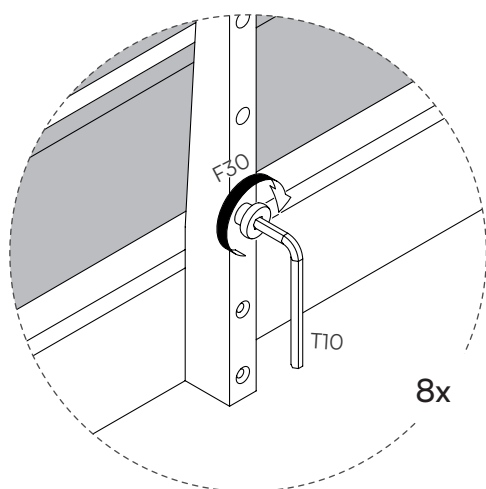
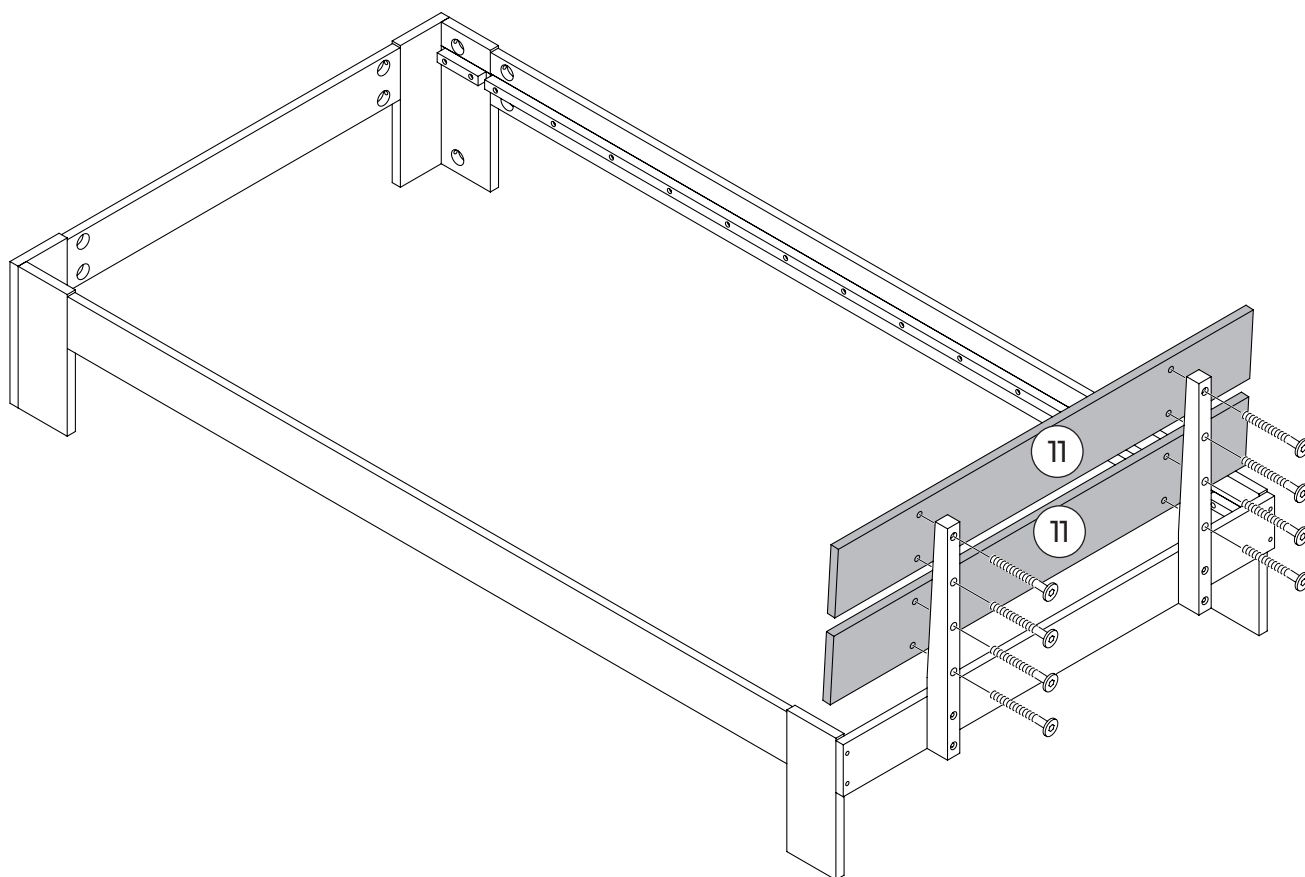
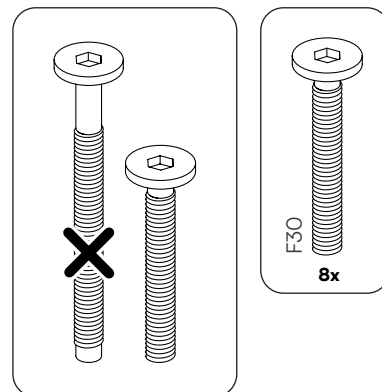

# 10

