

# skølm.

**Vidar**  
Metallbett

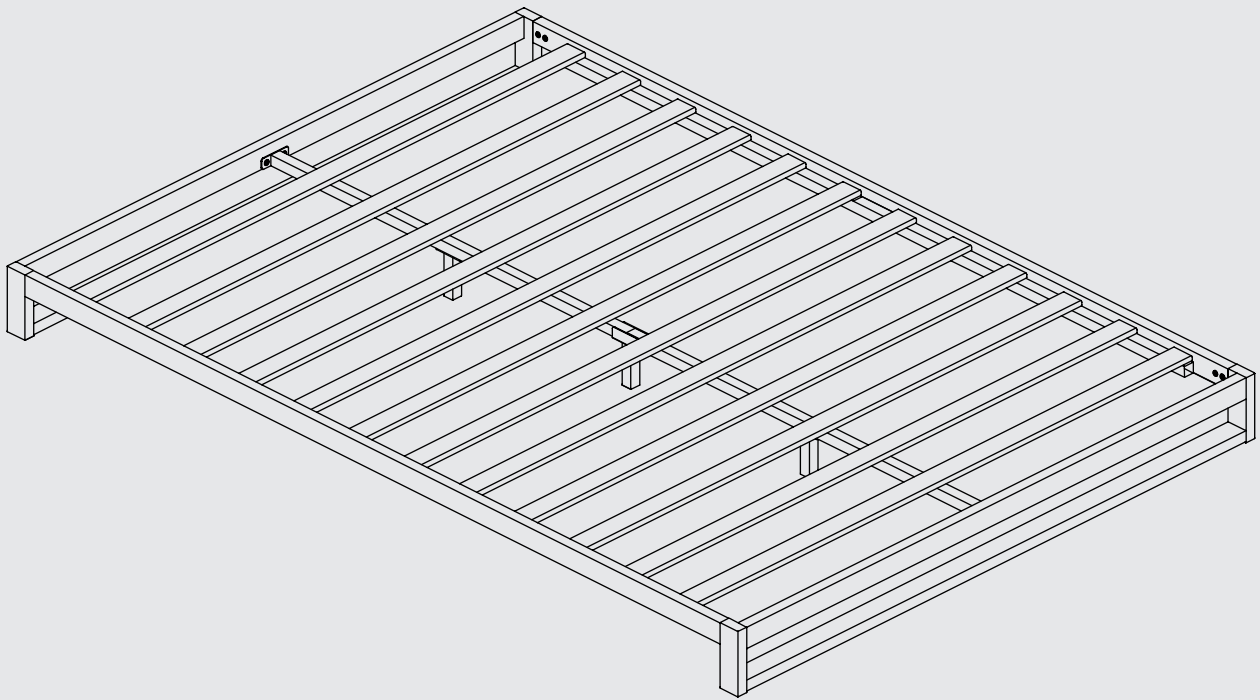



# Hey,

wir freuen uns, dass Du Dich für unser Produkt entschieden hast. Beachte die kommenden Hinweise, um den Aufbau problemlos zu gestalten.

**Viel Spaß mit Deinem Produkt!**

# 50%

weniger Fehler beim Aufbau durch  
sorgfältiges Lesen der Anleitung



# 30-45

min

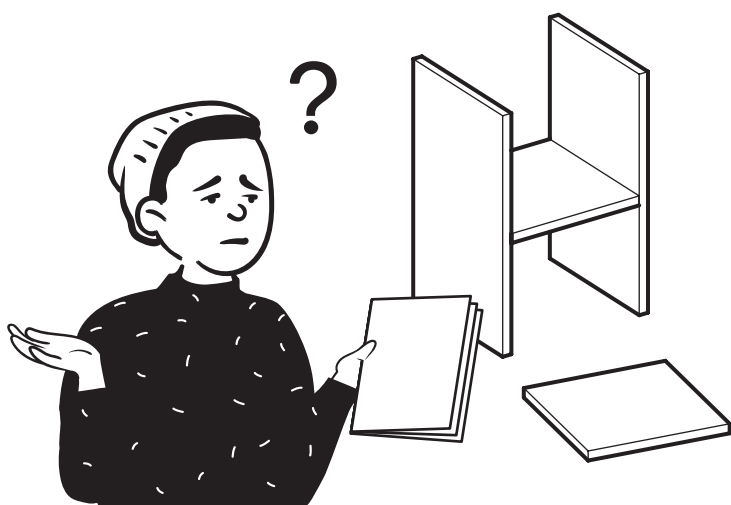
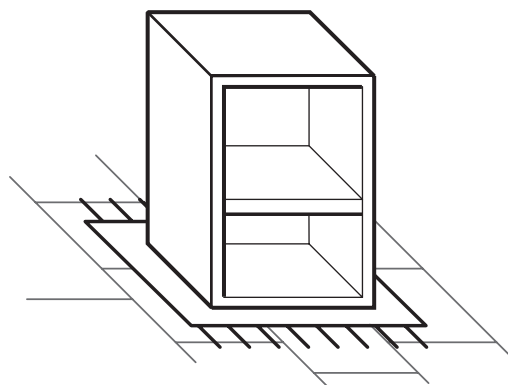
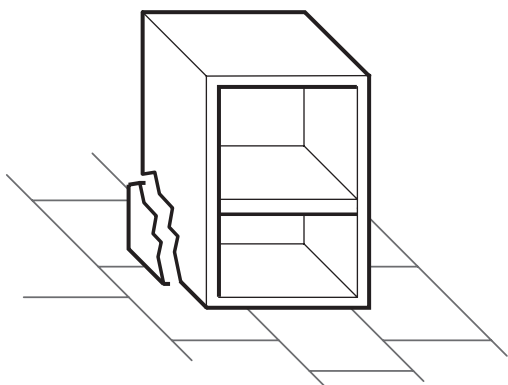

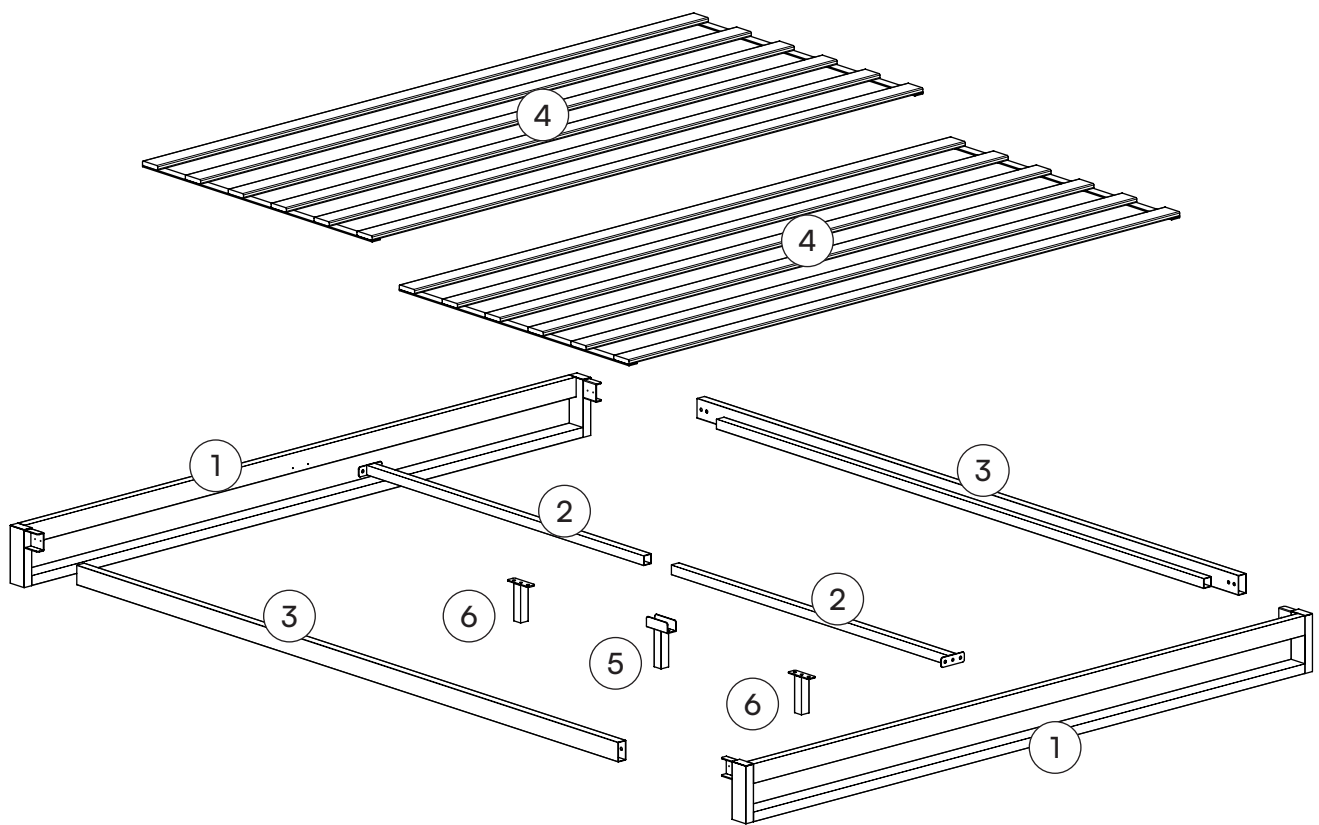



1 Kopf-/ Fußteil  
2x



2 Mittelstrebe  
2x

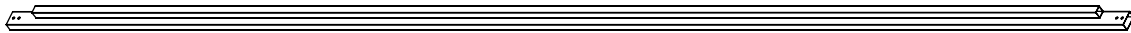

3 Seitenstrebe  
2x

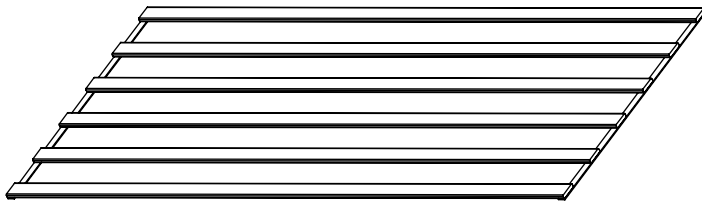

4 Lattenrost  
2x

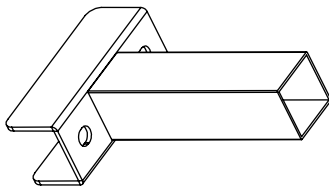

5 Fuß, mittig  
1x

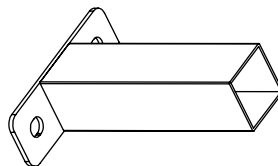

6 Fuß, außen  
2x

**F12** - Schraube M6 x 10

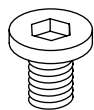

18x

**L72** - Endkappe

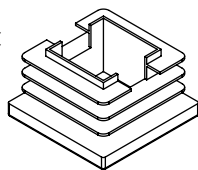

3x

**L74** - Endkappe

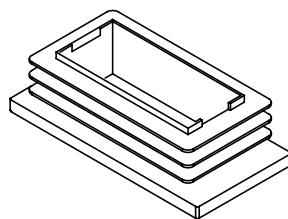

4x

**T10** - Inbusschlüssel

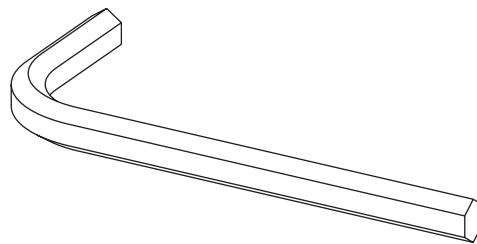

1x

# Ein letzter Check:

Bitte überprüfe, ob Du alle Teile hast.

**Viel Spaß beim Aufbau!**

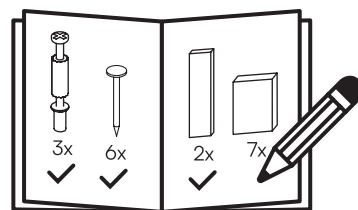

**1** 

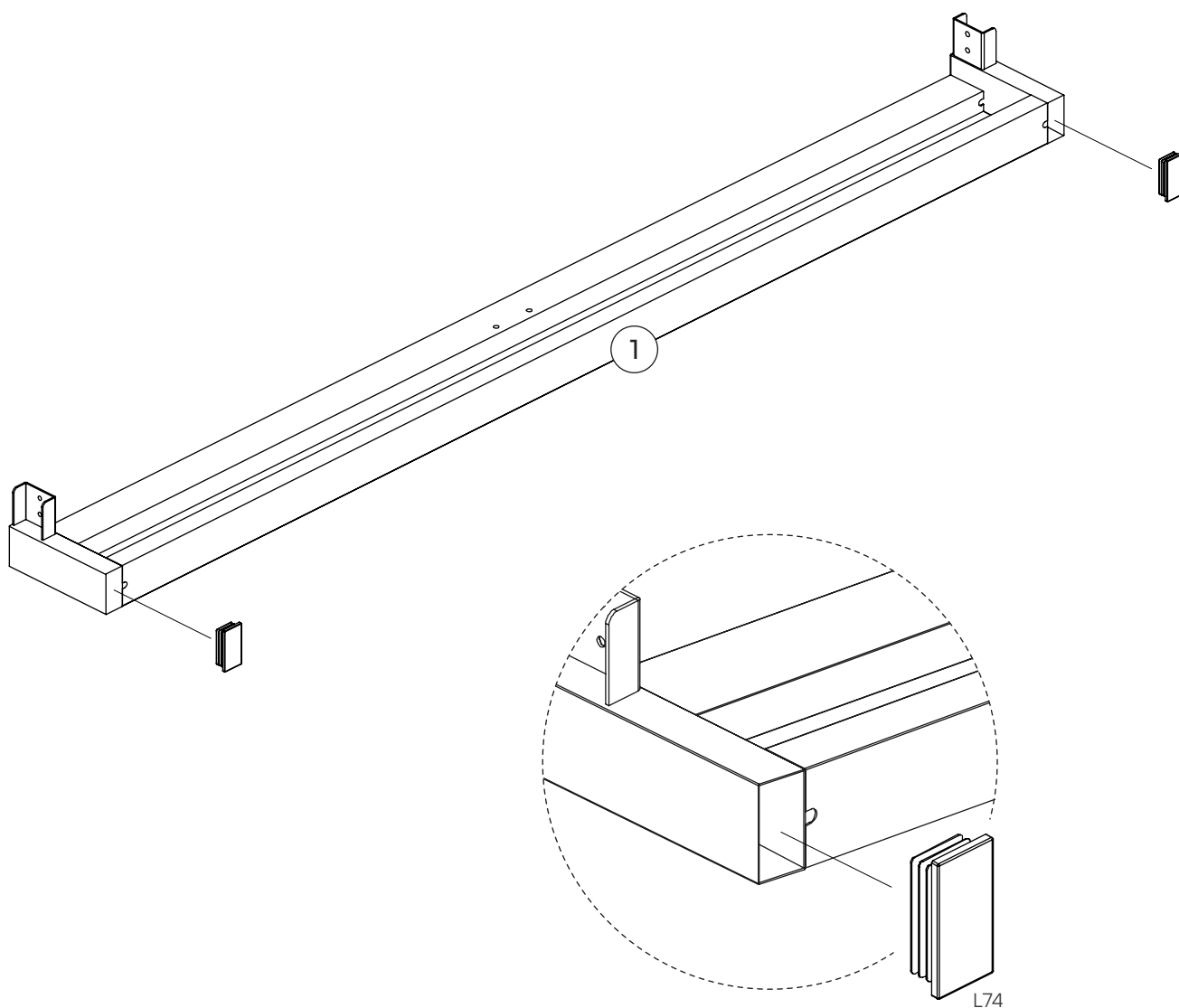
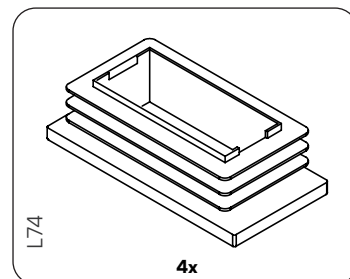

# 2

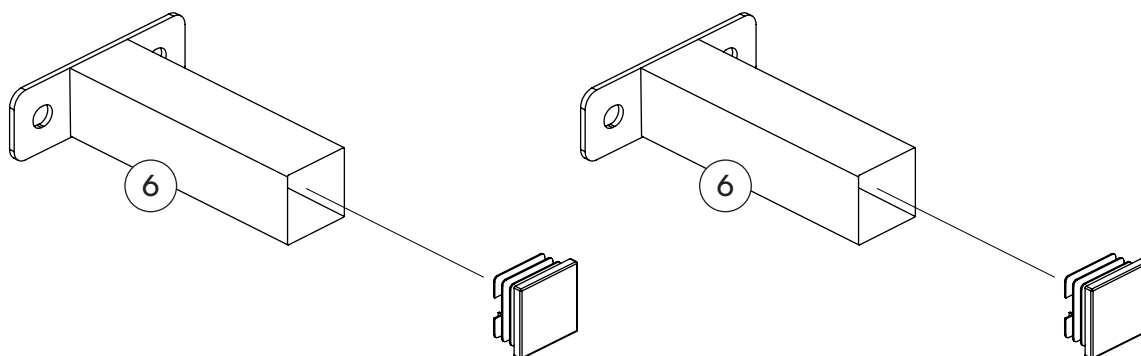
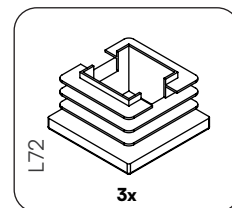
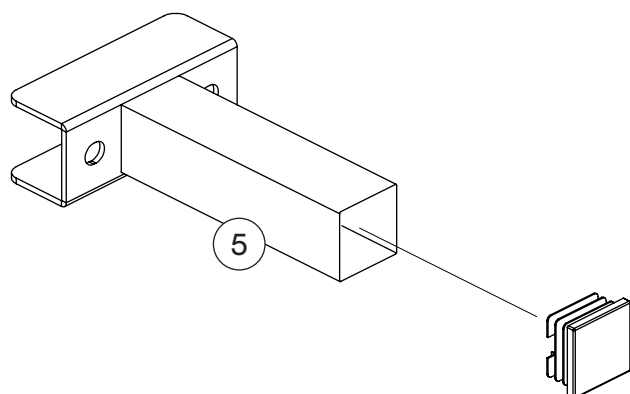

# 3

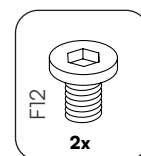
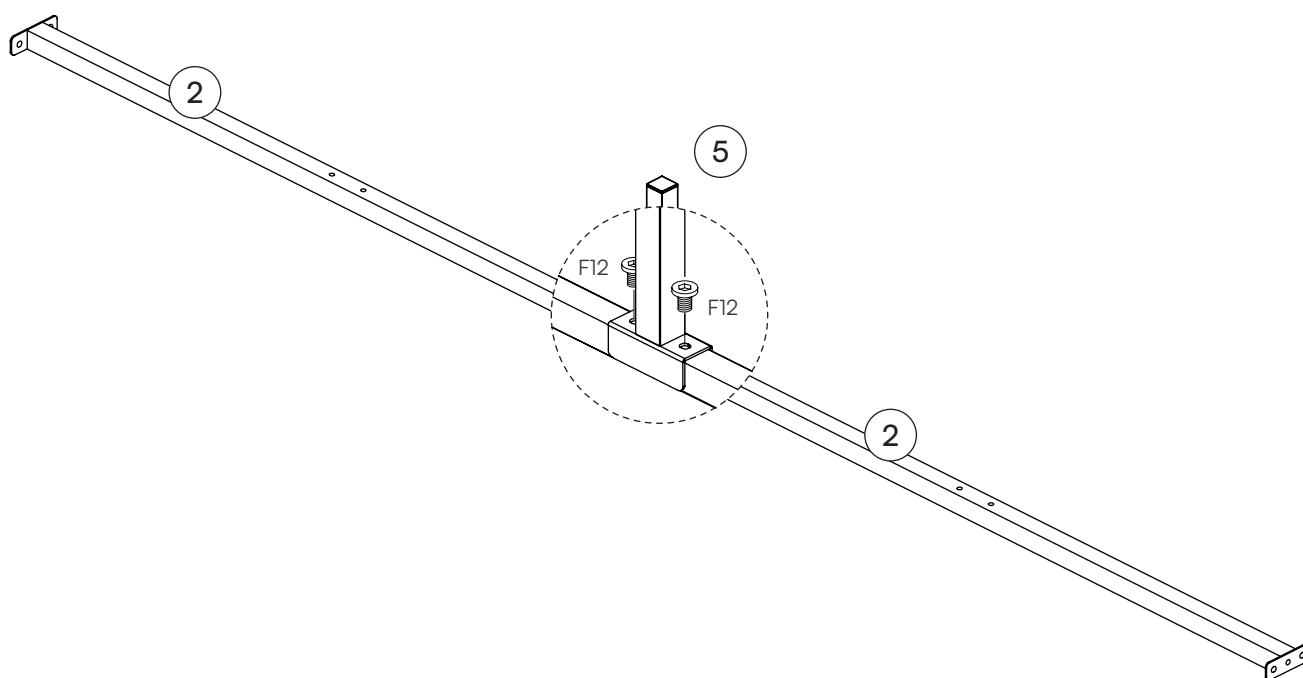



# 4

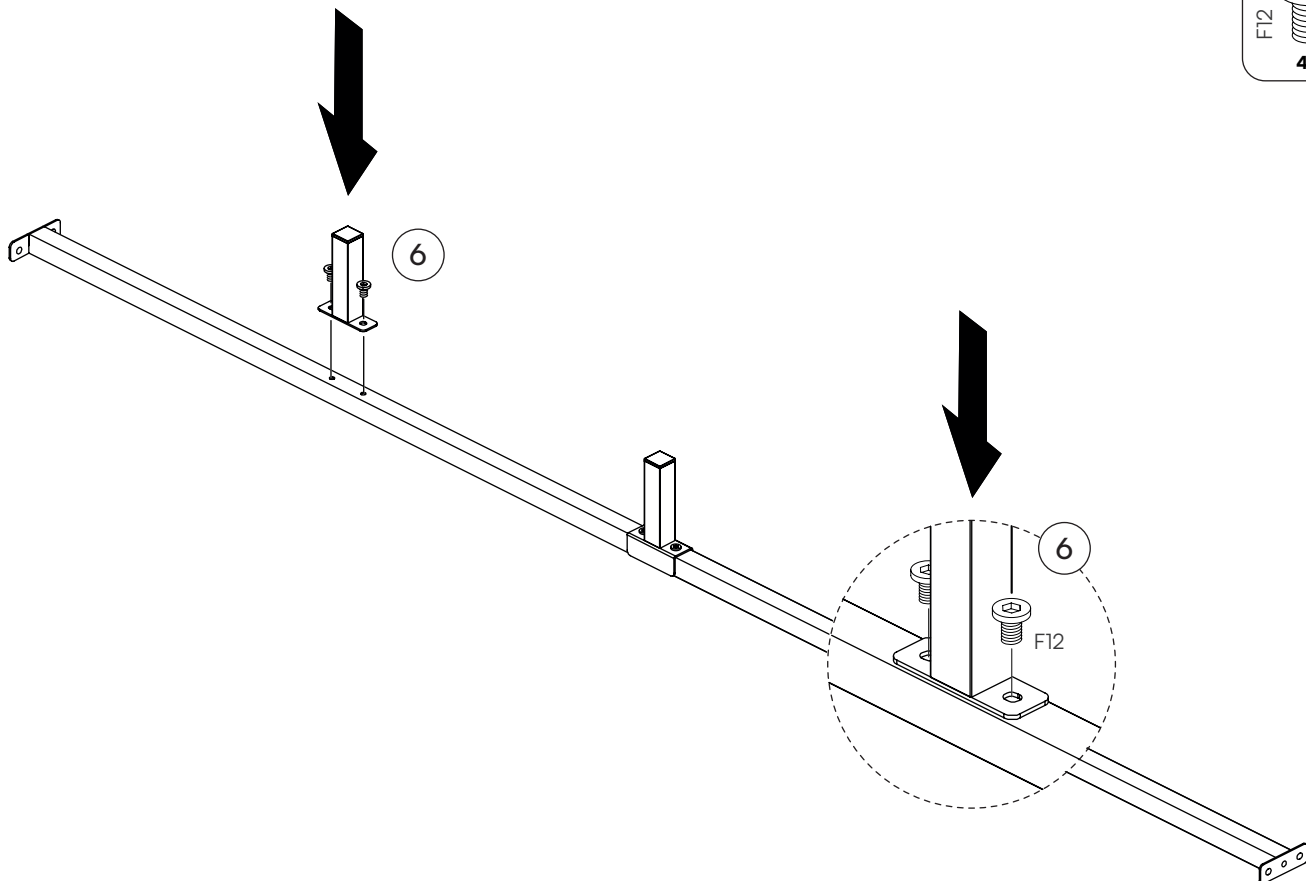

# 5

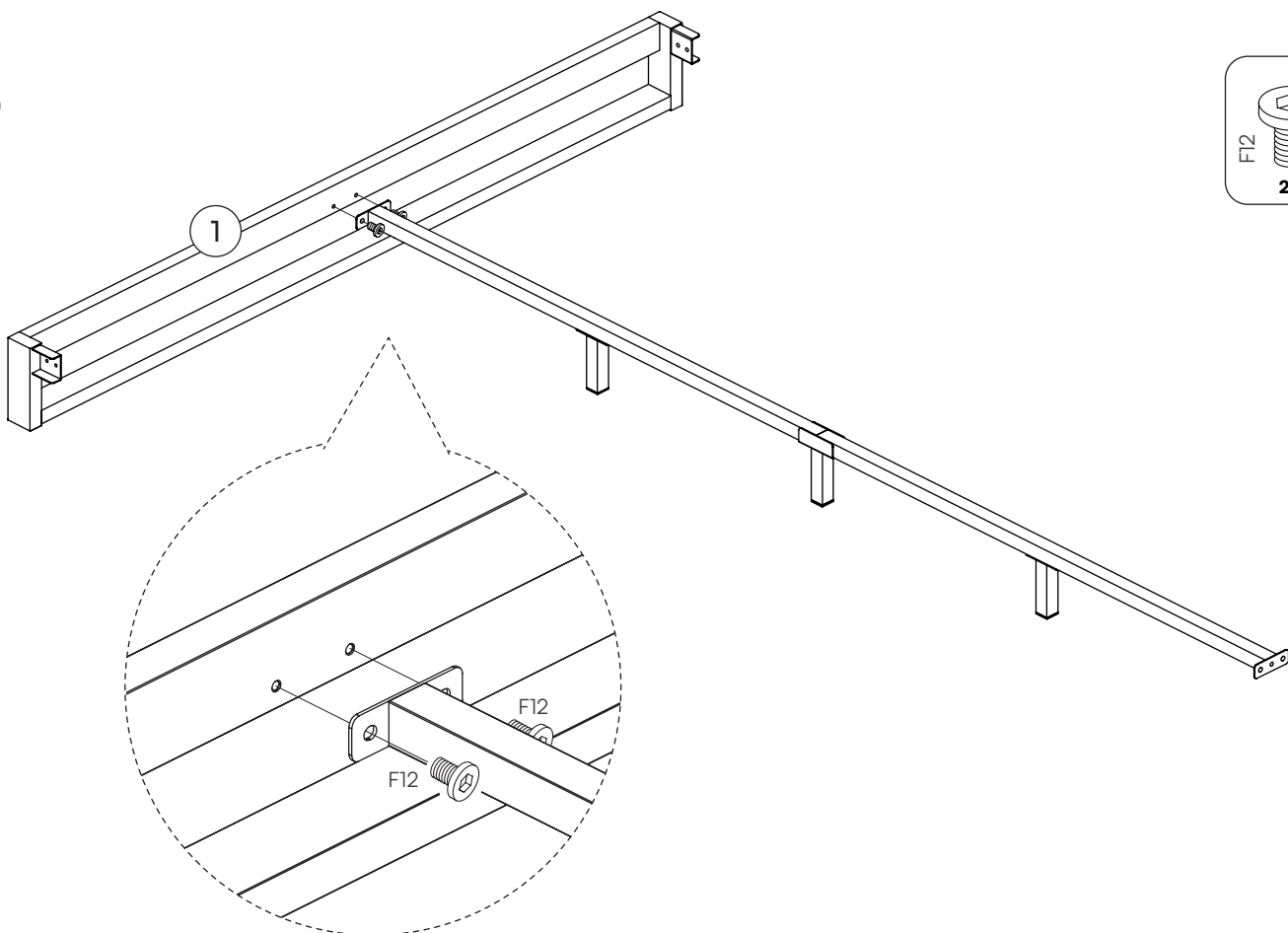

6

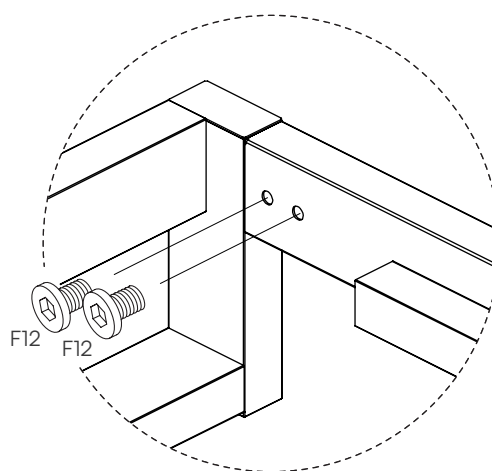
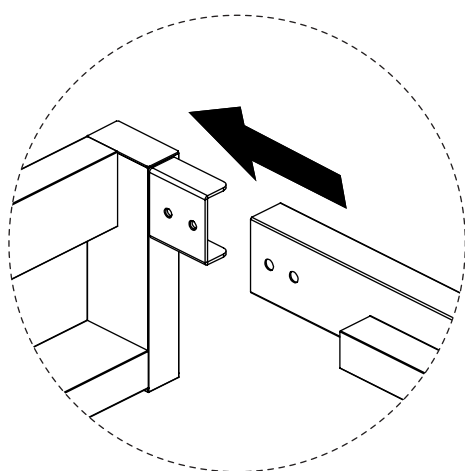
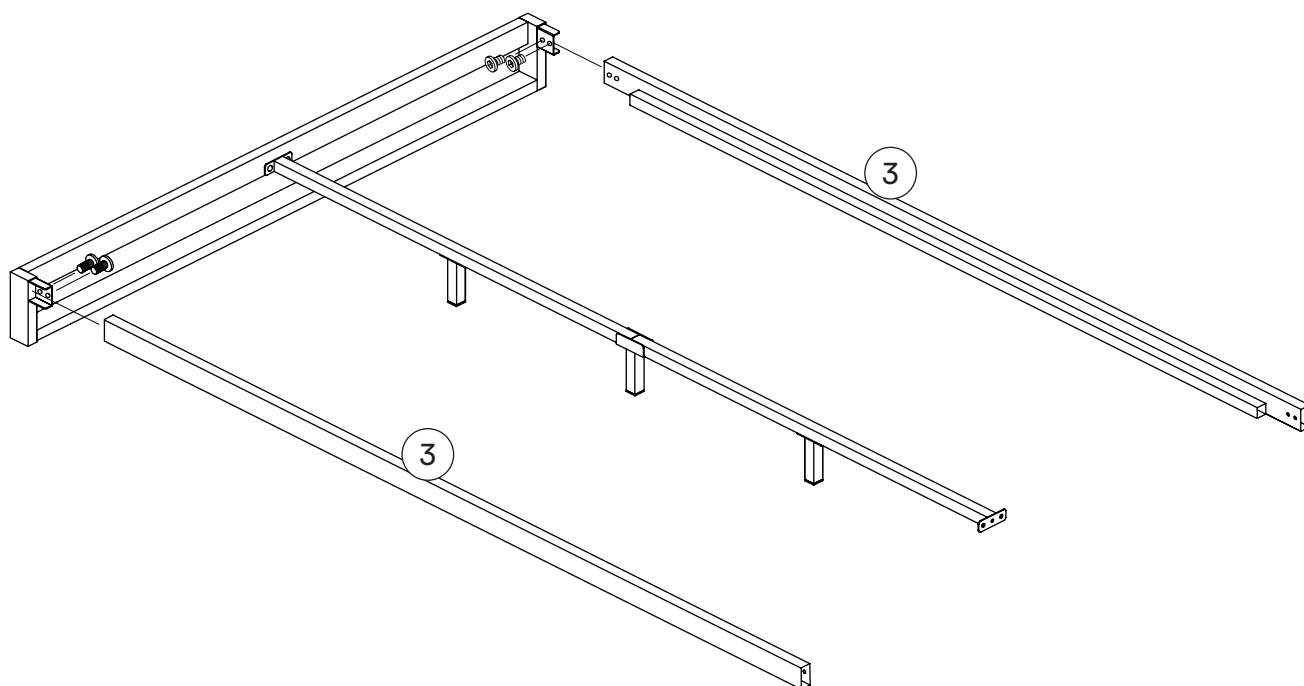
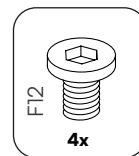

7

